

G40, G50, G40 Air & G50 Air

A flip front welding and grinding helmet



G40 & G50 is a combined welding and grinding helmet of which the G40 houses a passive mineral glass and the G50 houses an ADF Automatic Darkening Filter, shade levels DIN 9-13, and with flip-up visor. The large plastic lens gives the welder an unobstructed field of view when the visor is flipped up. The helmets are rated B in the impact resistance classification, which means they are approved for grinding.

- Lightweight shell
- Automatic / fix shade options
- Large inner grinding visor (clear)
- Comfort headgear
- Respiratory option with ESAB PAPR

Visit esab.com for more information.

Process

- SMAW/MMA (Stick)
- GMAW (MIG/MAG)
- GTAW (TIG)
- Grinding
- Oxy Fuel Cutting
- Plasma Cutting
- PAW - Plasma Arc Welding



G50 Air with ESAB PAPR

Specifications

Model	G40	G50
Viewing Area	60 x 110 / 90 x 110 mm	97 x 47 mm
Lens Shade	DIN 10	9-13 Automatic
Power Supply	-	Solar cell, no battery change
Standards	EN12941 Class TH3 P R SL	EN12941 Class TH3 P R SL
Classification	-	1/1/1/2
Weight Standard Helmet	700 g	730 g
Weight Air Version Helmet	870 g	890 g

Ordering Information

G40 60 x 110	0700000436
G40 90 x 110	0700000437
G50 9-13	0700000438
G40 Air 60 x 110 Prepared for fresh air (incl. air duct and face seal)	0700000439
G40 Air 90 x 110 Prepared for fresh air (incl. air duct and face seal)	0700000440
G50 Air 9-13 Prepared for fresh air (incl. air duct and face seal)	0700000441
PAPR with Standard Hose 850 mm (33.5 in)	0700002300
PAPR with Long Hose 1000 mm (39.4 in)	0700002301

Wear and Spare Parts

1. Main Shell G30, G40 & G50	0700000515
2. Large inner Visor G30, G40 & G50 - Clear	0700000501
3. Front Cover Lens G40 & G50	0700000517
4. Filter Lens 60 x 110 Shade 10 Pk 25	0160292002
4. Filter Lens 90 x 110 Shade 10 Pk 25	0760031632
5. Lens Retainer G40 & G50	0700000518
6. G50 ADF	0700000523
7. Cradle G40 90 x 110 & G50	0700000519
7. Cradle G40 60 x 110	0700000520
8. Gasket for Mineral Glass G40 60 x 110 & 90 x 110	0700000521
9. Head gear	0700000415
9A. Sweat band	0700000414
10. Headgear including air duct	0700000420
11. Head & Face Seal for G30, G40 & G50	0700000512
Kit Bag (empty)	0700002315

For additional information on PAPR units please see separate fact sheet.

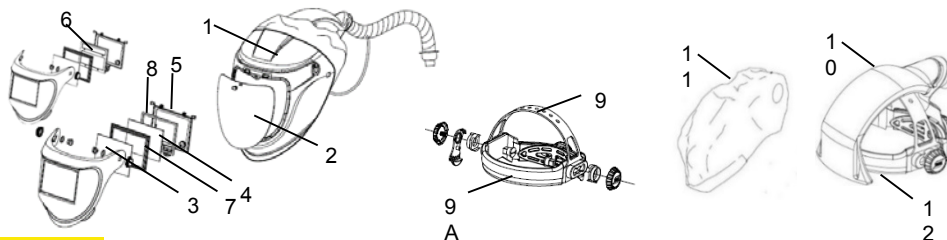

ESAB / esab.com

