

lil' fella™

Trolling Plate

Little Brother to the HAPPY TROLLER®

For Outboard Motors Up To and Including 25 Horsepower

INSTALLATION INSTRUCTIONS

- Step 1:** Remove the four 1/4" (6.5 mm) mounting bolts, washers, and nuts from package and retain for installation.
- Step 2:** Pull control handle and allow troll plate to move down into troll position. **CAUTION: Troller is spring loaded; don't pinch your fingers.**
- Step 3:** Locate the anti-cavitation plate on your motor or outdrive. It's the wide horizontal plate which extends just above the propeller. Always select the flat side of the anti-cavitation plate to mount the Lil' Fella. Where possible, mount the unit on the underside of the cavitation plate.
- Step 4:** With the troller plate locked in the troll (down) position, place Troller on the anti-cavitation plate and move as far forward as possible without causing interference with the Troller's operating mechanism. Prior to drilling, pull cord making sure the locking bar moves all the way forward to the end of its slots, without any interference with the anti-cavitation plate, fins, or ridges. Square up the Troller and use two small "C" clamps to hold it securely in place for drilling. Note: The two forward and two stern holes are to be used for most outboard motor installations.
- Step 5:** Using a 1/4" (6.5 mm) drill bit, place drill in existing hole in mounting plate. Using the hole as a drill guide and keeping the drill square, drill straight through the anti-cavitation plate (this plate is a solid casting and no water jacket is involved). Before proceeding to the next hole, insert a 1/4" (6.5 mm) bolt in the hole just drilled. Position head of bolt on the mount plate side and lightly tighten the nut and washer on the anti-cavitation plate side. Repeat this procedure for the three remaining holes. Tighten all four bolts, but **be careful not to over-tighten.**
- If for some reason the hole pattern in the Lil' Fella does not work for your anti-cavitation plate, feel free to drill new holes in the Lil' Fella to obtain the best possible fit and maximum strength. **Do not attempt to modify your anti-cavitation plate.**
- Step 6:** Uncoil Troller control cord and tie off securely in a convenient location, preferably in the center of the stern of your boat. **CAUTION: Allow sufficient slack in the control cord to prevent accidental operation of the Troller during full turns of the boat. Such inadvertent operation, going undetected, could cause damage to the Troller or anti-cavitation plate. Excess slack may foul in the propeller, also resulting in damage.**

OPERATING INSTRUCTIONS

Always lubricate moving parts before each day's use.

- Step 1:** We recommend keeping your Troller in the troll (down) position for storage and trailering.
- Step 2:** Before launching your boat, make certain the troll plate is in the cruise (up) position. To accomplish this, pull the control lever forward with one hand and lift up the troll plate with the other hand. When troll plate is against the stop (horizontal), release the control lever and the Troller will lock in the cruise/travel position. You are now ready to launch your boat. **After launching, visually check to make sure the Troller is in the cruise (up) position before getting underway.**
- Step 3:** Ready to troll?
- Bring boat to a full stop.
 - Place motor in neutral.
 - Pull control cord to end of its travel and hold for a few seconds while the springs move troll plate to the locked down position, then release.
 - Shift to forward gear and slowly adjust throttle for proper trolling speed. Troll speed will normally be 50 to 75 RPM above dead idle. **Caution: Damage will occur if sudden throttle is applied or engine is operated over 1200 RPM while in trolling position.**
- Step 4:** Finished trolling?
- Reduce speed to dead idle.
 - While still in forward gear, pull control cord. You should feel a sudden movement forward as the troll plate is released.
 - Stop and visually check to make sure the troll plate is released (locked in the up position).
 - Slowly proceed to cruising speed. If drag is felt, stop immediately and check Troller position.
 - Visually check one more time. If in locked up position, you may proceed to full power.

Be sure to carefully follow these instructions. Neither the manufacturer or re-seller are responsible for the correction of any damage incurred to the boat, engine, anti-cavitation plate, lower drive, propeller, or the Troller.

Save These Instructions

lil' fella™

Trolling Plate

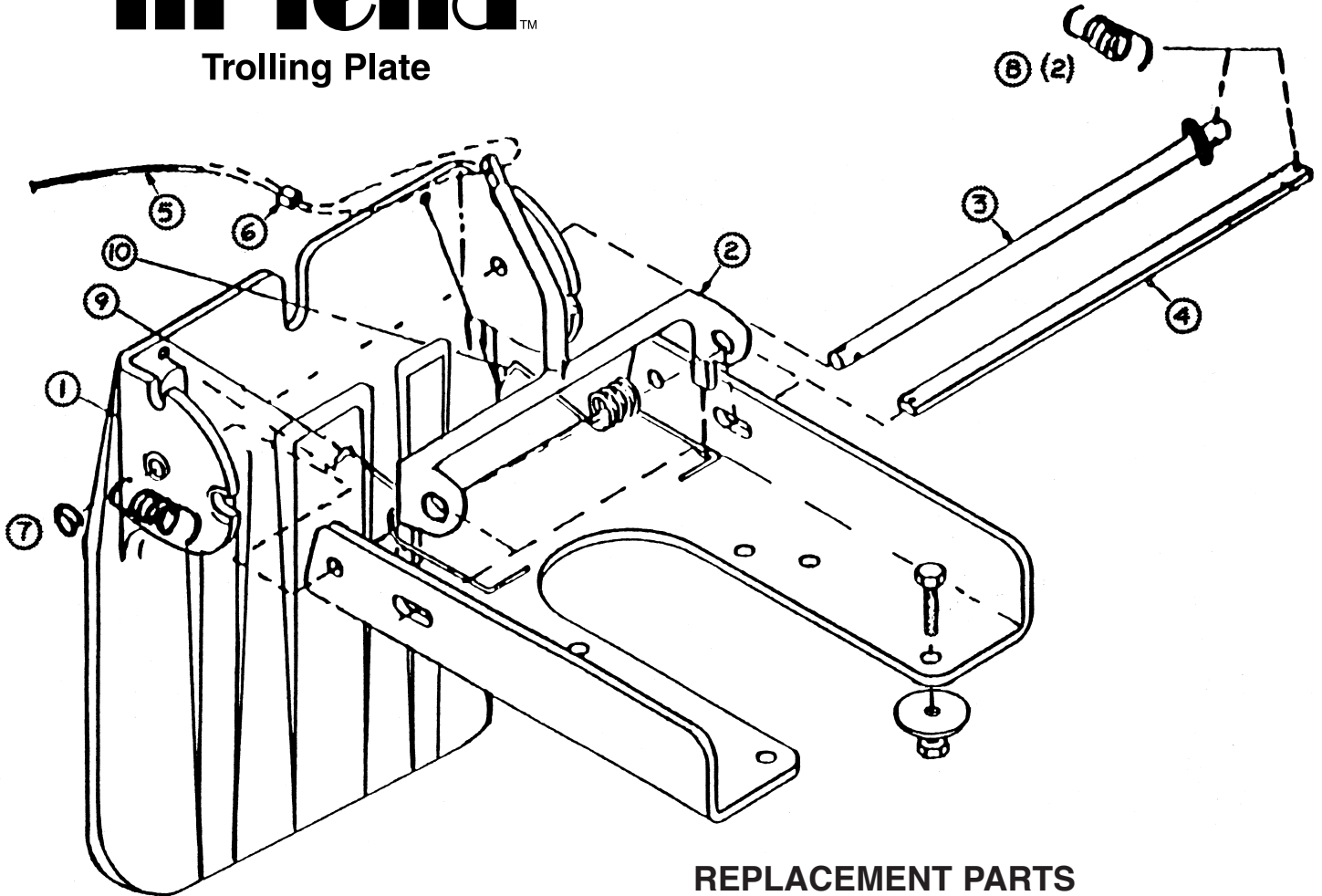

REPLACEMENT PARTS

Lil' Fella™ replacement parts may be available through your local dealer. If not, you may order directly from Davis Instruments Corporation.

| Part Number | Description | Order Number |
|-------------|--|-------------------------------------|
| 2 | Control Arm with Cord and Swedge | R462B |
| 3 | Pivot Rod | } R462C Lil' Fella™ Parts Kit |
| 4 | Locking Bar | |
| 5, 6 | Control Cord and Swedge | |
| 7 | Ring Pin, stainless steel | |
| 8 | Locking Bar Springs, stainless steel (2) | |
| 9 | Lowering Spring, LH stainless steel | |
| 10 | Lowering Spring, RH stainless steel | |

R462A Backplate is no longer available.

ONE-YEAR WARRANTY

We warrant our products to be free of defects in material and workmanship for one year from the date of original purchase. Write for full warranty details.

Davis Instruments

3465 Diablo Ave., Hayward, CA 94545 U.S.A.
Phone (510) 732-9229 • Fax (510) 732-9188
info@davisinstruments.com

www.davisinstruments.com