

**DAVIS** 

# HAPPY TROLLER®

For the Fisherman who thinks he has everything!

#460 LARGE  
#461 SMALL

**Happy Troller** is the answer to correct trolling speed. Trolls big motors down to that "ever so slow" fish-tantalizing speed. Use it year-round in all boating activities—great for both salt and fresh water. Two sizes fit all I/Os and outboard motors:

#460 Large Fits inboards/outdrives plus all outboard motors 50 HP and larger.

#461 Small Fits outboard motors from 20–50 HP.

For motors under 20 HP, see Lil' Fella™, product #462

Happy Troller mounts on the anti-cavitation plate with stainless steel hardware included. Installs in 15 minutes.

Made with high-quality clear anodized aluminum plates with stainless steel parts. Three position design—locks "down" for trolling and "up" for cruising, with middle position for added flexibility.

**HAPPY TROLLER** offre une parfaite vitesse de traine a votre bateau. Permet de "retenir" la vitesse de votre moteur pour obtenir la vitesse ideale pour la pêche a la traine. Peut etre utilisé en toute saison, et lors de toutes vos activités nautiques. Excellente performance en eaux claires et eaux salées. Deux tailles: #460 Grande pour tout moteur (hors-bord ou in-bord/interieur) de plus de 50 HP; #461 Normale pour tout moteur de 20 a 50 HP. Se monte facilement sur la plaque anti-depression du moteur. S'installe en 15 min. Fabrication aluminium de haute qualité et avec un fini anodisé clair. Les pieces de montage sont en inox. Visserie de montage Inox incluse.

**Happy Troller** ist DIE Lösung für die richtige Schleppgeschwindigkeit. Große Motoren werden auf die „ach so langsame“, für Fische aber attraktive Geschwindigkeit reduziert. Ganzjähriger Einsatz für alle Sportboote möglich—großartig sowohl im Süß- als auch im Salzwasser. Zwei Größen—Groß, Nr. 460 für alle Innen-/Außenbordmotoren und Motoren über 50 PS und Klein, Nr. 461 für Motoren von 20 bis 50 PS. Befestigung an der Antiwirbelplatte. Einbau in nur 15 Minuten. Hergestellt aus hochwertigen, farblos eloxierten Aluminiumplatten mit Edelstahlteilen und -befestigungen. Inklusive Befestigungsteile aus Edelstahl.

**Happy Troller** è la soluzione giusta per la pesca a traina. Riduce la velocità dei motori potenti per ottenere l'andatura lenta che attira i pesci. Da utilizzare tutto l'anno per tutte le attività in barca; ideale in acqua dolce e salata. Due misure: grande, n. 460, per tutti i motori entro bordo/fuoribordo e al di sopra di 50 CV; piccola, n. 461, per i motori con potenza compresa fra 20 e 50 CV. Da montare sul pannello anticavitazione. Si installa in 15 minuti. Realizzato con pannelli di alluminio anodizzati bianchi di alta qualità con componenti e fissaggi in acciaio inossidabile. Componenti in acciaio inossidabile inclusi.

**Happy Troller** es la respuesta a la velocidad de caceo correcta. Cacee grandes motores hasta la velocidad que es más atractiva para los peces. Se puede usar durante todo el año en cualquier actividad de navegación. Ideal para su uso en agua salada y en agua dulce. Dos tamaños—Grande #460 para todos los motores intraborda o fueraborda, y para motores de mas de 50 CV y Pequeño #461 para motores de 20-50 CV. Se monta sobre la placa anticavitación. Se instala en 15 minutos. Se ha fabricado con placas de aluminio anodizado claro de alta calidad, con piezas y accesorios de acero inoxidable. Accesorios de acero inoxidable incluidos.

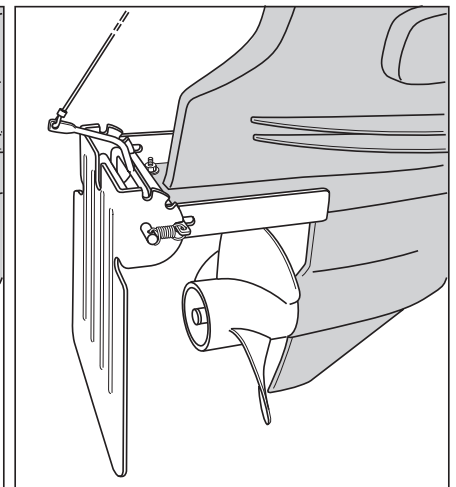
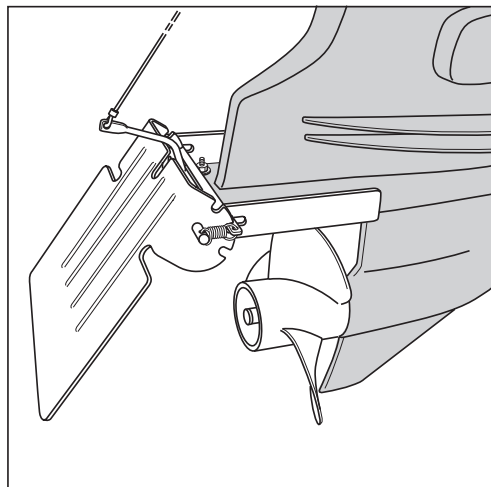
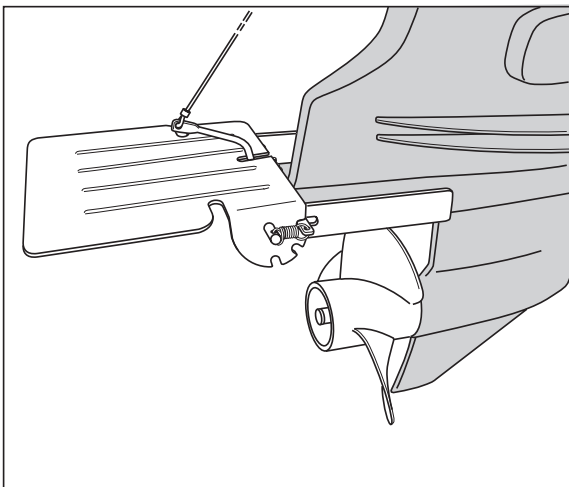

Se verrouille en position "basse" pour vitesses de traine, "haute" pour vitesses de croisiere. Un troisieme cran est disponible pour vitesses intermédiaires.

Schleppangeln: „unten“ arretierbar. Beim Kreuzen: „oben“ arretierbar. Plus dritte Einkerbung für Befestigung in der mittleren Position.

Blocco nella posizione abbassata per l'andatura per pesca a traina. Sollevata per la velocità di crociera. Terzo dente supplementare per la posizione intermedia.

Se bloquea para cacear. Se desbloquea para navegar. Tercera hendidura añadida para posición media.

## INSTALLATION INSTRUCTIONS

Be sure you have the right model of Happy Troller® for your boat.

Large size fits inboard/outboard and outboard motors 50 hp and larger.

Small size is for 20–50 hp.

For boats under 20 hp, see Lil' Fella™, product #462.

- Step 1:** Remove the four 1/4" (64 mm) mounting bolts, washers, and nuts from package and retain for installation.
- Step 2:** Pull control handle and allow troll plate to move down into troll position. **CAUTION: Troller is spring loaded; don't pinch your fingers.**
- Step 3:** Locate the anti-cavitation plate on your motor or outdrive. It's the wide flange directly above the propeller. Mount the Happy Troller on the underside when possible, but with some designs it must go on top.
- Step 4:** With the troller plate locked in the down position, place Troller on the anti-cavitation plate and move as far forward as possible without causing interference with the Troller release mechanism. Prior to drilling, pull cord making sure the locking bar moves all the way forward to the end of its slots. Square up the Troller and use two small "C" clamps to hold it securely in place for drilling. Note: Use the two forward mounting holes and whichever two of the four rear holes that will work best on your application. On Volvo outdrives with hollow anti-cavitation plates, longer 1/4" x 2" (.65 x 5.1 cm) bolts than provided will be needed. **CAUTION: Locate Troller so that rubber exhaust flap on older Volvos has clearance to fully open with the Troller locked in the down position.**
- Step 5:** Using a 1/4" (6.5 mm) drill bit, and using punched hole as a guide and keeping bit square, drill straight through the anti-cavitation plate. Before proceeding to the next hole, insert a 1/4" (6.5 mm) bolt from the mount plate side and lightly tighten the nut and washer on the anti-cavitation plate side. Repeat this procedure for the three remaining holes. Tighten all four bolts, but **be careful not to over-tighten**. The nylock nuts are self-locking and will not work loose. If the hole pattern in the Troller does not work for your anti-cavitation plate, feel free to drill new holes in the Happy Troller to obtain the best possible fit. **Do not attempt to modify your anti-cavitation plate.**
- Step 6:** Uncoil Troller cord and tie off securely in a convenient location, preferably in the center of the stern of your boat. **Leave enough slack in the cord to permit full turn without accidental operation of the Troller, but tie short enough to prevent the cord from getting caught in the propeller.**

## OPERATING INSTRUCTIONS

Always lubricate moving parts before each day's use.

- Step 1:** We recommend keeping your Troller in the down position for storage and trailering.
- Step 2:** Before launching your boat, make certain the Happy Troller is in the up position. To accomplish this, pull the control lever forward with one hand and lift up the troll plate with the other hand, release the locking bar as you lift up the troll plate, allowing it to "lock" in position. **After launching, visually check to make sure the Troller is up before getting underway.**
- Step 3:** Ready to troll?
- Bring boat to a full stop.
  - Place motor in neutral.
  - Pull control cord and hold for a few seconds while the springs move troll plate to the down position, then release.
  - Shift to forward gear and slowly adjust throttle for proper trolling speed. **Damage will occur if sudden throttle is applied or engine is operated over 1200 RPM.**
- Step 4:** Finished trolling?
- Reduce speed to dead idle.
  - While still in forward gear, pull control cord. You should feel a sudden movement forward as the troll plate is released.
  - Stop and visually check to make sure the troll plate is locked in the up position.
  - Slowly proceed to cruising speed. If drag is felt, stop immediately and check Troller position.

Be sure to carefully follow these instructions. Neither the manufacturer or re-seller are responsible for the correction of any damage incurred to the boat, engine, anti-cavitation plate, lower drive, propeller, or the Troller. **The trolling plate is designed to bend to prevent damage to the anti-cavitation plate if the recommended engine RPM is exceeded.**

**Save These Instructions**

## ONE-YEAR WARRANTY

We warrant our products to be free of defects in material and workmanship for one year from the date of original purchase. Write for full warranty details.

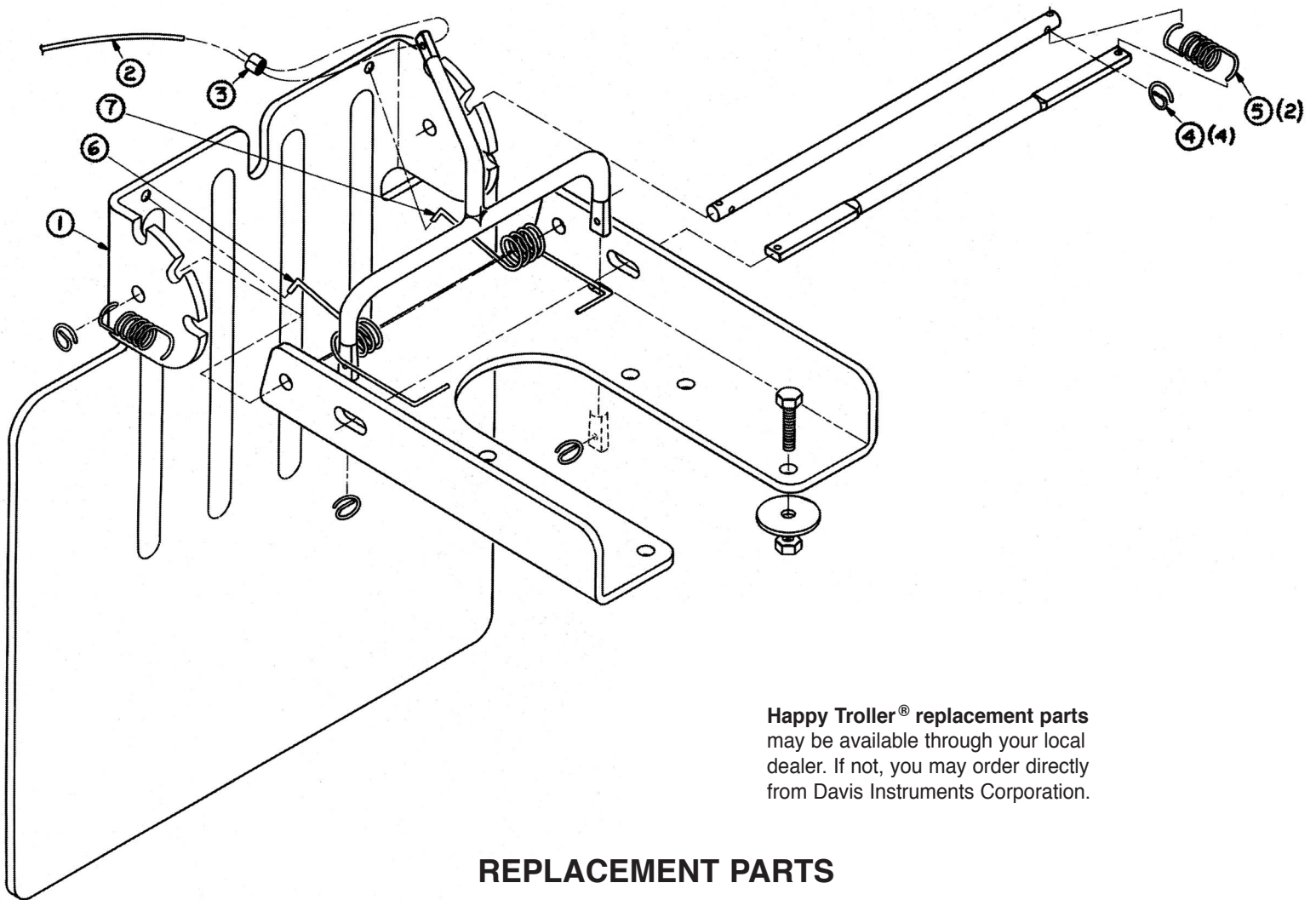

Happy Troller® replacement parts may be available through your local dealer. If not, you may order directly from Davis Instruments Corporation.

## REPLACEMENT PARTS

Part Number	Description	Order Number
1	Backplate for Large Troller, anodized aluminum	<b>R460A</b>
2, 3	Control Cord and Swedge	} <b>Product #468 Happy Troller® Parts Kit,</b>
4	Ring Pins, stainless steel (4)	
5	Locking Bar Springs, stainless steel (2)	
6, 7	Lowering Springs, stainless steel (2)	

**R461A** Backplate for Small Troller is no longer available.

### **Davis Instruments**

3465 Diablo Ave., Hayward, CA 94545 U.S.A.

Phone (510) 732-9229 • Fax (510) 732-9188

[info@davisinstruments.com](mailto:info@davisinstruments.com)

[www.davisinstruments.com](http://www.davisinstruments.com)