

Parts and Instruction
Manual

Yale[®]

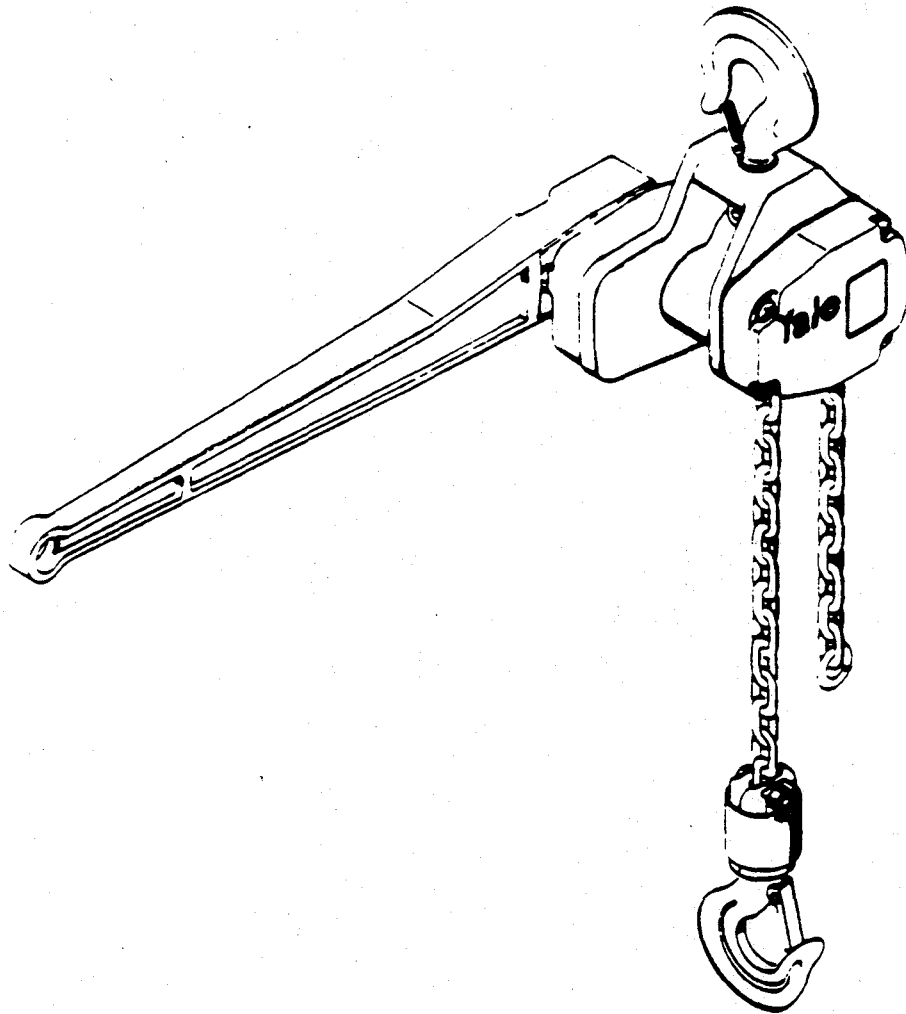



- TABLE OF CONTENTS -

SAFE HOISTING PRACTICES.....	2
GENERAL INFORMATION.....	5
Safe Operating Procedures.....	5
Warranty Policy.....	6
Repair Parts Ordering Information.....	6
Inspection.....	7
Operating Instructions.....	7
PREVENTIVE MAINTENANCE.....	8
Lubrication.....	8
Lubrication Guide.....	8
Daily And Annual Inspection.....	9
Function Testing.....	10
Load Chain Inspection.....	10
Repair Of Bottom Hook Or Chain.....	11
Allowable Hook Openings.....	12
Hook Alignment.....	13
Repair Or Replace Top Hooks.....	14
Repair Load Brake.....	15
RECOMMENDED SPARE PARTS FOR ONE YEAR.....	17
REPAIR PARTS SECTION.....	17
3/4 Ton Model PF Pul-Lift.....	18
3/4 Ton Model PE Pul-Lift.....	20
1 1/2 Ton Model PF Pul-Lift.....	22
1 1/2 Ton Model PE Pul-Lift.....	24
3/4-1 1/2 Ton Model PF Convertible Pul-Lift.....	26
3/4-1 1/2 Ton Model PE Convertible Pul-Lift.....	28
3 Ton Model PF Pul-Lift.....	30
3 Ton Model PE Pul-Lift.....	32
4 1/2 Ton Model PF Pul-Lift.....	34
4 1/2 Ton Model PE Pul-Lift.....	36
6 Ton Model PF Pul-Lift.....	38
6 Ton Model PE Pul-Lift.....	40
INSPECTION CHECK LIST.....	Final Pages

When Replacement Parts Are Needed, Order Only YALE® Factory Engineered Parts



Safe Hoisting Practices

Yale RATCHET LEVER HOIST

For your own safety and that of your fellow workers, Material Handling Equipment must be used and maintained as recommended by the Manufacturer. Failure to heed the following recommendations could endanger your life. Use good common sense and judgement at all times. Safety is the responsibility of the operator of the equipment. You must be competent and attempt to foresee and avoid all hazardous conditions. To be safe as possible, the hoist must be given proper preventative maintenance and testing as described in this manual.

BEFORE OPERATING HOIST:

1. Do not operate hoist unless you are properly trained, physically fit, and authorized to do so. You must be familiar with all operating controls of the hoist, warnings and instructions on the hoist, and the safe hoisting practices listed in this bulletin.
2. Do not allow unqualified personnel to operate the hoist.
3. Be familiar with the equipment and its proper care. Do not operate hoist if adjustments or repairs are necessary, if any damage or undue wear is known or suspected, or if any warning, operating, or capacity instructions normally attached to hoist are damaged or missing, report same promptly to the proper person and also notify next operator when changing shifts.
4. Conduct periodic visual inspections as described in Preventive Maintenance Section of this manual and make sure necessary lubrication and repairs are made.
5. Do not operate hoist if it is functioning improperly.
6. Do not operate hoist with an out-of-order sign attached until sign has been removed by a properly authorized person.
7. Do not adjust or repair hoist unless qualified for maintenance of hoist.
8. Do not use chain as a ground for welding.
9. Do not touch a welding electrode to the chain.
10. Never attempt to motorize or mechanically operate a hoist designed for manual operation.

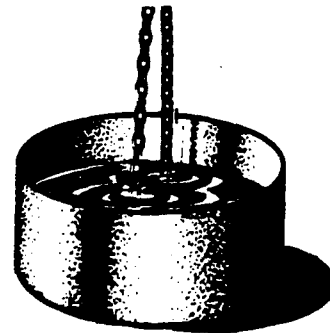

LUBRICATE AND INSPECT
CHAIN PERIODICALLY

When Replacement Parts Are Needed, Order Only YALE® Factory Engineered Parts



Safe Hoisting Practices

Yale RATCHET LEVER HOIST

APPLYING THE LOAD:

11. Never wrap the hoist chain around the load.
12. Use slings or other approved devices to attach load as necessary.
13. Be sure the load or sling is properly seated in the saddle of the hook. Do not allow hook safety latch to support any part of load.
14. Do not apply a load to tip of hook, or in such a way as to cause bending or prying forces on the hook or hook support block.
15. When loading, be sure chains are not kinked or twisted or that multiple part chains are not twisted about each other
16. Do not operate hoist if chain is not seated properly in the sheaves or sprockets.

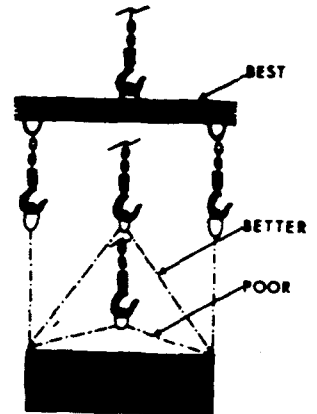

CONSIDER THESE ANGLES WHEN LIFTING LOAD

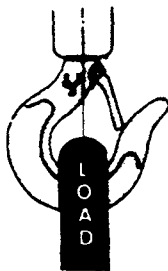

SEAT LOAD CORRECTLY IN HOOK

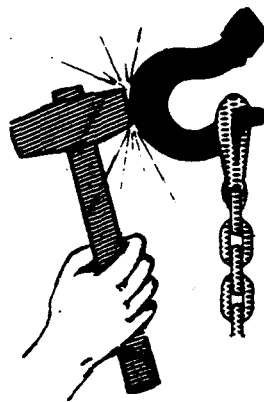

DO NOT FORCE HOOK



DO NOT KINK OR TWIST CHAIN

17. Center hoist unit on the load before loading. Avoid side pull.
18. Never apply a load beyond rated capacity appearing on the hoist, except for properly authorized tests.



DO NOT OVERLOAD

When Replacement Parts Are Needed, Order Only YALE® Factory Engineered Parts



Safe Hoisting Practices

Yale RATCHET LEVER HOIST

MOVING THE LOAD:

19. Do not engage in any activity which will divert your attention while operating hoist.
20. Respond to signals from designated personnel only, except for stop signals.
21. Never move a load with the hoist until you and all other personnel are clear of load.
22. Make sure a load has proper clearance before moving.
23. Do not lift load more than a few inches until it is well balanced in the sling or lifting device.
24. Each time a load approaching rated capacity is lifted, check load brake action by raising load just clear of supports and continuing only after you are sure brake is operating properly.
25. Do not transport load over personnel.
26. Never carry personnel on the hook or the load.
27. Avoid swinging of load or load hook when traveling.
28. Do not leave a load suspended in the air for extended or untended periods.

When Replacement Parts Are Needed, Order Only YALE[®] Factory Engineered Parts



Yale

GENERAL INFORMATION

IMPORTANT: Safe Operating Procedures

Before operating your YALE® PUL-LIFT, read the SAFE HOISTING PRACTICES (located on pages 1, 2, & 3). Read this information carefully for your safety and protection. Some of the most important points are re-emphasized below:

- (a) **CAUTION** DO NOT USE THIS EQUIPMENT FOR HANDLING PERSONNEL. IT IS INTENDED TO HANDLE MATERIALS ONLY.
- (b) DO NOT LOAD BEYOND THE RATED CAPACITY. The immediate danger is a possible failure of load carrying parts. Overloading may start defects leading to future failure at less than rated capacity.
- (c) On chain units that have a bottom sheave (3 ton through 6 ton), care must be taken to avoid flipping the bottom block. See Figure (1) below.

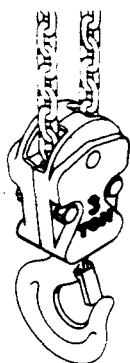

CORRECT

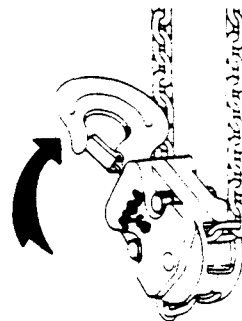

INCORRECT

Figure 1. Avoid flipping the bottom block. This will twist the chain creating damage and possible failure of hoist.

- (d) DO NOT use the hoisting chain as a substitute for slings. This damages the chain creating a possible failure. See Figure 2 page 6.

When Replacement Parts Are Needed, Order Only YALE® Factory Engineered Parts

GENERAL INFORMATION



Safe Operating Procedures continued

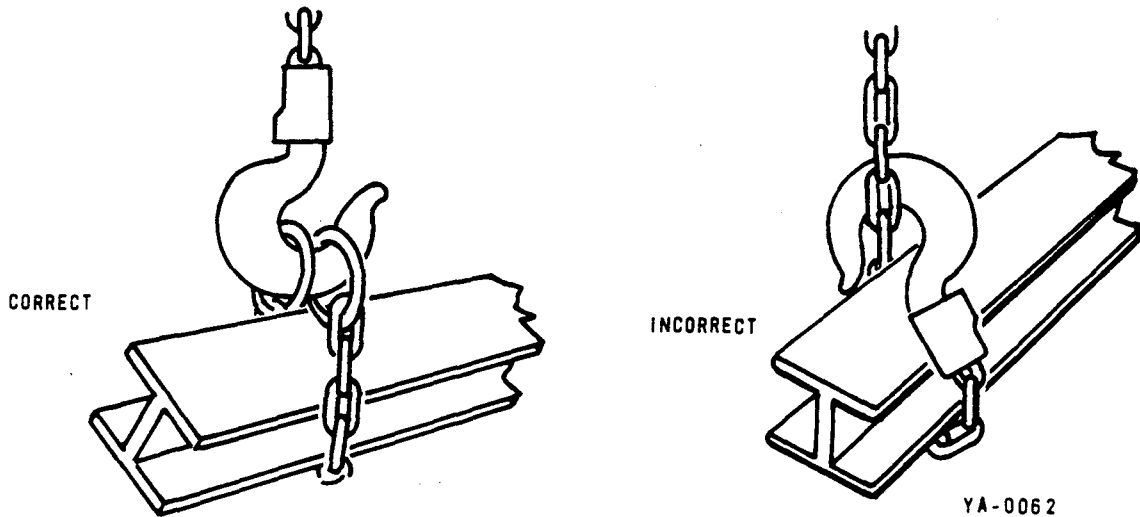

Figure 2. Using the hoisting chain as a sling will result in damage to chain and bottom block.

- (e) Make sure the load is seated properly in the seat of the hook. Never attempt to lift a load with the tip of the load hook. This will cause the hook to open and create an unsafe condition.
- (f) DO NOT drag chain under a load or use chain as a sling.
- (g) Lubricate and inspect chain periodically.
- (h) **CAUTION** DO NOT OIL LOAD BRAKE HUB, BRAKE DISCS, RATCHET DISC OR REACTION DISC. LOAD BRAKE MUST OPERATE DRY.

Warranty Policy

The warranty policy is located on the back cover and is self-explanatory.

Repair Parts Ordering Information

This instruction and parts manual is provided as a convenience to assist you in ordering repair parts for your YALE® PE and PF MODEL RATCHET LEVER HOISTS. To insure prompt service, place all parts orders with your local YALE® distributor.

Please give all information listed below in items (a), (b) and (c). This will enable your distributor to fill your order promptly.

- (a) Give model and capacity of your hoist.
- (b) Give part numbers, description and quantity required.
- (c) Give the correct shipping destination.

If it becomes necessary to return the complete hoist or certain parts to the factory, a letter requesting such a return is necessary. This letter should contain an explanation for requesting the return. A return authorization will be issued giving you clearance for returning the hoist or parts to the factory. Should you need additional help in ordering, contact your local YALE® distributor.

When Replacement Parts Are Needed, Order Only YALE® Factory Engineered Parts



Inspection

Before shipment the hoist is rigidly tested, inspected and carefully adjusted for proper operation. However, it would be wise to inspect for possible damage resulting during shipment and oil the chain.

Your YALE RATCHET LEVER HOIST is now ready for service. With the proper maintenance and care you should receive many years of service.

Operating Instructions

- (a) TO LIFT A LOAD: Place selector lever in "UP" position. Operate handle with a pump action.
- (b) TO LOWER A LOAD: Place selector lever in "DOWN" position. Operate handle with a pump action.
- (c) The pumping action (in hoisting and lowering) should be with the effort applied on downward movement of handle and with upward movement free. The opposite action is obtained by rotating handle to opposite side of hoist.
- (d) OPERATION WITHOUT LOAD: Place selector lever in neutral "N" position. Push down on "free chain" lever to disengage load brake pawl. This will allow the chain to be moved quickly and easily in either direction to engage a load.

CAUTION

BEFORE TRIPPING "FREE CHAIN" LEVER, PLACE HANDLE SELECTOR IN NEUTRAL "N" POSITION TO AVOID POSSIBLE INJURY FROM HANDLE MOVEMENT.

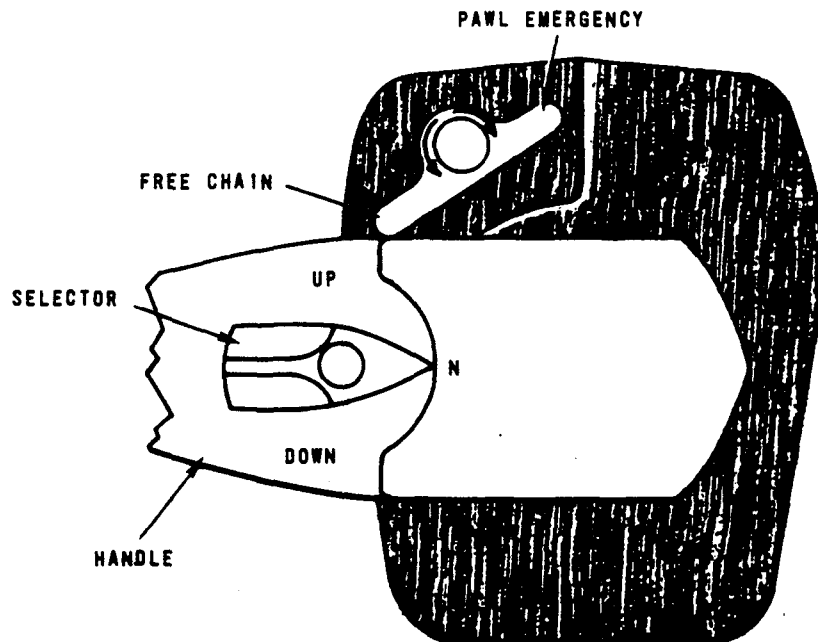

Figure 3. Control lever positions.

YA-0064

When Replacement Parts Are Needed, Order Only YALE[®] Factory Engineered Parts

PREVENTIVE MAINTENANCE



Operating Instructions continued

- (e) The "FREE CHAIN" lever also has pawl emergency marked on opposite side of lever. This pawl emergency is to be used only in case of emergency (broken pawl spring) when lowering a load.



DO NOT OIL LOAD BRAKE HUB, BRAKE DISCS, RATCHET DISC OR REACTION DISC.

- (f) Raising the lower hook to a point where it jams against housing or excessive overloading of PUL-LIFT may "FREEZE" the load brake. If this occurs, the brake can be released by placing selector lever in "DOWN" position, tapping handle with a hammer, and lowering with the handle.

PE and PF Ratchet Lever Hoist - Lubrication

LUBRICANT	LUBRICATION POINT	LUBRICATION INSTRUCTIONS
Gulf Crown no.2 Shell Alvania no.2 or equal	Gears, Axles and Pivot Points	Lubricate These Items When Unit Is Disassembled.
Graphited Keystone no. 2 or equal	Link Chain	Immerse all parts of chain in oil. Allow Oil To Drip. Wipe Excess Oil From Chain.
ESSO Coray 50 or equal Atlantic Non-Pariel	Roller Chain	Same As Link Chain.

LOAD BRAKE OPERATES DRY. DO NOT OIL.

Lubrication Of Chain

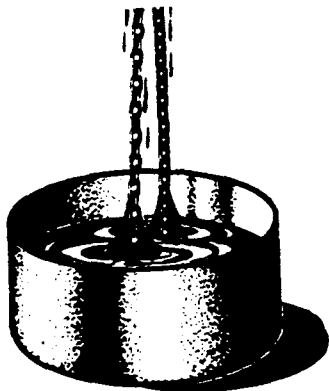

LUBRICATE AND INSPECT
CHAIN PERIODICALLY

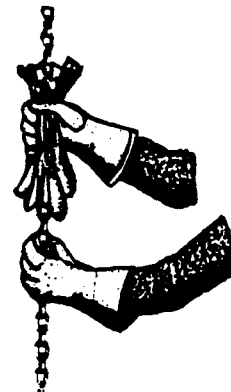

BRAKE OPERATES DRY. DO NOT OIL OR GREASE THE DISC HUB, FIBER DISC, RATCHET DISC OR RATCHET.

Note: AFTER IMMERSING CHAIN IN LUBRICANT, WIPE OFF SURFACE OF CHAIN. THIS WILL MAKE THE OUTER SURFACE OF THE CHAIN CLEAN AND ALLOW LUBRICATION BETWEEN THE LINKS WHERE THE LUBRICATION IS NECESSARY.

Figure 4. chain lubrication.

When Replacement Parts Are Needed, Order Only YALE[®] Factory Engineered Parts



PREVENTIVE MAINTENANCE

Inspection Is Important

The replacing of parts when worn, at small expense, will make your chain hoist last longer, maintain its efficiency and help prevent accidents due to breakage.

The following recommended inspection periods are based on an average duty, single shift operation of forty (40) hours per week under normal environmental conditions. If the hoist is used in heavier applications or in adverse environmental conditions, the inspections should be made more frequently.

Daily Inspection

Inspect the following items before using the hoist.

- (a) BRAKING MECHANISM: Check for slipping brake.
- (b) LOAD CHAIN: Check for worn, broken or cracked links. Check for grit, dirt or other foreign matter which may be carried into the hoist mechanism. Check for proper lubrication. Check chain for twists or kinks. If cracks or excessive wear is observed, see instructions under annual inspection below.
- (c) HOOKS: Check for cracks, chemical damage, or deformation. The bottom hook must swivel freely. If cracks, excessive damage, or excessive deformation is observed, see instructions under annual inspection below.

Note: Bent or twisted hooks indicate overloading or abuse of the unit. Other load bearing components of the hoist should be inspected for damage.

CAUTION

DO NOT OPERATE THE HOIST IF IT IS FUNCTIONING IMPROPERLY OR IF DAMAGE IS NOTED.

Annual Inspection

Inspect the following items at least once every year or more according to the paragraph above.

- (a) All items under Daily Inspection.
- (b) LOAD CHAIN AND SHEAVES: Check for excessive wear or corrosion of chain, load sheaves and bottom block sheaves. Check for chain stretch. If roller chain is used, check for exceptionally loose joints, exceptionally tight joints, worn or broken rollers, bent, cracked or deformed side plates, kinks or twists over the entire length of chain, and external corrosion or rust. Carefully inspect link chain for wear between the links in section of chain that most often passes over the sheave. Check several links, as wear is seldom even from one link to another. The chain should be replaced if wear has increased the specified gauge length beyond the maximum shown in tables on page 10.
- (c) HOOKS: Dye penetrant, magnetic particle or other suitable crack detecting inspection should be performed if need is indicated by external appearance. Replace hook if throat opening is in excess of maximum shown in table on page 12 or if there is 10 degrees or more twist from normal plane of hook.

When Replacement Parts Are Needed, Order Only YALE[®] Factory Engineered Parts

PREVENTIVE MAINTENANCE



Inspection continued

- (d) **HARDWARE:** Check hook retaining nut, collars or pins for wear. Check for loose bolts, nuts or rivets. Check for missing or damaged hook latch.
- (e) **BRAKING MECHANISM:** Check for worn, glazed or oil contaminated friction discs, worn pawls or ratchet, and corroded, stretched or broken pawl springs.
- (f) **LOAD BEARING PARTS:** Check for worn, cracked or distorted parts such as hook blocks, suspension housing, chain attachments, clevises, yokes, suspension bolts, shafts, gears and bearings.
- (g) Check for missing or illegible warning labels and replace as necessary.
- (h) Fill out inspection check list at back of this manual, sign, date, and file for future reference.

Note: **INSPECTION RECORDS:** The last pages of this manual are inspection check lists to be filled out and signed by the person making the annual inspections.

Function Testing

After repair of hoist, test with a light load for proper function. Load test unit with 125% of the rated capacity by lifting and lowering through a short distance.

Load Chain Inspection

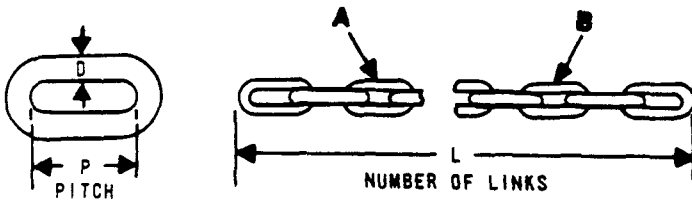

NOTE: GAUGE LENGTHS SHOULD BE CHECKED ON PORTION OF CHAIN THAT NORMALLY PASSES OVER THE LOAD SHEAVE. THE GAUGE LENGTH SHOULD BE CHECKED WITH A LOAD ON THE HOOK.

WARNING

WHEN REPLACING LOAD CHAIN USE ONLY YALE REPLACEMENT CHAIN. (SEE REPAIR PARTS SECTION)

LINK CHAIN NOTE: OTHER CHAINS MARKED Y-4 AND Y* ARE ALSO ACCEPTABLE.

STANDARD CHAIN NUMBER	CADMIUM PLATED CHAIN NO.	CHAIN MARKING		LINKS BETWEEN MARKINGS	D DIAMETER	P PITCH	L GAUGE LENGTH NOMINAL	L NUMBER OF LINKS IN GAUGE	REPLACE IF L EXCEEDS
		A	B						
0033640-00	0033641-00	Y*ORY1	1D	11	1/4	.75	14.76	19	15.00
0033645-00	0033646-00	Y*ORY1	2K	9	5/16	.91	17.83	19	18.12

WARNING

ROLLER CHAIN

PITCH	NUMBER OF PITCHES IN L	LENGTH L (INCHES)	REPLACE IF L EXCEEDS
5/8	20	12 1/2	12 3/4
1	12	12	12 1/4

WARNING

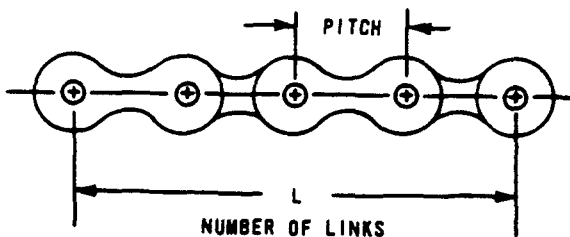

NOTE: WHEN ADDING OR REPLACING ROLLER CHAIN BE SURE SPLICING LINK, PIN AND WASHER IS RIVETED TOGETHER SECURELY AND WILL OPERATE FREELY.

WARNING

WHEN REPLACING ROLLER CHAIN, USE ONLY YALE HOISTING CHAIN. THE USE OF STANDARD TYPE ROLLER CHAIN WILL RESULT IN AN UNSAFE HOIST.

When Replacement Parts Are Needed, Order Only YALE® Factory Engineered Parts



PREVENTIVE MAINTENANCE

To Repair Bottom Hook or Chain On 3/4 Or 1½ Ton

- (a) Place selector lever in neutral "N" position.
- (b) **ROLLER CHAIN:** Remove the split retainer or two (2) cotter pins from chain stop link. Remove link side plate roller stop, side plate and pins from end of chain.
- (c) **LINK CHAIN:** Open and remove ring from end of chain.
- (d) Hold down free wheeling lever to disengage load brake pawl. Pull chain out of hoist. When replacing link chain, See Figure 6 page 12, and Figure 7 page 13.
- (e) **LINK CHAIN:** Remove socket head screw from bottom block. Remove retaining band from bottom hook.
- (f) Replace chain anchor bolt and block half when necessary.
- (g) **ROLLER CHAIN:** To replace any part of the bottom block assembly, first drill out detent with 1/4 inch drill. Secure hook in a vise. Drive band off with a hammer and punch, using access slots A and B per Figure 5 below.
- (h) After reassembly stake swivel band per Figure 5 below.

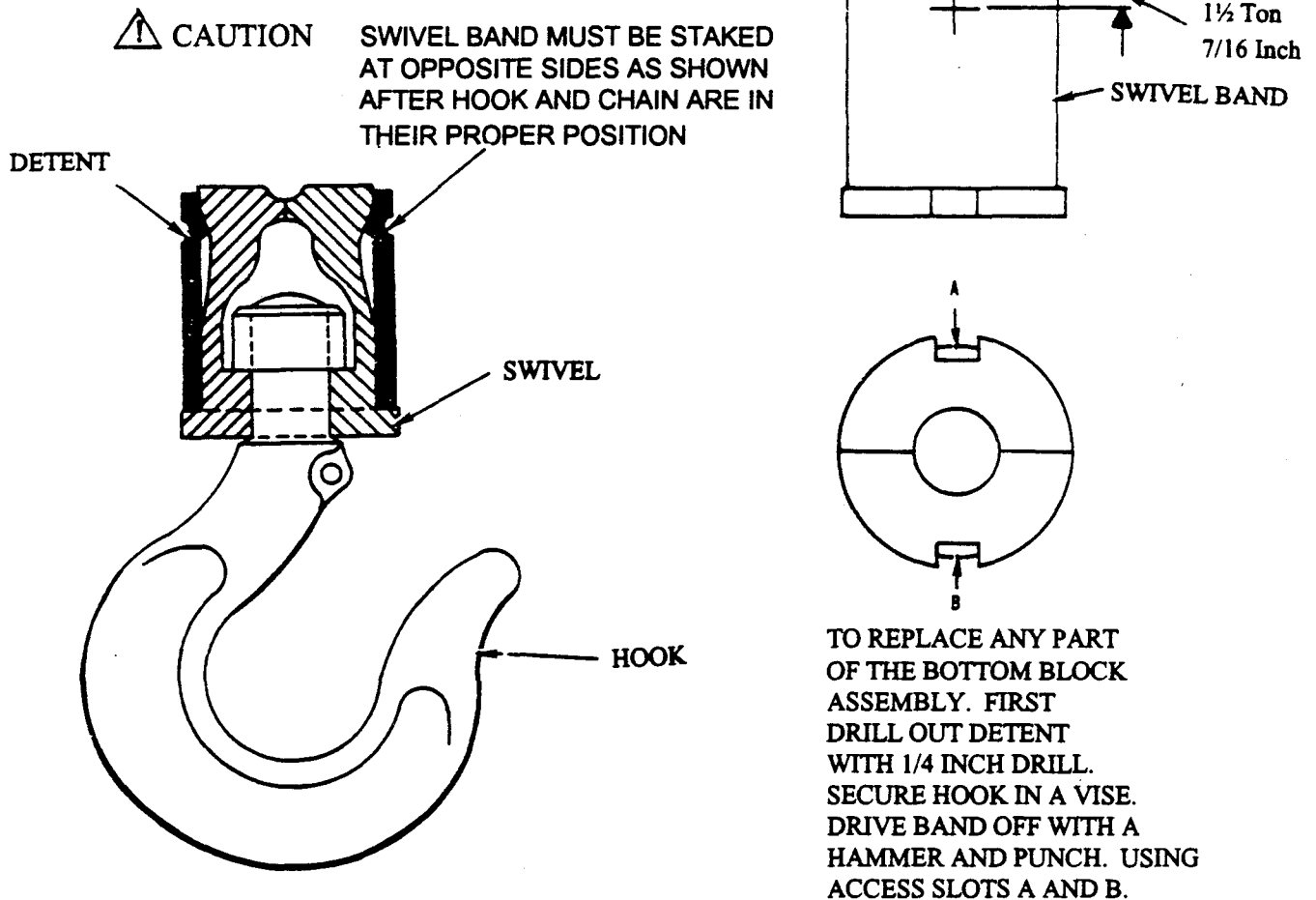

Figure 5. 3/4 and 1½ ton roller chain type bottom hook with component parts.

When Replacement Parts Are Needed, Order Only Yale® Factory Engineered Parts

PREVENTIVE MAINTENANCE



Chain Attachment

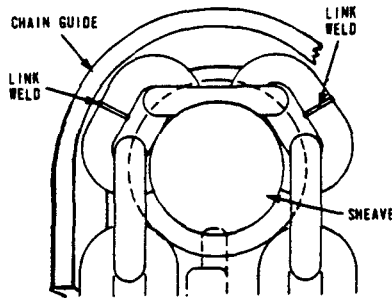

WELD ON STANDING LINK MUST FACE AWAY FROM SHEAVE

Figure 6.

PROPER POSITIONING OF LINK CHAIN ON LOAD SPROCKET

Allowable Hook Opening Dimensions

Hook Dimensions

DIMENSIONS IN INCHES

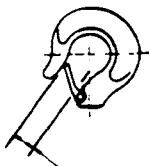

"E" NORMAL OPENING
WITH SAFETY LATCH

PE AND PF RATCHET LEVER HOIST
(E AND F PUL-LIFT)

CAPACITY IN TONS	E TOP HOOK		E BOTTOM HOOK	
	NORMAL	MAXIMUM	NORMAL	MAXIMUM
3/4 PE	1 5/32	1 13/32	1 1/32	1 7/32
3/4-1 1/2 PE	1 5/32	1 13/32	1 5/32	1 13/32
1 1/2 PE	1 5/32	1 13/32	1 5/32	1 13/32
3 PE	1 11/32	1 19/32	1 5/16	1 19/32
4 1/2 PE	1 11/32	1 19/32	1 17/32	1 13/16
6 PE	1 21/32	1 31/32	2 1/8	2 15/32
3/4 PF	1 5/32	1 13/32	1 1/32	1 7/32
3/4-1 1/2 PF	1 5/32	1 13/32	1 5/32	1 13/32
1 1/2 PF	1 5/32	1 13/32	1 5/32	1 13/32
3 PF	1 11/32	1 19/32	1 5/16	1 19/32
4 1/2 PF	1 11/32	1 19/32	1 17/32	1 13/16
6 PF	1 21/32	1 31/32	2 1/8	2 15/32

WARNING

REPLACE HOOK IF "E"
EXCEEDS MAXIMUM
SHOWN IN CHART

When Replacement Parts Are Needed, Order Only YALE® Factory Engineered Parts

PREVENTIVE MAINTENANCE



Chain Attachment

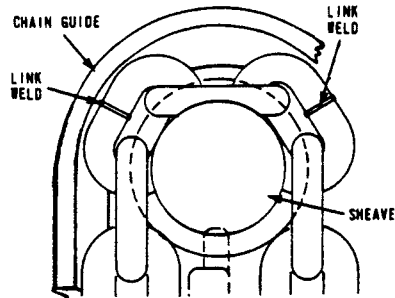

WELD ON STANDING LINK MUST FACE AWAY FROM SHEAVE

Figure 6.

PROPER POSITIONING OF LINK CHAIN ON LOAD SPROCKET

Allowable Hook Opening Dimensions Hook Dimensions

DIMENSIONS IN INCHES



WARNING

REPLACE HOOK IF "E"
EXCEEDS MAXIMUM
SHOWN IN CHART

PE AND PF RATCHET LEVER HOIST
(E AND F PUL-LIFT)

CAPACITY IN TONS	E TOP HOOK		E BOTTO
	NORMAL	MAXIMUM	NORMAL
3/4 PE	1 5/32	1 13/32	1 1/32
3/4-1 1/2 PE	1 5/32	1 13/32	1 5/32
1 1/2 PE	1 5/32	1 13/32	1 5/32
3 PE	1 11/32	1 19/32	1 5/16
4 1/2 PE	1 11/32	1 19/32	1 17/32
6 PE	1 21/32	1 31/32	2 1/8
3/4 PF	1 5/32	1 13/32	1 1/32
3/4-1 1/2 PF	1 5/32	1 13/32	1 5/32
1 1/2 PF	1 5/32	1 13/32	1 5/32
3 PF	1 11/32	1 19/32	1 5/16
4 1/2 PF	1 11/32	1 19/32	1 17/32
6 PF	1 21/32	1 31/32	2 1/8

When Replacement Parts Are Needed, Order Only YALE® Factory Engineer



PREVENTIVE MAINTENANCE

To Repair Bottom Hook or Chain On 3/4 Or 1 1/2 Ton

- (a) Place selector lever in neutral "N" position.
- (b) **ROLLER CHAIN:** Remove the split retainer or two (2) cotter pins from chain stop link. Remove link side plate roller stop, side plate and pins from end of chain.
- (c) **LINK CHAIN:** Open and remove ring from end of chain.
- (d) Hold down free wheeling lever to disengage load brake pawl. Pull chain out of hoist. When replacing link chain, See Figure 6 page 12, and Figure 7 page 13.
- (e) **LINK CHAIN:** Remove socket head screw from bottom block. Remove retaining band from bottom hook.
- (f) Replace chain anchor bolt and block half when necessary.
- (g) **ROLLER CHAIN:** To replace any part of the bottom block assembly, first drill out detent with 1/4 inch drill. Secure hook in a vise. Drive band off with a hammer and punch, using access slots A and B per Figure 5 below.
- (h) After reassembly stake swivel band per Figure 5 below.

CAUTION SWIVEL BAND MUST BE STAKED AT OPPOSITE SIDES AS SHOWN AFTER HOOK AND CHAIN ARE IN THEIR PROPER POSITION

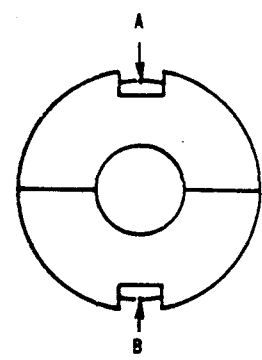
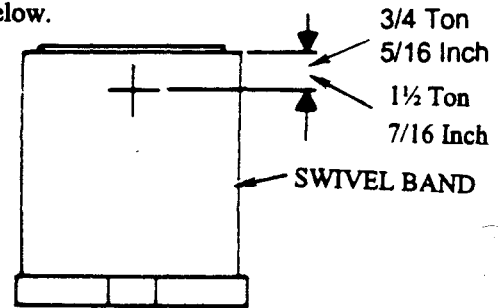
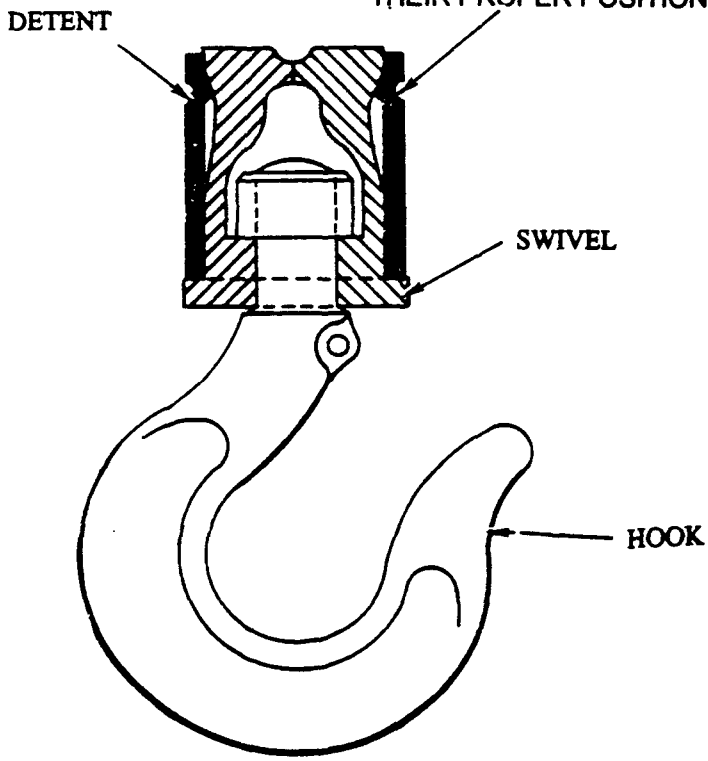

TO REPLACE ANY PART OF THE BOTTOM BLOCK ASSEMBLY. FIRST DRILL OUT DETENT WITH 1/4 INCH DRILL. SECURE HOOK IN A VISE. DRIVE BAND OFF WITH A HAMMER AND PUNCH. USING ACCESS SLOTS A AND B.

Figure 5. 3/4 and 1 1/2 ton roller chain type bottom hook with component parts.

When Replacement Parts Are Needed, Order Only Yale® Factory Engineered Parts

CAUTION

ON HOISTS WITH TWO PART REEVING, CARE SHOULD BE TAKEN NOT TO ROTATE THE BOTTOM BLOCK THROUGH THE CHAIN LOOP SINCE THIS WILL INTRODUCE A TWIST IN THE CHAIN LEADING TO JAMMING AND POSSIBLE FAILURE.

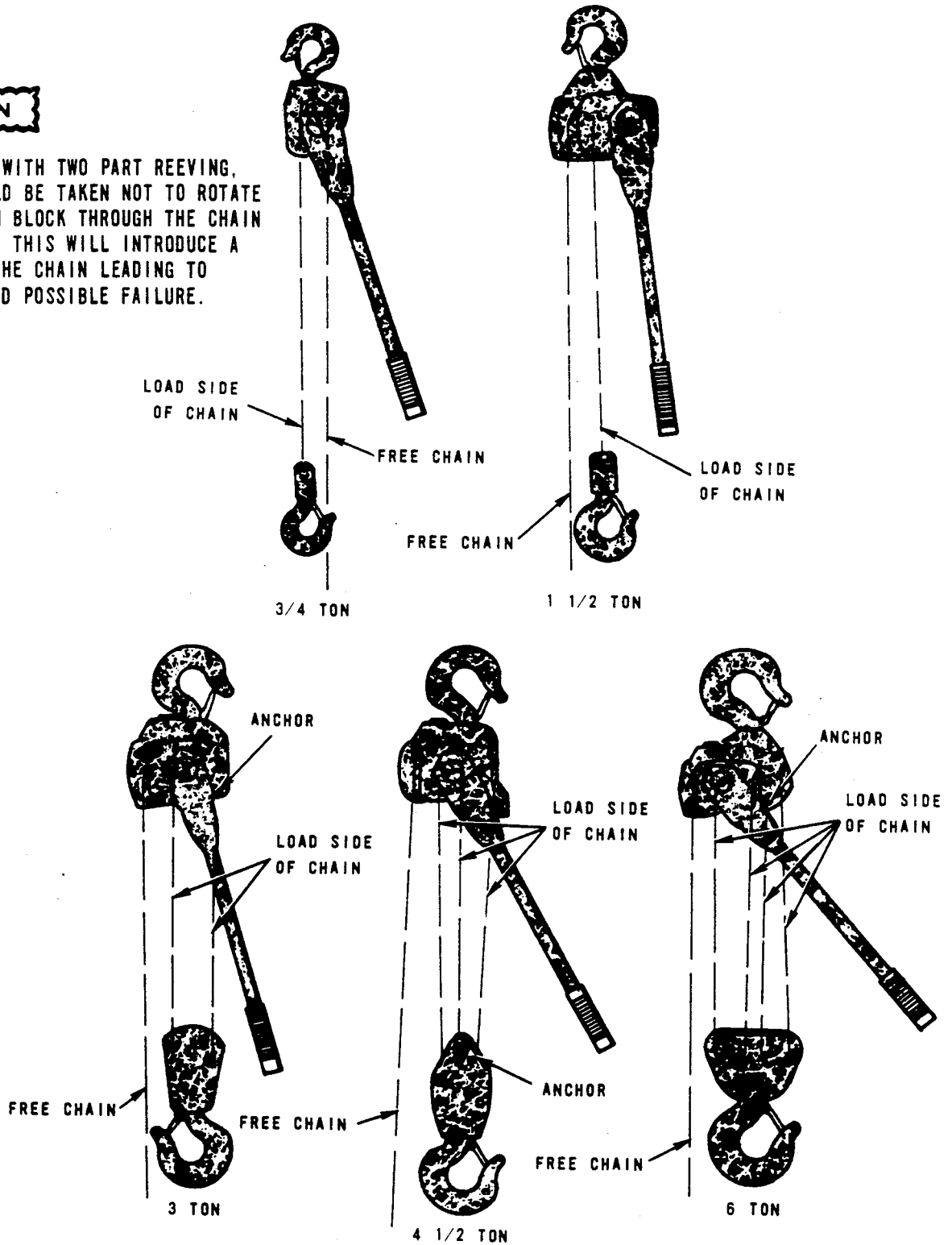

Figure 7. Hook alignment, showing load side and free side of chain when properly assembled.

YA-0069

When Replacement Parts Are Needed, Order Only YALE[®] Factory Engineered Parts

To Repair Or Replace Top Hook, 3/4 or 1 1/2 Ton YALE Pul-lift

- (a) Place pul-lift on a clean work bench. Lay pul-lift on its' side and support hook by placing a block of wood underneath.
- (b) Remove pin with a drift bar, (be certain hook is supported by wooden block). Remove collar washer and hook.
- (c) To reassemble, position hook. Then install washer, collar and pin. Be sure support block is under hook.
- (d) Stake collar on both sides with a blunt end chisel. Be sure hooks turn freely.

To Repair Or Replace Top Hook, 3 Ton YALE Pul-lift

- (a) Place pul-lift on a clean work bench. Remove anchor pin and pull chain out of hook.
- (b) Remove socket head screw and lockwasher, retaining cap and top hook.
- (c) To reassemble, position hook assembly. Install cap, lockwasher and screw. Position and install chain assembly. If chain has been removed for any reason be sure that it is properly installed as shown in Figure 7 on page 13.

To Repair Or Replace Top Hook, 4 1/2 and 6 Ton YALE Pul-lift

- (a) Place pul-lift on a clean work bench. Remove chain assembly as follows: Place selector lever in neutral position. Push down on free wheeling lever to disengage load brake pawl. Allow bottom block to be pulled away from upper unit approximately one (1) foot.
- (b) Remove cotter pins connecting link and roller stop, (Roller chain only).
- (c) Remove anchor pin and pull link chain free, (Link chain only).
- (d) Remove socket head screw and lockwasher, retaining cap and top hook.
- (e) To reassemble, position hook assembly. Install cap, lockwasher and screw.
- (f) Install chain assembly. If chain has been removed for any reason, be sure that it is properly installed as shown in Figure 7, page 13.

CAUTION

DO NOT KINK OR TWIST CHAIN. WHEN REPLACING HOOK OR CHAIN BE CERTAIN BOTTOM BLOCK IS ANCHORED TO LOAD SIDE OF CHAIN. See Figure 7 on page 13.



Note: Repair pul-lift on a clean work bench or in a clean area. Never disassemble the hoist in dirty surroundings or allow dirt, grit or any foreign material to get on the working parts of the hoist or into the working areas of these parts.

To Repair The Load Brake

- (a) Remove snap ring and handle assembly.
- (b) Remove hex head screws and lockwashers securing cover to gear case.
- (c) Remove pin and cap. "O" ring, spring and stop arbor are all part of cap assembly.
- (d) Remove load brake hub by turning it off drive pinion. Remove brake disc, ratchet disc, remaining brake disc and reaction disc. Remove "O" ring.
- (e) Replace brake discs when worn, damaged or glazed. Wash, clean and thoroughly dry all parts, except brake discs, in a clean solvent. Replace seals when worn or damaged. Replace cover gasket.

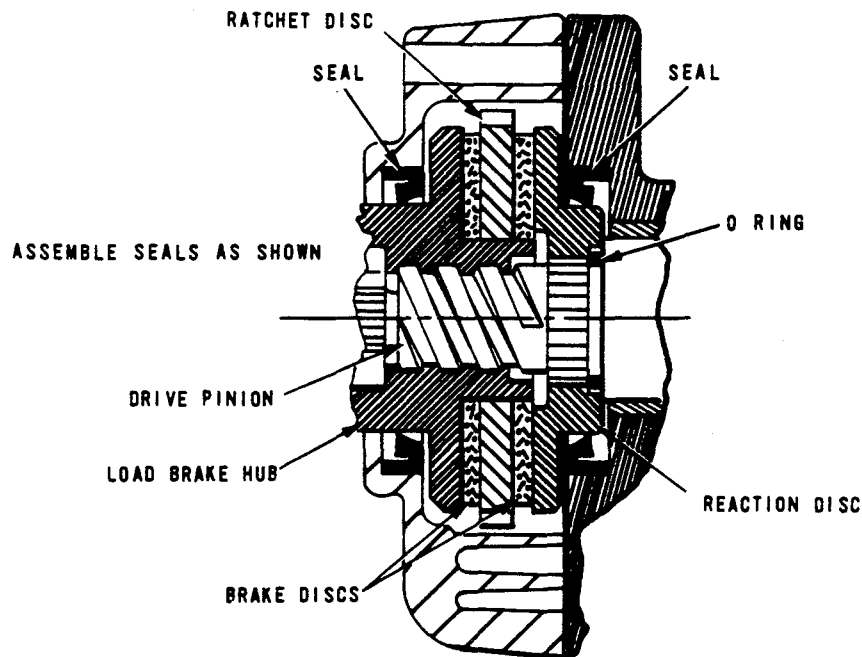

Figure 8. Proper arrangement of seals.

YA-0067

PREVENTIVE MAINTENANCE



To Reassemble The Load Brake

- (a) Apply a small amount of lubricant on worm gear portion of driving pinion. Insert "O" ring in reaction disc. Install reaction disc.
- (b) Position brake disc and ratchet disc. Ratchet disc must be assembled as shown in Figure (8) on preceding page.
- (c) Position remaining brake disc and install brake hub.
- (d) Assemble load brake adjuster. Load brake adjuster consists of cap and spring assembly, "O" ring and stop arbor. Engage the flat portion of the spring in the cap with the slotted end of the stop arbor. Press the stop arbor down into the cap. A properly assembled load brake adjuster should resemble Figure 9 below.

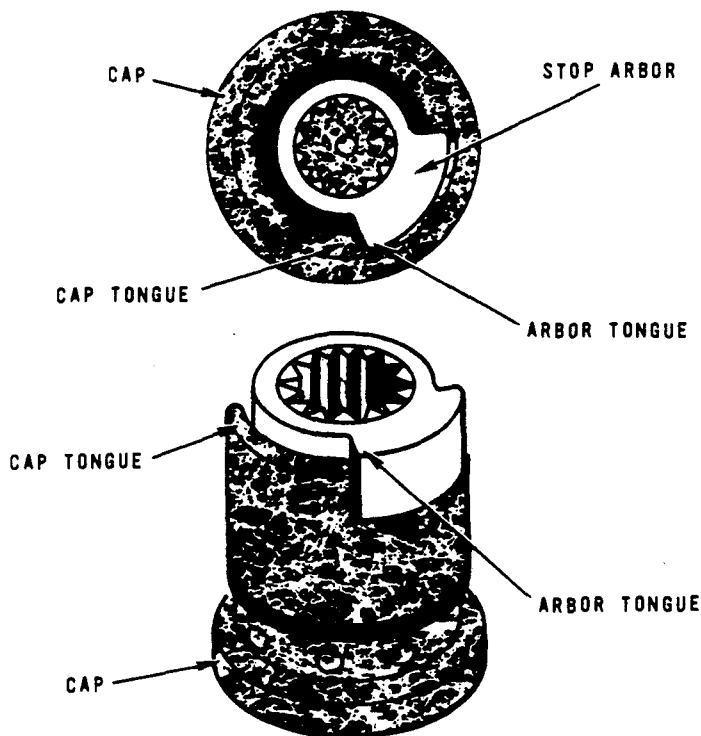

YA-0073

Figure 9. Assembled load brake adjuster.

- (e) Install load brake into hoist as follows: Start the cap tongue into the load brake hub. Align stop arbor splines with driving pinion spline. Push load brake adjuster down into load brake hub.
- (f) Holding load brake hub securely, turn cap counter-clockwise to stop. Back cap off to the first hole that lines up with the hole in the load brake hub. Insert locking pin.
- (g) Position cover gasket, install cover, hex head bolts and lock-washers.
- (h) Position handle assembly and install snap ring.

When Replacement Parts Are Needed, Order Only YALE[®] Factory Engineered Parts



REPAIR PARTS

QTY.	PART NUMBER	DESCRIPTION
1	0644851-00	BRAKE PAWL SPRING
2	6468714-00	BRAKE DISC
1	6413891-00	RATCHET

RECOMMENDED SPARE PARTS FOR ONE YEAR

When Replacement Parts Are Needed, Order Only YALE[®] Factory Engineered Parts

REPAIR PARTS

Yale

MODEL PF RATCHET LEVER HOIST
3/4 TON (PUL-LIFT)

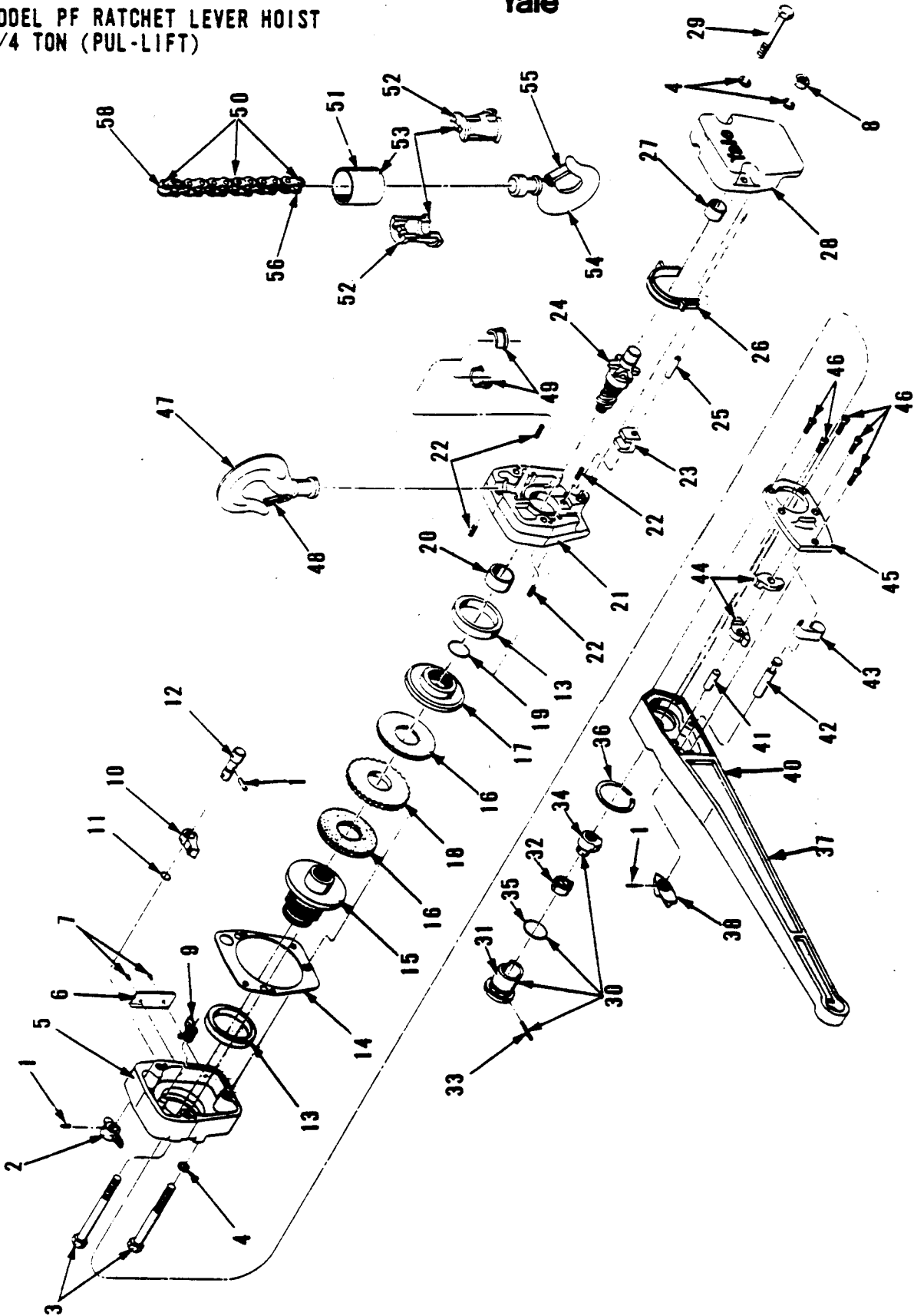

Figure 10. 3/4 ton model PF YALE® pul-lift.

When Replacement Parts Are Needed, Order Only YALE® Factory Engineered Parts

MODEL PF RATCHET LEVER HOIST
3/4 Ton (PUL-LIFT)



REPAIR PARTS

ITEM NUMBER	PART NUMBER	DESCRIPTION	QTY.	ITEM NUMBER	PART NUMBER	DESCRIPTION	QTY.
1	0583763-00	ROLL PIN.....	3	32	0644863-00	SPRING.....	1
2	0644849-00	FREE CHAIN SELECTOR.....	1	33	0644859-00	LOCKING PIN.....	1
3	5000269-04	HEX HEAD BOLT.....	2	34	0644862-00	STOP ARBOR.....	1
4	0150262-00	LOCKWASHER.....	3	35	5001599-01	"O" RING (Not Shown).....	1
5	5007030-00	BACK COVER ASSM. (INC. ITEMS 6 AND 7).....	1	36	0644854-00	RETAINING RING.....	1
6	0660531-00	INSTRUCTION PLATE.....	1	37	6475482-00	RATCHET LEVER ASSM. (INCL ITEMS 1 AND 38 THRU 46).....	1
7	0209149-00	DRIVE SCREW.....	2	38	6403821-00	SELECTOR LEVER.....	1
8	0106628-00	HEX NUT.....	1	40	6469673-00	LEVER HOUSING.....	1
9	0644851-00	PAWL SPRING.....	1	41	5036661-00	PAWL PIN.....	1
10	0644850-00	RATCHET PAWL.....	1	42	0644866-00	SELECTOR STUD.....	1
11	0154923-00	"O" RING.....	1	43	0644867-00	SPRING.....	1
12	0644852-00	PAWL PIN.....	1	44	0644865-00	SELECTOR PAWL.....	2
13	0644898-00	WATER SEAL.....	2	45	5031763-00	LEVER HOUSING COVER.....	1
14	0644857-00	LOAD BRAKE GASKET.....	1	46	6413661-00	PHILLIPS HEAD SCREW.....	5
15	0644847-00	LOAD BRAKE HUB.....	1	47	6420280-00	TOP HOOK ASSM. (INCL ITEMS 48 AND 49).....	1
16	6468714-00	BRAKE DISC.....	2	48	0669402-00	LATCH KIT.....	1
17	0644845-00	REACTION DISC.....	1	49	6405811-00	INSERT.....	2
18	6413891-00	RATCHET DISC.....	1	50	0176043-00	ROLLER CHAIN ASSM, 5 Feet 6 Inches Standard, (Incl. Items 56 and 58).....	1
19	0128239-00	"O" RING.....	1	*	0032858-00	BULK ROLLER CHAIN (SPECIFY LENGTH).....	1
20	0644856-00	OILITE BEARING.....	1	51	0175792-00	BOTTOM SWIVEL BAND.....	1
21	0644842-00	MIDDLE HOUSING.....	1	52	0556446-00	BOTTOM SWIVEL.....	2
22	5019869-06	ROLL PIN.....	4	53	0573812-00	BOTTOM SWIVEL ASSM. (INCL ITEMS 51 AND 52).....	1
23	0643025-00	STRIPPER.....	1	54	0549576-00	BOTTOM HOOK ASSM. (INCL ITEM 55).....	1
24	0643014-00	LOAD SPROCKET.....	1	55	0669400-00	LATCH KIT.....	1
25	0559292-00	STRIPPER PIN.....	1	56	6407380-00	PIN AND WASHER.....	1
26	0643021-00	CHAIN GUIDE.....	1	**57	0182575-00	SPLICE LINK (Not Shown).....	2
27	0644855-00	OILITE BEARING.....	1	58	6420050-00	ROLLER STOP AND LINK KIT.....	1
28	0644841-00	FRONT COVER.....	1	59	6446083-00	WARNING & OPER. INST. DECAL (Not Shown)	1
29	5000269-02	HEX HEAD BOLT.....	1				
30	0644840-00	LOAD BRAKE ADJUSTER ASSM. (INCL ITEMS, 31,33,34 AND 35).....	1				
31	5029623-00	CAP AND SPRING ASSM. (INCL ITEM 32).....	1				

* For Chain Lengths Other Than Standard.
** To Provide Additional Lift Use Item 57 For Splicing Chain.

When Replacement Parts Are Needed, Order Only YALE Factory Engineered Parts

REPAIR PARTS

MODEL PE RATCHET LEVER HOIST
3/4 TON (PUL-LIFT)

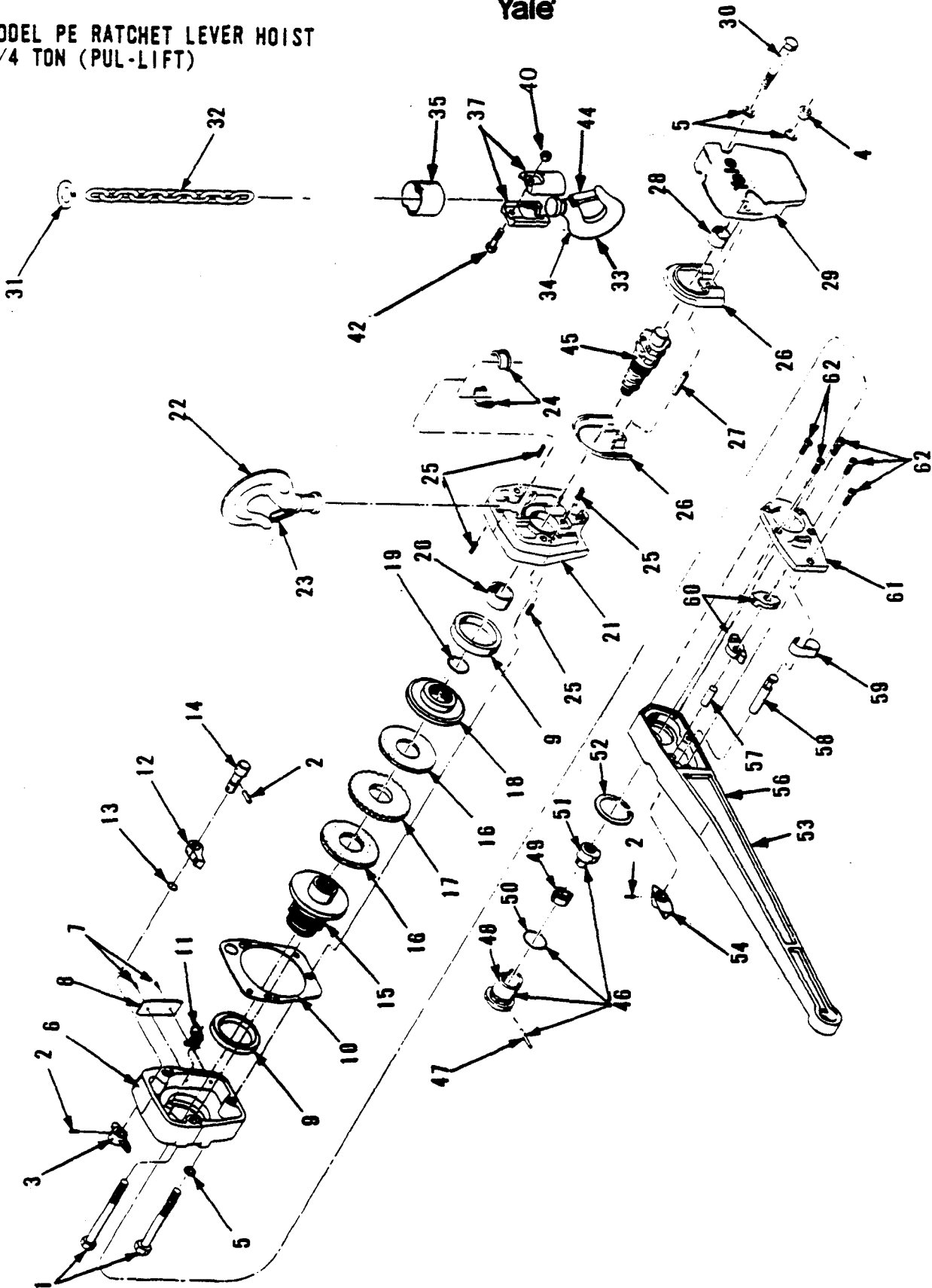

Figure 11. 3/4 ton model PE YALE® pul-11ft.

When Replacement Parts Are Needed, Order Only YALE® Factory Engineered Parts

MODEL PE RATCHET LEVER HOIST
3/4 Ton (PUL-LIFT)



REPAIR PARTS

NO.	PART NUMBER	DESCRIPTION	QTY.	NUMBER	PART NUMBER	DESCRIPTION	QTY.
1	5000269-04	HEX HEAD BOLT.....	2		0033640-00	BULK LOAD CHAIN (Specify Length).....	As
2	0583763-00	ROLL PIN.....	3		0033641-00	BULK CAD. PLATED LOAD CHAIN (Spec).....	As Req'd
3	0644849-00	FREE CHAIN SELECTOR.....	1	*33	6425372-00	BOTTOM BLOCK ASSM.....	1
4	0106628-00	HEX NUT.....	1	*34	6425382-00	BOTTOM HOOK ASM. (INCL 38,43,44).....	1
5	0150262-00	LOCKWASHER.....	3	*35	6456701-00	RETAINER BAND.....	1
6	5007030-00	BACK COVER ASSM. (INCL ITEMS 7 AND 8).....	1	*36			1
7	0209149-00	RIVET.....	2	*37	6420171-00	BLOCK HALF.....	1
8	0660531-00	INSTRUCTION PLATE.....	1	*40	0150152-00	CROWN LOCKNUT.....	1
9	0644898-00	WATER SEAL.....	2	*42	6428951-00	SPECIAL SOCKET HEAD SCREW.....	1
10	0644857-00	LOAD BRAKE GASKET.....	1	44	0669400-00	LATCH KIT.....	1
11	0644851-00	PAWL SPRING.....	1	45	0644844-00	LOAD SHEAVE.....	1
12	0644850-00	RATCHET PAWL.....	1	46	0644840-00	LOAD BRAKE ADJUSTER ASSM. (INCL ITEMS 47,48,50 AND 51).....	1
13	0154923-00	*O* RING.....	1	47	0644859-00	LOCKING PIN.....	1
14	0644852-00	PAWL PIN.....	1	48	5029623-00	CAP AND SPRING ASSM. (INCL ITEM 49).....	1
15	0644847-00	LOAD BRAKE HUB.....	1	49	0644863-00	SPRING.....	1
16	6468714-00	BRAKE DISC.....	2	50	5001599-01	*O* RING.....	1
17	6413891-00	RATCHET DISC.....	1	51	0644862-00	STOP ARBOR.....	1
18	0644845-00	REACTION DISC.....	1	52	0644854-00	RETAINING RING.....	1
19	0128239-00	*O* RING.....	1	53	6475482-00	RATCHET LEVER ASSM. (INCL ITEMS 2 AND 54 THROUGH 62).....	1
20	0644856-00	OILITE BEARING.....	1	54	6403821-00	SELECTOR LEVER.....	1
21	0644842-00	MIDDLE HOUSING.....	1	56	6469673-00	LEVER HOUSING.....	1
22	5016350-00	TOP HOOK ASSM. (INCL ITEMS 23 AND 24).....	1	57	5036661-00	PAWL PIN.....	1
23	0669402-00	LATCH KIT.....	1	58	0644866-00	SELECTOR STUD.....	1
24	6405811-00	INSERT.....	2	59	0644867-00	SPRING.....	1
25	5019869-06	ROLL PIN.....	4	60	0644865-00	SELECTOR PAWL.....	2
26	0644853-00	CHAIN GUIDE AND STRIPPER.....	2	61	5031763-00	LEVER HOUSING COVER.....	1
27	0559292-00	ROLL PIN.....	1	62	6413661-00	PHILLIPS HEAD SCREW.....	5
28	0644855-00	OILITE BEARING.....	1	63	6446083-00	WARNING & OPER. INSTR. DECAL(Not Shown).....	1
29	0644841-00	FRONT COVER.....	1				
30	5000269-02	HEX HEAD BOLT.....	1				
31	0164373-00	CHAIN STOP.....	1				
32		LOAD CHAIN (5 Feet 6 inches Standard).....					

When Replacement Parts Are Needed, Order Only YALE Factory Engineered Parts

REPAIR PARTS

MODEL PF RATCHET LEVER HOIST
1 1/2 TON (PUL-LIFT)

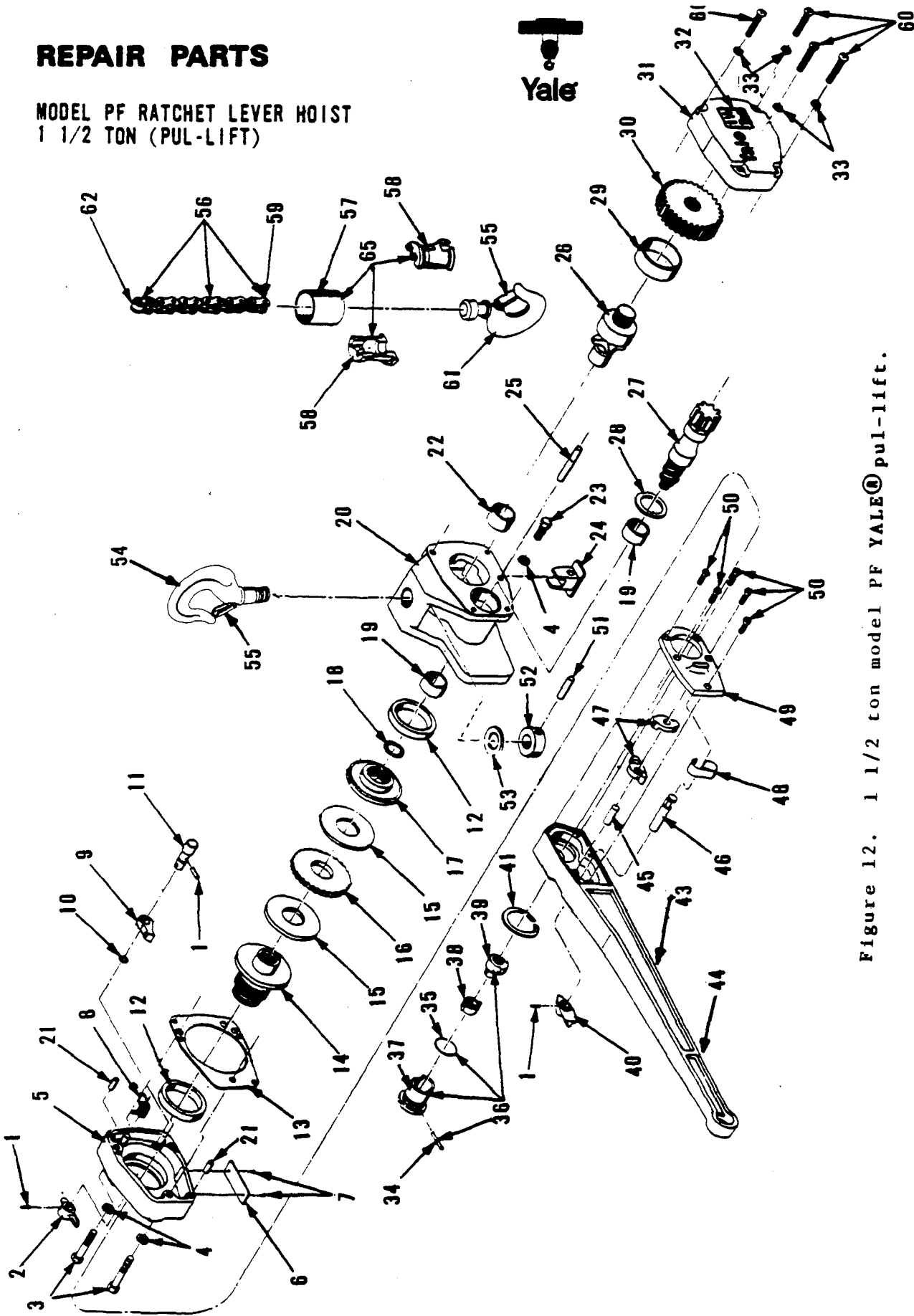

Figure 12. 1 1/2 ton model PF YALE® pul-lift.

When Replacement Parts Are Needed, Order Only YALE® Factory Engineered Parts

MODEL PF RATCHET LEVER HOIST
1 1/2 Ton (PUL-LIFT)



REPAIR PARTS

ITEM NUMBER	PART NUMBER	DESCRIPTION	QTY.	ITEM NUMBER	PART NUMBER	DESCRIPTION	QTY.
1	058373-00	ROLL PIN.....	3	36	0644840-00	LOAD BRAKE ADJUSTER ASSM. (INCL. ITEMS 34,35, 37 AND 39).....	1
2	0644849-00	FREE CHAIN SELECTOR.....	1	37	5029623-00	CAP AND SPRING ASSM. (INCL. ITEM 38).....	1
3	5000269-01	HEX HEAD BOLT.....	2	38	0644863-00	SPRING.....	1
4	0150262-00	LOCKWASHER.....	3	39	0644862-00	STOP ARBOR.....	1
5	5007030-00	BACK COVER ASSM. (INC. ITEMS 6 AND 7).....	1	40	6403821-00	SELECTOR LEVER.....	1
6	0660531-00	INSTRUCTION PLATE.....	1	41	0644854-00	RETAINING RING.....	1
7	0209149-00	RIVET.....	2	42	6401973-00	RUBBER GRIP.....	1
8	0644851-00	PAWL SPRING.....	1	43	6475482-00	RATCHET LEVER ASSM. (INCL. ITEMS 1,40,42,44 AND 45 THRU 50).....	1
9	0644850-00	RATCHET PAWL.....	1	44	6469673-00	LEVER HOUSING.....	1
10	0154923-00	"O" RING.....	1	45	5036661-00	PAWL PIN.....	1
11	0644852-00	PAWL PIN.....	1	46	0644866-00	SELECTOR STUD.....	1
12	0644898-00	WATER SEAL.....	2	47	0644865-00	SELECTOR PAWL.....	2
13	0644857-00	LOAD BRAKE GASKET.....	1	48	0644867-00	SPRING.....	1
14	0644847-00	LOAD BRAKE HUB.....	1	49	5031763-00	LEVER HOUSING COVER.....	1
15	6468714-00	BRAKE DISC.....	2	50	6413661-00	PHILLIPS HEAD SCREW.....	5
16	6413891-00	RATCHET DISC.....	1	51	5004099-02	ROLL PIN.....	1
17	0644845-00	REACTION DISC.....	1	52	0652673-00	NUT.....	1
18	0128239-00	"O" RING.....	1	53	0544158-00	WASHER.....	1
19	6459748-00	BUSHING.....	2	54	6460669-02	TOP HOOK ASSM. (INCL. ITEMS).....	1
20	0644884-00	GEAR CASE.....	1	55	0669402-00	LATCH KIT (Used On Top and Bottom Hook).....	1
21	5019869-06	ROLL PIN.....	2	56	0168176-00	ROLLER CHAIN ASSM. 5 Feet 8 Inches Standard (Incl. Item 59 and 62).....	2
22	6417681-00	BUSHING.....	1	*	0034268-00	BULK ROLLER CHAIN (Specify Length).....	1
23	0597163-00	HEX HEAD BOLT.....	1	57	0168165-00	BOTTOM SWIVEL BAND.....	1
24	0643009-00	STRIPPER.....	1	58	0556445-00	BOTTOM SWIVEL.....	2
25	0644885-00	STRIPPER PIN.....	1	59	6417630-00	PIN AND WASHER ASSM.....	1
26	6496260-00	SPROCKET & BUSHING KIT (INCL. ITEM 22).....	1	60	0644882-00	SCREW.....	4
27	0644874-00	DRIVING PINION.....	1	61	0562364-00	BOTTOM HOOK ASSM. (INCL. ITEM 55).....	1
28	0644883-00	WASHER.....	1	62	6409280-00	CONNECTING LINK AND ROLLER ASSM.....	1
29	0644879-00	OILITE BEARING.....	1	64	6416083-00	WARNING & OPER. INSTR. DECAL (Not Shown).....	1
30	0644876-00	GEAR.....	1	65	0573813-00	BOTTOM SWIVEL ASSM. (INCL. ITEMS 57 & 58).....	1
31	0644877-00	GEAR CASE COVER.....	1				
33	0150260-00	LOCKWASHER.....	4				
34	0644859-00	LOCKING PIN.....	1				
35	5001599-01	"O" RING.....	1				

* For Chain Lengths Other Than Standard.
** To Provide Additional Lift Use Item 63 For Splicing Chain.

When Replacement Parts Are Needed, Order Only YALE Factory Engineered Parts

REPAIR PARTS

MODEL PE RATCHET LEVER HOIST
1 1/2 TON (PUL-LIFT)

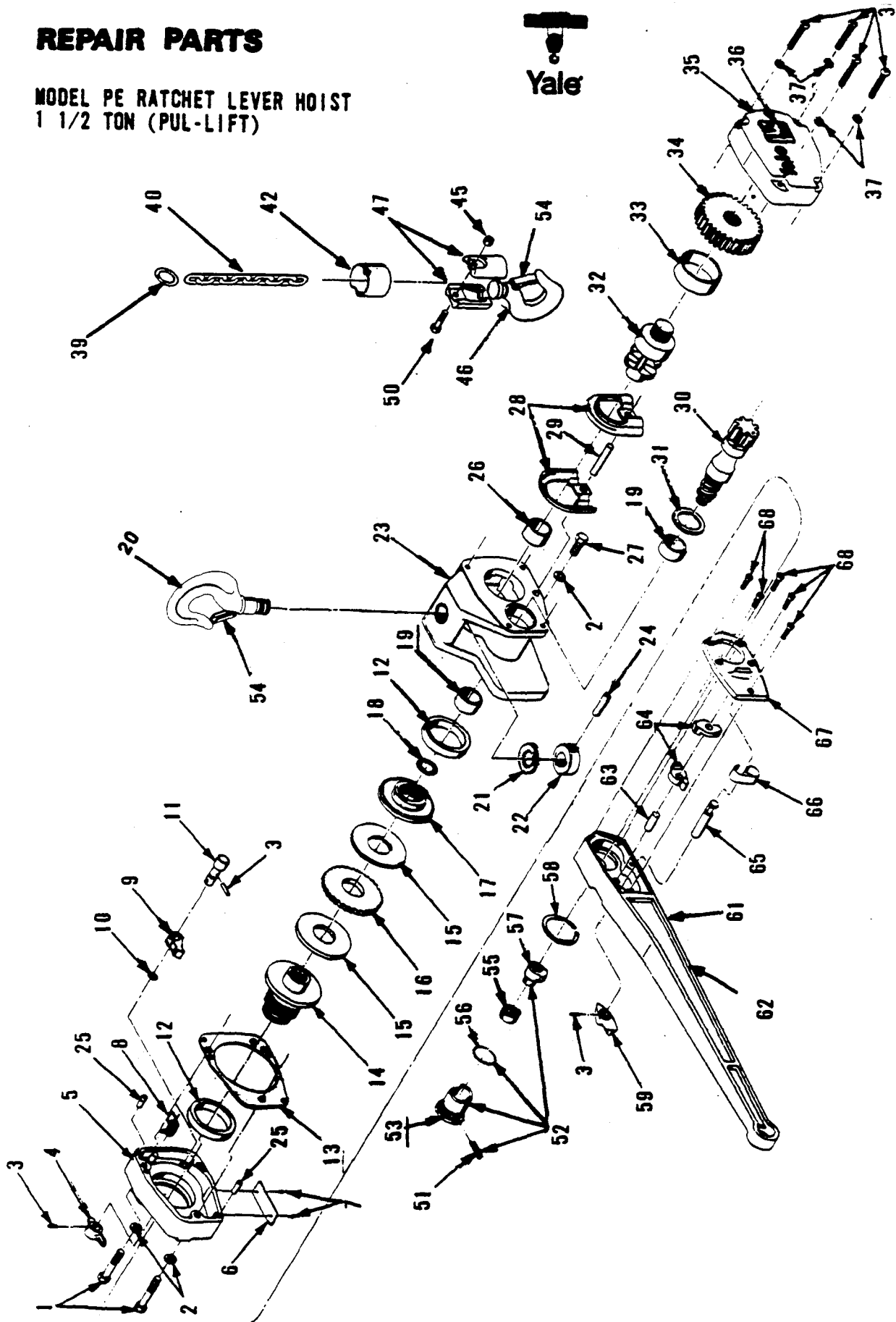

Figure 13. 1 1/2 ton model PE YALE pul-lift.

When Replacement Parts Are Needed, Order Only YALE® Factory Engineered Parts

ITEM NO.	PART NO.	DESCRIPTION	QTY.
1	500026901	Hex head bolt	2
2	015026200	Lockwasher	3
3	058376300	Roll pin	3
4	064484900	Free chain selector	1
5	646159000	Back cover asm (incl. items 6 & 7)	1
6	066053100	Instruction plate	1
7	020914900	Drive screw	2
8	064485100	Pawl spring	1
9	064485000	Ratchet spring	1
10	015492300	"O" ring	1
11	064485200	Pawl pin	1
12	064489800	Water seal	2
13	064485700	Load brake gasket	1
14	064484700	Load brake hub	1
15	646871400	Brake disc	2
16	641389100	Ratchet disc	1
17	064484500	Reaction disc	1
18	012823900	"O" ring	2
19	645974800	Bushing	1
20	646069201	Top hook asm (incl. item 54)	1
21	054415800	Washer	1
22	065267300	Hook nut	1
23	064488400	Gear case	1
24	500409902	Roll pin	2
25	501986906	Roll pin	1
26	641768100	Bushing	1
27	059716300	Hex head bolt	2
28	064488100	Chain guide and stripper	1
29	064488500	Stripper pin	1
30	064487400	Driving pinion	1
31	064488300	Washer	1
32	649625000	Load sheave & bearing kit (incl. item 26)	1
33	064487900	Oilite bearing	1
34	064487600	Gear	1
35	064487700	Gearcase cover	1
36	644161301	Capacity decal	4
37	015026000	Lockwasher	4
38	064488200	Phillips head screw	1
39	016437300	Chain stop	1
40	003364500	Bulk load chain (specify length)	1
42	645671100	Retainer band	1
43	642594200	Bottom block asm. (incl. items 42, 45, 46, 47, 50, 54)	1
45	015015300	Crown locknut	1
46	642593200	Bottom hook including items 54	1
47	642039100	Block half	1
50	642896100	Special socket head screw	1
51	064485900	Locking pin	1
52	064484000	Load brake adjuster	1
53	502962300	Cap and spring asm. (incl. item 55)	1
54	066940200	Hook latch kit	2
55	064486300	Spring	1
56	500159901	"O" ring	1
57	064486200	Stop arbor	1
58	064485400	Retaining ring	1
59	640382100	Selector lever	1
61	647548200	Ratchet lever asm. (incl items 3, 59, 62, and 63 - 68)	1
62	646967300	Lever housing	1
63	503666100	Pawl pin	1
64	064486500	Selector pawl	2
65	064486600	Selector stud	1
66	064486700	Spring	1
67	503176300	Lever housing cover	1
68	641366100	Phillips head screw	5
70	644608300	Warning & Operating Instruction decal (not shown)	1

WHEN REPLACEMENT PARTS ARE NEEDED, ORDER ONLY YALE® FACTORY ENGINEERED PARTS

REPAIR PARTS



MODEL PF RATCHET LEVER HOIST
3/4-1 1/2 CONVERTIBLE (PUL-LIFT)

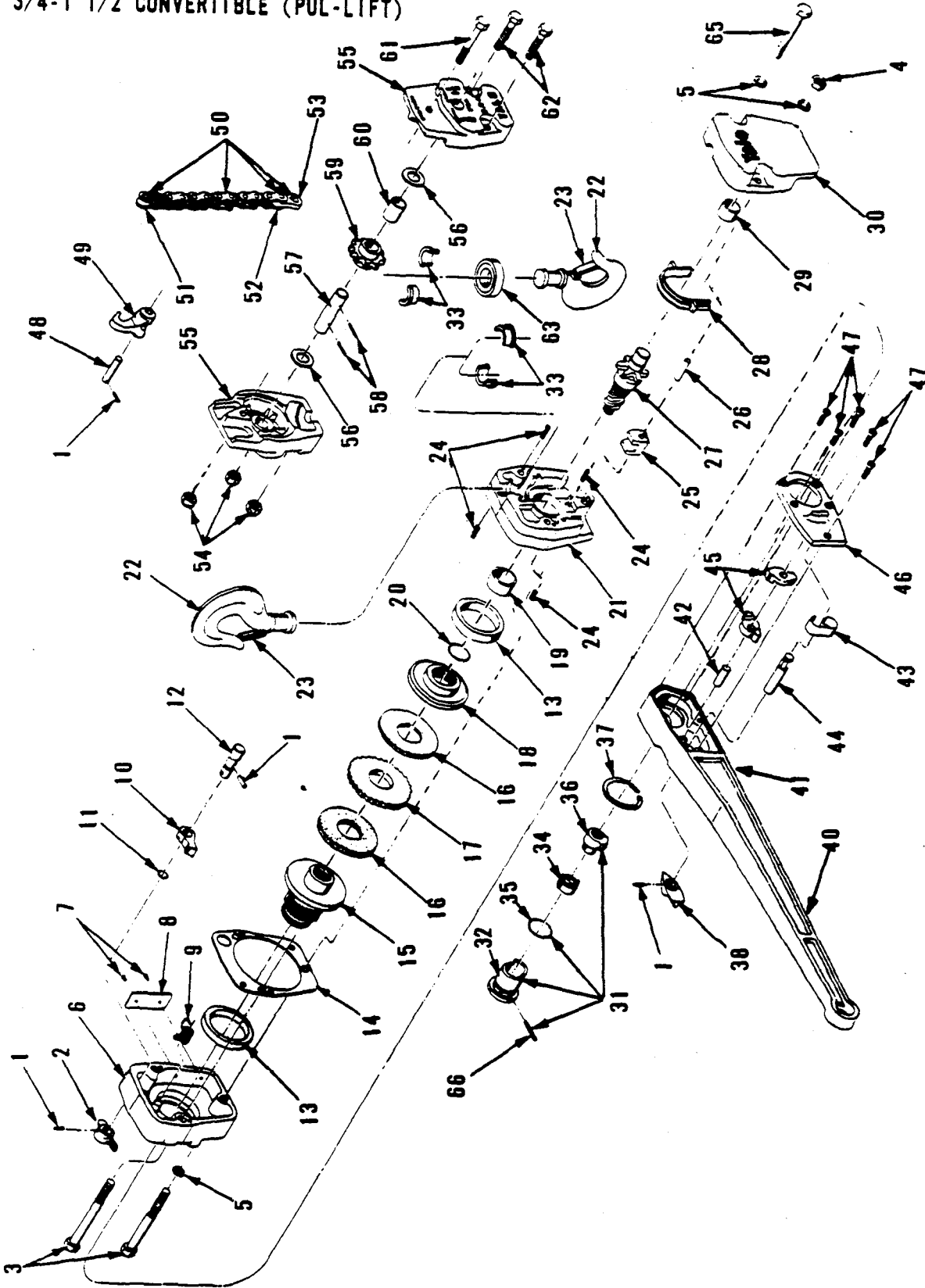

Figure 14. 3/4-1111/2 ton model PF YALE® convertible pul-lift.

When Replacement Parts Are Needed, Order Only YALE® Factory Engineered Parts

MODEL PF RATCHET LEVER HOIST
3/4 - 1 1/2 CONVERTIBLE (PUL-LIFT)



REPAIR PARTS

NUMBER	PART NUMBER	DESCRIPTION	QTY.	ITEM NUMBER	PART NUMBER	DESCRIPTION	QTY.
1	0583763-00	ROLL PIN.....	4	38	6403821-00	SELECTOR LEVER.....	1
2	0644849-00	FREE CHAIN SELECTOR.....	1	40	6475482-00	RATCHET LEVER ASSM. (INCL. ITEMS 1,38,39,41 THRU 47).....	1
3	5000269-04	HEX HEAD BOLT.....	2	41	6469673-00	LEVER HOUSING.....	1
4	0106628-00	HEX NUT.....	1	42	5036661-00	PAWL PIN.....	1
5	0150262-00	LOCKWASHER.....	3	43	0644867-00	SPRING.....	1
6	5007030-00	BACK COVER ASSM. (INCL. ITEMS 7 AND 8).....	1	44	0644866-00	SELECTOR STUD.....	1
7	0209149-00	DRIVE SCREW.....	2	45	0644865-00	SELECTOR PAWL.....	2
8	0660531-00	INSTRUCTION PLATE.....	1	46	5031763-00	LEVER HOUSING COVER.....	1
9	0644851-00	PAWL SPRING.....	1	47	6413661-00	PHILLIPS HEAD SCREW.....	5
10	0644850-00	RATCHET PAWL.....	1	48	0669092-00	ANCHOR PIN.....	1
11	0154923-00	"O" RING.....	1	49	0669088-00	ANCHOR.....	1
12	0644852-00	PAWL PIN.....	1	50	5024511-00	ROLLER CHN. ASSM. (INC. ITEMS 51,52 &53).....	1
13	0644898-00	WATER SEAL.....	2	*	0032858-00	BULK ROLLER CHAIN (Specify Length).....	1
14	0644857-00	LOAD BRAKE GASKET.....	1	51	6420050-00	ROLLER STOP AND LINK KIT.....	1
15	0644847-00	LOAD BRAKE HUB.....	1	52	0118622-00	CONNECTING LINK.....	1
16	6468714-00	BRAKE DISC.....	2	53	0643026-00	ANCHOR LINK.....	1
17	6413891-00	RATCHET DISC.....	1	54	0150152-00	STOVER LOCKNUT.....	3
18	0644845-00	REACTION DISC.....	1	55	5009754-00	BOTTOM BLOCK HALF.....	2
19	0644856-00	OILITE BEARING.....	1	56	5000729-01	WASHER.....	2
20	0128239-00	"O" RING.....	1	57	0669087-00	SHEAVE AXLE.....	1
21	0644842-00	MIDDLE HOUSING.....	1	58	5000679-07	ROLL PIN.....	2
22	6420280-00	TOP AND BOTTOM HOOK ASSM. INCL. ITEMS 23 & 33.....	2	59	0669082-00	BOTTOM BLOCK SPROCKET.....	1
23	0669402-00	LATCH KIT.....	2	60	0608407-00	OILITE BEARING.....	1
24	5019869-06	ROLL PIN.....	4	61	5000269-05	HEX HEAD BOLT.....	1
25	0643025-00	STRIPPER.....	1	62	0629135-00	HEX HEAD BOLT.....	2
26	0559292-00	STRIPPER PIN.....	1	63	5000479-01	ROLLER BEARING.....	1
27	0643014-00	SPROCKET.....	1	64	0669097-00	BOTTOM BLOCK ASSM. (INCL. ITEMS 54 THR 63 & 22 (Not Shown).....	1
28	0643021-00	CHAIN GUIDE.....	1	65	5000269-02	HEX HEAD BOLT.....	1
29	0644855-00	OILITE BEARING.....	1	66	0644859-00	LOCKING PIN.....	1
30	0644841-00	FRONT COVER.....	1	**67	0182575-00	SPUCE LINK (Not Shown).....	2
31	0644840-00	LOAD BRAKE ADJUSTER ASSM. (INCL. ITEMS 32,35,36 & 66).....	1	68	6446083-00	WARNING & OPER. INSTR. DECAL (Not Shown).....	1
32	5029623-00	CAP AND SPRING ASSM. (INCL. ITEM 34).....	1				
33	6405811-00	INSERT.....	4				
34	0644863-00	SPRING.....	1				

When Replacement Parts Are Needed, Order Only YALE Factory Engineered Parts

REPAIR PARTS



MODEL PE RATCHET LEVER HOIST
3/4-1 1/2 CONVERTIBLE (PUL-LIFT)

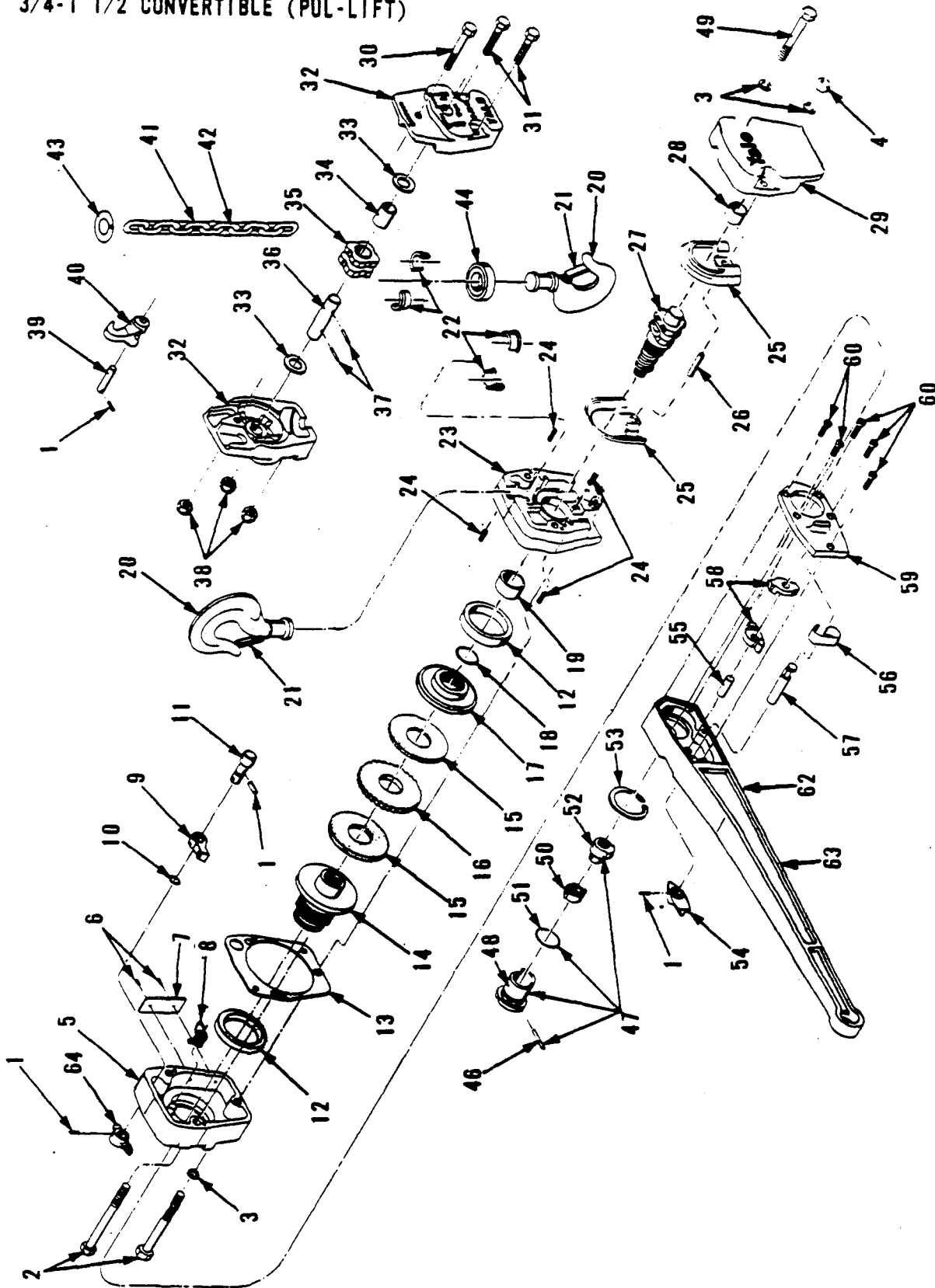

Figure 15. 3/4-1 1/2 ton model PE YALE® convertible pul-lift.

When Replacement Parts Are Needed, Order Only YALE® Factory Engineered Parts

MODEL PE RATCHET LEVER HOIST
3/4 - 1 1/2 Convertible (PUL-LIFT)



REPAIR PARTS

NUMBER	PART NUMBER	DESCRIPTION	QTY.	NUMBER	PART NUMBER	DESCRIPTION	QTY.
1	0583763-00	ROLL PIN.....	4	34	0608407-00	OILITE BEARING.....	1
2	5000269-04	HEX HEAD BOLT.....	2	35	0608404-00	BOTTOM BLOCK SHEAVE.....	1
3	0150262-00	LOCKWASHER.....	3	36	0669087-00	SHEAVE AXLE.....	1
4	0106628-00	HEX NUT.....	1	37	5000679-07	ROLL PIN.....	2
5	5007030-00	BACK COVER ASSM. (INCL. ITEMS 6 AND 7).....	1	38	0150152-00	STOVER NUT.....	3
6	0209149-00	DRIVE SCREW.....	2	39	0669092-00	ANCHOR PIN.....	1
7	0660531-00	INSTRUCTION PLATE.....	1	40	0669088-00	ANCHOR.....	1
8	0644851-00	PAWL SPRING.....	1	41	0033640-00	BULK LOAD CHAIN (Specify Length).....	1
9	0644850-00	RATCHET PAWL.....	1	42	0033641-00	CADIUM PLATED CHAIN (Specify Length).....	1
10	0154923-00	"O" RING.....	1	43	0164373-00	CHAIN STOP.....	1
11	0644852-00	PAWL PIN.....	1	44	5000479-01	ROLLER BEARING.....	1
12	0644898-00	WATER SEAL.....	2	45	0669094-00	BOTTOM BLOCK ASSM. (INCL. ITEMS 30 THROUGH 38,44 AND 20).....	1
13	0644857-00	LOAD BRAKE GASKET.....	1	46	0644859-00	LOCKING PIN.....	1
14	0644847-00	LOAD BRAKE HUB.....	1	47	0644840-00	LOAD BRAKE ADJUSTER ASSM. (INCL. ITEMS 46, 48, 51 AND 52).....	1
15	6468714-00	BRAKE DISC.....	2	48	5029623-00	CAP AND SPRING ASSM. (INC. ITEM 50).....	1
16	6413891-00	RATCHET DISC.....	1	49	5000269-02	HEX HEAD BOLT.....	1
17	0644845-00	REACTION DISC.....	1	50	0644863-00	SPRING.....	1
18	0128239-00	"O" RING.....	1	51	5001599-01	"O" RING.....	1
19	0644856-00	OILITE BEARING.....	1	52	0644862-00	STOP ARBOR.....	1
20	5016350-00	TOP AND BOTTOM HOOK ASSM. (INCL. ITEMS 21 AND 22).....	2	53	0644854-00	RETAINING RING.....	1
21	0669402-00	LATCH KIT.....	2	54	6403821-00	SELECTOR LEVER.....	1
22	6405811-00	INSERT.....	4	55	5036661-00	PAWL PIN.....	1
23	0644842-00	MIDDLE HOUSING.....	1	56	0644867-00	SPRING.....	1
24	5019869-06	ROLL PIN.....	4	57	0644866-00	SELECTOR STUD.....	1
25	0644853-00	CHAIN GUIDE AND STRIPPER.....	2	58	0644865-00	SELECTOR PAWL.....	2
26	0559292-00	ROLL PIN.....	4	59	5031763-00	LEVER HOUSING COVER.....	1
27	0644844-00	LOAD SHEAVE.....	1	60	6413661-00	PHILLIPS HEAD SCREW.....	5
28	0644855-00	OILITE BEARING.....	1	62	6475482-00	RATCHET LEVER ASSM. (INCL. ITEMS 1 AND 54 THROUGH 63).....	1
29	0644841-00	FRONT COVER.....	1	63	6469673-00	LEVER HOUSING.....	1
30	5000269-05	HEX HEAD BOLT.....	1	64	0644849-00	FREE CHAIN SELECTOR.....	1
31	0629135-00	HEX HEAD BOLT.....	2	65	6446083-00	WARNING & OPER. INST. DECAL (Not Shown).....	1
32	5009754-00	BOTTOM BLOCK HALF.....	2				
33	5000729-01	WASHER.....	2				

When Replacement Parts Are Needed, Order Only YALE Factory Engineered Parts

REPAIR PARTS

MODEL PF RATCHET LEVER HOIST
3 TON (PUL-LIFT)

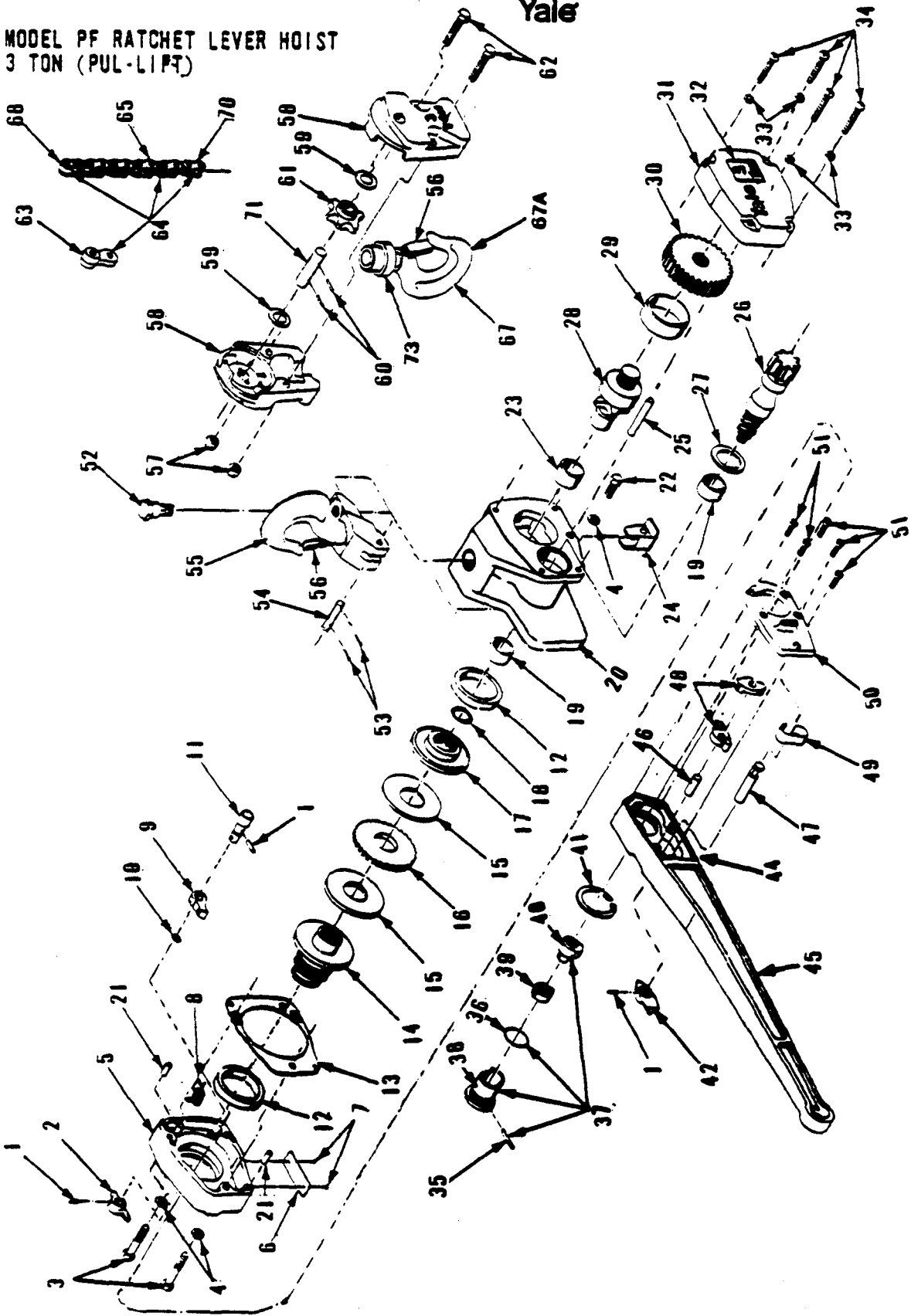

Figure 16. 3 ton model PF YALE® pul-lift.

When Replacement Parts Are Needed, Order Only YALE® Factory Engineered Parts

MODEL PF RATCHET LEVER HOIST
3 Ton (PUL-LIFT)



REPAIR PARTS

NUM.	PART NUMBER	DESCRIPTION	QTY.	NUMBER	PART NUMBER	DESCRIPTION	QTY.
1	0583763-00	ROLL PIN.....	3	38	5029623-00	CAP AND SPRING ASSM. (INCL ITEM 39).....	1
2	0644849-00	FREE CHAIN SELECTOR.....	1	39	0644863-00	SPRING.....	1
3	5000269-01	HEX HEAD BOLT.....	2	40	0644862-00	STOP ARBOR.....	1
4	0150262-00	LOCKWASHER.....	3	41	0644854-00	RETAINING RING.....	1
5	6461590-00	BACK COVER ASSM.(INCL ITEMS 6 AND 7)	1	42	6403821-00	SELECTOR LEVER.....	1
6	0660531-00	INSTRUCTION PLATE.....	1	44	6475482-00	RATCHET LEVER ASSM. (INCL ITEMS 1,42,45 AND 46 THRU 51).....	1
7	0209149-00	DRIVE SCREW.....	2	45	6469673-00	LEVER HOUSING.....	1
8	0644851-00	PAWL SPRING.....	1	46	5036661-00	SELECTOR STUD.....	1
9	0644850-00	RATCHET PAWL.....	1	47	0644866-00	PAWL PIN.....	2
10	0154923-00	"O" RING.....	1	48	0644865-00	SELECTOR PAWL.....	1
11	0644852-00	PAWL PIN.....	1	49	0644867-00	SPRING.....	1
12	0644898-00	WATER SEAL.....	2	50	5031763-00	LEVER HOUSING COVER.....	1
13	0644857-00	LOAD BRAKE GASKET.....	1	51	6413661-00	PHILLIPS HEAD SCREW.....	5
14	0644847-00	LOAD BRAKE HUB.....	1	52	5037791-00	SUSPENSION YOKE BOLT.....	1
15	6468714-00	BRAKE DISC.....	2	53	0154161-00	COTTER PIN.....	2
16	6413891-00	RATCHET DISC.....	1	54	0644889-00	ANCHOR PIN.....	1
17	0644845-00	REACTION DISC.....	1	55	5027830-00	TOP HOOK ASSM. (INCLUDES ITEM 56).....	2
18	0128239-00	"O" RING.....	1	56	0669403-00	LATCH KIT.....	2
19	6459748-00	BUSHING.....	2	57	0150153-00	LOCK NUT.....	2
20	0644884-00	GEAR CASE.....	1	58	0645018-00	BOTTOM BLOCK HALF.....	2
21	5019869-06	ROLL PIN.....	2	59	0143734-00	WASHER.....	2
22	0597163-00	HEX HEAD BOLT.....	1	60	0230207-00	ROLL PIN.....	1
23	6417681-00	BUSHING.....	1	61	5031211-00	SPROCKET ASSM.....	2
24	0643009-00	STRAPPER.....	1	62	0350234-00	HEX HEAD BOLT.....	1
25	0644885-00	STRAPPER PIN.....	1	63	0643011-00	ANCHOR LINK.....	1
26	0644874-00	DRIVING PINION.....	1	64	0653045-00	ROLLER CHAIN ASSM. (INCL ITEMS 63 AND 68)	1
27	0644883-00	WASHER.....	1	*65	0034268-00	BULK ROLLER CHAIN (SPECIFY LENGTH).....	1
28	6496260-00	SPROCKET & BUSHING KIT (INCL ITEM 23).....	1	66	0643032-00	BOTTOM BLOCK ASSM. (INCL ITEMS 56 THROUGH 62,67 AND 71) (Not Shown).....	1
29	0644879-00	OUTLE BEARING.....	1	67	6456492-00	BOTTOM HOOK ASSM. (INCL ITEM 56)	1
30	0644876-00	GEAR.....	1	67A	6494220-00	BOTTOM HOOK & BRG. ASSM. (INCL ITEM 56)	1
31	0644877-00	GEAR CASE COVER.....	1	68	6409280-00	CONNECTING LINK & ROLLER STOP ASSM.....	2
32	6441613-02	CAPACITY DECAL.....	1	**69	0182620-00	SPLICE LINK (Not Shown).....	1
33	0150260-00	LOCKWASHER.....	4	70	0653019-00	CONNECTING LINK (Bottom).....	1
34	0644882-00	PHILLIPS HEAD SCREW.....	4	71	0644897-00	SHEAVE AXLE.....	1
35	0644859-00	LOCKING PIN.....	1	72	6446083-00	WARNING & OPER INST. DECAL (Not Shown).....	1
36	5001599-01	"O" RING.....	1	73	0501931-00	BEARING.....	1
37	0644840-00	LOAD BRAKE ADJUSTER ASSM. (INCL ITEMS 35,36,38 & 40).....	1				

* For Chain Lengths Other Than Standard. ** To Provide Additional Lift Use Item #69 For Splicing Chain.

When Replacement Parts Are Needed, Order Only YALE Factory Engineered Parts

MODEL PE RATCHET LEVER HOIST
3 Ton (PUL-LIFT)



REPAIR PARTS

ITEM NUMBER	PART NUMBER	DESCRIPTION	QTY.	ITEM NUMBER	PART NUMBER	DESCRIPTION
1	5000269-01	HEX HEAD BOLT.....	2	36	6441613-02	CAPACITY DECAL.....
2	0150262-00	LOCKWASHER.....	3	37	0150260-00	LOCKWASHER.....
3	0644849-00	FREE CHAIN SELECTOR.....	1	38	0644882-00	PHILLIPS HEAD SCREW.....
4	6461590-00	BACK COVER ASSM. (INCL ITEMS 5 And 6).....	1	39	0150153-00	LOCK NUT.....
5	0660531-00	INSTRUCTION PLATE.....	1	40	0645018-00	BOTTOM BLOCK HALF.....
6	0209149-00	DRIVE SCREW.....	2	41	0143734-00	WASHER.....
7	0644898-00	WATER SEAL.....	2	42	5031201-00	SHEAVE ASSM. (INCL ITEM 44).....
8	0644857-00	LOAD BRAKE GASKET.....	1	44	0551654-00	SHEAVE BEARING.....
9	0644847-00	LOAD BRAKE HUB.....	1	45	0230207-00	ROLL PIN.....
10	0644851-00	PAWL SPRING.....	1	46	0644897-00	SHEAVE AXLE.....
11	0644850-00	RATCHET PAWL.....	1	47	0350234-00	HEX HEAD BOLT.....
12	0154923-00	"O" RING.....	1	48	0164373-00	CHAIN STOP.....
13	0583763-00	ROLL PIN.....	3	49	0033645-00	BULK LOAD CHAIN (Specify Length).....
14	0644852-00	PAWL PIN.....	1	50	0033646-00	CADIUM PLATED CHAIN (Specify Length).....
15	6468714-00	BRAKE DISC.....	2	51	0644859-00	LOCKING PIN.....
16	6413891-00	RATCHET DISC.....	1	52	0644840-00	LOAD BRAKE ADJUSTER ASM. (INC. ITEMS 51,53,55 AND 56).....
17	0644845-00	REACTION DISC.....	1	53	5029623-00	CAP AND SPRING ASSM. (INCL ITEM 54).....
18	0128239-00	"O" RING.....	1	54	0644863-00	SPRING.....
19	6459748-00	BUSHING.....	2	55	5001599-01	"O" RING.....
20	0644884-00	GEAR CASE.....	1	56	0644862-00	STOP ARBOR.....
21	5027830-00	TOP HOOK ASSM. (INCL ITEM 23).....	1	57	0644854-00	RETAINING RING.....
22	6494220-00	BOTTOM HOOK ASSM. (INCL ITEM 23).....	1	58	6403821-00	SELECTOR LEVER.....
23	0669403-00	LATCH KIT.....	2	59	6475482-00	RATCHET LEVER ASSM. (INCL ITEMS 13,58 AND 60 THROUGH 67).....
24	5037791-00	SUSPENSION YOKE BOLT.....	1	60	6469673-00	LEVER HOUSING.....
25	0154161-00	COTTER PIN.....	2	62	5036661-00	PAWL PIN.....
26	0644889-00	ANCHOR PIN.....	1	63	0644866-00	SELECTOR STUD.....
27	5019869-06	ROLL PIN.....	2	64	0644865-00	SELECTOR PAWL.....
28	0597163-00	HEX HEAD BOLT.....	1	65	0644867-00	SPRING.....
29	6417681-00	BUSHING.....	1	66	5031763-00	LEVER HOUSING COVER.....
30	0644881-00	CHAIN GUIDE AND STRIPPER.....	2	67	6413661-00	PHILLIPS HEAD SCREW.....
31	0644885-00	STRIPPER PIN.....	1	68	0644886-00	BOTTOM BLOCK ASSM. (INCL ITEMS 22,39,40,41,42,45,46 AND 47).....
32	6496250-00	LOAD SHEAVE AND BEARING KIT (INC. Item 29).....	1	69	0644874-00	DRIVING PINION.....
33	0644879-00	OILITE BEARING.....	1	70	0644883-00	WASHER.....
34	0644876-00	GEAR.....	1	71	6446083-00	WARNING & OPER. INST. DECAL (Not Shown).....
35	0644877-00	GEAR CASE COVER.....	1			

When Replacement Parts Are Needed, Order Only YALE Factory Engineered Parts

REPAIR PARTS

MODEL PF RATCHET LEVER HOIST
4 1/2 TON (PUL-LIFT)

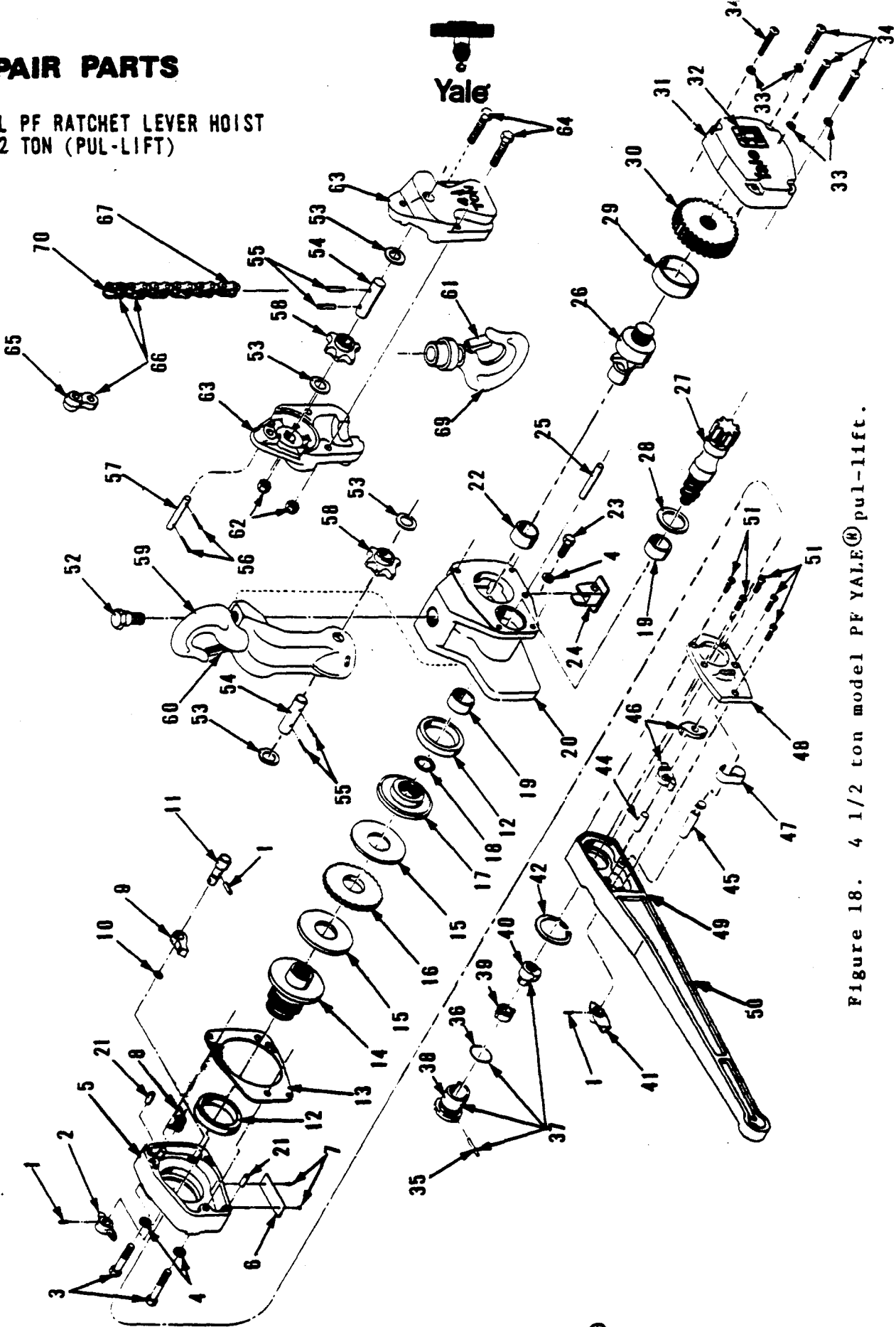

Figure 18. 4 1/2 ton model PF YALE® pul-lift.

When Replacement Parts Are Needed, Order Only YALE® Factory Engineered Parts

MODEL PF RATCHET LEVER HOIST
4 1/2 Ton (PUL-LIFT)



REPAIR PARTS

NUMBER	PART NUMBER	DESCRIPTION	QTY.	NUMBER	PART NUMBER	DESCRIPTION	QTY.
1	0583763-00	ROLL PIN.....	3	38	5029623-00	CAP AND SPRING ASSM. (INCL ITEM 39)	1
2	0644849-00	FREE CHAIN SELECTOR.....	1	39	0644863-00	SPRING.....	1
3	5000269-01	HEX HEAD BOLT.....	2	40	0644862-00	STOP ARBOR.....	1
4	0151262-00	LOCKWASHER.....	3	41	6403821-00	SELECTOR LEVER.....	1
5	6461590-00	BACK COVER ASSM. (INCL ITEM 6 AND 7)	1	42	0644854-00	RETAINING RING.....	1
6	0660531-00	INSTRUCTION PLATE.....	1	44	6475482-00	RATCHET LEVER ASSM.(INCL ITEMS 1,41,45 AND 46 THRU 51)	1
7	0209149-00	DRIVE SCREW.....	2	45	6469673-00	LEVER HOUSING.....	1
8	0644851-00	PAWL SPRING.....	1	46	5036661-00	PAWL PIN.....	1
9	0644850-00	RATCHET PAWL.....	1	47	0644866-00	SELECTOR STUD.....	1
10	0154923-00	"O" RING.....	1	48	0644865-00	SELECTOR PAWL.....	2
11	0644852-00	PAWL PIN.....	1	49	0644867-00	SPRING.....	1
12	0644898-00	WATER SEAL.....	2	50	6469673-00	LEVER HOUSING COVER.....	1
13	0644857-00	LOAD BRAKE GASKET.....	1	51	6413661-00	PHILLIPS HEAD SCREW.....	5
14	0644847-00	LOAD BRAKE HUB.....	1	52	0143734-00	WASHER.....	6
15	6468714-00	BRAKE DISC.....	2	53	0644897-00	SHEAVE AXLE.....	3
16	6413891-00	RATCHET DISC.....	1	54	0230207-00	ROLL PIN.....	6
17	0644845-00	REACTION DISC.....	1	55	0154161-00	COTTER PIN.....	2
18	0128239-00	"O" RING.....	1	56	0644889-00	ANCHOR PIN.....	1
19	6459748-00	BUSHING.....	2	57	5037791-00	SUSPENSION YOKE BOLT.....	1
20	0644884-00	GEAR CASE.....	1	58	5027840-00	TOP HOOK ASSM. (INCL ITEM 59)	1
21	5019869-06	ROLL PIN.....	2	59	5006958-00	LATCH KIT.....	1
22	6417681-00	HEX HEAD BOLT.....	1	60	0669406-00	LATCH KIT(Bottom Hook)	1
23	0597163-00	BUSHING.....	1	61	5031211-00	IDLER SPROCKET ASSEMBLY.....	3
24	0643009-00	STRIPPER.....	1	62	0150155-00	LOCK NUT.....	2
25	0644885-00	STRIPPER PIN.....	1	63	0645022-00	BOTTOM BLOCK HALF.....	2
26	6496260-00	SPROCKET & BUSHING KIT (INCL ITEM 23)	1	64	5000289-01	HEX HEAD BOLT.....	2
27	0644879-00	OILITE BEARING.....	1	65	0643011-00	ANCHOR LINK.....	1
28	0644874-00	DRIVING PINION.....	1	66	0653047-00	ROLLER CHAIN ASSM. (INCL ITEMS 65,67 AND 73)	1
29	0644883-00	WASHER.....	1	67	6409280-00	CONNECTING LINK AND ROLLER STOP ASSM.	1
30	0644876-00	GEAR.....	1	*68	0034268-00	BULK ROLLER CHAIN (Specify Length)	1
31	0644877-00	GEAR CASE COVER.....	1	69	0643034-00	BOTTOM BLOCK ASSM. (INCL ITEMS 52,53,54,61,62,63,64 AND 70) (Not Shown)	1
32	6441613-03	CAPACITY DECAL.....	1	70	5021300-00	BOTTOM HOOK ASSM. (INC. ITEM 60)	1
33	0150260-00	LOCKWASHER.....	4	**71	0182620 00	SPLICE LINK (Not Shown)	2
34	0644882 00	PHILLIPS HEAD SCREW.....	4	72	6446083-00	DECAL(Not Shown)	1
35	0644859-00	LOCKING PIN.....	1	73	0653019-00	CONNECTING LINK.....	1
36	5001599-01	"O" RING.....	1				
37	0644840-00	LOAD BRAKE ADJUSTER ASSM. (INCL ITEMS 35,36,38,40)	1				

* For Chain Lengths Other Than Standard. ** To Provide Additional Lift Use Item #71 For Splicing Chain.

When Replacement Parts Are Needed, Order Only YALE Factory Engineered Parts

REPAIR PARTS

MODEL PE RATCHET LEVER HOIST
4 1/2 TON (PUL-LIFT)

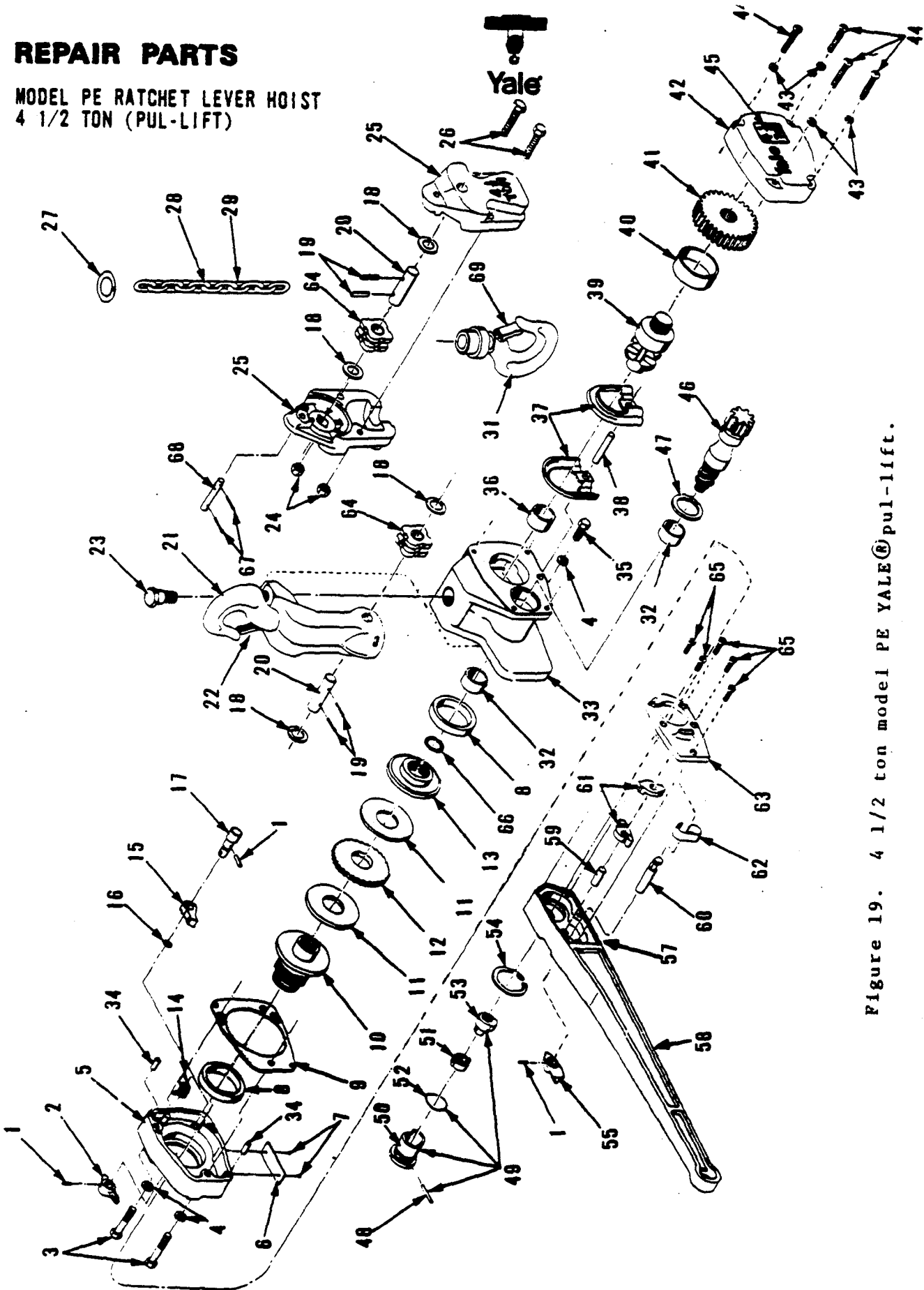

Figure 19. 4 1/2 ton model PE YALE® pul-lift.

When Replacement Parts Are Needed, Order Only YALE® Factory Engineered Parts

MODEL PE RATCHET LEVER HOIST
4 1/2 Ton (PUL-LIFT)



REPAIR PARTS

NO.	PART NUMBER	DESCRIPTION	QTY.	1 NUMBER	PART NUMBER	DESCRIPTION	QTY.
1	0583763-00	ROLL PIN.....	3	35	0597163-00	HEX HEAD BOLT.....	1
2	0644849-00	FREE CHAIN SELECTOR.....	1	36	6417681-00	BUSHING.....	1
3	5000269-01	HEX HEAD BOLT.....	2	37	0644881-00	CHAIN GUIDE AND STRIPPER.....	2
4	0150262-00	LOCKWASHER.....	3	38	0644885-00	STRIPPER PIN.....	1
5	6461590-00	BACK COVER ASSM. (INC. ITEMS 6 AND 7).....	1	39	6496250-00	LOAD SHEAVE & BEARING KIT (INC. ITEM 36).....	1
6	0660531-00	INSTRUCTION PLATE.....	1	40	0644879-00	OILITE BEARING.....	1
7	0209149-00	DRIVE SCREW.....	2	41	0644876-00	GEAR.....	1
8	0644898-00	WATER SEAL.....	2	42	0644877-00	GEAR CASE COVER.....	1
9	0644857-00	LOAD BRAKE GASKET.....	1	43	0150260-00	LOCKWASHER.....	4
10	0644847-00	LOAD BRAKE HUB.....	1	44	0644882-00	PHILLIPS HEAD SCREW.....	4
11	6468714-00	BRAKE DISC.....	2	45	6441613-03	CAPACITY DECAL.....	1
12	6413891-00	RATCHET DISC.....	1	46	0644874-00	DRIVING PINION.....	1
13	0644845-00	REACTION DISC.....	1	47	0644883-00	WASHER.....	1
14	0644851-00	PAWL SPRING.....	1	48	0644859-00	LOCKING PIN.....	1
15	0644850-00	RATCHET PAWL.....	1	49	0644840-00	LOAD BRAKE ADJUSTER ASSM. (INC. ITEMS 48,50,52 AND 53).....	1
16	0154923-00	"O" RING.....	1	50	5029623-00	CAP AND SPRING ASSEMBLY (INC. ITEM 51).....	1
17	0644852-00	PAWL PIN.....	1	51	0644863-00	SPRING.....	1
18	0143734-00	WASHER.....	4	52	5001599-01	"O" RING.....	1
19	0230207-00	ROLL PIN.....	4	53	0644862-00	STOP ARBOR.....	1
20	0644897-00	SHEAVE AXLE.....	2	54	0644854-00	RETAINING RING.....	1
21	5027840-00	TOP HOOK ASSM. (INC. ITEM 22).....	1	55	6403821-00	SELECTOR LEVER.....	1
22	5006908-00	LATCH KIT.....	1	57	6475482-00	RATCHET LEVER ASSM. (INC. ITEMS 1,55,58,59,60,61,62,63 AND 65).....	1
23	5037791-00	SUSPENSION YOKE BOLT.....	1	58	6469673-00	LEVER HOUSING.....	1
24	0150153-00	LOCK NUT.....	2	59	5036661-00	PAWL PIN.....	1
25	0645020-00	BOTTOM BLOCK HALF.....	2	60	0644866-00	SELECTOR STUD.....	1
26	0350234-00	HEX HEAD BOLT.....	2	61	0644865-00	SELECTOR PAWL.....	2
27	0164373-00	CHAIN STOP.....	1	62	0644867-00	SPRING.....	1
28	0033645-00	BULK LOAD CHAIN (SPECIFY LENGTH).....	1	63	5031763-00	LEVER HOUSING COVER.....	1
29	0033646-00	CADIUM PLATED CHAIN (SPECIFY LENGTH).....	1	64	5031201-00	SHEAVE ASSEMBLY.....	2
30	0644895-00	BOTTOM BLOCK ASSM. (INC. ITEMS 18,19,20,24,25,26,31,64,67 AND 68) (Not Shown).....	1	65	6413661-00	PHILLIPS HEAD SCREW.....	5
31	5021260-00	BOTTOM HOOK ASSM. (INC. ITEM 69).....	1	66	0128239-00	"O" RING.....	1
32	6459748-00	BUSHING.....	2	67	0154161-00	COTTER PIN.....	2
33	0644884-00	GEAR CASE.....	1	68	0644889-00	ANCHOR PIN.....	1
34	5019869-06	ROLL PIN.....	2	69	0669404-00	LATCH KIT.....	1
				70	6446083-00	WARNING & OPER. INST. DECAL (Not Shown).....	1

When Replacement Parts Are Needed, Order Only YALE Factory Engineered Parts

REPAIR PARTS

MODEL PF RATCHET LEVER HOIST
6 TON (PUL-LIFT)

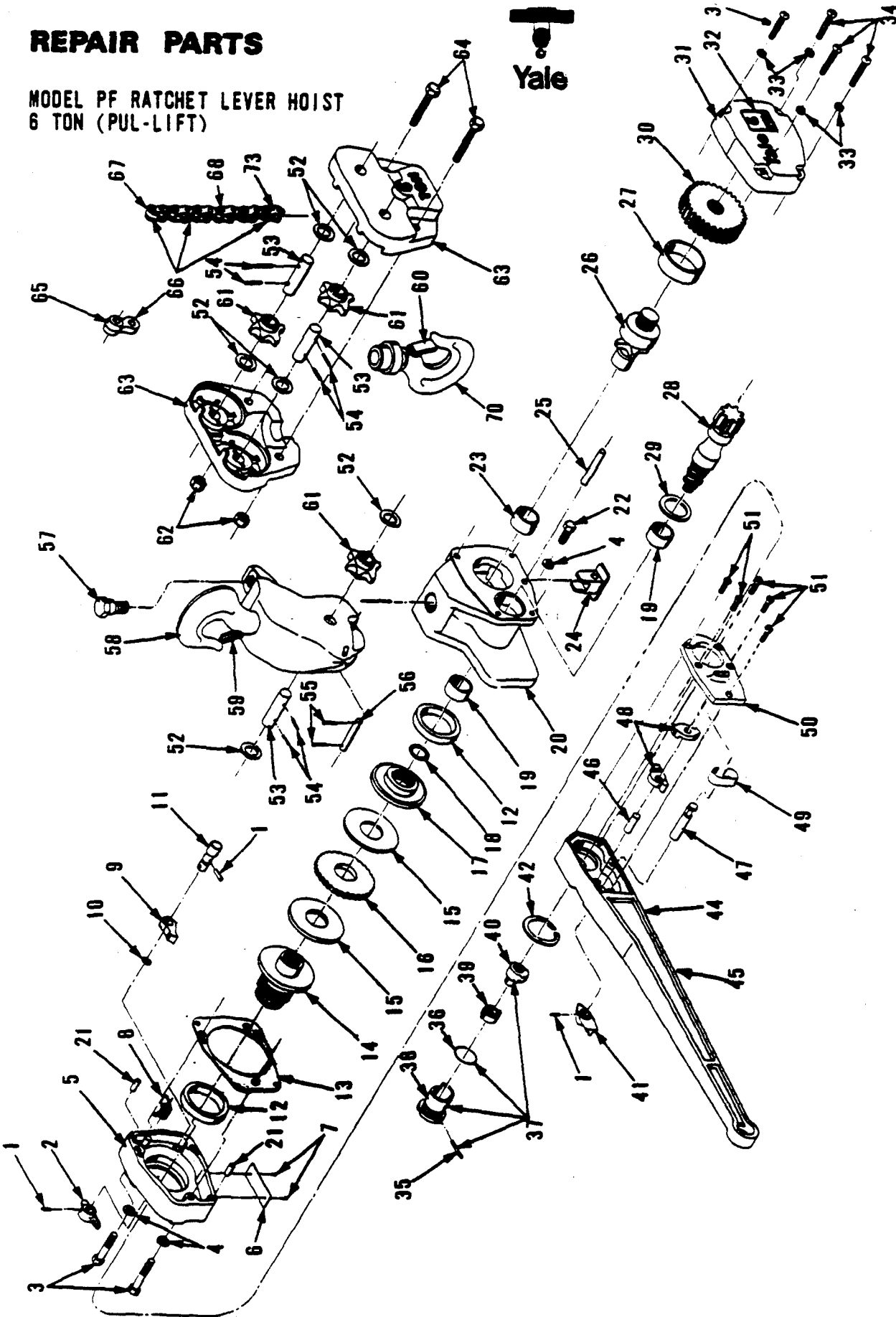

Figure 20. 6 ton model PF YALE® pul-lift.

When Replacement Parts Are Needed, Order Only YALE® Factory Engineered Parts

MODEL PF RATCHET LEVER HOIST
6 Ton (PUL-LIFT)



REPAIR PARTS

NUMBER	PART NUMBER	DESCRIPTION	QTY.	NUMBER	PART NUMBER	DESCRIPTION	QTY.
1	0583763-00	ROLL PIN.....	3	38	5029623-00	CAP AND SPRING ASSM. (INCL ITEM 39).....	1
2	0644849-00	FREE CHAIN SELECTOR.....	1	39	0644863-00	SPRING.....	1
3	5000269-01	HEX HEAD BOLT.....	2	40	0644862-00	STOP ARBOR.....	1
4	0151262-00	LOCKWASHER.....	3	41	6403821-00	SELECTOR LEVER.....	1
5	6461590-00	BACK COVER ASSM. (INCL ITEM 6 AND 7).....	1	42	0644854-00	RETAINING RING.....	1
6	0660531-00	INSTRUCTION PLATE.....	1	44	6475482-00	RATCHET LEVER ASSM.(INCL ITEMS 1,41,45 THRU 51).....	1
7	0209149-00	DRIVE SCREW.....	2	45	6469673-00	LEVER HOUSING.....	1
8	0644851-00	PAWL SPRING.....	1	46	5036661-00	PAWL PIN.....	1
9	0644850-00	RATCHET PAWL.....	1	47	0644866-00	SELECTOR STUD.....	1
10	0154923-00	"O" RING.....	1	48	0644865-00	SELECTOR PAWL.....	2
11	0644852-00	PAWL PIN.....	1	49	0644867-00	SPRING.....	1
12	0644898-00	WATER SEAL.....	2	50	5031763-00	LEVER HOUSING COVER.....	1
13	0644857-00	LOAD BRAKE GASKET.....	1	51	6413661-00	PHILLIPS HEAD SCREW.....	5
14	0644847-00	LOAD BRAKE HUB.....	1	52	0143734-00	WASHER.....	6
15	6468714-00	BRAKE DISC.....	2	53	0644897-00	SHEAVE AXLE.....	3
16	6413891-00	RATCHET DISC.....	1	54	0230207-00	ROLL PIN.....	6
17	0644845-00	REACTION DISC.....	1	55	0154161-00	COTTER PIN.....	2
18	0128239-00	"O" RING.....	1	56	0644889-00	ANCHOR PIN.....	1
19	6459748-00	BUSHING.....	2	57	5037791-00	SUSPENSION YOKE BOLT.....	1
20	0644884-00	GEAR CASE.....	1	58	5027850-00	TOP HOOK ASSM. (INCL ITEM 59).....	1
21	5019869-06	ROLL PIN.....	2	59	5006958-00	LATCH KIT.....	1
22	0597163-00	HEX HEAD BOLT.....	1	60	0669406-00	LATCH KIT (Bottom Hook).....	1
23	6417681-00	BUSHING.....	1	61	5031211-00	IDLER SPROCKET ASSEMBLY.....	3
24	0643009-00	STRIPPER.....	1	62	0150155-00	LOCK NUT.....	2
25	0644885-00	STRIPPER PIN.....	1	63	0645022-00	BOTTOM BLOCK HALF.....	2
26	6496260-00	SPROCKET & BUSHING KIT (INCL ITEM 23).....	1	64	5000289-01	HEX HEAD BOLT.....	2
27	0644879-00	OILITE BEARING.....	1	65	0643011-00	ANCHOR LINK.....	1
28	0644874-00	DRIVING PINION.....	1	66	0653047-00	ROLLER CHAIN ASSM. (INCL ITEMS 65,67 AND 73)	1
29	0644883-00	WASHER.....	1	67	6409280-00	CONNECTING LINK AND ROLLER STOP ASSM.	1
30	0644876-00	GEAR.....	1	*68	0034268-00	BULK ROLLER CHAIN (Specify Length).....	1
31	0644877-00	GEAR CASE COVER.....	1	69	0643034-00	BOTTOM BLOCK ASSM. (INCL ITEMS 52,53,54,61,62,63,64 AND 70) (Not Shown).....	1
32	6441613-04	CAPACITY DECAL.....	1	70	5021300-00	BOTTOM HOOK ASSM. (INC. ITEM 60)	1
33	0150260-00	LOCKWASHER.....	4	**71	0182620-00	SPUCE LINK (Not Shown).....	2
34	0644882-00	PHILLIPS HEAD SCREW.....	4	72	6446083-00	DECAL(Not Shown).....	1
35	0644859-00	LOCKING PIN.....	1	73	0653019-00	CONNECTING LINK.....	1
36	5001599-01	"O" RING.....	1				
37	0644840-00	LOAD BRAKE ADJUSTER ASSM. (INCL ITEMS 35,36,38,40).....	1				

* For Chain Lengths Other Than Standard. ** To Provide Additional Lift Use Item #71 For Splicing Chain.

When Replacement Parts Are Needed, Order Only YALE Factory Engineered Parts

REPAIR PARTS

MODEL PE RATCHET LEVER HOIST
6 TON (PUL-LIFT)

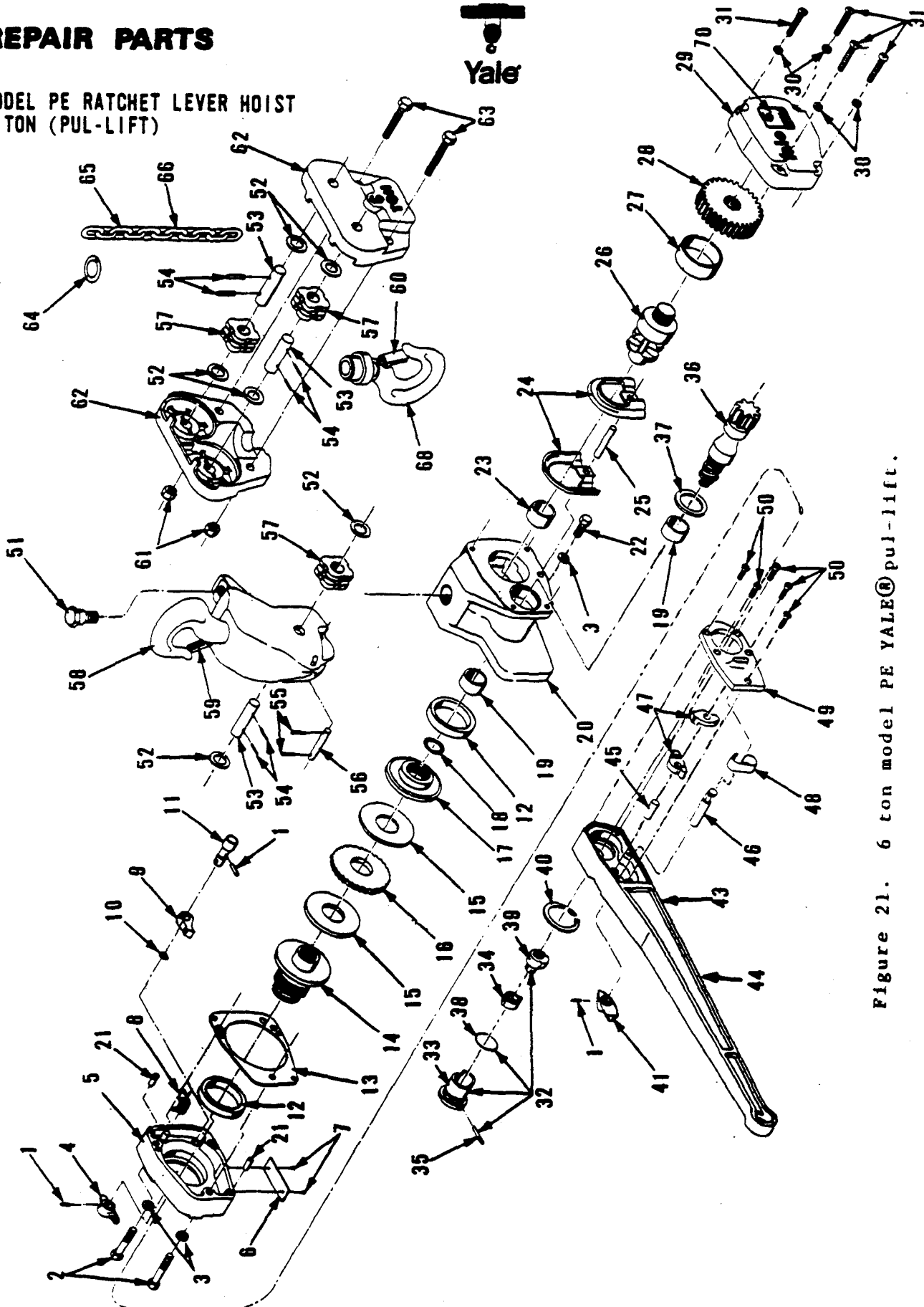

Figure 21. 6 ton model PE YALE® pul-lift.

When Replacement Parts Are Needed, Order Only YALE® Factory Engineered Parts

MODEL PE RATCHET LEVER HOIST
6 Ton (PUL-LIFT)



REPAIR PARTS

NUMBER	PART NUMBER	DESCRIPTION	QTY.	ITEM NUMBER	PART NUMBER	DESCRIPTION	QTY.
1	0583763-00	ROLL PIN.....	3	36	0644874-00	DRIVING PINION.....	1
2	5000269-01	HEX HEAD BOLT.....	2	37	0644883-00	WASHER.....	1
3	0150262-00	LOCKWASHER.....	3	38	5001599-01	"O" RING.....	1
4	0644849-00	FREE CHAIN SELECTOR.....	1	39	0644862-00	STOP ARBOR.....	1
5	6461590-00	BACK COVER ASSM. (INCL. ITEMS 6 AND 7).....	1	40	0644854-00	RETAINING RING.....	1
6	0660531-00	INSTRUCTION PLATE.....	1	41	6403821-00	SELECTOR LEVER.....	1
7	0209149-00	DRIVE SCREW.....	2	43	6475482-00	RATCHET LEVER ASSM. (INCL. ITEMS 1,41,42,44 AND 45 THROUGH 50).....	1
8	0644851-00	SPRING.....	1	44	6469673-00	LEVER HOUSING.....	1
9	0644850-00	RATCHET PAWL.....	1	45	5036661-00	PAWL PIN.....	1
10	0154923-00	"O" RING.....	1	46	0644866-00	SELECTOR STUD.....	1
11	0644852-00	PAWL PIN.....	1	47	0644865-00	SELECTOR PAWL.....	2
12	0644898-00	WATER SEAL.....	2	48	0644867-00	SPRING.....	1
13	0644857-00	LOAD BRAKE GASKET.....	1	49	5031763-00	LEVER HOUSING COVER.....	1
14	0644847-00	LOAD BRAKE HUB.....	1	50	6413661-00	PHILLIPS HEAD SCREW.....	5
15	6468714-00	BRAKE DISC.....	2	51	5037791-00	SUSPENSION YOKE BOLT.....	1
16	6413891-00	RATCHET DISC.....	1	52	0143734-00	WASHER.....	6
17	0644845-00	REACTION DISC.....	1	53	0644897-00	SHEAVE AXLE.....	3
18	0128239-00	"O" RING.....	1	54	0230207-00	ROLL PIN.....	6
19	6459748-00	BUSHING.....	2	55	0154161-00	COTTER PIN.....	2
20	0644884-00	GEAR CASE.....	1	56	0644889-00	ANCHOR PIN.....	1
21	5019869-06	ROLL PIN.....	2	57	5031201-00	SHEAVE.....	3
22	0597163-00	HEX HEAD BOLT.....	1	58	5027850-00	TOP HOOK ASSM. (INC. ITEM 59).....	1
23	6417681-00	BUSHING.....	1	59	5006958-00	LATCH KIT (Top Hook).....	1
24	0644881-00	CHAIN GUIDE AND STRIPPER.....	2	60	0669406-00	LATCH KIT (Bottom Hook).....	1
25	0644885-00	STRIPPER PIN.....	1	61	0150155-00	LOCK NUT.....	2
26	6496250-00	LOAD SHEAVE & BEARING KIT (INC. 23).....	1	62	0645022-00	BOTTOM BLOCK HALF.....	2
27	0644879-00	OILITE BEARING.....	1	63	5000289-01	HEX HEAD SCREW.....	2
28	0644876-00	GEAR.....	1	64	0164373-00	CHAIN STOP.....	1
29	0644877-00	GEAR CASE COVER.....	1	65	0033646-00	CADIUM PLATED CHAIN (Specify Length).....	1
30	0150260-00	LOCKWASHER.....	4	66	0033645-00	BULK LOAD CHAIN (Specify Length).....	1
31	0644882-00	PHILLIPS HEAD SCREW.....	4	67	0644899-00	BOTTOM BLOCK ASSM. (INC. ITEMS 52,53,54,57,61,62,63 AND 68).....(Not Shown)	1
32	0644840-00	LOAD BRAKE ADJUSTER ASSM. (INCL. ITEMS, 33,35,38 AND 39).....	1	68	5021300-00	BOTTOM HOOK ASSM. (INCL. ITEMS 60).....	1
33	5029623-00	CAP AND SPRING ASSM. INC. ITEM 34.....	1	69	6446083-00	WARNING & OPER. INS. DECAL (Not Shown).....	1
34	0644863-00	SPRING.....	1	70	6441613-04	CAPACITY DECAL.....	1
35	0644859-00	LOCKING PIN.....	1				

When Replacement Parts Are Needed, Order Only YALE Factory Engineered Parts

10

11

12

POWERED HOIST INSPECTION CHECK LIST

SEE PREVENTIVE MAINTENANCE SECTION OF INSTRUCTION MANUAL FOR DETAILS.

CHECK ONLY COMPONENTS APPLICABLE FOR SPECIFIC EQUIPMENT AND INSPECTION TYPE.

HOIST MODEL _____

HOIST S/N _____

HOOKS	YES	NO	CABLE	YES	NO	CHAINS	YES	NO
HARDWARE LOOSE	<input type="checkbox"/>	<input type="checkbox"/>	BROKEN WIRES AT ENDS	<input type="checkbox"/>	<input type="checkbox"/>	BINDING	<input type="checkbox"/>	<input type="checkbox"/>
CRACKS	<input type="checkbox"/>	<input type="checkbox"/>	BROKEN WIRES EXCESSIVE	<input type="checkbox"/>	<input type="checkbox"/>	CRACKED	<input type="checkbox"/>	<input type="checkbox"/>
EXCESSIVE WEAR	<input type="checkbox"/>	<input type="checkbox"/>	EXCESSIVE WEAR	<input type="checkbox"/>	<input type="checkbox"/>	TWISTED	<input type="checkbox"/>	<input type="checkbox"/>
BENT	<input type="checkbox"/>	<input type="checkbox"/>	KINKED OR DISTORTED	<input type="checkbox"/>	<input type="checkbox"/>	DISTORTED	<input type="checkbox"/>	<input type="checkbox"/>
SPREADING	<input type="checkbox"/>	<input type="checkbox"/>	CORROSION	<input type="checkbox"/>	<input type="checkbox"/>	CORRODED	<input type="checkbox"/>	<input type="checkbox"/>
FREELY ROTATE	<input type="checkbox"/>	<input type="checkbox"/>	HEAT DAMAGED	<input type="checkbox"/>	<input type="checkbox"/>	EXCESSIVE WEAR	<input type="checkbox"/>	<input type="checkbox"/>
LATCH DAMAGED	<input type="checkbox"/>	<input type="checkbox"/>				WORN CHAIN GUIDES	<input type="checkbox"/>	<input type="checkbox"/>
						POCKET WHEELS WORN	<input type="checkbox"/>	<input type="checkbox"/>
BRAKES			WIRING			DRUM & SHEAVES		
MOTOR BRAKE WORN OR NOT OPERATING	<input type="checkbox"/>	<input type="checkbox"/>	LOOSE CONNECTIONS	<input type="checkbox"/>	<input type="checkbox"/>	WORN EXCESSIVELY	<input type="checkbox"/>	<input type="checkbox"/>
EXCESSIVE LOADBRAKE DRIFT OR BLACKLASH	<input type="checkbox"/>	<input type="checkbox"/>	FRAYED	<input type="checkbox"/>	<input type="checkbox"/>	CRACKED OR SCORED	<input type="checkbox"/>	<input type="checkbox"/>
EXCESSIVE DISC WEAR	<input type="checkbox"/>	<input type="checkbox"/>	DAMAGED	<input type="checkbox"/>	<input type="checkbox"/>			
			PROPER GROUNDING	<input type="checkbox"/>	<input type="checkbox"/>			
LIMIT SWITCHES			LOAD LIMITING DEVICE			COLLECTORS		
OPERATING PROPERLY	<input type="checkbox"/>	<input type="checkbox"/>	OPERATING PROPERLY	<input type="checkbox"/>	<input type="checkbox"/>	BINDING	<input type="checkbox"/>	<input type="checkbox"/>
						EXCESSIVE WEAR	<input type="checkbox"/>	<input type="checkbox"/>
HOUSING			OPERATION CONTROLS			LUBRICATION		
DISTORTED	<input type="checkbox"/>	<input type="checkbox"/>	CONTACTOR PITTING	<input type="checkbox"/>	<input type="checkbox"/>	ALL POINTS LUBRICATED AS GIVEN IN LUB CHART	<input type="checkbox"/>	<input type="checkbox"/>
CRACKS	<input type="checkbox"/>	<input type="checkbox"/>	OPERATING PROPERLY	<input type="checkbox"/>	<input type="checkbox"/>	OIL DARK OR LOW	<input type="checkbox"/>	<input type="checkbox"/>
LOOSE HARDWARE	<input type="checkbox"/>	<input type="checkbox"/>	DAMAGED PUSH BUTTON	<input type="checkbox"/>	<input type="checkbox"/>	OIL LEAKS	<input type="checkbox"/>	<input type="checkbox"/>
BEARING NOISE	<input type="checkbox"/>	<input type="checkbox"/>	HOUSING	<input type="checkbox"/>	<input type="checkbox"/>			
SUPPORTING STRUCTURE			AIR SYSTEM			WARNING LABELS		
CONTINUED ABILITY TO SUPPORT IMPOSED LOADS	<input type="checkbox"/>	<input type="checkbox"/>	LEAKING	<input type="checkbox"/>	<input type="checkbox"/>	MISSING	<input type="checkbox"/>	<input type="checkbox"/>
WORN OR DISTORTED TROLLEY PARTS	<input type="checkbox"/>	<input type="checkbox"/>	LOOSE CONNECTIONS	<input type="checkbox"/>	<input type="checkbox"/>	ILLEGIBLE	<input type="checkbox"/>	<input type="checkbox"/>
			BROKEN CONTROL PENDANT	<input type="checkbox"/>	<input type="checkbox"/>			

NOTE: IF ANY () IS CHECKED DO NOT OPERATE THE HOIST UNTIL REPAIRS HAVE BEEN MADE.

REMARKS AND REPAIRS MADE _____

SIGNATURE _____ DATE _____ CLOCK NUMBER _____

POWERED HOIST INSPECTION CHECK LIST

SEE PREVENTIVE MAINTENANCE SECTION OF INSTRUCTION MANUAL FOR DETAILS.

CHECK ONLY COMPONENTS APPLICABLE FOR SPECIFIC EQUIPMENT AND INSPECTION TYPE.

HOIST MODEL _____

HOIST S/N _____

HOOKS	YES	NO	CABLE	YES	NO	CHAINS	YES	NO
HARDWARE LOOSE	<input type="checkbox"/>	<input type="checkbox"/>	BROKEN WIRES AT ENDS	<input type="checkbox"/>	<input type="checkbox"/>	BINDING	<input type="checkbox"/>	<input type="checkbox"/>
CRACKS	<input type="checkbox"/>	<input type="checkbox"/>	BROKEN WIRES EXCESSIVE	<input type="checkbox"/>	<input type="checkbox"/>	CRACKED	<input type="checkbox"/>	<input type="checkbox"/>
EXCESSIVE WEAR	<input type="checkbox"/>	<input type="checkbox"/>	EXCESSIVE WEAR	<input type="checkbox"/>	<input type="checkbox"/>	TWISTED	<input type="checkbox"/>	<input type="checkbox"/>
BENT	<input type="checkbox"/>	<input type="checkbox"/>	KINKED OR DISTORTED	<input type="checkbox"/>	<input type="checkbox"/>	DISTORTED	<input type="checkbox"/>	<input type="checkbox"/>
SPREADING	<input type="checkbox"/>	<input type="checkbox"/>	CORROSION	<input type="checkbox"/>	<input type="checkbox"/>	CORRODED	<input type="checkbox"/>	<input type="checkbox"/>
FREELY ROTATE	<input type="checkbox"/>	<input type="checkbox"/>	HEAT DAMAGED	<input type="checkbox"/>	<input type="checkbox"/>	EXCESSIVE WEAR	<input type="checkbox"/>	<input type="checkbox"/>
LATCH DAMAGED	<input type="checkbox"/>	<input type="checkbox"/>				WORN CHAIN GUIDES	<input type="checkbox"/>	<input type="checkbox"/>
						POCKET WHEELS WORN	<input type="checkbox"/>	<input type="checkbox"/>
BRAKES			WIRING			DRUM & SHEAVES		
MOTOR BRAKE WORN OR NOT OPERATING	<input type="checkbox"/>	<input type="checkbox"/>	LOOSE CONNECTIONS	<input type="checkbox"/>	<input type="checkbox"/>	WORN EXCESSIVELY	<input type="checkbox"/>	<input type="checkbox"/>
EXCESSIVE LOADBRAKE DRIFT OR BLACKLASH	<input type="checkbox"/>	<input type="checkbox"/>	FRAYED	<input type="checkbox"/>	<input type="checkbox"/>	CRACKED OR SCORED	<input type="checkbox"/>	<input type="checkbox"/>
EXCESSIVE DISC WEAR	<input type="checkbox"/>	<input type="checkbox"/>	DAMAGED	<input type="checkbox"/>	<input type="checkbox"/>			
			PROPER GROUNDING	<input type="checkbox"/>	<input type="checkbox"/>			
LIMIT SWITCHES			LOAD LIMITING DEVICE			COLLECTORS		
OPERATING PROPERLY	<input type="checkbox"/>	<input type="checkbox"/>	OPERATING PROPERLY	<input type="checkbox"/>	<input type="checkbox"/>	BINDING	<input type="checkbox"/>	<input type="checkbox"/>
						EXCESSIVE WEAR	<input type="checkbox"/>	<input type="checkbox"/>
HOUSING			OPERATION CONTROLS			LUBRICATION		
DISTORTED	<input type="checkbox"/>	<input type="checkbox"/>	CONTACTOR PITTING	<input type="checkbox"/>	<input type="checkbox"/>	ALL POINTS LUBRICATED AS GIVEN IN LUB CHART	<input type="checkbox"/>	<input type="checkbox"/>
CRACKS	<input type="checkbox"/>	<input type="checkbox"/>	OPERATING PROPERLY	<input type="checkbox"/>	<input type="checkbox"/>	OIL DARK OR LOW	<input type="checkbox"/>	<input type="checkbox"/>
LOOSE HARDWARE	<input type="checkbox"/>	<input type="checkbox"/>	DAMAGED PUSH BUTTON	<input type="checkbox"/>	<input type="checkbox"/>	OIL LEAKS	<input type="checkbox"/>	<input type="checkbox"/>
BEARING NOISE	<input type="checkbox"/>	<input type="checkbox"/>	HOUSING	<input type="checkbox"/>	<input type="checkbox"/>			
SUPPORTING STRUCTURE			AIR SYSTEM			WARNING LABELS		
CONTINUED ABILITY TO SUPPORT IMPOSED LOADS	<input type="checkbox"/>	<input type="checkbox"/>	LEAKING	<input type="checkbox"/>	<input type="checkbox"/>	MISSING	<input type="checkbox"/>	<input type="checkbox"/>
WORN OR DISTORTED TROLLEY PARTS	<input type="checkbox"/>	<input type="checkbox"/>	LOOSE CONNECTIONS	<input type="checkbox"/>	<input type="checkbox"/>	ILLEGIBLE	<input type="checkbox"/>	<input type="checkbox"/>
			BROKEN CONTROL PENDANT	<input type="checkbox"/>	<input type="checkbox"/>			

NOTE: IF ANY () IS CHECKED DO NOT OPERATE THE HOIST UNTIL REPAIRS HAVE BEEN MADE.

REMARKS AND REPAIRS MADE _____

SIGNATURE _____ DATE _____ CLOCK NUMBER _____

Yale®

HOISTS

WARRANTY

Every hoist is thoroughly inspected and tested prior to shipment from the factory. Should any problems develop, return the complete hoist prepaid to your nearest Yale Hoists Authorized Warranty Repair Station.

This warranty does not apply where: (1) deterioration is caused by normal wear, abuse, improper or inadequate power supply, eccentric or side loading, overloading, chemical or abrasive actions, improper maintenance or excessive heat; (2) problems resulted from repairs, modifications or

alterations made by persons other than factory or Yale Hoists personnel; (3) the hoist has been abused or damaged as a result of an accident; (4) repair parts or accessories other than those supplied by Yale Hoists are used on the hoist. Equipment and accessories not of the seller's manufacture are warranted only to the extent that they are warranted by the manufacturer. EXCEPT AS STATED HEREIN, YALE HOISTS MAKES NO OTHER WARRANTIES, EXPRESS OR IMPLIED, INCLUDING WARRANTIES OF MERCHANTABILITY AND FITNESS FOR A PARTICULAR PURPOSE.

Improvements:

Yale Hoists is constantly striving to improve its product. Changes in design and improvements will be made whenever manufacturer believes the efficiency of the product will be improved without incurring any obligation to incorporate such improvements in any products which have been shipped or are in service.

Important Notice:

Use of chain, wire rope or replacement parts other than as supplied as original equipment on Yale hoists may lead to dangerous operation. Accordingly, Yale Hoists cannot be responsible in such cases and our warranty will be voided.

For more information, write Yale Hoists, Forrest City, Arkansas 72335.

Yale® HOISTS
3105 N. Washington
P. O. Box 1000
Forrest City, Arkansas 72335
Customer Service (800) 999-6318
FAX (800) 766-0223