

Brunswick Billiards Storage Drawer Installation Manual

STEP 1 – Determine proper mounting location on billiard table base frame for drawer attach brackets.

There are 3 possible methods to mount the bracket to the base frame cross supports. The method that is correct for your application will depend on the model of billiard table that you have.

Method #1

(Aligned to bottom)

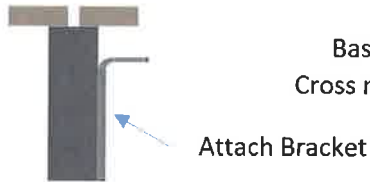

Allenton - 8'
Tremont - 8'
Bayfield - 8'
Black Wolf - 8' & 9'
Glenwood - 8' & 9'

Method #2

(Aligned to top)

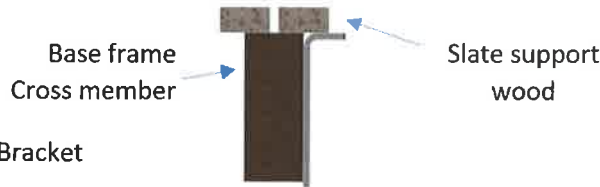

Park Falls - 8'
Canton - 8' I
Brixton - 8'
Merrimack - 8'

Method #3

(Aligned below)

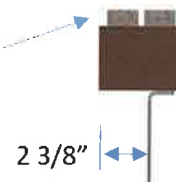

Sanibel - 8'
The Loft - 8'
Soho - 8'

Once you've identified your mounting method, you will need to know how far back in relation to the tables centerline to attach your brackets. There are two recommended locations based on 8' or 9' table sizes.

8' Tables - Measure back 3" from table centerline to 8' line on upper bracket

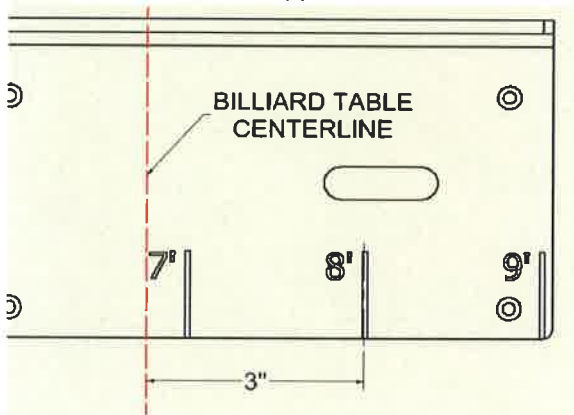

9' Tables - Measure back 2" from table centerline to 9' line on upper bracket

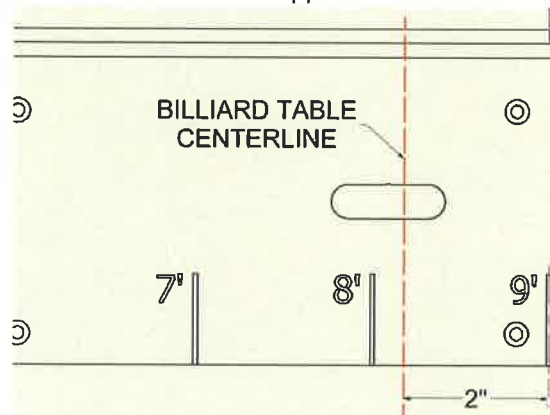

Note: Black Wolf 8' and 9' Tables do not work with above dimensions due to an "H" shaped base frame. Use below dimensions specific to Black Wolf tables only. The Storage Drawer will not work with "Black Wolf Pro".

Black Wolf - 8'

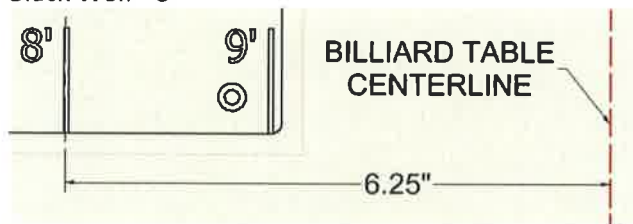

Black Wolf - 9'

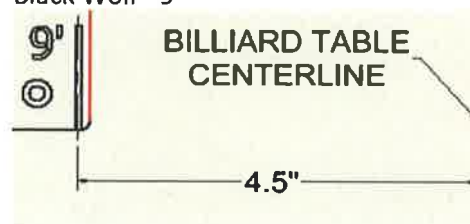

www.brunswickbilliards.com

SERVICE DEPARTMENT P.O. BOX 68 BRISTOL, WI 53104
EMAIL: BRUNSWICKSERVICE@BRUNSWICKBILLIARDS.COM



Page 1 of 4

STEP 2 – Attach both attach brackets to determined locations on inside faces of the base frame cross members using #8 hardware provided. Once bracket is mounted, drill through cross member using a 7/16" drill bit in the two slotted areas and further secure bracket with the 3/8" hardware included. See pages 3 & 4 for more detail.

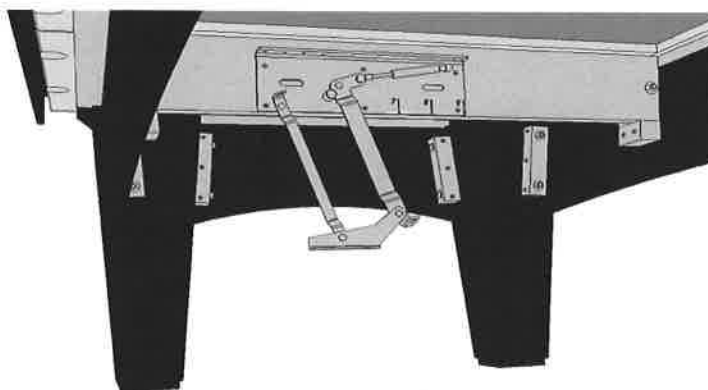

STEP 3 – Assemble upper and lower Stretcher tubes to proper width and bolt to left & right drawer attach brackets using 1/4" hardware provided. Leave hardware loose to allow adjustment when drawer body is attached. Mount tubes as shown, inside of slotted hinge tabs. See pages 3 & 4 for more detail.



STEP 4 – Securely bolt drawer body to attach brackets using 5/16" hardware provided. Once drawer is on and aligned, tighten all loose hardware from Step 3 above. See pages 3 & 4 for more detail.

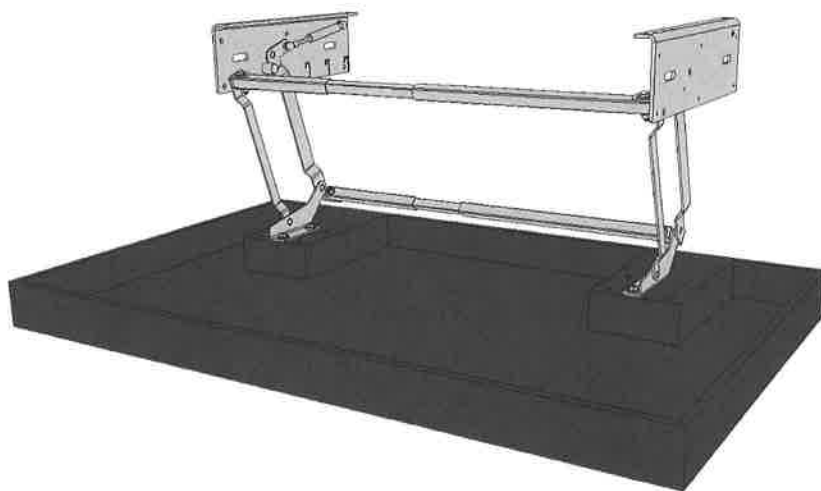

Page 2 of 4

www.brunswickbilliards.com
SERVICE DEPARTMENT P.O. BOX 68 BRISTOL, WI 53104
EMAIL: BRUNSWICKSERVICE@BRUNSWICKBILLIARDS.COM

The Standard
of Superior Craftsmanship



Preferred by
Experts Around the World

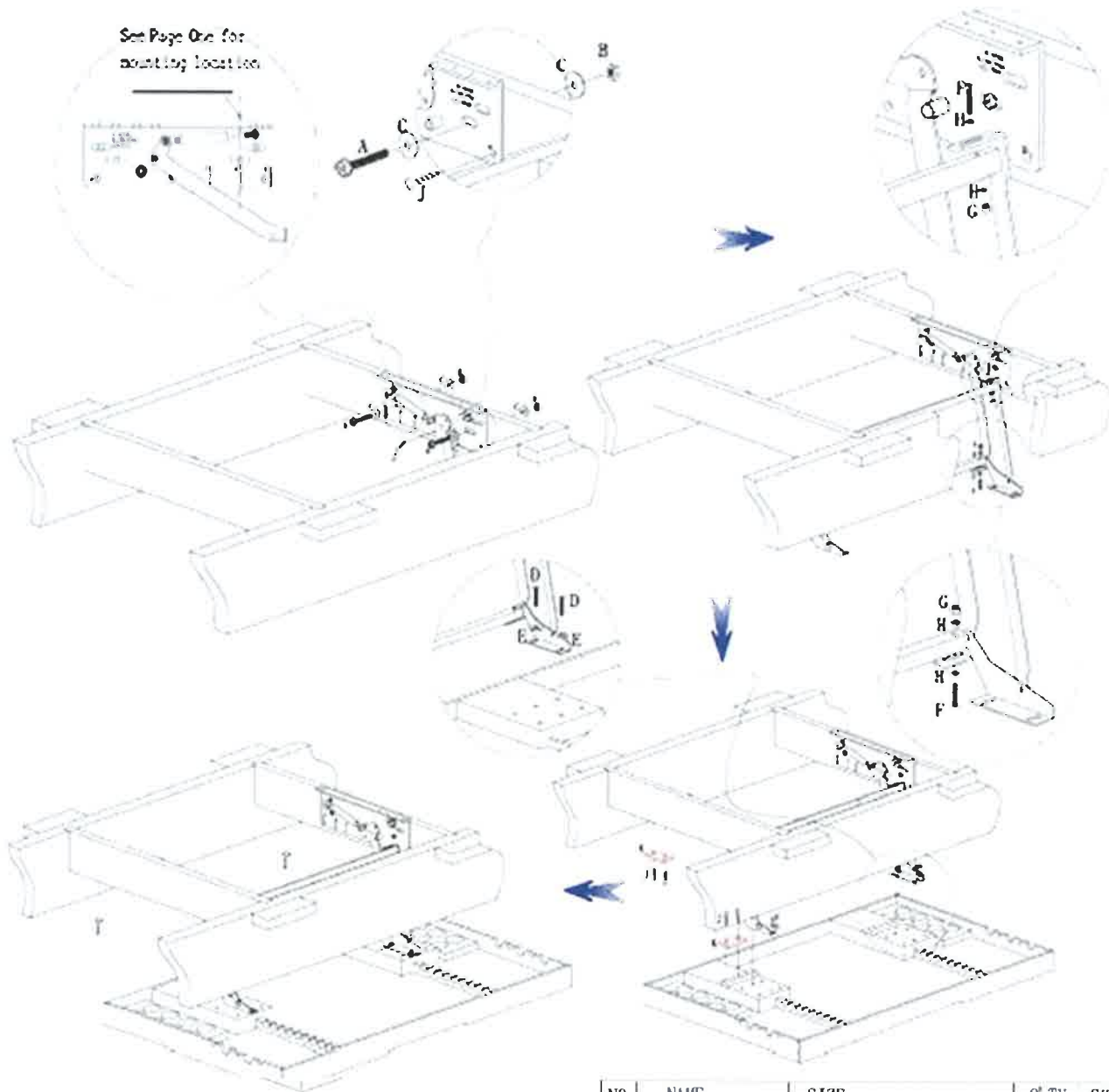

NO	NAME	SIZE	Q' TY	SKETCH	NO	NAME	SIZE	Q' TY	SKETCH
					F	BOLT	$\phi 1/4" \times 1-1/4"$	4	
A	BOLT	$\phi 3/8" \times 2-3/4"$	4		G	NYLOCK NUT	$\phi 1/4"$	4	
B	NYLOCK NUT	$\phi 3/8"$	4		H	WASHER	$\phi 1/4" \times \phi 3/4" \times 2mm$	8	
C	WASHER	$\phi 3/8" \times \phi 1" \times 2mm$	8		I	EVA PAD	$1-1/4" \times 1-1/4" \times 1/4"$	4	
D	NYLOCK BOLT	$\phi 5/16" \times 1-1/4"$	4		J	SCREW	#8*1-1/4"	14	
E	WASHER	$\phi 5/16" \times \phi 3/4" \times 2mm$	4		K	MAGNET	$2-3/8" \times 1-1/4" \times 3/16"$	4	

The Standard
of Superior Craftsmanship



Preferred by
Experts Around the World

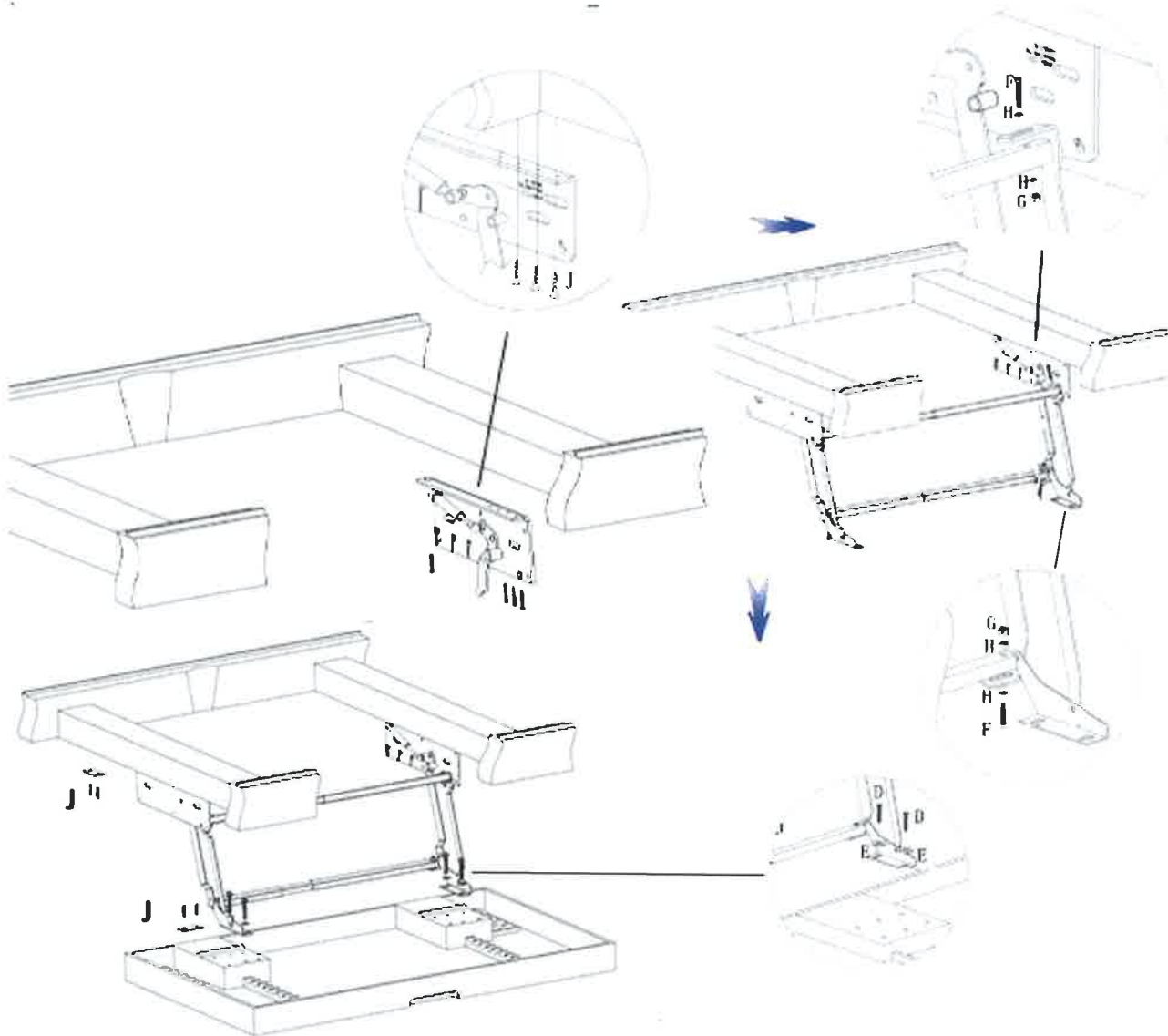

NO	NAME	SIZE	Q' TY	SKETCH	NO	NAME	SIZE	Q' TY	SKETCH
D	NYLOCK BOLT	Ø5/16"×1-1/4"	4		H	WASHER	Ø1/4"×Ø3/4"×2mm	8	
E	WASHER	Ø5/16"×Ø3/4"×2mm	4		I	EVA PAD	1-1/4"×1-1/4"×1/4"	4	
F	BOLT	Ø1/4"×1-1/4"	4		J	SCREW	#8×1-1/4"	20	
G	NYLOCK NUT	Ø1/4"	4		K	MAGNET	2-3/8"×1-1/4"×3/16"	4	