

# 9401CF

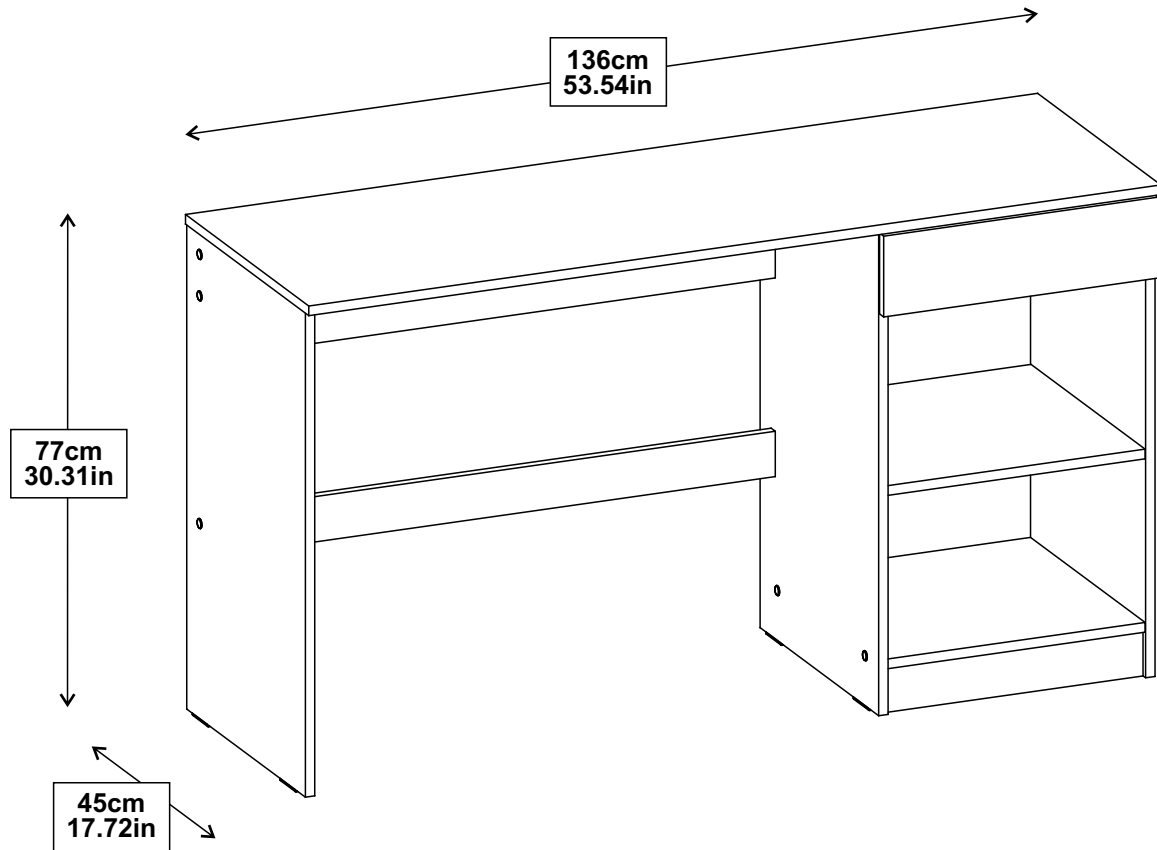

[cdn.madesa.com/mont/9401CF](https://cdn.madesa.com/mont/9401CF)

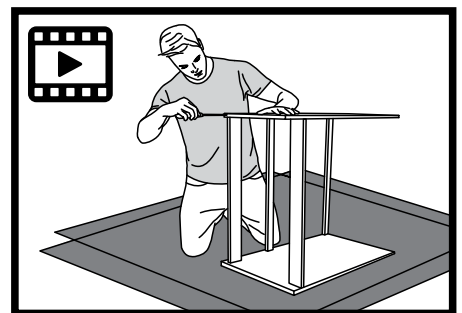
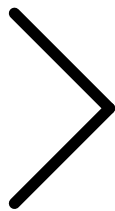

**madesa**  
madesa.com

Tools needed to assemble the furniture: - Outils nécessaires pour assembler les meubles:

Werkzeuge, die für die Montage der Möbel benötigt werden: - Herramientas necesarias para armar el mueble:

Ferramentas necessárias para montar o móvel: - Strumenti necessari per assemblare il mobile:

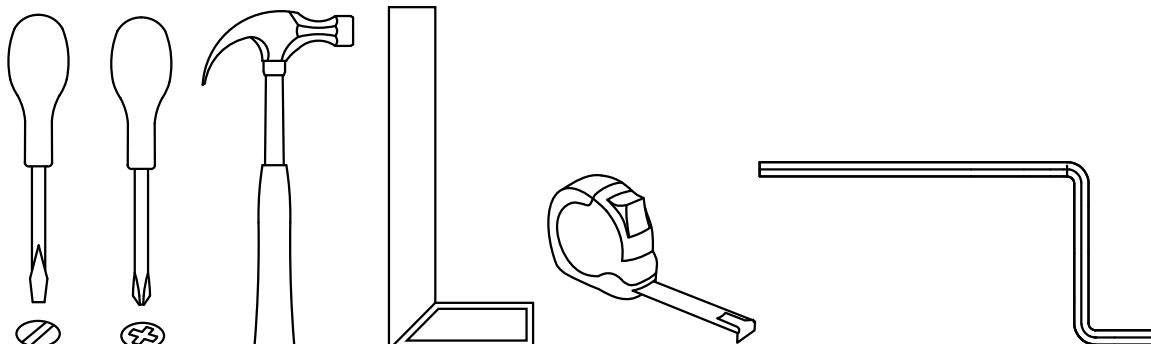

The assembly must be done by two people.

L'assemblage doit être effectué par deux personnes.

Es wird empfohlen, dass zwei Personen den Artikel montieren.

El montaje debe ser efectuado por dos personas.

A montagem deve ser efetuada por duas pessoas.

Il montaggio deve essere effettuato da due persone.

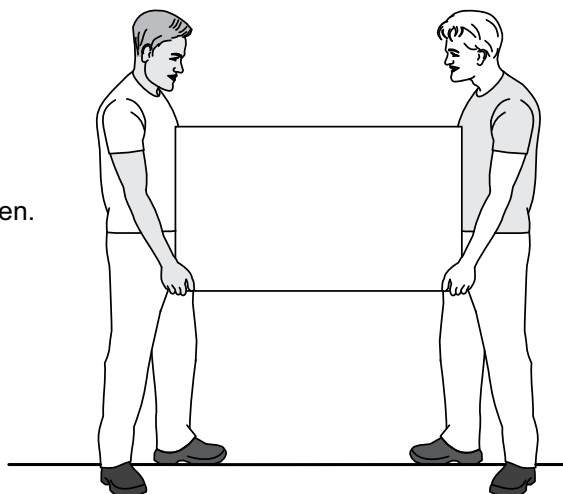

This product contain small parts, please,  
keep out of reach of children.

Ce produit contient de petites pièces, s'il vous plait,  
à conserver hors de portée des enfants.

Bitte halten Sie kleine Teile außerhalb der Reichweite von Kindern.

Este producto contiene piezas pequeñas,  
mantener fuera del alcance de los niños.

Este produto contém peças pequenas, por favor,  
mantenha fora do alcance das crianças.

Questo prodotto contiene piccole parti,  
si prega di tenerle fuori dalla portata dei bambini.

In case of doubt, compare the hardware with the full-size images below.

En cas de doute, veuillez comparer le matériel avec les images en taille réelle ci-dessous.

Vergleichen Sie im Zweifelsfall die Schrauben mit den Abbildungen in Originalgröße.

En caso de dudas, compare las herrajes con las imágenes a seguir en tamaño real.

Em caso de dúvida, compare as ferragens com as imagens abaixo em tamanho real.

In caso di dubbio, confronta le ferramenta con le immagini sottostanti a grandezza reale.

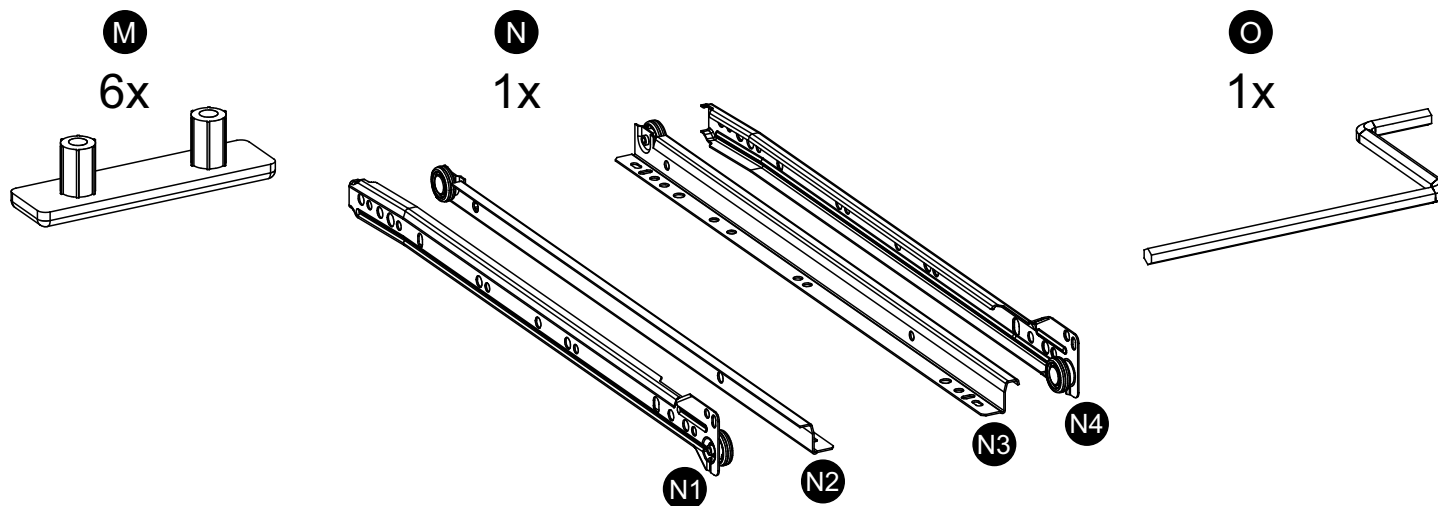
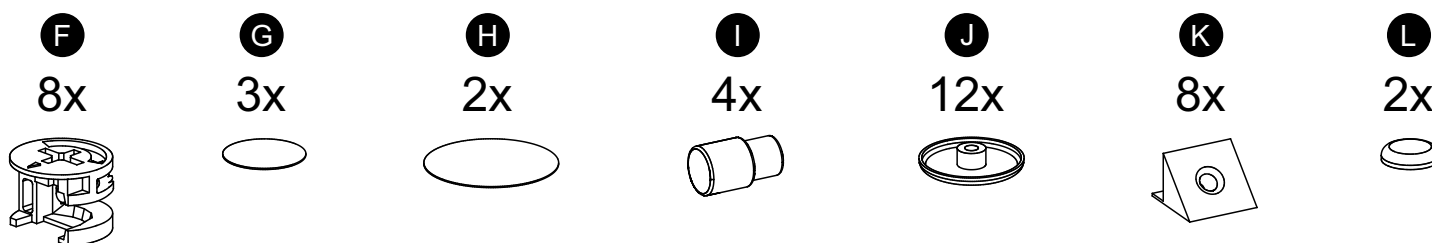
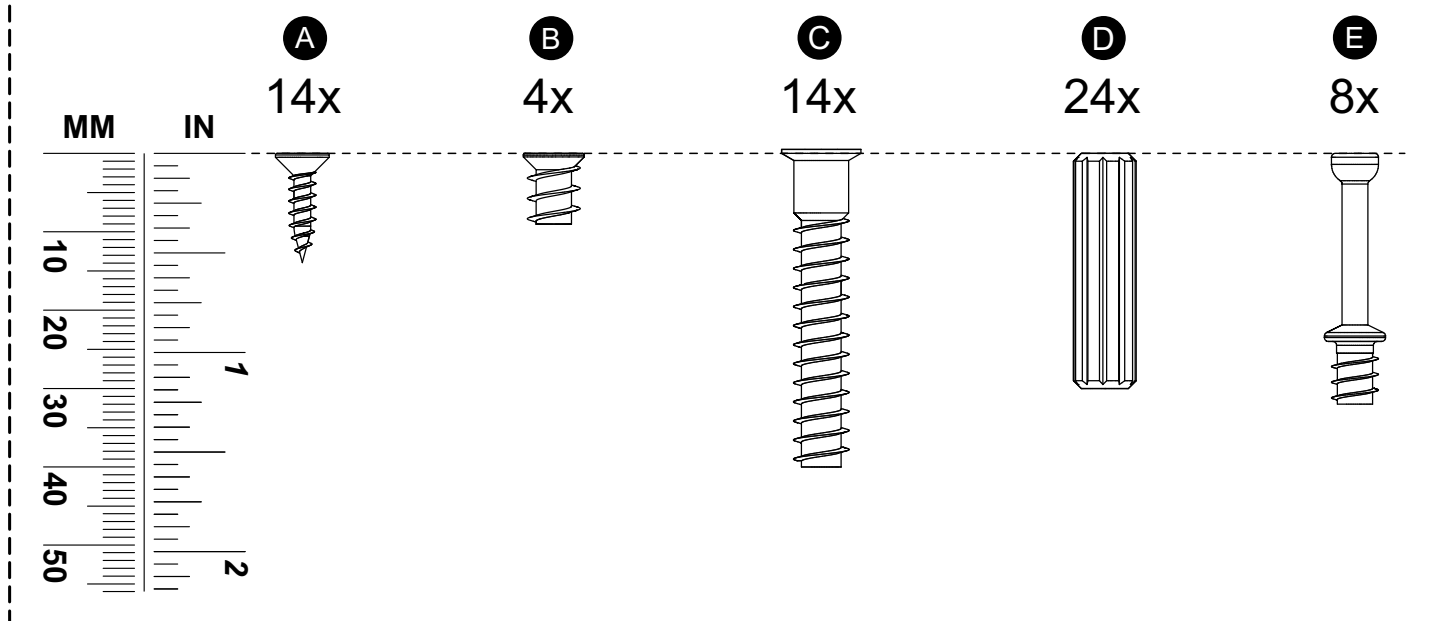
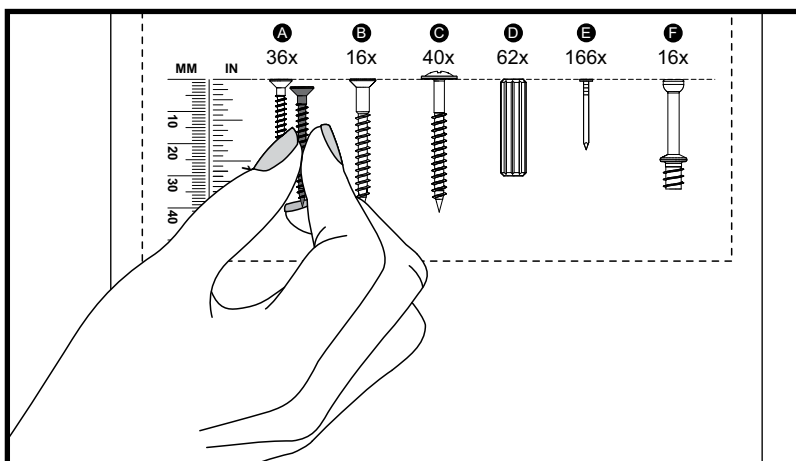

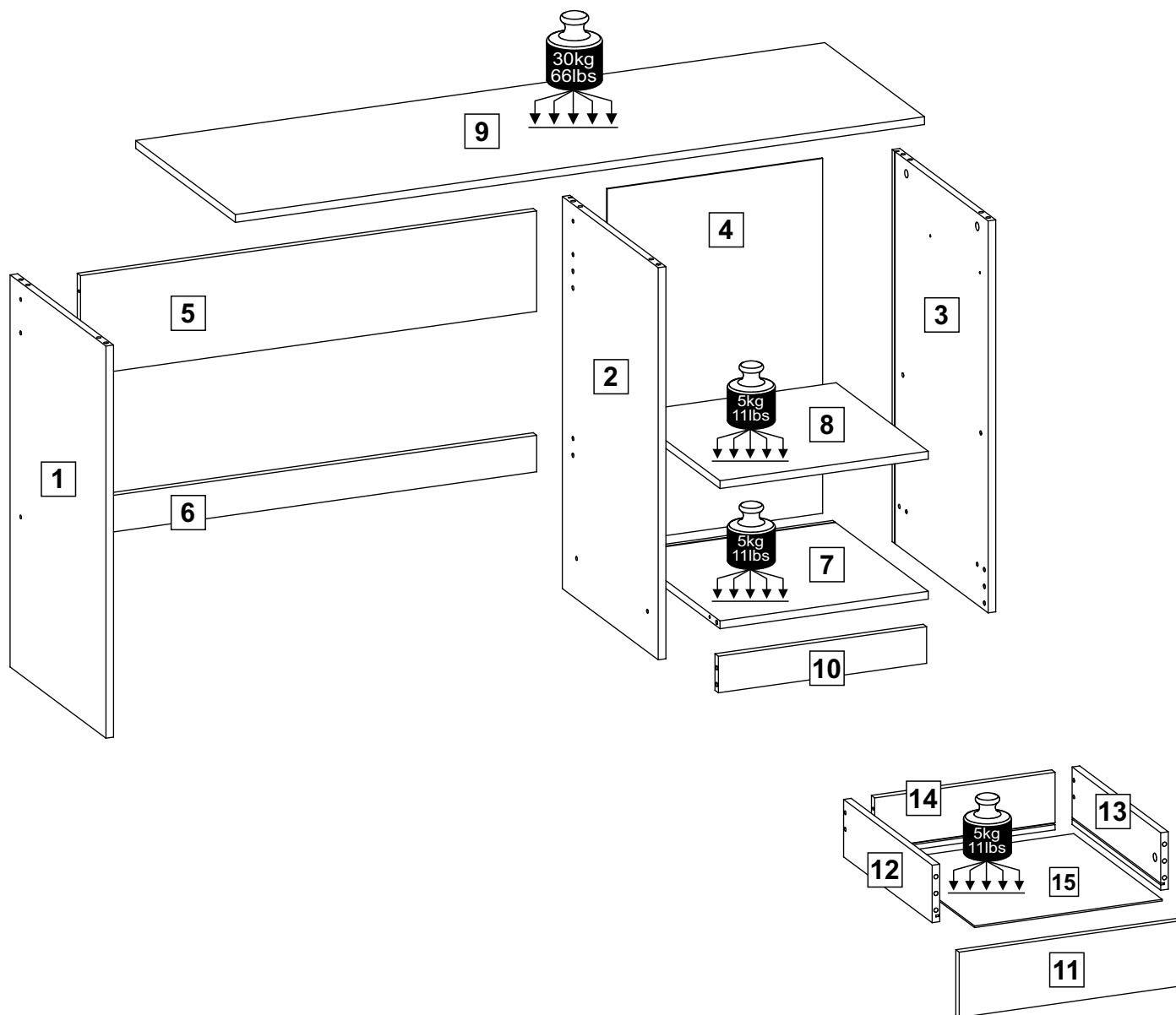

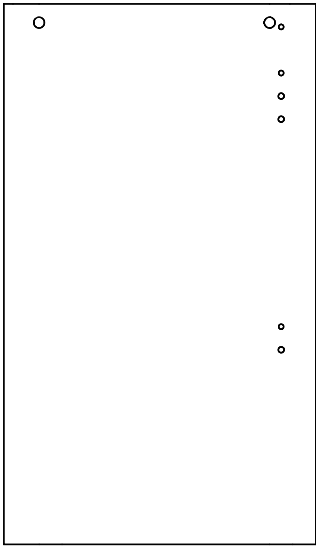

**1** (433 x 750 mm)  
(17,05 x 29,53 in)

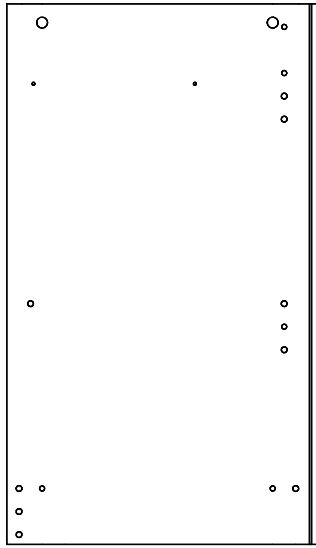

**2** (433 x 750 mm)  
(17,05 x 29,53 in)

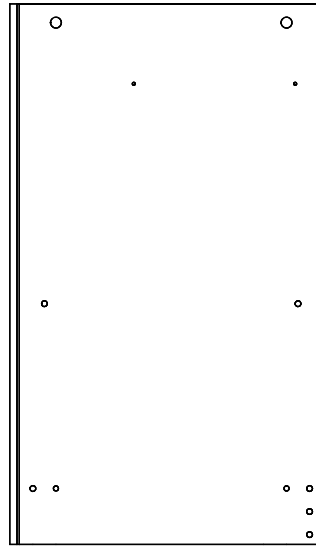

**3** (433 x 750 mm)  
(17,05 x 29,53 in)

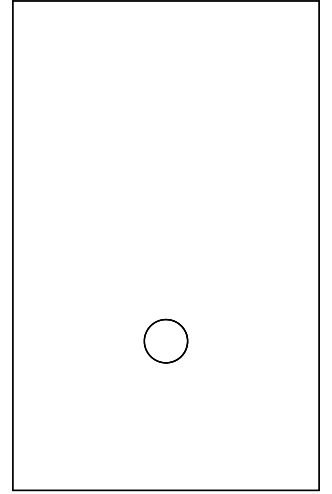

**4** (425 x 679 mm)  
(16,73 x 26,73 in)



**5** (192 x 900 mm)  
(7,56 x 35,43 in)

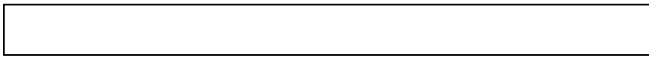

**6** (70 x 900 mm)  
(2,76 x 35,43 in)

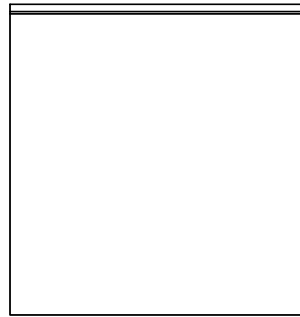

**7** (431 x 411 mm)  
(16,97 x 16,18 in)

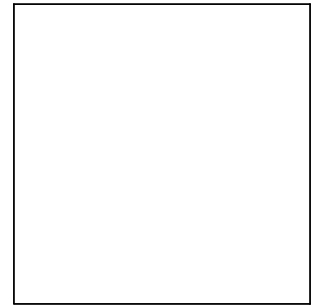

**8** (416 x 411 mm)  
(16,38 x 16,18 in)



**9** (452 x 1360 mm)  
(17,80 x 53,54 in)



**10** (70 x 411 mm)  
(2,76 x 16,18 in)

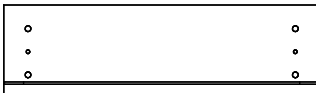

**11** (125 x 438 mm)  
(4,92 x 17,24 in)

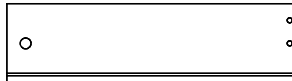

**12** (110 x 400 mm)  
(4,33 x 15,75 in)

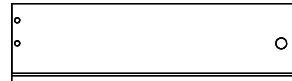

**13** (110 x 400 mm)  
(4,33 x 15,75 in)

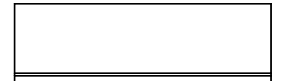

**14** (110 x 356 mm)  
(4,33 x 14,02 in)

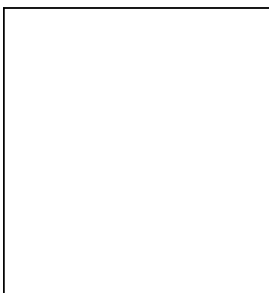

**15** (370 x 399 mm)  
(14,57 x 15,71 in)

**ATTENTION - AVERTISSEMENT - ACHTUNG - ATENCIÓN - ATENÇÃO - ATTENZIONE**

Assemble the furniture on a clean and flat surface and cover it with the cardboard of the packaging.

Assemblez le meuble sur une surface propre et plane et couvrez-le avec le carton de l'emballage du produit.

Um Beschädigungen zu vermeiden, montieren Sie den Artikel auf einer weichen, sauberen Unterlage.  
Tipp: Legen Sie den Artikel auf dem Verpackungskarton.

Montar el mueble sobre una superficie limpia y plana y cubrirlo con el cartón del embalaje del producto.

Montar o móvel sobre uma superfície limpa e plana e forrá-la com o papelão da embalagem do produto.

Montare il mobile su una superficie pulita e piana e rivestirla con il cartone d'imballaggio del prodotto.

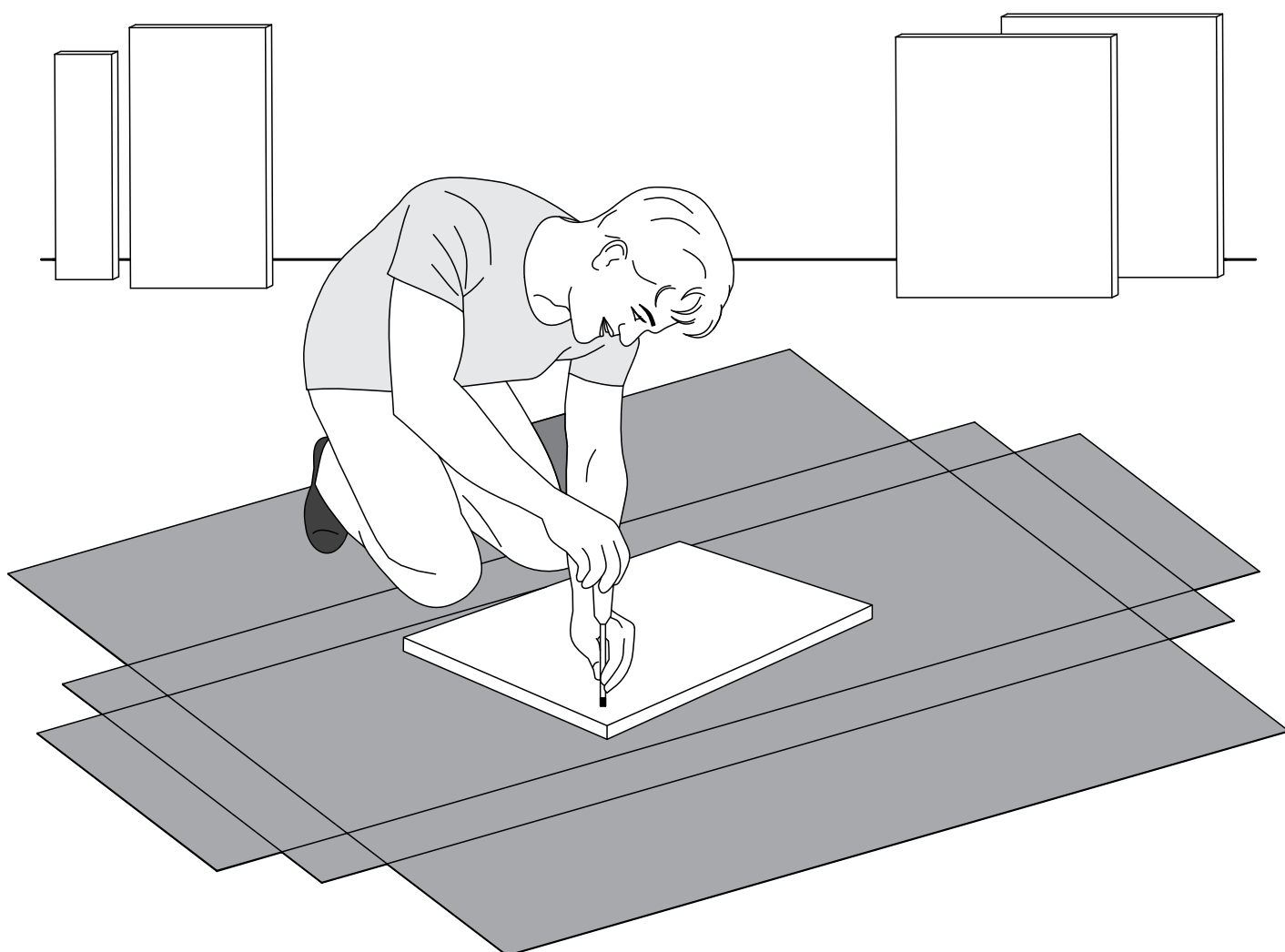
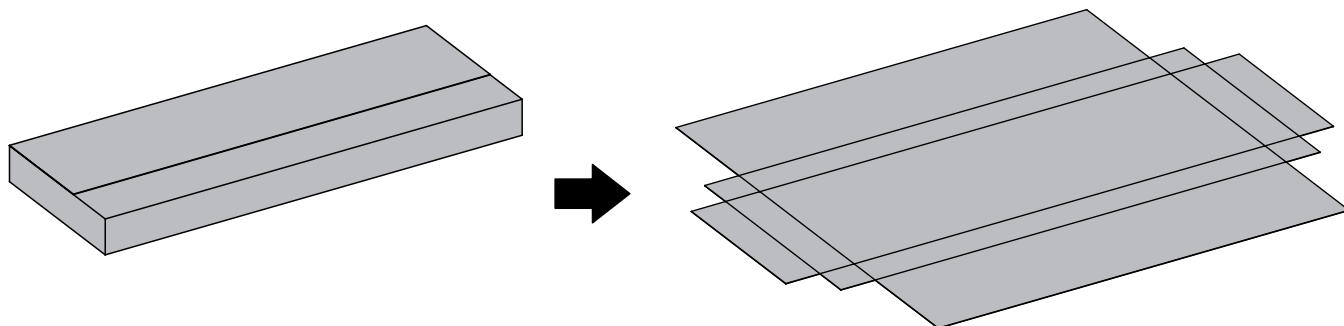

# 1

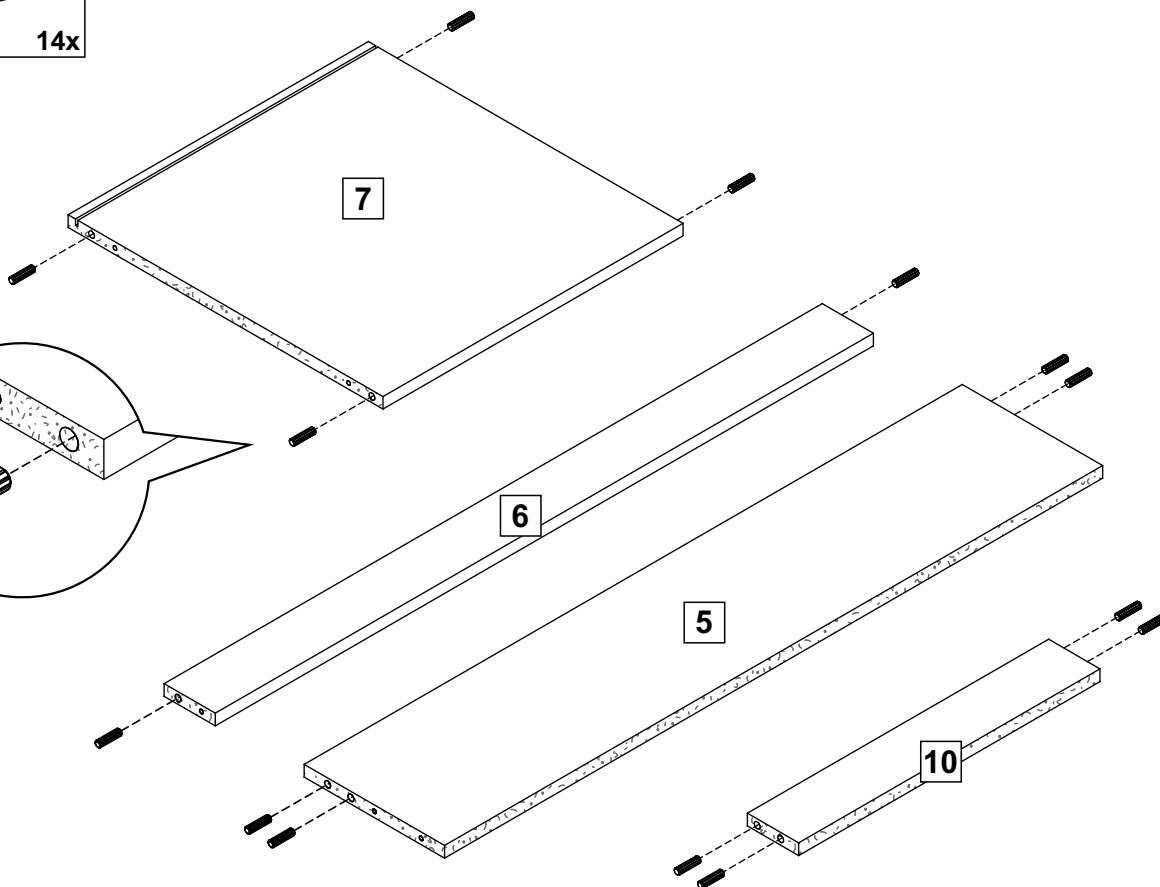
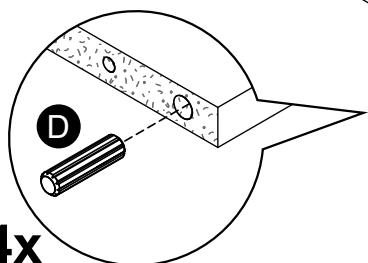
**D****14x****14x**

# 2

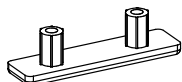
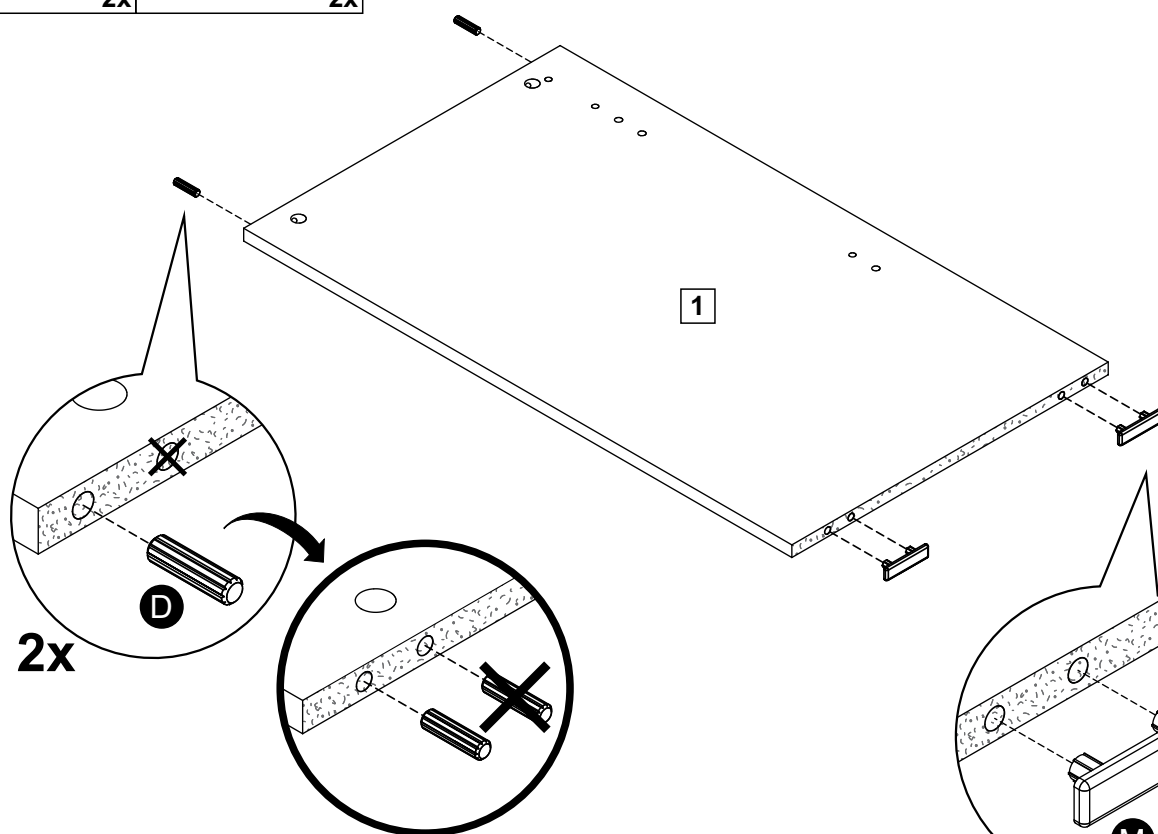
**D****2x****M****2x****2x****2x****M**

# 3

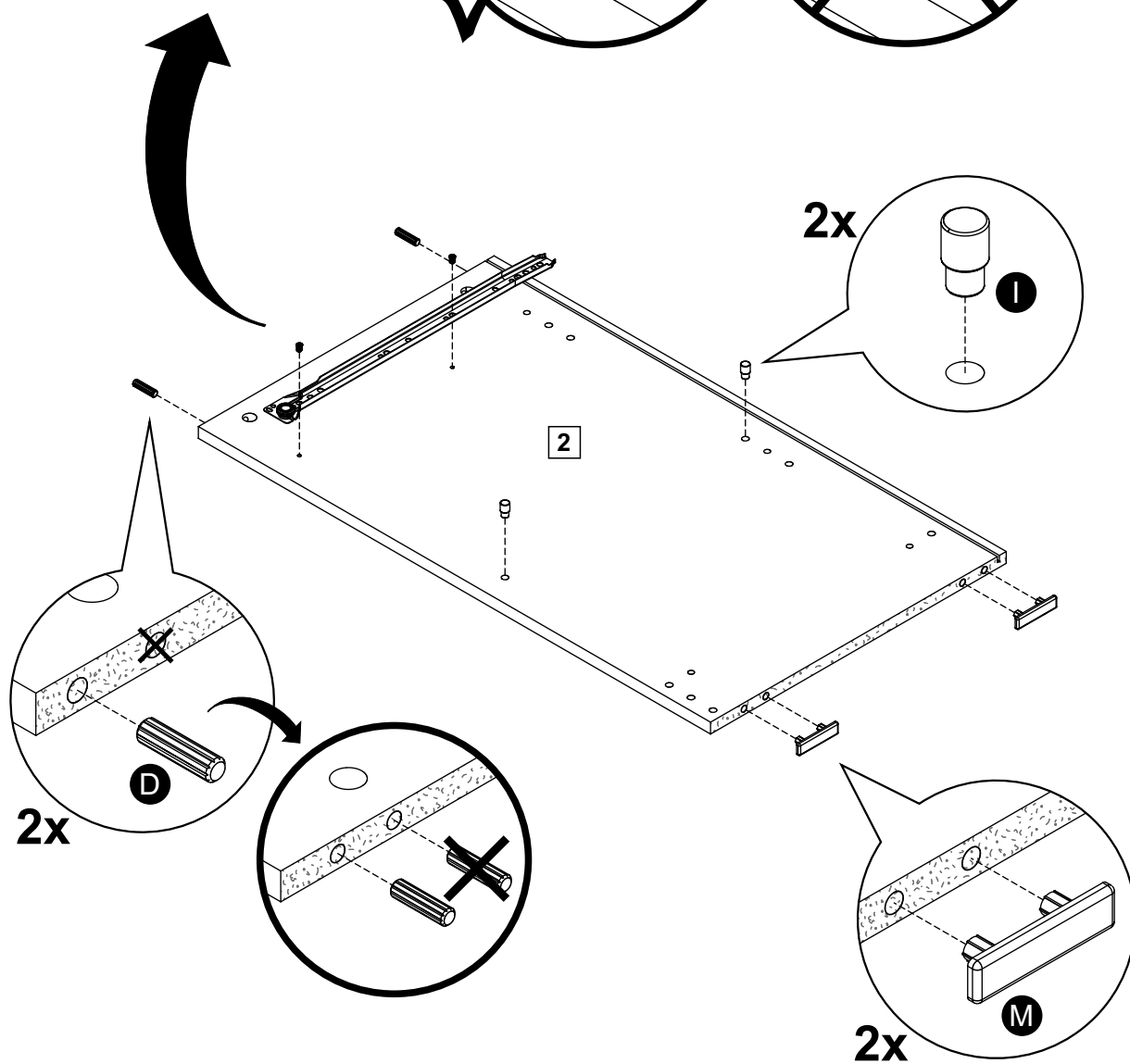
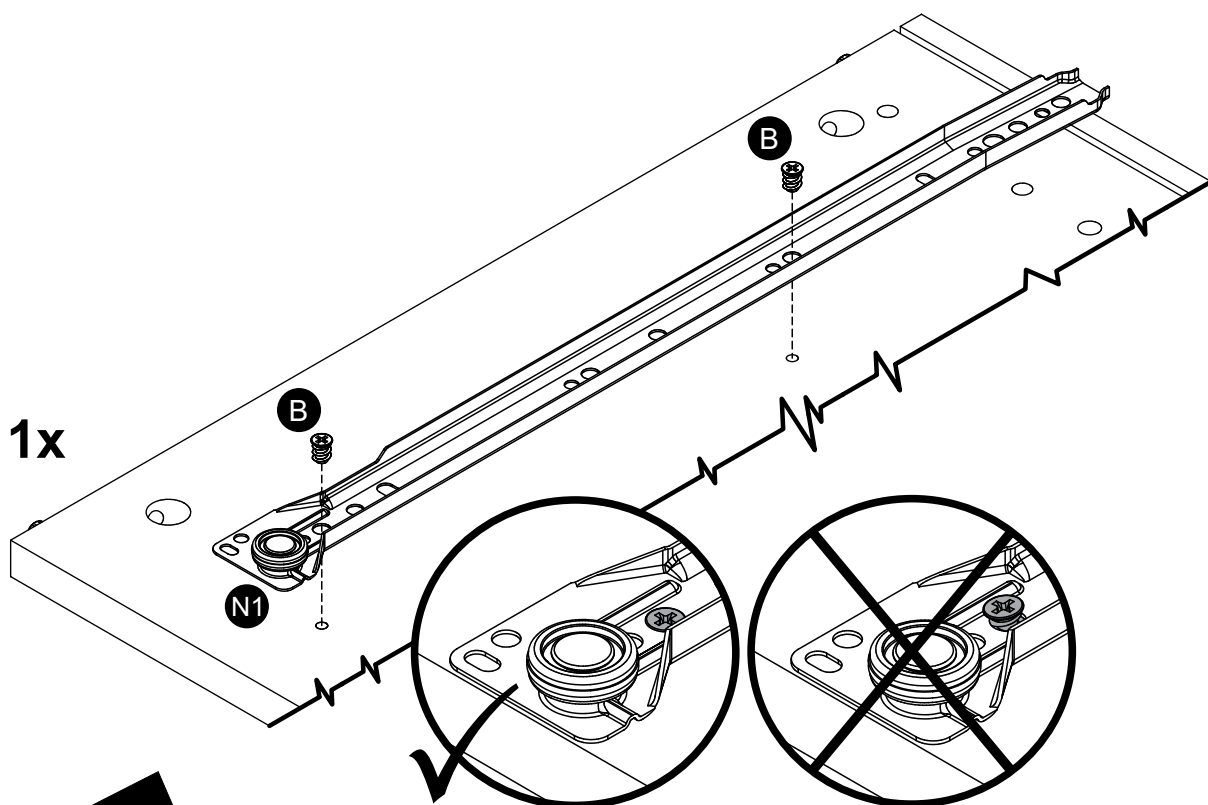
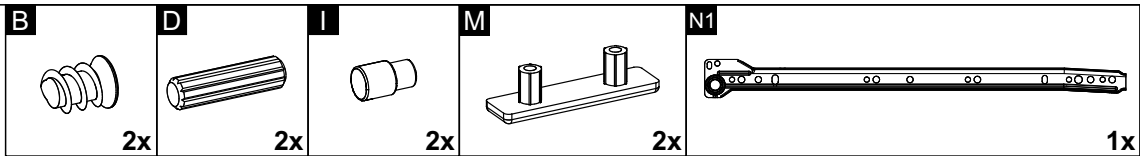



# 4

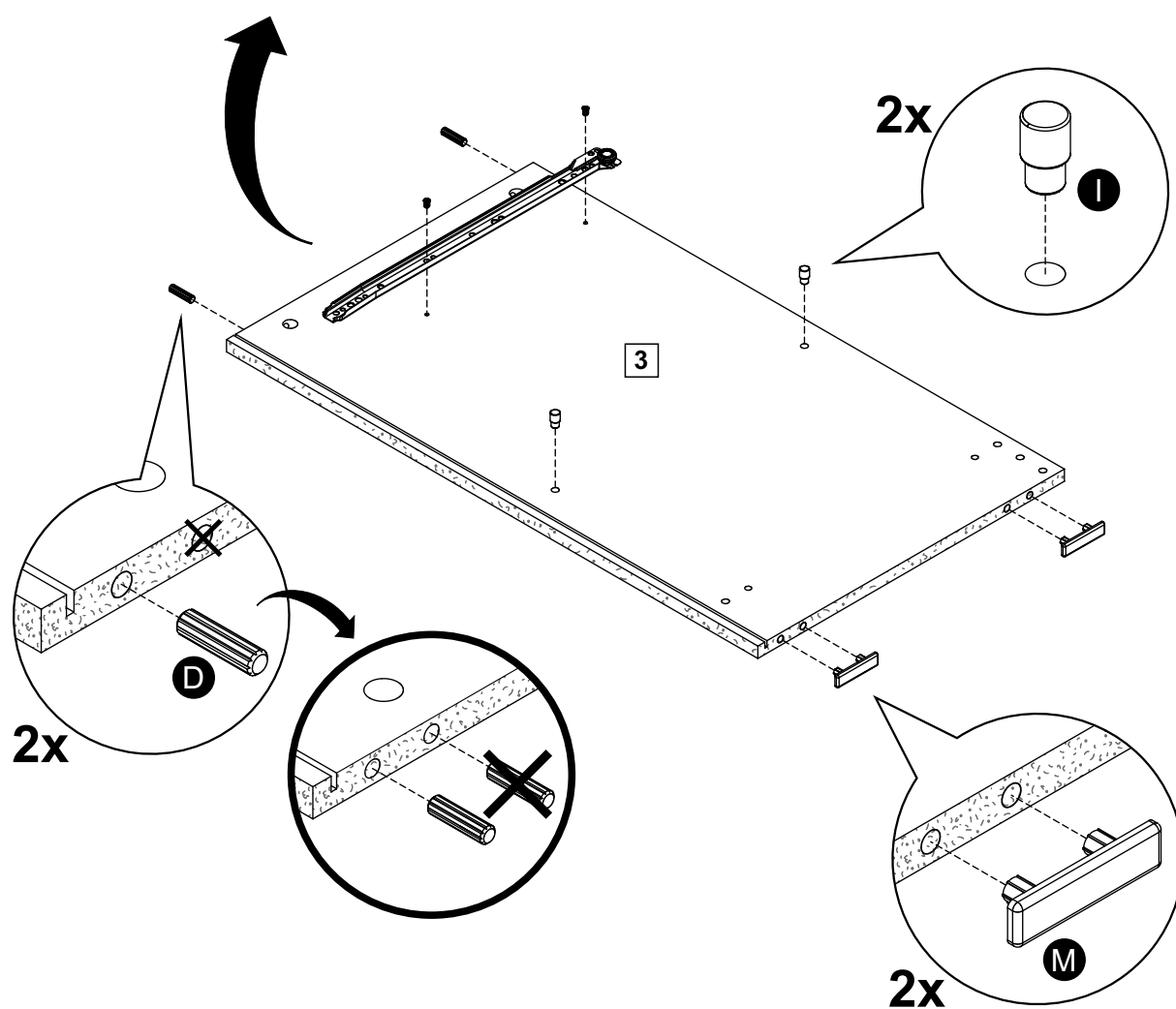
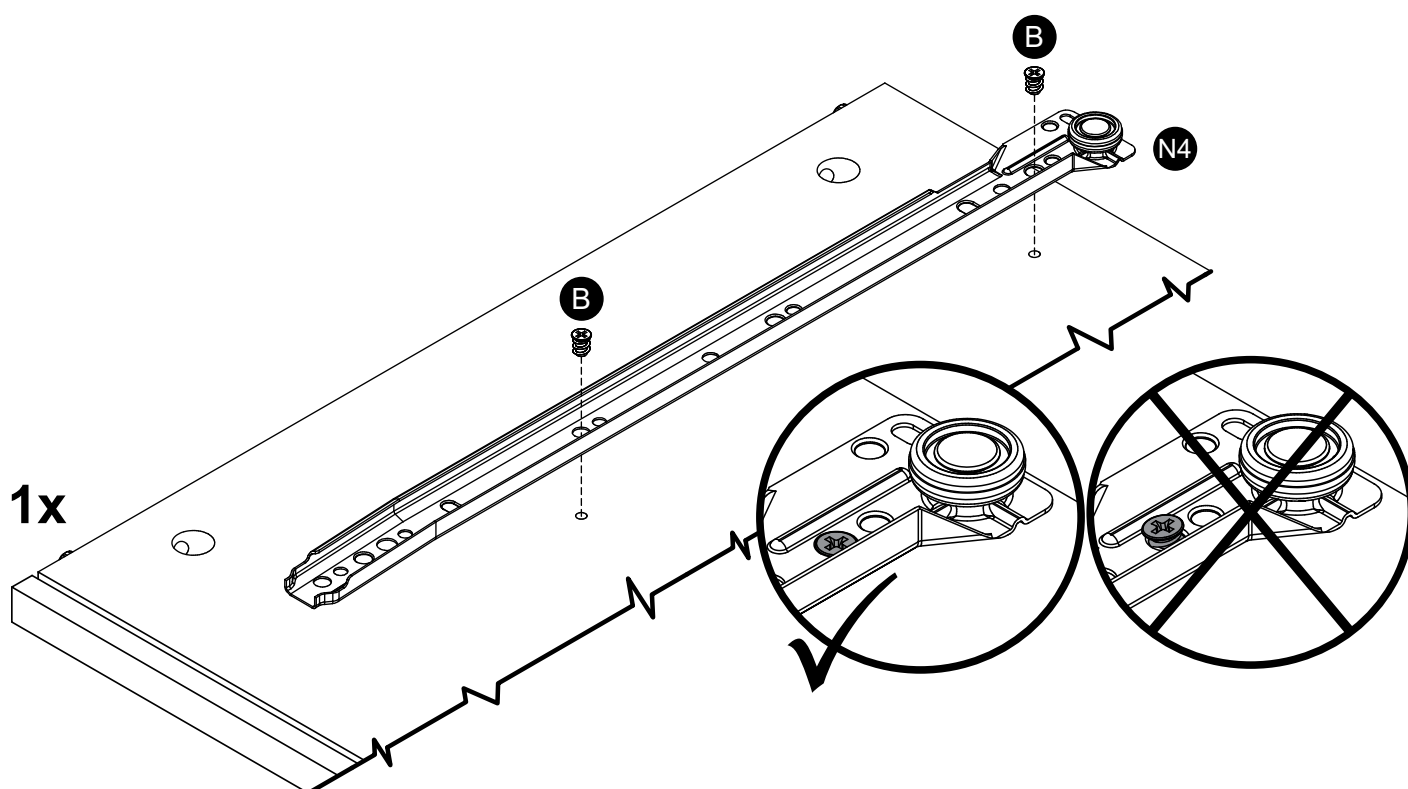
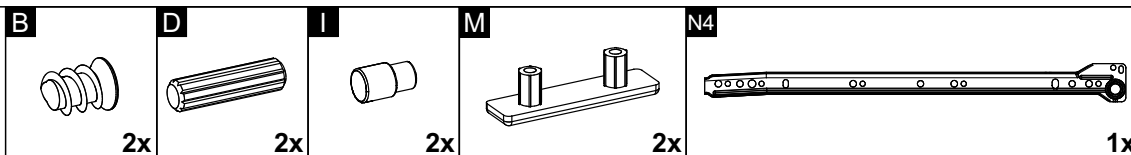

# 5

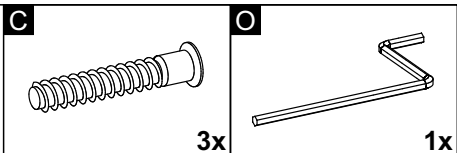

ATTENTION - AVERTISSEMENT - ACHTUNG - ATENCIÓN - ATENÇÃO - ATTENZIONE

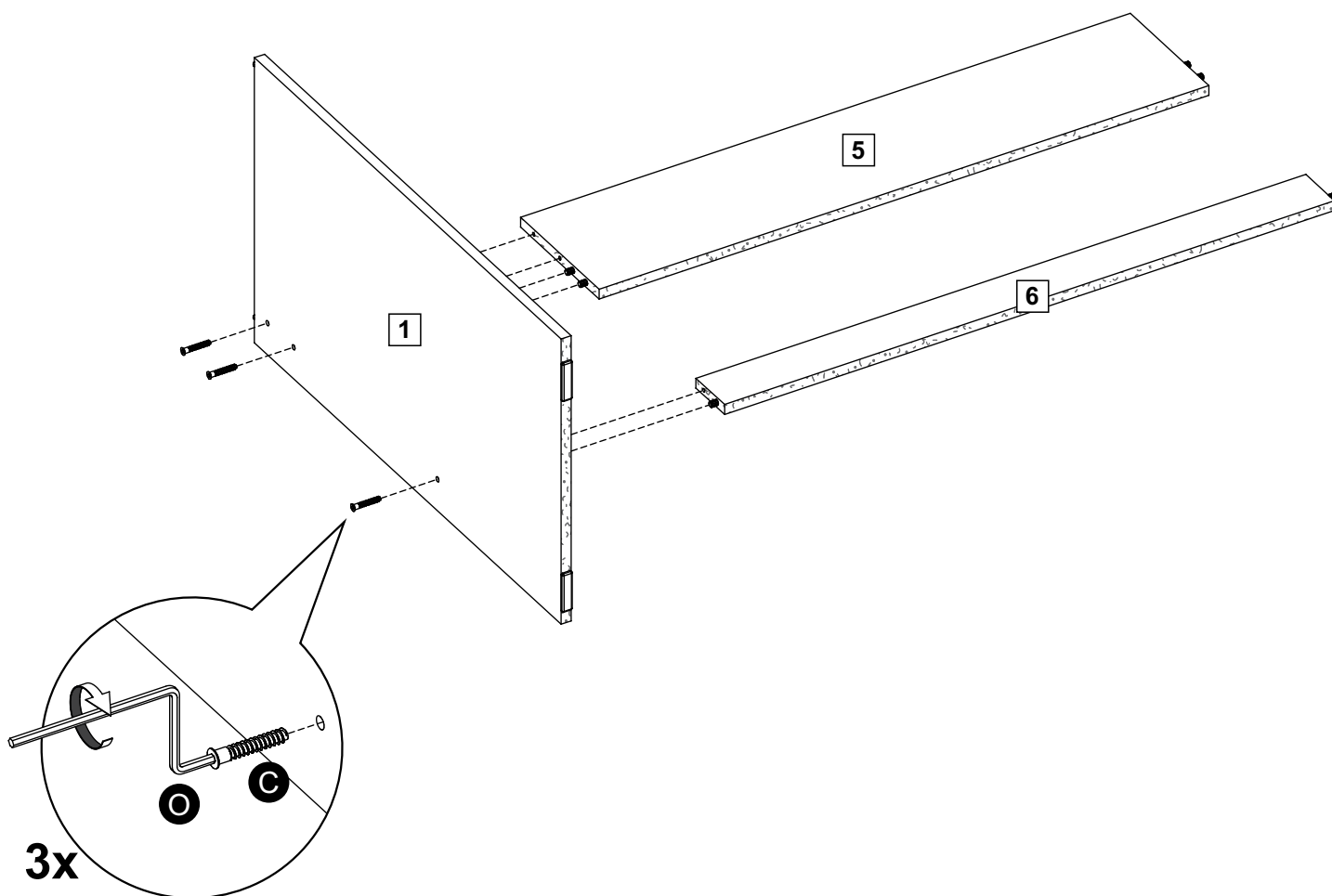
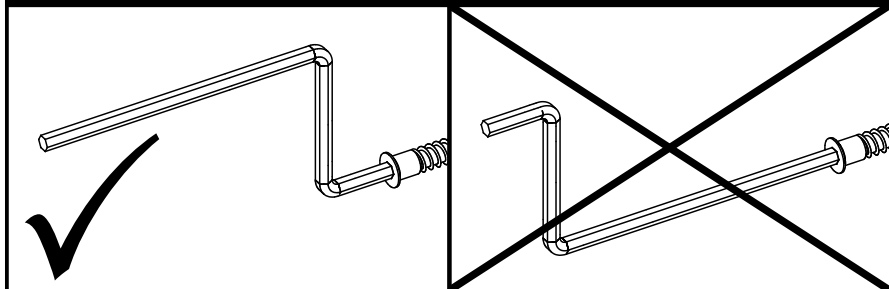

# 6

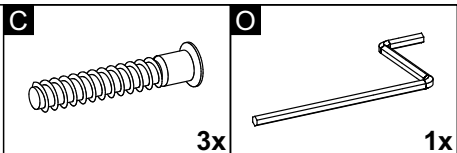

ATTENTION - AVERTISSEMENT - ACHTUNG - ATENCIÓN - ATENÇÃO - ATTENZIONE

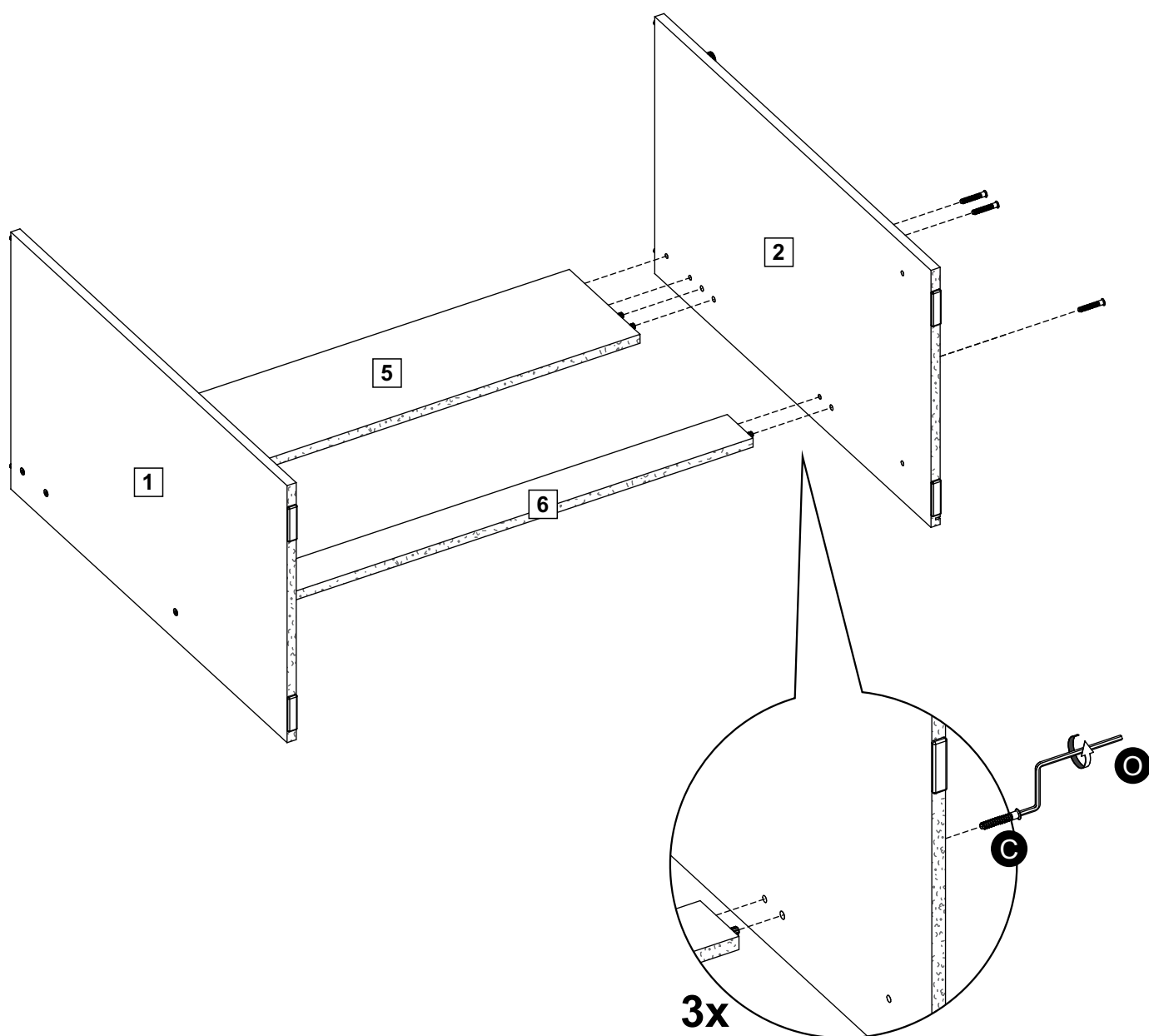
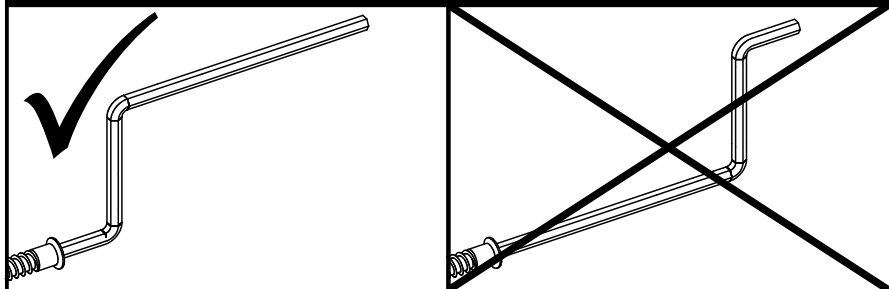

# 7

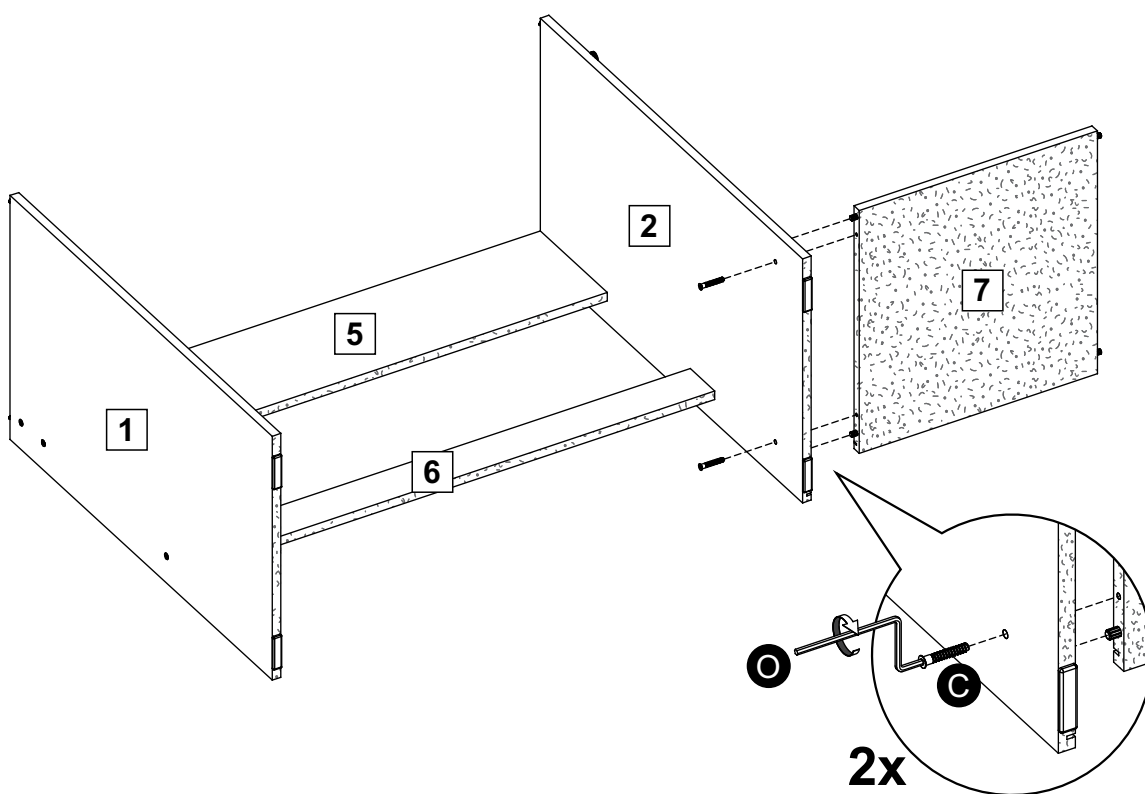
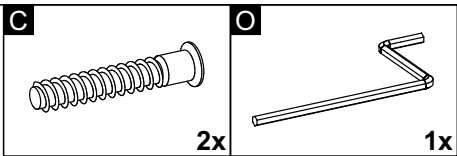

# 8

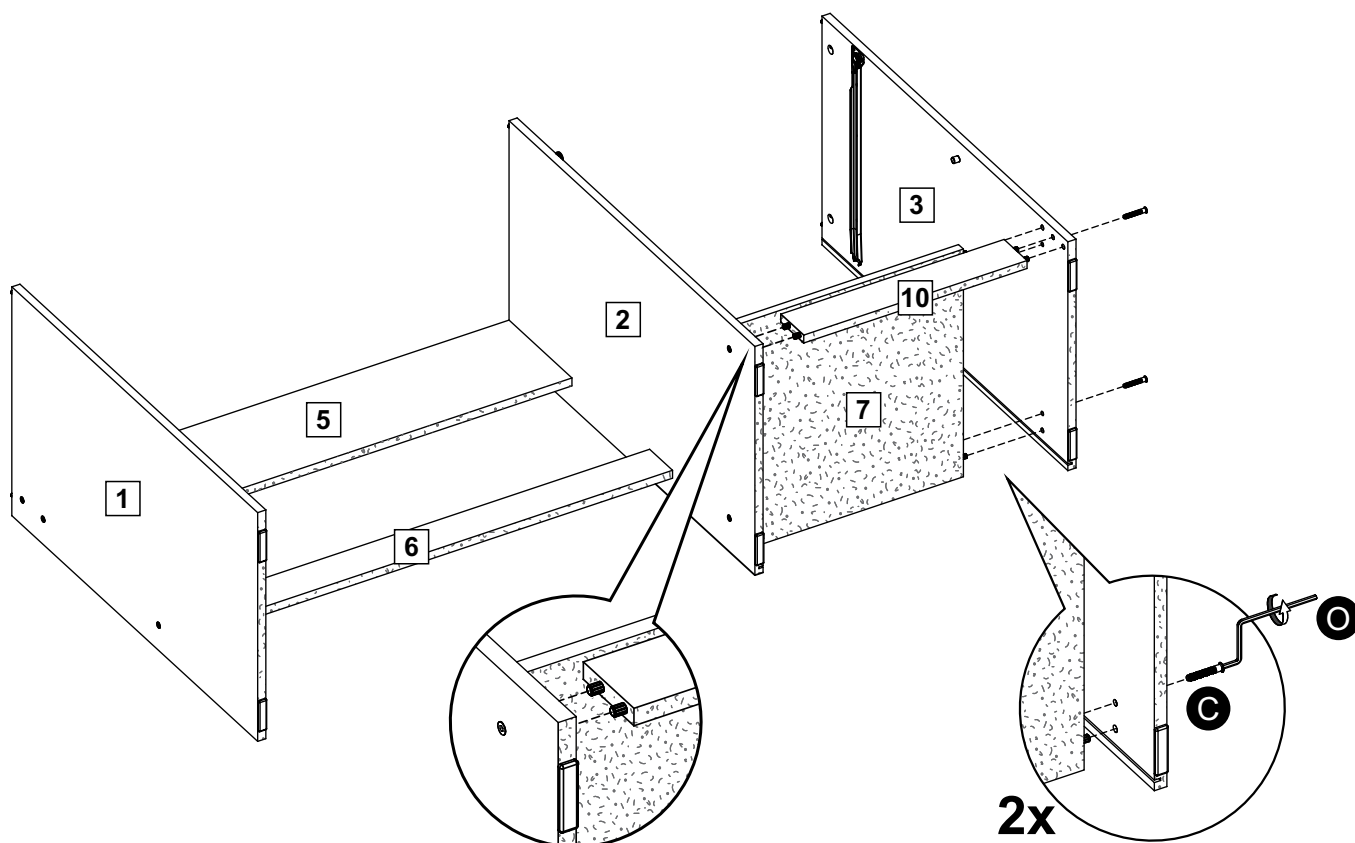
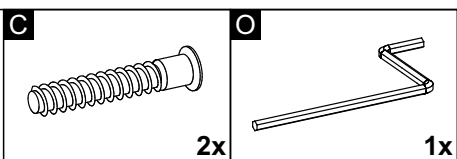

# 9

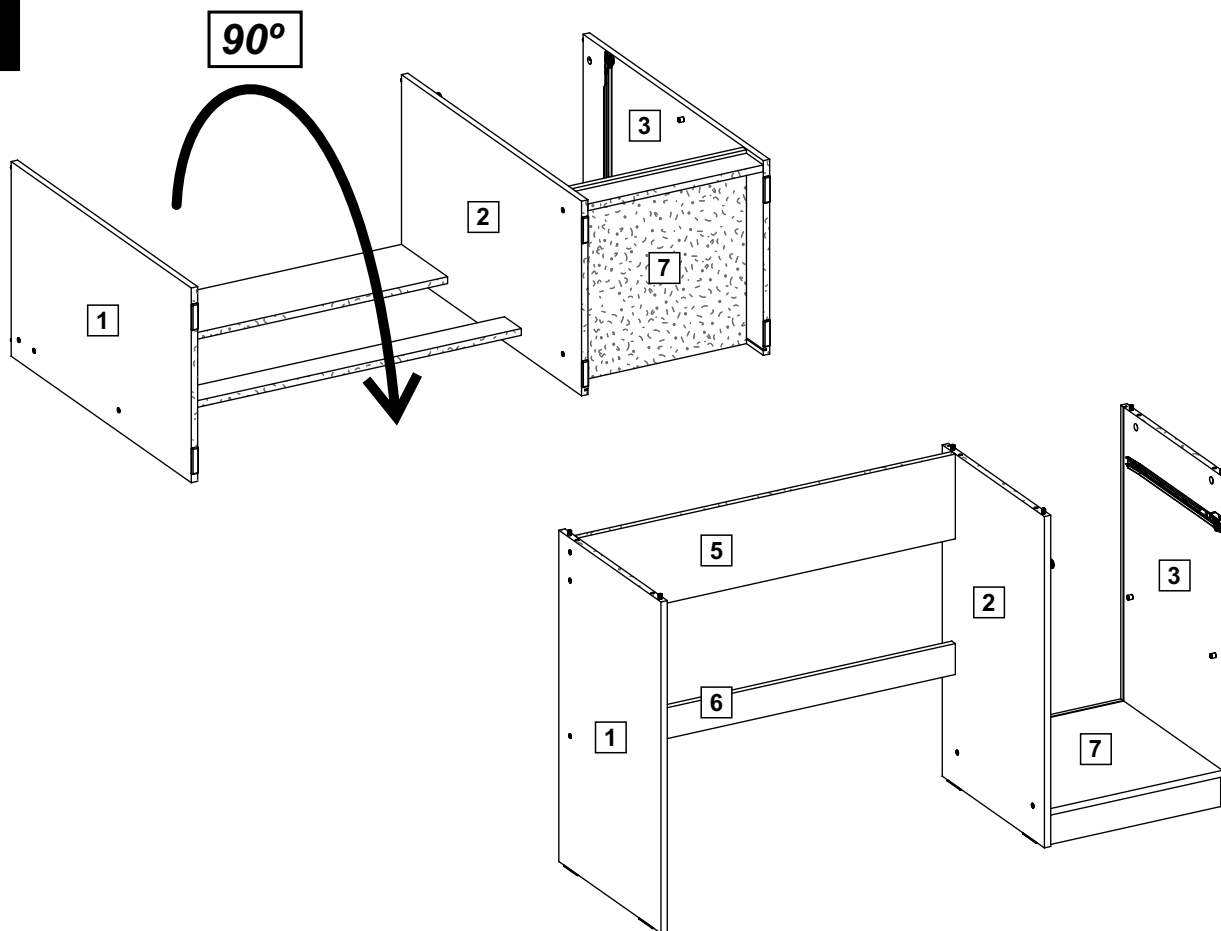

# 10

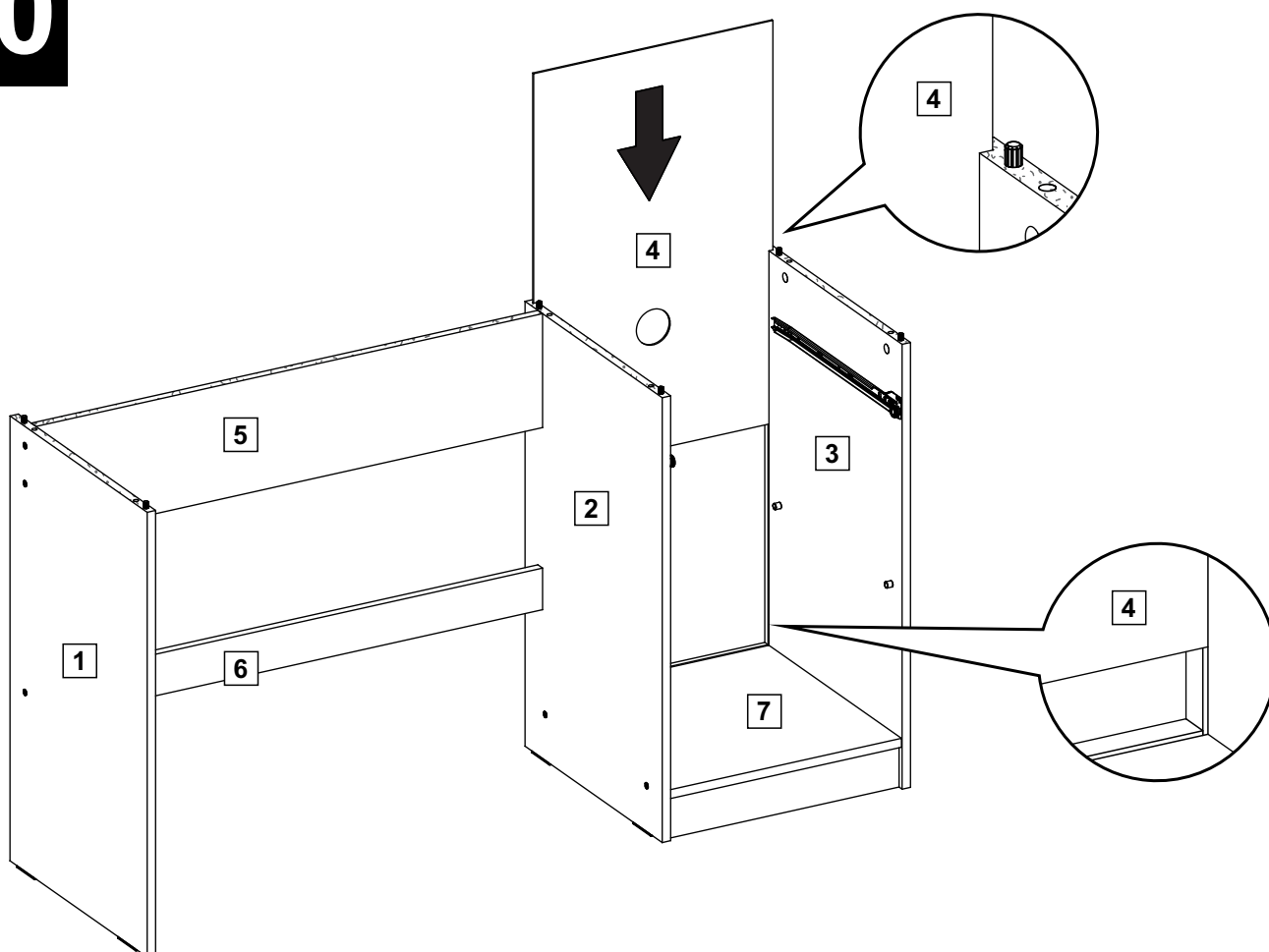

# 11

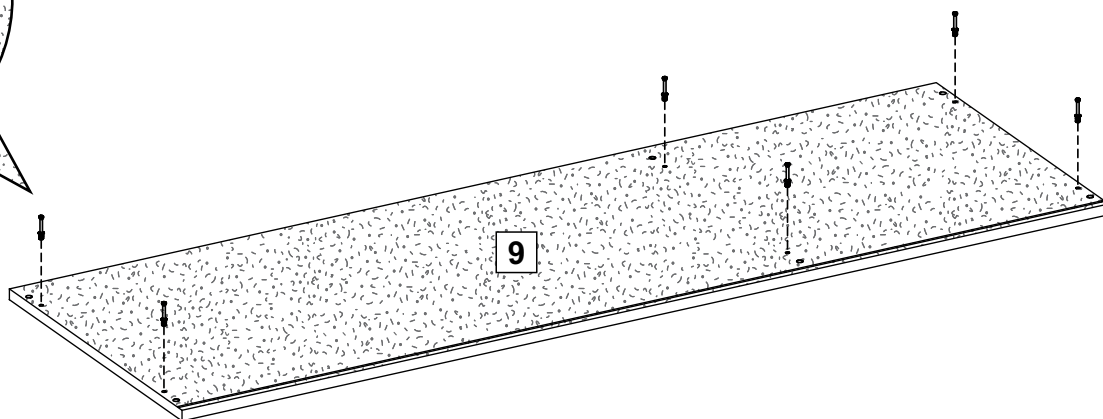
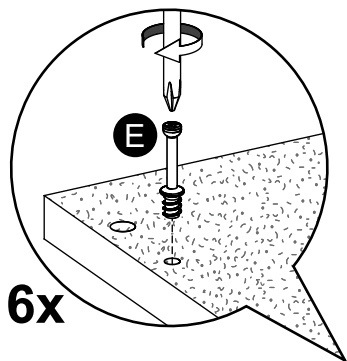
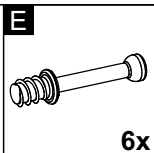

# 12

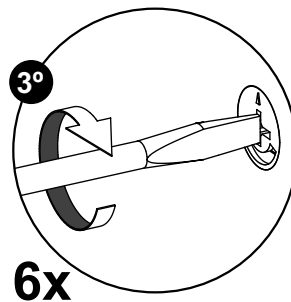
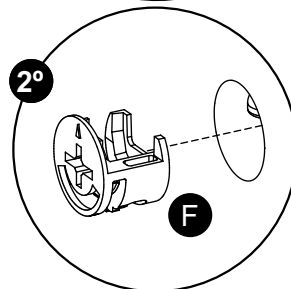
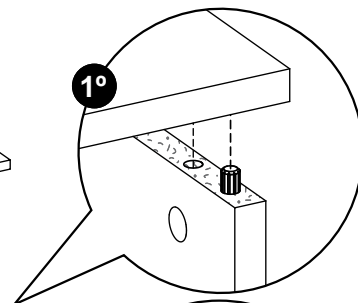
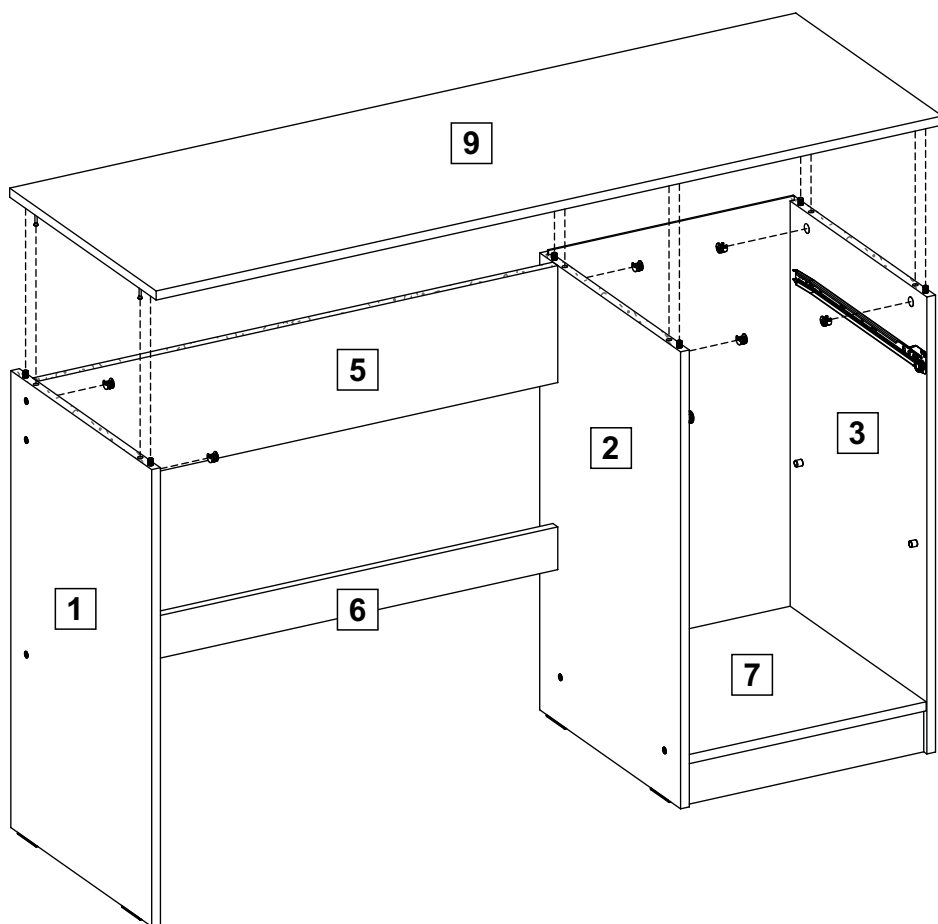
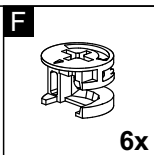

# 13

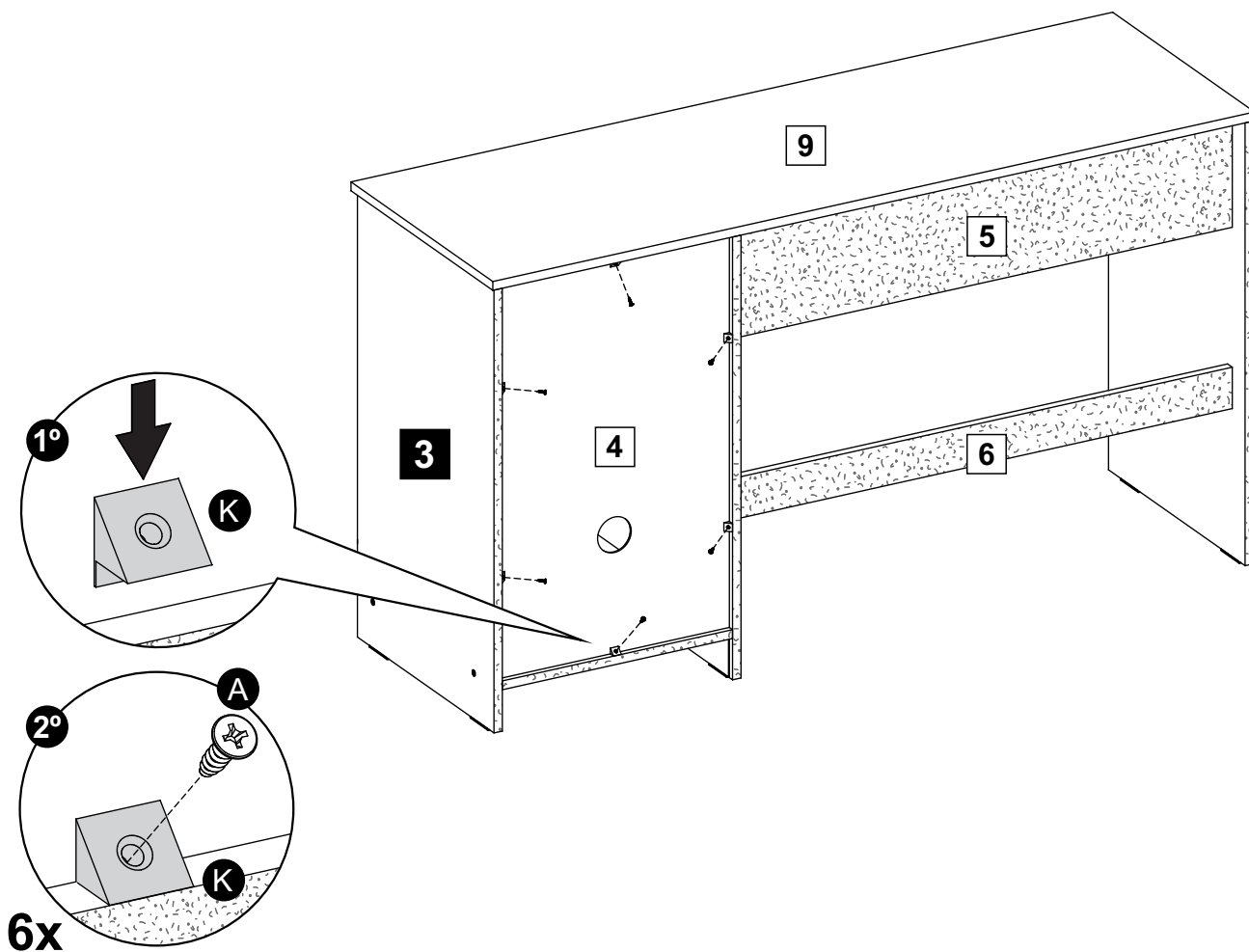
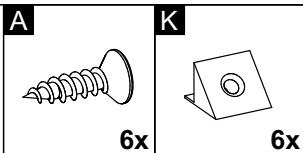

# 14

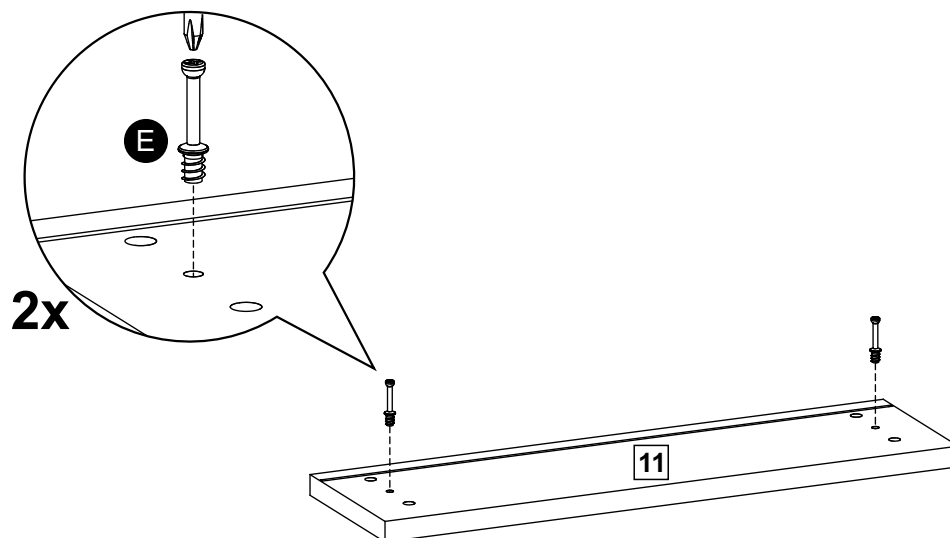
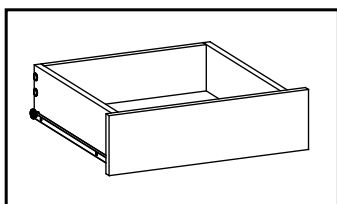
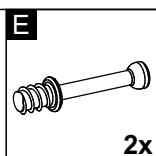

# 15

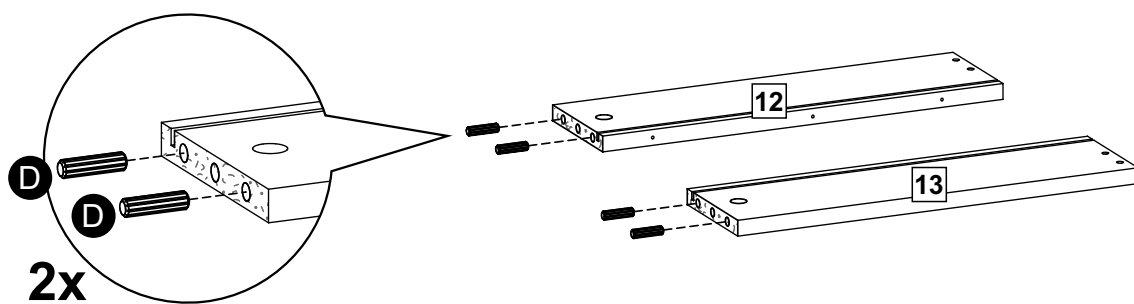
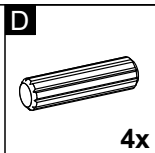

# 16

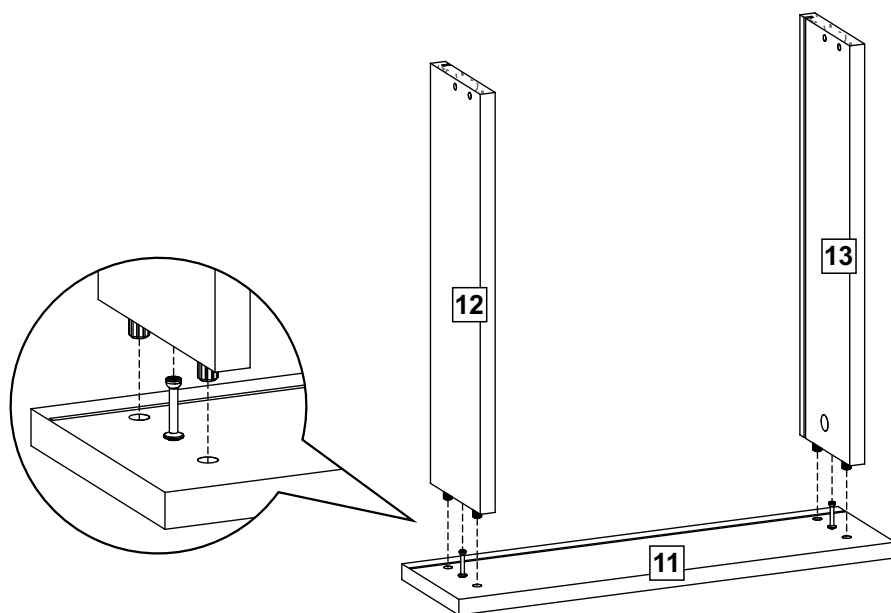

# 17

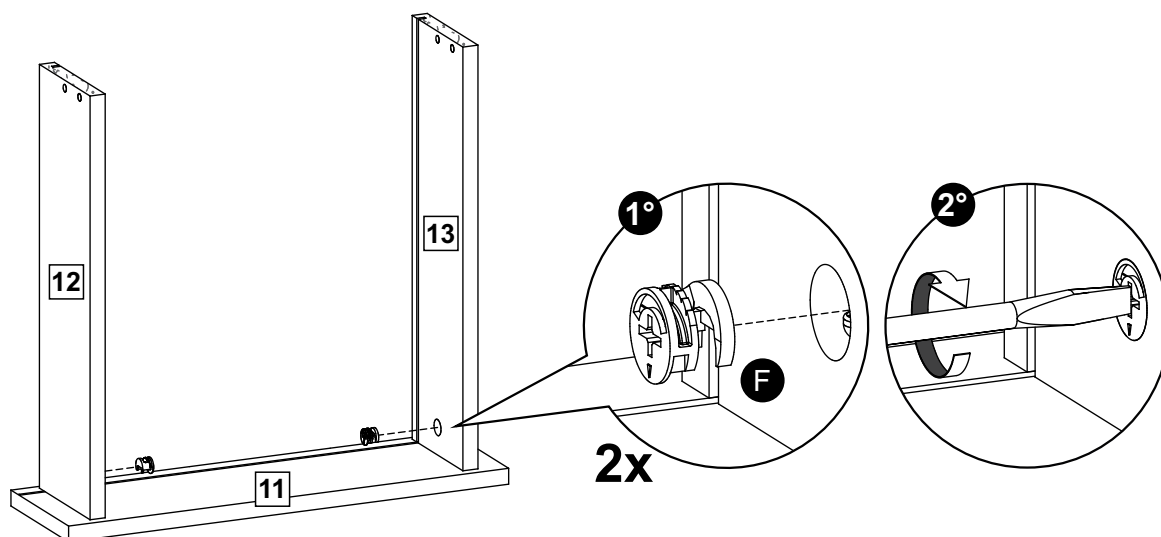
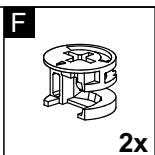



# 18

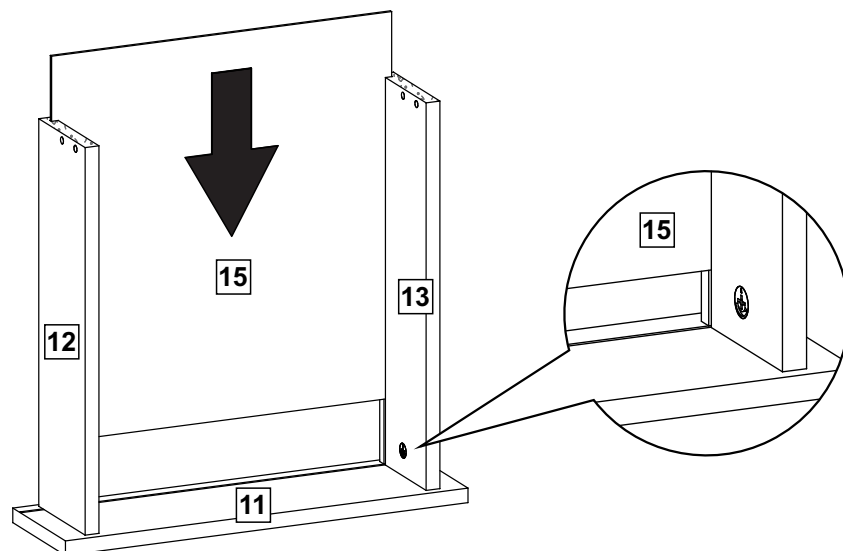

# 19

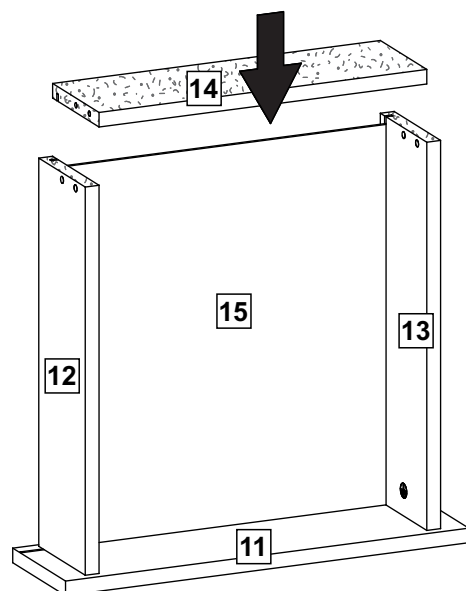

# 20

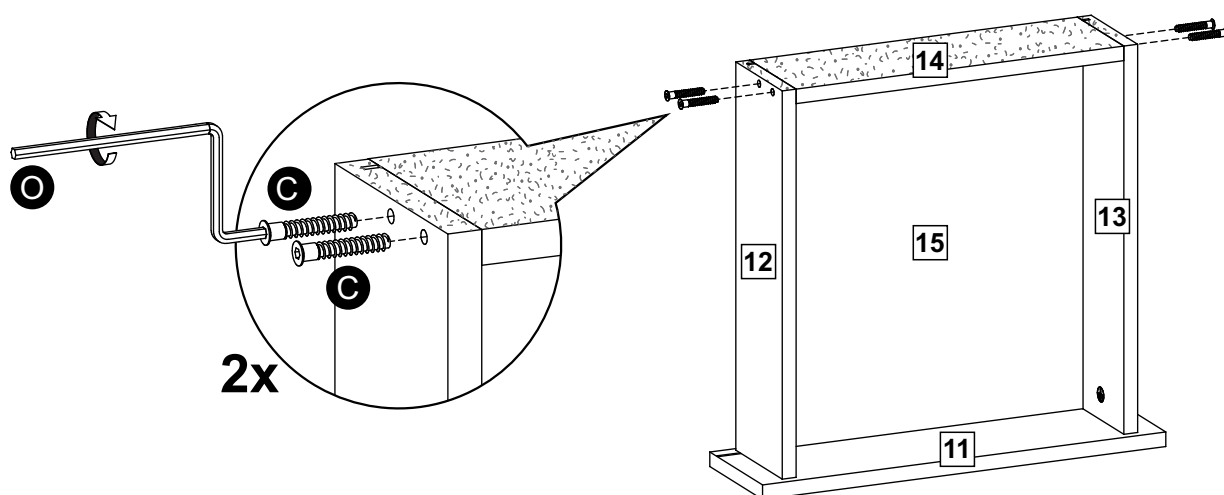
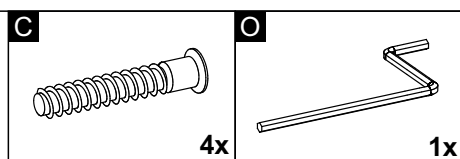

# 21

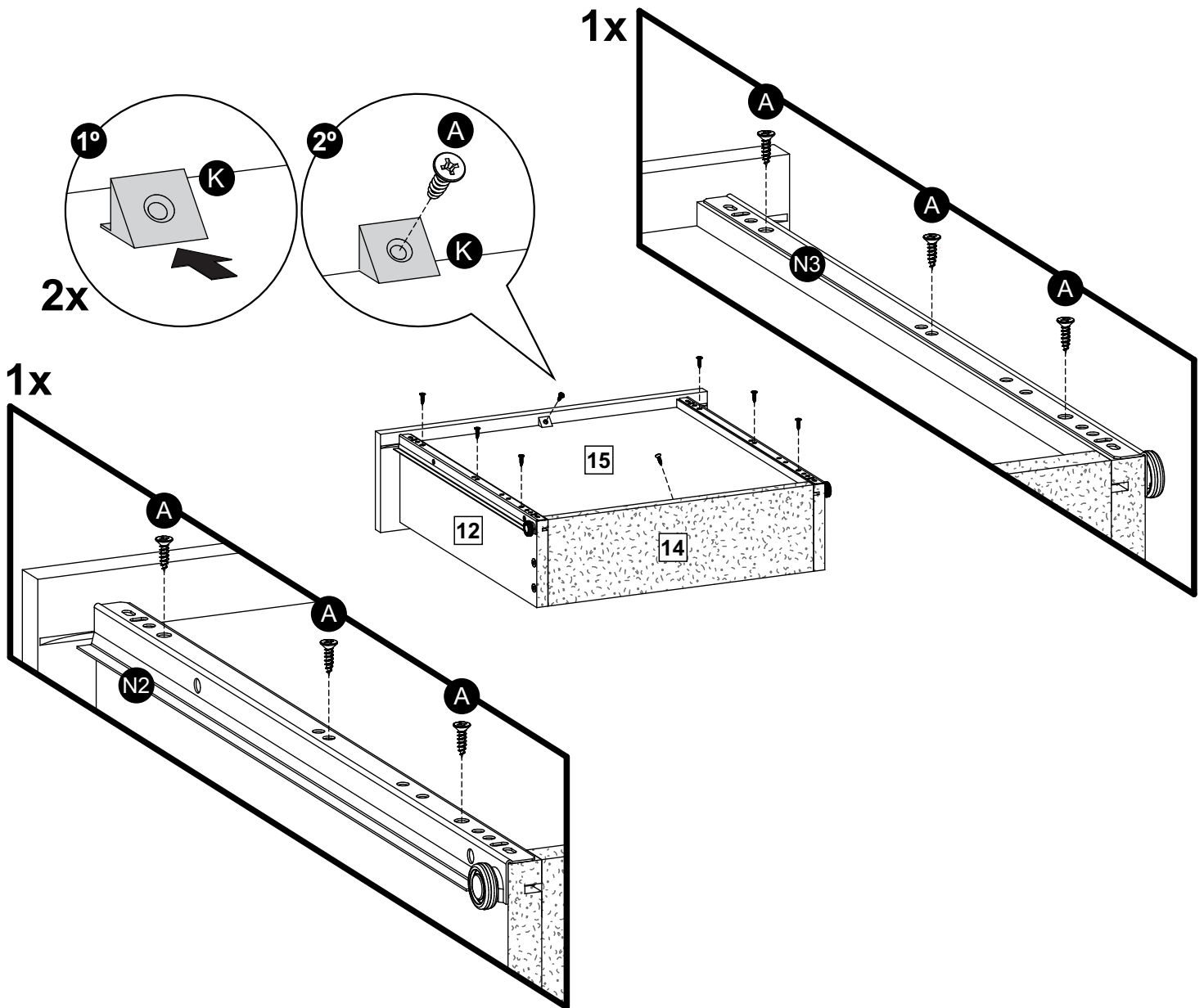
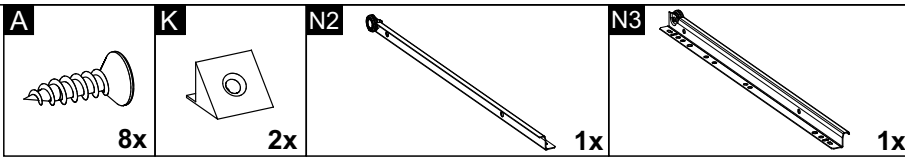

# 22

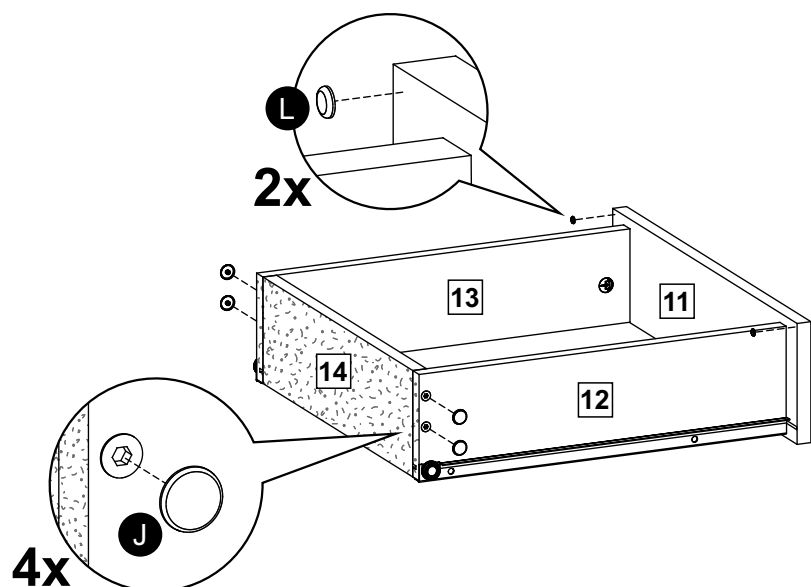
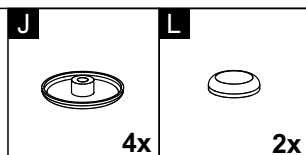

# 23

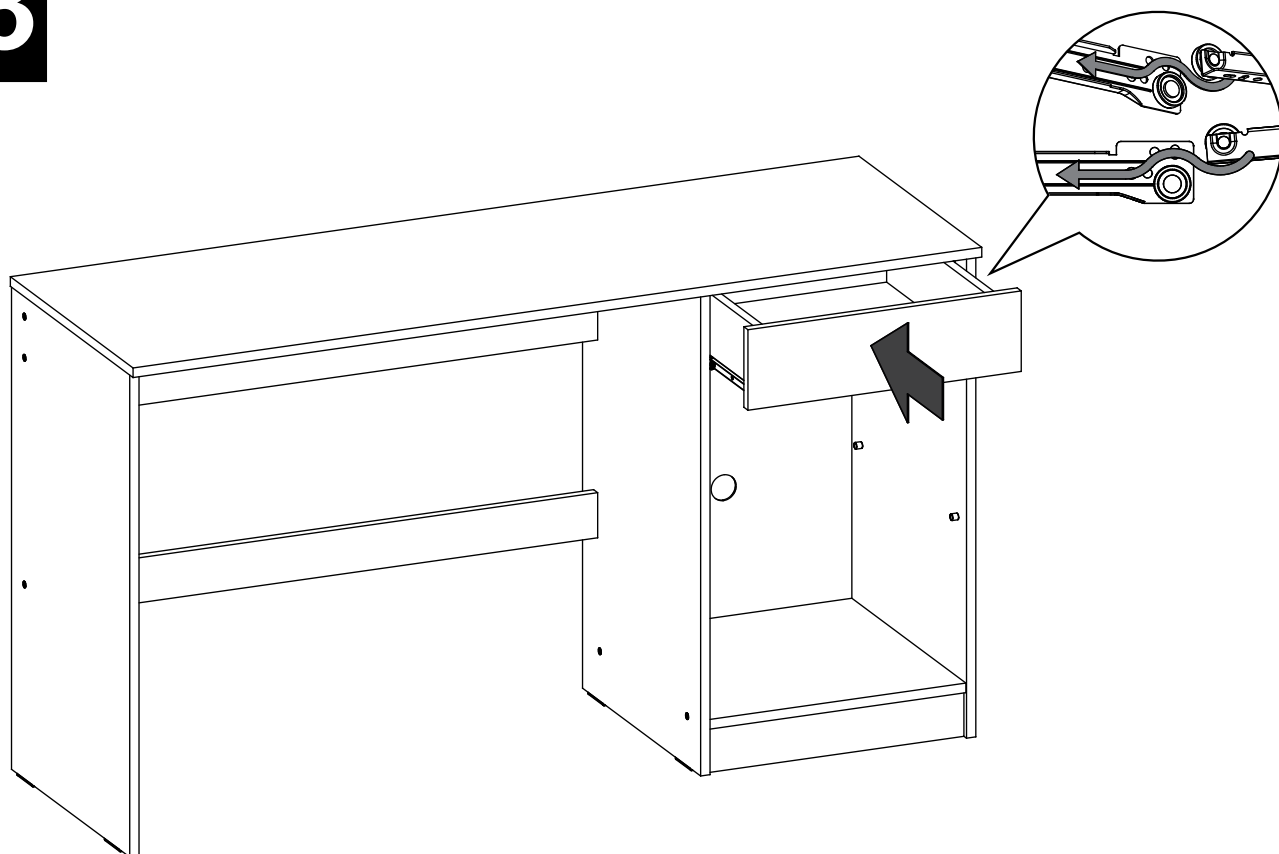

# 24

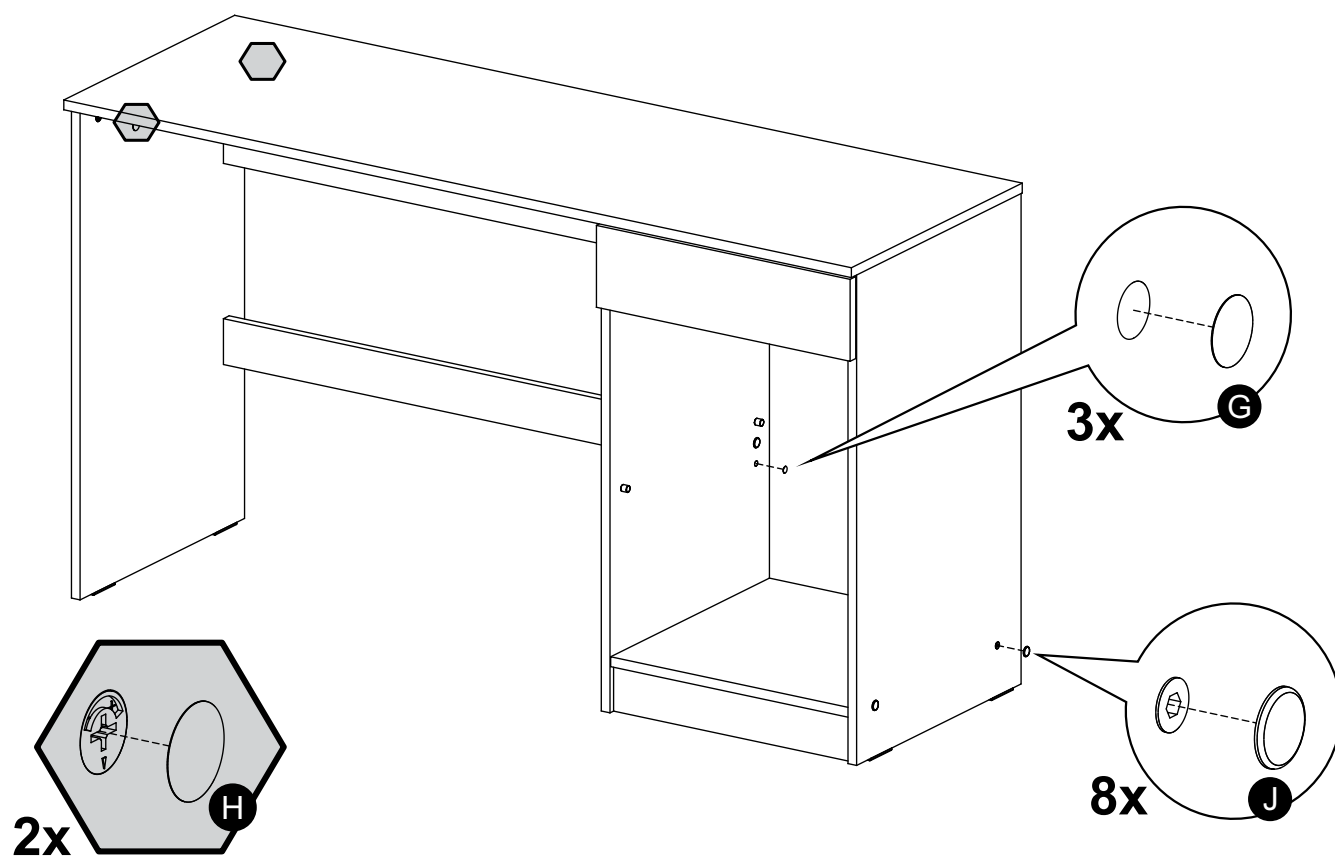
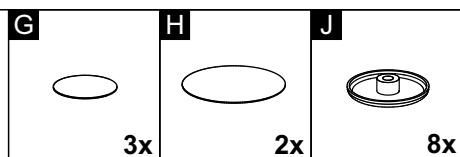

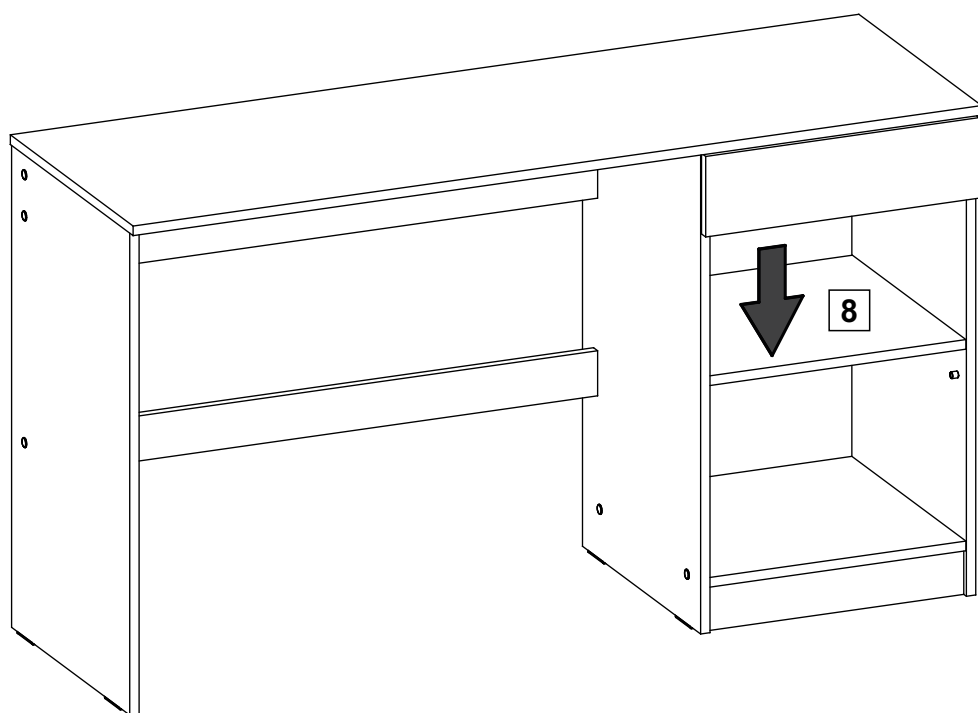

IT	DESCRIPTION / DESCRIÇÃO	THICK ESP	WIDTH LAR	LENGHT COMP	QTY QTD	9401091CF	94018N1CF	9401921CF
1	LEFT SIDE PANEL - LATERAL ESQUERDA	15	433	750	1	2034940109C8	203494018NC8	2034940192C8
2	RIGHT SIDE PARTITION - DIVISÓRIA DIREITA	15	433	750	1	2034940109C4	203494018NC4	2034940192C4
3	RIGHT SIDE PANEL - LATERAL DIREITA	15	433	750	1	2034940109C7	203494018NC7	2034940192C7
4	BACK PANEL - COSTA	3	425	679	1	2033940109C2	2033940109C2	2033940109C2
5	BEAM - TRAVESSA	15	192	900	1	2034940109C15	203494018NC15	2034940192C15
6	SMALLER BEAM - TRAVESSA MENOR	15	70	900	1	2034940109C16	203494018NC16	2034940192C16
7	BASE - BASE	15	431	411	1	2034940109C1	203494018NC1	2034940192C1
8	SHELF - PRATELEIRA	15	416	411	1	2034940109C11	203494018NC11	2034940192C11
9	TOP PANEL - TAMPO	15	452	1360	1	2034940109C14	203494018NC14	2034940192C14
10	PLINTH - RODAPÉ	15	70	411	1	2034940109C12	203494018NC12	2034940192C12
11	DRAWER FRONT -FRENTE GAVETA	15	125	438	1	2034940109C5	203494018NC5	2034940192C5
12	LEFT SIDE DRAWER -LATERAL GAVETA ESQUERDA	15	110	400	1	2034940109C10	2034940109C10	2034940109C10
13	RIGHT SIDE DRAWER -LATERAL GAVETA DIREITA	15	110	400	1	2034940109C9	2034940109C9	2034940109C9
14	DRAWER BACK -COSTA GAVETA	15	110	356	1	2034940109C3	2034940109C3	2034940109C3
15	DRAWER BASE -FUNDO GAVETA	3	370	399	1	2033940109C6	2033940109C6	2033940109C6
A	3,5x14 CC SCREW -PARAFUSO 3,5x14 CC				14		2065351420028	
B	6x10 EURO CC SCREW -PARAFUSO 6x10 EURO CC				4		2065601000024	
C	7x40mm CC10mm FSI SCREW -PARAFUSO 7x40mm CC10mm FSI				14		2065140800017	
D	8x30mm DOWEL - CAVILHA 8x30mm				24		2080083000010	
E	6x35mm CAM LOCK -MINIFIX PARAFUSO 6x35mm				8		2075063000012	
F	15x12mm CAM NUT -TAMBOR PARA MINIFIX 15x12mm				8		2075151200027	
G	10/13mm SELF ADHESIVE - TAPA FURO ADESIVO 10/13mm				3	2070010090146	2070100012522	2070100010207
H	19mm SELF ADHESIVE - TAPA FURO ADESIVO 19mm				2	2070100090148	2070100012515	2070100010191
I	8x7mm SHELF SUPPORT PIN -SUPORTE PRATELEIRA 8x7mm				4	2070200180206	2070200180343	207020014R343
J	CC10mm PLASTIC CAP -CAPA P/ PARAFUSO CC10mm				8	2070417311004	2070417312001	207041733Z00
	CC10mm PLASTIC CAP DRAWER -CAPA P/ PARAFUSO CC10mm PARA GAVETA				4	2070417311004	2070417311004	2070417311004
K	14x14mm CORNER -CANTONEIRA SUPORTE TRIANGULAR 14x14mm				8		2070000000148	
L	DRAWER STOPPER -BATENTE DE SILICONE				2		2070711500036	
M	FEET - SAPATA DESLIZADORA				6	2070020202003	2070020202010	2070020202010
N	400mm DRAWER RUNNER -CORREDIÇA 400mm NORMAL				1		2075400000354	
O	4mm ALLEN KEY - CHAVE ALLEN Z 4mm				1		2075417500045	