

 TRNDlabs

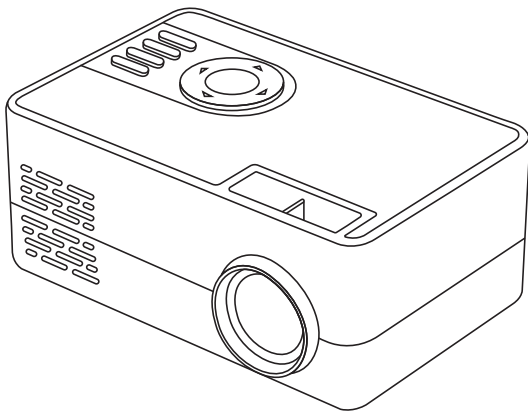

USER GUIDE

VIEW
Projector



WWW.TRNDLABS.COM

**Thank you for purchasing the VIEW
Projector and welcome to the world
of TRNDlabs products.**

The VIEW is a compact and portable projector, that can project your images onto any wall, making it perfect for movie nights at home. It is multi-compatible with HDMI and AV, so it can be hooked up by a variety of devices.

Table of Contents

Parts Identification	5
Functions	6
Connection	9
Setup	10
How To Use	11
Settings	13
Specifications	14
Format Support	15
Troubleshooting	16
Safety Information	18

Parts Identification

VIEW
Projector

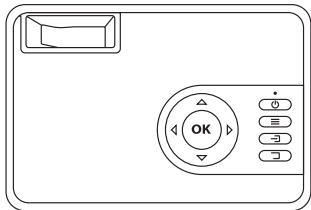

Remote
Control

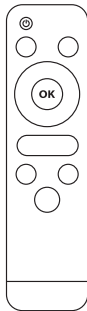

Power
Adapter

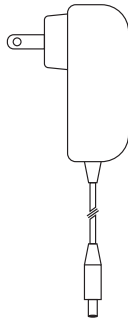

HDMI Cable

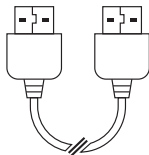

AV Cable

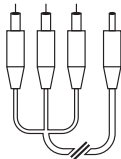

Functions

1. On/Off
2. Settings
3. Source
4. Return
5. Indicator Light
6. Focus Adjustment Handle

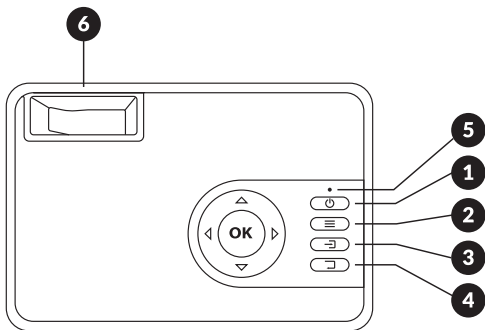



1. IR

2. USB-C

3. HDMI

4. USB

5. AV

6. DC IN

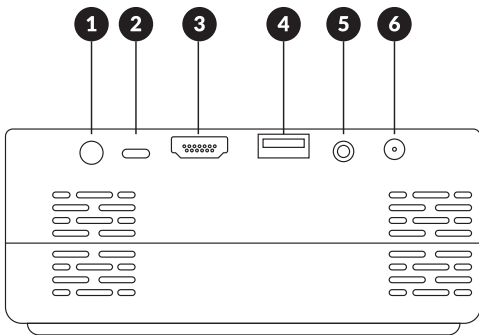

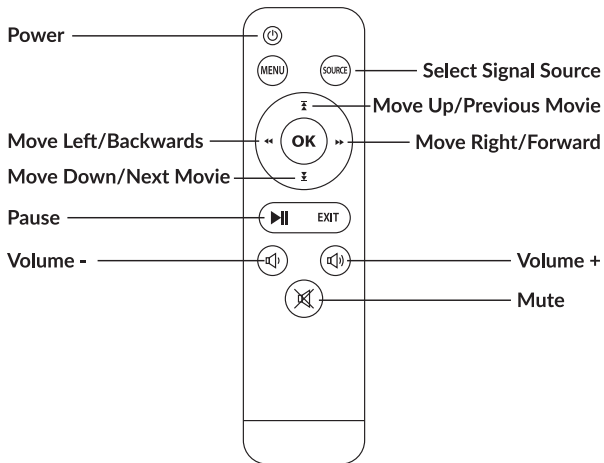

Connection

- **USB-C:** For mobile power supply, like a power bank
- **HDMI:** For connection to a PC or TV
- **AV:** For connection to TV (video and audio)
- **Headphone Jack:** For earphones
- **USB:** Insert removable storage disk or other local storage
- **DC IN:** For power supply

Setup

- 1** Insert the Power Adapter into the DC IN port on the back of the projector and insert the other end into a wall socket.
- 2** The indicator light on top of the projector will light up, indicating that it is ready to turn on.
- 3** Turn the projector on by pressing the On/Off button on the projector or the Power button on the remote.
- 4** To turn the projector off, press the On/Off button on the projector or the Power button on the remote.

How to Use

- After turning the projector on, a user interface will appear in 2 to 5 seconds.

Play media from local storage

- Connect your local storage device with the projector using the USB port.
- Press 'Source' on the remote control or press the 'Source' button on top of the projector
- Select 'MediaPlayer'.
- In the menu navigate to Movie, Music, or Photo and select the files you want to play.



Connect with AV or HDMI

- Connect your PC or TV to the Projector using the HDMI or the AV cable.
- Press 'Source' on the remote control or press the 'Source' button on top of the projector.
- Select 'AV' or 'HDMI', depending on the input used to connect your device.
- If the source is selected and the projector is connected, the screen of the device will be projected after a few seconds.

Settings

- To enter the settings menu, press the 'Settings' button on top of the projector.
- Navigate with the arrows to the left and right to switch between:
 - General Settings
 - Image Settings
 - Time Settings
 - Audio Settings

Specifications

Input:	DC12V-1.5A
Resolution:	340 x 240p (1080p support)
Brightness:	1000 Lumen
Aspect Ratio:	4:3 and 16:9
Dimensions:	13.1 x 8.6 x 5.8 cm
Weight:	470 grams

Format Support

Video: MPG, AV, TS, MOV, MKV, DAT, MP4, and

Audio: VOB

Image: MP3, WMA, AAC, AC3, and M4A

JPG, JPEG, BMP, and PNG

Troubleshooting

Problem: My PC is connected via HDMI to the projector, but it does not project the screen.

Solution: Check if the right source is selected. Press on 'Source' and select HDMI.

Solution: Go to the settings of the PC and check if the projector is selected as screen.

Problem: The projector is not playing the sound that belongs to the audio or video file.

Solution: Go to the settings of the device you are connected to and select the projector as audio output device.



Problem: The text in the projector's menu is not the language I prefer.

Solution: Go to settings. In the general settings menu select 'Language', and choose the preferred language out of 23 languages.

Safety Information

- Do not use the projector near water or in wet places. Do not place water filled with liquids, such as vases, close to the projector.
- Do not expose the projector to dripping or splashing.
- Keep the projector away from open fire.
- The projector should be placed on a stable, flat surface. Do not expose the projector to shocks or falls.
- The placement of the projector should not block the ventilation.
- Do not place on soft surfaces like a bed or a sofa, or in a small space where its ventilation is blocked.
- Do not place the projector close to heat sources such as radiators.
- Do not connect the projector to a power supply other than the one that comes with the product (DC12V-1.5A).
- Do not clean using cleaners or detergents. Clean by wiping with a dry and clean cloth.
- Do not clean product while being turned on.
- Do not leave the projector plugged in, when not being used for a long time.



The contents of this document are subject to change.
Download the latest version from
www.trndlabs.com.

If you have any questions about this document, please
contact TRNDlabs by sending a message
to hello@trndlabs.com.

© 2022 TRNDlabs. All rights reserved.



4040/1/EN