

# CHARGING STATION

For SPECTRE

## USER GUIDE



# **Welcome to the world of TRNDlabs products!**

TRNDlabs products are design focused electronics, engineered to combine ultimate performance and aesthetics.

**[WWW.TRNDLABS.COM](http://WWW.TRNDLABS.COM)**

# PACKAGE CONTENTS

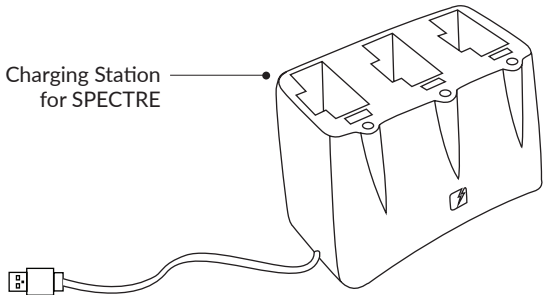

# FUNCTIONS

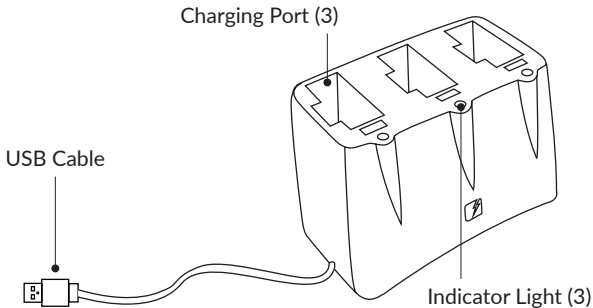

# SPECIFICATIONS

**Weight**  
**Size**

59 grams

79 mm (l) x 46 mm (w) x 56 mm (h)

# CHARGING

Connect the USB Cable to a USB Port **1**. Now slide a battery into one of the three charging ports in the Charging Station for SPECTRE **2**. The red Indicator Light indicates that the battery is charging. When the battery is completely charged the red Indicator Light turns off **3**.

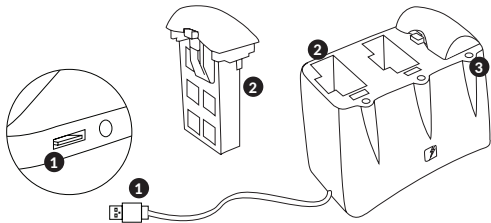

# TROUBLESHOOTING



**The LED light is not indicating the battery is charging.**  
The battery is not inserted properly.



Push the battery in far enough until the LED lights up.

# SAFETY PRECAUTIONS

- Do not use the Charging Station in temperatures below -20 °C or above 40 °C or in a humidity higher than 85%.
- Place the Charging Station at room temperature when charging.
- Store the Charging Station in a dry place. Never store it somewhere moist.
- Do not try to alter or disassemble the Charging Station. If there is a problem with the Charging Station, contact the retailer for further assistance.
- Keep away from high voltage devices or fire.
- This product is not a toy, please keep away from children.







The contents of this document are subject to change.  
Download the latest version from  
[www.trndlabs.com](http://www.trndlabs.com).

If you have any questions about this document, please contact TRNDlabs  
by sending a message to [hello@trndlabs.com](mailto:hello@trndlabs.com).

© 2017 TRNDlabs. All rights reserved.





[WWW.TRNDLABS.COM](http://WWW.TRNDLABS.COM)