

You have decided to buy a watch, which was assembled by a watchmaker using a Ronda movement. Please note that no watches are produced or distributed under the Ronda Brand.

In case of repairs, guarantee claims and questions concerning the functioning of a watch, purchasers and consumers should contact their retailer or the watch manufacturer, for which the relevant information can be found in the sales or guarantee documentation provided with the watch.

### Description of the display and control buttons

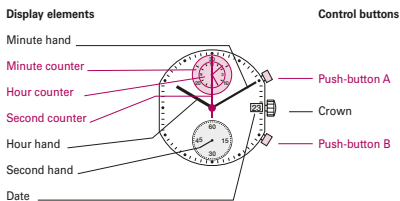

01

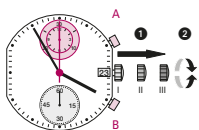

### Setting the time

- \* Pull out the crown to position III (the watch stops).
- Turn the crown until you reach the correct time 8:45.

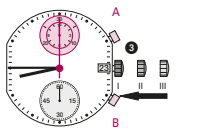

- Push the crown back into position I.

**Please note:**  
\* In order to set the time to the exact second, 1 must be pulled out when the second hand is in position «60». Once the hour and minute hands have been set, 2 must be pushed back into position I at the exact second.

02

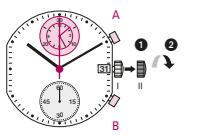

### Setting the date (quick mode)

- Pull out the crown to position II (the watch continues to run).
- Turn the crown anticlockwise until the correct date [1] appears.
- Push the crown back into position I.

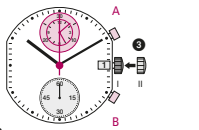

**Please note:**  
During the date changing phase between approx. 08:30 PM and 12 PM, the date must be set to the date of the following day.

03

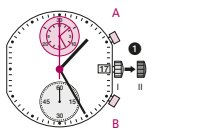

### Setting the date/time

Example:  
– Date / time on the watch: [17] / 1:25 AM  
– Present date / time: [4] / 8:30 PM

- Pull out the crown to position II (the watch continues to run).
- Turn the crown anticlockwise until yesterday's date appears [3].
- \* Pull out the crown to position III (the watch stops).
- Turn the crown until the correct date [4] appears.
- \*\* Continue to turn the crown until the correct time 8:30 PM appears.
- Push the crown back into position I.

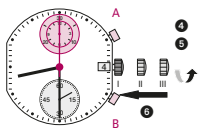

**Please note:**  
\* To set your watch to the exact second, please refer to the chapter entitled «setting the time».  
\*\* Please observe the AM/PM clock rhythm.

04

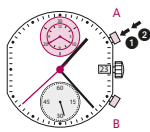

### Chronograph: Basic function

(Start / Stop / Reset)

Example:

- Start: Press push-button A.
- Stop: to stop the timing, press push-button A once more and read the chronograph counters:  
4h / 20 min / 38 sec
- Zero positioning: Press push-button B. (The chronograph hands will be reset to their zero positions.)

05

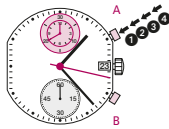

### Chronograph: Accumulated timing

Example:

- Start: (start timing)
- Stop: (e.g. 15 min 5 sec following 1)
- Restart: (timing is resumed)
- Stop: (e.g. 5 min 12 sec following 3) = 20 min 17 sec (The accumulated measured time is shown)

06

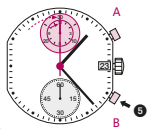

- Reset: The chronograph hands are returned to their zero positions.

**Please note:**  
\* Following 4, the accumulation of the timing can be continued by pressing push-button A (Restart / Stop, Restart / Stop, ...).

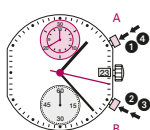

### Chronograph: Intermediate or interval timing

Example:

- Start: (start timing)
- Display interval: e.g. 20 minutes 17 seconds (timing continues in the background)
- Making up the measured time: (the chronograph hands are quickly advanced to the ongoing measured time.)
- Stop: (Final time is displayed)
- Reset: The chronograph hands are returned to their zero position

07

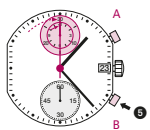

**Please note:**  
\* Following 5, further intervals or inter-mediate times can be displayed by pressing push-button B (display interval / make up measured time, ...).

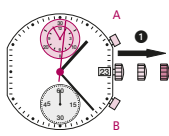

### Adjusting the chronograph hands to zero position

Example:

One or several chronograph hands are not in their correct zero positions and have to be adjusted (e.g. following a battery change).

- Pull out the crown to position III (all chronograph hands are in their correct or incorrect zero position.)
- Keep push-buttons A and B depressed simultaneously for at least 2 seconds (the second counter hand rotates by 360° → corrective mode is activated.)

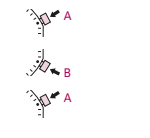
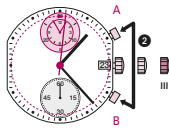

#### Adjusting the second counter hand

Single step: A 1 x short  
Continuous: A long

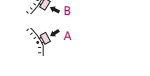

#### Adjusting the next hand B

Single step: A 1 x short  
Continuous: A long

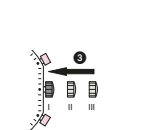

- Returning the crown to position I  
Termination of the chronograph hands adjustment (can be carried out at any time).

08

