



ANCHORING

**friulsider**



# X1 The absolute Plug.

ENDLESS BASE MATERIAL, ENDLESS APPLICATIONS



Collapsible rim



Dynamic Geometry



Extra thin countersunk rim



Hex head wood screws

Chipboard screws

Machine threaded screws and Threaded rod



Solid base material



Hollow base material

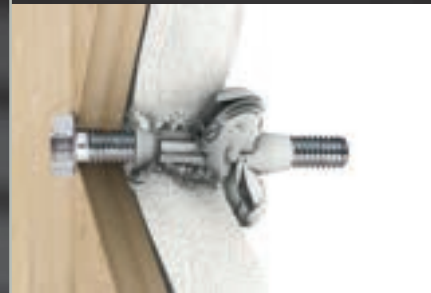

Plasterboard base material

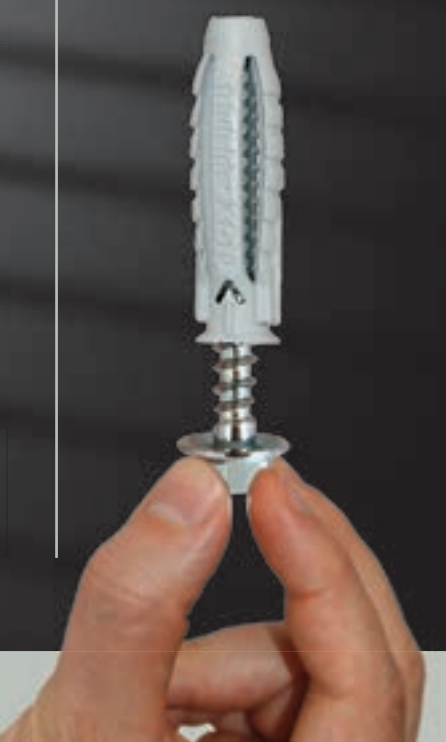
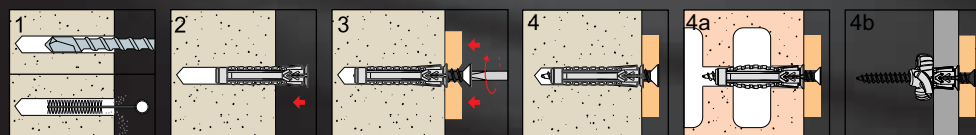

**friulsider X1®** The Absolute Plug**NEW**

Part No.	Description	mm	mm	mm	metric	qty	qty
<b>FMX1P05025</b> (60070005025)	5 x 25mm Plug only	5	25	3.5 - 4	n/a	100	3200
<b>FMX1P06030</b> (60070006030)	6 x 30mm Plug only	6	30	4.5	M4	100	3200
<b>FMX1P08040</b> (60070008040)	8 x 40mm Plug only	8	40	5 - 6	M5	100	1600
<b>FMX1P10050</b> (60070010050)	10 x 50mm Plug only	10	50	6	M6	50	800
<b>FMX1P12060</b> (60070012060)	12 x 60mm Plug only	12	60	8	M8	25	400
<b>FMX1P14070</b> (60070014070)	14 x 70mm Plug only	14	70	10	M10	20	320

**friulsider X1®** with Hex Head Screw Carbon Steel Hex Head Screw - Zinc Clear

ZINC INTERNAL

**NEW**

Part No.	Description	mm	mm	mm	mm	qty	qty
<b>FX1PH08040</b> (60071b08040)	8 x 40mm Plug with Hex Head Screw	8	40	6	50	100	1600
<b>FX1PH10050</b> (60071b10050)	10 x 50mm Plug with Hex Head Screw	10	50	6	60	50	800
<b>FX1PH12060</b> (60071b12060)	12 x 60mm Plug with Hex Head Screw	12	60	8	70	25	400
<b>FX1PH14070</b> (60071b14070)	14 x 70mm Plug with Hex Head Screw	14	70	10	80	20	320

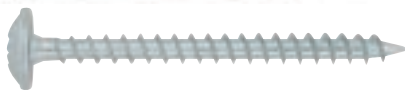
**friulsider X1®** with Pan Head Screw Carbon Steel Pan Head Screw - Zinc Clear

ZINC INTERNAL

**NEW**

Part No.	Description	mm	mm	mm	mm	qty	qty
<b>FX1PP05025</b> (60072b05025)	5 x 25mm Plug with Wide Pan Head Screw	5	25	3.5	30	100	1600
<b>FX1PP06030</b> (60072b06030)	6 x 30mm Plug with Wide Pan Head Screw	6	30	4.5	40	100	1200
<b>FX1PP08040</b> (60072b08040)	8 x 40mm Plug with Wide Pan Head Screw	8	40	5	50	50	600