



Bluetooth[®] Automatic Pill Dispenser

User Guide

LVFPDBTC

Thank you for purchasing the LiveFine Bluetooth® Automatic Pill Dispenser. This User Guide is intended to provide you with guidelines to ensure that operation of this product is safe and does not pose risk to the user. Any use that does not conform to the guidelines described in this User Guide may void the limited warranty. Please read all directions before using the product and retain this guide for reference. This product is intended for household use only. It is not intended for commercial use. This product is covered by a limited one-year warranty. Coverage is subject to limits and exclusions. See warranty for details.

About the LiveFine Bluetooth® Automatic Pill Dispenser

This automatic pill dispenser helps you organize your medications, vitamins, and supplements, and reminds you when to take them with audible and visible alerts or phone notifications. You can program the unit manually or simply download the app to program your unit and send notifications right to your or your caregiver's smartphone.

Safety Precautions

- Organizing medications correctly and assigning dosage quantities and times is the sole responsibility of the user and/or his/her caregiver or healthcare provider.
- If you miss a dose please follow the directions from your physician or pharmacist.
- Some medications should be sealed tightly and not be exposed to the air. If you are not certain about any of your medications, please check with your pharmacist.
- A low battery symbol  will appear in the upper right corner of the LCD display when battery power is low. Please replace the batteries promptly to ensure proper operation of the pill dispenser.
- Keep the unit on a flat, stable surface. Do not turn the unit upside down unless you are removing pills from the compartment.
- Be careful not to drop the unit.
- Do not expose the unit to heat sources, open flames, or direct sunlight.
- Do not immerse the unit in water or other liquids or expose it to splashing liquid.
- Do not force the unit open.
- Cleaning: Wipe the exterior of the unit with a damp cloth. Do not use harsh cleaning agents on the unit. Wash the medication carousel by hand only. Let washed parts dry completely before using the unit.

Features

- Set dosage times manually or via the app
- Use your smartphone to track dosages and receive phone alerts
- Allow caregivers to access the app to monitor your dosages
- Prevent forgetting or accidental double-dosing
- Easy to set up and use
- Up to 28 days capacity
- Can be set to dispense pills from one to nine times daily
- Large, easy-to-read LCD display
- Visual and audio alerts from the unit as well as phone notifications
- Locking system with key

Package Contents

Automatic pill dispenser

9 dosage rings

Key

4 AA batteries

User guide

Parts and Controls

1. Cover
2. Cover Handle
3. Dispenser Door
4. Dosage Window
5. Alert Light
6. Removable Dosage Ring
7. LCD Display
8. Button C
9. Button B
10. Button A
11. Removable Tray
12. Cover Lock
13. Battery Compartment Cover
14. Battery Compartment Latch
15. Speaker

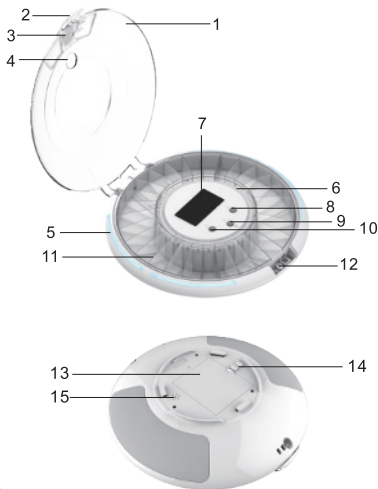

Dosage Rings

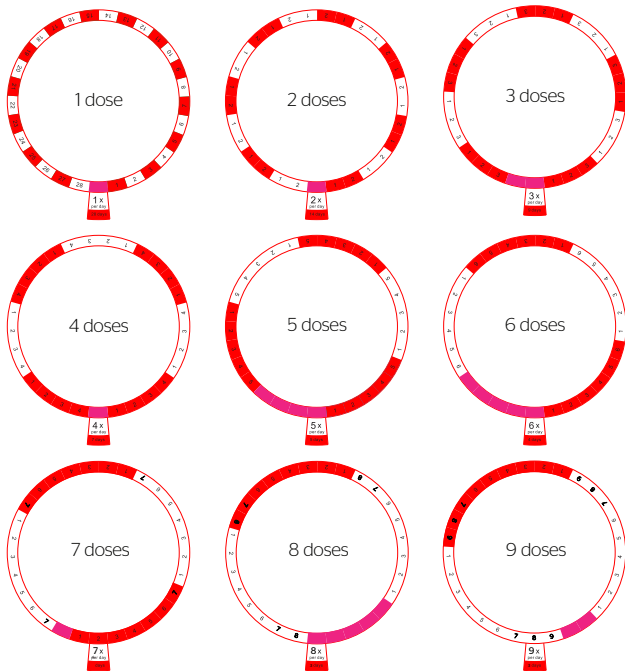

Operation

Insert Batteries

- Slide the battery compartment door latch on the bottom of the unit to the open position. Lift the battery compartment cover. Insert four (4) AA batteries into the compartment, matching battery polarities to the markings inside the compartment. Replace the compartment cover and slide the latch to lock it.
- Do not mix types or brands of batteries. Do not mix old and new batteries.

Open or Lock the Cover

- If the cover is locked, turn the unit upside down and locate the round keyhole. Insert the key and turn it clockwise to unlock.
- Place pill dispenser on a flat, stable surface. Press the cover handle/locking latch (#2) to release the latch and lift up the cover.
- To lock the cover, lower it into position and press it down so that it snaps shut. Turn the unit upside down. Insert the key into the round keyhole and turn the key counterclockwise.



Fill the Carousel

- The dispenser comes with nine (9) different dosage rings that fit around the center portion of the unit. The number on the tab under the red rectangle indicates the number of dosages to be taken each day.
- The dispenser carousel has 28 compartments that can correspond to daily and weekly dosage times. Each compartment corresponds to one (1) dose and can contain multiple medications.
- Insert the appropriate dosage ring. Place the ring so that the red rectangle lines up with the bottommost compartment. **DO NOT PLACE PILLS IN THE COMPARTMENT MARKED BY THE RED RECTANGLE.** Fill each compartment accordingly.

Ring #	# of Doses per Day	Programmable Time Period
1	1	28 days
2	2	14 days
3	3	9 days
4	4	7 days
5	5	5 days
6	6	4 days
7	7	4 days
8	8	3 days
9	9	3 days

Download the App

Scan the QR code on the bottom of the dispenser to download the HealBox app.

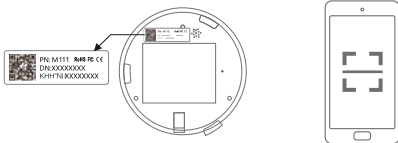

Pair Your Phone and Pill Dispenser

Before attempting to pair, make sure your smartphone is within range of the dispenser and that both Bluetooth and GPS are turned on.

- Open the HealBox app and tap the “+” in the top right corner.
- A scanning interface will appear on your screen. Scan the QR code on the back of your dispenser to pair the devices.
- When pairing is complete, the pill dispenser will sound an audio notification and will automatically sync the time between your phone and the dispenser.

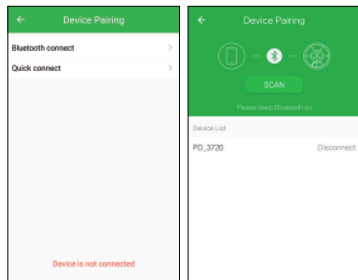

Set Your Medication Plan

Tap “Alarm” and navigate to “Alarm Settings” to select alarm times. To save an alarm, tap “Save”.

For any day, you can set a maximum of nine (9) alarms.

NOTE: If a dose needs to be taken before the alarm time, press “Early Dose”.

Alarm Settings

For each alarm, you can add notes or pictures to help keep track of your medications.

Review Records

To view records of previous doses, tap “Record” to view daily and monthly records.

Device Management

Tap “Settings” to navigate to “Device Management”. From this menu, you can view Parameter Settings, Bluetooth Connection Help and Unbind.

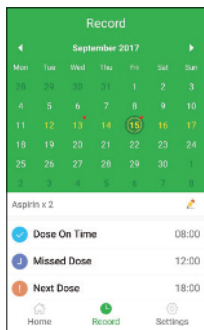

Parameter Settings

1. Time Format

Tap "Settings" → "Device Management" → "Parameter Settings", then select "Time Format" to choose between 12-hour and 24-hour time formats.

NOTE: Changing the time format on the dispenser does not change the time format in the app. To change the time format of the app, tap "Mine" → "Settings" → "Time Format".

2. Volume

Tap "Settings" → "Device Management" → "Volume Control" to set the pill dispenser's volume level or to mute the device.

3. Bell Duration

Tap "Settings" → "Device Management" → "Parameter Settings" → "Time of Bell" to select how long the bell rings for. The bell can be set to ring for a time between one (1) minute and 60 minutes.

4. Default Settings

To reset the device to factory settings, tap "Reset".

5. Restart

To restart the device, tap "Device Restart".

6. Device Unbinding

Tap "Settings", then tap "Device Management". In the Device Management menu, tap "Unbind" to unpair your dispenser from your phone.

Take Medications

- If a dose alarm is set, both the pill dispenser and your smartphone will alert you.
- At the programmed time, the carousel will automatically rotate to position the pill compartment at the bottom of the unit underneath the dispenser door.
- Slide open the compartment door. Turn the unit upside down & pour the pills into your hand.

NOTES: The alert will stop after the unit has been turned upside down.

Be sure to close the sliding door and turn the unit right side up again after you've taken your medications.

Low Battery Alert

When the battery is low, a low battery icon will display on the screen. Replace the batteries when the low battery icon displays to ensure proper function.

To help save battery, the screen on the pill dispenser will shut down when not in use.

To wake it up, tap the screen or gently move the dispenser.

Program Alerts Manually

While dosages can be programmed from your smartphone, you can also program alerts manually on the pill dispenser by following the steps below.

Setting the Time

1. Press and hold Button A (#10) for about three (3) seconds until the ":" symbol stops flashing.
2. Press Button B (#9) to adjust the hour digit and Button C (#8) to adjust the minute digits. Holding the button down will advance the digits quickly.
3. Confirm the clock settings by pressing Button A (#10) again.



Setting Alarm Times

1. Press Button A (#10) to display an alarm clock icon and the number 1 on the LCD screen.
2. Press Button B (#9) to adjust the hour digit and Button C (#8) to adjust the minute digits. Holding the button down will advance the digits quickly.
3. To cancel a setting, press and hold Button B (#9) until "--:" displays. This occurs after 23:00 or 11:00 PM. Or press and hold Button A (#10) until "--:" displays.
4. Confirm the alert time setting by pressing Button A (#10) again. The number 2 for the next alert setting will appear next to the alarm clock icon. Repeat steps 2 and 3 above to schedule alerts 2, 3, etc. up to 9.
5. When finished, press Button A (#10). The display will return to the clock mode.

Setting the Time Format

1. Under clock mode, press Button C (#8) to enter time format settings. Then, press Button C (#8) again to switch between 12-hour format or military time (24-hour) format.
2. Confirm the time format setting by pressing Button A (#10), or simply wait a few seconds until the display returns to the clock mode.

Setting the Volume

1. Under clock mode, press Button C (#8) to enter time format settings. Then, press Button B (#9) to switch between 0, 1, and 2. "0" means mute, "1" means low volume, and "2" means high volume.
2. Confirm the volume settings by pressing Button A (#10), or simply wait a few seconds until the display returns to the clock mode.

Specifications

Power source: 4 AA batteries (included)

Connectivity: Bluetooth®

Compatibility: iOS version 8.1 and later; Android™ 4.4 and later

Dimensions: 9.25" (23.5 cm) diameter

FCC Compliance Statement

This device complies with part 15 of the FCC Rules. Operation is subject to the following two conditions:

- (1) This device may not cause harmful interference, and
- (2) This device must accept any interference received, including interference that may cause undesired operation.

FCC Warning:

§ 15.21 Information to user.

Any Changes or modifications not expressly approved by the party responsible for compliance could void the user's authority to operate the equipment.

§ 15.105 Information to the user.

This equipment has been tested and found to comply with the limits for a Class B digital device, pursuant to part 15 of the FCC Rules. These limits are designed to provide reasonable protection against harmful interference in a residential installation. This equipment generates uses and can radiate radio frequency energy and, if not installed and used in accordance with the instructions, may cause harmful interference to radio communications. However, there is no guarantee that interference will not occur in a particular installation. If this equipment does cause harmful interference to radio or television reception, which can be determined by turning the equipment off and on, the user is encouraged to try to correct the interference by one or more of the following measures:

- Reorient or relocate the receiving antenna.
- Increase the separation between the equipment and receiver.
- Connect the equipment into an outlet on a circuit different from that to which the receiver is connected.
- Consult the dealer or an experienced radio/TV technician for help.

RF warning for Portable device:

The device has been evaluated to meet general RF exposure requirement.

The device can be used in portable exposure condition without restriction.

Limited Warranty to Original Consumer

This LiveFine Bluetooth® Automatic Pill Dispenser ("Product"), including any accessories included in the original packaging, as supplied and distributed new by an authorized retailer is warranted by C&A Marketing, Inc. (the "Company") to the original consumer purchaser only, against certain defects in material and workmanship ("Warranty") as follows:

To receive Warranty service, the original consumer purchaser must contact the Company or its authorized service provider for problem determination and service procedures. Proof of purchase in the form of a bill of sale or receipted invoice, evidencing that the Product is within the applicable Warranty period(s), MUST be presented to the Company or its authorized service provider in order to obtain the requested service.

Service options, parts availability, and response times may vary and may change at any time. In accordance with applicable law, the Company may require that you furnish additional documents and/or comply with registration requirements before receiving warranty service. Please contact our customer service for details on obtaining warranty service:

Email: supportlfc@camarketing.com

Phone number: 1-888-390-7622

Shipping expenses to the Company's Return Facility are not covered by this warranty and must be paid by the consumer. The consumer likewise bears all risk of loss or further damage to the Product until delivery to said facility.

EXCLUSIONS AND LIMITATIONS The Company warrants the Product against defects in materials and workmanship under normal use for a period of ONE (1) YEAR from the date of retail purchase by the original end-user purchaser ("Warranty Period"). If a hardware defect arises and a valid claim is received within the Warranty Period, the Company, at its sole option and to the extent permitted by law, will either (1) repair the Product defect at no charge, using new or refurbished replacement parts, (2) exchange the Product with a Product that is new or which has been manufactured from new or serviceable used parts and is at least functionally equivalent to the original device, or (3) refund the purchase price of the Product.

A replacement Product or part thereof shall enjoy the warranty of the original Product for the remainder of the Warranty Period, or ninety (90) days from the date of replacement or repair, whichever provides you longer protection. When a Product or part is exchanged, any replacement item becomes your property, while the replaced item becomes the Company's property. Refunds can only be given if the original Product is returned.

This Warranty does not apply to:

- (a) Any non-LiveFine Bluetooth® Automatic Pill Dispenser product, hardware or software, even if packaged or sold with the Product;
- (b) Damage caused by use with non-LiveFine Bluetooth® Automatic Pill Dispenser product;
- (c) Damage caused by accident, abuse, misuse, flood, fire, earthquake, or other external causes;
- (d) Damage caused by operating the Product outside the permitted or intended uses described by the Company;
- (e) Damage caused by third party services;
- (f) A Product or part that has been modified to alter functionality or capability without the written permission of the Company;
- (g) Consumable parts, such as batteries, fuses, and bulbs;
- (h) Cosmetic damage; or
- (i) If any LiveFine Bluetooth® Automatic Pill Dispenser serial number has been removed or defaced.

This Warranty is valid only in the country where the consumer purchased the Product, and only applies to Products purchased and serviced in that country.

The Company does not warrant that the operation of the Product will be uninterrupted or error-free. The Company is not responsible for damage arising from your failure to follow instructions relating to its use.

NOTWITHSTANDING ANYTHING TO THE CONTRARY AND TO THE MAXIMUM EXTENT PERMITTED BY APPLICABLE LAW, THE COMPANY PROVIDES THE PRODUCT "AS-IS" AND "AS-AVAILABLE" FOR YOUR CONVENIENCE AND THE COMPANY AND ITS LICENSORS AND SUPPLIERS EXPRESSLY DISCLAIM ALL WARRANTIES AND CONDITIONS, WHETHER EXPRESSED, IMPLIED, OR STATUTORY, INCLUDING THE WARRANTIES OF MERCHANTABILITY, FITNESS FOR A PARTICULAR PURPOSE, TITLE, QUIET ENJOYMENT, ACCURACY, AND NON-INFRINGEMENT OF THIRD-PARTY RIGHTS. THE COMPANY DOES NOT GUARANTEE ANY SPECIFIC RESULTS FROM THE USE OF THE PRODUCT, OR THAT THE COMPANY WILL CONTINUE TO OFFER OR MAKE AVAILABLE THE PRODUCT FOR ANY PARTICULAR LENGTH OF TIME. THE COMPANY FURTHER DISCLAIMS ALL WARRANTIES AFTER THE EXPRESS WARRANTY PERIOD STATED ABOVE.

YOU USE THE PRODUCT AT YOUR OWN DISCRETION AND RISK. YOU WILL BE SOLELY RESPONSIBLE FOR (AND THE COMPANY DISCLAIMS) ANY AND ALL LOSS, LIABILITY, OR DAMAGES RESULTING FROM YOUR USE OF THE PRODUCT. NO ADVICE OR INFORMATION, WHETHER ORAL OR WRITTEN, OBTAINED BY YOU FROM THE COMPANY OR THROUGH ITS AUTHORIZED SERVICE PROVIDERS SHALL CREATE ANY WARRANTY.

IN NO EVENT WILL THE COMPANY'S TOTAL CUMULATIVE LIABILITY ARISING FROM OR RELATED TO THE PRODUCT, WHETHER IN CONTRACT OR TORT OR OTHERWISE EXCEED THE FEES ACTUALLY PAID BY YOU TO THE COMPANY OR ANY OF ITS AUTHORIZED RESELLERS FOR THE PRODUCT AT ISSUE IN THE LAST YEAR FROM YOUR PURCHASE. THIS LIMITATION IS CUMULATIVE AND WILL NOT BE INCREASED BY THE EXISTENCE OF MORE THAN ONE INCIDENT OR CLAIM. THE COMPANY DISCLAIMS ALL LIABILITY OF ANY KIND OF ITS LICENSORS AND SUPPLIERS. IN NO EVENT WILL THE COMPANY OR ITS LICENSORS, MANUFACTURERS, AND SUPPLIERS BE LIABLE FOR ANY INCIDENTAL, DIRECT, INDIRECT, SPECIAL, PUNITIVE, OR CONSEQUENTIAL DAMAGES (SUCH AS, BUT NOT LIMITED TO, DAMAGES FOR LOSS OF PROFITS, BUSINESS, SAVINGS, DATA, OR RECORDS) CAUSED BY THE USE, MISUSE, OR INABILITY TO USE THE PRODUCT.

Nothing in these terms shall attempt to exclude liability that cannot be excluded under applicable law. Some countries, states, or provinces do not allow the exclusion or limitation of incidental or consequential damages or allow limitations on warranties, so certain limitations or exclusions may not apply to you. This warranty gives you specific legal rights, and you may have other rights that vary from state to state or province to province. Contact your authorized retailer to determine if another warranty applies.



NEED HELP?

If you experience any problems with your LiveFine Bluetooth® Automatic Pill Dispenser, please contact us at supportlfc@camarketing.com or 888-390-7622 before returning your product to the place of purchase.

WE'RE HERE TO HELP!

Distributed by C&A Marketing, Inc., 114 Tived Lane East, Edison, NJ 08837 USA.
LiveFine is a trademark of C&A IP Holdings LLC. In the U.S. | Bluetooth is a registered trademark of Bluetooth SIG, Inc. USA. | Android is a trademark of Google Inc. | IOS is a trademark or registered trademark of Cisco in the U.S. and other countries and is used under license.
All other products, brand names, company names, and logos are trademarks of their respective owners, used merely to identify their respective products, and are not meant to connote any sponsorship, endorsement, or approval.
Made in China | ©2021. All right reserved.