

You will require a screwdriver in order to adjust the doors

We best recommend using a Philips head screwdriver, but you may use a flat head screwdriver as well. With the 6-way adjustable hinges, you will be able to move the door up or down, left or right, or front and back.

Review the vanity and assess which doors require realignment

It may take several adjustments to get your doors leveled

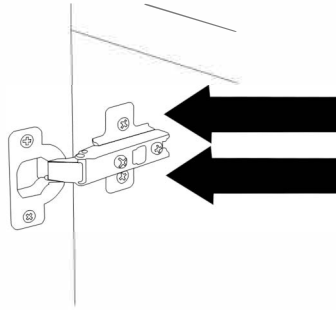

We will begin with adjusting the height of the door. First, you will want to loosen the top and bottom screws of both hinges.

Use your screwdriver to rotate the screws counter-clockwise.

Note: Remember to not completely unscrew the hinges from the wall of the vanity as this will fully disconnect the door from the cabinet.

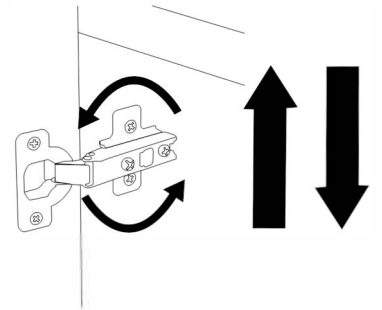

Once you have loosened the screws, begin your adjustments by moving the door up or down until you have determined that it is at equal height of the adjacent door.

Once you have loosened the screws, begin your adjustments by moving the door up or down until you have determined that it is at equal height of the adjacent door.

Holding the door in its desired location, begin tightening the screws by rotating the screws in a clockwise motion.

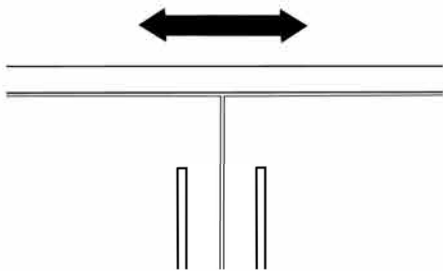

Next, we will look at adjusting any gaps that may be seen between the doors.

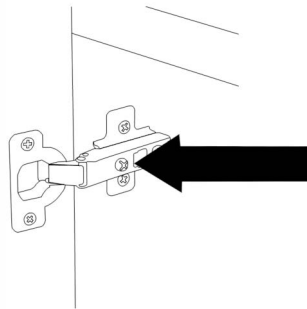

To adjust the gaps, simply loosen or tighten the screw that is in the middle, closest to the front of the cabinet.

This adjustment will either move the doors closer together or further apart.

Tightening the screw will move the doors closer together and loosening the screw will move the doors further apart.

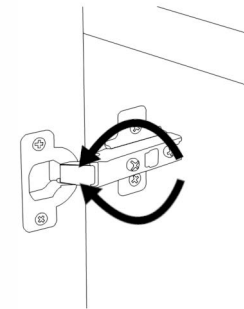

As you loosen or tighten the screw, the door should then begin to move accordingly.

Simply stop loosening or tightening the screw once the door is in the desired position.

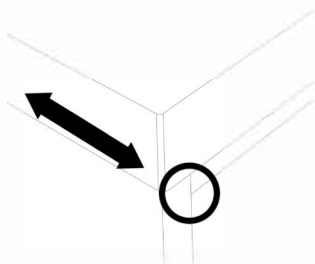

Lastly, we will go over adjusting the distance between the door and the vanity itself.

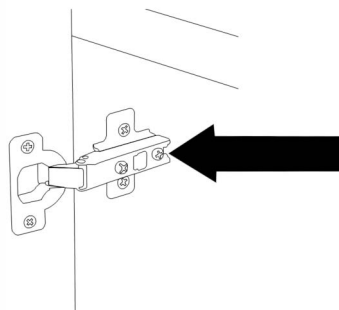

This specific adjustment can be achieved by loosening or tightening the screw that is furthest away from the door, or closest to the inside of the vanity.

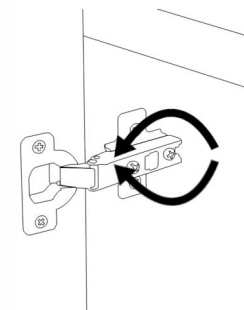

Adjust the screw by rotating in a clockwise or counter-clockwise motion.

Once you have loosened the screw, you should then be able to freely move the door forward and back.

When you have the door in place to your desired location, proceed with tightening your screw in order to stabilize your door.

You are now all set to enjoy your new vanity.