

Peak PKX160LH Stainless Steel Kitchen Sink

Aesthetically pleasing and remarkably functional, the Peak sink collection brings unparalleled style and utility to any kitchen.

FEATURES

- Integrated Ledge: The integrated ledge enhances your workspace by allowing you to work directly over the sink. Custom-fit accessories streamline the workflow.
- Multi-Level Workspace: The bottom sink grid raises to sit on the integrated ledge, creating a higher level workspace to expand your prep, clean and rinse area.
- Removable Drain Cover: The removable square drain cover conceals the drain for a seamless bowl surface, while providing a flat bottom surface to allow for more usable workspace. Square drain cover included.
- Undermount Installation: Fitted underneath the counter, it gives an edgeless finish that is easy to clean

Product Picture

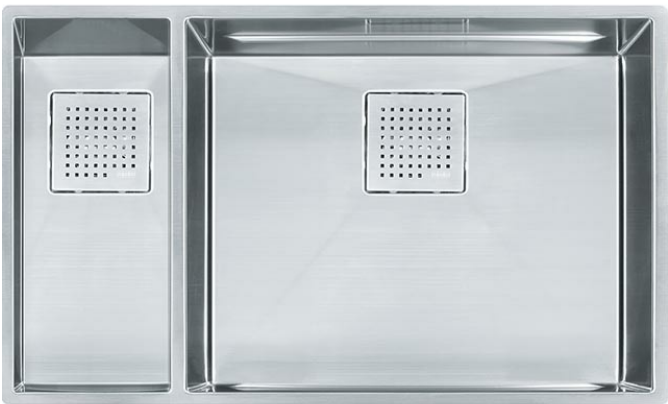

Technical Drawing

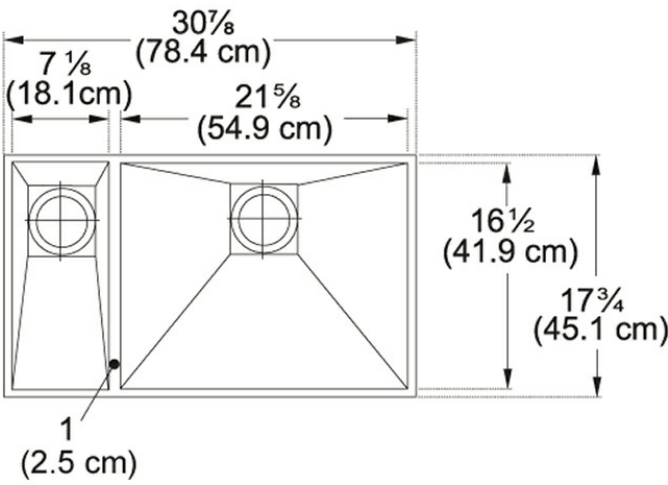

Product Dimensions

Length overall	30 7/8"
Width overall	17 3/4"
Length of large bowl	21 5/8"
Width of large bowl	16 1/2"
Depth of large bowl	9 5/8"
Length of small bowl	7 1/8"
Width of small bowl	16 1/2"
Depth of small bowl	7 1/8"
Minimum Cabinet Size	36"

General Information

Type of Material	16 Gauge Stainless Steel
Number of Bowls	2
Installation Clips	Yes
Cut-Out Template	Yes
Integral Ledge System	Yes

Article Numbers



FUN#	122.0074.965
US Part Number	PKX160LH

