

Safety Instructions

- This product is rated as IP65 Waterproof. It can be used outdoors but cannot be immersed in water.
- The power adapter is not waterproof. Avoid exposing it to splashes, water drops, or high-humidity environments.
- Tighten up the waterproof cap before installing the lights.
- The internal light sources of the strip light cannot be replaced. If the light sources sustain damage, the product should be replaced.
- Do not allow children to assemble and install this product without adult supervision.
- Avoid installing this product near major heat sources.
- External dimmers cannot be used with this product.
- Use this product with the provided power adapter only.

Introduction

Thanks for choosing Govee LED Bulb Strip Lights. This product has an IP65 waterproof rating, making them ideal for outdoor use. Using Govee Home App, you can adjust its color and brightness, and sync its lighting effects with rhythm by turning on the music mode.

What You Get

Item	Quantity
Bulb Strip Light	1
Adapter & Control Box	1
User Manual	1
Service Card	1

At a Glance

- Press to turn the light on or off.
- Press twice to switch the light to Illumination Mode.
- Long press for 5 seconds to reset.

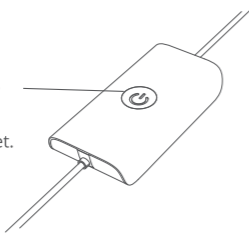

Controlling Strip Lights in Series

1. Connect the two strip lights as shown in the image.
2. Firmly screw the wire nut.

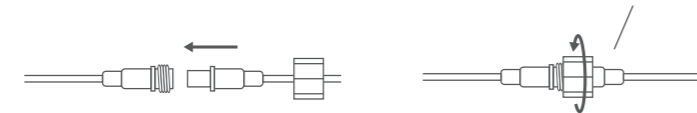

Note: Only 2 bulb strip lights can be connected in a series.

Installing Your Device

Installation Steps

Use the hook to hang the light bulbs onto the rope.



Note: When installing the lights, do not leave more than 2 bulbs off the rope as it may affect stability.

Airing Your Device with Govee Home App

What You Need:

- A Wi-Fi router supporting the 2.4GHz and 802.11 b/g/n bands (5GHz is not supported).
- A smartphone or tablet running iOS or Android.

Pairing Instructions

1. Download Govee Home App from App Store (iOS) or Google Play (Android).
2. Enable your smartphone's Bluetooth.
3. Open the app, tap the "+" icon in the top right corner and search for "H7041".
4. Tap the device icon and follow the on-screen instructions to complete pairing.



Specifications

Power Input (Adapter)	AC 100-240V 50/60Hz 0.8A Max
Power Output (Adapter)	DC 12V/2A
Length	50ft/15m
Number of Bulbs	25
Light Color	RGB+Warm White
Waterproof	Adapter (IPX0) Control Box (IPX5) Bulb String Lights (IP66)
Working Temperature	-20~50°C/-4~122°F

Troubleshooting

1 Cannot connect to Govee Home App.

- Make sure the device is powered on.
- Make sure your smartphone's Bluetooth has been enabled.
- Make sure your smartphone is connected to a 2.4GHz WiFi network.
- Position your smartphone close to the control box, then try connecting again.

2 One or more flood lights fail to light up.

- Remove the light and then reattach it to the power cable. Also unplug the power adapter and then plug back into power.
- If the problem persists, please contact Govee Customer Service.

Customer Service

Warranty: 12-Month Limited Warranty

Support: Lifetime Technical Support

Email: support@govee.com

Official Website: www.govee.com

@Govee @govee_official @govee.official

@Goveeofficial @Govee.smarthome

Compliance Information

EU Compliance Statement:

Shenzhen Intellirocks Tech Co. Ltd. hereby declares that this device is in compliance with the essential requirements and other relevant provisions of the Directive 2014/30/EU.

A copy of the EU Declaration of Conformity is available online at www.govee.com/ EU contact address:

C&E Connection E-Commerce (DE) GmbH
(E-mail: info@ce-connection.de)
Zum Linnegraben 20, 65933, Frankfurt am Main, Germany

EU-Compliance:

Hiermit erklärt Shenzhen Intellirocks Tech Co. Ltd., dass dieses Gerät den wesentlichen Anforderungen und anderen einschlägigen Bestimmungen der EU-Richtlinie 2014/30/EU entspricht.

Eine Kopie der EU-Konformitätserklärung finden Sie online auf www.govee.com/ Kontaktadresse innerhalb der EU:

C&E Connection E-Commerce (DE) GmbH
(E-mail: info@ce-connection.de)
Zum Linnegraben 20, 65933, Frankfurt am Main, Germany

Déclaration de conformité UE:

Par la présente, Shenzhen Intellirocks Tech Co. Ltd. déclare que cet appareil est conforme aux principales exigences et autres clauses pertinentes de la directive européenne 2014/30/EU.

Une copie de la déclaration de conformité UE est disponible sur le site www.govee.com/

Adresse de contact pour l'UE :

C&E Connection E-Commerce (DE) GmbH
(E-mail: info@ce-connection.de)
Zum Linnegraben 20, 65933, Frankfurt am Main, Germany

Declaración de cumplimiento UE:

Shenzhen Intellirocks Tech Co. Ltd. por la presente declara que este dispositivo cumple los requisitos básicos y el resto de provisiones relevantes de la Directiva 2014/30/EU.

Hay disponible online una copia de la Declaración de conformidad UE en www.govee.com/

Dirección de contacto de la UE:

C&E Connection E-Commerce (DE) GmbH
(E-mail: info@ce-connection.de)
Zum Linnegraben 20, 65933, Frankfurt am Main, Germany

Dichiarazione di conformità UE:

Shenzhen Intellirocks Tech Co. Ltd. dichiara che il presente dispositivo è conforme ai requisiti essenziali e alle altre disposizioni rilevanti della direttiva 2014/30/EU.

Una copia della dichiarazione di conformità UE è disponibile online all'indirizzo [Web www.govee.com/](http://www.govee.com/)

Indirizzo di contatto UE:

C&E Connection E-Commerce (DE) GmbH
(E-mail: info@ce-connection.de)
Zum Linnegraben 20, 65933, Frankfurt am Main, Germany

UK Compliance Statement:

Shenzhen Intellirocks Tech Co., Ltd. hereby declares that this device is in compliance with the essential requirements and other relevant provisions of the Electromagnetic Compatibility Regulations 2016

A copy of the UK Declaration of Conformity is available online at www.govee.com/



Environmentally friendly disposal

Old electrical appliances must not be disposed of together with the residual waste, but have to be disposed of separately. The disposal at the communal collecting point via private persons is for free. The owner of old appliances is responsible to bring the appliances to these collecting points or to similar collection points. With this little personal effort, you contribute to recycle valuable raw materials and the treatment of toxic substances.

Umweltfreundliche Entsorgung

Elektro-Altgeräte dürfen nicht mit gewöhnlichem Abfall entsorgt werden und müssen separat entsorgt werden. Die Entsorgung an kommunalen Sammelstellen ist für Privatpersonen kostenlos. Die Eigentümer der Altgeräte sind für den Transport zu den Sammelstellen verantwortlich. Durch diesen geringen Aufwand können Sie zur Wiederverwertung von wertvollen Rohmaterialien beitragen und dafür sorgen, dass umweltschädliche und giftige Substanzen ordnungsgemäß unschädlich gemacht werden.

Mise au rebut écologique

Les appareils électriques usagés ne doivent pas être éliminés avec les déchets résiduels. Ils doivent être éliminés séparément. La mise au rebut au point de collecte municipal par l'intermédiaire de particuliers est gratuite. Il incombe au propriétaire des appareils usagés de les apporter à ces points de collecte ou à des points de collecte similaires. Avec ce petit effort personnel, vous contribuez au recyclage de matières premières précieuses et au traitement des substances toxiques.

Tratamiento de residuos responsable con el medio ambiente

Los aparatos eléctricos viejos no pueden desecharse junto con los residuos orgánicos, sino que deben ser desechados por separado. Existen puntos limpios donde los ciudadanos pueden dejar estos aparatos gratis. El propietario de los aparatos viejos es responsable de llevarlos a estos puntos limpios o similares puntos de recogida. Con este pequeño esfuerzo estás contribuyendo a reciclar valiosas materias primas y al tratamiento de residuos tóxicos.

Smaltimento ecologico

I vecchi dispositivi elettrici non devono essere smaltiti insieme ai rifiuti residui, ma devono essere smaltiti separatamente. Lo smaltimento da parte di soggetti privati presso i punti di raccolta pubblici è gratis. È responsabilità del proprietario dei vecchi dispositivi portarli presso tali punti di raccolta o punti di raccolta analoghi. Grazie a questo piccolo impegno personale contribuirete al riciclo di materie prime preziose e al corretto trattamento di sostanze tossiche.

FCC and ISED Canada Statement

This device complies with Part 15 of the FCC Rules and Industry Canada licence-exempt RSS standard(s). Operation is subject to the following two conditions:

(1) This device may not cause harmful interference, and (2) This device must accept any interference received, including interference that may cause undesired operation.

Warning: Changes or modifications not expressly approved by the party responsible for compliance could void the user's authority to operate the equipment.

Le présent appareil est conforme aux CNR d'Industrie Canada applicables aux appareils radio exempts de licence. L'exploitation est autorisée aux deux conditions suivantes :

(1) l'appareil n'émet pas de brouillage, et
(2) l'utilisateur de l'appareil doit accepter tout brouillage radioélectrique subi, même si le brouillage est susceptible d'en compromettre le fonctionnement."

NOTE: This equipment has been tested and found to comply with the limits for a Class B digital device, pursuant to Part 15 of the FCC Rules.

These limits are designed to provide reasonable protection against harmful interference in a residential installation. This equipment generates uses and can radiate radio frequency energy and, if not installed and used in accordance with the instructions, may cause harmful interference to radio communications. However, there is no guarantee that interference will not occur in a particular installation. If this equipment does cause harmful interference to radio or television reception, which can be determined by turning the equipment off and on, the user is encouraged to try to correct the interference by one or more of the following measures:

1. Reorient or relocate the receiving antenna.
2. Increase the separation between the equipment and receiver.
3. Connect the equipment into an outlet on a circuit different from that to which the receiver is connected.
4. Consult the dealer or an experienced radio/TV technician for help.

This Class B digital apparatus complies with Canadian ICES-005.

Cet appareil numérique de la classe B est conforme à la norme NMB-005 du Canada.

Responsible party :

Name: GOVEE MOMENTS(US) TRADING LIMITED
Address: 13013 WESTERN AVE STE 5 BLUE ISLAND IL 60406-2448
Email: support@govee.com
Contact information: <https://www.govee.com/support>

For ambience lighting only. Not for illumination.

This device uses a non-replaceable light source. When the light source reaches the end of its life cycle, this device should be replaced.
Do not connect the rope light to the supply while it is in the packing or wound onto a reel;
Do not use the rope light when covered or recessed into a surface;
Do not open or cut the rope light.
The light source or separate control gear is not intended for use in other applications.

Nur für Ambientebeleuchtung. Nicht zur Beleuchtung.

Dieses Gerät verwendet eine nicht austauschbare Lichtquelle. Wenn die Lichtquelle das Ende ihres Lebenszyklus erreicht, sollte dieses Gerät ersetzt werden.
Schließen Sie die Lichterkette nicht an die Stromversorgung an, während sie sich in der Verpackung befindet oder auf eine Rolle aufgewickelt ist;
Verwenden Sie die Lichterkette nicht, wenn sie abgedeckt oder verbeult ist.
Öffnen oder schneiden Sie die Lichterkette nicht.
Die Lichtquelle oder das separate Betriebsgerät sind nicht für andere Anwendungen bestimmt.

Solo para iluminación de ambiente. No para la iluminación.

Este dispositivo utiliza una fuente de luz no reemplazable. Cuando la fuente de luz llegue al final de su ciclo de vida, debe sustituir este dispositivo.
No conecte la luz de cuerda al suministro mientras esté en el embalaje o enrollado en un rollo;

No utilice la luz de cuerda cuando esté cubierta o empotrada en una superficie;
No abra ni corte la luz de cuerda.
La fuente de luz o el equipo de control separado no está destinado a ser utilizado en otras aplicaciones.

Seulement pour un éclairage d'ambiance. Pas pour l'éclairage quotidien.

Cet appareil utilise une source lumineuse non remplaçable. Lorsque la source lumineuse atteint la fin de son cycle de vie, cet appareil doit être remplacé.
Ne connectez pas le corde lumineux à l'alimentation lorsqu'il est dans l'emballage ou enroulé sur un enrouleur ;
N'utilisez pas le corde lumineux lorsqu'il est couvert ou encastré dans une surface ;
Ne pas ouvrir ou couper la corde lumineuse.
La source lumineuse ou l'appareillage de commande séparé ne convient pas à d'autres applications.

Solo per l'illuminazione dell'atmosfera. Non per illuminare.

Questo dispositivo utilizza una sorgente luminosa non sostituibile. Quando la sorgente luminosa raggiunge la fine del suo ciclo di vita, questo dispositivo deve essere sostituito.
Non collegare la fune luminosa all'alimentazione mentre è nell'imballo o avvolta su una bobina;
Non utilizzare la fune luminosa quando è coperta o incassata in una superficie;
Non aprire o tagliare la luce della fune;
La sorgente luminosa o l'alimentatore separato non è destinato all'uso in altre applicazioni.



FOR INDOOR USE ONLY
NUR FÜR DEN INNENGEBRAUCH
POUR UNE UTILISATION EN INTÉRIEUR UNIQUEMENT
SOLO PARA USO EN INTERIORES
SOLO PER USO INTERNO

The Bluetooth® word mark and logos are registered trademarks owned by Bluetooth SIG, Inc. and any use of such marks by Shenzhen Intellirocks Tech. Co., Ltd. is under license.

Govee is a trademark of Shenzhen Intellirocks Tech Co., Ltd.
Copyright ©2021 Shenzhen Intellirocks Tech Co., Ltd. All Rights Reserved.



User Manual



Govee Home App

For FAQs and more information,
please visit: www.govee.com

Model: H7041
Govee LED Bulb String Lights