



SINGLE-USE PRODUCTS



AFFORDABLE
INNOVATIONS

RUMEX best-selling instruments are now available in a single-use edition.

Doctors around the world choose to perform the surgeries using RUMEX single-use instruments because they are:

SAFE. Instruments are supplied sterile in a protective case and ready for use;

RELIABLE. High-quality stainless steel and heat-resistant plastics are used in production;

COST-EFFECTIVE. No additional expenses on sterilizing equipment, repairs and storage space needed; considerably reduced price due to the composition of materials.

The range of RUMEX single-use instruments is designed to assist surgeons in various procedures on both anterior and posterior segments of the eye. The most commonly used items are available from stock.

SAFE. RELIABLE. COST-EFFECTIVE.



CONTENTS

IOLs	4
HYDROPHOBIC	4
HYDROPHILIC	5
DISPOSABLE IOL INJECTOR&CARTRIDGES	5
OVDs	6
DISPERSIVE	6
COHESIVE	7
DISPOSABLE KNIVES	8
DISPOSABLE INSTRUMENTS FOR ANTERIOR SEGMENT	10
PVA SPEARS	10
SPECULUMS	10
IRIS RETRACTORS	10
FORCEPS	11
SCISSORS	11
MANIPULATORS	12
DISPOSABLE CANNULAS FOR ANTERIOR SEGMENT	13
DISPOSABLE INSTRUMENTS FOR POSTERIOR SEGMENT	16
STAINLESS STEEL FORCEPS AND SCISSORS	16
SCISSORS AND FORCEPS WITH PLASTIC HANDLE	17
DISPOSABLE DIAMOND DUSTED ILM ELEVATORS	18
DISPOSABLE BACKFLUSH INSTRUMENTS	18
SILICONE OIL	19
SILICONE OIL CANNULAS	19
DISPOSABLE TROCAR SYSTEMS	20
DISPOSABLE VITREORETINAL CANNULAS	21
DISPOSABLE REPLACEMENT RESERVOIRS FOR BACKFLUSH HANDLE	21

HYDROPHOBIC IOLs

AquaFree Yellow Aspheric Hydrophobic*

**MOST
POPULAR**

Min. incision size	2.20 mm
Power range	0 .. +30 D
Overall diameter	13 mm
Optic diameter	6.0 mm
Self-unfolding	Yes
Water content	< 0.50%
Angulation	0°
Material	Natural Yellow Hydrophobic Acrylic
Refractive index	1.50
A-constant	118
UV Filter	Yes
Shelf Life	5 years



Aqua-Free Yellow Aspheric Preloaded*

AquaFree Yellow IOL is also available preloaded in the Accuject™ injection system. Push-type injector allows performing implantation within less than 5 seconds.

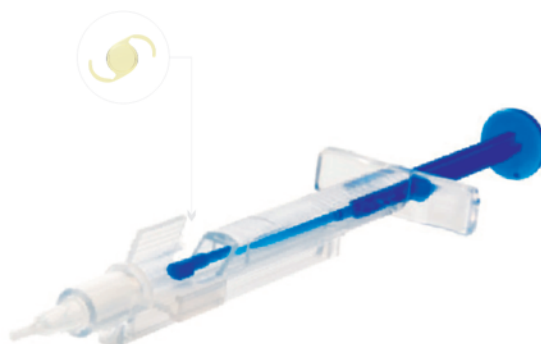

Advantages



- Increased contrast sensitivity
- Easy to inject, excellent folding and unfolding ability
- Not tacky – lens does not stick to itself or instruments
- No spherical aberrations



Minimized glare and unwanted images

HYDROPHILIC IOLs

	Hydro-Sense Aspheric*	Hydro-4 Aspheric*	Hydro-Sense Aspheric Yellow*
Min. incision size	2.20 mm	1.80 mm - suitable for MICS	2.20 mm
Power range	-5 .. +38 D	-5 .. +38 D	-5 .. +38 D
Overall diameter	12.5 mm	11 mm	12.5 mm
Optic diameter	6.0 mm	6.0 mm	6.0 mm
Self unfolding	Yes	Yes	Yes
Water content	23.5 – 27.5 %	23.5 – 27.5 %	23.5 – 27.5 %
Angulation	5°	5°	5°
Material	Hydrophilic Acrylic	Hydrophilic Acrylic	Natural Yellow Hydrophilic Acrylic
Refractive index	1.46	1.46	1.46
A-constant	118.7	118.7	118.7
UV Filter	Yes	Yes	Yes
Shelf Life	5 years	5 years	5 years

DISPOSABLE IOL INJECTOR AND CARTRIDGES

Medical Viscojet™ Eco is an injection system with unbeatable quality and performance in its price segment.

Single-use Viscojet™ Eco
IOL injection system
VE2200*

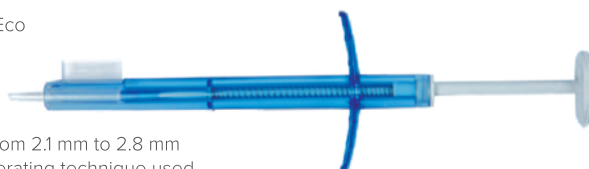

20
PER
BOX

Incision sizes range from 2.1 mm to 2.8 mm depending on the operating technique used

- For hydrophilic and hydrophobic 1-piece lenses
- Complete control of every step of lens injection
- Soft-tip technology

Single-use cartridge**
Used with RUMEX reusable IOL Injector 16-2853

CAT-22 for 2.2 mm incision
CAT-24 for 2.4 mm incision



NEW

20
PER
BOX

*Not available in the US
**Not available in Europe

DISPERSIVE OVDs

**MOST
POPULAR**

SUPREME* Ophthalmic Viscosurgical Device

Supreme is a dispersive viscoelastic solution of low molecular weight, highly purified grade of hydroxypropyl methylcellulose (HPMC) 2%, clear, isotonic, sterile, non-inflammatory and non-pyrogenic in nature. It is used for intraocular injection during anterior segment surgery.

Physico-chemical properties

Type	Dispersive
Material	2% HPMC
Molecular weight	86 000 Da
Viscosity	3 000–4 000 cSt
pH	6.0–7.8
Osmolality	250–350 mOsmol/kg
Volume	2 ml
Shelf Life	3 years

Advantages

- highly dispersive
- the best endothelial protection
- easy removal
- completely transparent
- no refrigeration necessary
- easy transportation and storage (2–35 °C)

Dispersive Solution

Supreme is used to:

- coat ocular structures during cataract surgery: in the initial part, during capsulorhexis and phacoemulsification, and during ultrasound
- protect corneal endothelium in an eye where endothelium pathology is suspected

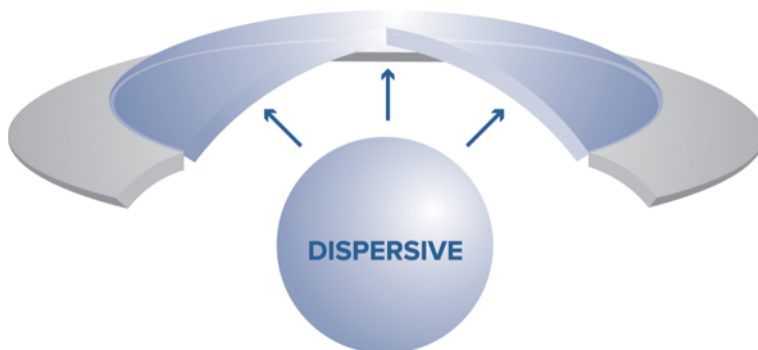

COHESIVE OVDs

SMARTVISC / SMARTVISC PLUS* Ophthalmic Viscosurgical Device

SmartVisc and SmartVisc Plus are cohesive viscoelastic solutions of high molecular weight used for intraocular injection during anterior segment surgery of the eye.

Physico-chemical properties

	SmartVisc	SmartVisc PLUS
Composition	Sodium Hyaluronate 1.6 %	Sodium Hyaluronate 3.0 %
Molecular Weight	1.2–2.0 m Da	1.0–1.8 m Da
Viscosity	approx. 80 000 mPas	approx. 400 000 mPas
Osmolality		270–400 mOsmol/kg
Storage		2–25°C
pH		6.8–7.4
Volume		1.00 ml
Shelf Life		3 ½ years

Advantages

- no refrigeration necessary
- good maintenance of anterior chamber depth and the capsular bag
- controlled capsulorhexis
- easy implantation
- better adhesiveness on the corneal endothelium during phacoemulsification
- favorable environment to ophthalmic surgery
- excellent protection against mechanical damages
- steam sterilized

Cohesive Solution

SmartVisc is used to:

- maintain space and pressure in the eye
- keep the empty capsular bag open for IOL insertion
- support the anterior chamber and flatten the anterior capsule
- dilate small pupils
- dissect areas of adhesion

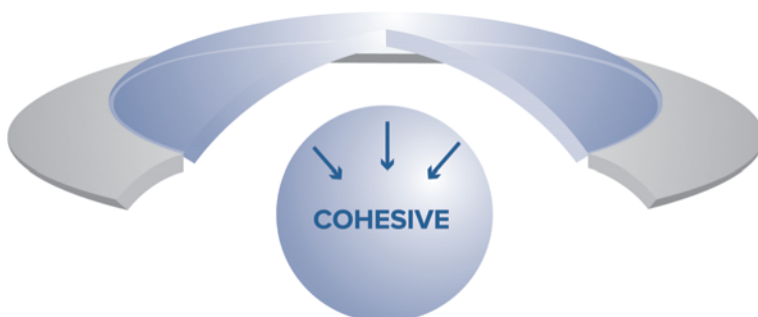

DISPOSABLE KNIVES

HIGH PRECISION DISPOSABLE KNIVES WITH SAFETY SYSTEM*

6
PER
BOX

All knives are equipped with safety function lids

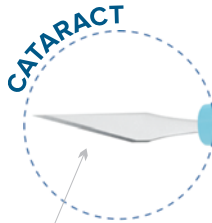
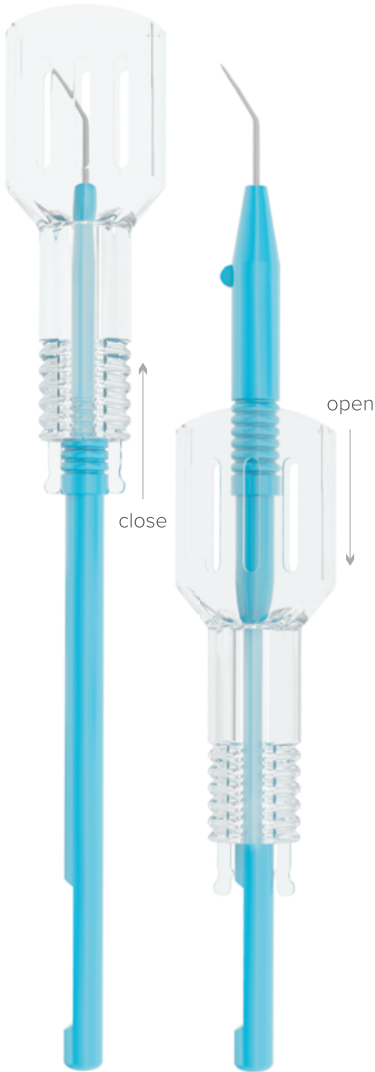

**MOST
POPULAR**

Side Port Knives

initial stab incisions
double bevel, straight
SP-15 1.00 mm, 15°
SP-30 1.00 mm, 30°
SP-45 1.00 mm, 45°

Exquisite sharpness for effortless penetration and withdrawal.

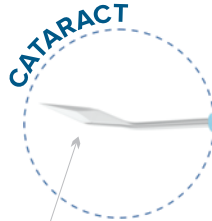

Paracentesis Knives

paracentesis/side port incisions
double bevel, angled
PK-11 1.10mm

Angled option of paracentesis knife helps to avoid blocking the spot of intended incision.

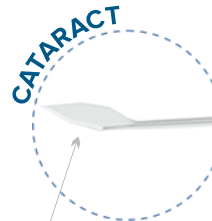

Trapezoidal Knives

tunnel incisions
single bevel, angled
TR-10 1.20-1.40 mm
TR-17 1.50-1.70 mm

Absolutely smooth surface and anti-glare coating ensures the maximal Intraoperative comfort.

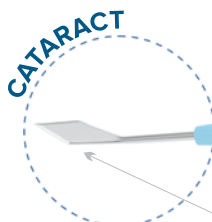

Slit Knives

scleral tunnel incisions
single bevel, angled
SL-22 2.20 mm **POPULAR**
SL-24 2.40 mm **POPULAR**
SL-26 2.65 mm
SL-27 2.75 mm
SL-28 2.80 mm **POPULAR**
SL-32 3.20 mm

Optimal design of cutting edges allows for performance of watertight corneal incisions.

DISPOSABLE KNIVES

6 PER BOX

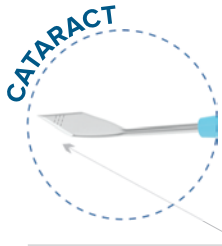

MOST POPULAR

Clear Corneal Knives

- clear cornea incisions
double bevel, angled
- CC-22 2.20 mm
 - CC-24 2.40 mm
 - CC-26 2.65 mm
 - CC-27 2.75 mm
 - CC-30 3.00 mm

Ultra-thin profile reduces penetration force and contributes to re-epithelization.

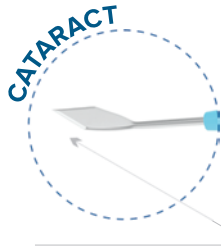

Clear Corneal Knives with Depth Indicators

- tunnel incisions
double bevel, angled
- CCD-22 2.20 mm
 - CCD-24 2.40 mm
 - CCD-26 2.65 mm
 - CCD-27 2.75 mm **POPULAR**

1.50 and 1.75 mm depth indicators of CCD-22 and 1.50, 1.75, 2.00 mm of CCD-24, CCD-26, CCD-27 ensure controlled diving.



MOST POPULAR

Crescent Knives

- lamellar dissections/flap formation
single bevel, angled
- CR-20 2.00 mm

Facet-free blade for smooth flap formation.



MOST POPULAR

MVR Knives

- posterior segment penetration/
side port incisions
multifacet
- VRS-19 19 Ga, **straight**
 - VRS-20 20 Ga, **straight**
 - VRS-23 23 Ga, **straight**
 - VRA-19 19 Ga, **angled**
 - VRA-20 20 Ga, **angled**
 - VRA-23 23 Ga, **angled**

Promotes safe and easy sclerotomy for vitreoretinal procedures. **POPULAR**

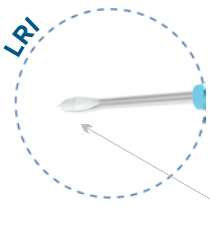

Pre-Set Knives

- groove making/limbal relaxing incisions
multifacet
- PD-60 600µm depth

Pre-set style blade allows for fixed cutting depth of 600 microns and clear view of patient's cornea.

Other sizes are available upon request

DISPOSABLE INSTRUMENTS FOR ANTERIOR SEGMENT

PVA SPEARS

Compressed lint-free PVA spears ideal for controlling and absorbing fluid in and around the orbital area during cataract and refractive procedures

180
BOX
BOX

R2-40405*

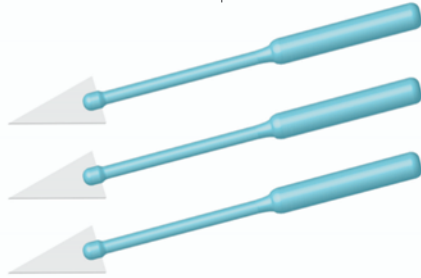

SPECULUMS

Barraquer Wire Speculum

14-022D

POPULAR

6
BOX
BOX



IRIS RETRACTORS

Safe and comfortable dilation and fixation of a rigid pupil.

Iris Retractors*

Strong yet flexible polypropylene hook for mechanical iris dilation
Vertical orientation for easy handling

4
BOX
BOX

10-5016-1

POPULAR

5
BOX
BOX

10-5067-1



DISPOSABLE INSTRUMENTS FOR ANTERIOR SEGMENT

FORCEPS

Perfectly aligned tips make every surgical manipulation safe and easy.

6
PER
BOX



Utrata Capsulorhexis Forceps

Cystotome Tips
Straight

4-0311D

POPULAR



Utrata Capsulorhexis Forceps

Cystotome Tips
Curved

4-0331D

**MOST
POPULAR**



Bonn-Catalano Corneal Forceps

0.12 mm, 1x2 Teeth
Straight

4-0551D



Castroviejo Suturing Forceps

0.12 mm, 1x2 teeth
Straight

4-0600D

POPULAR

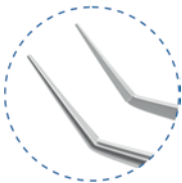

McPherson Tying Forceps

Angled

4-174D

POPULAR



McPherson Tying Forceps

Curved

4-177D

POPULAR

SCISSORS

Unique blade sharpening technology allows controlled cutting of various tissues with minimal pressure applied.

POPULAR



Vannas Capsulotomy Scissors

Sharp Tips

11-052D



Castroviejo Universal Corneal Scissors

Blunt Tips

11-012D



Westcott Tenotomy Scissors

Blunt Tips

11-040D

DISPOSABLE INSTRUMENTS FOR ANTERIOR SEGMENT

MANIPULATORS

Premium quality stainless steel ensures stiffness and flexibility of the working part.

6
BOX
BOX



Spatula for Femtosecond Laser Procedure

20-204D



Nagahara Phaco Chopper
RHD

7-063D

POPULAR



Kuglen Iris Hook
Angled

5-030D



Rosen Phaco Chopper
Universal

7-065D

POPULAR



Sinsky Hook
Angled

5-032D



Drysdale Nucleus Manipulator
Universal

7-093D



Lester Lens Manipulator
Angled

5-0331D

DISPOSABLE CANNULAS ANTERIOR SEGMENT*

ANTERIOR CHAMBER CANNULAS, RYCROFT

Used for maintaining and forming the anterior chamber by injecting or removing air, fluids, viscoelastics and intraocular medications.

21-R2023 23 Ga x 22 mm
21-R2025 25 Ga x 22 mm

21-R2030 30 Ga x 22 mm **POPULAR**
21-R2027-8 27 Ga x 22 mm **← MOST POPULAR**

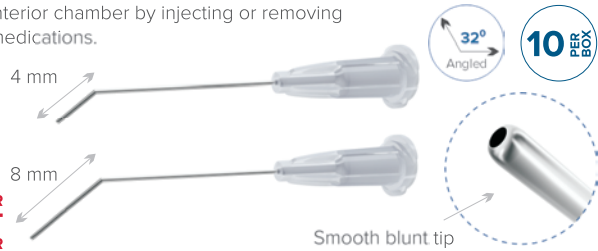

ANTERIOR CHAMBER MAINTAINER, LEWICKY

Provides control over the depth of the anterior chamber during eye surgical procedures.

21-R2520 20 Ga x 22 mm

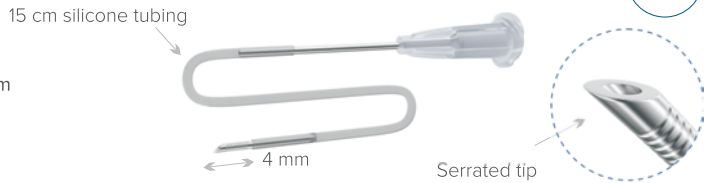

VISCOELASTIC CANNULAS

Used for injecting viscoelastic to all meridians of the anterior chamber and to coat the intraocular lens.

21-R2225 25 Ga x 22 mm **POPULAR**
21-R2227 27 Ga x 22 mm **← MOST POPULAR**

21-R2323 23 Ga x 22 mm
21-R2327 27 Ga x 22 mm **POPULAR**

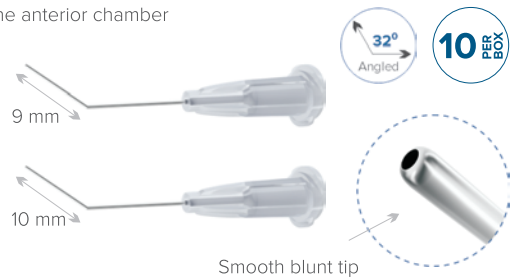

IRRIGATING CYSTOTOMES, PEARCE

Provides an easier access to the anterior capsule during the capsulorhexis.

21-R3027 27 Ga x 16 mm
21-R3330 30 Ga x 16 mm – for capsulotomy on deep-set eyes or small pupils

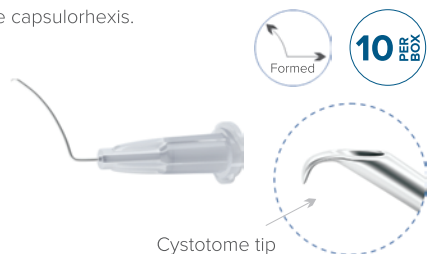

DISPOSABLE CANNULAS ANTERIOR SEGMENT

HYDRODISSECTION CANNULAS

Used for easy placement under the anterior capsule to deliver fluids to facilitate the separation of the cortex from the nucleus and capsule.



Hydrodissector, Pearce **MOST POPULAR**
21-R4025 25 Ga x 22mm



Spatulated tip

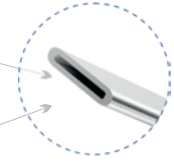

Hydrodissector, Pearce **MOST POPULAR**
21-R4027 27 Ga x 22mm



Hydrodissector
21-R4427 27 Ga x 22 mm



Smooth blunt tip

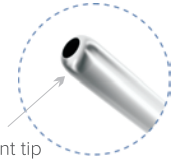

CORTEX EXTRACTOR, SIMCOE

Used to remove the tissue especially at the difficult 12'clock position with the top port for more effective aspiration.



21-R5023 23 Ga x 22 mm



Smooth blunt tip

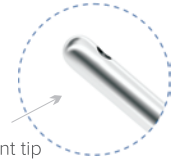

CANNULAS FOR ANESTHESIA



Retrobulbar Needle, Atkinson
 For injecting anesthetic agents into the muscle cone.

21-R1125 25 Ga x 38 mm



Sharp beveled tip

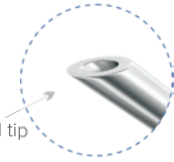

Sub-Tenon's Cannula
 For administering anesthetic agents into the posterior Sub-Tenon's space.

21-R1320 20 Ga x 25 mm **POPULAR**



Flattened tip

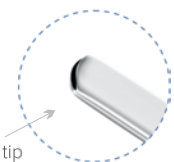

DISPOSABLE CANNULAS ANTERIOR SEGMENT*

LACRIMAL INTUBATION AND DACRYOCYSTORHINOSTOMY (DCR)

Designed for surgical treatment, repair and irrigation of the nasolacrimal system.

Lacrimal Intubation Set
21-R7004 27 Ga x 110 mm **MOST POPULAR**

21-R7004RD 27 Ga x 110 mm,
 With Retrieval Device

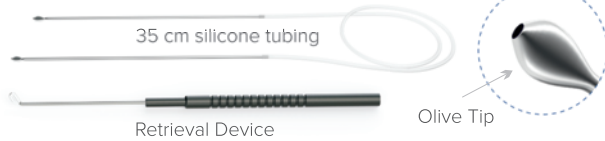

Lacrimal Intubation Set
21-R7001 23 Ga x 175 mm

21-R7011 20 Ga x 45 mm

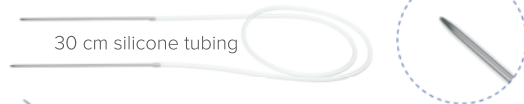

DCR Set
21-R7012 20 Ga x 45 mm



Lacrimal Intubation Tubing **MOST POPULAR**
21-R7002 30 cm silicone tubing

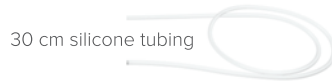

LACRIMAL CANNULA

Used for probing and irrigating the lacrimal duct.

21-R7021 21 Ga x 33 mm
21-R7026 26 Ga x 28 mm **MOST POPULAR**



LASIK CANNULA, LINDSTROM

Used after ablation to wash away particulates from anterior and posterior sides of the flap and stromal bed.

3 ports
21-R7430 25 Ga X 25.4 mm

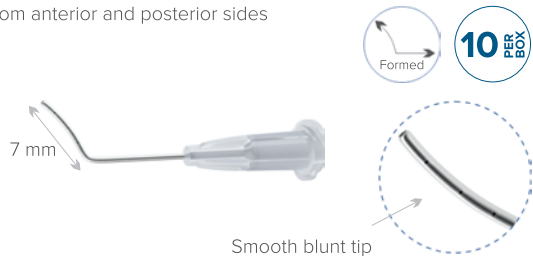

*not available in Europe

Product design and/or features that do not influence its functionality and main parameters are subject to change.

DISPOSABLE INSTRUMENTS FOR POSTERIOR SEGMENT

STAINLESS STEEL FORCEPS AND SCISSORS*

All stainless steel instruments are manufactured as an integral tool with an intact inner spring mechanism that provides for precise performance and instant tactile control.

6
PER
BOX



Eckardt End-Gripping Forceps

12-410-23D 23 Ga **POPULAR**
12-410-25D 25 Ga



End-Grasping Forceps

12-420-23D 23 Ga
12-420-25D 25 Ga



Gripping Forceps
with a "crocodile platform"

12-304-23D 23 Ga
12-304-25D 25 Ga



Gripping Forceps

12-301-23D 23 Ga
12-301-25D 25 Ga



Pick Forceps

12-325-23D 23 Ga
12-325-25D 25 Ga



Curved Scissors

12-209-23D 23 Ga
12-209-25D 25 Ga

DISPOSABLE INSTRUMENTS FOR POSTERIOR SEGMENT

SCISSORS AND FORCEPS WITH PLASTIC HANDLE*

360-degree handle design incorporates a unique rotatability, convenience, and actuation.

NEW

6
PER
BOX



- 23 Ga
- 25 Ga
- 27 Ga

The instrument's weight is less than 8 grams.
Lightweight plastic ergonomic handle especially valuable during hours-long surgeries.



Eckardt End Gripping Forceps

- 12-410-23DP** 23 Ga
- 12-410-25DP** 25 Ga
- 12-410-27DP** 27 Ga



Gripping Forceps

with a "Crocodile Platform"

- 12-304-23DP** 23 Ga
- 12-304-25DP** 25 Ga
- 12-304-27DP** 27 Ga



Curved Scissors

- 12-209-23DP** 23 Ga
- 12-209-25DP** 25 Ga
- 12-209-27DP** 27 Ga

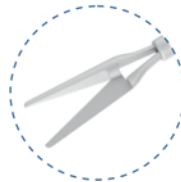

Straight Scissors

- 12-211-23DP** 23 Ga
- 12-211-25DP** 25 Ga
- 12-211-27DP** 27 Ga



Vertical Scissors

- 12-202-23DP** 23 Ga
- 12-202-25DP** 25 Ga

*not available in Europe and USA

Product design and/or features that do not influence its functionality and main parameters are subject to change.

DISPOSABLE INSTRUMENTS FOR POSTERIOR SEGMENT

DISPOSABLE DIAMOND DUSTED RETRACTABLE ILM ELEVATORS*

Used to elevate membrane edge during vitreoretinal surgery.



NEW

5
PER
BOX



12-7523 23 Ga
12-7525 25 Ga

Diamond dusted soft silicone tip provides an extreme grip.

Retractable version for easy insertion through the trocar valves.

DISPOSABLE BACKFLUSH INSTRUMENTS*

The instruments combine the ergonomic handle with soft, brush or blunt tip cannulas into one instrument.

The set comes with two connectors for active and passive aspiration.

Used for intraocular fluids and debris aspiration during vitreoretinal surgery.

- 23 Ga
- 25 Ga
- 27 Ga



NEW

6
PER
BOX

With silicone brush tip

12-5162H 23 Ga x 34 mm
12-5160H 25 Ga x 34 mm
12-5167H 27 Ga x 34 mm



With blunt tip

12-5164H 23 Ga x 34 mm
12-5156H 25 Ga x 34 mm
12-5492H 27 Ga x 34 mm

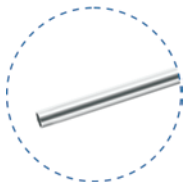

With silicone soft tip

12-5161H 23 Ga x 34 mm
12-5152H 25 Ga x 34 mm
12-5491H 27 Ga x 34 mm



SILICONE OIL

SILICONE OIL

SMARTSIL 1000/5000*

Purified Silicone Oil for Vitreoretinal Surgery

SmartSil 1000/5000 is used for prolonged tamponade after surgical treatment for severe retinal detachment.

- Maximum interfacial tension and minimum interactions between tissues, cells, and endo-tamponades media
- Optimal combination of specific gravity, refractive index and surface tension
- The choice of viscosity for a balance between easy injection and a stable temporary tamponade



***Not available in the US**

*To be used with RUMEX Silicone Oil Infusion Systems 12-RTUB-1 (2,3 or 4)

Physico-chemical properties

Interfacial tension	≥ 40 mNm ⁻¹ at 37°C
Density	0.97
Viscosity	1000/5000 cSt
Refractive index	1.40
Volatility	< 1%
Polydispersity	< 2.8
Volume of oil	10 ml
Syringe	20 ml
Shelf life	3 years

SILICONE OIL CANNULAS

Viscous Fluid Injection Cannula**

Allows injection of viscous fluids such as silicone oil through 23 Ga or 25 Ga trocar cannula

12-5248 23 Ga x 4 mm
12-5258 25 Ga x 4 mm **NEW**

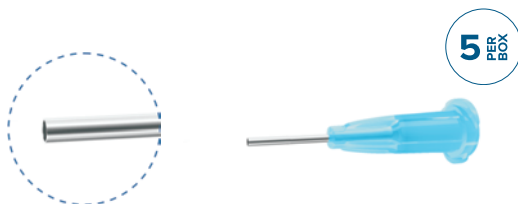

***Not available in the US**
****Not available in Europe**

Product design and/or features that do not influence its functionality and main parameters are subject to change.

DISPOSABLE TROCAR SYSTEMS

6
PER
BOX

One Step Trocar System*

Disposable Trocar Systems with closure valves

Package includes:

- Trocar knife with preloaded trocar cannula – 3 pcs
- Self-sealing trocar cannula (preloaded) – 3 pcs
- Universal infusion line – 1 pc

12-5229 23 Ga ●

12-5244 25 Ga ●

12-5227 27 Ga ● **NEW**

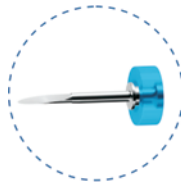

Trocar Knife

Spear point (MVR style) blade helps create a smooth incision and provides for low pressure insertion and superior sealing



Trocar Cannulas

Stainless steel cannulas are equipped with the silicone valves, that eliminate the need for plugs and promote easy instrument insertion

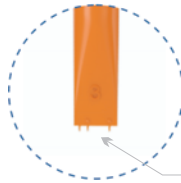

Trocar Cannula Inserter

the proximal end of the plastic handle (opposite to the knife) can be used as a caliper (2 dimensions, 3.00 and 4.00 mm) and a scleral marker

Universal Infusion Line for BSS



DISPOSABLE VITREORETINAL CANNULAS*

DUAL BORE CANNULA

Simultaneous infusion of PFC and aspiration of intraocular fluids

12-5203 23 Ga x 33 mm
12-5205 25 Ga x 33 mm **NEW**

BSS
 PFCL

↔ Straight

5 PER BOX

Dual Bore tip

CANNULAS FOR BACKFLUSH INSTRUMENTS

Used for retrograde flushing of incarcerated tissue during aspiration of intraocular fluids in during vitreoretinal ophthalmic surgeries.

Soft Tip Cannulas

Allows for atraumatic aspiration of subretinal fluid

- 12-5161** 23 Ga x 34 mm ← **MOST POPULAR**
12-5152 25 Ga x 34 mm ← **POPULAR**
12-5491 27 Ga x 34 mm **NEW**

Soft tip



Brush Tip Cannulas

Ideal for atraumatic brushing of retina

- 12-5162** 23 Ga x 34 mm
12-5160 25 Ga x 34 mm
12-5167 27 Ga x 34 mm **NEW**

Brush tip

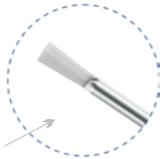

Charles Flute Cannula

Designed for debris and blood aspiration from the posterior segment

- 12-5164** 23 Ga x 34 mm
12-5156 25 Ga x 34 mm
12-5492 27 Ga x 34 mm

Smooth blunt tip

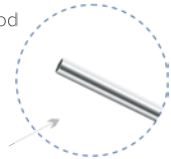

DISPOSABLE REPLACEMENT RESERVOIRS FOR BACKFLUSH HANDLE

Replacement Reservoir for Backflush Handle

- 12-5159** Active Aspiration
12-5147 Passive Aspiration

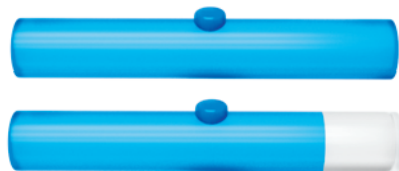

DISPOSABLE CANNULAS GAUGE CONVERSION CHART

A hub of each cannula has a different color according to its Gauge.
Please see the cannula gauge conversion chart below to learn more.

Gauge	Inner Diameter		Outer Diameter		Colour
	In	mm	In	mm	
19G	.028	.70	.043	1.10	
20G	.024	.60	.036	.90	
21G	.020	.51	.032	.80	
22G	.016	.41	.028	.70	
23G	.013	.33	.025	.60	
24G	.012	.30	.022	.55	
25G	.010	.25	.020	.50	
26G	.010	.25	.018	.45	
27G	.008	.20	.016	.40	
30G	.006	.15	.012	.30	

DISPOSABLE CANNULAS

CANNULA TIPS BY PROCEDURE

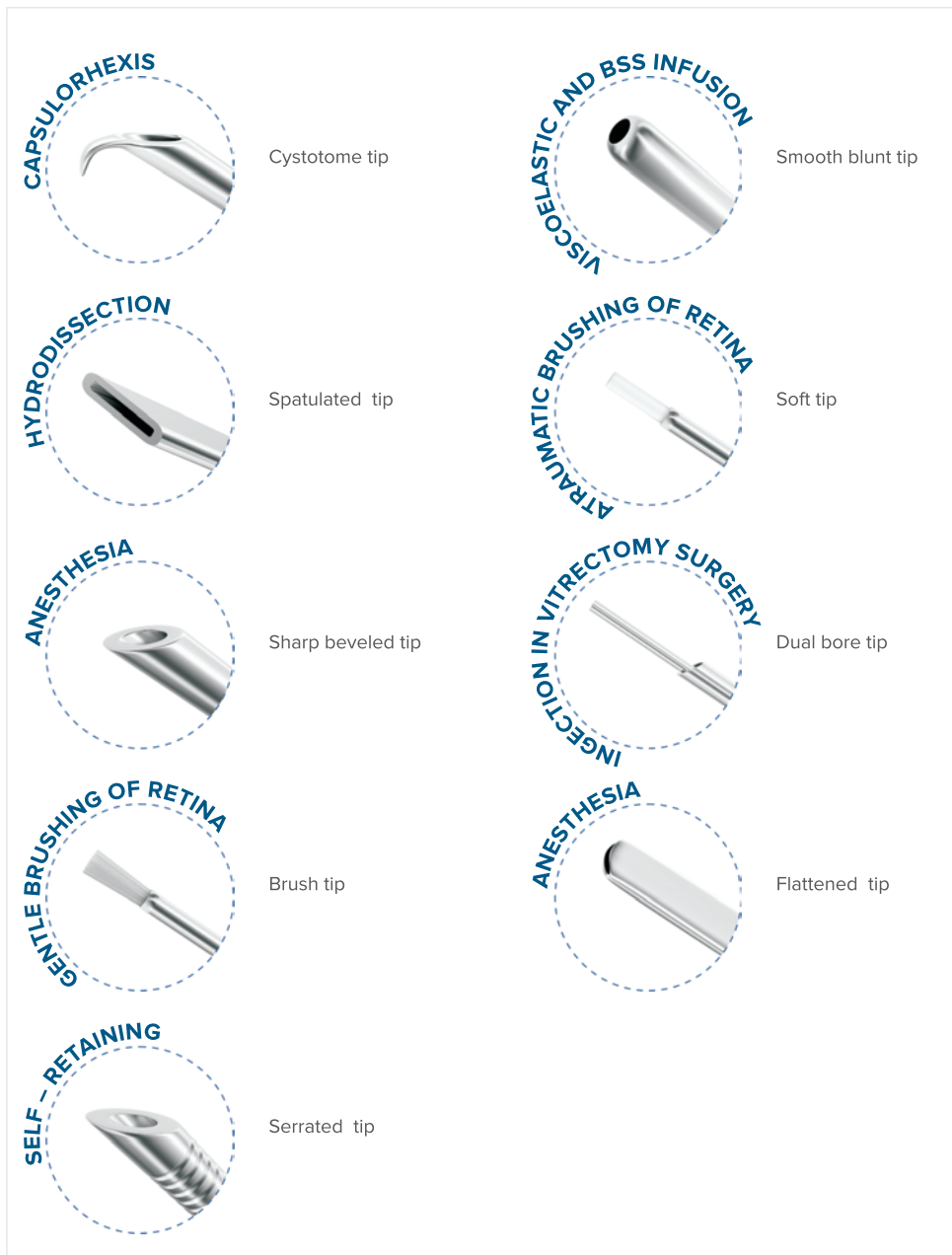

RUMEX International Co.
14240 Carlson Circle, Building K,
Suite 8, Tampa, FL 33626

USA & Canada

☎ +1 (727) 535 9600

☎ +1 (877) 77 RUMEX (Toll-Free)

■ +1 (727) 535 8300

Europe, Asia, Africa, Latin America

☎ +371 6616 3182

✉ rumex@rumex.com

🏠 www.rumex.com

