

ChimeBuster – TJ Wrangler



Fitting and programming instructions

'ChimeBuster' overrides the chime that occurs when the driver's door is opened with the key still in the ignition. The continuous chime "encourages" you to remove the keys from the ignition – however when off road this practice can easily lead to losing the key with all its associated problems.

ChimeBuster is designed for off road application - It is the user's obligation to confirm that its operation complies with local legal requirements.

Fitment:

To ensure reliability in the harsh 4WD environment we recommend all connections are soldered and protected with 'heatshrink' or even better; 'glueshrink' sleeving.

Tools Required:

Insulation tape, soldering iron/solder, shrink sleeving, heat gun (or equivalent) wire cutters and a small sharp knife.

Package Contents:

- 1 x ChimeBuster module
- 1 x Double sided adhesive tape
- 1 x Instructions

Wiring Detail:

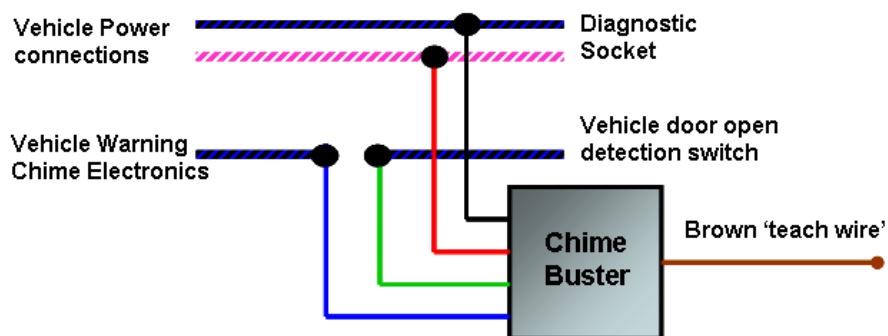

Installation:

1. Disconnect the battery (good practice for all electrical work).
2. Remove the 2 screws holding the RH speaker grill in place and unclip it (clips in at top and bottom). Remove the foam surround and undo the 4 speaker mounting screws, unplug and carefully remove the speaker.

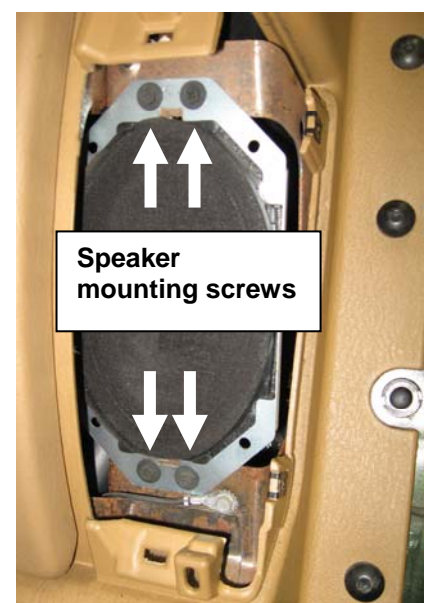
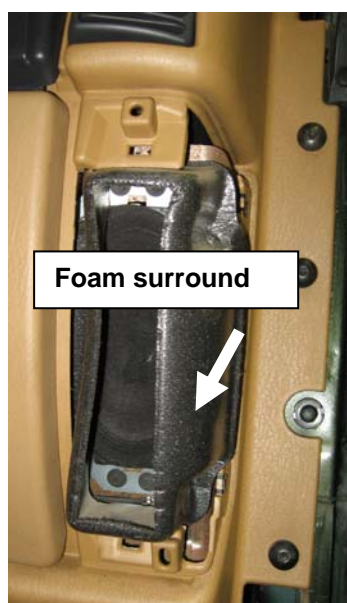
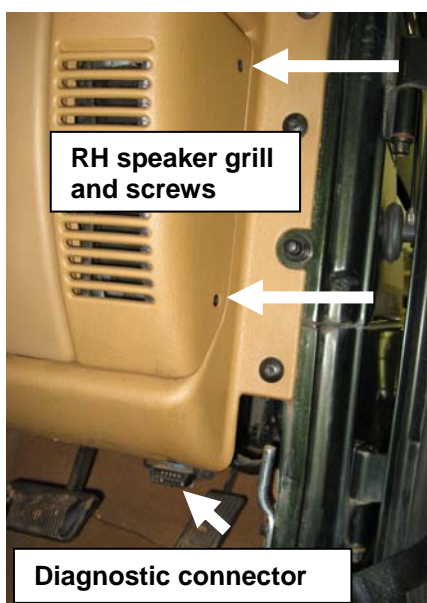

3. Behind the speaker area locate the wiring harness that comes from the door detection switch. Un-tape and peel back the harness insulation. Locate and cut the black/light blue wire (cut and use 'brown' wire instead if model has only 2 wires going to door detection switch), slide heatshrink over the cut wire and solder the blue wire from ChimeBuster to the black/light blue wire end coming from the vehicle harness. Repeat the process with the green wire from ChimeBuster to the black/light blue wire end coming from the door detection switch. Re-tape the harness insulation.

Tip: DO NOT cut the ChimeBuster wires too short, the wires can be tucked away later. This will allow easy wiring and provide more options for mounting locations. At this stage also consider if you wish of use some form of insulation sleeving over the wires before connecting.

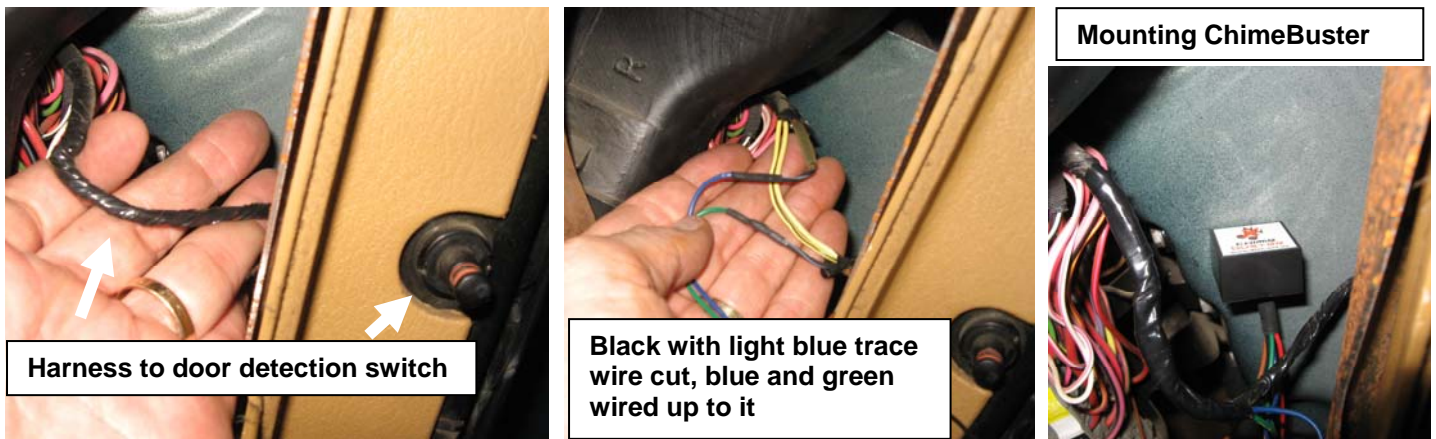

Note: Some TJ only have 2 wires to door detection switch, in this case wire into the brown wire (not black/light blue)

4. Mount ChimeBuster in a convenient location using the double sided tape provided (clean the surfaces thoroughly with an 'alcohol wipe' to degrease). ChimeBuster can also be simply 'cabled tied' out of sight under the dash panel if you wish, but allowing for future access to the brown 'teaching wire' should be considered.
5. Beneath the dash area (below area you removed speaker from) is the vehicles diagnostic socket; undo the 2 mounting screws and pull down to allow good access to the wiring. Un-tape and peel back the harness insulation.

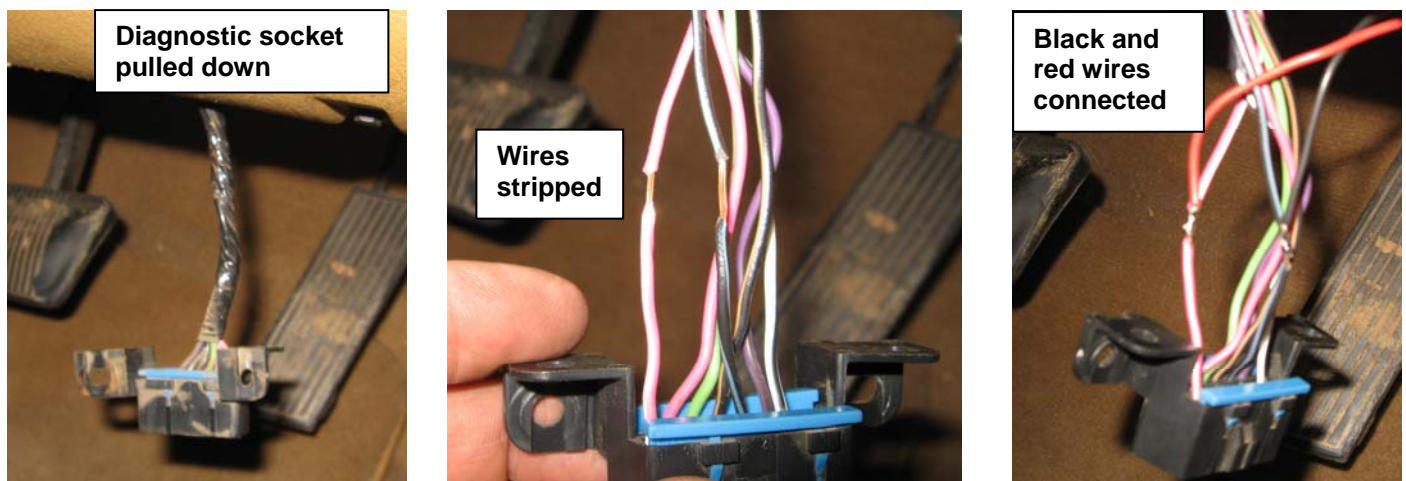

6. Connect the ChimeBuster black wire to a black/light blue wire (pin 4 of diagnostic connector) in the harness by carefully removing the insulation (NOT cutting the wire). Solder and use insulation tape to protect the finished connection. Repeat the process connecting the ChimeBuster red wire to the pink/white wire (pin 16 of diagnostic connector) in the harness. Re-tape the harness insulation.
7. Ensure the ChimeBuster brown 'teach wire' is not touching any metal (wrap some tape on it temporarily). Restore removed components to original position; ensure the harnesses aren't unduly forced or rubbing on any sharp edges.



Testing and setting the chime period after fitment:

When the battery is reconnected ChimeBuster will be in its default setting, providing approximately a 5 second chime period (i.e. chime will sound for 5 seconds and then turn off). This was chosen as it gives sufficient warning of a door being ajar (a very important safety consideration!) without being too annoying.

Chime settings are permanently stored even if the battery is disconnected. They can be altered as many times as you wish. When finished programming ensure the brown wire is tucked away and cannot contact vehicle ground accidentally.

To alter the Chime setting -

Factory setting- With drivers door open, ignition off, key in lock, hold the brown teach wire to vehicle ground (a metal surface, battery negative or a bare bolt head) for less than 5 seconds. The chime will stop when the teach wire is removed from ground, indicating successful setting.

ChimeBuster default setting - With the drivers door open, ignition off, key in lock, hold the brown teach wire to vehicle ground (a metal surface, battery negative or a bare bolt head) for more than 5 seconds, but less than 10 seconds. The chime will pause momentarily after the first 5 seconds has passed and then again when ground is removed, indicating successful setting.

Delay of your choice (up to 5 min) - The chime period time setting will begin at the 10 second point until the ground is removed (i.e. if the brown wire is held to ground for 50secs, then time setting will be 40secs). With drivers door open, ignition off, key in lock, hold the teach wire to vehicle ground (a metal surface, battery negative or a bare bolt head) for more than 10 seconds, but less than 5 minutes. The chime will cease momentarily after 5 and 10 seconds have passed and then again when ground is removed, indicating successful setting.

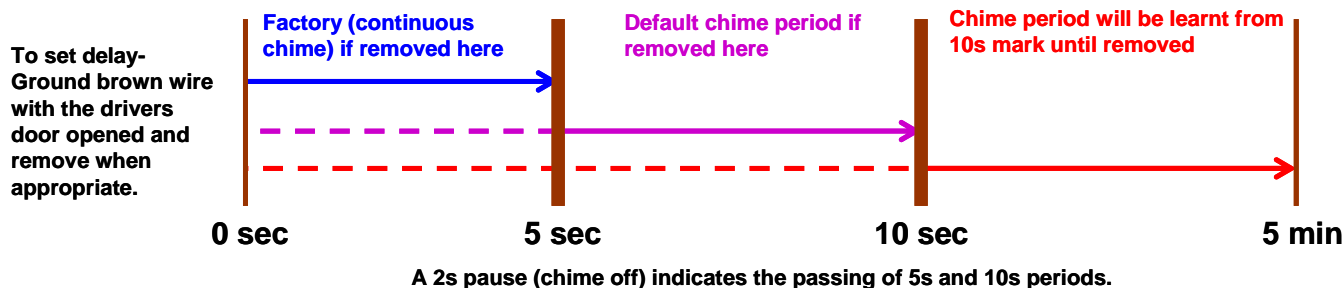

Note: The minimum delay setting will generally still result in a single "chime". A small delay is needed so the vehicles computer can receive the information it requires to control its outputs, it also allows a brief door ajar alert for safety!