

BASE 200P SYSTEM - LOAD CLASS A15-C250

8" (200mm) BASE PLASTIC TRENCH DRAIN

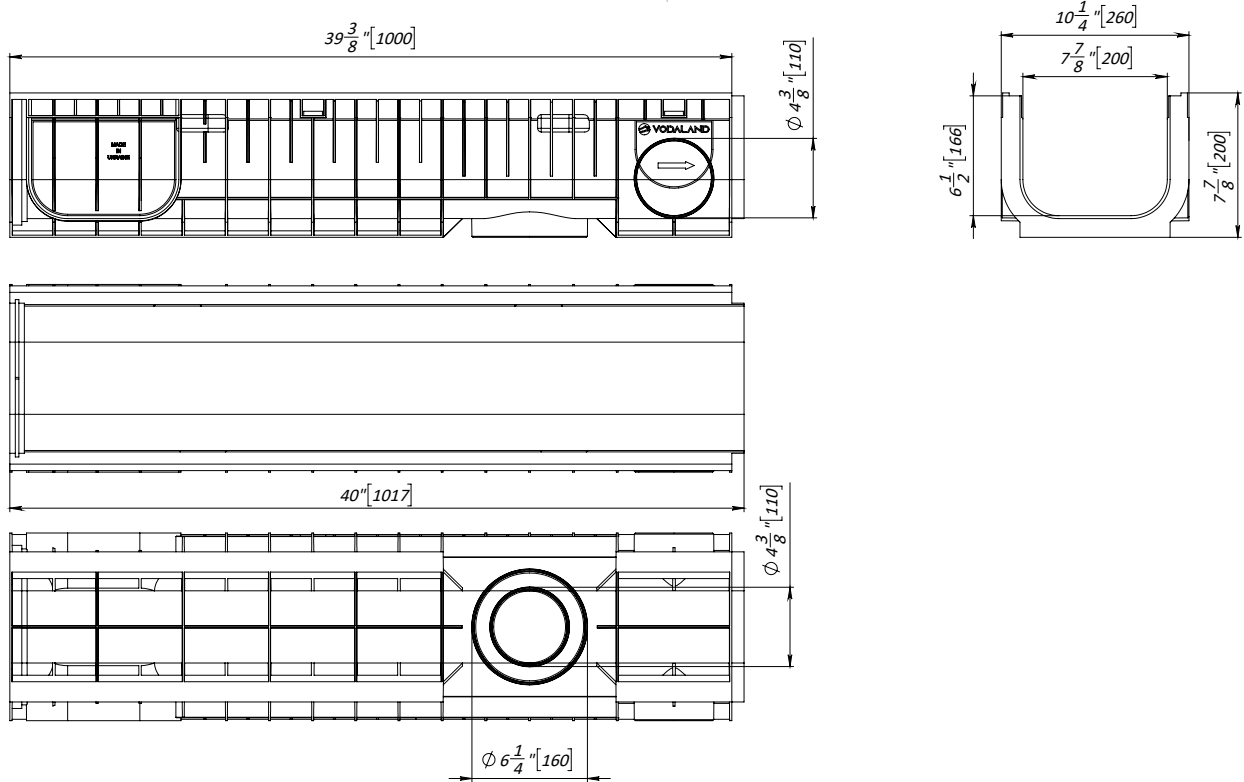

General: The trench drain shall be Vodaland Canada BASE 200P as manufactured by Vodaland or approved equal.

Specification: BASE 200P trench drain shall be 39.4" (1000mm) long and the nominal clear opening shall be 8" (200mm) with 10.2" (260mm) overall width and 7.9" (200mm) height. Channels shall be manufactured from UV stabilized 100% recycled polypropylene. Units shall have male-to-female interlocking joints that will not separate during the installation. Channels shall have a radiused self cleaning bottom with a Manning's coefficient of 0.009 and neutral 0% built in slope. Gratings shall meet the system load class specified. Channels and grate shall withstand a required EN1433 load class.

Notes:

1. See flow rate chart for channel flow rates.

Neutral channel

Name	Item #	H, in	H, mm	W, lb
8" BASE neutral channel H7.9"	8540-UA	7.9	200	8

Notes:

1. Channel has a side outlet Ø110mm and bottom outlets Ø110mm and Ø160mm.
2. Channels feature 90-degree connection on each side.

BASE 200P SYSTEM - LOAD CLASS A15-C250
8" (200mm) BASE PLASTIC TRENCH DRAIN
Flow rate chart

Slope	GPM		L/s	
	70% water fill	100% water fill	70% water fill	100% water fill
0.5% slope	483.11	763.81	30.48	48.19
1% slope	683.29	1080.18	43.11	68.15

Grating options

Name	Item #	Load class
Galvanized steel grate slotted (1m)	25101	A15
Stainless steel grate slotted (1m)	25901	A15
Galvanized steel grate ADA (1m)	252018	A15
Stainless steel grate ADA (1m)	255018	A15
Ductile cast iron grate slotted (0.5m)	25303	C250
Ductile cast iron grate mesh (0.5m)	25403	C250
Ductile cast iron grate ADA (0.5m)	25403-ADA	C250

Notes:

1. For detailed grate drawings refer to Vodaland Canada website or consult with one of our professionals.

Other accessories

Name	Item #
Mounting brackets	6104
Rebar bracket supports	RBR10G-450
4" PVC pipe adapter	6815-4