

$39\frac{1}{4}$ " [998]

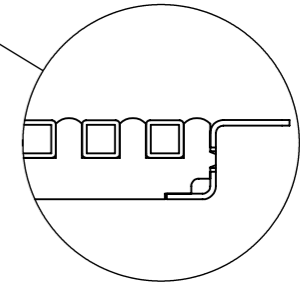

$2\frac{3}{4}$ " [71]

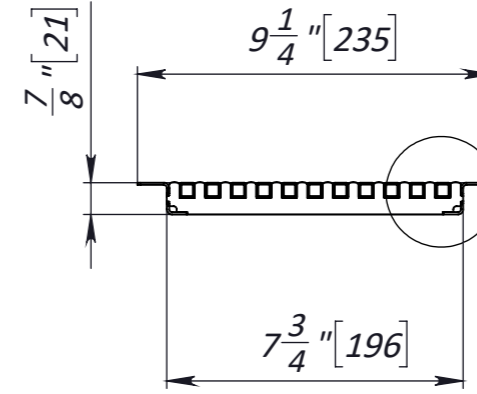
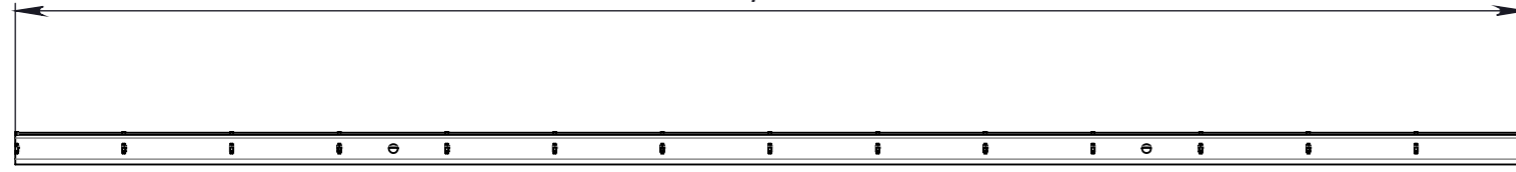
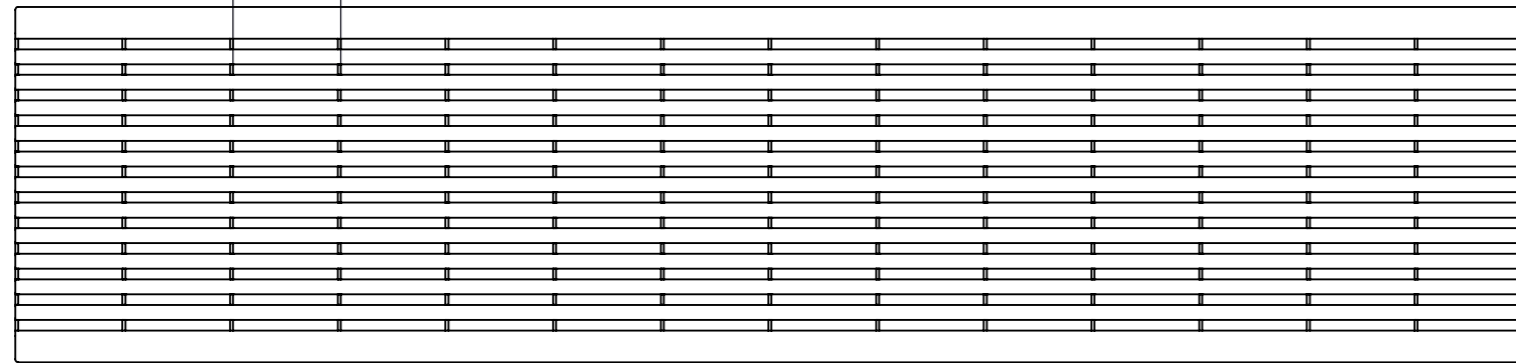

$\frac{1}{4}$ " [7]

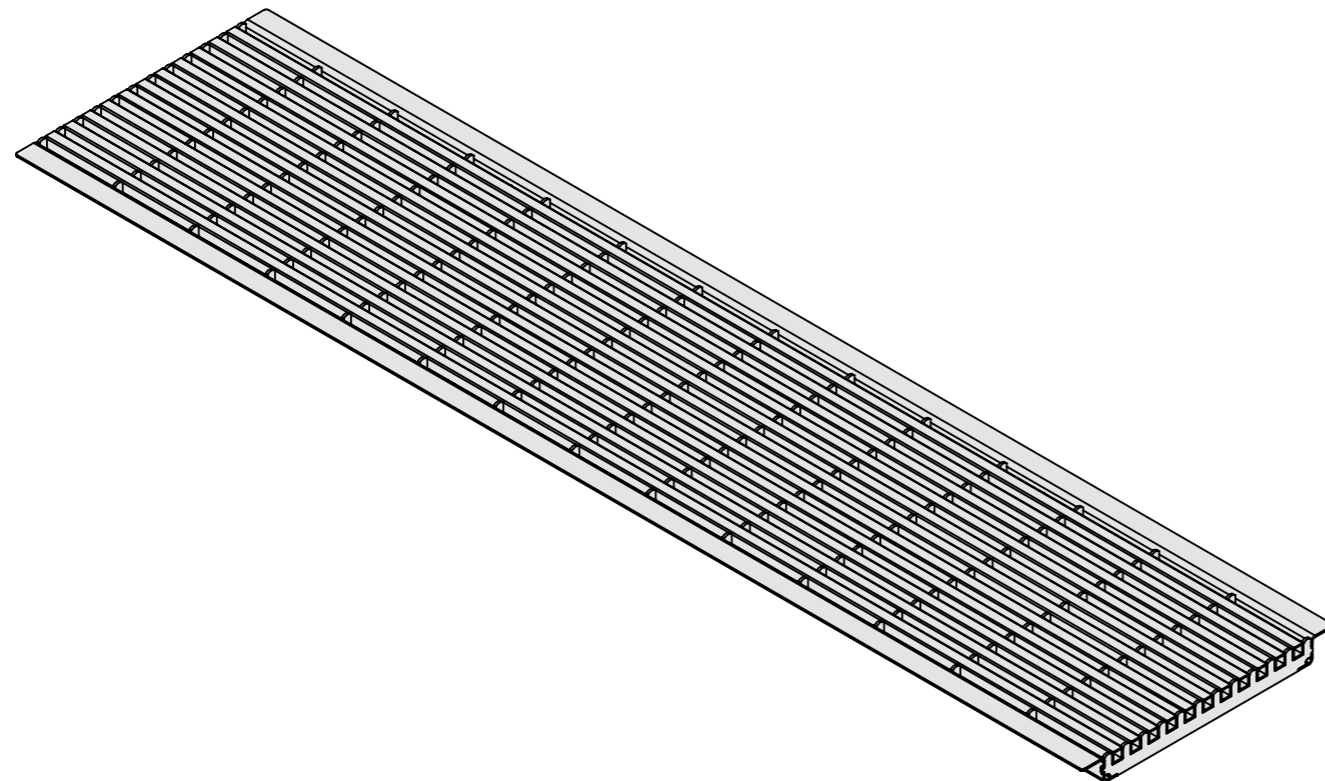

Area of water intake slot 125 sq in [820 cm²]

1. Dimensions for reference, inch [mm]
2. Hot dip galvanized according to ISO 1461:2009
3. Delivery and packaging are carried out in accordance with the terms of the contract
4. The manufacturer reserves the right, without notice to the consumer, to make changes to the design of the products for improvement of their technological and operational parameters, which will not affect the quality and properties of the product.

UNLESS OTHERWISE SPECIFIED: DIMENSIONS ARE IN MILLIMETERS SURFACE FINISH: TOLERANCES: ISO 2768-m LINEAR: ANGULAR:		FINISH: Hot dip galvanized		DEBURR AND BREAK SHARP EDGES		DO NOT SCALE DRAWING		REVISION	
DRAWN M.YUM		SIGNATURE		DATE 21.07.22		TITLE: 8" Base Galvanized Steel Heelproof Grate A15		Load class A15	
CHK'D		MFG		MATERIAL: Galvanized Steel		ARTICLE: 252018		A3	
APPV'D		Q.A		WEIGHT: 11,8 lb /5.38kg		SCALE:1:5		SHEET 1 OF 1	