



Video
User
Guide

Installing SleekStrip®

▲ If your phone is equipped with wireless charging capability, be sure to use the Installation Tool to position SleekStrip® correctly on your phone to avoid blocking the wireless charging coil in the phone.

Burn risk: Placing SleekStrip® too close to the center of the phone (where the wireless charging coil is located) may cause SleekStrip® to become hot during wireless charging.

▲ SleekStrip® CAN NOT adhere well to fabric surface.

For glass or silicone surface, must use the Auxiliary Adhesive Film before attaching SleekStrip®.

When removing SleekStrip®, weak/fragile/delicate surface such as leather might be damaged. Use at your own discretion.

IN THE PACKAGE



Clean the mounting surface with the enclosed alcohol wipe.



Decide where to mount SleekStrip®.



▲ For glass-backed phone WITHOUT case, glass phone case, or silicone phone case: Must apply enclosed Auxiliary Adhesive Film to the back of your phone before attaching SleekStrip®. Use the Installation Tool to position the film.

▲ For glass-backed phone WITHOUT case, glass phone case, or silicone phone case: Must apply enclosed Auxiliary Adhesive Film to the back of your phone before attaching SleekStrip®. Use the Installation Tool to position the film.



Use the Installation Tool to position and mount SleekStrip®.



Adhesiveness:
50% of full strength in 20 min;
90% of full strength in 24 hours;
100% in 3 days.
Please wait at least one day before use.

ENJOY!

Removing SleekStrip®

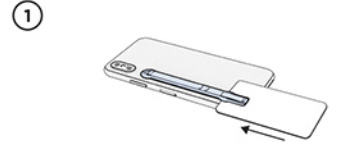

Use a plastic card to separate SleekStrip® from the mounting surface.
DO NOT use sharp metal such as knife as it can cause injury or damage to your phone.

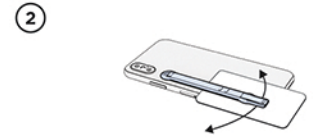

About half way through, rotate SleekStrip® horizontally until it comes off the mounting surface completely.
DO NOT pull up SleekStrip® vertically. Doing so could damage the back panel of your phone.

Using SleekStrip®

OPEN

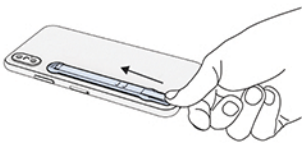

CLOSE

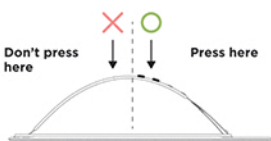

USE

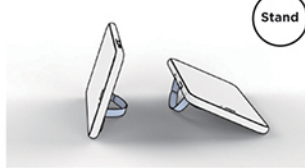

Stand



Grip



Most Car Mounts



Most Wireless Chargers**

SPECS

Materials :
Zinc alloy, Steel,
PU leather
Weight : 10g

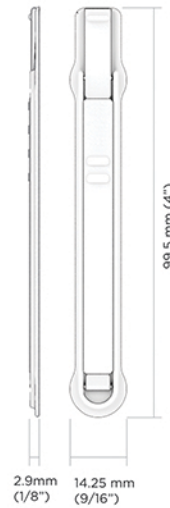

WARRANTY

For warranty and return policy, please visit: www.sleekstrip.com/return-policy-warranty

This warranty does not cover problems that result from abuse, accident, or misuse. It does not cover uses not in accordance with the instruction manual. It does not cover commercial use of the product. In no event shall iQOOL Design Products Inc. be liable for any direct, indirect, punitive, incidental, special consequential damages whatsoever arising out of or connected with the use or misuse of its products.

*Due to the variety of types of glass and silicone, we do not guarantee sufficient adhesiveness of the Auxiliary Adhesive Film on all types of glass and silicone surface. Please use with caution.

**SleekStrip® must be installed by using the Installation Tool. Wireless charging is also effected by the thickness of phone case and wireless charger's charging distance.

www.SleekStrip.com

@sleekstrip

#sleekstrip

Customer Support
support@sleekstrip.com

Sales Inquiry
sales@sleekstrip.com

Designed by
© iQOOL Design Products Inc. Canada

Manufactured in China
U.S. Patent-pending
SleekStrip® is a trademark of
iQOOL Design Products Inc.,
registered in the U.S.
and other countries.