

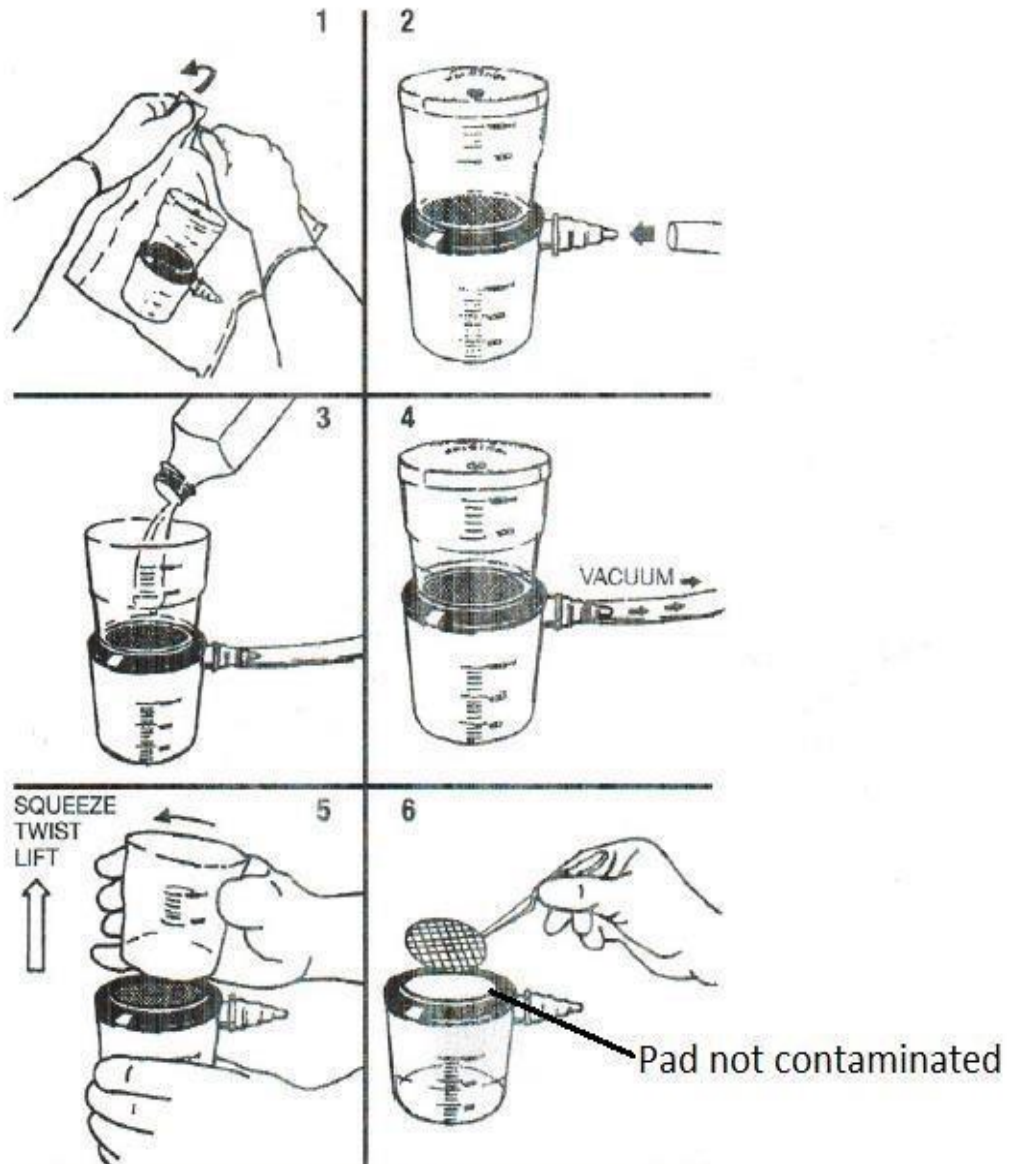

## Direction for Membrane Filtration Device



1. Open the sealed bag
2. Insert the syringe tube
3. Remove the lid of the barrel and pour your sample
4. Put the lid back on the barrel and pull the plunger to cause a vacuum
5. After all the liquid sample is vacuumed, twist and lift the barrel (lubricating the gasket with petroleum jelly will make it easier to lift the barrel off for subsequent usage)
6. Using a sterile forceps, lift the membrane filter and place it on the card. (The pad under the membrane filter is not contaminated and can be reused unless it's damaged.)
7. To reuse the membrane filtering device, just dip the top barrel into boiling hot water for 1 or 2 seconds to sterilize it. This will kill non-spore-forming bacteria.