

Grandi Tower User Manual

Before using: For Your safety, please read and understand this manual before using your product.

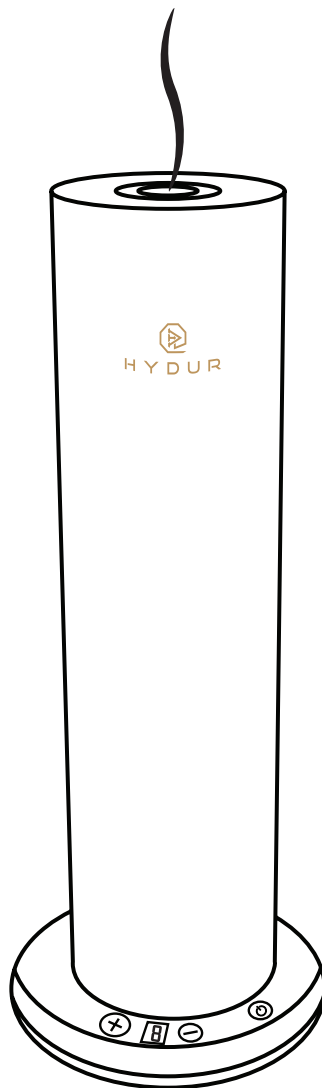

10 Scent Intensity
Schedules



Up to 50sqm
Coverage



120ml Oil
Capacity



Mobile app
Bluetooth Operated

Product Name: Hydur, The Grandi Tower diffuser

Color: Gold/Black/Silver/Titanium

Coverage: Up to 50m²/150m³/5300ft³

Dimensions: (H) 297 mm x (W) 112 mm x (D) 112mm

Net weight: 1.30 kg

Gross weight: 1.71 kg

Oil Consumption: 0.04ml - 0.4ml per hour

Power: 5.0 Watts

Voltage: DC12V

Container capacity: 120 ml

Accessories: Power adapter

Charging time: 8 hours on mode 3

Environment: Indoor



Waste electrical products should not be disposed of with household waste. Separate disposal facilities exist, for your nearest facilities see www.recycle-more.co.uk

Specification

Our Grandi Tower is one of our most powerful machine which uses nebulisation technology makes it ideal for large spaces. Stylishly designed yet nimble to be part of an interior with minimal invasion space. With sufficient oil storage, this machine will diffuse for a long period of time before needing a refill.

Operated by Bluetooth using the Hydur scenting app, you are able to control your diffusion levels and set to continuous diffusion or set it based on your preferred time and day.

With a ten-intensity diffusion setting, this diffuser is impeccable.

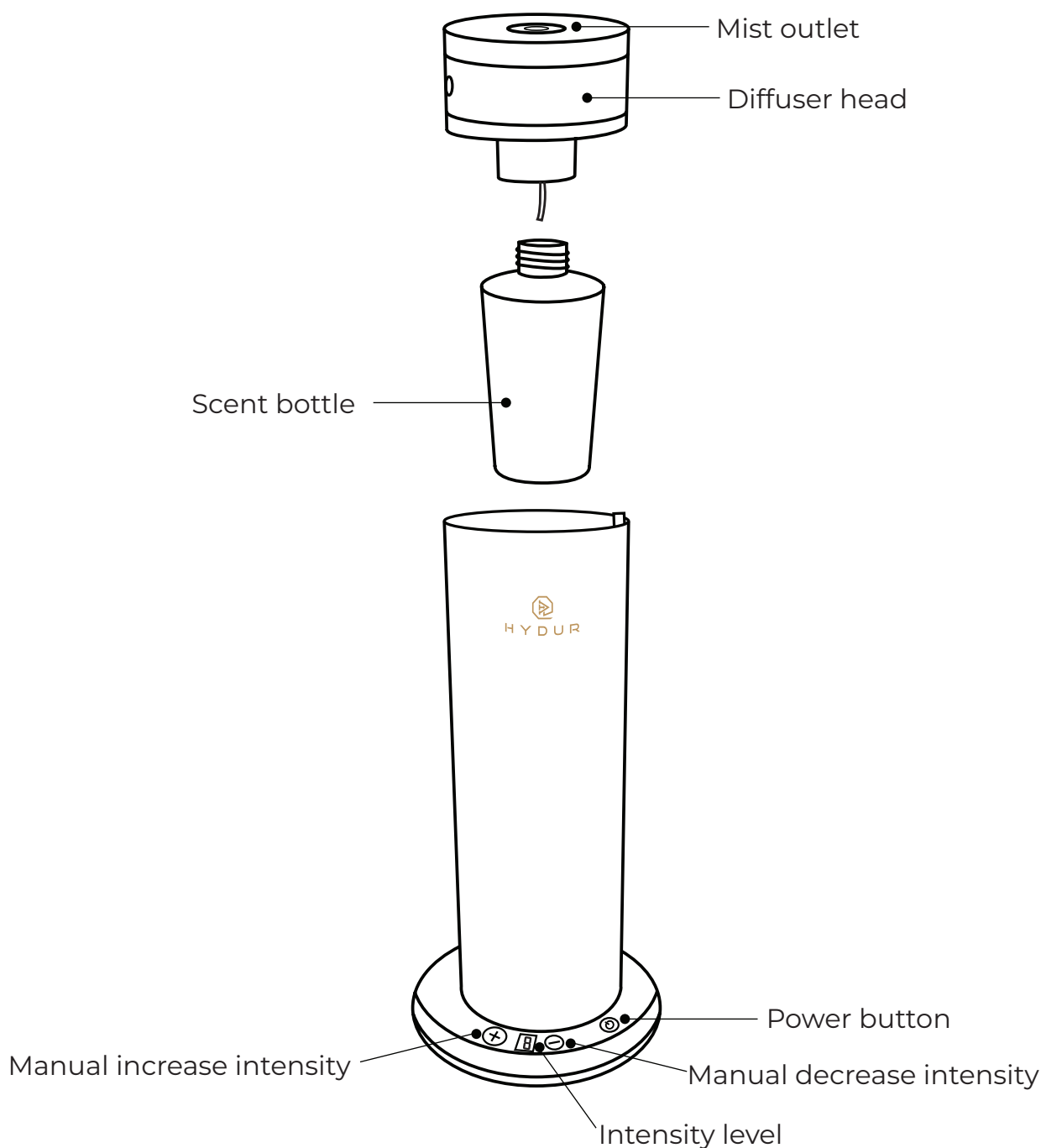

Operating your diffuser

- 1 Press down the top of the diffuser and lift up the atomiser head with the bottle.



- 2 Unscrew the bottle from the atomiser head and fill with scented oil (Do not fill to the rim).

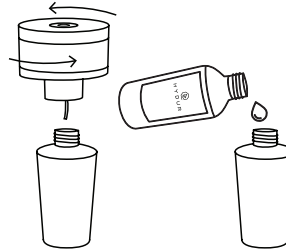

- 3 Screw the bottle back on to the atomiser head and align the notches with air nozzle and push down until you hear a click.

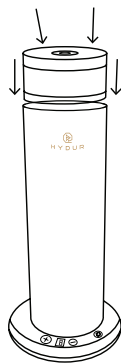

- 4 Plug the power adapter in and press the power button to turn ON.

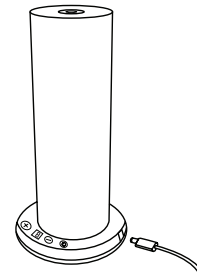

- 5 Adjust the desired intensity level by pressing the increase/decrease (+) (-) level button manually or operate it with Bluetooth using the Hydur scented app which allows you to control your diffusion levels and settings based on your preferred time and day. The hydur Scenting controller app is available to download on IOS or android.



- 6 Place your Grandi Diffuser on a flat Surface in Your living room, bedroom, office, or any ventilated indoor space.

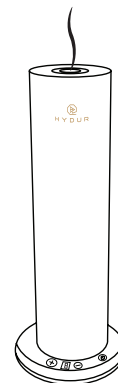

How to set & control your scent intensity settings

1 Download and open the Hydur Scenting Controller App.

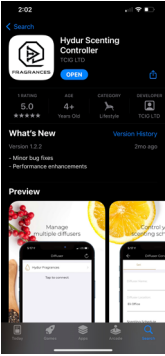

2 Select the Scent Diffuser from the list

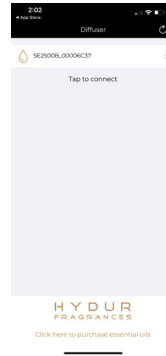

3 Log in using the default password '8888.'

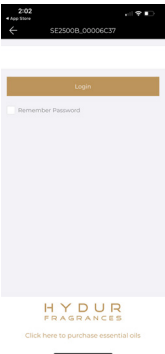

4 Tap the '+' or 'Add' button to add scenting schedule.

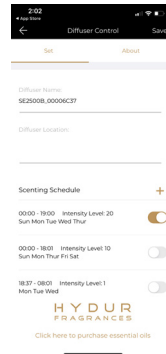

5 Select the desired Start and End Time.

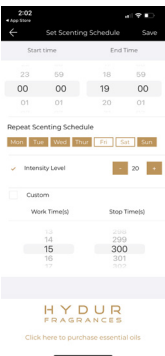

6 Adjust the intensity level and tap 'Save.'

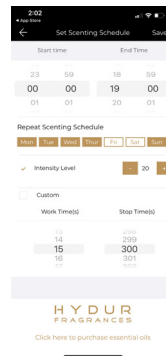

Hydur Scent Diffuser can work continuously or intermittently, depending on your settings. We recommend that you schedule your scent diffusion intermittently between one to three times a day for up to 1 hour at the maximum.

Set your intensity to the maximum level on the first cycle of scenting and reduce the intensity on the next cycles.

Directions

Button

1. Press the power button to turn ON/OFF
2. Press (+) or (-) button to increase/decrease the scent intensity,
3. The display indicates the intensity of diffusion from 1-10

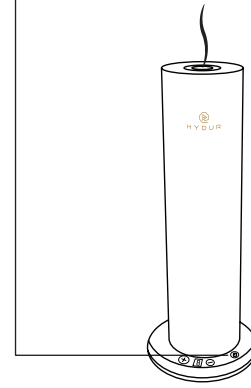

Intensity and Oil Consumption

Intensity Level Indicator Light	Run Time (Sec)	Pause Time (Sec)	Oil Consumption (ml/hr)
1	5 secs	240	0.04
2	10 secs	220	0.08
3	15 secs	200	0.13
4	15 secs	180	0.18
5	20 secs	160	0.23
6	20 secs	120	0.28
7	25 secs	100	0.33
8	25 secs	80	0.38
9	25 secs	60	0.44

* The above information consumption data may vary depending on the different scented oil.

Adjusting the fragrance intensity

After placing the Hydur scented oil in the device, basic operation involves adjusting the scent level to suit the room size, ambience, or occasion. Activate the machine using the intensity buttons, starting at level 1. After a few minutes, the fragrance will disperse throughout your space. If necessary, make adjustments. Once you find the optimal setting, minor adjustments may be needed when using different scented oils.

Allow the Grandi Tower some time to distribute the scent evenly across the space when adjusting the scent level. Wait before deciding if further adjustments are necessary. The Grandi Tower user profiles are as follows:

- Low intensity: Levels 1-3, 2 hours of operation per day
- Medium intensity: Levels 4-6, 4 hours of operation per day
- High intensity: Levels 7-9, 8-10 hours of operation per day

Safety Care

- Unplug the diffuser immediately and discontinue use in the event of smoke or a burning smell
- Do not wrap the adaptor with cloth, paper, or anything that may result to avoid abrasions, cuts, fraying, crimping, and kinking
- Do not disassemble or attempt to self-repair the diffuser, this will void the warranty. Any damage caused by the user does not qualify for replacement by Hydur
- Disconnect the diffuser from power adaptor before refilling, cleaning or moving the diffuser
- Clean the sensor with a isopropyl alcohol-soaked cotton swab
- Do not use metal objects to clean the sensor; use only a cotton swab or cloth dipped in isopropyl alcohol or a neutral detergent
- Make sure to clean the unit before switching to different scenting oils
- Use only essential oils or Hydur scenting oils. Artificial, synthetic, or impure oils and fragrances can damage the diffuser.
- Avoid placing the diffuser in direct sunlight, close to a refrigerator or fan, or in a hot environment
- When not in use, clean the diffuser and store dry at 0°C—50°C, 5%-95% humidity.

Taking Care of your Storage

To keep your diffuser clean and ensure the best mixture of Hydur Fragrances it is recommended that you perform a cleaning cycle on your diffuser at least once a month, if you use your diffuser daily or in case any of these situation happens:

- Switch or change to another Scenting Oil
- Atomization volume becomes weak or there is no mist or less mist than usual

To do a cleaning cycle on your diffuser, follow these steps:

Step 1: Turn the device off and unplug prior to cleaning.

Step 2: Gently wipe the plate using a cotton swab dipped in rubbing/isopropyl alcohol.

Step 3: Fill a clean bottle with isopropyl alcohol.

Step 4: Install the bottle filled with rubbing alcohol to the diffuser and turn it on. Let it diffuse for 5-20 minutes or until the essential oil scent wears off.

Step 5: Replace the bottle of rubbing/isopropyl alcohol with your scenting oil.

Disposal

Dispose of this product and packaging materials with your local regulation. Waste electrical products should not be disposed with household waste. Separate disposal exist for your nearest facilities, see www.recycle-more.co.uk

Condition	Solution
Diffuser is not working.	<p>USB cable may not be properly plugged in or your diffuser ran out of battery</p> <ul style="list-style-type: none"> • Check if the power is on or off and/or your diffuser is charged. • Check if there is essential oil inside the bottle.
No mist coming out of my diffuser.	<p>Your atomizer head might be blocked.</p> <ul style="list-style-type: none"> • Check if there is any scented oil build up on the plate. In case there is a buildup, follow the cleaning instructions.
Diffuser is leaking.	<p>Your diffuser head is either displaced or the the diffuser is tilted.</p> <ul style="list-style-type: none"> • Check that the diffuser head is screwed properly to the bottle. • Make sure that the diffuser is set on a hard, flat surface. • Keep the diffuser constantly vertical do not tilt or keep the diffuser horizontal.
Scent is too strong or too weak.	<p>If you find the mist/intensity is too strong or weak, adjust the diffuser intensity to either a higher or lower setting to suit your preference.</p>
Diffuser does not connect to Scenting App.	<p>Reset the diffuser by holding down the power button till you hear 2 beeps. Reconnect to Bluetooth via the app on your phone.</p>
Air pump is running but no mist is visible and/or cannot smell the scent.	<p>*Diffuser core could be clogged.</p> <p>Replace oil with diffuser cleaner/rubbing alcohol, run 2. There is not enough scented oil on level 9 for 10 minutes.</p> <p>*There is not enough scented oil remaining in bottle.</p> <p>Replace scented oil over MIN level</p> <p>*The top of the unit is not pushed down securely</p> <p>Make sure the top of the diffuser is pushed down until you hear a click.</p>

Troubleshooting

Condition	Solution
The diffuser turned off by itself, no blue light on the base, no intensity level showing	<p>*The diffuser is designed to cycle the pump on and off and mists intermittently.</p> <p>Turn your diffuser on and then wait a full cycle, 10 min. Diffuser light turns off during normal running cycle.</p> <p>*The time of the day is outside of the scheduled operating periods.</p> <p>Check scheduling in the Scenting App.</p>
Unusual or loud noise	Turn diffuser off and contact customer care support@hydur.co.uk

What is the average oil consumption of a Grandi Tower?

Average scenting oil consumption ranges from 0.04 ml – 0.4 ml per hour.

How much area does a Grandi Tower cover?

A Grandi Tower will cover up to 50 square meters.

How long will my 100ml Scent last?

Can last up to 2 months if used on the lowest setting For an average of 4- 5 hours per day.

Do I need to put water on the diffuser?

No. Hydur Diffuser does not use water. It atomize the scenting oils using a series of tubes, dispersing the oils in their purest form.

What type of oils can I use on the diffuser?

Hydur Diffuser diffuses 100% essential oil or Hydur Scenting Oil. Other blends and oils may contain fragrances, base oils or synthetics that could result in malfunction. Hydur Scenting Oils are carefully blended and curated for Hydur Diffusers.

Do I need to clean the diffuser?

Yes. It is recommended that you perform a cleaning cycle at least once a month.

How do I reset the password of the Hydur Scenting App?

In case you forget the password, simply press the reset button to restore to factory settings. The default password is 8888.

How do I create a scenting schedule from the Hydur Scenting App?

The scent scheduling feature is only available on Grandi Square, Grandi Tower and Ultra Tower Max.

To create a new scenting schedule using the app, simply:

Step 1: Select "Add New" under the "Schedule" section on the Homepage

Step 2: Choose to create your own schedule, or select one of the pre-set schedules

Step 3: Enter your desired Start time, End time, Name and intensity. If you would like the schedule to repeat, select the day(s) you would like it to repeat.

Step 4: Click "Save"

Will my diffuser work even if I am not connected to the Hydur Scenting App?

Yes. The diffuser will keep the schedules you have set. Once you reconnect via Bluetooth you can change the schedules, adjust the scent intensity or turn the diffuser off manually.