



# ESSENTIALS MINI



# USER MANUAL



SOS Help  
Button



GPS Data  
Location



In- / Outdoor  
Connectivity



2-Way  
Speaker

[zembro.com](http://zembro.com)

# Zembro Essentials Mini

**Zembro Essentials Mini is an SOS button for raising an alert.**

## **FEATURES**

- Outdoor/indoor alerting via button press
- Call button, with in-built microphone and speaker
- Clear voice quality
- Always connected due to in-built SIM card

Your Zembro Essentials Mini is a wearable SOS button, an ergonomic rechargeable button device that features an in-built SIM card, so it stays connected to Zembro when you are indoors and outdoors.

It can be worn as a pendant using the lanyard or popped into your pocket. We recommend that you always keep it with you.

# Getting To Know Your Device

## FRONT



# Getting To Know Your Device

## **SIDE**

**Call button**

*(Increase volume button)*



**Silent mode button**

*(Decrease volume button)*

# Getting To Know Your Device

## **BACK**



# Getting To Know Your Device

## CHARGING BASE

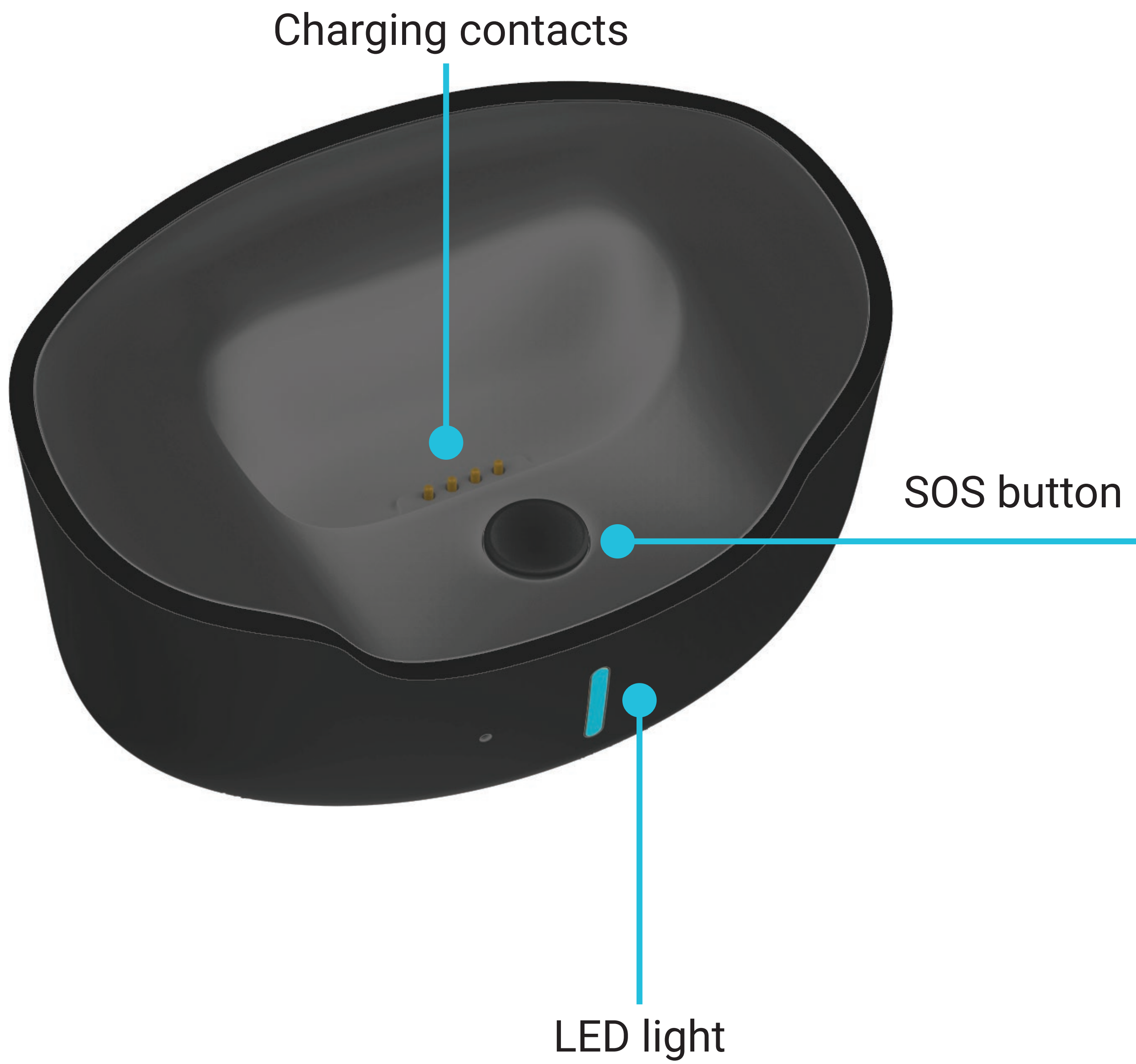

# Charging Your Device



- Place the device on the charging base.
- Connect the USB cable from the charging base to the AC adaptor.
- The charging base light will glow when charging and turn solid when fully charged.

**TIP** When using the device for the first time, please fully charge the battery for around 2-3 hours.

**TIP** When the battery level falls below 20%, it will send a low battery warning message to recipients on the contact list via text message or app.

**Battery life varies by use and configuration; actual results will vary.**

# Switching Device On And Off

## TO TURN THE DEVICE ON:

- Press the CALL button for 1 second, all the LED's will flash rapidly.
- The device can also be turned on automatically by charging via the magnetic cable or by putting it into the charging base.

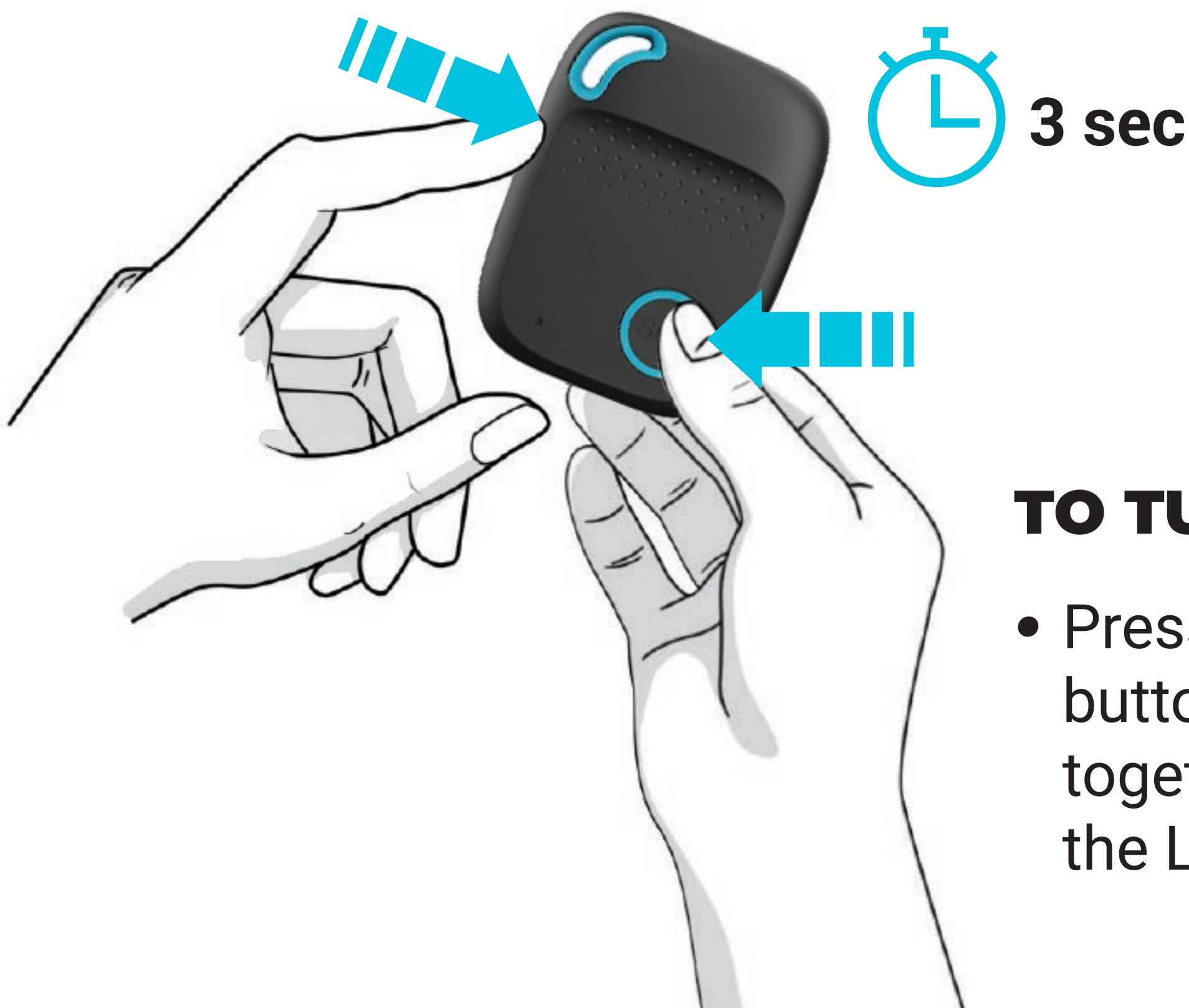
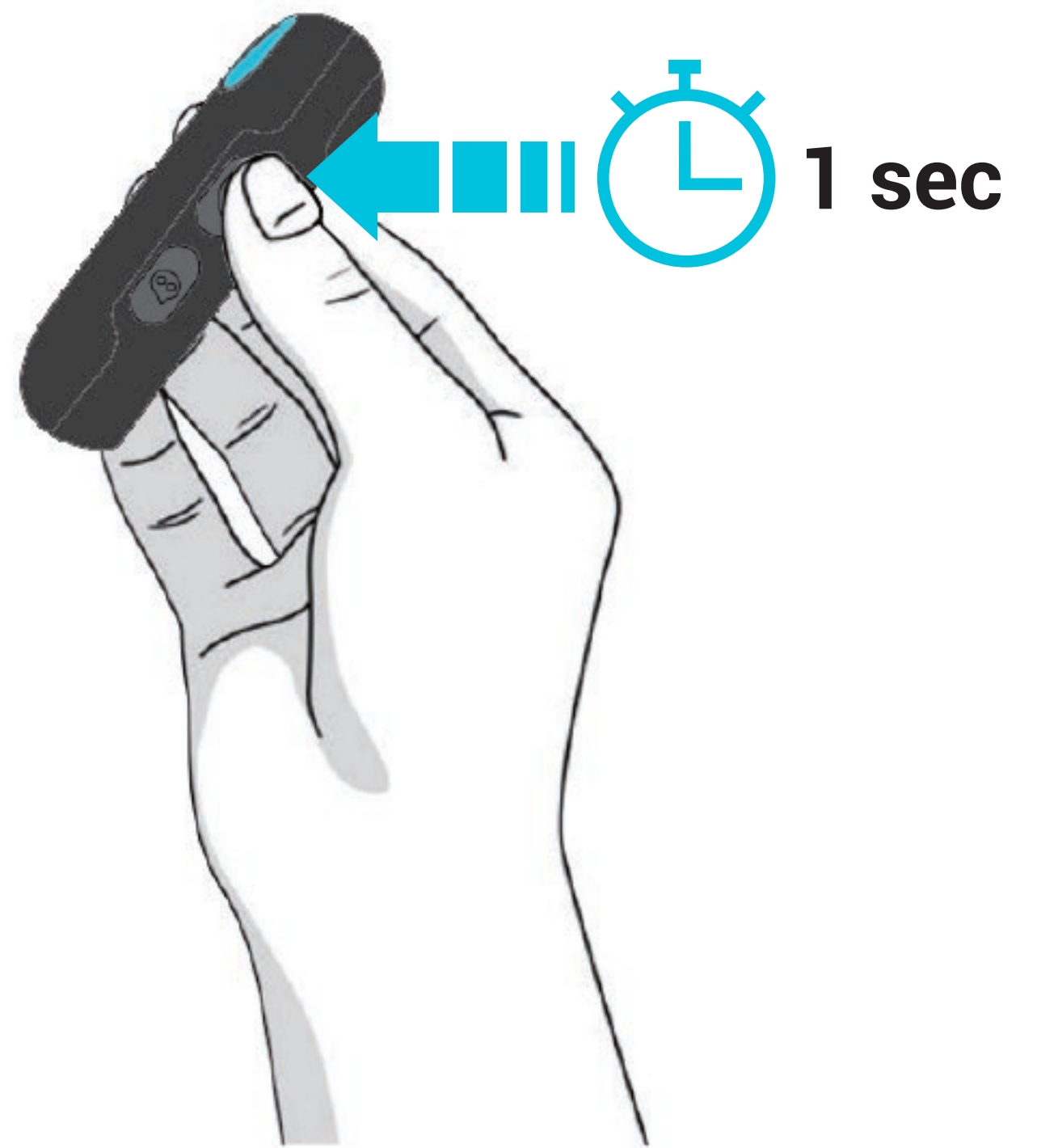

## TO TURN THE DEVICE OFF:

- Press and hold the top side button and SOS button together for 3 seconds until the LED's turn off.



# What Do The Lights Mean?

## CELLULAR SIGNAL INDICATOR - GREEN

<b>GREEN</b>	Light shows a single flash rapidly every 3 seconds.	Light shows a double flash rapidly every 3 seconds.
<b>MEANING</b>	The device has a stable cellular signal.	The device is registered to the cellular network.

## CELLULAR SIGNAL INDICATOR - BLUE

<b>BLUE</b>	Light shows a single flash rapidly every 3 seconds.	Light shows a double flash rapidly every 3 seconds.	Light off
<b>MEANING</b>	The device has no latest location fix.	The device has latest location fix.	The device is not fixing the latest location.

# Activating an SOS Alarm

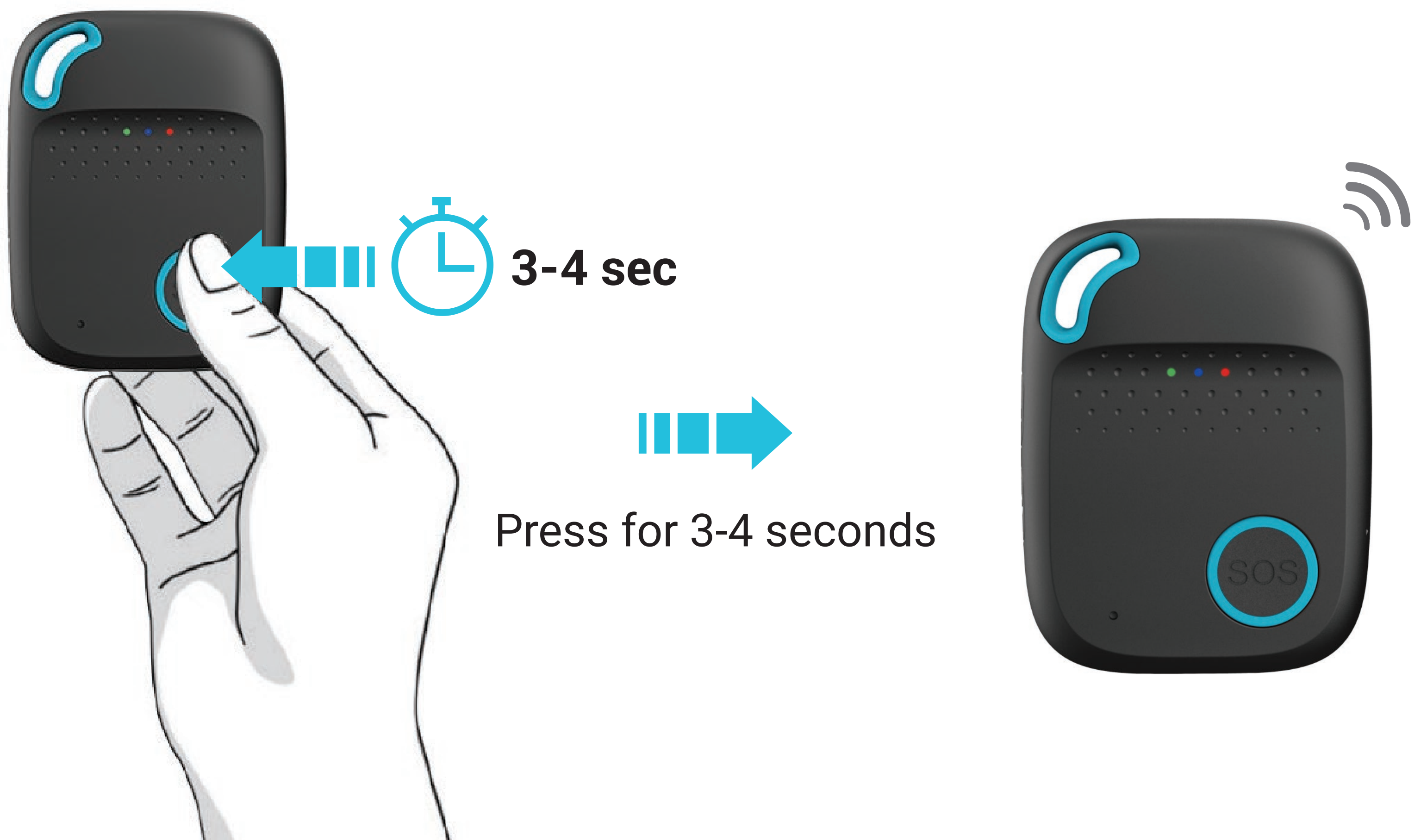

When you need help, press the SOS button for 3-4 seconds until you hear a voice prompt, indicating an SOS alarm.

This starts the sequence of sending a “Help Me!” text message to your emergency contact numbers followed by the outgoing calls.

If the device fails to connect to the first emergency number, it will call the second emergency number after a delay of 10 seconds.

In case the second numbers fails to be connected as well, the system will connect to the third number, etc.

# Activating an SOS Alarm

Between each call, there will be a 10-second delay, during which time, the user can stop the call sequence or prevent a possible false alarm by pressing the SOS button.

Use the side buttons +/- to adjust the sound volume during a call.

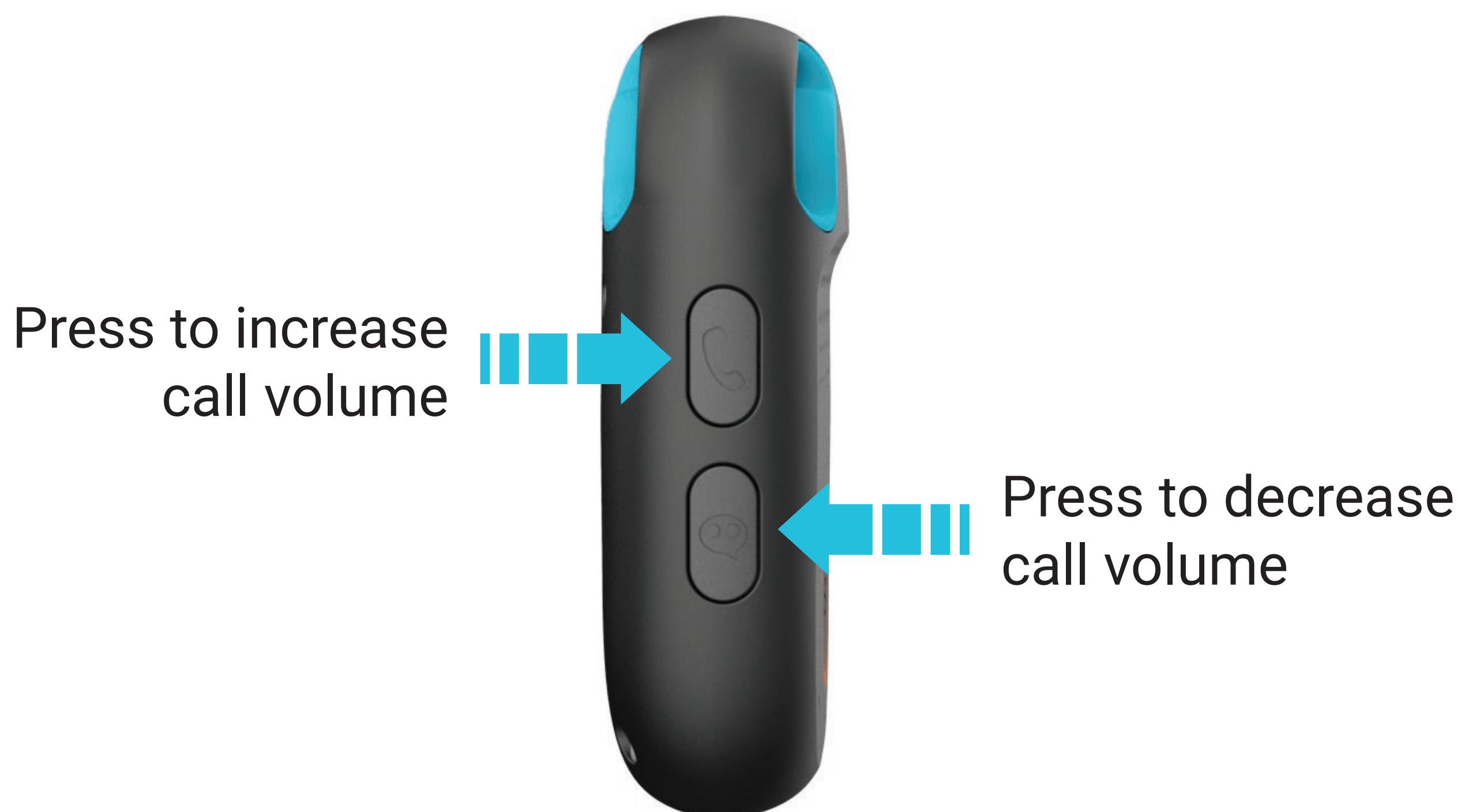

**TIP** Please remember to program emergency contact numbers.

It is not mandatory for all the authorized numbers to be set, however a minimum of one must always be set.

**TIP** Please be patient during the call sequence.

There can be short delays as the alarm calls phones which might be out of range or gets diverted to recipients' voicemail.

## Getting a GPS Fix

Getting an initial location for the GPS features, use outdoors or near window so the device can get a fix on the satellites.

This could take a few minutes depending on your environment.

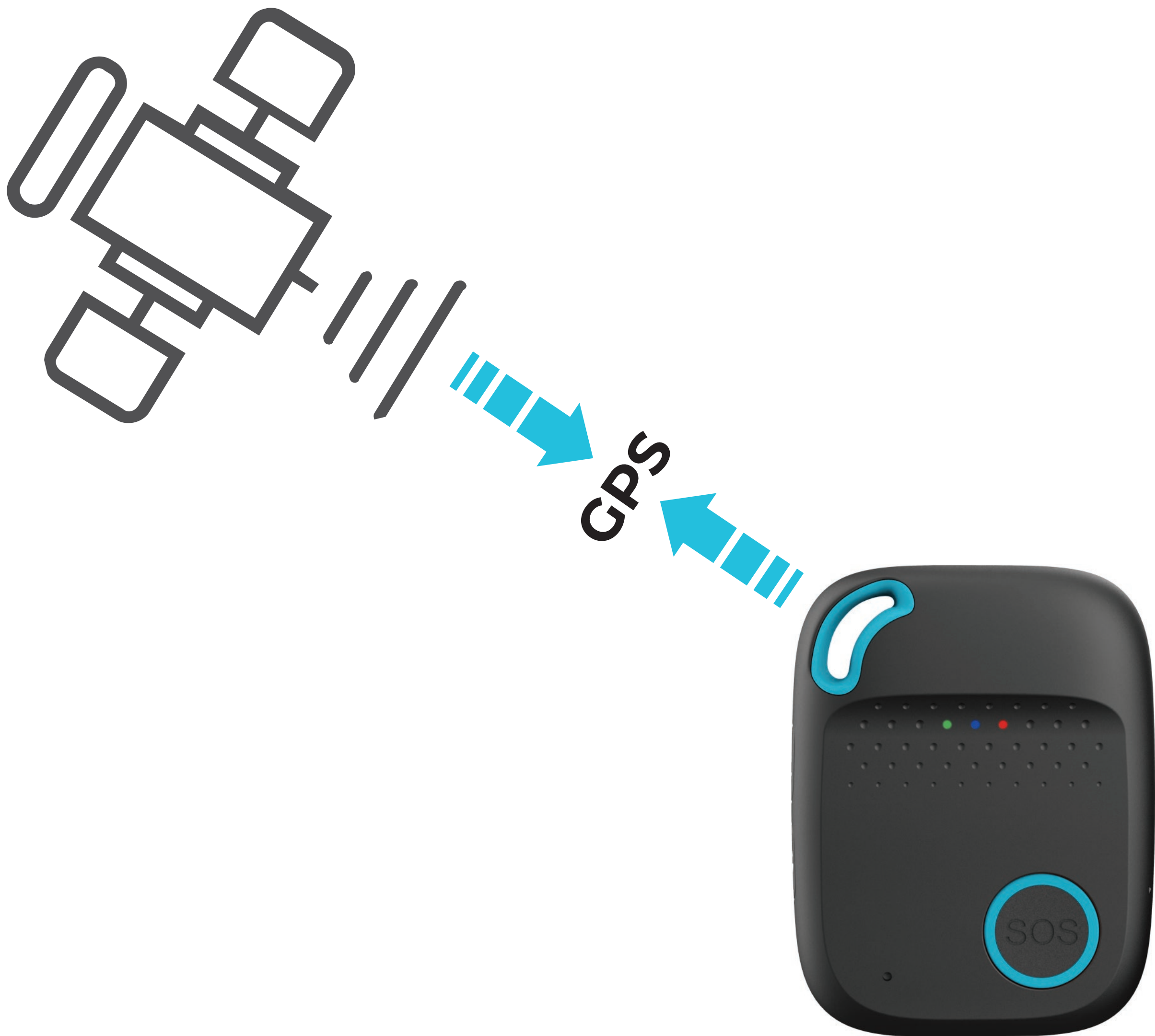

# Making a Phone Call

## **TO MAKE A CALL:**

Press the CALL button for 3 seconds and you will hear a beep, and then it will dial de predefined number.



## **TO END THE CALL:**

Press the SOS button

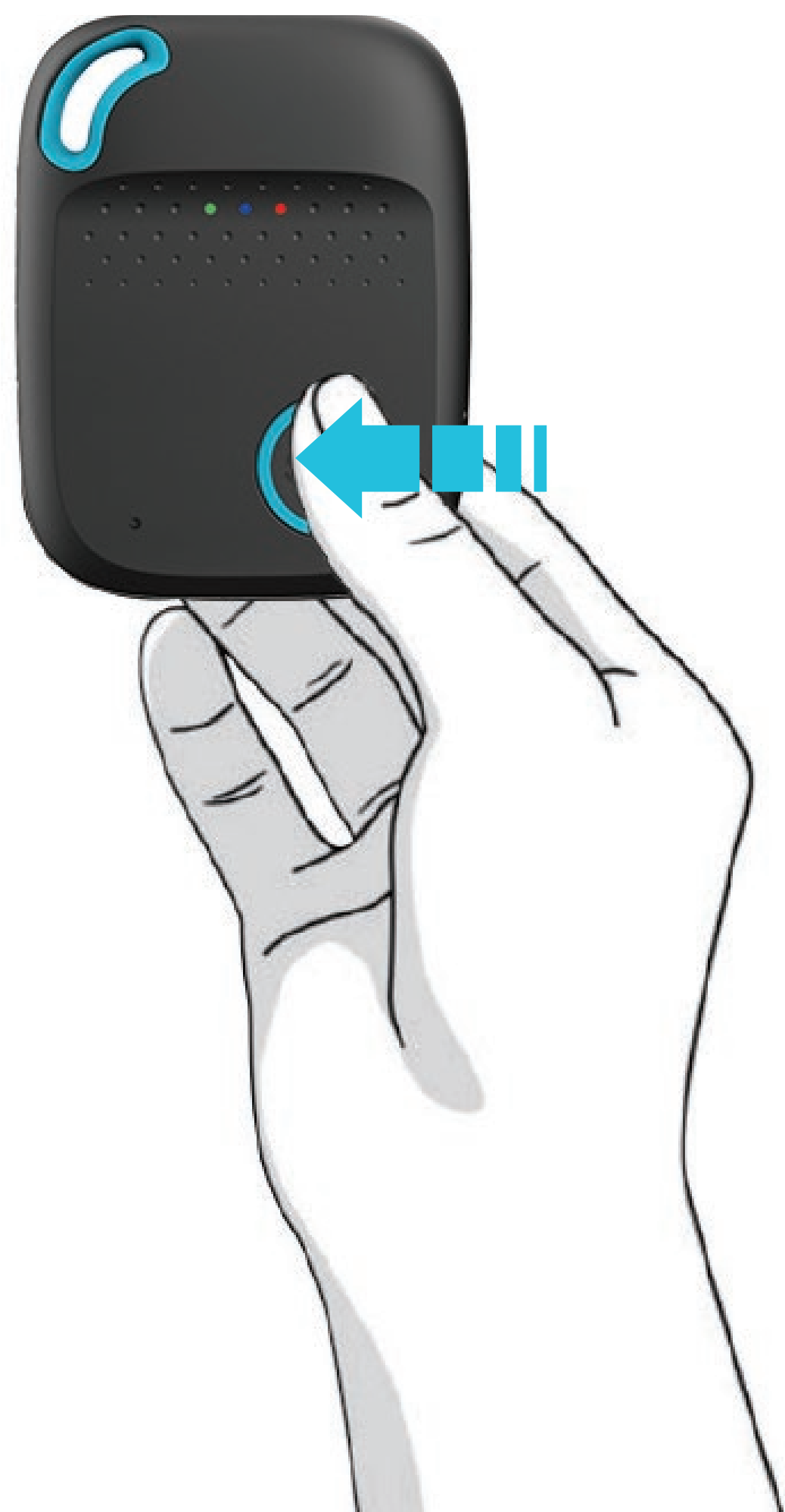

# Silent Mode

Double-click the silent mode button to turn off voice warnings.  
Double-click again to turn voice warnings on.

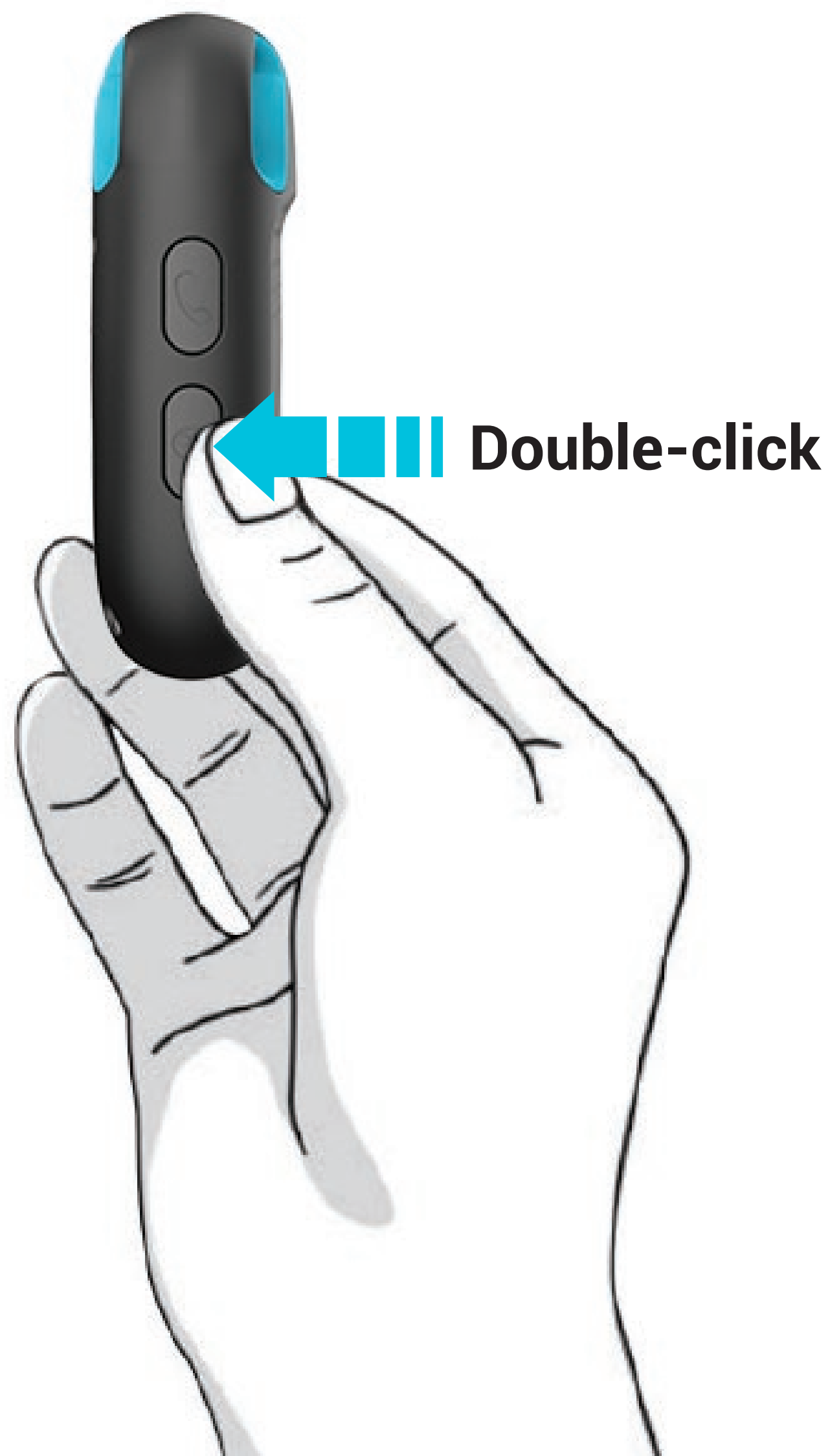

# Bluetooth Pairing

Put device in the charging base for more than 30 seconds, and they will be paired automatically via Bluetooth.



# Receiving an Alert

If you are the emergency contact for a person wearing a Zembro Essentials Mini SOS button, the following section describes how to receive and respond to alerts.

You will receive a call from the person sending the alert, as well as an SMS text message and an email from Zembro, which contains alert information and a clickable link.

Clicking this link opens your phone or PC browser and takes you to a site that gives you the alert details and the latest location of the person pressing the alert.

This alert page updates once per minute, with position of the person when they alerted.

We recommend that you test the alert service when first using a new Zembro Essentials Mini SOS button and save to your favourites the number that calls and texts you, to ensure it can override any do-not-disturb or silent mode that you may set on your phone (e.g. at night-time).

You may need to consult your phone's settings for more details on how to do this.



# Changing your Contact Numbers

If you need to change a contact, add, or delete a contact number, please contact Zembro customer service.

---

**Thank you for choosing the Zembro Essentials Mini SOS button.**

We wish you many years of protection and peace of mind.

Do not hesitate to contact our customer service if you have queries or problems.

**Peace of mind  
with connected health & safety**

[zembro.com](https://zembro.com)

# Water Resistance

**Water Resistance Rating:** IPX7 under IEC standard 60529

The Zembro Essentials Mini Device is splash and water resistant but not waterproof.

You can, for example, wear and use the device during exercise in the rain and while washing your hands, but submerging your device is not recommended.

Water resistance isn't a permanent condition and can diminish over time.

Essentials Mini can't be rechecked or resealed for water resistance.

**The following can affect the water resistance of your Essentials Mini and should be avoided:**

- Dropping your Essentials Mini or subjecting it to other impacts
- Exposing your Essentials Mini to soap or soapy water (for example, while showering or bathing)
- Exposing your Essentials Mini to disinfectants, perfume, solvents, chlorine, detergent, acids or acidic foods, insect repellent, lotions, sunscreen, oil, or hair dye
- Exposing your Essentials Mini to high-velocity water
- Wearing your Essentials Mini in a steam room
- Wearing your Essentials Mini in a sauna

While the above should be avoided, if your Essentials Mini comes in contact accidentally with soaps, shampoos, conditioners, lotions, disinfectants, perfumes, solvents, detergent, acids or acidic foods, insect repellent, sunscreen, oil, hair dye, chlorine or any substance other than water, it should be cleaned with fresh warm water and dried with a lint-free cloth.

Chemicals found in these items could negatively affect water seals and acoustic membranes.

# Specifications

<b>Dimensions:</b>	62 mm x 47 mm x 17 mm
<b>Weight:</b>	53 g
<b>Battery:</b>	Rechargeable, 3.7 V, 950 mAh
<b>Charging voltage:</b>	5 V DC
<b>Locating Technologies:</b>	GPS, BLE, WiFi, LBS

## Caution

### **Please comply with the instructions to extend the life of the device:**

- Don't use or store the device in dusty places.
- Avoid storing or using the device likely to be exposed to extremes of temperature.
- Clean the device with a dry cloth. Don't clean it using chemicals or detergents.
- Don't disassemble or refit the device.
- Using other batteries will cause unwanted situations.
- The built-in nano-SIM card can only be used inside the European Union (EU 28).

### **WARNING**

Keep the IMEI and SIM confidential to maintain privacy and security.