

# Installation Manual

## 1. Before Installation

1.1 Please check the parts before installation.

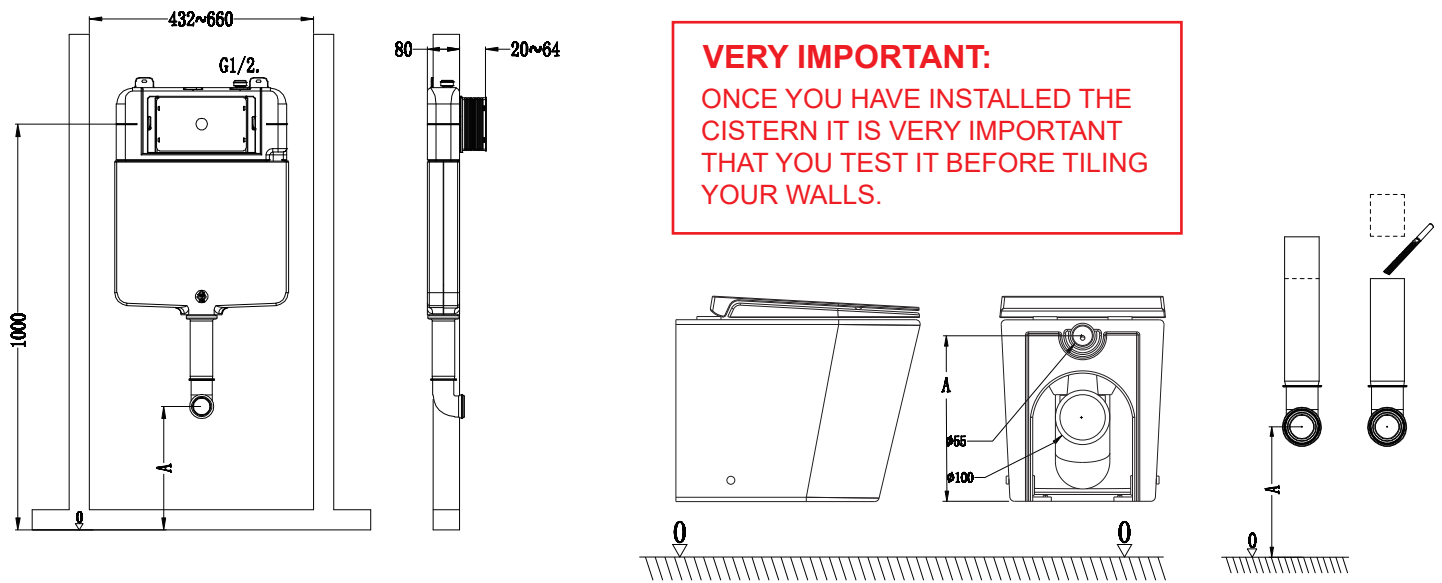

1.2 Tools and Materials required: Measuring tape, pencil, hammer, sealant, Hammer drill, Phillips screwdriver, level, cutter and hand file.

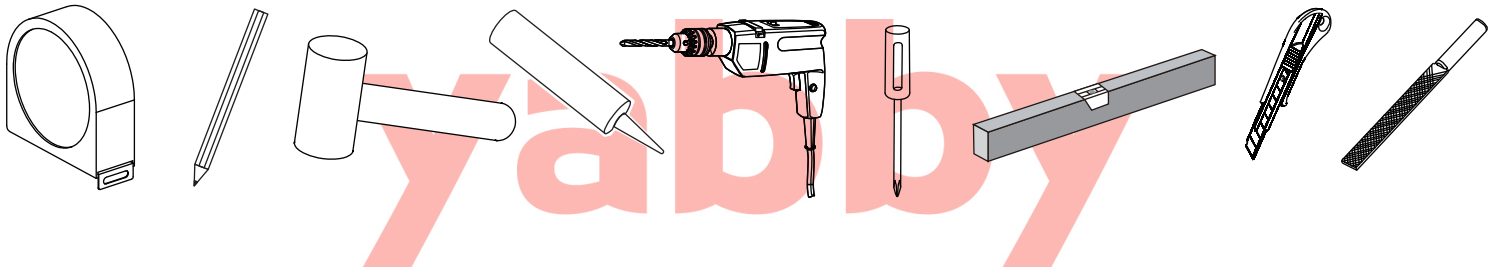

## 2. Installation Procedure

2.1 Connection of the water inlet pipe.

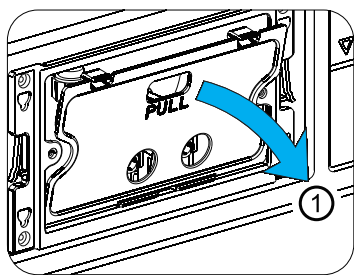

2.1.1 Remove the panel board.

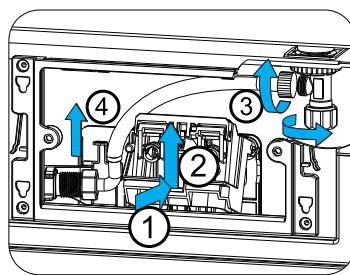

2.1.2 Remove the bolts and flush valve.

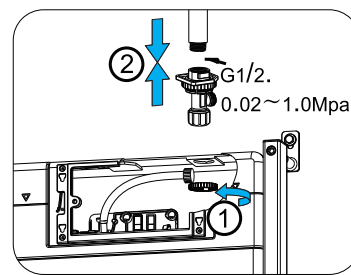

2.1.3 Connect the water inlet pipe.

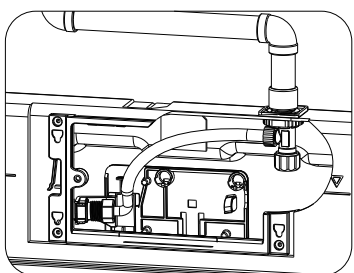

2.1.4 Tighten the hose.

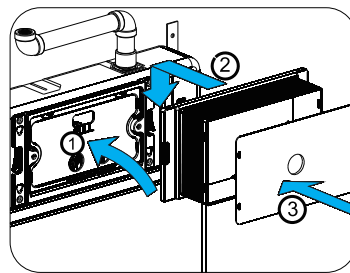

2.1.5 Tighten the flush valve and bolt frame, then install the panel frame and panel board.

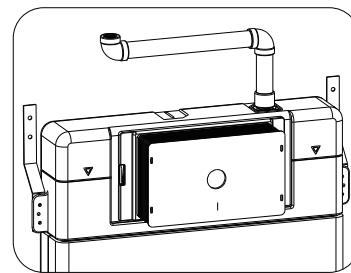

2.1.6 Finished.

# Installation Manual

## 2.2 Install the concealed cistern.

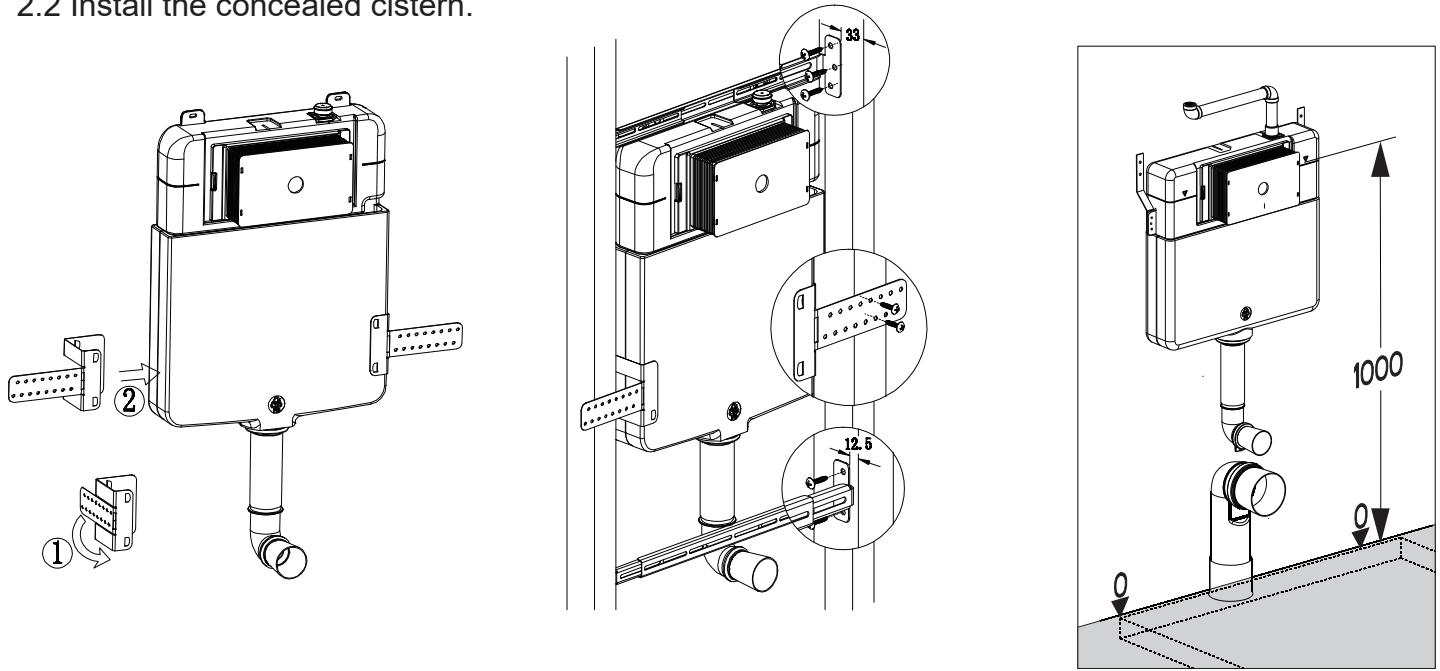

2.2.1 Tighten the screws.

2.2.2 Install the waste pipe.

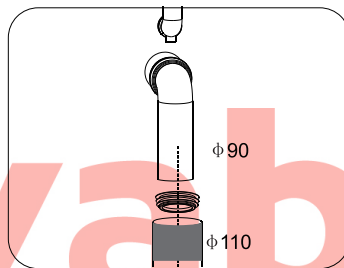

2.2.3 Use the pipe gasket to connect the waste pipe of  $\phi 90\text{mm}$  and  $\phi 100\text{mm}$ .

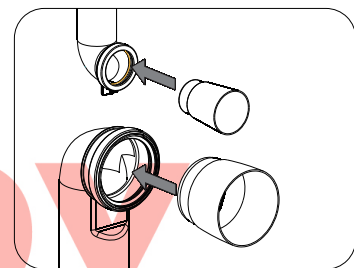

2.2.4 Put the pollution and flush cup on the pollution and flush pipe.

## 2.3 Install the flush panel

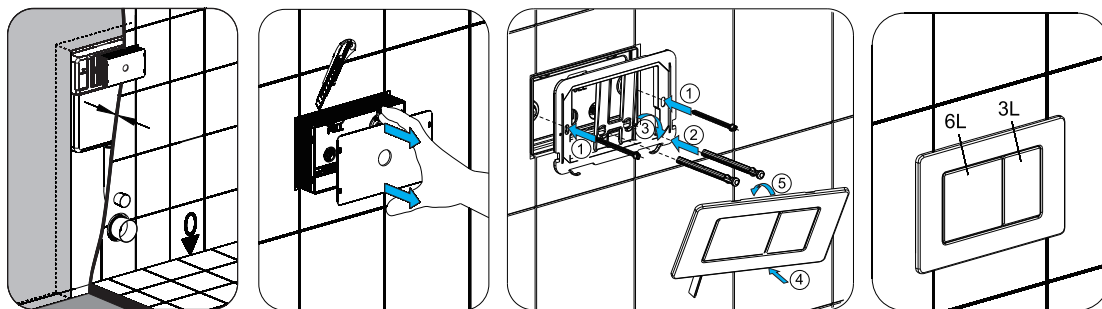

2.3.1 Cut the cistern frame close to the tiles/ wall.

2.3.2 Screw the flush rods and connective rods. Install the flush panel.

2.3.3 Finalise the installation of flush panel.

## 2.4 Install the toilet

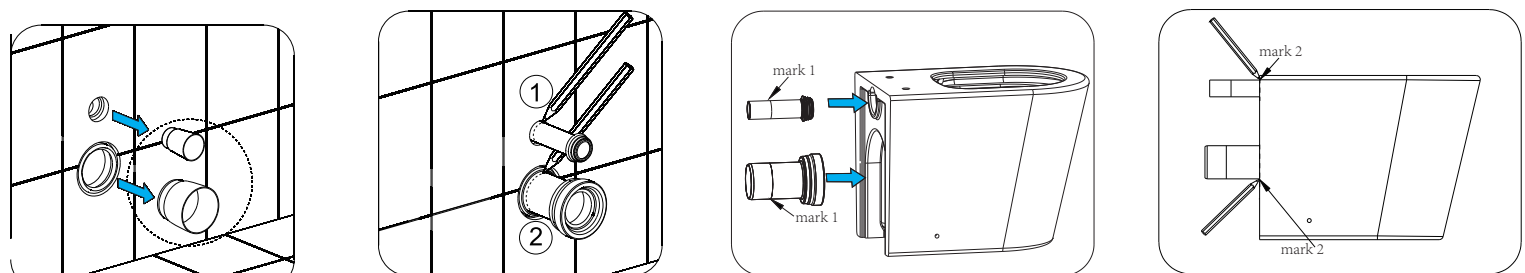

2.4.1 Dispose the pollution and flush cup.

2.4.2&3 Insert the straight pipes into the cistern and mark them as per the diagram.

2.4.4 Insert the straight pipes into the toilet and mark them as per the diagram.

# Installation Manual



2.4.5 Shorten part of  $L2+3$ mm.



2.4.6 Shorten part of  $L3+3$ mm.



Please make sure you have cut the flush pipe to the correct length. Failure to do so, will result in leakage.

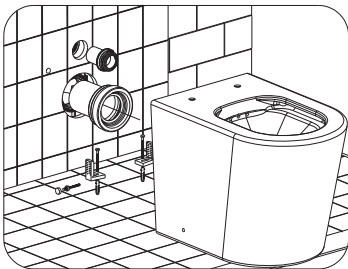

2.4.7 Measure the distance for the anchor screws and fix them on the floor. Apply the sealant to both pipes, then insert them into the cistern and install the toilet.

# yabby

## 2.5 Install the toilet seat and cover

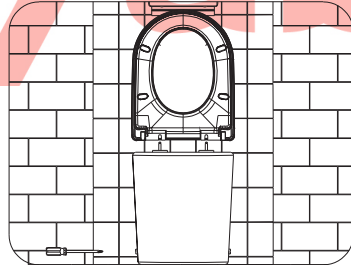
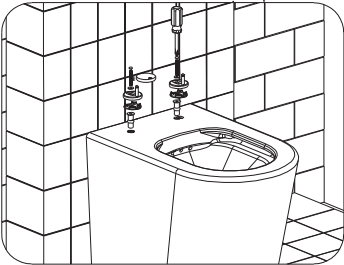

2.5.1 Fix and screw the expansion sleeve, base, bolts, and decorative cover in sequence.

2.5.2 Install the toilet seat and cover.

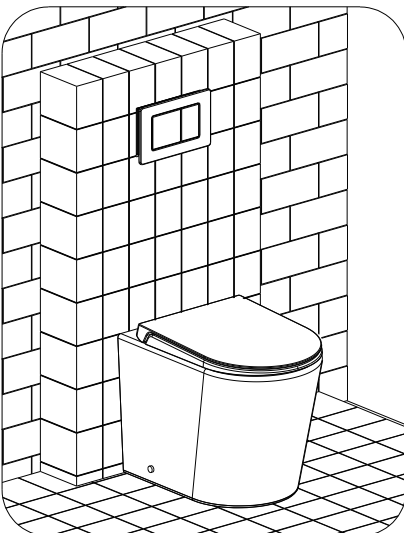

2.5.3 Finished.

# Installation Manual



## 3. Maintenance

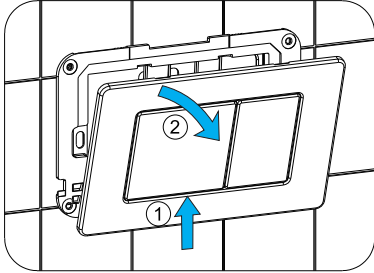

3.1 Remove the flush panel.

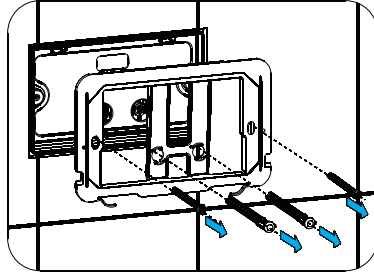

3.2 Remove the flush rods and connective rods.

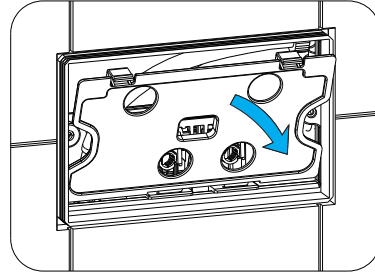

3.3 Remove the panel board.

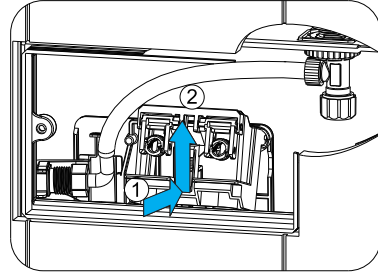

3.4 Remove the bolt frame combination.

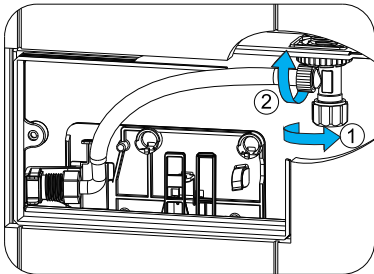

3.5 Unscrew the water inlet pipe.

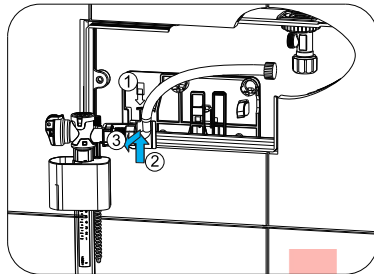

3.6 Remove the water inlet valve.

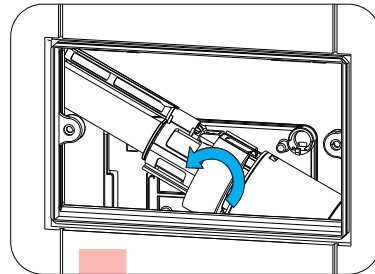

3.7&3.8 Remove the flush valve and bracket of the flush valve.

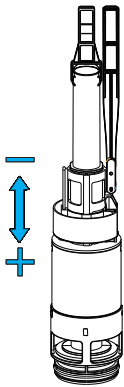
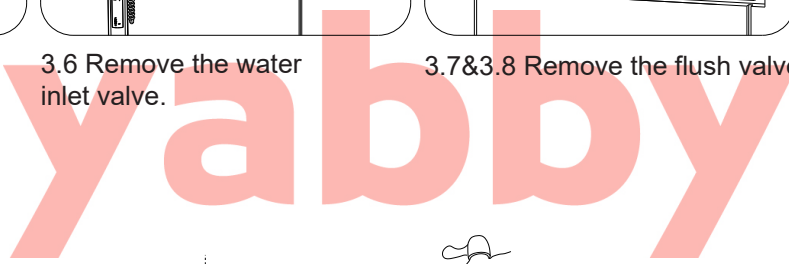
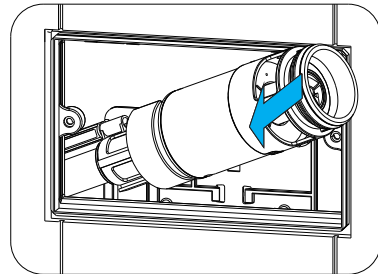

3.9 Adjust the small flush water volume.

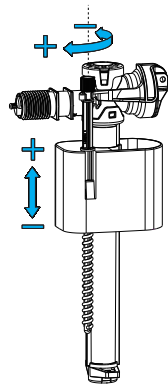

3.10 Turn over the knob, adjust the water level height.

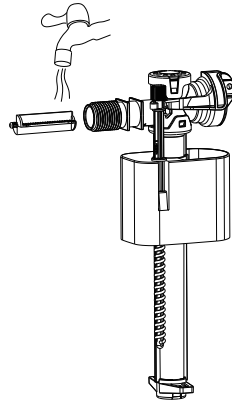

3.11 Clean the water inlet valve.

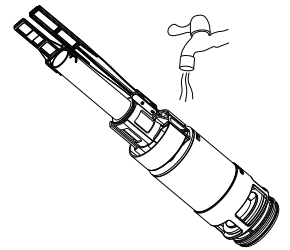

3.12 Clean the flush valve.

# Installation Manual

## Installation

1. Dispose the pollution and flush cup, Insert the straight pipes into the cistern and mark them as per the diagram, Insert the straight pipes into the toilet and mark them.
2. Shorten part of L2+3mm, Shorten part of L3+3mm.
3. Measure the distance for the anchor screws and fix them on the floor. Apply the sealant to both pipes, then insert them into the cistern and install the toilet.
4. Fix and screw the expansion sleeve, base, bolts, and decorative cover in sequence. Install the toilet seat and cover.

## Installation steps

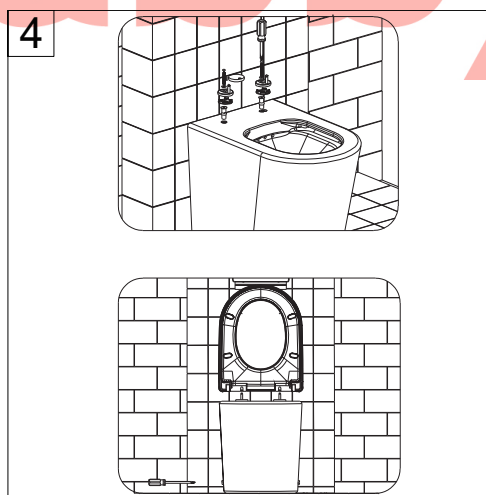
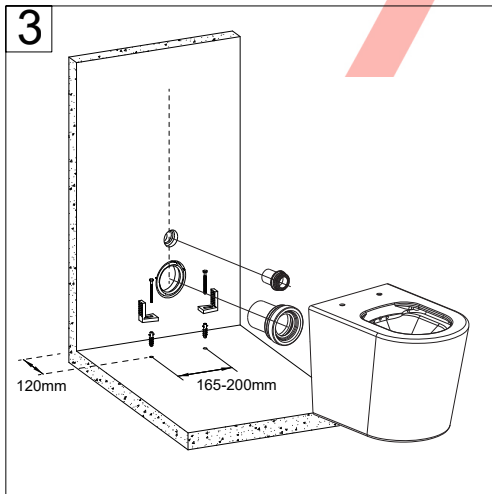
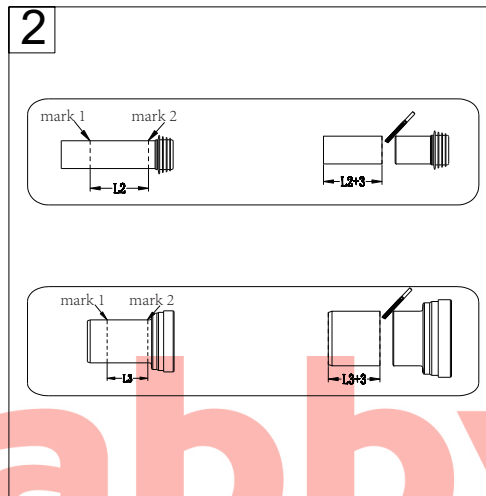
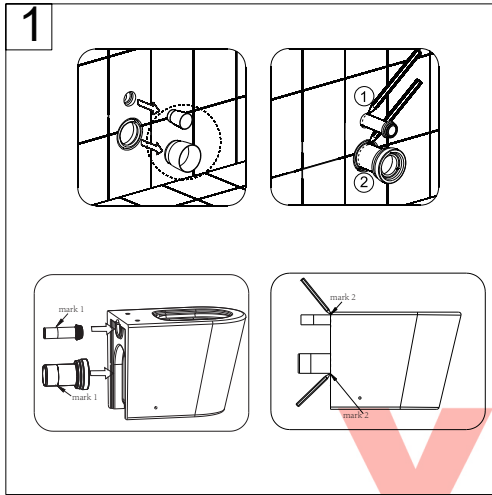

# Installation Manual

## Installation

1. Cut the cistern frame close to the tiles/ wall.
2. Screw the flush rods and connective rods.
3. Install the flush panel.
4. Finalise the installation of flush panel.

## Installation steps

