

80x80mm



Outdoor Security Camera

Blaberg.is

Product Introduction

Packing list: Smart Camera × 1, Manual × 1, Power Adapter × 1, Screw Accessories Package x 1

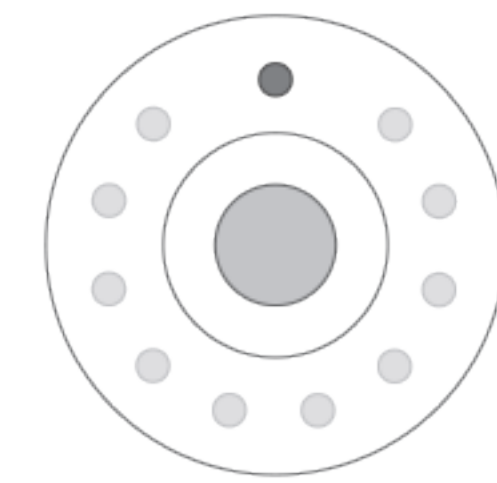

Smart Camera

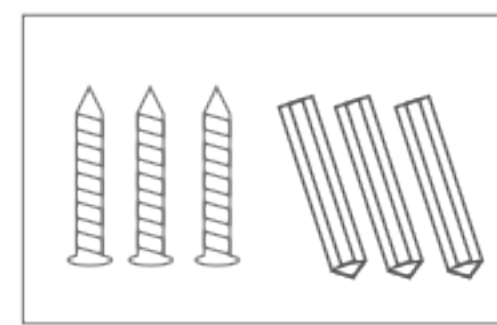

Screw Accessories Package

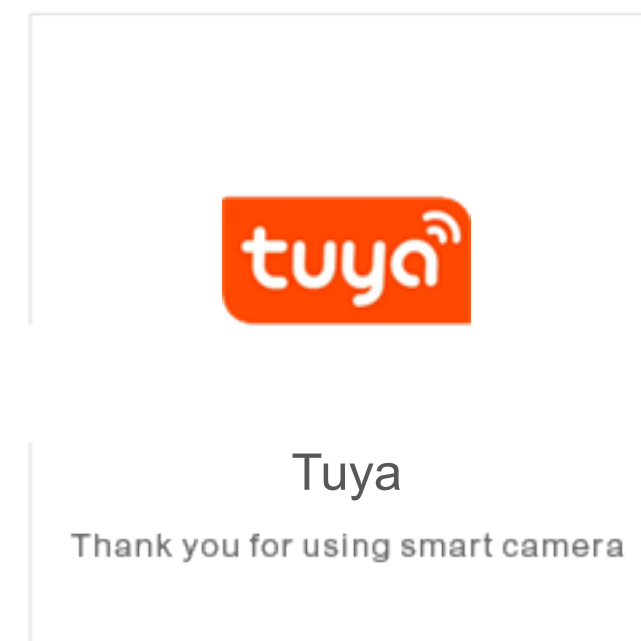

Manual

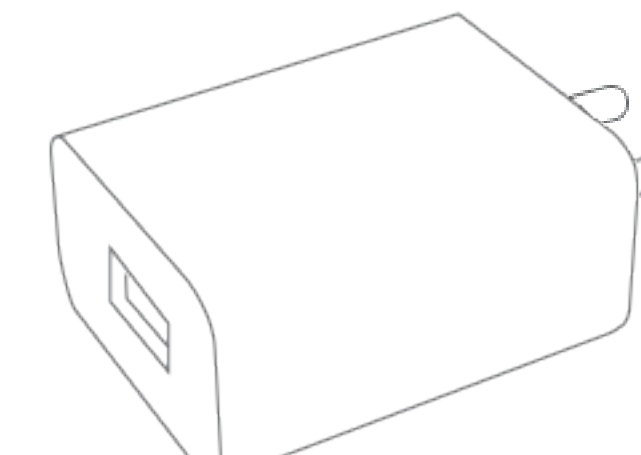

Power Adapter

Basic Parameters

Product Name: Smart Camera			
Pixel:		Wireless Encryption: WEP/WPA/WPA2 Encryption	
Video Compression	H.265 High Profile	Power Input: 5V 1A(Min)	
	H.264 High Profile		
Image Enhancement: Digital Wide Dynamic 3D Noise Reduction		Total Power Consumption: 5W (Max)	
Local Storage: MicroSD card		WirelessStandard: 2.4G 802.11 b/g/n	
Support Platform: Android/iOS		The light:	Full color night vision
			Infrared night vision

Component Description:

Reset Button: Long press "reset" hole 5sec, reset success.

It is recommended to insert 8-128GB high-speed Micro SD card, otherwise it will not be able to store, view historical video and support Important functions such as firmware upgrading.

Install APP

Download APP: scan the QR code below to download and install.
Register and login: open the "Tuya Smart" APP to register and login according to the prompts.



Add The Device-Scan QR code mode

- Make sure Wi-Fi is available and connected to the Internet.
- Connect the camera to the
- Open "Tuya Smart" APP, press the '+' in the upper right corner of the main screen (Figure 01); choose "Security & lock" click "Smart Camera (WiFi)" (Figure 02) to add camera; and then click "Next" (Figure 03);

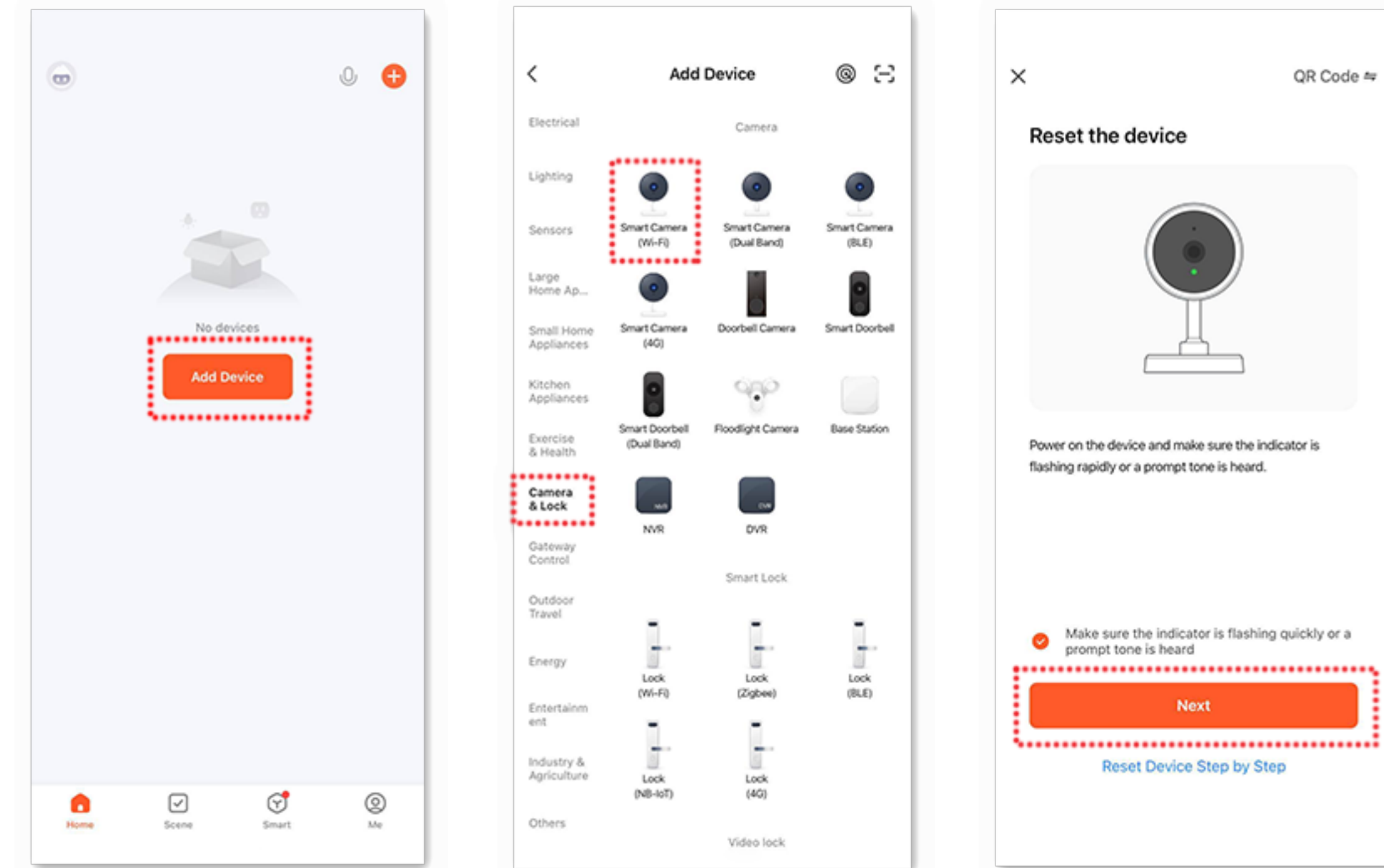

Please note that only 2.4 GH Wi-Fi network is supported;

- If the mobile phone is not connected to wi-fi, please click "Connect to Wi-fi" (Figure 04);
- It will jump to the WLAN interface and connects Wi-Fi (Figure 05).
- If the phone is connected to Wi-Fi (Figure 06);

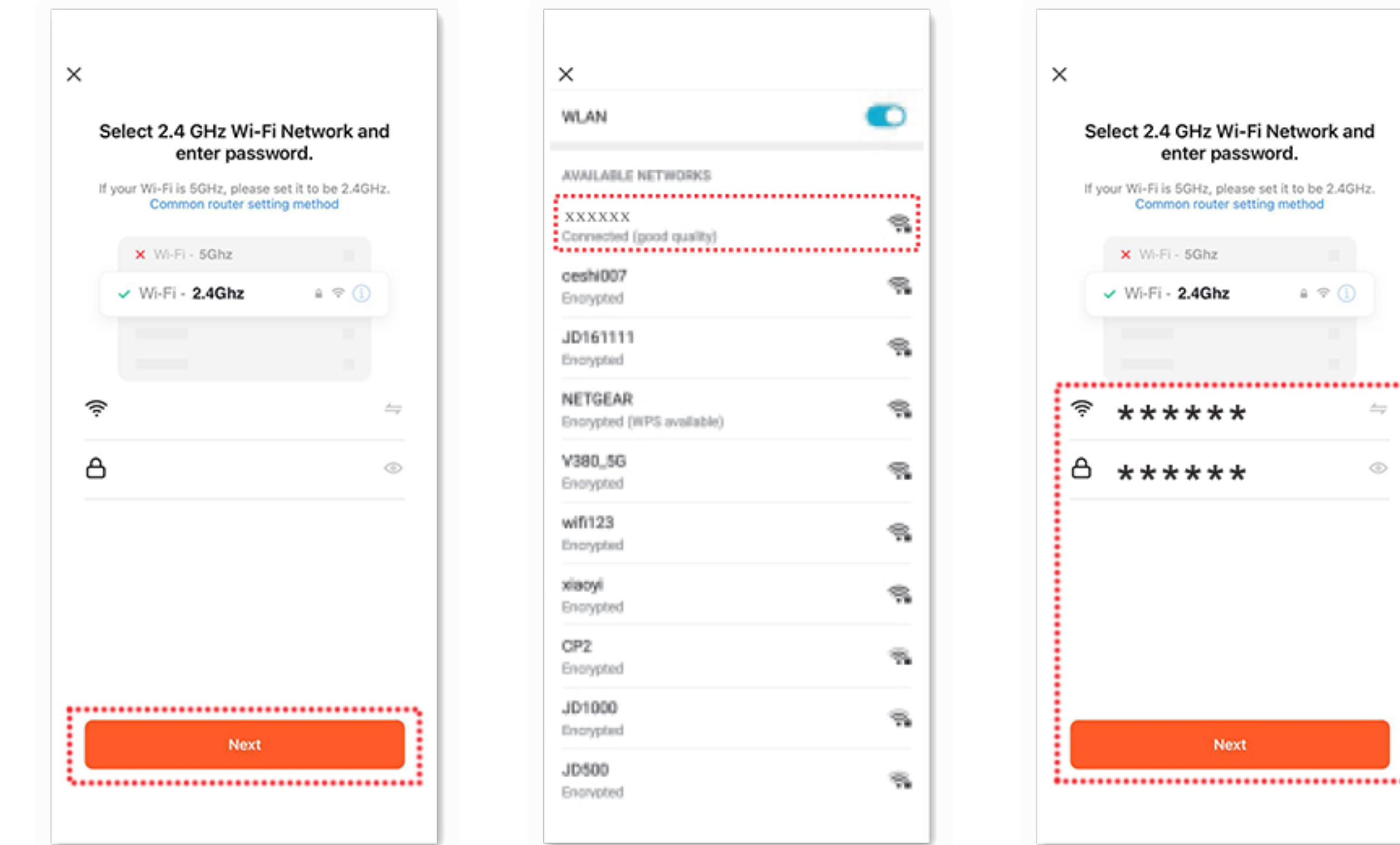

- A QR code will prompt on your screen and you need to scan it with the Smart Camera. (the camera is about 20-30 cm away from the mobile phone lens). Then click "hear the prompt sound" (Figure. 07).
- "connecting" (Figure. 08);

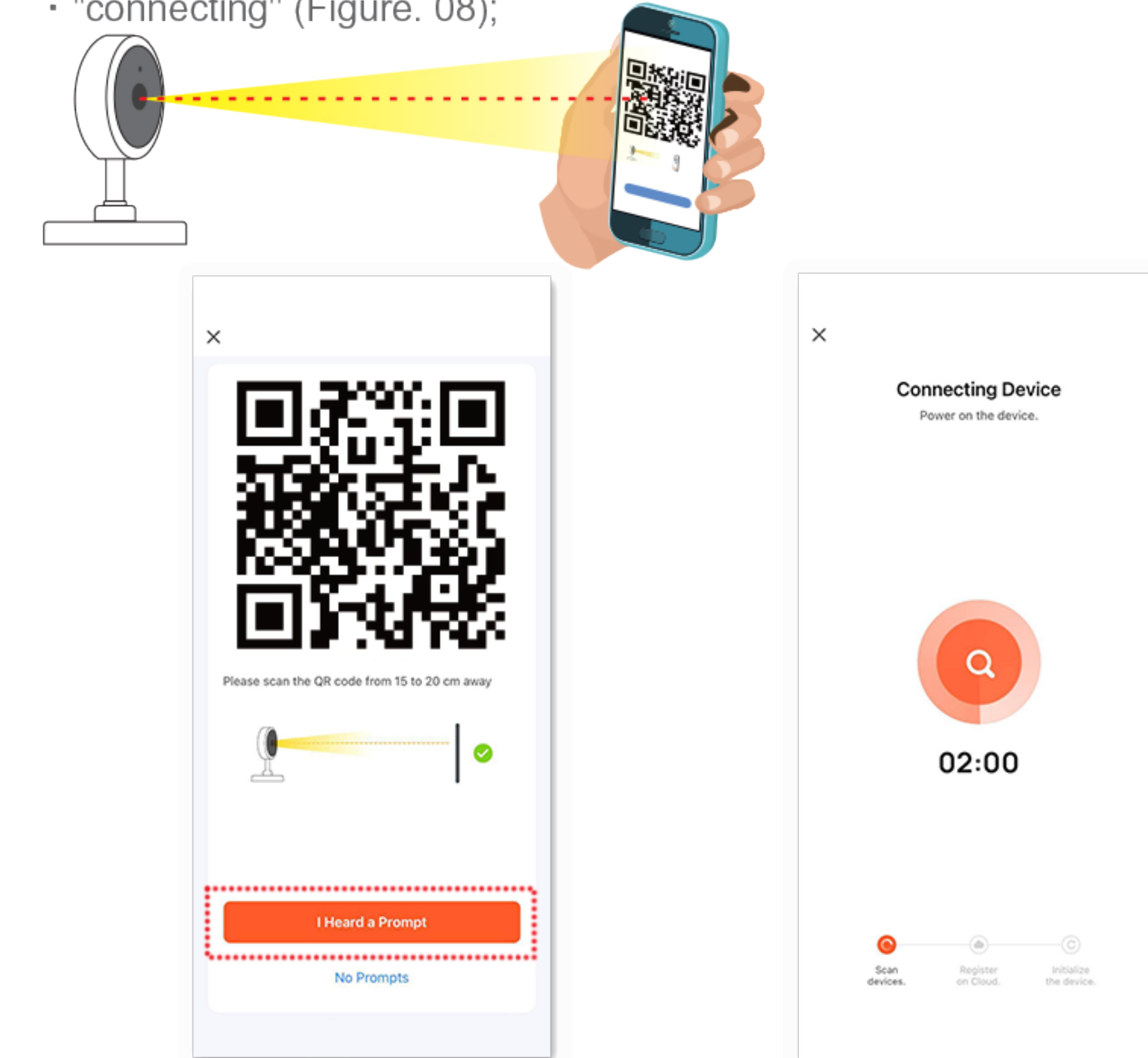

- connection completed(Figure 09), and click "Done";
- Then jump to preview interface (Figure 10)
- After closing the device preview interface, the interface returns to the APP home page. At this time, the connected device will appear on the APP home page (Figure 11). Then you can click directly to the device interface to see the monitoring situation without re-adding afterwards.

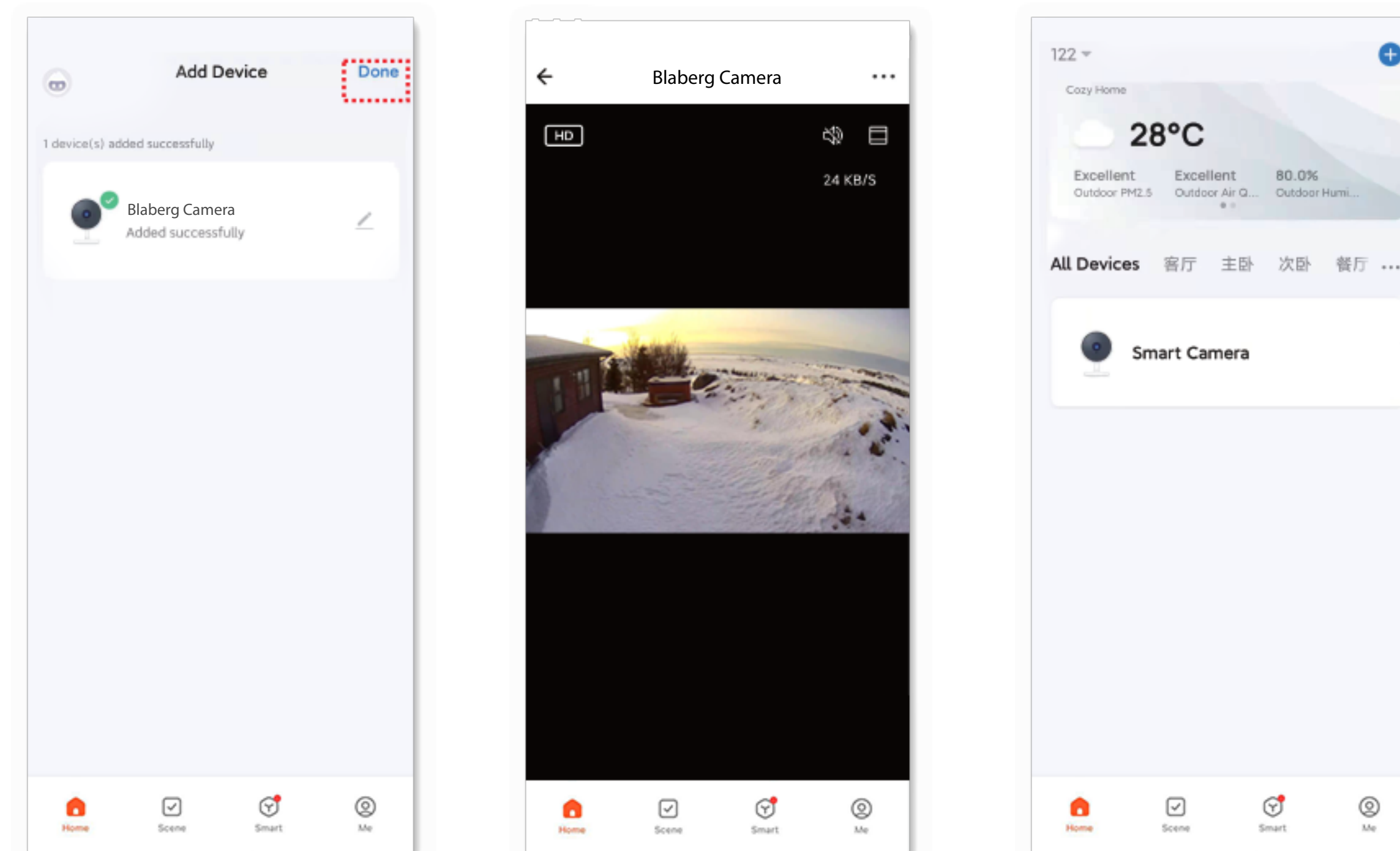

Flood light or IR light

Smart mode: Auto switch

Infrared mode: Active when dark

Colour light mode: Active when dark

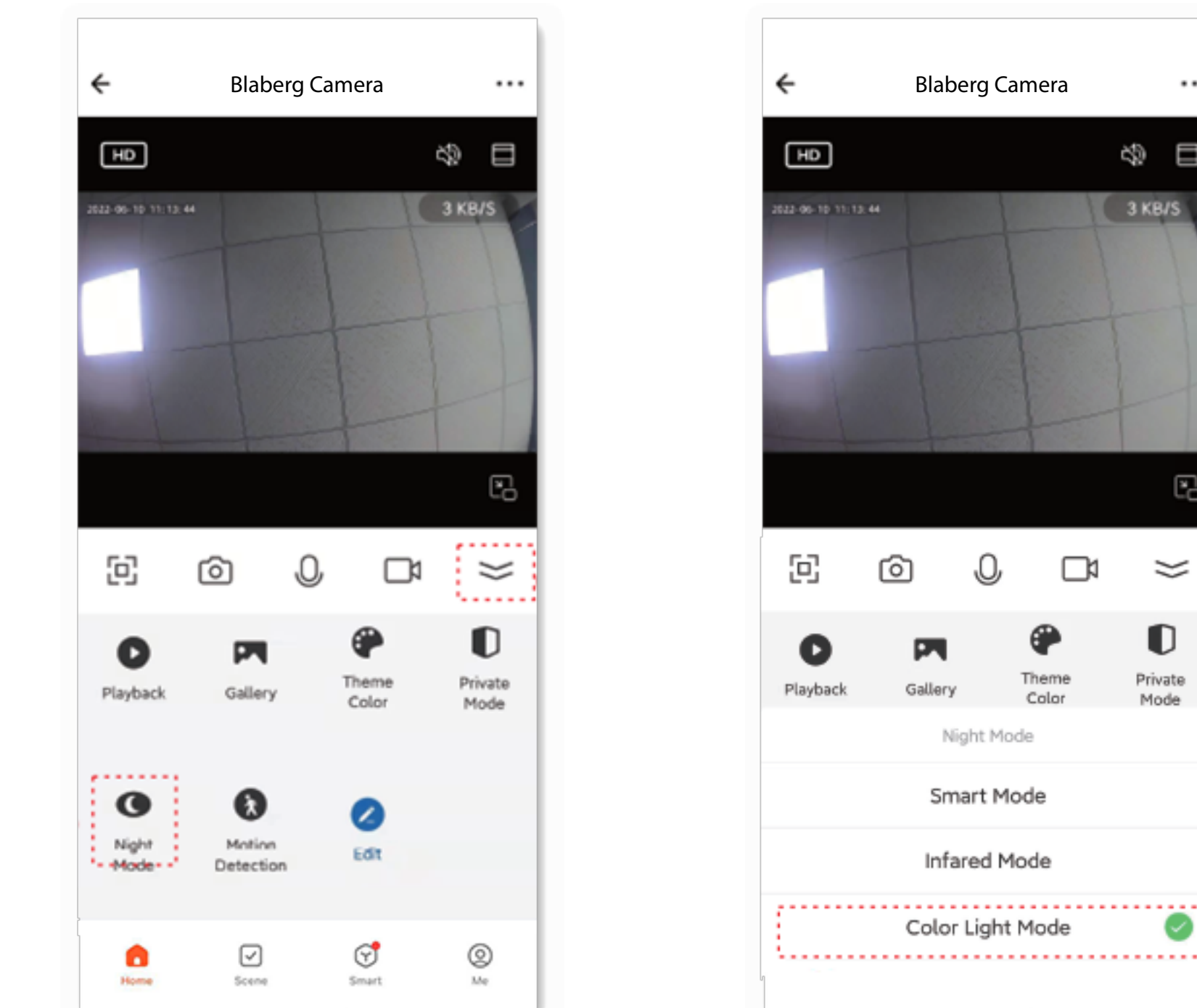

Other connection methods

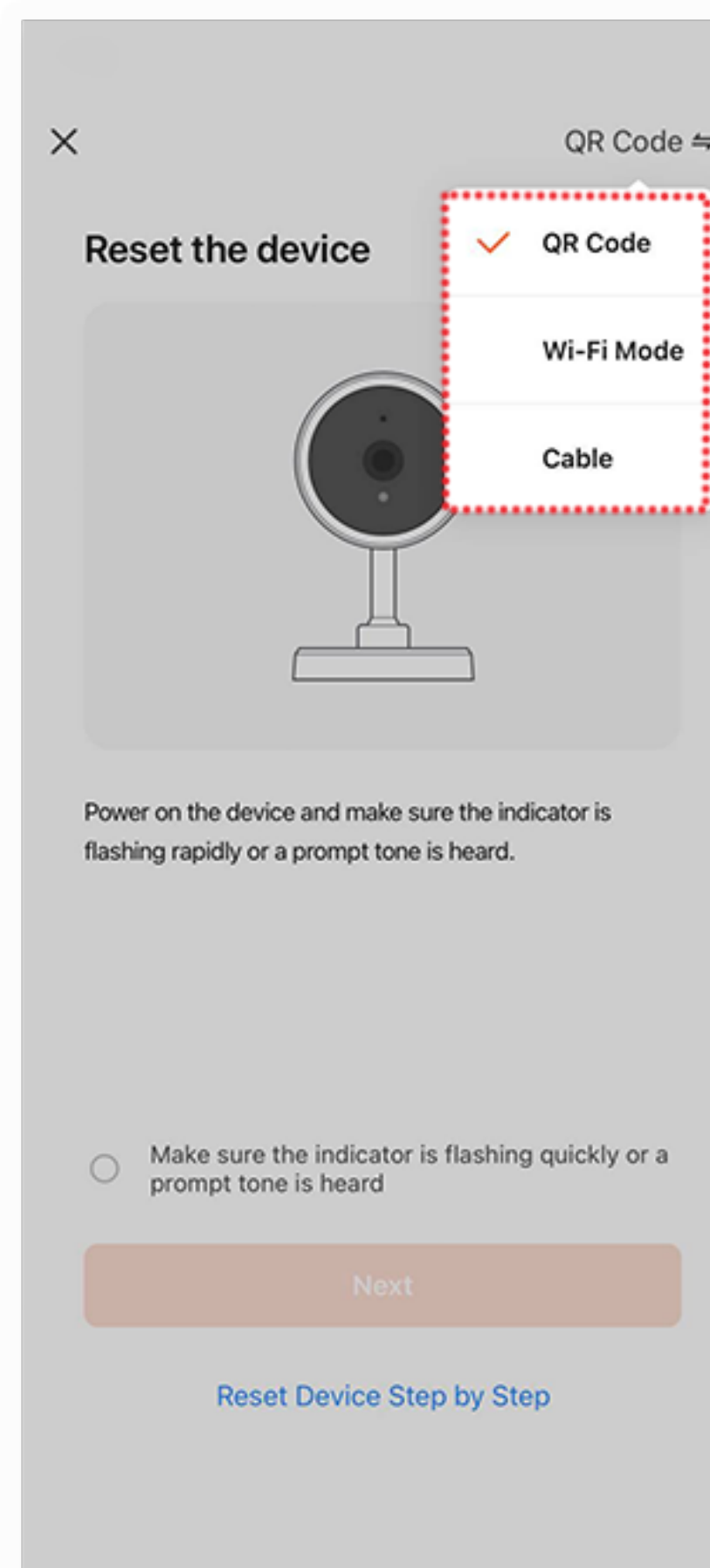

Matters Need Attention

Try to keep away from the metal space;
Avoid the furniture, microwave oven blocked;
Avoid the space where the audio, video and data lines are wound, and keep the space away from them as large as possible;
Ensure that as close as possible to the coverage of wireless Wi-Fi signals. Switching network environment;
In the new network environment, please press the reset hole about 5 seconds, then connect to the network.

The name and content of the harmful substances in the product

Part Name	Harmful Substance					
	Pb	Hg	Cd	Cr(VI)	PBB	PBDE
shell	○	○	○	○	○	○
Board	X	○	○	○	○	○
charger	○	○	○	○	○	○
annex	○	○	○	○	○	○

This form is based on the provisions of SJ/T 11364.
This product conforms to RoHS environmental protection requirements. At present, there is no mature technology in the world to replace or reduce the lead content in the electronic ceramics, porcelain, optical glass, steel and copper alloy.

Maintenance records: _____

Maintenance time: _____

Fault conditions: _____

Fault cause: _____

Troubleshooting: _____

Return and exchange proof: _____

Date of validity: _____

Original device ID: _____

New device ID: _____

maintenance personnel signature: _____

Maintenance Department seal: _____

Maintenance voucher of intelligent

Customer: _____ Mobile: _____

Address: _____

Model: _____ Camera ID: _____

Device store: _____ Date of purchase: _____

Store address: _____

Store contact number: _____

Maintenance voucher of intelligent

Customer: _____ Mobile: _____

Address: _____

Model: _____ Camera ID: _____

Device store: _____ Date of purchase: _____

Store address: _____

Store contact number: _____