

PT-300Q

Indoor WiFi Pan/Tilt Camera

User Manual

Things to Note before Getting Started

High-speed WiFi Internet Connection

One critical factor affecting the performance of your PT-300Q camera is the relative positions of your home WiFi router and the PT-300Q. Set up your PT-300Q in an open space (DO NOT place it directly on the floor); the closer the camera is to the router, the stronger the WiFi signal will be, and the better the footage on your smartphone will be.

A slow network speed will also affect the performance of your PT-300Q camera. It is recommended that you have an upload speed of at least 2Mbps or higher per camera. You can easily test your network's upload and download speeds by getting a speed-test app.

The PT-300Q only supports 2.4GHz WiFi band.

SSID and Password

Have your WiFi network name and password handy. The WiFi network name is normally referred as the SSID. The password or security ID is normally the next line or two down from the WiFi/SSID network name.

These can be easily found on your WiFi router if they were left as default during the router setup.

For example:

WiFi/SSID Network Name: XXXX

WiFi/SSID Network Password/Security Key: XXXXX

Operating System Requirements

- iOS 9.0 or above with iPhone 6 or newer
- Android 6.0 or above

Contents

Get to Know Your PT-300Q Camera	1~2
Getting Started	2~3
Setting Up Your Camera	4~5
App Control	6~11
App Operation	12-16
Installation	17
Specifications	18

Get to Know Your PT-300Q Camera

Overview

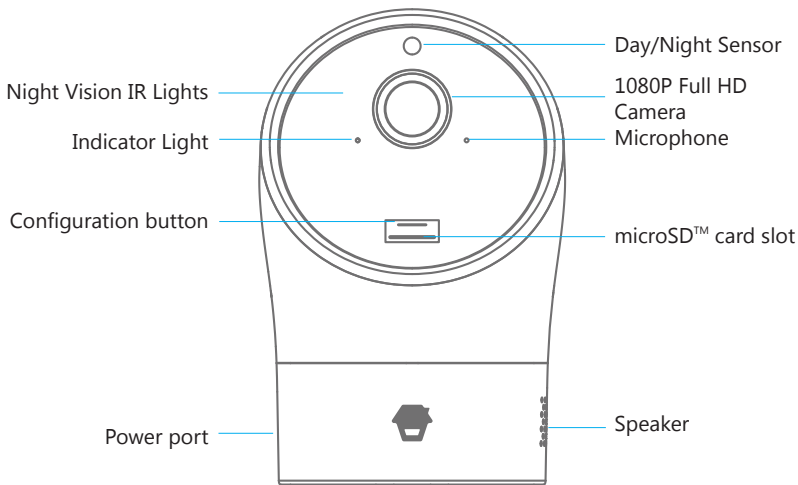

microSD™ Card (Not Included)

Supports up to a 128GB microSD™ card; please do not insert the card when the camera is powered on.

The video recorded at the earliest will be replaced with the most recent recording if the microSD™ card is full.

Note: If you are inserting a previously used microSD™ card, please format the card before inserting.

Indicator Light

The indicator light on the camera gives you an idea of the current device status. Here is a list of what each pattern means:

Camera booting up	Green LED Indicator	Blinks once per second
WiFi configuration mode	Red & green LED Indicator	Blinks alternately
Searching for network	Green LED Indicator	Blinks slowly
Connected to a network	Green LED Indicator	Solid
Real-time view	Red LED Indicator	Solid
Motion detection	Red LED Indicator	Blinks once
Firmware update	Yellow LED Indicator	Solid

Note: After device powering up, the camera will perform a self-check by rotating horizontally and vertically once.

Getting Started

Downloading the “DreamCatcher” App

Search for “DreamCatcher Life” in App Store/Google Play, then download and install the app.



Signing Up/In

Press "Sign up" just below the "Sign in" icon on the app, then follow the instructions to create your account first.

* If you do not receive an account verification code in your email inbox during the registration process, please remember to check your spam/junk folder and make sure the notice has not been blocked by your service provider.

Once you have an account with us, please select the "Sign in" icon and enter your email address and password to log in.

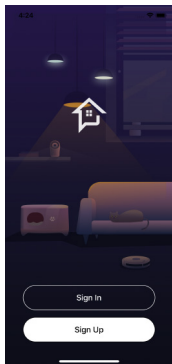

Adding Device

Tap the [+] button on the main page. Tap on [Security & Sensor], then follow the device set up steps to connect the camera with your home WiFi.

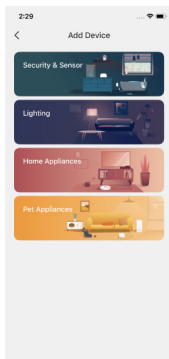
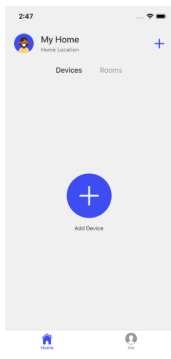

Setting Up Your Camera

- 1: Press and hold the configuration button underneath the camera lens for 3 seconds until you hear ONE beep.
- 2: If the red and green lights flash alternately, tap "Confirm" to enter your network information.
- 3: Tap "Connect" to move to the WiFi settings page and select the hotspot of the camera: "Smart WiFi Camera".
- 4: Return to the app after the connection.
- 5: Wait for the device to be connected. If the device is successfully connected to the internet, it will beep once.

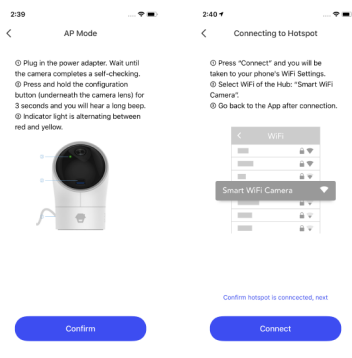

Important: The camera does not support 5GHz band WiFi. If a dual-band (5GHz and 2.4GHz) router is used, make sure to connect to the 2.4GHz WiFi instead of the 5GHz. Make sure your smart phone is connected to the local WiFi network and then follow the steps in the app to connect the hub to the router.

App Control

Live Video Page

Tap the device to enter real-time view page and more device settings.

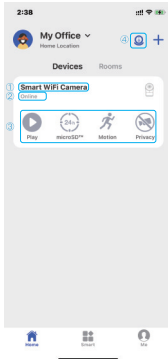

1. Device Name
2. Device Status
3. Shortcut Buttons: Real-time View, 24/7 Recording, Activity-triggered Events, and Activating Privacy Mode.
4. Simultaneous Multi-Camera Viewing

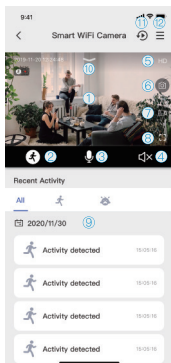

Tap the device to access real-time view and additional device settings.

- 1. Pan & Tilt Control of the Camera** Slide on the Live-View Screen to the left or right, up or down to adjust the overall view of your camera monitoring area.
- 2. Enable AI Human Detection** Tap to turn on the AI Human Detection. Tap on it again to turn the function off.
- 3. Microphone** Tap to talk with anyone near the camera. Tap on it again to turn the function off.
- 4. Enable Audio** Tap to enable audio for the surrounding area of your camera. Tap on it again to turn the function off.
- 5. Resolution** Tap to change the video resolution, high definition (HD) or standard definition (SD).
- 6. Snapshot** Tap to take screenshots that will be saved directly in your phone's album.
- 7. Record** Tap to record video clips that will be saved directly in your phone's album.
- 8. Full Screen** Tap to switch to full screen.
- 9. Recent Activity** Tap to play the activity-triggered video clips.
- 10. Privacy Mode** Drag the pull-down button to activate the privacy mode. When the camera is under privacy mode, NO video will be recorded.
- 11. All Video Records** Activity-triggered video clips, 24/7 recording, and cloud video clips (if enabled) are all in here.
- 12. More Settings** Tap to view more settings about the camera.

microSD™ Card

Tap the playback button to check activity-triggered alerts and 24/7 video (requires a microSD™ card).

Note: Motion-triggered video clips could be stored to the cloud if you have the cloud service activated.

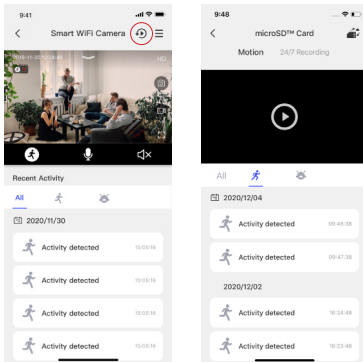

Motion

Tap to view activity-triggered events by all, human-triggered events and baby crying detection events. Or by selecting date below to check activity-triggered events.

From microSD™ Card - 24/7 Continuous Recording

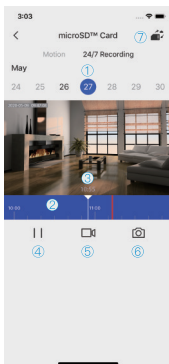

1. Select date
2. Timeline: slide back and forth to select a time to play the corresponding video.
(Motion alert: activity was detected in this interval marked in red.)
3. Current time
4. Pause/play button
5. Video recording *
6. Snapshot *
7. microSD™ card/cloud switch

* While you review the recording saved to the memory card, you can also manually save snapshots and video clips of interest directly to your phone's album.

Cloud Recording

Tap the microSD™/cloud switch button to view your video clips of events after activating a cloud plan.

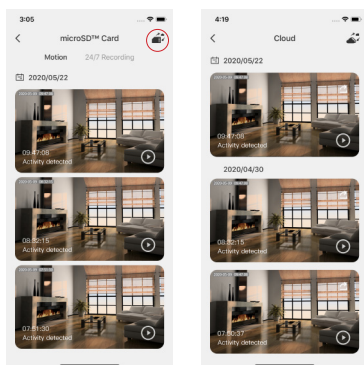

Activity-triggered events could be accessed in [Me]-[Message Center]-[Alerts] as well.

Settings

Tap the [☰] button to enter the camera setting page.

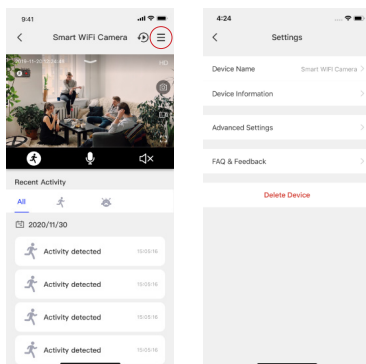

Device Name

This setting enables you to rename your camera. The new name will be shown on the Live View Page and Main Page.

Device Information

This shows detailed information of the camera and updates firmware.

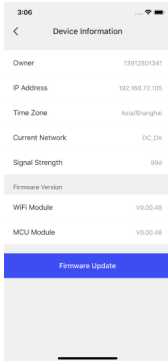

Advanced Settings

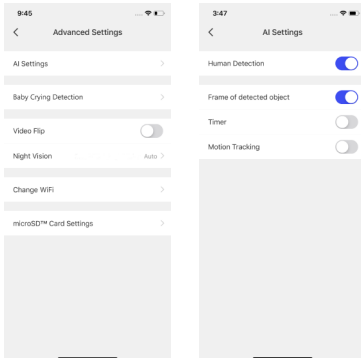

1. AI Settings

Tap to enable functions such as: human detection and motion tracking, show frame of detected human and set timer. When the human detection and motion tracking are turned on, the camera will track the moving person and record a video clip when it detects any human movement.

You can set the timer which human detection will turn on as scheduled time.

2. Baby Crying Detection

This function is dedicated to baby monitoring. When the camera detects the sound of a baby crying, it will send you notifications. You can set a custom schedule for sound detection.

3. Video Flip

Flip your view angle of the real-time play when your camera is mounted on the ceiling.

4. Night Vision

Tap to choose night vision function to be automatically turned on, always on or off to ensure clear recordings in the dark.

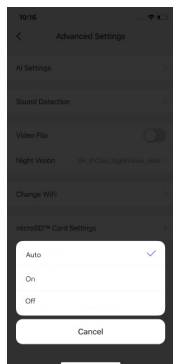

5. Change WiFi

This setting enables you to connect your online camera with another nearby WiFi network, without repeating the camera & phone binding process.

6. microSD™ Card Settings

This shows your memory card usage status. Format setting will wipe all the recordings on your memory card.

Note: This process is irreversible, so please do perform with caution!

FAQ & Feedback

Find questions and answers regarding the camera, and send feedback of the product or the application.

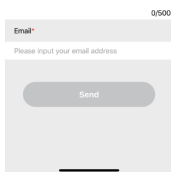
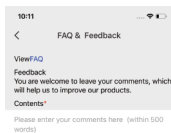

Delete Device

This deletes the device from your account.

App Operation

Main Page

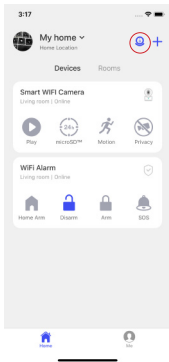

Simultaneous Multi-Camera Viewing

If you have two or more cameras, you can view them simultaneously by tapping the camera icon at the top right corner of the main page

Devices

There are four shortcut actions right below the camera online status: real-time view, 24/7 recording, activity-triggered detection events, and turning on the privacy mode.

Rooms

If you have created rooms for your home, the rooms will be listed here. Check for more information on [Me]-[Home Management]-[My Home]-[Room Management]. You can assign the camera to any room (for example Living Room), then the camera will be shown under [Rooms]-[Living Room] as well.

Account Management

Tap the portrait on the main page to enter the account management. You can change your profile photo, add nickname and check your account and security related items to change sign-in password or delete your account.

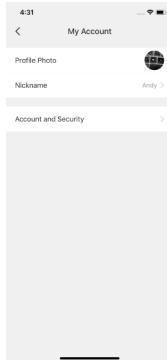
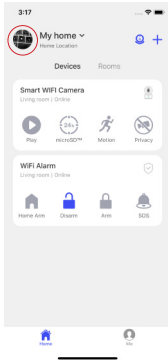

Home Management

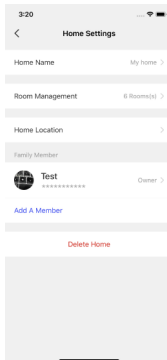
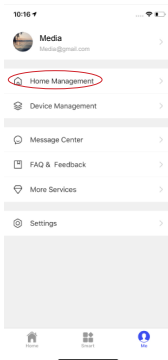

Tap [Me] on the main page and tap [Home Management] to add home name, home location, rooms and members to your home.

You can create different homes and classify devices to specific homes, then you can tap the home name next to the portrait on the main page to control different home's devices.

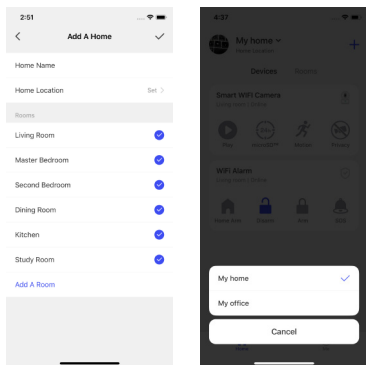

Add an unregistered user by sending email through the app to join your home.

There are two access level for users.

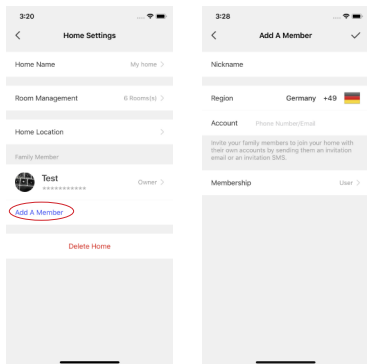

Administer (Full Access)

Administrators have full access but they are unable to re-share the device(s) to others.

User (Read Only)

Users can only edit the name of the camera(s) and receive alerts for activity-triggered detection. They are unable to re-share the camera(s) to other users or changing the settings.

Device Management

You can check all the devices under the same account. This includes devices from homes you own, homes you are a member of, and devices shared by others to you.

You can share individual devices to others without adding them to your home. Tap the device and then tap [+] to share it to other registered accounts. You can also delete a shared account if you want to remove access to the device you shared.

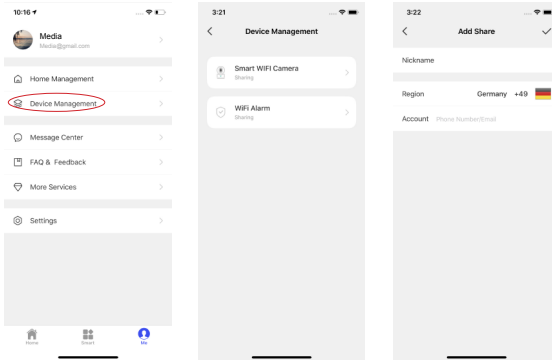

Message Center

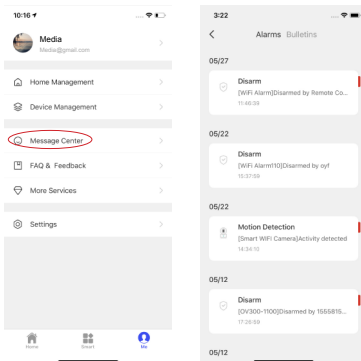

Alarms

Here you can check camera's activity-triggered events.

Bulletins

Here you can check all system notifications, like firmware update, remote/different smart phone login alert and device sharing invitation, etc.

FAQ & Feedback

Tap to find questions and answers to the products and application. Feel free to send us feedback on the product or the service.

More Services

Here you can purchase cloud storage plan for the camera and find third party integrations such as Alexa and Google Assistant.

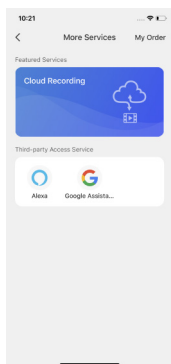

Settings

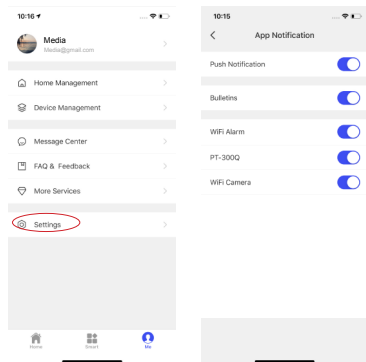

App Notification

You can enable push notifications which include alarm and bulletin information or you can disable the push notification of a specific device.

Installation

Desk Stand

Put the camera on any desk or flat surface.

Warning: Keep the power cord at least 1m away from baby cribs and out of reach of children and infants.

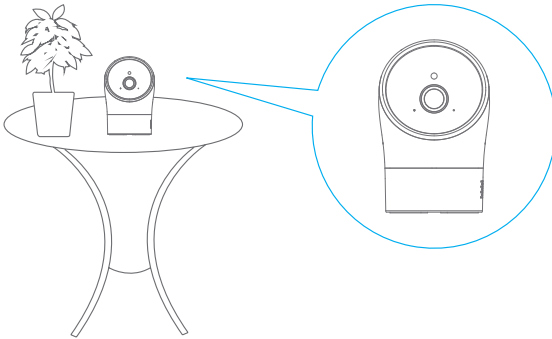

Ceiling Mount

Drill the holes and fit the anchors. Then, install the camera bracket with the provided fixing screws and lock the camera to the bracket.

You can enable video flip on [Camera Settings]-[Advanced Settings] after installation.

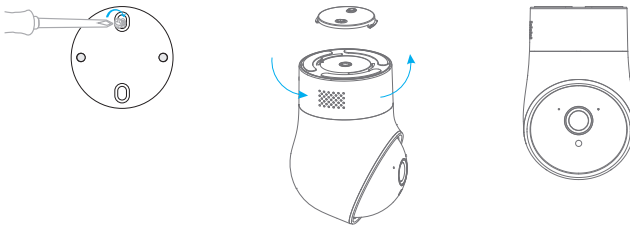

Note: Please place this unit away from load-bearing walls and operating home appliances. Elevate this unit and your modem or router away from the ground to ensure the best possible connectivity.

Specifications

Image Sensor	1/2.9 " CMOS Sensor
Field of View	82°
View Range	350°Horizontal, 110°Vertical
Video Compression	H.264 Encoding
Audio	Built-in Speaker and Microphone
Max. Image Resolution	1920*1080
Min. Illumination	Color: 0.01Lux@F1.2, Black and White: 0.001Lux@F1.2
WiFi	IEEE 802.11 b/g/n
Local Storage	Built-in microSD™ Card Slot, up to 128GB
Night Vision	9 x IR LEDs, Illuminates up to 3 meters
Power Supply	DC 5V 2A
Power Consumption	7W Max.
Operation Condition	Temperature 0°to 50°, Relative Humidity < 80% (non-condensing)