

# OWNER'S MANUAL

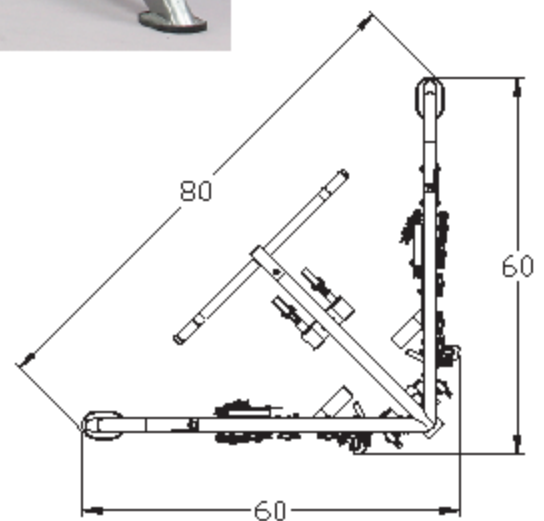

CXT-100  
CORNER MULTI-FUNCTIONAL TRAINER



CXT-100  
L 60" W 60" H 84"



*AMERICA'S PREMIER EXERCISE EQUIPMENT*

## Introduction

**A**bout the CORNER MULTI-FUNCTIONAL TRAINER CXT-100  
Congratulations on your new purchase of the Super Rack/Smith Machine. We hope you are completely satisfied with this product and wish you many years of enjoyment.

### Tuff Stuff Equipment

This Tuffstuff product has been built to precise quality standards and has been carefully packaged to ensure that damage will not occur during shipment. The Limited Warranty and signature indicating final inspection has been conducted by our line foreman, is an expression of our confidence in the completeness, the materials, and workmanship of this product.

### Warranty

SEE A COPY OF WARRANTY ON BACK PAGE.

### Registration Card

To avoid unnecessary delays in warranty service and to insure that a permanent record of your purchase is on file with our factory, be sure to complete the warranty registration card and send it to TuffStuff Fitness Equipment today.

### Specifications

1. Maximum Wt. Capacity - 150 lbs.
2. Total Machine Weight - 595 lbs.
3. Footprint (LWH) - See Front Cover.

Note: Due to continuing product improvements, specifications and designs are subject to change without notice.

## Maintenance



### TuffStuff Basic Strength Equipment Safety and General Maintenance

All TUFFSTUFF strength equipment is designed and manufactured to offer maximum, long-life service with minimal maintenance. However, safety inspection and routine maintenance in your facility should be the utmost importance in your daily operation. Information presented in these pages will serve as a basic guideline to design your own inspection procedures.

#### Part One: General Inspection and Cleaning

Equipment should be wiped down with a damp cloth and dried on a daily basis. Sweat is corrosive and when left on the frame and components will eventually cause corrosion or rust. When performing these cleaning sessions, it is the perfect time to inspect the equipment and note any problems for the maintenance personnel to correct.

1. Check equipment if it is operating properly.
2. Check the cable for loose fittings or frayed cable and is seating properly on the pulleys and cams.
3. Make sure that the proper weight stack selector pin is with each machine and that the pin functions properly.
4. If something appears loose be sure to have it tightened immediately.
5. If a piece of equipment appears damaged or not operation properly, place the piece out-of-service immediately.

**P**rior to the Assembly of the CORNER MULTI-FUNCTIONAL TRAINER

1. We advise you to consult your local Tuff Stuff retailer if you should have a question or problem regarding the proper assembly of this unit.

### Tool Requirements

1. One 3/4" combination wrench
2. One 9/16" combination wrench
3. One ratchet
4. One 3/4" socket
5. One 9/16" socket
6. One rubber mallet
7. Windex or household glass cleaner
8. Measuring tape
9. Utility knife

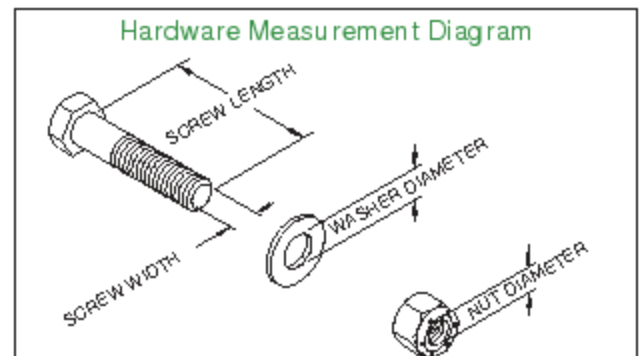

## Part Two: Maintenance

In this paragraph, we will discuss the inspection of the cables, pulleys and their associated components. If there exists the potential for injury to occur on a machine, it will most likely lie in the cable system. It is important to inspect the cables frequently and let it be known to all users that it is their responsibility to report any worn-out cable to prevent a sudden failure that can result in an injury. Cables are moving parts, meaning cable-wear will occur regardless of the type or size used. In the advent of the 3/16" mill-spec cable this wear takes longer to become apparent and this is why frequent inspections are so important.

1. Check the cable termination at the weight stack. To perform any cable tension adjustment, loosen the hex jam nut and thread the hex tap bolt in or out to give cable the proper tension. Re-tightened the hex jam nut when adjustment is complete and make sure the hex tap bolt is threaded 1/2" into the socket of the selector bar top plate.
2. Check the end fitting for any signs of fraying in this area. Inspect the bolt and nut and/or screw holding the fitting and be sure that it is tight.
3. Check the cables as it passes over all pulley wheels. Visually inspect the cables and pulleys. A cable that is wearing will exhibit a ballooned surface that passes over the pulley. This is an early warning sign to replace the cable.

## Part Three: Lubrication

TuffStuff uses only the highest quality bearings and linear motion components that are virtually trouble-free but requires the regular preventive maintenance to insure long-lasting performance.

1. Bronze and nylon bushings, we recommend on a monthly basis to spray a teflon-base lubricant (silicone-free) directly onto the shaft as it passes through these bushings. Spray a small amount onto the shaft and rotate it through its complete movement and wipe off any excess.
2. Weight stack guide rods and bushings, again use teflon spray lubricant and this time spray onto a rag and wipe the guide rods down with this rag on a weekly basis. Do not use WD-40 or other lubricants as they attract dirt and will create a mess between the weight plates and bushings.
3. Sealed bearings pivot points, as the name implies are protected from the outside environment and require no lubrication. During the machine wipe down, wipe the external bearing surfaces with the damp rag and dried to prevent the build up of dust and sweat.

If you religiously perform the maintenance procedures, you will increase the life of the machine and ultimately lower your maintenance costs with fewer replaced components and downtime.

Any doubts, equipment with mechanical problems should be placed "Out-of-Service" until all problems are corrected. If replacement parts are required or maintenance questions, please contact TuffStuff Service Department:

Phone: 909-629-1600 Fax: 909-629-4967 e-mail: [service@tuffstuff.net](mailto:service@tuffstuff.net)

# CXT-100 Weight Resistance

## Attention Users!

This machine has been designed with a unique mechanism that allows you to reduce the actual physical weight by 50%. Despite your excitement to begin using the equipment, you **MUST** become familiarized on how it works, so please take a few moments to follow the quick instructions included on this sheet. Lack of attention to caution can result in an accident. We thank you for choosing our products, and hope you will enjoy it.

Make sure both WRC (Weight Resistance Conversion) devices are set to the same adjustment setting and each weight stack to have the same amount of weight selected, when using the Dual Lat Pulley Station or the Dual Low Row Station for a bilateral exercise. This will aid perform a balanced and uniform exercise.

The WRC (weight resistance conversion) device allows changing the weight resistance to 50% or 100% of the weight selected for the Dual Lat Pulley Station and the Dual Low Row Station.

To engage to **100%** weight resistance, hold the handle and slide device to the **B** position.

### Two WRC (Weight Resistance Conversion) Devices

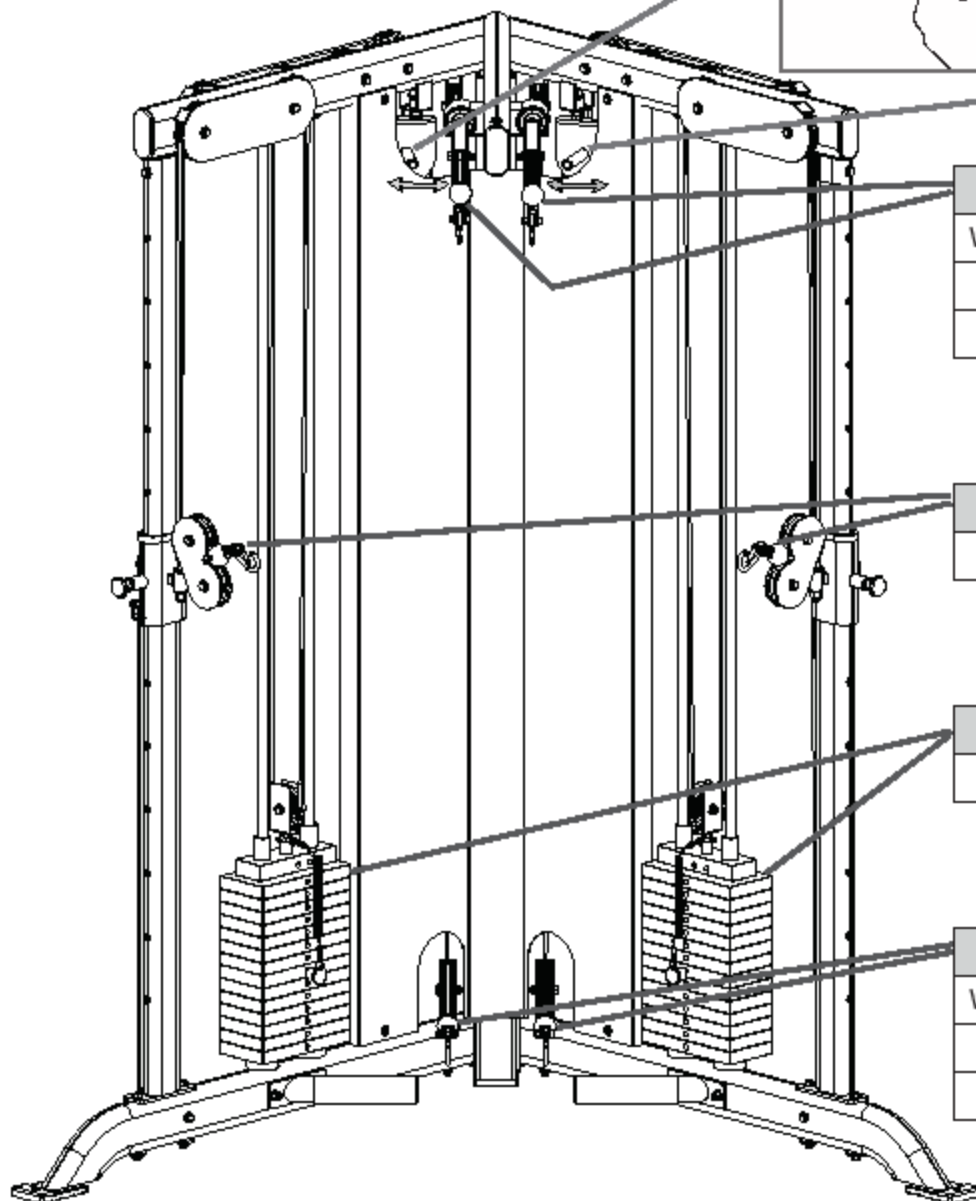
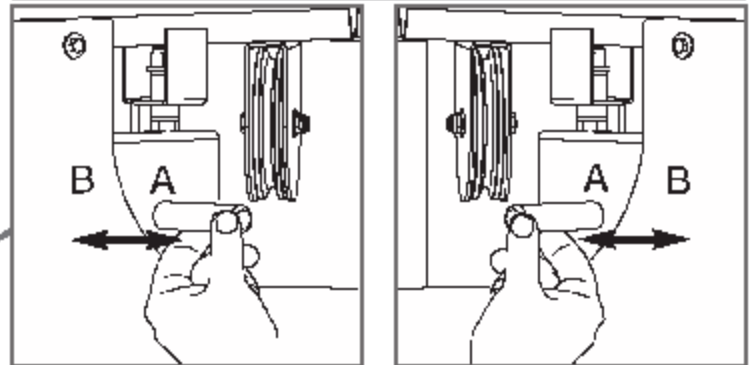

Dual Lat Pulley Station	
WRC Setting	Resistance
A	<b>50%</b> of Selected Weight
B	<b>100%</b> of Selected Weight

Dual High/Low Pulley Station
<b>50%</b> of Selected Weight

Two Weight Stacks
Actual Physical Weight <b>150 lbs.</b> each

Dual Low Row Station	
WRC Setting	Resistance
A	<b>50%</b> of Selected Weight
B	<b>100%</b> of Selected Weight

## Assembly List

Item #	Description	Qty.
2	CABLE RETAINER BRACKET	2
5	CARRIAGE RT	1
16	CARRIAGE LT	1
18	LEFT SIDE BASE FRAME	1
21	REAR UPRIGHT	1
22	RIGHT SIDE BASE FRAME	1
24	NICKEL SELECTORIZED UPRIGHT	2
56	FLAT WASHER SAE B/O 3/8"	20
62	HEX HEAD CAP SCREW GR-5 B/O 3/8-16 X 1 3/4	2
67	HEX HEAD CAP SCREW GR-5 B/O 3/8-16 X 4 1/4	4
69	HEX HEAD CAP SCREW GR-5 B/O 3/8-16 X 5	4
78	NYLON INSERT LOCK NUT B/O 3/8-16	12
80	NYLON INSERT THIN PATTERN LOCK NUT B/O 3/8-16	4
81	NYLON PULLEY 3/8 X 1 X 4 1/2 BLACK	4

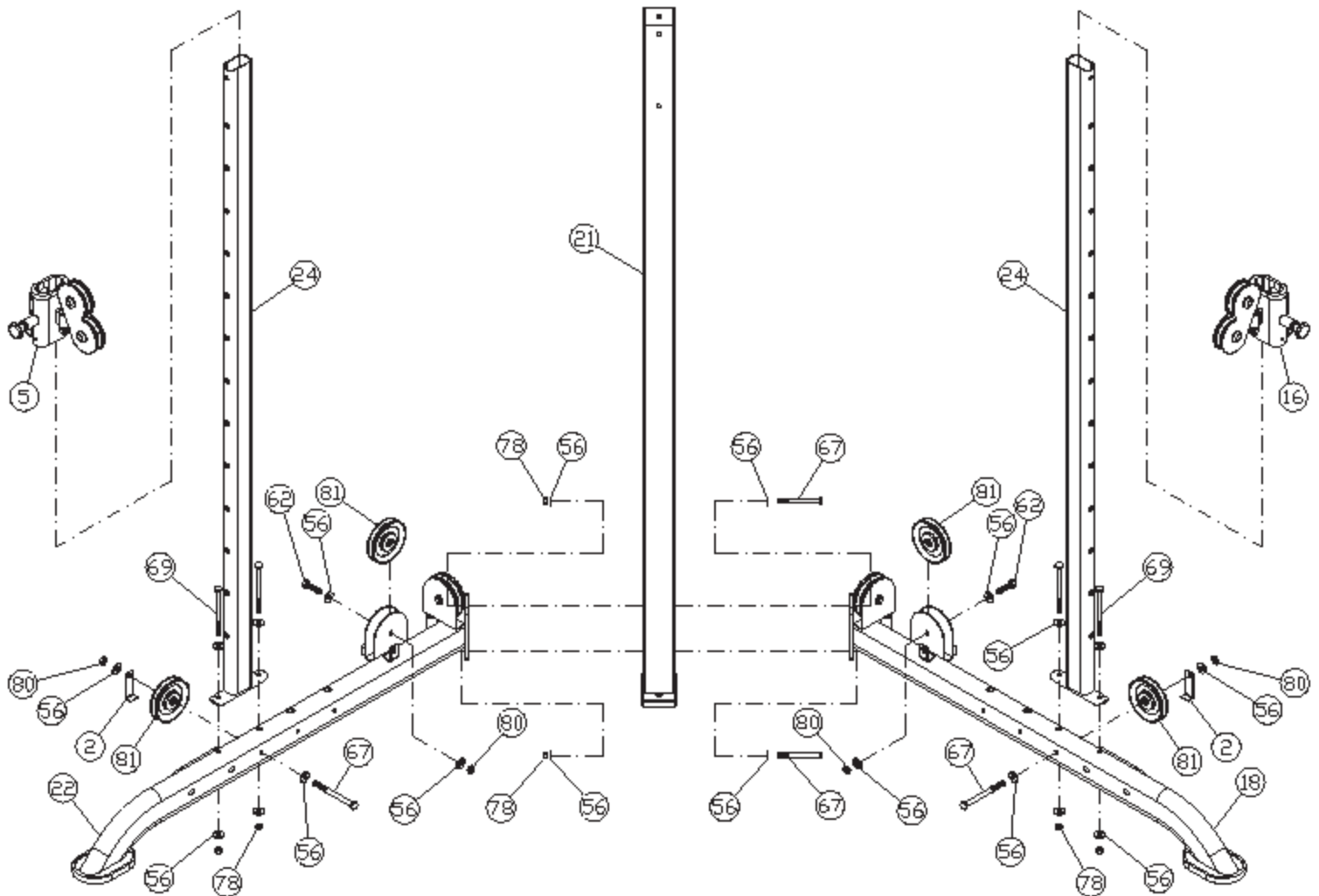

## Step 2

### Assembly List

Item #	Description	Qty.
6	CHIN UP BAR	1
26	TOP FRAME	1
27	TOP SWIVEL PULLEY BRACKET	2
34	BLACK NYLON PULLEY 3/8 X 1 X 3 1/2	2
56	FLAT WASHER SAE B/O 3/8"	8
59	HEX HEAD CAP SCREW GR-5 B/O 3/8-16 2 1/2	1
60	HEX HEAD CAP SCREW GR-5 B/O 3/8-16 X 1	2
61	HEX HEAD CAP SCREW GR-5 B/O 3/8-16 X 1 1/2	2
65	HEX HEAD CAP SCREW GR-5 B/O 3/8-16 X 3 3/4	2
80	NYLON INSERT THIN PATTERN LOCK NUT B/O 3/8-16	3
82	PLASTIC END CAP BLACK-BUMPER RH20	4
87	RETAINING SNAP RING EXT. PLAIN 1 1/4"	2
97	SPLIT LOCK WASHER B/O 3/8"	2
98	STEEL BUMPER WASHER Z/P 3/8"	4

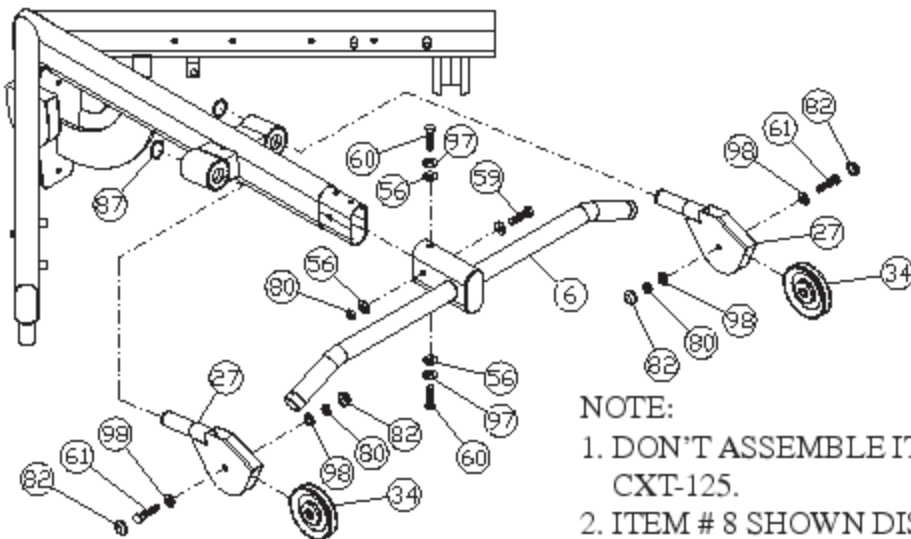
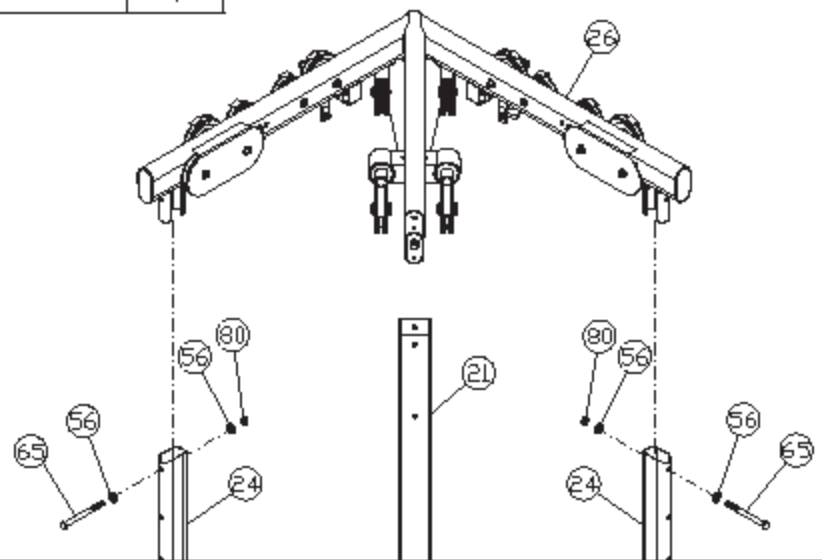

**NOTE:**

1. DON'T ASSEMBLE ITEM #6 IF YOU ARE ASSEMBLING THE CXT-125.
2. ITEM # 8 SHOWN DISASSEMBLED FOR CLARITY ONLY.

NOTE:  
ITEM # 8 SHOWN DIASSEMBLED  
FOR CLARITY ONLY.

## Assembly List

Item #	Description	Qty.
3	CABLE RETAINER BRACKET (3 1/2 PULLEY)	2
7	CONVERSION DOUBLE PULLEY BRACKET	2
8	CONVERSION SWIVEL PULLEY BRACKET	2
9	CONVERSION SWIVEL PULLEY BRACKET HANDLE	2
11	CONVERSION GUIDE ROD	2
56	FLAT WASHER SAE B/O 3/8"	14
62	HEX HEAD CAP SCREW GR-5 B/O 3/8-16 X 1 3/4	4
63	HEX HEAD CAP SCREW GR-5 B/O 3/8-16 X 2	2
70	HEX HEAD CAP SCREW GR-5 B/O 3/8-16 X 5 1/4	2
80	NYLON INSERT THIN PATTERN LOCK NUT B/O 3/8-16	8
81	NYLON PULLEY 3/8 X 1 X 4 1/2 BLACK	6
92	RUBBER GRIP 1/2 X 3 1/2	2
97	SPLIT LOCK WASHER B/O 3/8"	2
100	UHMW PLASTIC 1/2 ID X 1 OD X 1 1/4	2

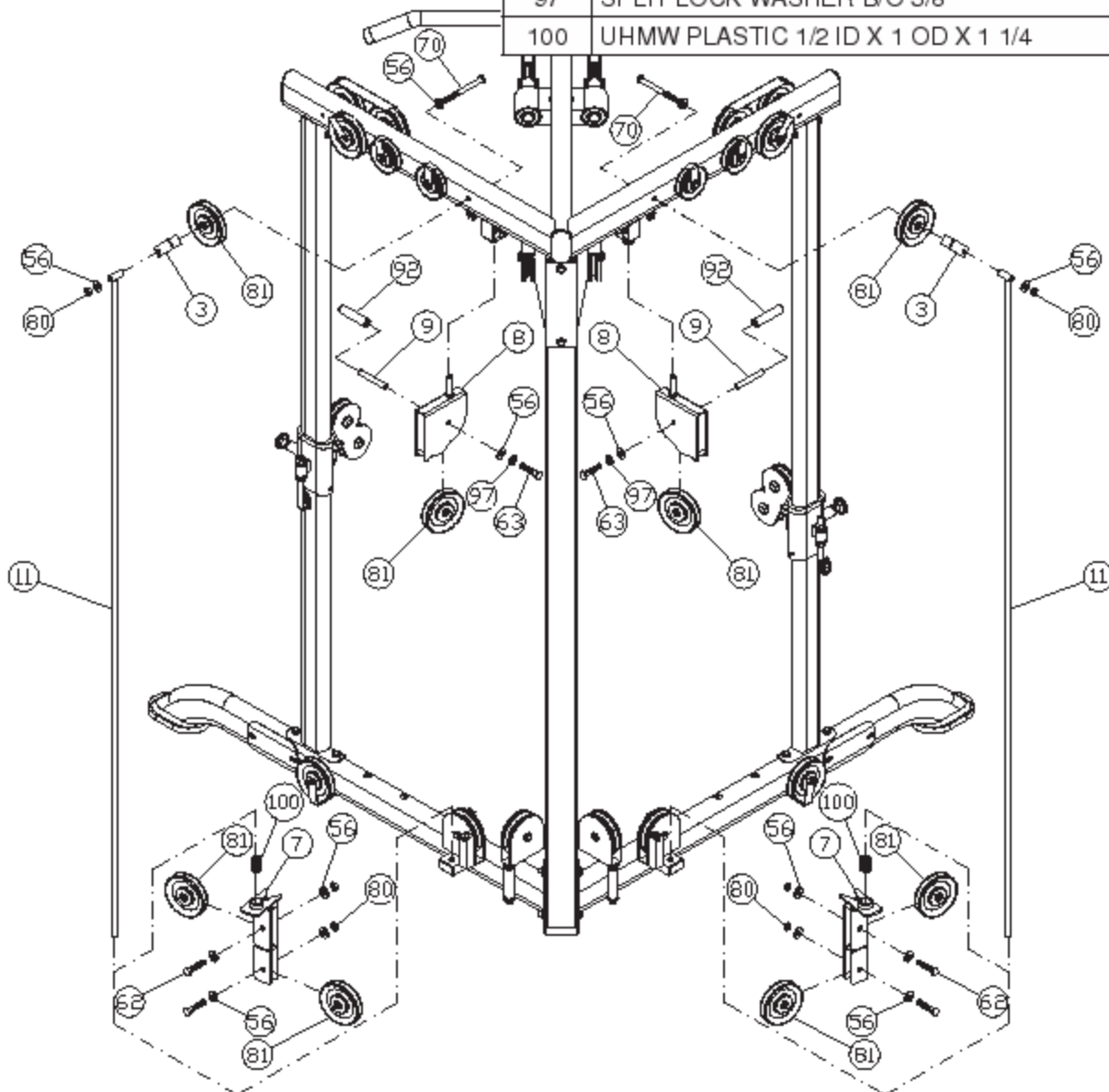

## Assembly List

Item #	Description	Qty.
14	GUIDE ROD 3/4 X 76 3/4	4
23	SELECTOR PIN W/COIL 3/8 X 3 1/4	2
25	SINGLE 3 1/2 PULLEY BRACKET	2
34	BLACK NYLON PULLEY 3/8 X 1 X 3 1/2	2
40	10 LB STEEL WEIGHT PLATE BLACK	28
49	DECAL-WEIGHT NUMBERS REF TP-10 (150 lbs)	2
51	FINISHED HEX NUT B/O 1/2-13	2
56	FLAT WASHER SAE B/O 3/8"	4
62	HEX HEAD CAP SCREW GR-5 B/O 3/8-16 X 1 3/4	2
66	FLAT WASHER B/O 3/4 X 2"	4
72	10 LB TOP PLATE W/ADJ. SLTR BAR 14 WTS	2
80	NYLON INSERT THIN PATTERN LOCK NUT B/O 3/8-16	4
88	RUBBER DONUT 3/4 X 2 1/2	2
96	SPLIT LOCK WASHER B/O 1/2"	2

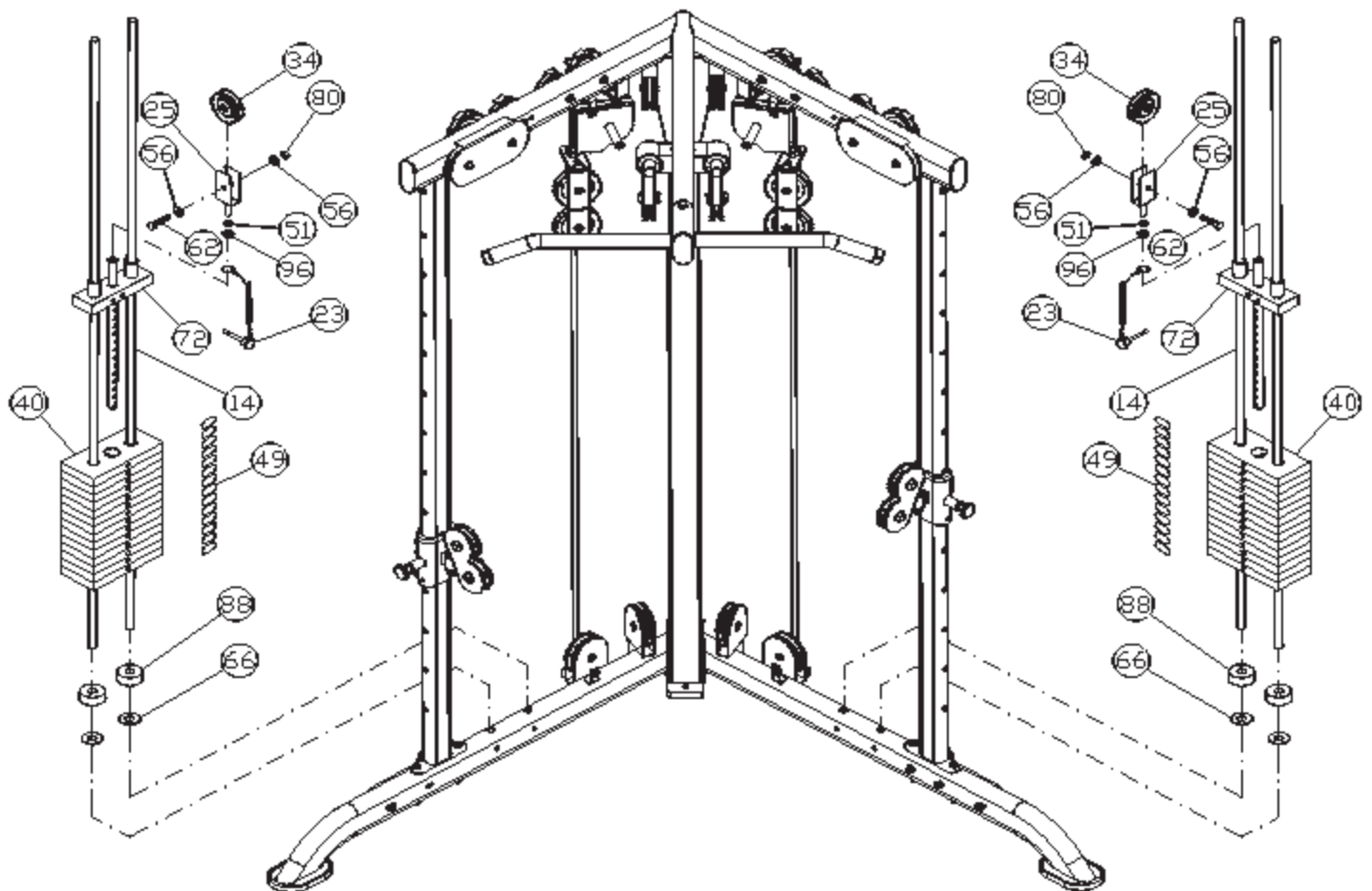



## Assembly List

Item #	Description	Qty.
13	FOOT SUPPORT	2
56	FLAT WASHER SAE B/O 3/8"	8
64	HEX HEAD CAP SCREW GR-5 B/O 3/8-16 X 3	2
78	NYLON INSERT LOCK NUT B/O 3/8-16	4

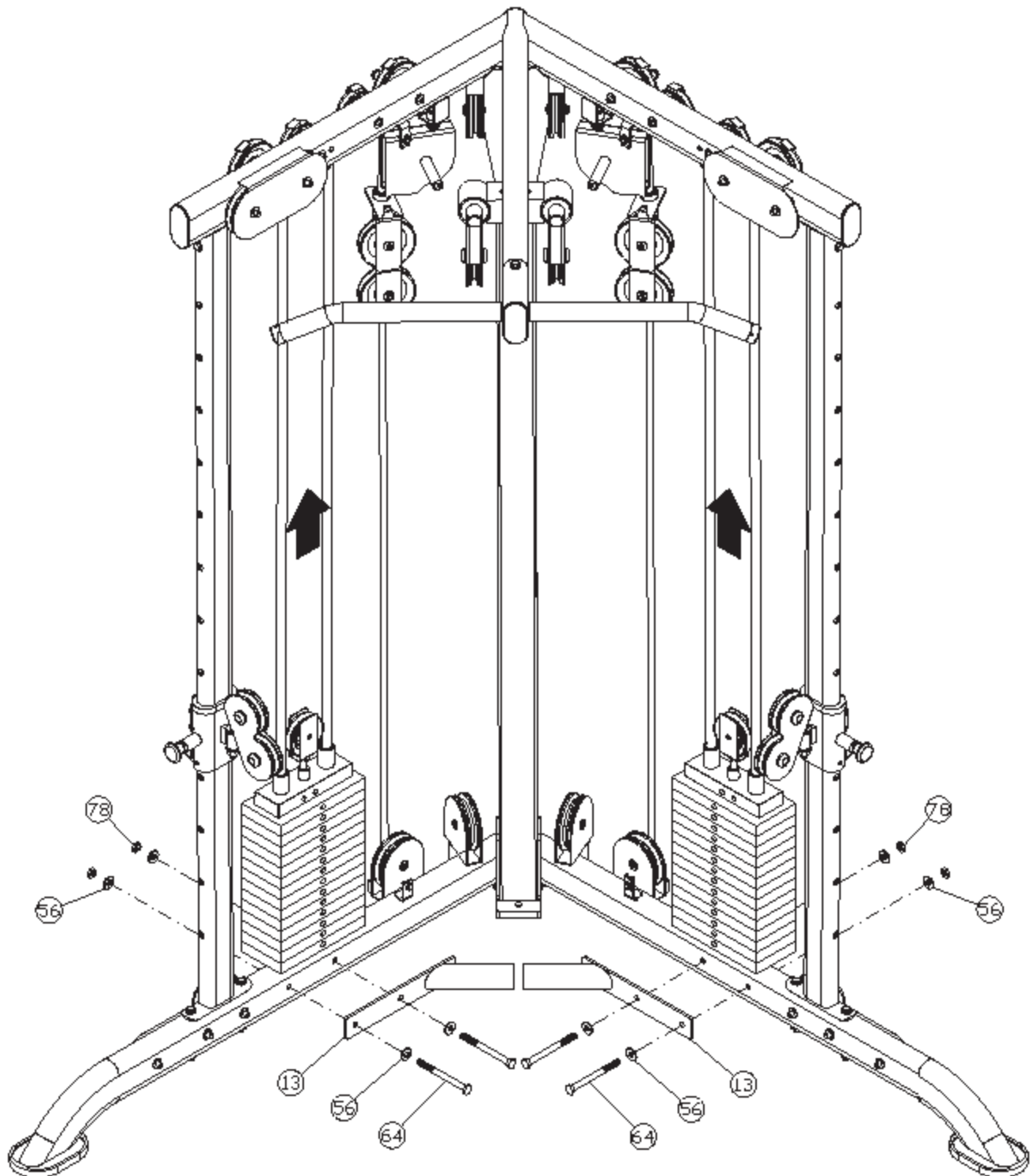

## Step 6 Lat Cable Assembly

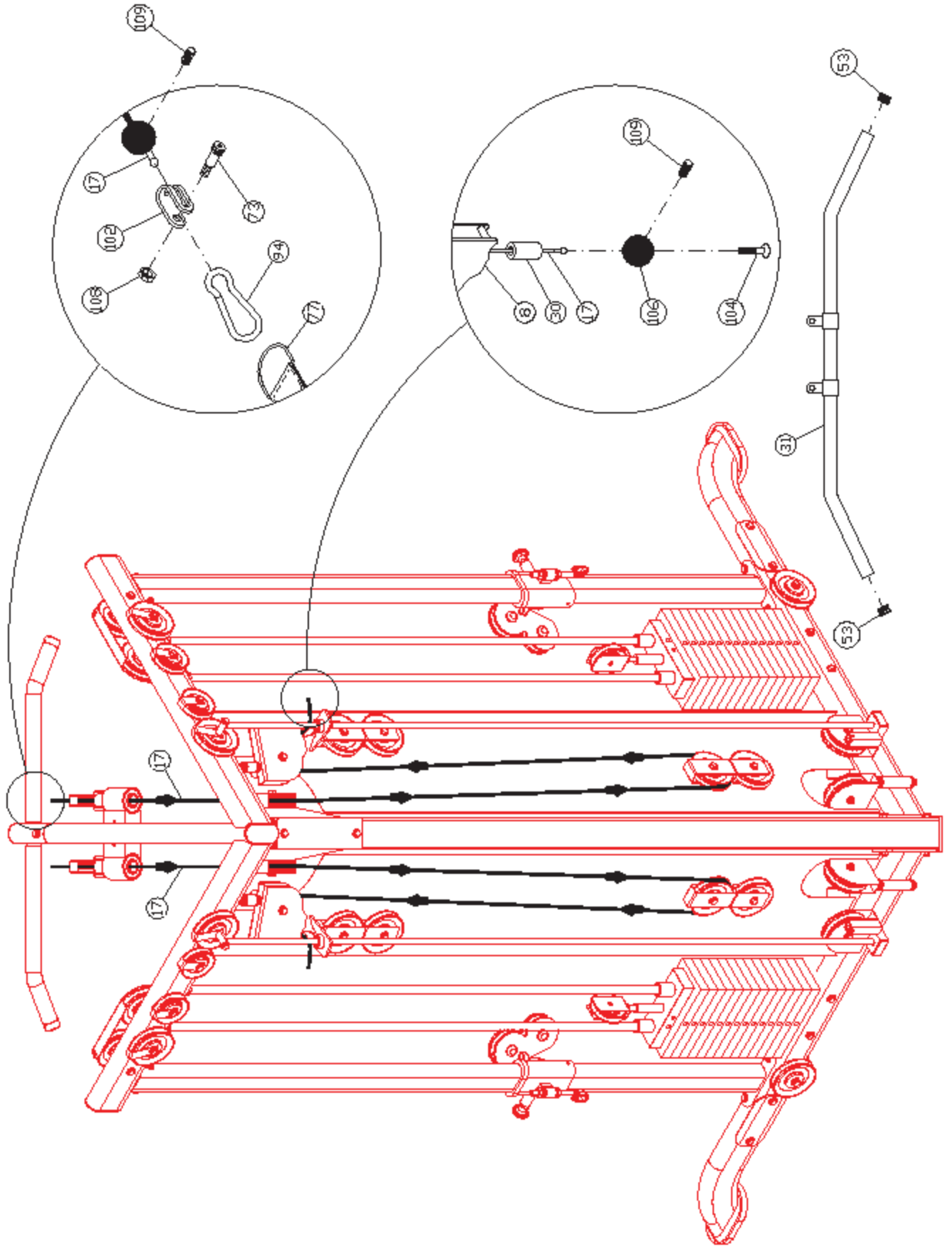

COLOR CHART  
 GRAY- SUB-ASSEMBLY PARTS  
 BLACK- HARDWARE

# CXT-100

## Parts List

Item No.	Description	Rev.	Part No.	Qty.	Item No.	Description	Part No.	Qty.
1	ADJUSTABLE CABLE BOLT	0	UP3648	2	56	FLAT WASHER SAE B/O 3/8"	BNF0239	96
2	CABLE RETAINER BRACKET	0	UP0014	6	57	FLAT WASHER USS B/O 1/4"	BNF0233	4
3	CABLE RETAINER BRACKET (3 1/2 PULLEY)	0	UP0998	4	58	HEX HEAD CAP SCREW GR-5 B/O 1/4-20 X 3/4	BNF0890	4
4	CARRIAGE DOUBLE PULLEY BRACKET	0	UP3635	2	59	HEX HEAD CAP SCREW GR-5 B/O 3/8-16 2 1/2	BNF0276	1
5	CARRIAGE RT	0	UP3887	1	60	HEX HEAD CAP SCREW GR-5 B/O 3/8-16 X 1	BNF0275	2
6	CHIN UP BAR	0	UP3883	1	61	HEX HEAD CAP SCREW GR-5 B/O 3/8-16 X 1 1/2	BNF0303	6
7	CONVERSION DOUBLE PULLEY BRACKET	0	UP3888	2	62	HEX HEAD CAP SCREW GR-5 B/O 3/8-16 X 1 3/4	BNF0274	16
8	CONVERSION SWIVEL PULLEY BRACKET	0	UP3890	2	63	HEX HEAD CAP SCREW GR-5 B/O 3/8-16 X 2	BNF0279	2
9	CONVERSION SWIVEL PULLEY BRACKET HANDLE	0	UP3889	2	64	HEX HEAD CAP SCREW GR-5 B/O 3/8-16 X 3	BNF0282	4
10	COVER PLATE	0	UP3885	2	65	HEX HEAD CAP SCREW GR-5 B/O 3/8-16 X 3 3/4	BNF0281	8
11	CONVERSION GUIDE ROD	0	UP3881	2	66	FLAT WASHER B/O 3/4 X 2"	BNF0878	4
12	DOUBLE PULLEY BRACKETS	0	UP3876	2	67	HEX HEAD CAP SCREW GR-5 B/O 3/8-16 X 4 1/4	BNF0317	10
13	FOOT SUPPORT	0	UP3886	2	68	U-STYLE TAPPED HOLE NUT 1/4-20	BNF0708	4
14	GUIDE ROD 3/4 X 76 3/4	0	UP3898	4	69	HEX HEAD CAP SCREW GR-5 B/O 3/8-16 X 5	BNF0320	4
16	CARRIAGE LT	0	UP3892	1	70	HEX HEAD CAP SCREW GR-5 B/O 3/8-16 X 5 1/4	BNF0690	2
17	LAT CABLE	0	UP3645	2	71	HEX KEY ALLOY 3/32"	BNF0372	1
18	LEFT SIDE BASE FRAME	0	UP3878	1	72	10 LB TOP PLATE W/ADJ. SLTR BAR 14 WTS	BNF1097	2
19	LOW ROW LONG CABLE	0	UP3646	2	73	SHOULDER BOLT ALLOY 3/8 X 3/4	BNF0718	6
20	LOW ROW SHORT CABLE	0	UP3647	2	74	HEX KEY ALLOY 7/32"	BNF0575	1
21	REAR UPRIGHT	0	UP3628	1	75	HEX KEY LONG ARM ALLOY 3/16"	BNF0371	1
22	RIGHT SIDE BASE FRAME	0	UP3879	1	76	LEATHER ANKLE STRAP	BNF1231	1
23	SELECTOR PIN W/COIL 3/8 X 3 1/4	0	UP3051	2	77	NYLON D HANDLE	BNF1215	4
24	NICKEL SELECTORIZED UPRIGHT	0	UP5271	2	78	NYLON INSERT LOCK NUT B/O 3/8-16	BNF0214	12
25	SINGLE 3 1/2 PULLEY BRACKET	0	UP3638	2	79	NYLON INSERT THIN PATTERN LOCK NUT B/O 1/2-13	BNF0366	6
26	TOP FRAME(CXT-100)	0	UP3884	1	80	NYLON INSERT THIN PATTERN LOCK NUT B/O 3/8-16	BNF0365	39
27	TOP SWIVEL PULLEY BRACKET	0	UP3634	2	81	NYLON PULLEY 3/8 X 1 X 4 1/2 BLACK	BNF0506	28
28	WEIGHT SHROUD	0	UP3882	1	82	PLASTIC END CAP BLACK-BUMPER R120	BNF0412	12
29	SWIVEL PULLEY BRACKET	0	UP3637	2	83	PLASTIC INSERT CAP 2" RD 10-14 GA	BNF0004	2
30	CONVERSION CABLE THREADED END	0	UP3891	2	84	PLASTIC INSERT CAP ELLIPTICAL 2 X 4	BNF1794	4
31	ALUMINUM LAT BAR 1 1/4 X 48		BNF1707	1	85	PLASTIC INSERT ELLIPTICAL GUIDE	BNF1760	2
32	ALUMINUM CAP 1.270" RD (CAP -125)		BNF0538	2	86	PULL PIN 1/2 X 2 7/8 LIGHT SPRING (YELLOW KNOB)	BNF0641	2
33	BALL BEARING 520-2R5		BNF1712	4	87	RETAINING SNAP RING EXT. PLAIN 1 1/4"	BNF1718	2
34	BLACK NYLON PULLEY 3/8 X 1 X 3 1/2		BNF0553	10	88	RUBBER DONUT 3/4 X 2 1/2	BNF0068	4
35	BRONZE BUSHING 1/2 X 5/8 X 1/2 X 7/8 X 1/8		BNF0528	16	89	RUBBER FOOT 3 X 4 1/2	BNF0607	1
36	COIL CHAIN 3/16 X 21		BNF1262	1	90	RUBBER FOOT FOR 6 X 4 1/4 PLATE	BNF1647	2
37	PLASTIC FOOT SUPPRORT 2 RD X 5		BNF1936	2	91	RUBBER GRIP 1.1875 ID X .125 X 18	BNF0955	2
38	DECAL-CAUTION WEIGHT TRAINING SAFETY...		BNF0126	1	92	RUBBER GRIP 1/2 X 3 1/2	BNF1221	2
39	DECAL-DANGER BACK LEG SUPPORT MUST BE...		BNF1889	1	93	RUBBER GROMMET 3/4" ID	BNF0401	4
40	10 LB STEEL WEIGHT PLATE BLACK 4 9/16 X 97/16 ASSY		BNF1650	28	94	SNAP LINK Z/P 8MM X 80MM	BNF0065	6
41	DECAL-DANGER TIGHTEN THIS RETAINING...		BNF0142	2	95	SOCKET SET SCREW ALLOY 10-32 X 1/8	BNF0473	6
42	DECAL-EXERCISE CHART (CXT-100)		BNF1899	1	96	SPLIT LOCK WASHER B/O 1/2"	BNF0653	6
43	EDGE PROTECTOR CHROME 18 GA		BNF1836	2	97	SPLIT LOCK WASHER B/O 3/8"	BNF0658	4
44	DECAL-IMPORTANT ADJUST CABLE HERE		BNF1893	4	98	STEEL BUMPER WASHER Z/P 3/8"	BNF0498	12
45	DECAL-IMPORTANT CHECK CABLES FOR PROPER...		BNF1891	1	99	TUFFSTUFF LOGO ALUMINUM SMALL	BNF1323	2
46	DECAL-IMPORTANT FOR BEST PERFORMANCE...		BNF1894	4	100	UBMW PLASTIC 1/2 ID X 1 OD X 1 1/4	BNF1935	2
47	DECAL-WARNING KEEP HANDS AND FINGERS...		BNF0620	2	101	URETHANE BUMPER 962	BNF0244	2
48	DECAL-WEIGHT CONVERSION RATIO		BNF1897	1	102	CLEVIS BRACKET 3/32"	BNF1904	6
49	DECAL-WEIGHT NUMBERS REF TP-10 (150 lbs)		BNF1730	2	103	SQUAT BAR 50 3/4" DOUBLE LINK	BNF1703	1
50	FENDER WASHER B/O 3/8 X 1 1/2		BNF0195	4	104	FLAT HEAD SOCKET CAP SCREW B/O 3/8-16 2	BNF1605	2
51	FINISHED HEX NUT B/O 1/2-13		BNF0201	8	105	HEX HEAD CAP SCREW GR-8 Z/Y 1/2-20 X 3 (1/8 HOLE)	BNF1938	2
52	ALUMINUM LOW ROW BAR 1 1/4 X 20		BNF1706	1	106	NYLON BALL 1 3/4 X 3/8	BNF1937	2
53	PLASTIC INSERT CAP 1 1/4" RD 11 GA		BNF0573	4	107	NYLON BALL 1 3/4 X 9/32	BNF1905	6
54	FLAT PHILLIPS SCREW ZINC # 2 X 1/2		BNF1480	4	108	NYLON INSERT LOCK NUT B/O 5/16-18	BNF0215	6
55	FLAT WASHER SAE B/O 1/2"		BNF0238	14	109	SOCKET SET SCREW ALLOY 3/8-16 X 3/4	BNF0476	8

Step 7 Low Row Long Cable Assembly

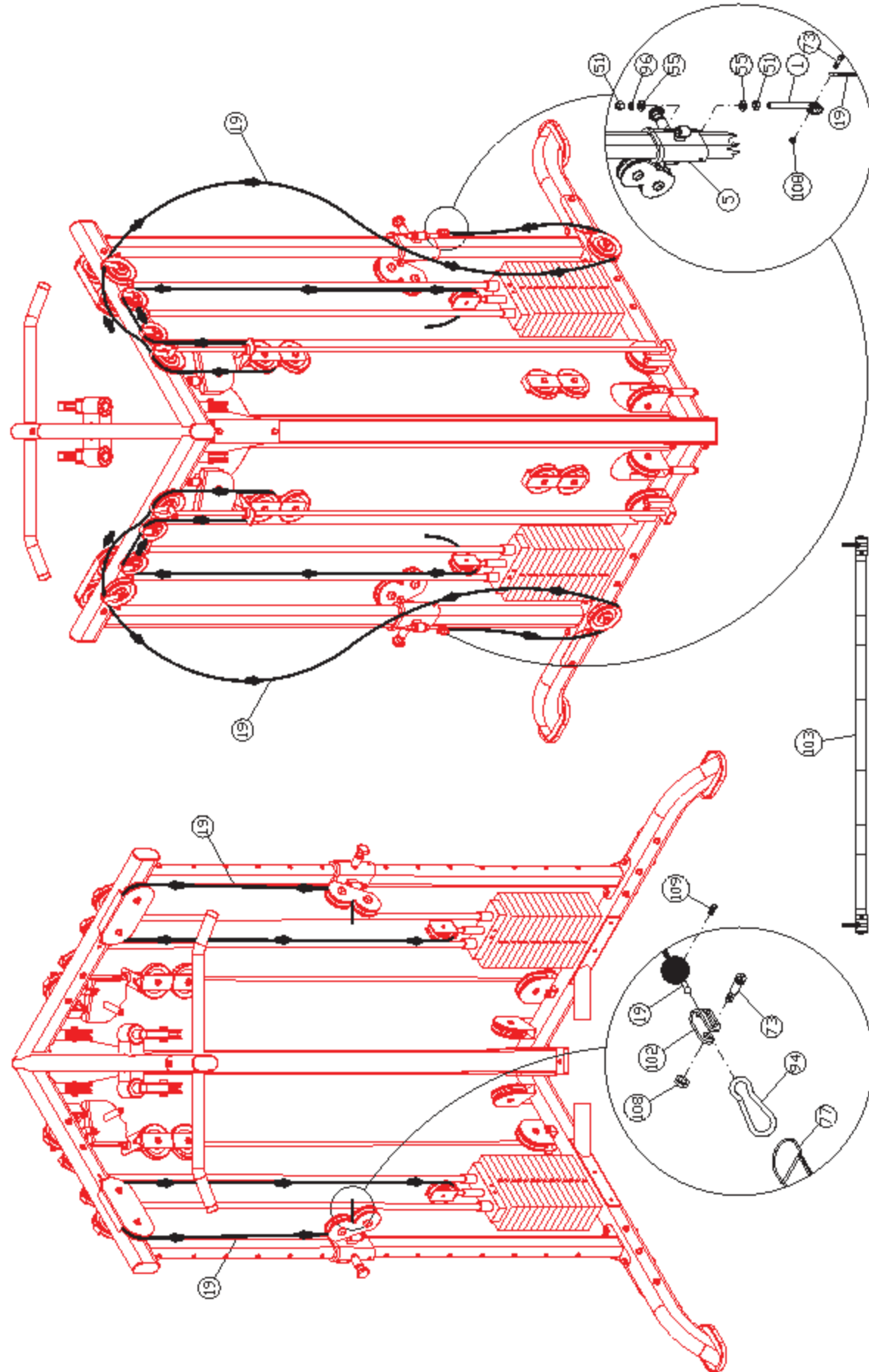

Step 8 Low Row Short Cable Assembly

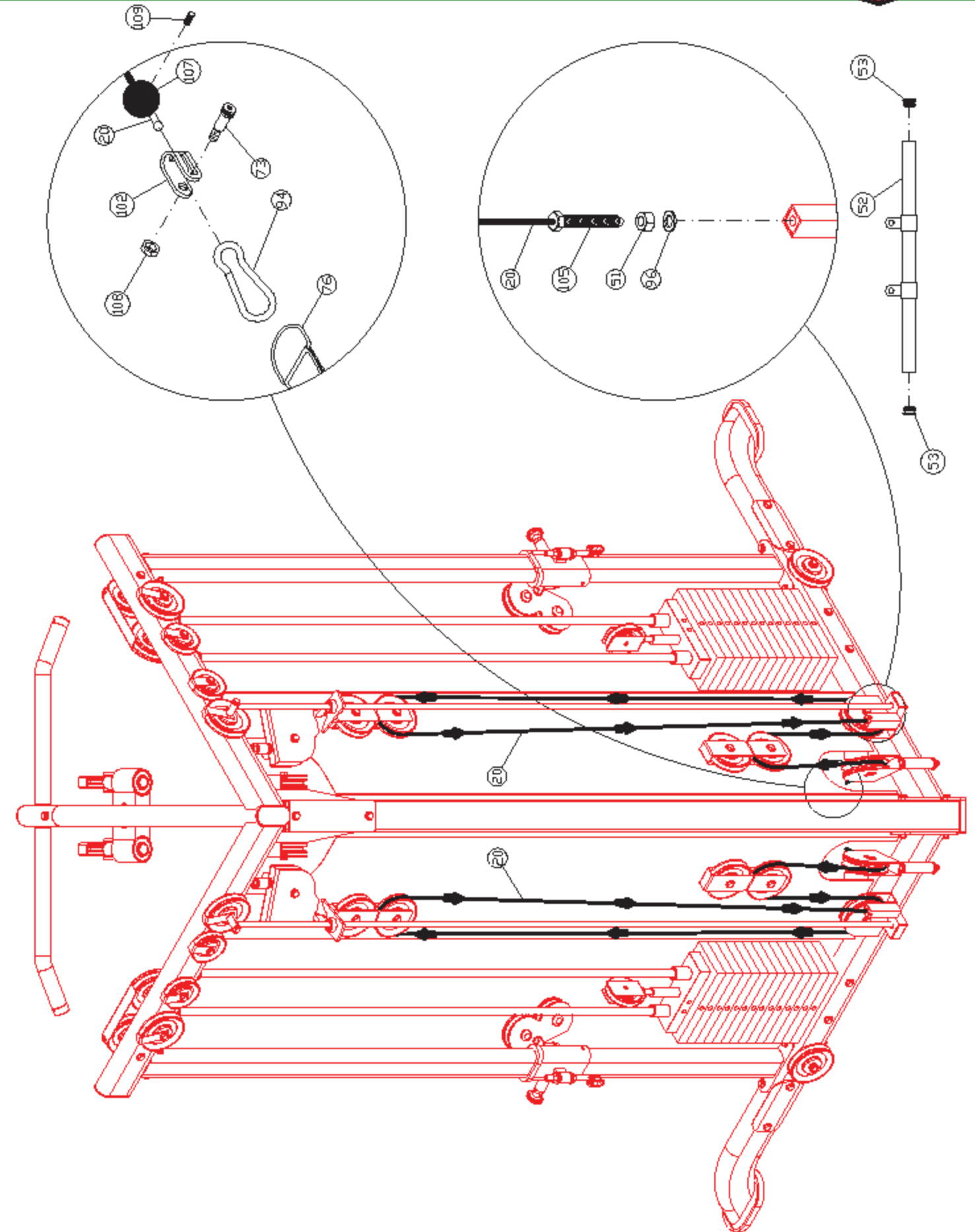

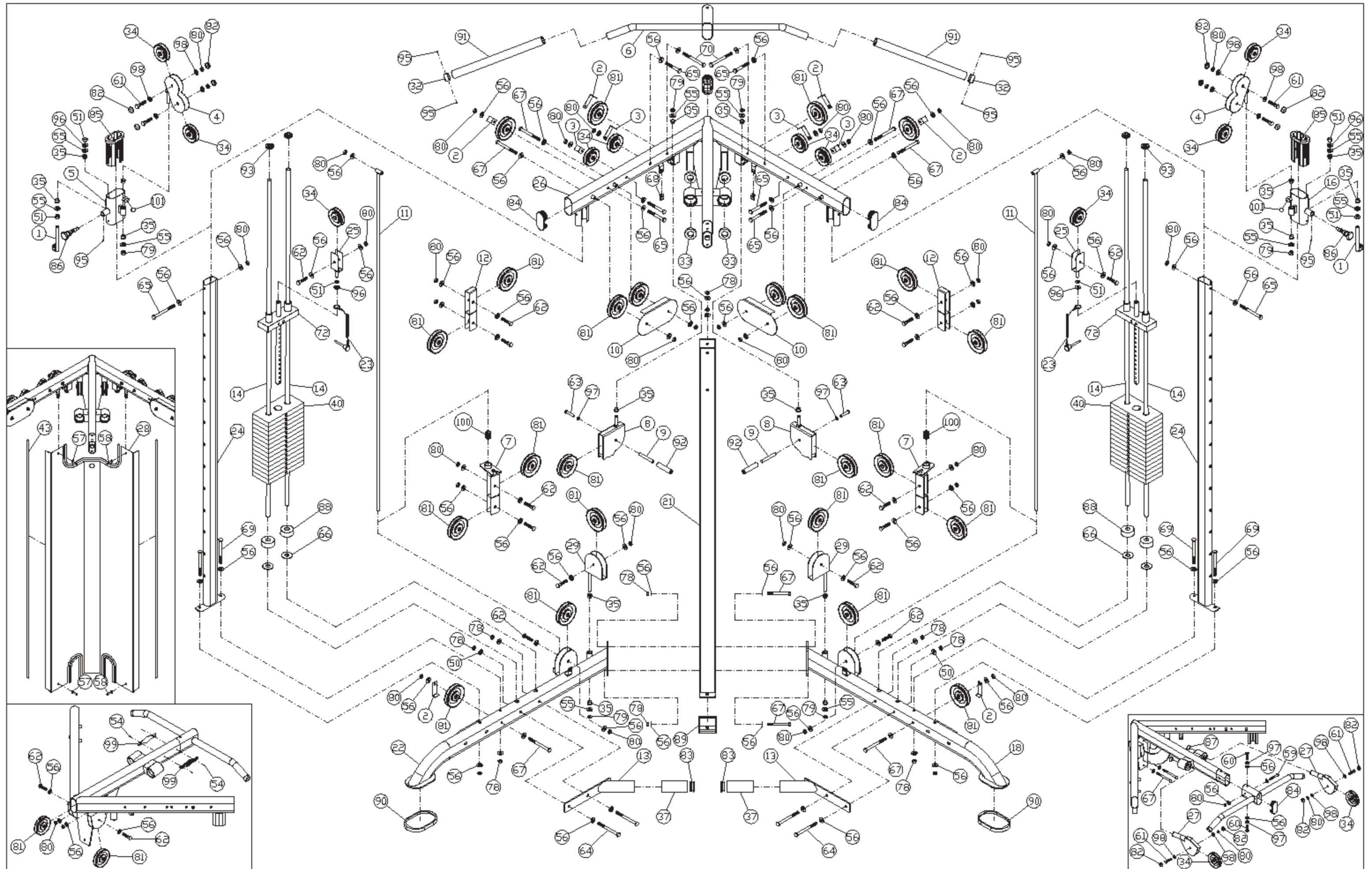

# DO NOT DISCARD THIS MANUAL



## HOME LIFETIME WARRANTY

TuffStuff products are warranted to the retail purchaser to be free from defects in materials and workmanship. TuffStuff exclusive Home Lifetime Warranty coverage extends for the life of the product while owned by the original retail purchaser, and used only in a home or residential setting unless otherwise noted in the owner's manual.

This warranty does not cover:

1. TuffStuff products sold for and used in a commercial or institutional setting.
2. Any damage, failure or loss caused by accident, misuse, neglect, abuse, improper assembly, improper maintenance, or failure to follow instructions or warnings in the owner's manual and warning labels posted on the machine.
3. Use of products in a manner for which they were not designed.
4. Original product that is altered, or the use of replacement parts and components of another manufacturer other than TuffStuff.

Limitations:

The foregoing shall constitute the sole remedy of the purchaser and the sole liability of TuffStuff with regard to warranty, whether express or implied by operation of law or otherwise, including but not limited to any implied warranties of merchantability or fitness. TuffStuff shall in no event be liable for incidental or consequential losses, damages or expenses in connection with exercise products. TuffStuff's liability hereunder is expressly limited to the repairs or replacements of warranted defective parts.

Procedures:

Warranty service will be performed at TuffStuff's facility in Pomona, California. TuffStuff will have the option of either repair or replacement at no charge for any defective product. Purchaser is responsible for installation of repaired or replaced parts and all transportation and insurance costs on returned or replaced equipment to and from TuffStuff's facility in Pomona.

This warranty gives you specific legal rights and you may also have other rights, which may vary from state to state. Effective July 1, 2004.

This warranty is the final, complete and exclusive agreement of the parties with respect to the quality or performance of the equipment and no action for breach of this written warranty or any implied warranty shall be commenced more than one (1) year after the accrual of the cause of action. No modification of this warranty or waiver of its terms shall be binding on either party unless approved in writing by an authorized representative of the party. Contact TuffStuff at 1325 E. Franklin Avenue, Pomona, California 91766, before returning any defective equipment.

Note: Retain your sales receipt and be sure to mail in the warranty registration card to insure that a permanent record of your purchase is on file with the factory and to avoid unnecessary delays in warranty service.

### **TuffStuff Fitness Equipment, Inc.**

1325 E. Franklin Avenue  
Pomona, CA 91766, USA

Ph: 909-629-1600 Fax: 909-629-4967

E-mail: [service@tuffstuff.net](mailto:service@tuffstuff.net) Net: [www.tuffstuff.net](http://www.tuffstuff.net)