

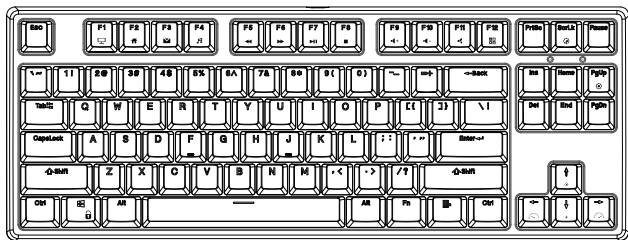

USER MANUAL

Mechanical Wireless Keyboard

Packing List



①

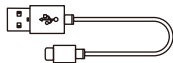

③



②



④

① Keyboard

② Key Puller

③ Type-C Cable

④ User Manual

Connection & Charging

1. Wired Mode

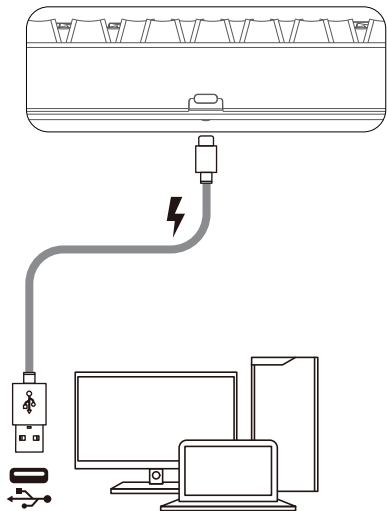

2. Wireless Mode

The power switch is only valid in wireless mode, and the device must be inserted into the USB receiving module. In USB cable mode, whether the switch is on or off, it is preferred to connect and charge.

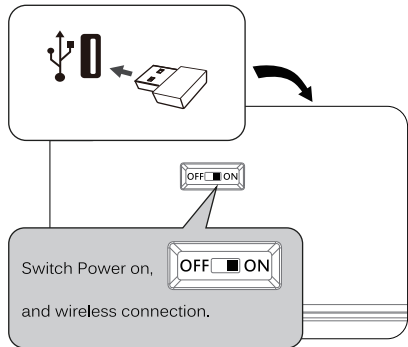

Backlight Control

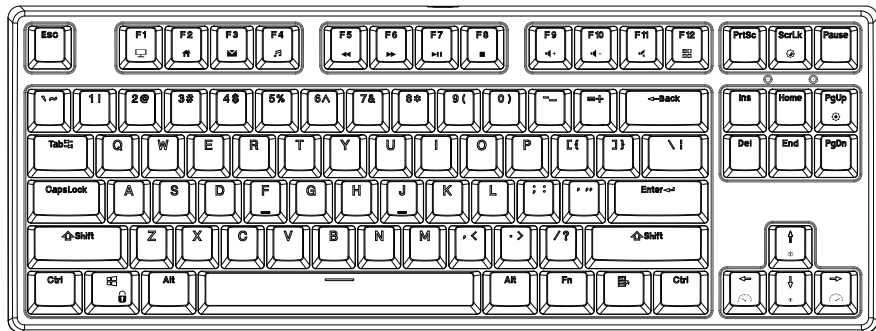



Fn + **ScrLk**  Switch Backlight Control

Fn + **PgUp**  Switch Backlight Color
(Only for RGB Version)

Fn +  * Backlight Brightness +

Fn +   Backlight Speed -

Fn +  * Backlight Brightness -

Fn +   Backlight Speed +

Custom Backlight Set

Step 1 : Press **Fn** + **1!** ~ **9(**
to select a set of backlight mode .

Step 2 : Press **Fn** + **PrtSc**
to enter the custom backlight settings
(when the indicator lights start to blink).

Step 4 : Press **Fn** + **PrtSc**
again to save and exit.

Step 3 : Press the keys that needs to set
the backlight, repeat this step, and
complete other key backlight settings.

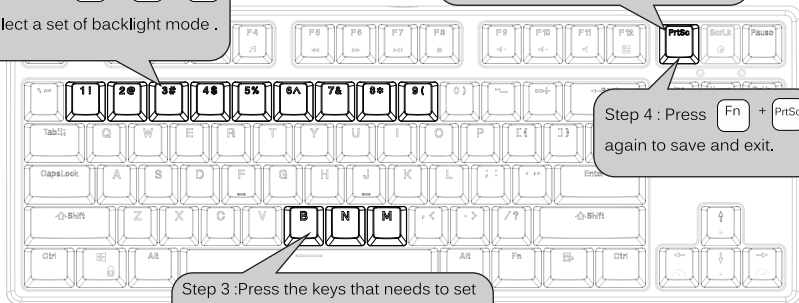

Multimedia Function Key

Fn +  **Computer**

Fn +  **Web**

Fn +  **E-mail**

Fn +  **Player**

Fn +  **Last Track**

Fn +  **Next Track**

Fn +  **Start / Pause**

Fn +  **Stop**

Fn +  **Volume +**

Fn +  **Volume -**

Fn +  **Mute**

Fn +  **Calculator**

Fn +  **Windows Lock**

Fn + Left  +  **Restore to factory settings**

Download Driver Address: www.rkgaming.com/download/1/

Macro Key Recording Function

Fn + **Ctrl** + **Q** / **W** / **E** Support 3 sets of macro recording function

Fn + **Q** / **W** / **E** Touch off 3 sets macro key

Eg: Set **Fn** + **W** to the **↑** **↓** **←** **→** continuous triggering function.

Step 1: press **Fn** + **Ctrl** + **W** enter pairing mode.

W key and indicator are flashing at the same time, indicating entering macro recording mode.

Step 2: press **↑** **↓** **←** **→** in turn to activate the recording keys.

Step 3: press **Fn** + **Ctrl** + **W** again,

W key and indicator light no longer flicker, indicating the completion of recording mode.

Step 4: When you need to use it, press **Fn** + **W** to automatically trigger the **↑** **↓** **←** **→** pre-recorded function.

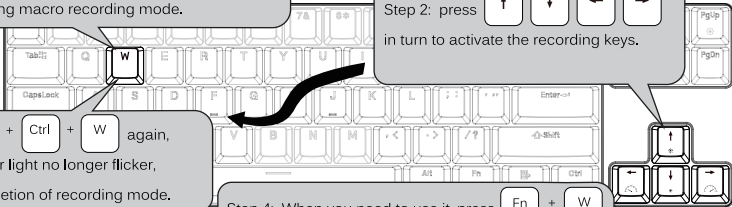

Have an issue with one of our RK products?

Feel free to contact us with any product issues or questions.
we will reply as quickly as possible to ensure all your needs are handled.
Please contact the seller.



 **WARNING:** This product can expose you to chemicals including {name of one or more chemicals}, which is (are) known to the State of California to cause cancer and birth defects or other reproductive harm. For more information go to www.P65warnings.ca.gov.

Executive standard:GB/T 14081-2010
Made in China www.rkgaming.com