



Teison Energy Technology Co.,Ltd

📍 NO.276 Museum Road, Yangzhou, Jiangsu, China
🌐 www.teison.com www.teisonev.com www.evs-cn.com

Instruction Manual

Product View

1.1 Appearance	5
1.2 Product Specification	6
1.3 Product List	7
1.4 Transportation and Storage	7

Installation Instruction

2.1 Safety tip	7
2.2 Installation guide	8

Charging Instruction

3.1 Charge preparation	11
3.2 Start to Charge (APP)	12
3.3 Help and issues feedback	14
3.4 LCD Indicator light	15

Customer Service and Maintenance

4.1 Maintenance caution	16
4.2 Breakdown and Maintenance	16
4.3 Warranty Card	17

Application

EV charging station is connected to the AC grid and is a power supply device that provides AC power to the on-board charger of electric vehicles. EV charging station can charge different types of electric vehicles according to different voltage levels. The input end of EV charging station is directly connected to the AC grid, and the output end is equipped with a charging plug or socket to charge the electric vehicle.

Main Function

APP smart control : Scheduled charging 、 Start charging、
Stop charging、 Current adjustment (memorable)、 plug and play model、
Charging status shown on mobile APP.

Under WiFi /4G network there are additional functions :
Charging records save on cloud and check on APP , view and update the
PIN code、 firmware update、 multiple wallbox control .

WARNING

It may cause danger and harm, or damage the device if you don't operate in accordance with safety guide.

Safety Instructions

- Persons who install and use chargers must observe the principles and regulations to ensure safety. Before using charger, the electrical infrastructure should be checked by qualified electrician for suitability. Electrical infrastructure must comply with the charger specifications.
- Before turning on the unit, make sure that the unit is properly grounded to avoid unnecessary accidents.
- Before charging always carry out a visual inspection for damage. The contact area of the charging plug should be free from dirt and moisture, the charging cable should not have cuts or abrasions of the insulation and the cable outlet of the charger must be checked to ensure that it is firmly seated.
- Unauthorized modifications, changes or repair of the charger is strictly prohibited and it leads the immediate exclusion of the warranty.
- The charger must not be used in the vicinity of volatile gases or flammable objects.
- Strictly forbidden for children to touch or use the device. Do not let children get close when using it.
- Disconnect the charger only by the plug and not by the cable.
- Do not disconnect the charger during the charging.
- Only remove the charging label by the plug and not by the cable of the power outlet.
- Only change the accessory adapters when the power supply is disconnected.
- Stop using the device immediately when charging failure or abnormality occurs.

Strictly forbidden to use the equipment in thunder and lightning weather. Protect from moisture, rain, sunlight and corrosive environment. Strictly forbidden to submerge AC charging device in water.
This product is only used for charging electric vehicles, not for other purposes.

Product View

1.1 Appearance

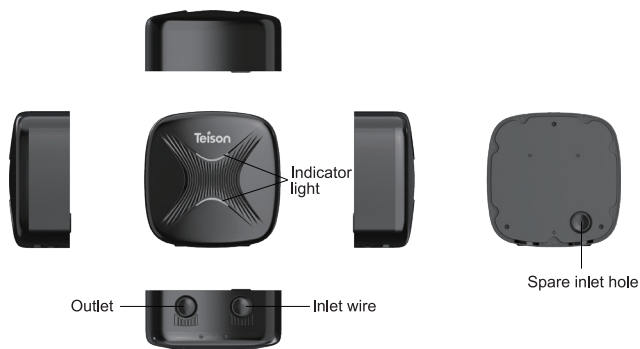

1.2 Product Specification

Model	TS-EVC07-003	TS-EVC11-003	TS-EVC22-003
Voltage	230V AC $\pm 10\%$	380V AC $\pm 10\%$	380V AC $\pm 10\%$
Output Current	32A	16A	32A
Frequency	50/60Hz	50/60Hz	50/60Hz
Output Power	7kw	11kw	22kw
Residual current protection	TYPE A (AC 30MA)		
Charging Outlet	4M charging cable with type1/2 plug		
Housing Material	PCV0 for outdoor		
Installation Method	Wall-mount/Floor-stand		
Safety Standard	EN 61851-1		
Warranty	2 years		
Protection Level	IP65		
Temperature/Humidity	-30~50°C/5%~95% without condensation		
Working Altitude	<2000M		
Application Site	Indoor/Outdoor		
Working temperature	-30 °C ~60 °C		
Storage temperature	-40 °C ~70 °C		
Working humidity	5%~95%, No condensation		
Altitude	$\leq 2000\text{m}$		
Salt spray test	Meet IEC 61851-1: 2017		
Atmospheric pressure	80kPa~101kPa		
Temperature and humidity cycle	Meet IEC 61851-1: 2017		
Network Gateway	Bluetooth and WIFI as default		
Mobile APP (Ios and Android supported) functions under Bluetooth	Scheduled charging · Start charging · Stop charging · Current adjustment (memorable) · plug and play charging switch on APP · Charging status shown on APP		
Product Size	228.5*228.5*100mm	228.5*228.5*100mm	228.5*228.5*100mm
Product Weight	4.4KG	5.2KG	5.4KG
Residual current protection	TYPE B (AC 30MA + DC 6 MA) as optional		
Network Gateway	4G as optional		
Added APP functions under WIFI / 4G	Charging records shown on mobile APP · view and update the PIN code · firmware updating function(OTA) · multiple wallbox control		
load balance	as optional		

1.3 Product list

Charging device assembled	1
Wall-mount Bracket	1 (Optional)
Installation accessories	1 envelope
Instruction Manual	1

1.4 Transportation and Storage

Strictly forbidden to use the equipment in thunder and lightning weather.

Protect from moisture, rain, sunlight and corrosive environment. Strictly forbidden to submerge AC charging device in water.

This product is only used for charging electric vehicles, not for other purposes.

Installation Instruction

2.1 Safety Tip

- The charger contains no user serviceable parts. Please do not try to repair device by yourself, all repairs must under the instruction of professional sales person.
- The installation, maintenance, and servicing of charger must only be performed by qualified personnel in accordance with applicable local regulations.
- Protect charger from any external impact.
- Take appropriate precautions with electronic medical implants.
- Disconnect the main service power to your charger before cleaning the unit. Do not use cleaning solvents to clean any part of your charger. Use a clean, dry cloth to remove accumulated dust and dirt.
- Under no circumstance should you over-tighten the connecting cable while it is connected to the vehicle.
- Ensure that the charging cable is positioned in such a way so that it will not be stepped on, tripped over, or subjected to damage or stress. Do not close your garage door on the charging cord.

2.2 Installation Guide

For operation conveniently, the lowest point and the highest point of EV charger should keep 0.4m-1.5m distance from ground.

Wall-mounted dimension

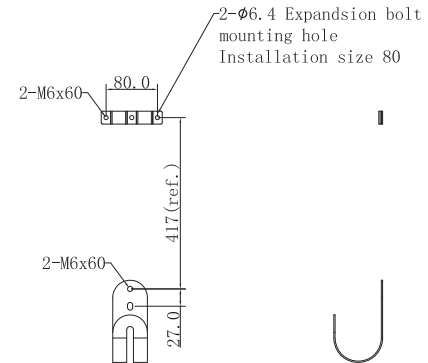
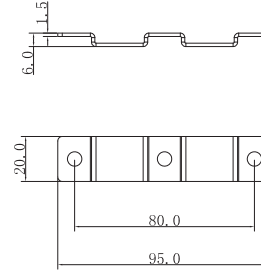

Pedestal installation dimension

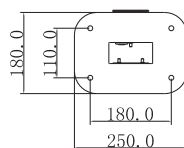
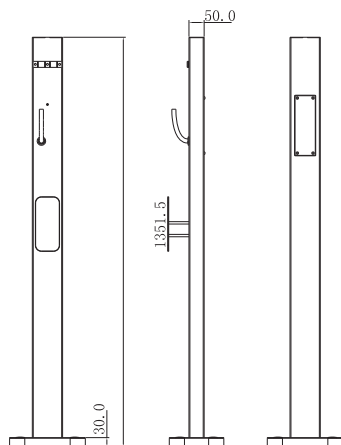

Warning:

The wall that assemble hanging back plate thickness is more than 200mm

Wiring Diagram

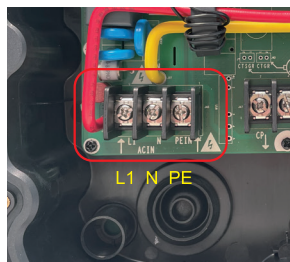

Single-Phase

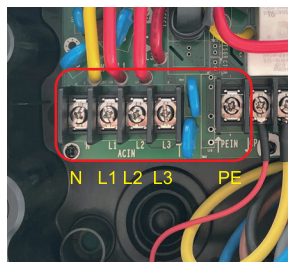

Three-Phase

Wall Installation:

Installation method 1

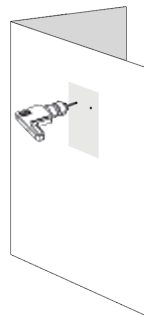

1. Use a drill to make mounting holes in suitable locations on the wall.

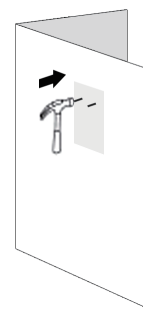

2. Tap the expansion bolts into the mounting holes.

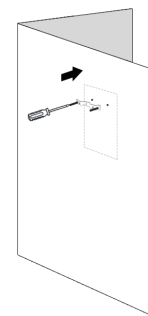

3. Mounting the wallbox back plate on the wall.

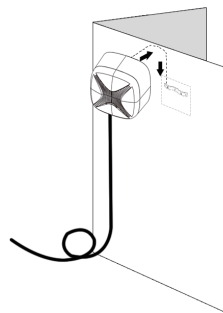

4. Place the wallbox in from the top down and fix it to the back plate

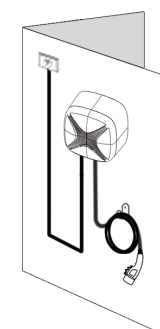

5. Organise and secure the incoming cables of the wallbox.

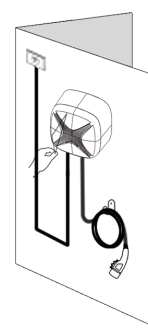

6. Remove the protective film from the front panel to start using the product.

Installation method 2

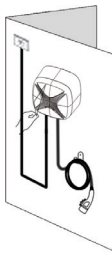
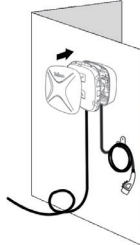
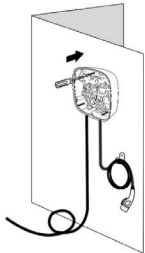
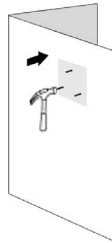
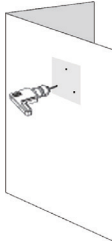
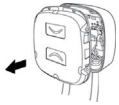
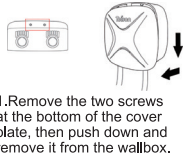

Charging Instruction

3.1 Charge preparation

Download "MyTeison " from APP store and register your account .Support for ios, Android and Harmony system according to your device version. After power on and plug cable , according to the APP operation,choose charging method to start.

3.2 Start to charge (APP)

3.2.1 App need to be given the authority to use the GPS and Bluetooth , at the first to use.

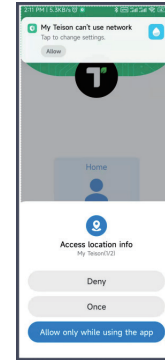

3.2.2 Home(HOME):Support Smart Mini OCPP charger for home user, with Bluetooth and Remote Control Commercial:For commercial use in public area, realize charging and operation of the charging stations.

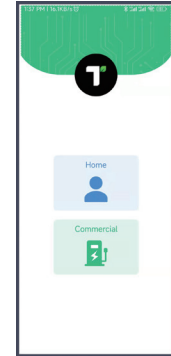

3.2.3 Register your information and login

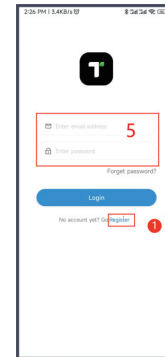

3.2.4 Moile App operation-Connection

1.Local Devices list, press "Use immediately" enter into the user page.
2.Online Devices list, showing all the online chargers bonded by user. Parameters: Device name, Serial No. , Status, type etc. To press "Use immediately" enter into online charger User interface.
3. Press "+Add device" to web configuration.
4. Devices selected area, to find out the correct charging station.

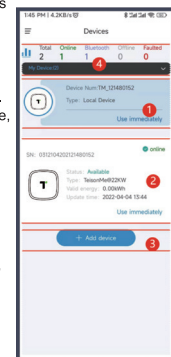

3.25 Mobile App operation- Connection:

1. Select : "Use immediately" to use local device.

2. Click the "... "button upper right side.

3. Click "Config Network"

4. By Wi-fi or 4G connection

4.1 ocpp1.6 If choose Wifi(Only supports 2.4G wifi), input your wifi password, select "WebSocket", Edit it with Teison platform: cloud.teison.com:9090/ws/ocpp 1.6

4.2 If choose 4G, input 4G network APN configuration, select WebSocket and edit it.

5. Network Configuration will finish in 30seconds.(If you use the ocpp platform by the third-party, it will show success by step 2, have to confirm it by your platform)

6. Config. success. To name your online charger.

7. Back to homepage, the device after success configuring network will show in the list.(if not in the list, pull down to refresh the page).

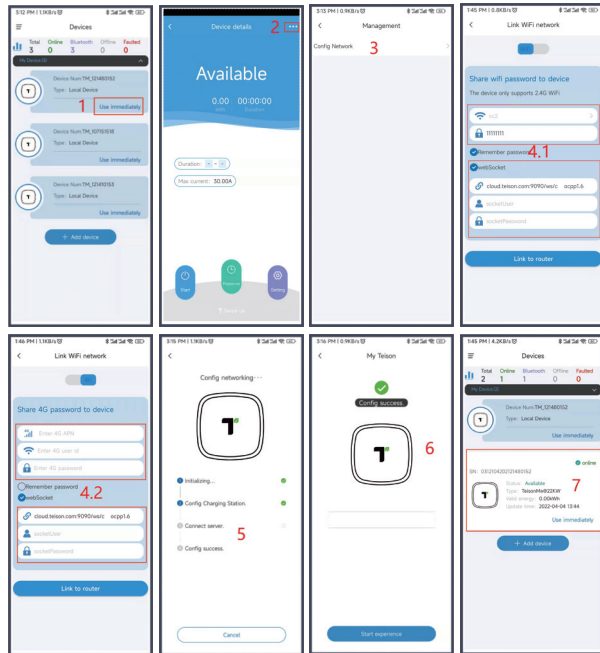

3.26 Mobile App operation- Pin Code

1. You can check your PIN code by local device management (press "... "on your home page).

2. Copy PIN code or Refresh PIN code

3. Pin Code can be shared to others for the usage of charger

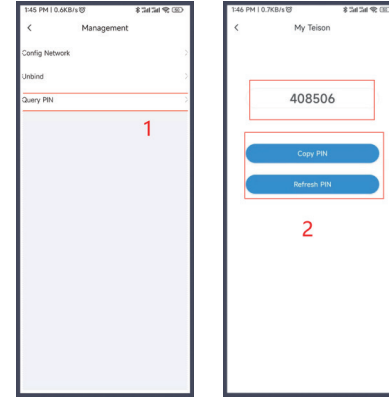

3.3 Help and issues feedback

3.31 Correctly power on and plug on, but the APP show blank :

A. make sure there is no fault reminder from our LCD indicator.

B. make sure your phone's Bluetooth is turned on.

3.32 Network Issue:

A . make sure you have insert 4G card if you choose 4G network.

B. make sure your phone is under 2.4G wifi, then share the wifi to ev charger.

3.33 Note:

1. Successful network distribution means that the device is bounded, and only the person who bounded can control the pile;
2. If you need to share with others, you can share the PIN code you set with others in Bluetooth mode.
3. You can unbind in Bluetooth mode so that other people can bind.

3.4 LCD Indicator light



LED Status	PE	Above (R/G/B)	Below (R/G/B)
Standby	yes	Blue on	Blue on
	no	Blue flash slowly	Blue flash slowly
Connecting/ charging finished/ Fully charged		Green on	Green on
Reserving		Green on	Green flash slowly
Charging	yes	Green flash slowly	Green flash slowly
	no	Green flash quickly	Green flash quickly
Fault		Red on	Red flash slowly (N+5s stop)

Customer Service and Maintenance

4.1 Maintainance caution

Check whether the line is aging with the monthly power cut. Observe incoming lines to make sure no wire is damaged.

4.2 Breakdown and Maintenance

Red light flash times	Condition	LED Status
1	Electric leakage	Below indicator light flash slowly
2	Over-voltage	
3	Under-voltage	
4	Over-current	
5	Over-temperature	
6	Electric leakage self-testing abnormal	
7	/	
8	CP pilot abnormal	
9	Relay abnormal	
10	/	
11	System 12v abnormal	
12	System -12V abnormal	

4.3 Warranty card

Information register

Product name	
Model	
Warranty date	
User name	
Contact phone	
Mail address	
Dealers shop	
Email address	