

NFB

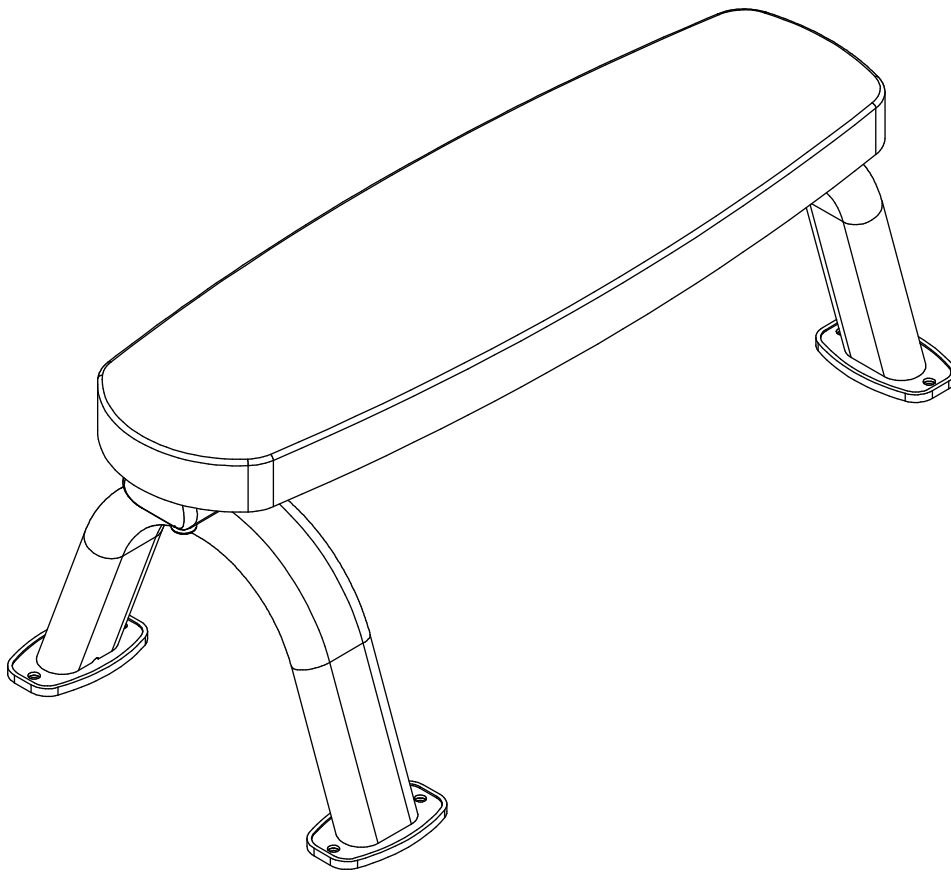

Assembly & Instructions

OWNER'S & MANUAL

A1. M10X25L Hex Head Bolt Qty.2

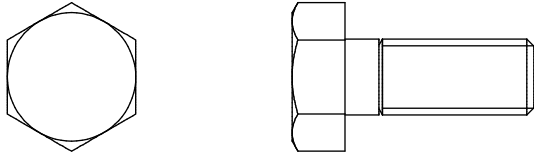

A2. M8X25L Hex Head Bolt Qty.4

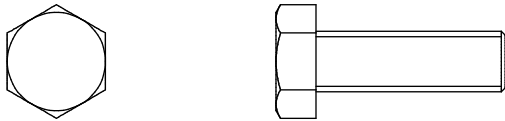

C1. M8-Ø24 Washer Qty.4

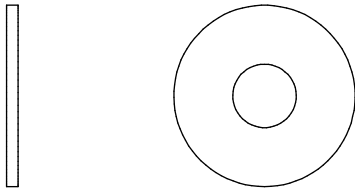

C2. M10 Bolt Cap Washer Qty.2

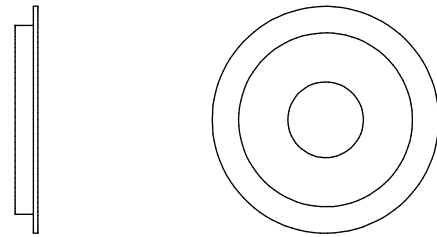

C3. M8 Spring Washer Qty.4

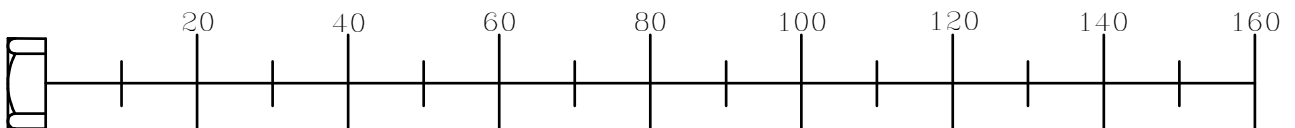

NFB HARDWARE

	Qty.
D1. Bolt Cap _____	2
D2. 50X100 Round End Cap (9211-114) _____	1
D3. Rubber Pad (9310-076) _____	3

D1



D2

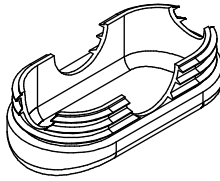

D3

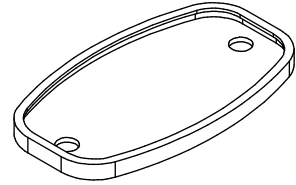

A [1PCS]

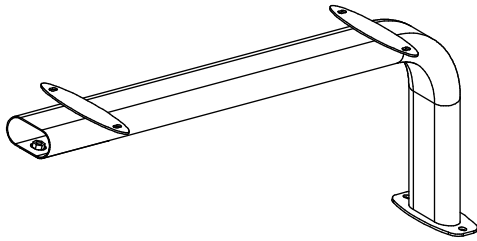

B [1PCS]

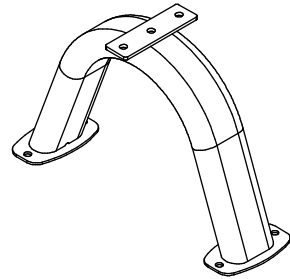

C [1PCS]

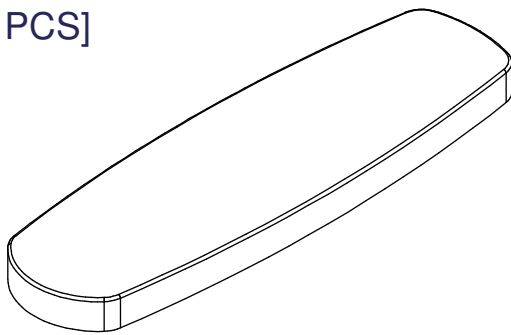

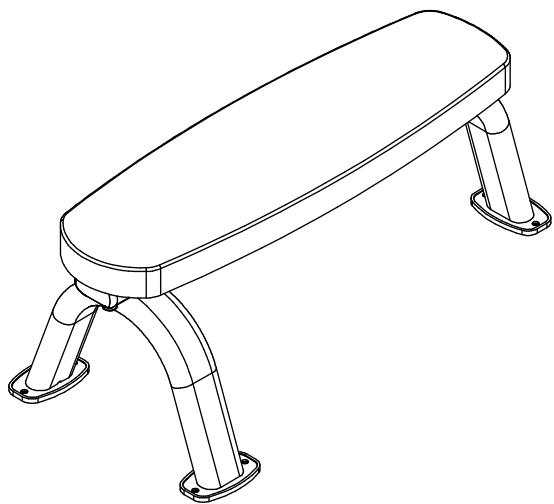

Above shows STEP 1 assembled and completed

