

# LAUNDRY TUB

## INSTALLATION INSTRUCTION

Model: STCL  
STCLN  
STCLF  
STCLNF  
STCLL (With adjustable feet)

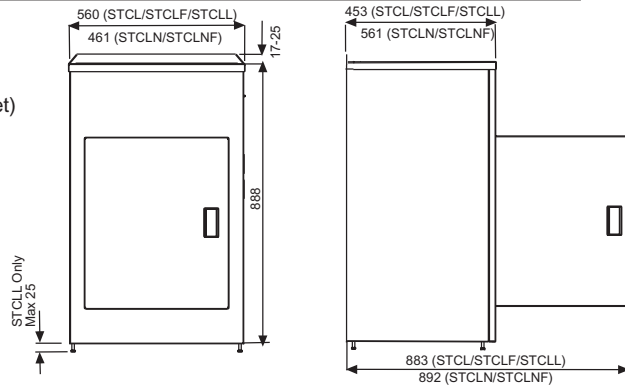

### NOTES

House Plumbing supplied by the customer.  
Washing Machine Drain System supplied with the Laundry Tub.

## 1 Pre-Installation Instruction

Please read the entire instruction before installing the laundry tub.

- Regulation Compliance - Comply with current drainage and plumbing regulations as required by your local authority. Sanitary plumbing shall only be carried out by a registered plumber.
- Washing Machine Waste - It is advisable to assemble the washing machine waste hose before installing the laundry tub to the wall for ease of installation.
- Determine Site - Determine the most suitable position for the laundry tub. It may be used either to the left or the right of the washing machine. Allow 10mm clearance between the units. Mark the position on the floor as reference.

## 2 Connect Washing Machine

The washing machine waste hose can be connected to either side of the laundry tub. Waste connection holes are located on the top of the laundry tub. Use the fittings supplied to connect the washing machine waste hose.

- It may be necessary to re-orient the waste outlet on the laundry tub. Loosen the screw on the waste outlet, adjust to suit and then TIGHTEN to avoid flooding.
- Insert the waste stay into the mounting hole. (Diagram A)
- Push the flexible waste hose firmly into the waste stay.
- Insert the waste lock into the waste stay.
- Use the cable tie to secure the waste hose. Refer to diagram B for the position of the tie
- Insert the grommet to cover the other hole.
- IMPORTANT:** Ensure the flexible waste is correctly fitted to the plastic waste outlet.

The fitting kit supplied:



Waste Stay



Waste Lock



Grommet



Cable Tie

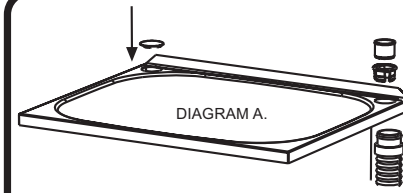

Height Adjustment - STCLL only.

Fit the four leveling feet supplied to the bottom of the cabinet and adjust to align with washing machine height. Tilt laundry tub slightly to assist with access. Check top of laundry tub with spirit level. Ensure the cabinet does not rock.

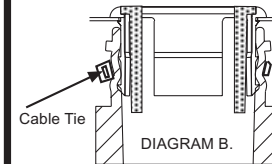

## 3 Securing Laundry Tub

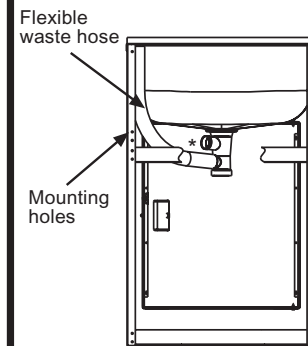

Rear view

\* Note: Top outlet is blocked

A. Position laundry tub and cut the house waste pipe which should already be installed to the exact height. The final height will depend on the waste trap dimensions. Connect the waste trap to the laundry tub. In New Zealand a waste adaptor (pictured and supplied) must be glued in place

B. Fasten the cabinet to the wall through the holes in the back flange of the cabinet sides. Alternative fastening can be achieved through the bottom flanges.

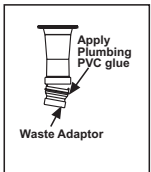

## 4 Change Door

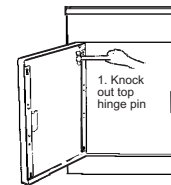

1. Knock out top hinge pin

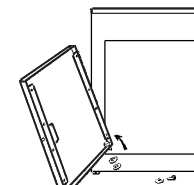

2. Lever lower hinge pin out with door (keep 3 washers)

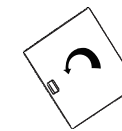

3. Turn door around

4. Tap in hinge pins with washers in position one at top, two at bottom

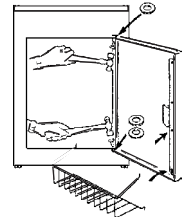

## 5 Safety Latch

The safety latch comes as a standard fitting in the interests of child protection against dangerous chemicals and cleaning fluids. However, should you not require the latch it can easily be snipped off with side cutters or a similar tool.

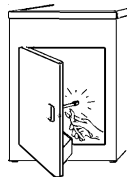

MANUFACTURED IN NEW ZEALAND BY:  
**ROBINHOOD LTD**  
P.O. BOX 51 201, PAKURANGA, AUCKLAND, N.Z.  
TEL: +64 9 272 5129 • FAX: +64 9 272 5148  
ISO9001 Certified