

# LAUNDRY TUB

## INSTALLATION INSTRUCTION

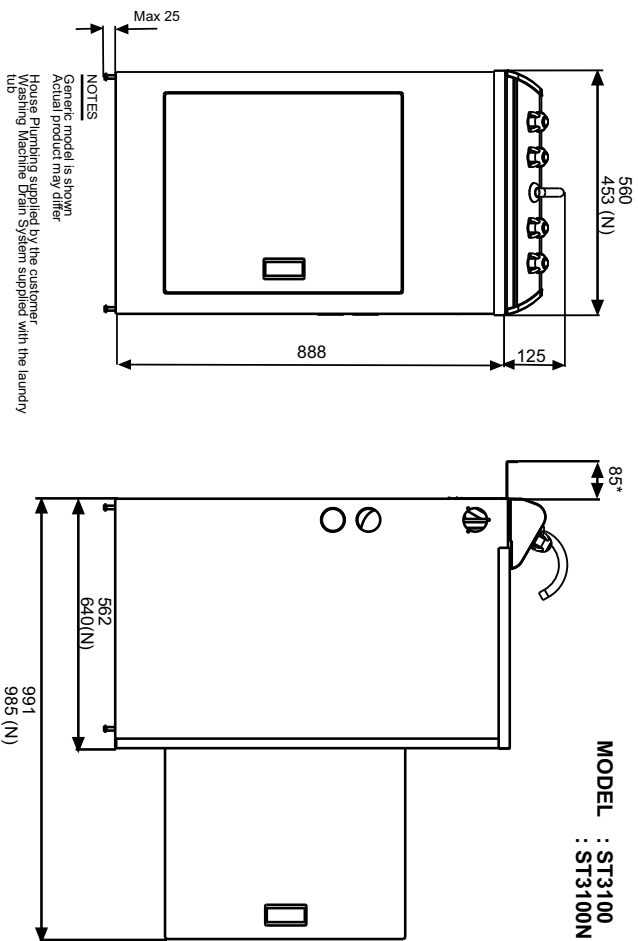

NOTES  
Generic model is shown.  
Actual product may differ.  
House Plumbing supplied by the customer.  
Washing Machine Drain System supplied with the laundry tub.  
\* For laundry tub ST3100 only.  
(N) For the Narrow model ST3100N rear shelf not supplied.  
All dimensions are in millimeters.

## 1 PRE-INSTALLATION INSTRUCTIONS

### PLEASE READ THE ENTIRE INSTRUCTION BEFORE INSTALLING THE LAUNDRY TUB

#### IMPORTANT

Please ensure Households Pipes are thoroughly flushed to remove debris before connecting your laundry tub to pipeworks.

#### REGULATION COMPLIANCE

Comply with current Drainage and Plumbing Regulations as required by your local authority. Sanitary plumbing shall only be carried out by a Registered Plumber.

#### CDETERMINE SITE

Determine the most suitable position for the laundry tub. It may be used either to the left or right of the Washing Machine. Allow 10mm clearance between the units. Mark the position on the floor as reference.

## 2 SECURING LAUNDRY TUB

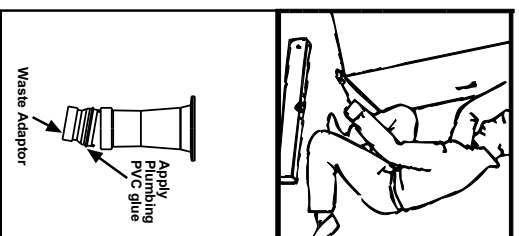

A: Fit the four leveling feet supplied to the bottom of the cabinet and adjust to align with Washing Machine height, use the nut to lock the feet in position. Tilt laundry tub slightly to assist with access. Check top of laundry tub with spirit level. Ensure the cabinet does not rock.

B: Position laundry tub then cut the house Waste Pipe which should already be installed to the exact height. The final height will depend on the Waste Trap dimensions. Connect Waste Trap to your laundry tub. For use in New Zealand a Waste Adaptor (pictured & supplied) must be glued in place.

C: To connect hot and cold water pipes to the mains, use suitable connectors. Standard fittings are available at most Plumbing Supplies. For Australian mains connections, the Hex Adaptor must be removed. NOTE: For installations in Australia an approved stopcock must be fitted to both hot and cold water inlet pipes.

D: For the ST3100 model only

Unscrew Rear Shelf which for transportation purposes is mounted at the rear of cabinet (refer diagram below). The Rear Shelf enables the laundry tub to align with the front of the Washing Machine. Ensure Rear Shelf is fastened to the cabinet with four screws (supplied). Fasten Rear Shelf to wall. Alternative/additional fastening can be achieved through the floor.

For the ST3100N model or if the shelf is not used. Fasten the cabinet to the wall through the holes in the back flange of the cabinet sides. Alternative fastening can be achieved through the bottom flanges.

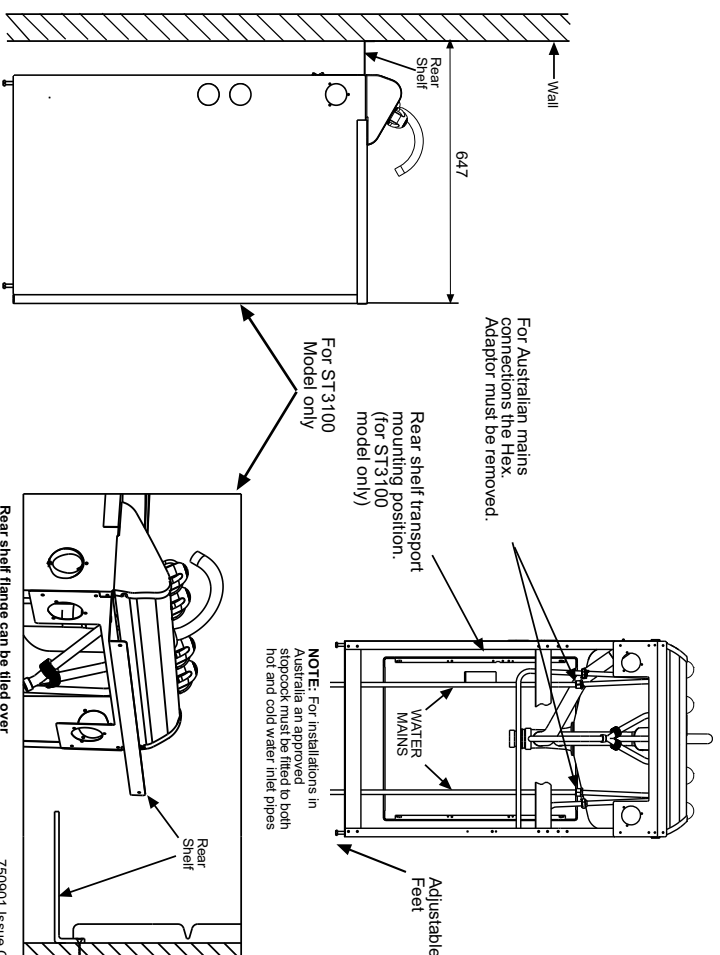

For ST3100 Model only

### 3 Connect Washing Machine

The Washing Machine Waste Hose can be connected to either the side or rear of the laundry tub.

#### A1: Rear Mounted (ST3100 model only).

Place the Washing Machine Connector from the inside of the laundry tub to either the L/H or R/H holes beneath the Rear Shelf. Fasten from the outside with the 3 screws supplied. Insert the Grommets in all 6 holes in the side panels.

#### A2: Side Mounted (both models)

Place the Washing Machine Connector from the inside of the laundry tub to either the L/H or R/H holes. Fit Grommets supplied from Installation Kit into side panel holes. Insert Grommets in the 3 holes that are not to be used for plumbing. On the opposite side fit Grommets to the bottom 2 holes only, and tap the centre section inward to produce a hole for the Washing Machine Hoses.

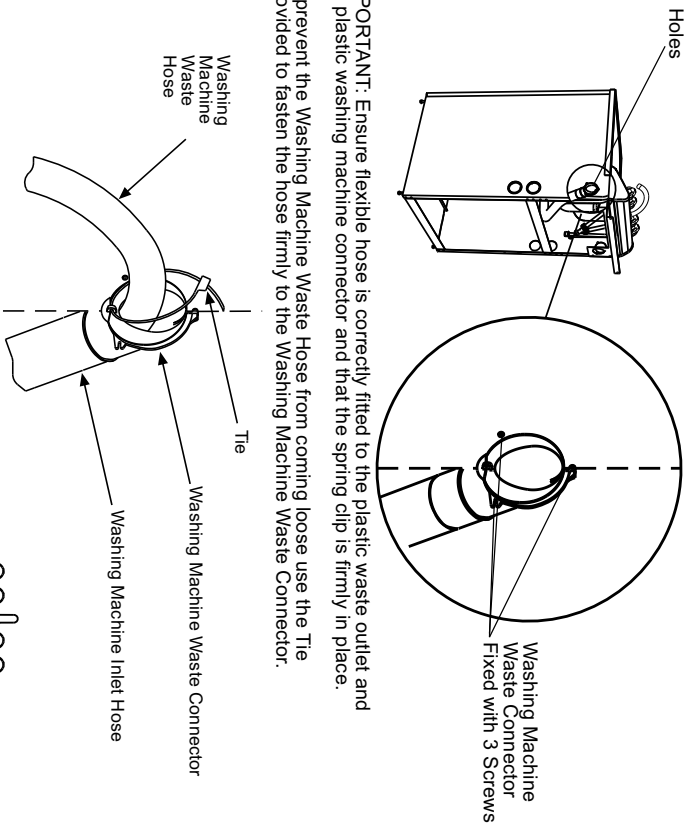

**IMPORTANT:** Ensure flexible hose is correctly fitted to the plastic waste outlet and the plastic washing machine connector and that the spring clip is firmly in place.

B: To prevent the Washing Machine Waste Hose from coming loose use the Tie provided to fasten the hose firmly to the Washing Machine Waste Connector.

D: Pass the Washing Machine Inlet Hoses through the Lower 2 Holes, or through gap when rear mounted fastening them firmly to Pipe Work Connectors.

E: On completion of installation check the complete system for water leaks.

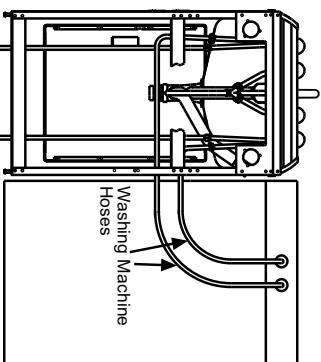

### 4 Change Door

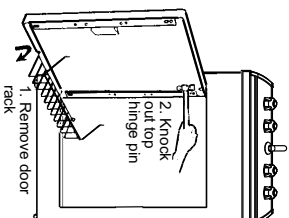

1. Remove door rack

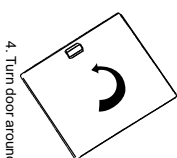
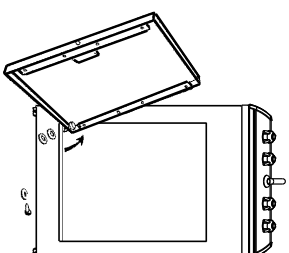

4. Turn door around

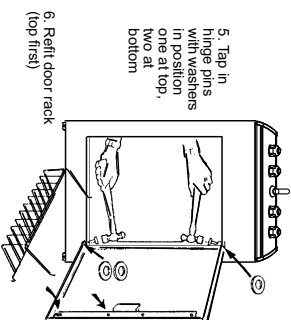

5. Tap in hinge pins with washers in position one at top, two at bottom

6. Refit door rack (top first)

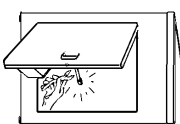

### 5 Safety Latch

The Safety Latch comes as a standard fitting in the interests of child protection against dangerous chemicals and cleaning fluids. However, should you not require the latch it can easily be snipped off with sidecutters or similar hand tool.

MANUFACTURED IN NEW ZEALAND BY:  
**ROBINHOOD LTD**  
 P.O. BOX 51 201, PAKURANGA, AUCKLAND, N.Z.  
 TEL.: +64 9 272 5129 • FAX: +64 9 272 5148  
 ISO9001 Certified