

**RG - SERIES**



**GRANGE RANGE HOOD**

**MODEL**

**RG6WH, RG6BL, RG6SS, RG6BR**

**RG9WH, RG9BL, RG9SS, RG9BR**

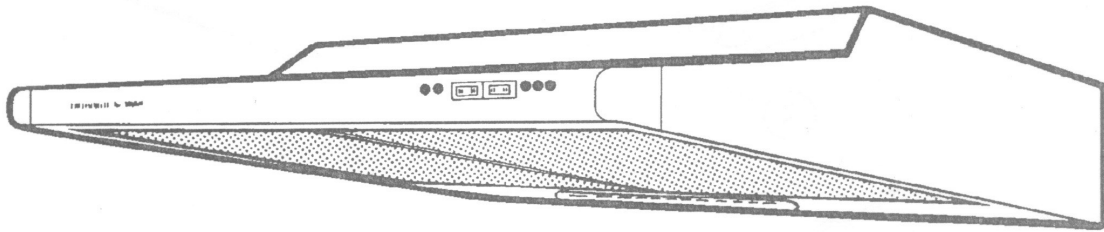

**SERVICE MANUAL**

# RG - SERIES

 **Robinhood** GRANGE

RG6WH, , RG6BL, RG6BR, RG6BZ, GRANGE 600 2 SPEED.

RG9WH, , RG9BL, RG9BR, RG9BZ, GRANGE 900 2 SPEED.

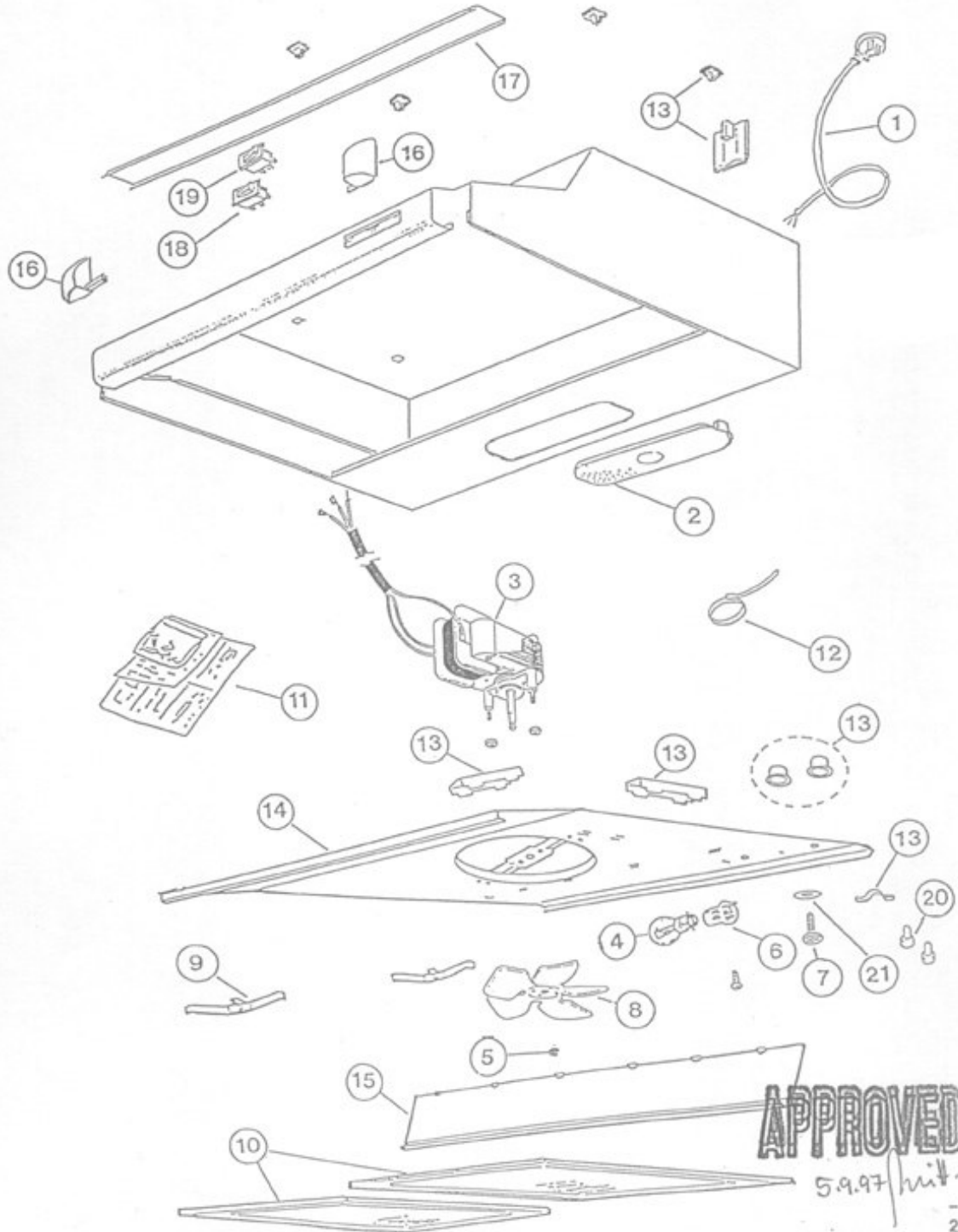

**RG - SERIES****ROBINHOOD GRANGE**

RG6WH, RG6BL, RG6SS, RG6BR, GRANGE 600 – 2 SPEED  
 RG9WH, RG9BL, RG9SS, RG9BR, GRANGE 900 – 2 SPEED

ITEM	DESCRIPTION	PART No.
1	Power Cord	103424
2	Disfuser	101112
3	2 Spd. Motor & Sleeve Nuts	103673
4	Lamp 40W	101191
5	'E' Clip E147	999084
6	Lamp Holder	101104
7	Screw Earth M5 x 8 Taptite	999083
8	Fan Blade 'D' Shaft	102283
9	Filter Spring (Polycarbonate)	101221
10	Filter (Aluminium) 600 x 2 Off	103793
	Filter (Charcoal) 600 x 2 Off	103793C
	Filter (Aluminium) 900 x 2 Off	100046
	Filter (Charcoal) 900 x 3Off	103793C
11	Mounting Hardware (with Installations)	100651
12	Wire Tie	106099
13	Cord Entry Family Includes:	102549CL
	2 Grommets	
	4 Top Mount Inserts	
	1 Cord Entry	
	2 Wire Covers	
	1 Cable Clamp	
20	Closed End Connectors	102321
21	Washer External Lock M5	999085
	Fingerguard	103943

**RG - SERIES****ROBINHOOD GRANGE**

RG6WH, RG6BL, RG6SS, RG6BR, GRANGE 600 – 2 SPEED

RG9WH, RG9BL, RG9SS, RG9BR, GRANGE 900 – 2 SPEED

ITEM	DESCRIPTION	P/N 600	P/N 900
<b>Grange - White</b>			
14	Motor Housing	101052WH	101053WH
15	Rear Cover	101062WH	101063WH
16	Corners L&R	101150WH	101150WH
17	Exhaust Cover	101064WH	101065WH
18	Switch Lamp	100683 103892	100683 103892
19	Switch Fan	100684 103893	100684 103893
<b>Grange – Nordic Brown</b>			
14	Motor Housing	101052NB	101053NB
15	Rear Cover	101062NB	101063NB
16	Corners L&R	101150BR	101150BR
17	Exhaust Cover	101064NB	101065NB
18	Switch Lamp	100685	100685
19	Switch Fan	100686	100686
<b>Grange – Copper Spangle</b>			
14	Motor Housing	101052CS	101053CS
15	Rear Cover	101062CS	101063CS
16	Corners L&R	101150BR	101150BR
17	Exhaust Cover	101064CS	101065CS
18	Switch Lamp	100685	100685
19	Switch Fan	100686	100686
<b>Grange – Black</b>			
14	Motor Housing	101052BL	101053BL
15	Rear Cover	101062BL	101063BL
16	Corners L&R	101150BL	101150BL
17	Exhaust Cover	101064BL	101065BL
18	Switch Lamp	100685	100685
19	Switch Fan	100686	100686

## **RG - SERIES**

### **SECTION 1.**

#### **MOTOR REMOVAL AND REPLACEMENT**

- 1.1 REMOVE DIFFUSER AND LIGHT BULB
- 1.2 REMOVE FINGERGUARD AND FANBLADE
- 1.3 REMOVE REAR COVER
- 1.4 REMOVE FILTER SPRINGS AND LOCATING SCREWS ON MOTOR HOUSING
- 1.5 LIFT MOTOR HOUSING FRONT EDGE, DRAW POWER CABLE THROUGH BACK
- 1.6 DISCONNECT SWITCHES
- 1.7 REMOVE MOTOR HOUSE FROM BODY AND TURN UPSIDE DOWN ON TOP OF BODY
- 1.8 REMOVE MOTOR NUTS AND WASHERS
- 1.9 DRAW MOTOR DOWN, AWAY FROM MOUNTING BRACKET TO SHOW MOTOR
- 1.10 CUT WIRES FROM NEW MOTOR KIT. LEAVE ABOUT 3 OR 4mm OF COLOUR ON RED, BLACK AND WHITE WIRES (DO NOT UNSOLDER THESE WIRES).
- 1.11 SOLDER WIRES FROM RANGEHOOD ONTO NEW MOTOR (USE COLOURS TO MATCH WITH).
- 1.12 REMOUNT MOTOR TO BRACKET
- 1.13 REASSEMBLE RANGEHOOD IN REVERSE TO PROCEDURE ABOVE, TAKING CARE TO PULL AS MUCH OF THE POWER CORD OUT OF THE BODY AS POSSIBLE
- 1.14 TEST TO ELECTRICAL SAFETY STANDARDS

## **RG - SERIES**

### **SECTION 2.**

#### **SWITCH REPLACEMENT**

- 2.1 REMOVE MOTOR HOUSING AS PER THE INSTRUCTIONS IN SECTION 1
- 2.2 SWITCHES ARE REMOVED FROM THE INSIDE OF THE RANGEHOOD BY DEPRESSING THE HOLDING TAGS MOULDED INTO EACH SIDE OF THE SWITCH
- 2.3 REPLACE WITH NEW SWITCH, CHECK WIRING AS PER WIRING DIAGRAM, AND THAT SWITCHES ARE IN THE CORRECT POSITION

### **SECTION 3.**

#### **POWER CORD REPLACEMENT**

- 3.1 REMOVE MOTOR HOUSING AS PER THE INSTRUCTIONS IN SECTION 1
- 3.2 REMOVE CABLE CLAMP
- 3.3 PULL OUT POWER CORD AND REMOVE BY CUTTING OFF THE CLOSED END CONNECTORS, STRIP AND RECONNECT NEW CORD USING NEW CONNECTORS – CRIMP SECURELY
- 3.4 REPLACE CABLE CLAMP
- 3.5 CARRY OUT EARTH TEST BEFORE CONNECTING TO POWER

**RG - SERIES**

 **Robinhood** GRANGE

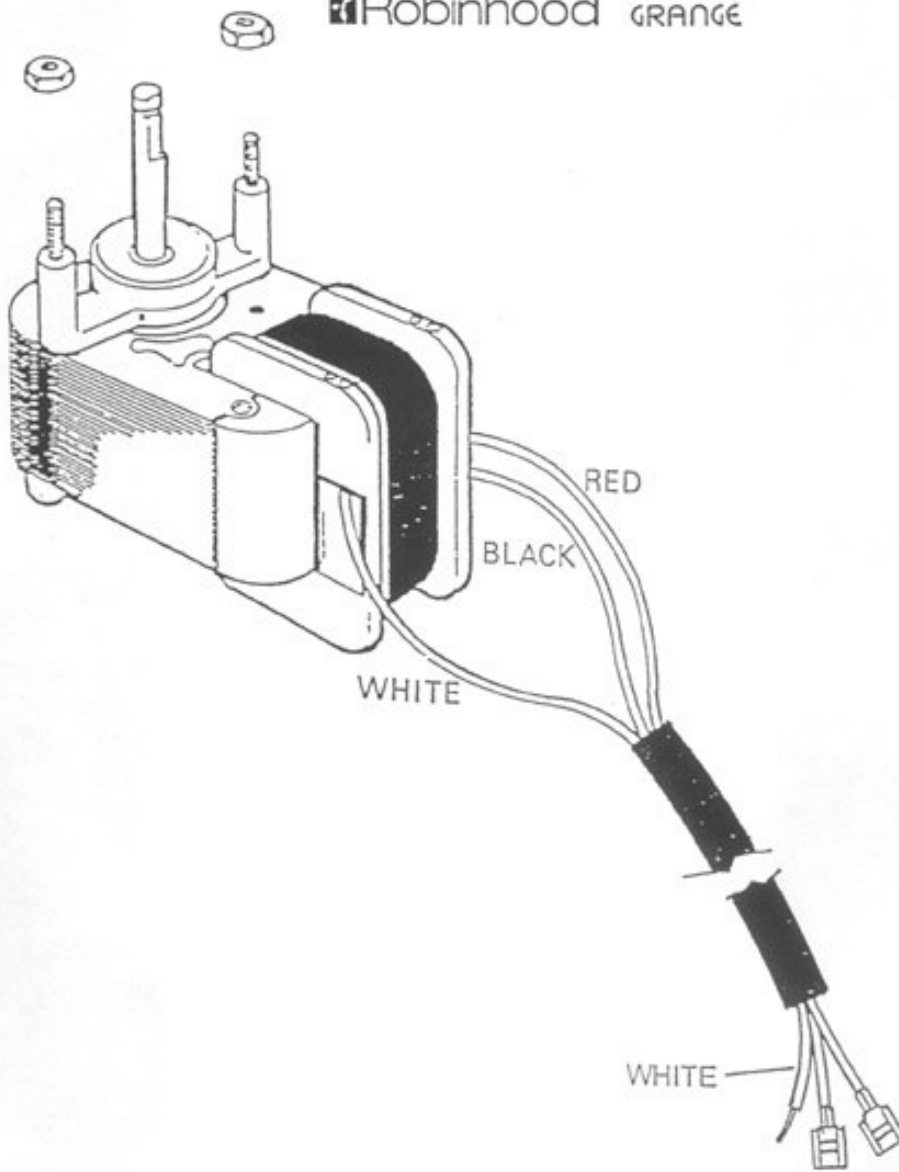

MOTOR (UPPCO) 2 SPEED No. 102264

SUPPLIED WITH SLEEVE & 2 NUTS

**APPROVED**

24.10.97

*Mid.*

6

# RG - SERIES

WIRING DIAGRAM FOR  
100683 AND 101909 LIGHT SWITCH  
100684 AND 101910 FAN SWITCH

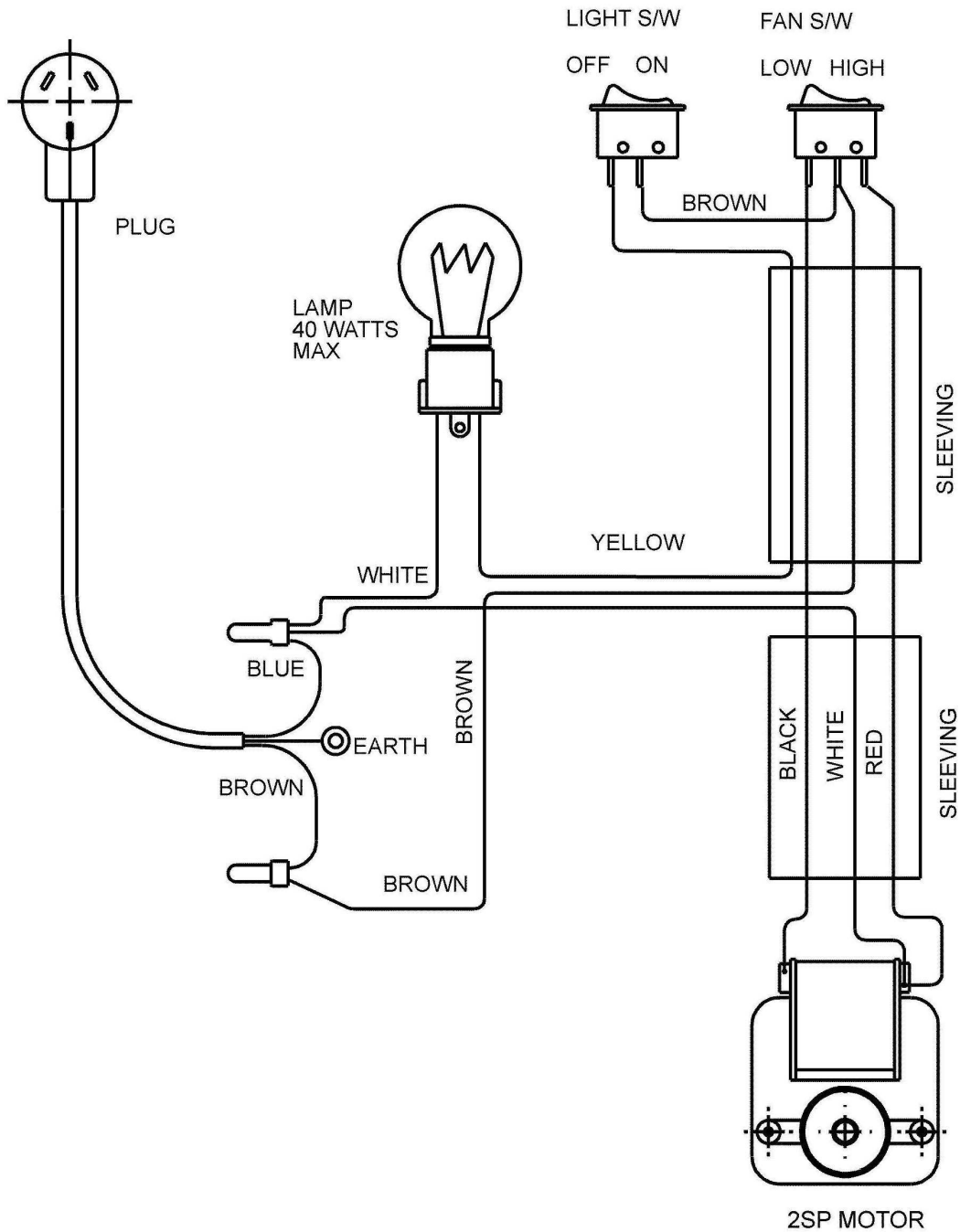



# RG - SERIES

WIRING DIAGRAM FOR  
103892 AND 103894 LIGHT SWITCH  
103893 AND 103895 FAN SWITCH

