

Description: **ROBINHOOD WALL CANOPY 90CM**

Model Number: **RWA3CL9SS/RWB3CL9SS**

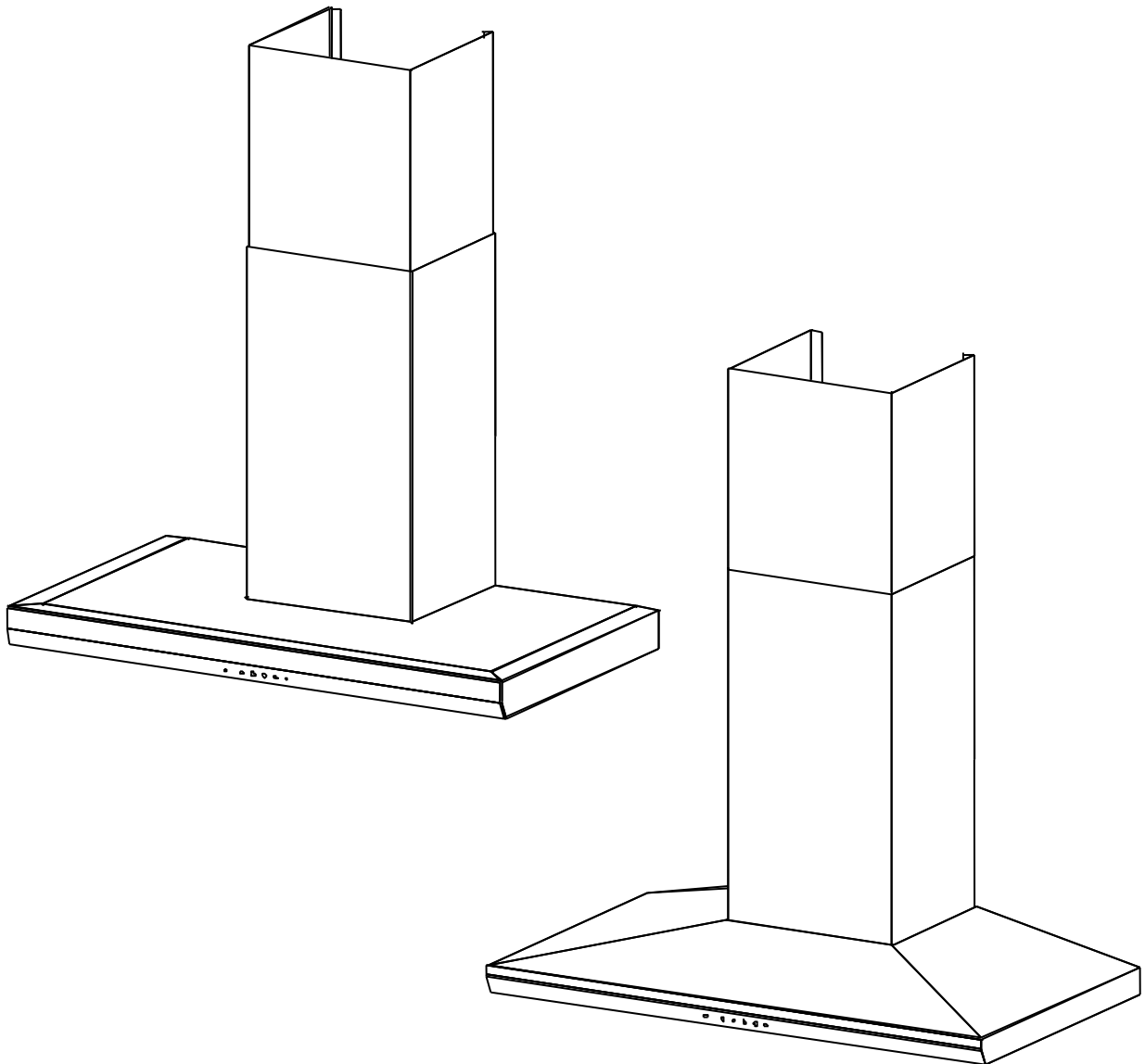

Model Pictured: **RWA3CL9SS & RWB3CL9SS**

Exploded view

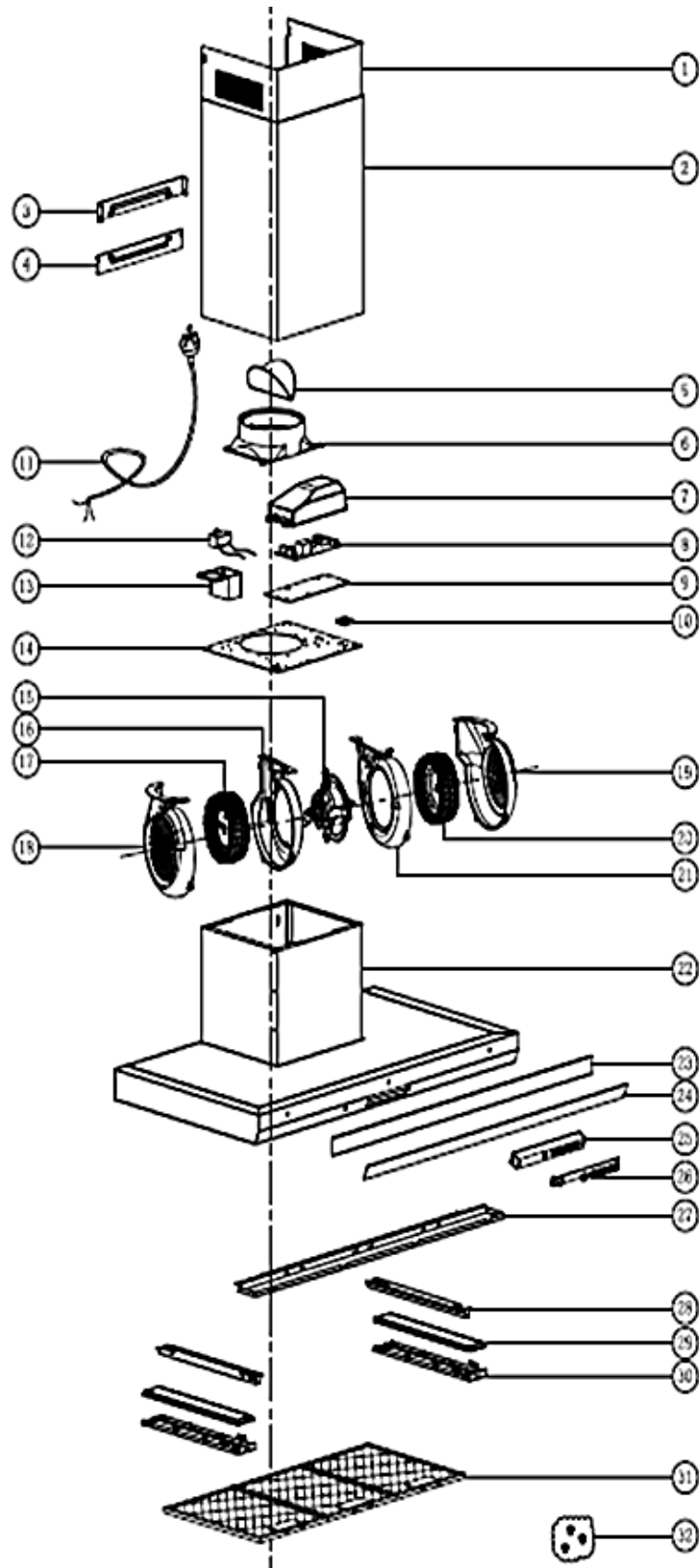

Model pictured: **RWA3CL9SS**

Item	Description	Part number
1	Upper chimney	ATICRWAS01
2	Lower chimney	114281
3	Inner chimney bracket	ATICBRWA01
4	Outer chimney bracket	ATOCBRWA01
5&6	Outlet with flaps	12001010300004
7	PCB cover/terminal box	114282
8	PCB board	114283
9-11	Insulating base, wire fixing base, power cord with plug	n/a
12	Capacitor	ATCP04
13	Capacitor box	114298
14	Top plate	1130402510
15-21	Motor assembly	ATRWABMA01
22	Cabinet assembly	ATRWABCA01
23-24	Front panel + glass	150050101277
25-26	Switch assembly	ATRWABSA01
27	Front plate	1130204827
28	Lamp bracket hanging bar	1130204829
29	LED lamp plate	1400600265
30	Lamp bracket	1130204830
31	SS decorative aluminium filter *3	1300100522
32	Screws bag	ATRWABSW01

Wiring diagram

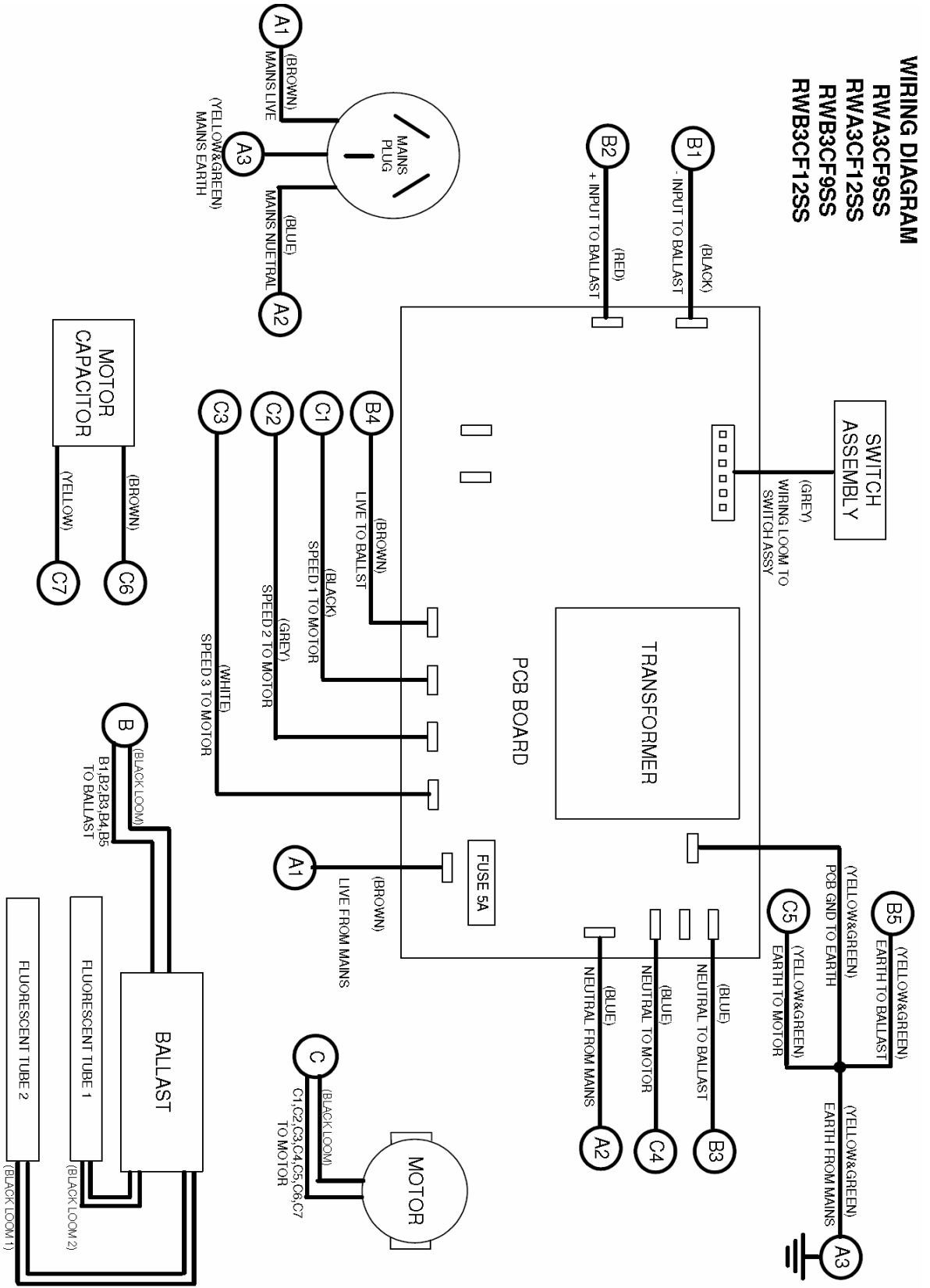

New Zealand

Monaco Corporation Ltd
 Telephone: (09) 415 6000
 Facsimile: (09) 415 7400
 Email: enquiries@robinhood.co.nz
 www.robinhood.co.nz

Australia

Shriro Australia Pty Ltd
 (ABN 28 002 386 129)
 Telephone: 1800 648 556
 Facsimile: 1800 628 577
 Email: enquiries@robinhood.com.au
 www.robinhood.com.au