

# Seatpost Installation

American Classic Seatpost Installation

## INSTALLATION:

1. Grease the threads on the Main Clamp Bolt and the Tilt Adjuster Bolt.
2. Lightly grease the Top Block and the Cradle Plate where the saddle rails make contact.
3. Install the saddle but leave the Main Clamp Bolt loose.
4. Set the Tilt Adjuster Bolt to give the desired saddle angle.
5. Tighten the Main Clamp Bolt to secure the saddle to the post.

**Important** - Torque to 12 foot pounds with a torque wrench.

## MAINTENANCE:

There will be an initial seating in of all parts. The Main Clamp Bolt should be retightened after the first ride.

Do not attempt to readjust the saddle angle without first loosening the Main Clamp Bolt.

If your saddles is making noise, lightly grease the Top Block and the Cradle Plate where the saddle rails make contact.

Always remember to keep bolt, threads, and surface contact points clean. Preventative maintenance will extend the life of your bike.

Inspect your post and top block assembly periodically for signs of wear, damage or corrosion.

**\*Note** - The Brass Washer is only used on our OLDER *one piece* Aluminum and Titanium seatposts.

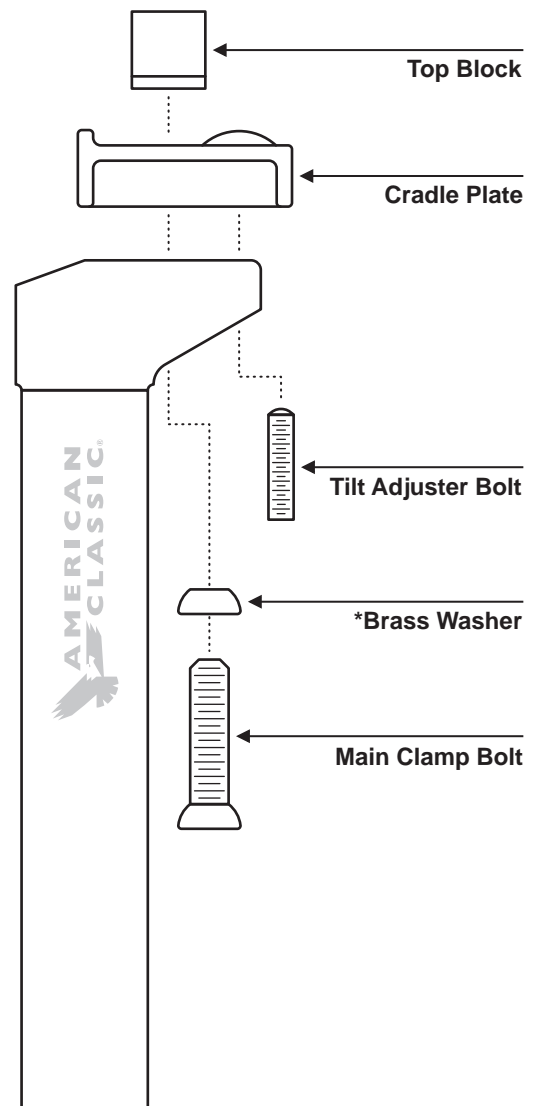

**All repairs should be performed by a Professional Bicycle Mechanic.**