

# TITAN CROSSBOW ASSEMBLING INSTRUCTIONS MANUAL

Thank you for purchasing TITAN Compound Crossbow Package, We hope this crossbow can enhance the quality for your leisure life and bring you more pleasant with outdoors shooting for many years. This sophisticated crossbow is composed of Hi-Tech CNC Machined and Optical components. It should be treated with care and maintained properly to optimize its precision performance.

**Important – Please check this deluxe package carefully to make sure that the following components and accessories are included in the box. (Simple Pack: some accessories are not included).**

- 1: TITAN Crossbow Body (stock, trigger assembly, weaver style scope base, sling studs)
- 2: TITAN 200lb Assemble Riser
- 3: Eye Protection Glasses
- 4: Quick Detachable 6-Bolt Quiver
- 5: Quiver Mounting Hardware Packet
- 6: Assembly Tools / hardware packet – Allen wrenches, nose bolt, washer, cable slide
7. Rope Cocker Device
- 8: Rail lube
- 9: 4 – 20” Carbon fiber arrows with 100 grain practice points
- 10.4x32 Deluxe Multi-Reticle Scope
11. Padded Shoulder Sling

**Warning-** In case that you received shortage package any of these items please contact your dealers or outlets for a prompt assistance for the safety consideration.

**Please do not directly return this crossbow package to the places where you bought this package without notification of your dealers or outlets in advance.**



①



③



⑤



⑦



⑨



⑪



②



④



⑥



⑧



⑩



## ASSEMBLING INSTRUCTIONS:

**Step 1:** Attach cable slide to cables as shown.

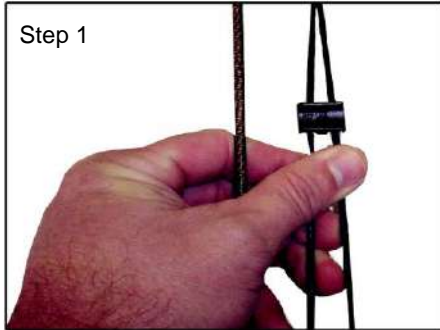

**Step 2:** Start with assembling stock and riser by positioning the bow string on the top of the rail and inserting the cable slide into position inside the rail to protect the cables from undue wear. **FAILURE TO SET UP CABLE SLIDE WILL RESULT IN CABLE DAMAGE** and will not be covered by the warranty. The section plane the cable slide is designed to match the section plane the aluminum rail of the crossbow and protect the cables.

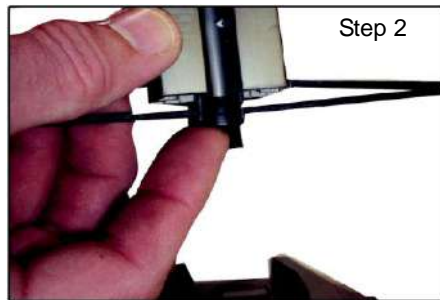

**Step 3:** Position the riser assembling and the body/stock together have to prepare the nose bolt and washer for installation. It is not necessary to force the stock and riser together, due to the precision machining and tight tolerance of the joint simply push the two pieces together so that they are properly aligned to be bolted together, and using the Allen wrench start with tighten the noses bolt. The stock/body and riser will begin to cinch together as the nose bolt is tightened. Continue to tighten until the two pieces are securely tightened.



**Step 4:** Flip the crossbow over and further secure the joint from potentially loosening by tightening the grub screw on the center of the underside of the riser as shown.

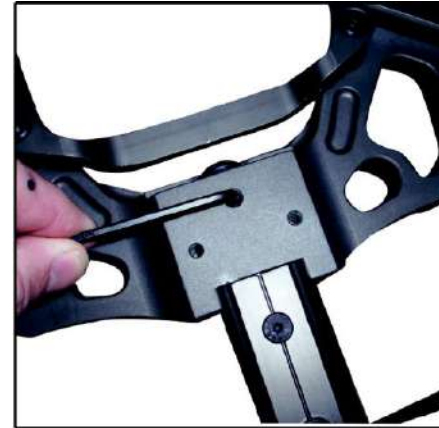

**Step 5:** Attach quiver mount found in the quiver mount hardware packet to the underside of the riser using the 2 counter sink Allen screws provided in the quiver hardware packet as pictured.



**Step 6:** Attach the quiver bracket with latch onto the quiver using the 2 Hex Socket Flat screws. You have to use a screwdriver to accomplish this. The latch is shown in the open position ready to mount the assembled quiver onto the crossbow.

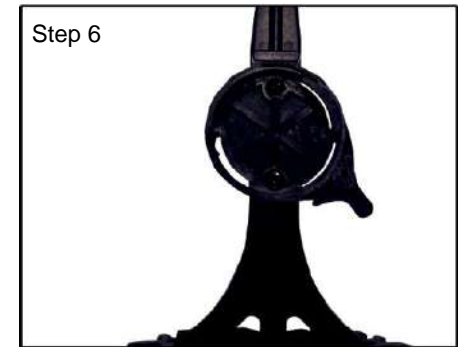

**Step 7:** Attach the quick detach quiver to the quiver mounting bracket using a twisting motion. The quiver should be at a diagonal angle in order to properly seat on the quick detach bracket prior to twisting into the fixed position.

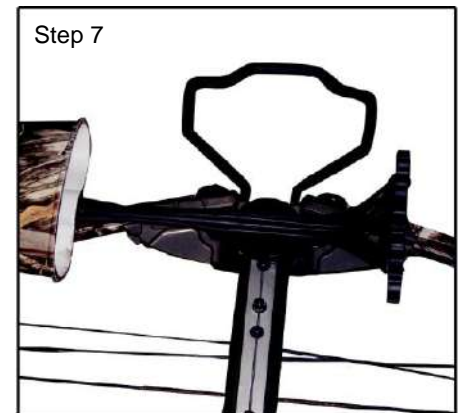

**Step 8:** Attach the padded shoulder sling to the crossbow. Loosen the thumb screw sling on the swivel so that the swivel may attach to the sling studs located on the underside of the crossbow stock. Tighten the thumb screws securely on both swivels.

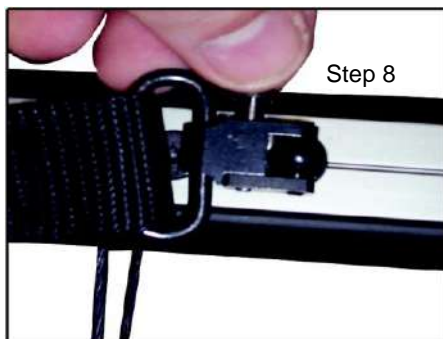

**Step 9:** Prepare to Mount 4x32 Scope. In order for your Titan and accuracy, your scope must be mounted fixed and level. Inspect the weaver style scope base for level. Visually check to ensure that scope base is flat and level. It should be level from the factory, however if the mount is loose or appears to be out of level you will need to adjust the leveler screws located inside 2 access holes on top of the scope mount. Please note the outer two holes contain the leveler screws, you will not be utilizing the other hole.



With the aid of a small level adjust the scope base until it is level and true. Begin by loosening the 2 leveler screws until the mount is able to be rocked slightly up and down with the pivot point being the center of the mount.

Tighten or loosen the rear leveler screw until your base is level, then tighten the front leveler screw until the base is secure and tight. Tighten both levelers securely and you are now ready to mount your scope.



**Step 10:** Loosen the clamps on the scope mount and align the crossbar on the clamps with the slots on the weaver style base and tighten down as shown.



## READ THIS BEFORE YOU ATTEMPT TO SHOOT YOUR TITAN CROSSBOW

Your Titan Crossbow is equipped with an anti dry-fire mechanism, this may be different from other crossbows you have owned and you must be familiar with the basic operation of the trigger before using. Please familiarize yourself with these steps:

- 1: **YOU MUST BE SURE**, prior to attempting to cock the Titan crossbow that the safety switch is in the **"FIRE"** position.
- 2: The crossbow **WILL NOT** cock if the safety switch is moved to the **"SAFE"** position.
- 3: Once you have cocked the crossbow, the safety will automatically be engaged and the safety switch will now be in the **"SAFE"** position.
- 4: You **WILL NOT** be able to release the safety until you are ready to shoot the crossbow and you have loaded a bolt on the rail and have it positioned and ready to fire the bow.
- 5: This is to prevent an accidental dry-fire (shooting without a bolt) of the crossbow. Please note that Dry-Fire is not covered by Warranty.
- 6: Once you load the bolt into position, you may release the safety to the **"FIRE"** position
- 7: Shoot at your target - Once the bow is shot the safety will remain in the **"FIRE"** position until you cock the bow again and repeat the process.
- 8: Please do not aim at any people as long as you cock the string and load a bolt on rail.

## FINAL ADJUSTMENTS TO YOUR CROSSBOW

### MARK YOUR STRING:

In order to achieve the highest level of accuracy it is recommended that you take the time to mark your string to ensure that you are cocking the bow in a consistent manner. Due to the high draw weight involved in cocking the bow it is easy to cock the crossbow off center. Failure to cock the crossbow squarely and with consistency will result in poor accuracy. Simply mark the string with a permanent marker or other means to visibly ensure the bow is being cocked properly.

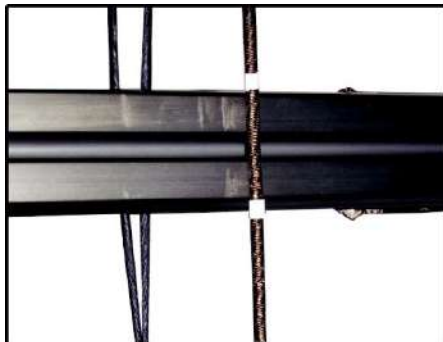

**IMPORTANT: LUBRICATE THE STRING SERVING AND RAIL AT THIS TIME. FAILURE TO DO SO WILL RESULT IN EXCESS FRICTION, THE STRING SERVING BURNING AND WEARING OUT PREMATURELY**

### COCKING THE CROSSBOW

The best way to cock the Titan crossbow is through the use of the included rope cocking device. To use the rope cocking device, simply grasp of the hooks and drape the rope over the groove located behind the trigger mechanism/scope mount and continue to

place the hooks onto the crossbow string on each side of the flight track. Once this is accomplished simply grasp the molded handles through the straps, hold crossbow to a level surface using the foot stirrup and pull the string back until it latches in the trigger. Using this method, the draw weight will be reduced by 50% and the string will cock in a consistent manner each time.

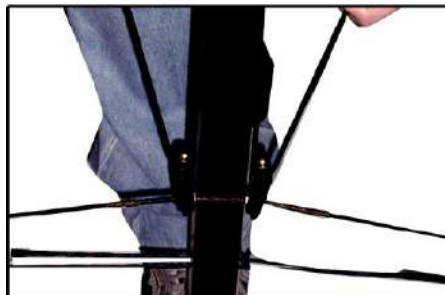

### *To manually cock the crossbow follows the instructions below.*

Place the foot stirrup on the ground in a flat and stable area. Insert your foot into the stirrup and securely hold the crossbow down to the ground with the weight of your body. With one hand on each side of the flight track, securely grasp the string as close as possible to the flight-track.

Begin drawing the string back towards the trigger mechanism, being sure to keep the string in contact with the flight track. Continue pulling the string back into position, being sure to keep the alignment straight. The trigger latch and safety will automatically engage when you have reached the back of the trigger housing.

Once cocked, the marks should be visible in the same position on each side of the trigger mechanism. You are now ready to load the crossbow with an arrow.

**Warning: Do not Dry-fire your (fire without an arrow) your crossbow. Your crossbow is equipped with an Anti-Dry-Fire trigger. You will not be able to release the safety until an arrow is inserted into shooting position. Therefore we strongly urge you to only unload your crossbow by shooting it at a safe target. Attempting to uncock the string by hand is dangerous and may cause damage to the crossbow, and/or physical harm, as well as void your warranty. Do not attempt to do this.**



When loading an arrow into your crossbow, be sure to check that the arrow is in good condition, is free from defects, and is straight and true. It should lay in the flight-track without any bends or other issues that would cause erratic flight of the arrow. Insert the arrow onto the flight-track with the index fletch (odd colored fletch) down in the groove of the flight-track as pictured.

It is **IMPERATIVE** that the arrow is seated ALL the way back with the half moon nock cradled against the string. If this is not done the string may jump the arrow or may go under the arrow

– which would be equivalent to dry firing the bow (Firing without an arrow – this would void your warranty and damage could occur)



### FIRING THE CROSSBOW

With the arrow correctly loaded and an appropriate target is in position with adequate backstop provided, release the automatic safety and pull the trigger to fire the crossbow. We recommend you start sighting in your bow at a maximum distance of 10 yards in order to be sure that your aim is on target. Once the unit is sighted in at close range, further distances may be attainable.

### RECOMMENDED ARROWS

The Titan crossbow includes 4 – 20" carbon fiber arrows equipped with 100 grain practice points. These arrows are appropriate for target shooting and hunting provided the tips are changed out and replaced with proper hunting tips of the same grain weight. If expendable broadheads are legal in your area then we recommend they be utilized. You may alter your arrow setup using 20" aluminum arrows with 100 grain practice points available through your Inferno dealer. Minimum arrow and tip weight of 350 grains is required.

Thank you for your purchase of this crossbow. We wish you a great success in hunting and target shooting pursuits!

### Basic Sighting of Your Scope

Your Titan crossbow includes a 4x32 multi-reticle crossbow scope; we suggest beginning to sight in your crossbow at no more than 10 yards to ensure that you are able to hit the target easily to avoid loss or damage of your arrows. You will be sighting in the TOP LINE on your scope for the shortest distance. Using an appropriate target designed for crossbows, begin by first checking to see if you will hit the target with your shot, similar to bore sighting aim at the target and verify that you will hit the intended target. It is a good idea to use some sort of rest to ensure that you are aiming consistently. Take your first shot aiming at the center bulls eye, and examine where on the target the arrow has hit.



Depending on where the shot hit you will need to adjust the Wind-age knob (Left and right) and elevation (up and down) knob on the scope in the direction indicated on the scope adjustment knobs to make the correction. Continue repeating the process until you are zeroed in at 10 yards and then begin to move slowly further away from the target to your desired first yardage making adjustments to wind-age and elevation as necessary. The other lines below the top line will offer you additional yardage sight points, the lower the line the further the distance. These distances will depend on your initial yardage sighting of the top line, and also depend on your arrow configuration (arrow shaft length, size and weight, tipect).



# TITAN CROSSBOW ASSEMBLING INSTRUCTIONS MANUAL

# Warranty Statement

Thank you for your purchase this Titan Crossbow, we offer you 1 year warranty service to be free in terms of defects on limbs - stocks or material under proper use from the date of purchase. It does not cover any damage resulting from abuse or misuse, repair or disassemble core components carried out by others rather than your dealers or authorized service center, or damage occurs during transit. Warranty services are not covered in terms of consumables, such as strings, cables as well as other parts or items that call for periodic replacements.

Those damages resulted from Dry-Fire (To fire your crossbow without loading an arrow) to the limbs, cables, cams or string no matter it happens on purpose or accidental as well as scratch generation from improperly loading an arrow or assembling without following assembling instructions cannot be covered under this warranty.

The crossbow unit should be well-packed before delivering back to your dealers or distributors to avoid damage during transportation, such kind of damage is not covered under warranty, either. Please prepay postage of your sent parcel for the defect crossbow in advance. Dealer will repair or offer replacement parts free of charge and reimburse postage back as long as the defect is identified under normal use or generated from product structure. Those who purchased this crossbow are not situated in the same countries of dealer's location. The inbound & outbound shipping and handling should be paid at account of buyers. If the faults were caused by misuses, accidents or abnormal conditions of operations, the appraisal for repairs will be informed for your approval prior to move forward your defect unit being repaired or replaced.

To activate your warranty service, your original purchase receipt or invoice, come with the sales after service form printed below to mail them back with your dealers or wholesalers to register your product purchase is required.

Dealer's contact information:

\_\_\_\_\_

Model Number \_\_\_\_\_ Date of Purchase \_\_\_\_\_

Last Name \_\_\_\_\_ First Name \_\_\_\_\_

Street Address \_\_\_\_\_

City \_\_\_\_\_ State \_\_\_\_\_ Zip Code \_\_\_\_\_

E-mail: \_\_\_\_\_ Phone Number \_\_\_\_\_

Reasons for your purchase: \_\_\_\_\_