

# Pikler triangle assembling instruction

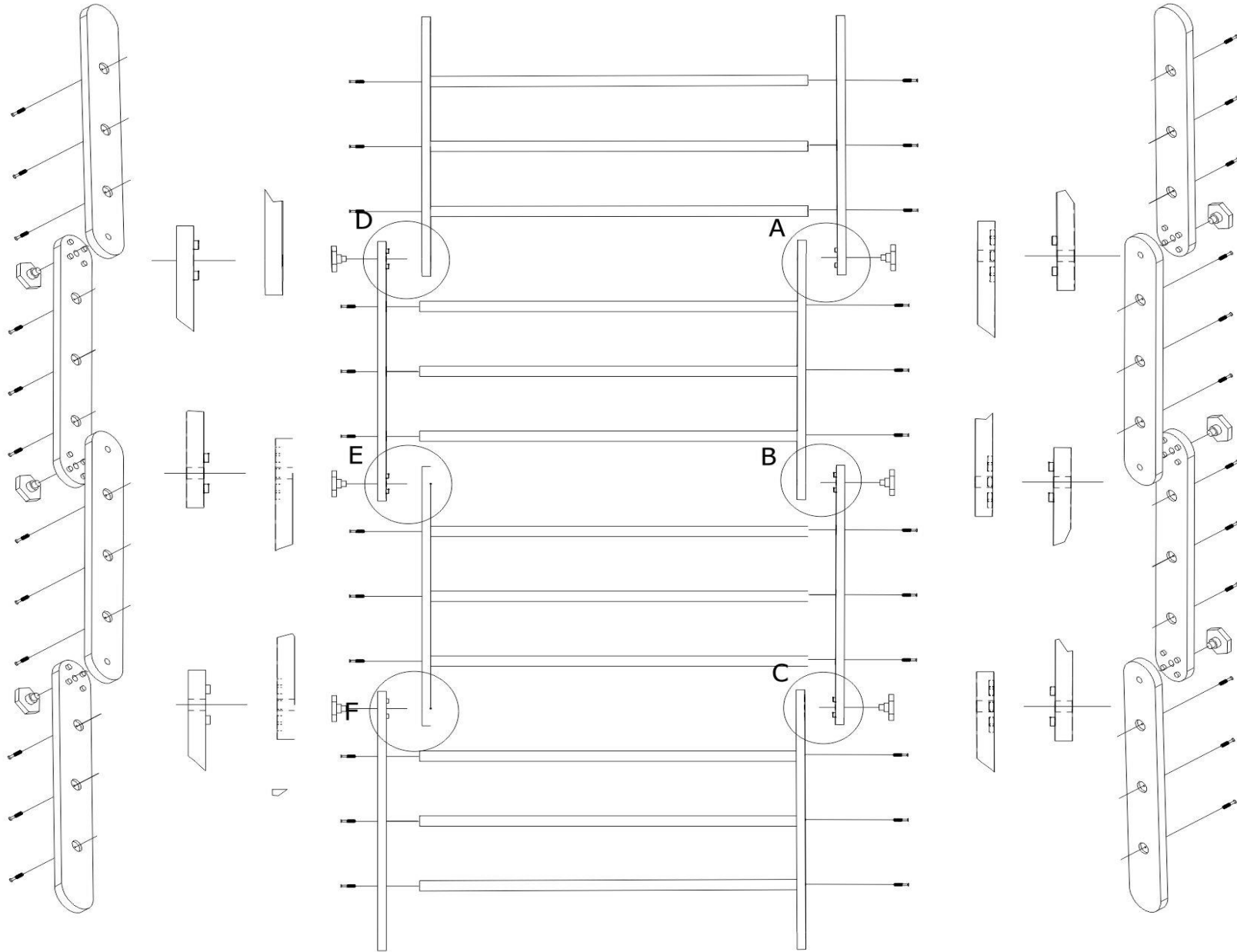

# Pikler triangle assembling instruction

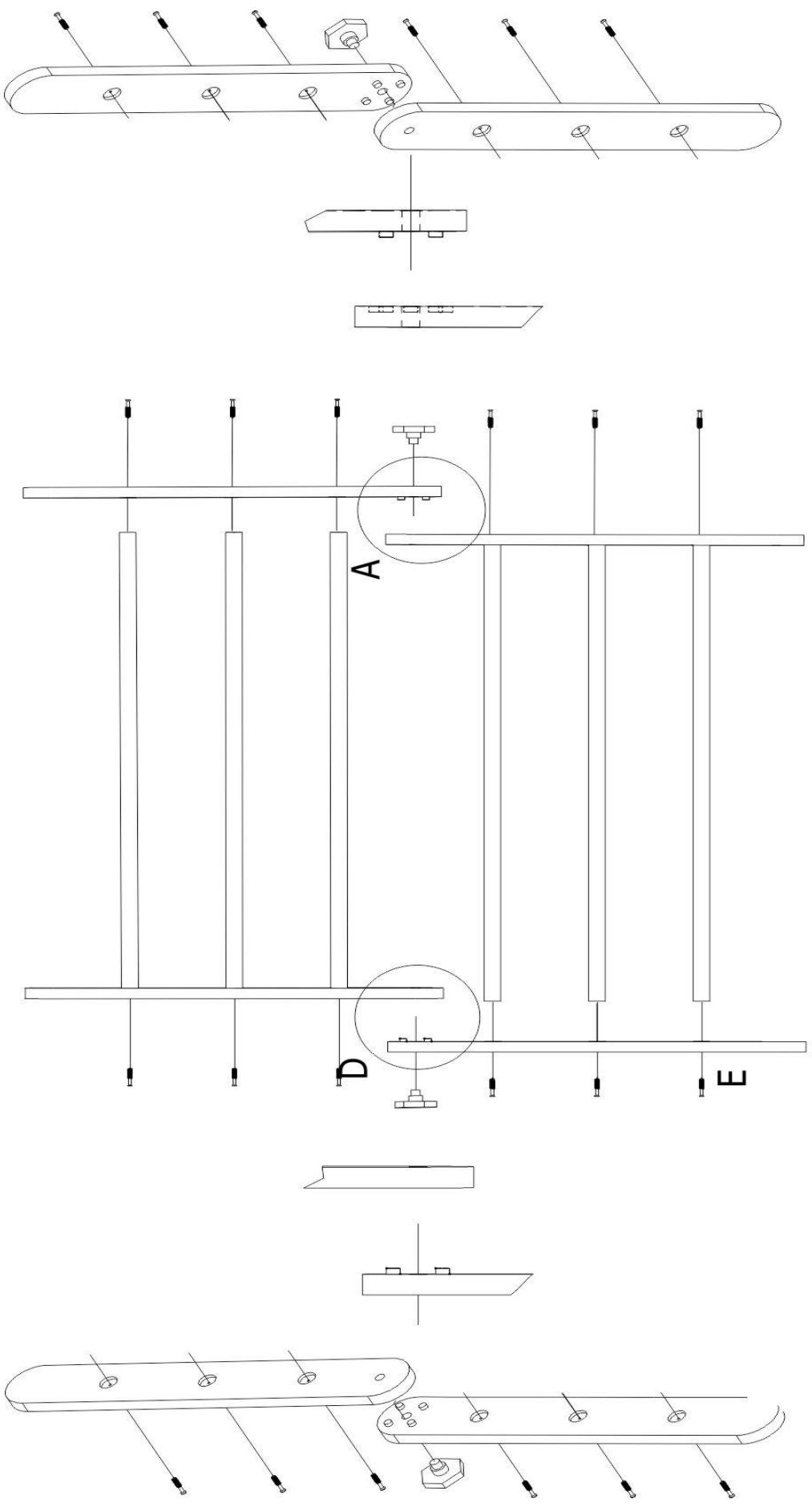

# Pikler triangle assembling instruction

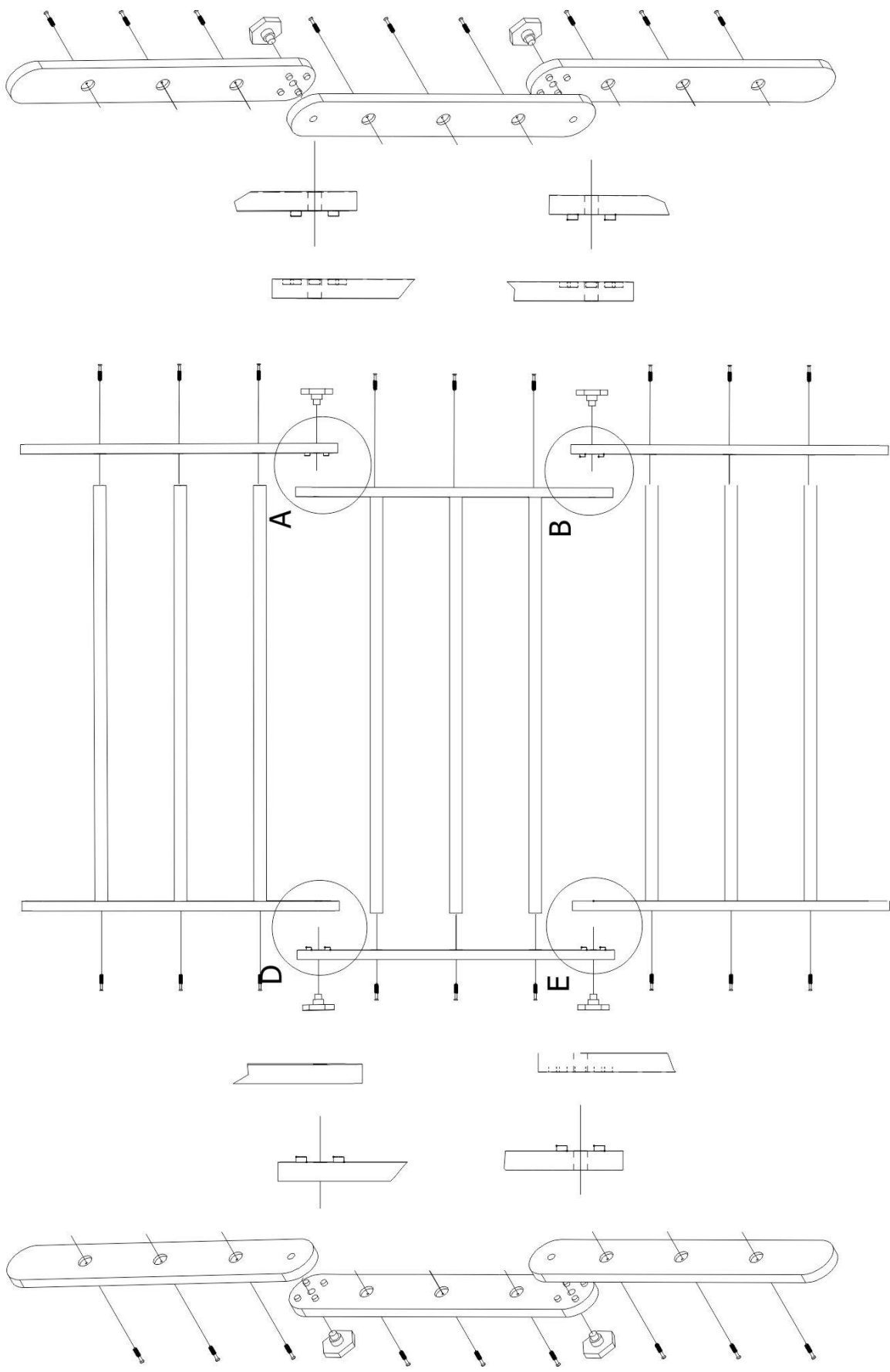

# ASSEMBLY INSTRUCTIONS

## Pikler triangle

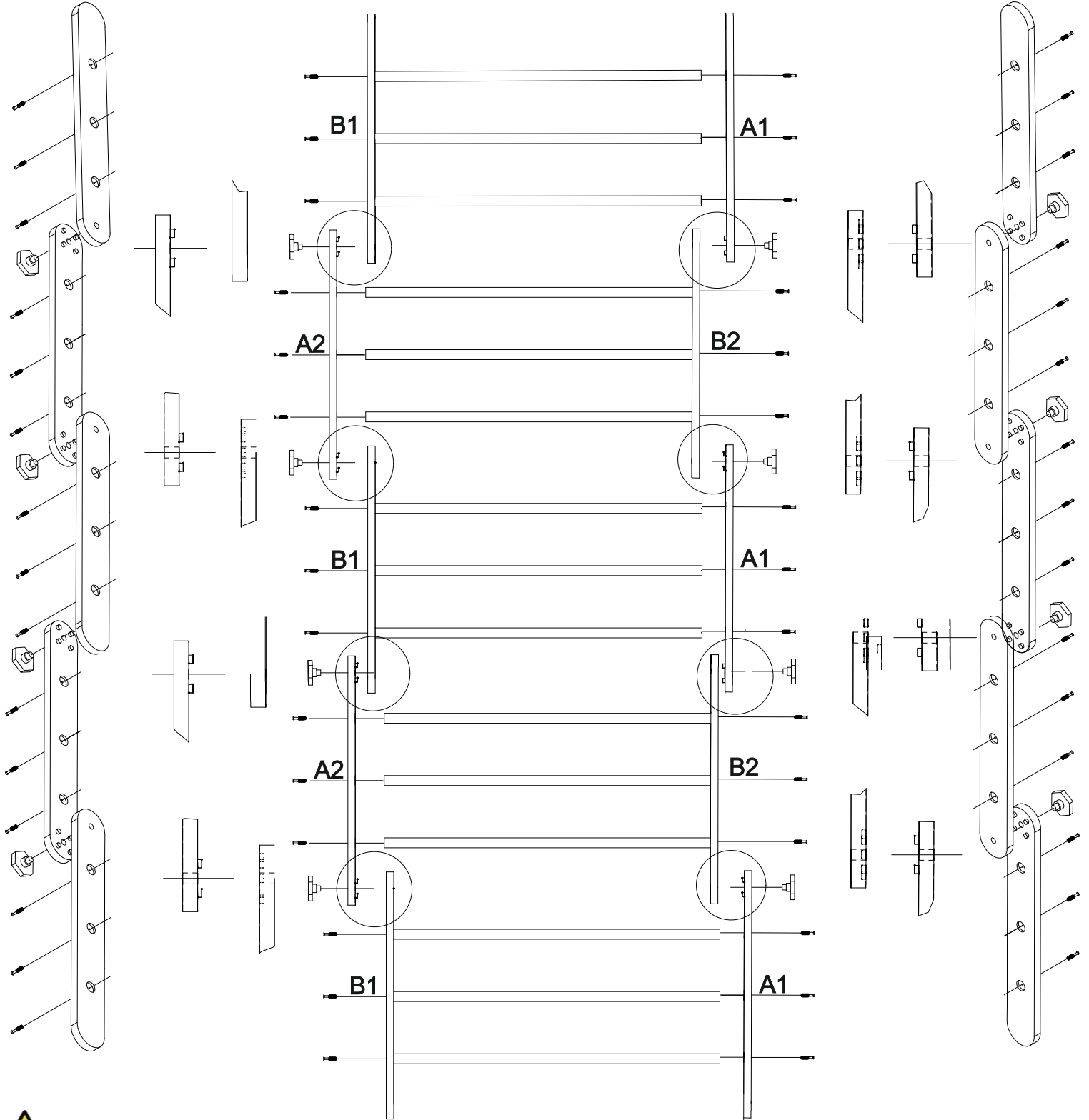

Ensure all screws and hardware are tightened and locked into place before use.  
Use only on a firm ground which is horizontal, level and dry. Use only under adult supervision.