

EXCEL

SKU - 31164

OPERATING INSTRUCTIONS



16" PEDESTAL FAN WHITE

3 SPEED SETTINGS



Please read these instructions carefully before use and retain for future reference

Before switching on your appliance,
always check for any damage which may have been caused in transit

EN Assembly - Use -
Maintenance Manual

Exceltools.co.uk

CONTENTS

Important Safety Instructions.....	3-4
Specification	5
Assembly Instructions.....	6-7
Operating Instructions.....	8
Cleaning and Maintenance	9
Trouble Shooting Guide.....	10
Disposal Information.....	10
Fuse Replacement.....	11

IMPORTANT SAFETY INSTRUCTIONS

Please read this user manual carefully to ensure proper use, maintenance and installation.

1. This product is intended for domestic and light office use **ONLY** and not for commercial, industrial or outdoor use.
2. Do not operate the unit with a damaged cord or plug, after it malfunctions or has been dropped or damaged in any way.
3. All electrical repairs must be carried out by a qualified electrician. Inadequate repairs may result in a major source of danger for the user and invalidate the warranty.
4. Make sure the voltage in your home corresponds to the one shown on the rating label of the appliance
5. This fan should not be operated without the base fitted or laying down.
6. This unit should always be kept in an upright position especially during operation to avoid any damage. Locate the unit on a flat stable surface.
7. Position the power cord where people will not step on or trip over it.
8. Ensure that the air inlets and outlets are not blocked or covered.
9. Do not place the unit too close to curtains or other objects - min 30cm.
10. Make sure there are no objects near the unit which can prevent it from oscillating.
11. Never insert fingers, pencils or other objects into the unit. Warn your children against these dangers.
12. This appliance should only be used by adults.
13. Keep the appliance and its cord out of reach of children.
14. Children shall not play with the appliance.
15. Cleaning and user maintenance shall not be made by children.
16. This appliance is not intended for use by persons (including children) with reduced physical, sensory or mental capabilities, or lack of experience and knowledge.

17. Unplug the unit from the socket when not in use. Do not pull on the cord.
18. Do not use the unit near a bath, shower, swimming pool or anywhere it could be splashed with water.
19. Do not expose the unit to direct sunlight.
20. Do not use the unit near flammable or explosive gases.
21. Before cleaning or moving the unit, switch it off and unplug the power cord.
22. Do not leave the unit unattended during operation. Always unplug the power cord when not in use.

SPECIFICATION

Brand	Excel
Colour	White/Black
Wattage (W)	45W
Frequency (Hz)	50/60Hz
Voltage (V)	220-240 V
Product Dimensions (mm)	H 1250 x W 620 x D 620 mm
Net Weight (kg)	2.5 kg
Oscillation Function	Yes
Class	II 
Speeds	Low, Medium, High

ASSEMBLY INSTRUCTIONS

Assembly Parts List

- A. 2 x Feet
- B. 1 x Main pole
- C. 1 x Extension pole (located inside Main pole B)
- D. 1 x Feet cover
- E. 1 x Tightening cap
- F. 1 x Fan motor
- G. 1 x Back fan cover
- H. 1 x Front fan cover
- I. 1 x Cover tightening cap (screwed to Fan motor F)
- J. 1 x Fan blades
- K. 1 x Fan tightening cap (screwed to Fan motor F)
- L. 1 x Small screw and nut
- M. 4 x Feet screws
- N. 1 x Logo cover and 3 x screws

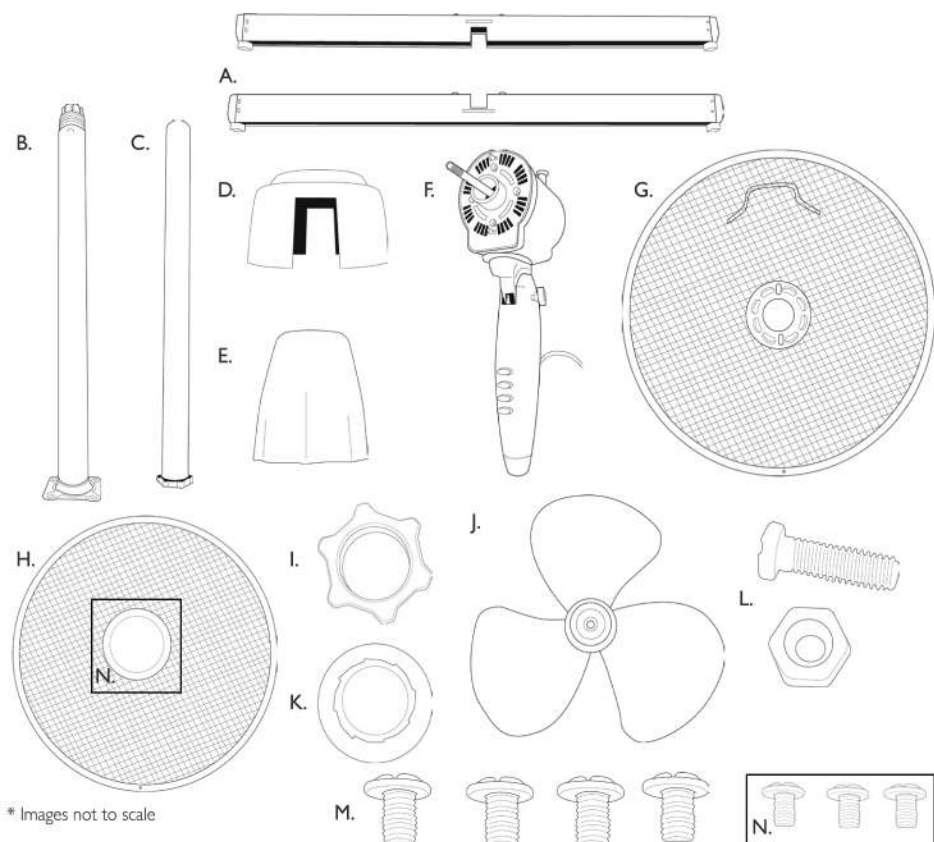

Required Equipment:

Small cross headed screwdriver

1. Locate both feet **(A)** together to form an X shape, ensuring 4 attached screws **(M)** are facing upwards and rubber feet are facing downwards. Unscrew four screws **(M)** and retain for use in step 4.
2. Line up four screw holes on base of main pole **(B)** with four screw holes on feet poles **(A)** - Screw in place using four screws **(M)** from step 1.
3. Place feet cover **(D)** over main body pole **(B)**.

IMPORTANT: DO NOT continue any further without fitting feet cover as once further steps are completed it will not be possible to fit feet cover without unscrewing tightening cap.

4. Pull extension pole **(C)** upwards from inside main pole **(B)** and extend to required height.
5. Once extended to desired height, place tightening cap **(E)** over both poles and secure tightly to keep extension pole **(C)** in place.
6. Place fan motor **(F)** on top of main pole **(B)** and secure with attached tightening screw.
7. Unscrew both tightening clips **(I & K)** from front of fan motor **(F)**. Place back fan cover **(G)** onto front of fan motor **(F)** and secure with cover tightening cap **(I)**.

IMPORTANT: Ensure back fan cover (G) is placed with small handle at the top and screw hole on outer edge at the bottom.

8. Place fan blades **(J)** onto front of fan motor **(F)** and secure with fan tightening cap **(K)**.

IMPORTANT: Ensure flattened section on back of fan blades (J) line up with flattened section on front of fan motor (F) when positioning to allow correct fitting.

9. Logo cover **(N)** needs attaching to the front of fan cover **(H)** using the 3 screws provided.
10. Place front fan cover **(H)** over front of fan blades **(J)** and ensure small hook at top of front fan cover **(H)** is hooked over back fan cover **(G)**. Ensure screw hole is lined up at the bottom with screw hole on back fan cover **(G)**. Place small screw and nut **(L)** through hole at bottom of fan blade covers and secure. Fasten all surrounding clips to secure both halves of fan cover together.

OPERATING INSTRUCTIONS

On/Off and Speed Control

The on/off and speed is controlled by the button switch.

0 = Off

1 = Low

2 = Medium

3 = High

Height Setting

- Loosen the height adjustment collar by turning it anti-clockwise (fig 2).
- Pull the inner pipe upwards to the desired height (fig 3).
- Re-tighten the collar by turning firmly clockwise (fig 4).

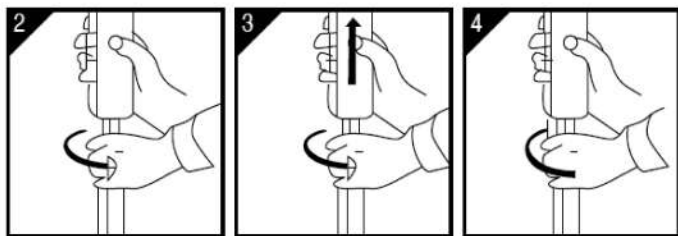

Angle Adjustment

Switch off the fan. Slightly loosen the adjusting screw by turning it anti-clockwise. Adjust the fan to the desired angle and then tighten the adjusting screw by turning it clockwise.

Oscillation Adjustment

Push the oscillation control to turn on the oscillation function. Pull the oscillation control to turn it off.

CLEANING AND MAINTENANCE

- Turn off the fan and remove the plug from the power supply before cleaning.
- Use a dry, soft cloth to remove any dust from the fan.
- If the fan is particularly dirty, use a soft damp cloth and wipe dry.
- Do not use any chemicals or detergents as they will damage the fan.
- It is recommended to cover the fan with a plastic bag before storage to prevent dust collecting on fan blades.
- Store the fan in a ventilated and dry area.
- Do not allow water to get inside the body of the fan.

TROUBLE SHOOTING GUIDE

If you experience difficulties with the appliance, please check the suggestions below before contacting customer services

Problem	Possible Cause	Possible Solution
The appliance does not work.	The appliance is not properly plugged into the wall socket.	Plug the appliance in firmly.
	The appliance is not switched on.	Make sure the appliance is switched on.
	There is no electricity running through the mains wall socket.	Check the fuse or breaker.

DISPOSAL INFORMATION

The European Directive 2012/19/EU on Waste Electrical and Electronic Equipment (WEEE), requires that old household electrical appliances must not be disposed of in normal unsorted municipal waste.

Old appliances must be collected separately in order to optimise the recovery and recycling of the materials they contain and reduce the impact on human health and the environment.

The crossed out "wheeled bin" symbol on the product reminds you of your obligation, that when you dispose of the appliance it must be separately collected. Consumers should contact their local authority or retailer for information concerning the correct disposal of their old appliance.



MAINS PLUG FUSE REPLACEMENT

Fuse Replacement (Class II)

Remove the fuse cover with a small flat head screw driver. Take out the fuse and replace with a new fuse of the same Amp. Replace the fuse cover and push back into place.



EXCEL

CONTACT US:

Tools4Trade Ltd.
6 Fitzhamon Court,
Bradwell Wolverton,
Milton Keynes, MK12 6LB

PHONE:

01908 969966

Email:

sales@tools4trade.co.uk

Exceltools.co.uk