

EXCEL

18V Cordless Grass Trimmer
11787



INSTRUCTION MANUAL

DESCRIPTION OF SYMBOLS



Read instructions carefully before any use.



Complies with relevant European regulations.



Danger of injury from flying parts!
Keep the bystanders away from the danger zone!



Wear eye protection.



Wear hearing protection.



Do not expose to rain.



Remove battery before adjusting or cleaning, and before leaving the machine unattended for any period.

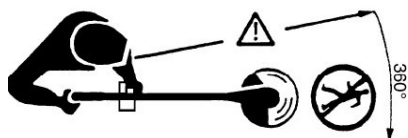

Warning! Keep bystanders away.

Original Instructions



Noise output level LWA



The crossed-out wheeled bin symbol indicates that the item should be disposed of separately from household waste. The item should be handed in for recycling in accordance with local environmental regulations for waste disposal.

By separating a marked item from household waste, you will help reduce the volume of waste sent to incinerators or land-fill and minimize any potential negative impact on human health and the environment.

On battery



Do not expose the battery to water.



Do not expose the battery to fire or incinerate.

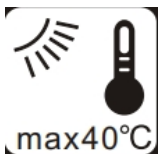

Do not expose the battery to high temperatures (above 40° C).

On charger



Class II machine – Double insulation – You don't need any earthed plug.



Use this device indoors only.

GENERAL SAFETY WARNINGS

IMPORTANT

READ CAREFULLY BEFORE USE

KEEP FOR FUTURE REFERENCE



WARNING! Read all safety warnings and instructions.

Failing to follow the warnings and instructions can result in an electric shock, a fire and/or a serious injury.

Keep all warnings and all instructions to be able to refer to them later on.

The term “tool” in the warnings refers to your electrical mains powered tool (with power cord) or your battery operated tool (without power cord).

Children should be supervised to ensure that they do not play with the appliance.

Training

- a) Read the instructions carefully. Be familiar with the controls and the proper use of the machine.
- b) Never allow children, people with reduced physical, sensory or mental capabilities or lack of experience and knowledge or people unfamiliar with these instructions to use the machine. Local regulations can restrict the age of the operator.
- c) Keep in mind that the operator or user is responsible for accidents or hazards occurring to other people or their property.

Preparation

- a) Never operate the machine while people, especially children, or pets are nearby.
- c) Before using the machine and after any impact, check for signs of wear or damage and repair as necessary.
- d) Never fit metal cutting elements.
- e) Never use replacement parts or accessories not provided or recommended by the manufacturer.
- f) Before use, always visually inspect the machine for damaged, missing or misplaced guards or shields.

Operation

- a) Wear eye protection and stout shoes at all times while operating the machine.
- b) Avoid using the machine in bad weather conditions especially when there is a risk of lightning.
- c) Use the machine only in daylight or good artificial light.
- d) Never operate the machine with damaged guards or shields or without guards or shields in place.

Original Instructions

- e) Switch on the motor only when the hands and feet are away from the **cutting means**.
- f) Always remove the battery from the machine:
 - 1) Whenever leaving the machine unattended;
 - 2) Before clearing a blockage;
 - 3) Before checking, cleaning or working on the machine;
 - 4) After striking a foreign object to inspect the machine for damage;
 - 5) Whenever the machine starts to vibrate abnormally, for immediately check, such as loose screw, and so on.
- g) Take care against injury to feet and hands from the **cutting means**.
- h) Always ensure that the ventilation openings are kept clear of debris.
- i) Take care against injury from any device fitted for trimming the filament line length. After extending new cutter line always return the machine to its normal operating position before switching on.

Maintenance and storage

- a) Disconnect the battery from the machine before carrying out check, maintenance or cleaning work on the machine, and when it is not in use.
- b) Use only the manufacturer's recommended replacement parts and accessories.
- c) Inspect and maintain the machine regularly. Have the machine repaired only by an authorized repairer.
- d) When not in use, store the machine out of the reach of children.

SPECIAL SAFETY WARNINGS

- The grass trimmer must not be used by anyone under the age of 16.
- Always check the good working order of the trimmer which, if not adequate, could endanger the user.
- Do not use the trimmer if the cutting device is not secured properly or is damaged.
- Before starting the trimmer, make sure that the nylon line is not touching stones or debris.
- Always wear suitable clothing when using the trimmer to prevent head, hand or feet injuries.
- When the trimmer is in operation, keep the cutting section away from all parts of the body.
- Do not start the trimmer when it is upside down or when not in working position.
- Do not let other people or animals come within 5 meters of the trimmer when in use.
- Remain in a stable and secure position while operating the trimmer.
- Do not cut against hard objects. This could cause injury or damage the trimmer.
- Use the edge of the guard to keep the trimmer away from walls, surfaces,

Original Instructions

miscellaneous things and delicate objects.

- Never use the trimmer without the guard.

CAUTION! The guard is vital for your and other peoples' safety and for the good working order of the trimmer. The failure to observe these safety regulations are not only dangerous but also annuls the guarantee terms.

- Be careful of the line-cutting blade, which can give deep cuts.
- Do not try to stop the cutting device (nylon line) with your hands. Always let it come to a stop by itself.
- **CAUTION!** After switching off, the nylon line will continue to rotate for a few more seconds.
- Only use the original type of nylon line. Under no circumstances use metal wire instead of nylon.
- Do not use the trimmer to cut grass that is not in contact with the ground; for example, do not cut grass that is not walls or rocks etc.
- Do not switch the grass trimmer on in enclosed or poorly ventilated spaces or in the presence of inflammable and/or explosive substances such as liquids, gas and powders.
- The user of the grass trimmer is responsible for any damage sustained by third parties that has been caused by the grass trimmer within the working area.
- Do not cross roads or gravel paths with the trimmer still running.
- The trimmer should be used in compliance with these instructions and only in a position that is vertical in relation to the ground. Any other position is dangerous.
- Check regularly that the screws are properly secured.

SAFETY INSTRUCTION FOR BATTERY

a) Recharge only with the charger specified by the manufacturer. A charger that is suitable for one type of battery pack may create a risk of fire when used with another battery pack.

b) Use power tools only with specifically designated battery packs. Use of any other battery packs may create a risk of injury and fire.

c) When battery pack is not in use, keep it away from other metal objects, like paper clips, coins, keys, nails, screws or other small metal objects, that can make a connection from one terminal to another. Shorting the battery terminals together may cause burns or a fire.

d) Under abusive conditions, liquid may be ejected from the battery; avoid contact. If contact accidentally occurs, flush with water. If liquid contacts eyes, additionally seek medical help. Liquid ejected from the battery may cause irritation or burns.

e) Have your power tool serviced by a qualified repair person using only identical replacement parts. This will ensure that the safety of the power tool is maintained.

WARNING! During the use of tools supplied with batteries, the basic safety measures must be followed in order to reduce fire hazards, electrolyte leakage and personal injury, including the following precautions:

Original Instructions

- Ensure that the battery block is suitable for the tool.
- Ensure that outside surface of the battery block is clean and dry before connecting it to the charger.
- Ensure that the batteries are charged using the correct charger recommended by the manufacturer. Incorrect use can create a risk of electric shock, overheating or the leaking of corrosive liquid from the battery.
- If there is an electrolyte leak, avoid any contact with the skin. In the event of a leak, wipe with a rag. If the liquid comes into contact with the skin, rinse abundantly with water. In the event of a reaction or contact with the eyes or mucous membranes, consult a doctor.
 - Ensure that the appliance is properly switched off before inserting the battery into the appliance. *Inserting a battery into an appliance while it is switched on can cause accidents.*
 - Use the appliance only with the type of battery indicated in the instructions. *Using another type of battery can create a serious risk of injury and cause a fire.*
 - When the battery is not in use, keep it away from metal objects such as trombones, coins, keys or other small metal objects that can create a connection between one terminal and the other. *Short-circuiting the terminals of batteries can cause burns to the user and cause a fire.*
- Dispose of batteries. Ensure that the battery is properly disposed of:
 - 1- Do not throw it away
 - 2- Do not to burn it
 - 3- Do not throw it in a river
 - 4- Dispose of it in the designated collection containers (ask your retailer)

INTENDED USE

This trimmer is ideal for trimming lawn edges and small lawn areas in private gardens. The trimmer should not be used in public gardens, parks, sports grounds, streets etc. and in farming and forestry.

• **Because of possible accidents the trimmer must not be used for:**

- trimming of bushes and hedges
- cutting of flowers

• **For safety reasons, the trimmer is not for use by persons below 16 years of age and persons who are not familiar with its handling.**

DESCRIPTION OF PARTS

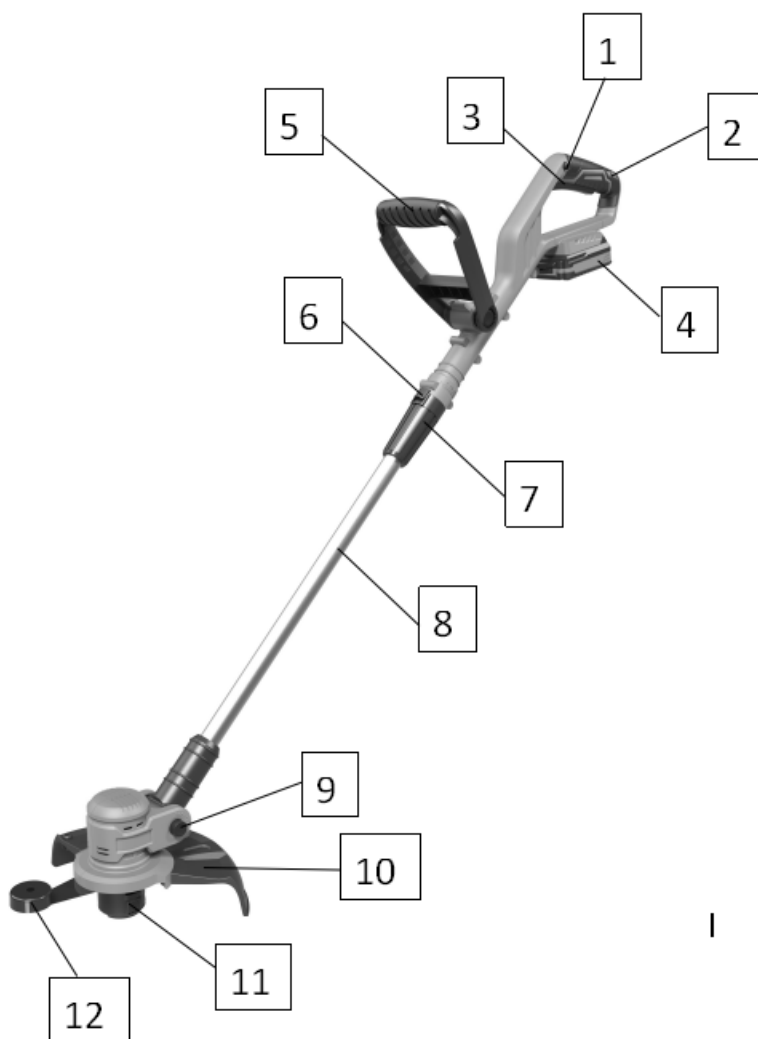

1 Lock-off button	2 Main handle
3 On/off switch	4 Battery pack(excluded)
5 Auxiliary handle	6 Handle rotation button
7 Telescopic shaft locking collar	8 Telescopic shaft
9 Cutting head adjusting button	10 Safety guard
11 Spool	12 Edge wheel

TECHNICAL DATA

Model:	11787
No load speed:	8500 min ⁻¹
Cutting width:	300 mm
Spool	Line diameter: 1.6mm single
Vibration:	<2.5 m/s ² , K=1.5 m/s ²
Sound emission level (L _{pA}) :	84.07 dB(A) K=0.47 dB(A)
Guaranteed sound power level (L _{wA}):	96.07 dB(A) K=0.47 dB(A)
Battery and Charger	
Recommended battery	a)11759,Li-ion 18V d.c. 2.0Ah
	b)11760,Li-ion 18V d.c. 5.0Ah
Recommended charger	1. Model : 11761 Input : 100-240V~ 50Hz 60W Output : 20V DC 2.3A Charging time : a)60MIN b)140MIN
	2. Model :11763 Input : 100-240V~ 50Hz 125W Output : 20VDC, 5A Charging time : a)30MIN b)70MIN
	3. Model :11762 Input : 100-240V~ 50Hz 130W Output : 20VDC, 2.3AX2, USB×2, 5VDC MAX 2A Charging time : a)60MIN b)140MIN

Noise/Vibration Information

Measured sound values determined according to EN 50636-2-91.

The noise figures quoted are emission levels and are not necessarily safe working levels. Whilst there is a correlation between the emission and exposure levels, this cannot be used reliably to determine whether or not further precautions are required. Factors that influence the actual level of exposure of work-force include the characteristics of the work room, the other sources of noise, etc. i.e. the number of machines and other adjacent processes, and the length of time for which an operator is exposed to the noise. Also the permissible exposure level can vary from country. This information, however, will enable the user of the machine to make a better evaluation of the hazard and risk.

Wear hearing protection!

Vibration total values (triax vector sum) determined according to EN 50636-2-91.

Original Instructions

The vibration emission level given in this information sheet has been measured in accordance with a standardised test given in EN 50636-2-91 and may be used to compare one tool with another.

It may be used for a preliminary assessment of exposure.

The declared vibration emission level represents the main applications of the tool. However if the tool is used for different applications, with different accessories or poorly maintained, the vibration emission may differ. This may significantly increase the exposure level over the total working period.

An estimation of the level of exposure to vibration should also take into account the times when the tool is switched off or when it is running but not actually doing the job. This may significantly reduce the exposure level over the total working period.

Identify additional safety measures to protect the operator from the effects of vibration such as: maintain the tool and the accessories, keep the hands warm, organisation of work patterns.

Wear high-quality safety gloves.

CHARGING PROCEDURE

Battery charger (Fig.1)

The lithium-ion battery can be charged at any time and will not develop a “memory” when charged after only a partial discharge. It is not necessary to run down the battery pack charge before recharging. Remove the battery pack from the tool when convenient for you and your job. You can “top-off” your battery pack’s charge before starting a big job or long period of use.

Due to lithium-ion’s fade-free properties, the only time it is necessary to charge the lithium-ion battery pack is when the pack has reached the end of its charge. To signal the end of charge, power to the tool will drop quickly. Charge the battery pack as needed.

Fig.1



a. Charging the battery

This lithium-ion battery pack is shipped partially charged. Before using it the first time, fully charge the battery pack. A fully discharged battery pack with a temperature between 5°C and 35°C will charge in about 30-140MIN(See section”Specifications”).

Original Instructions

11761:

- Plug the charger adapter into power source. The green light on the charger stand will illuminate, indicating the charger is powered.
- Slide the battery all the way into the charger stand until it locks in place with a click. The red light on the charger stand will illuminate, indicating that the battery is charging.
- The red light will go off after charging is complete and a green light will appear.

11763/11762:

See the manual of 11763/11762

NOTE: Batteries may become warm while charging. This is normal. If the battery is hot after continuous use in the tool, allow it to cool down to room temperature before charging. This will extend the life of your batteries.

WARNING: Always disconnect the battery pack from the tool before any assembly, adjustments or changing accessories.

a. Insertion and removal of rechargeable battery (Fig. 2)

Depress the battery-release button located on the front of the battery pack to release battery pack.

Pull the battery pack out and remove it from the tool.



Fig.2

Warning!

Always remove the battery pack before making adjustments to the equipment.

Be sure to read the following information before you put the cordless equipment into operation: • Charge the battery pack with the charger. An empty battery pack requires a charging period of approximately 0.5 to 1 hour.

ADJUSTMENT

Using Adjustable Handle

The adjustable handle can be set in various positions:

1. Click on the hide buttons on either end of it, to change the position you need.

Original Instructions



Adjusting Product Length

Loosen the adjustment collar.

Pull the shaft out to increase the height, or push the shaft in to decrease the height.

Re-tighten adjustment collar.

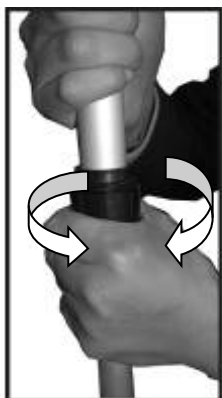

Adjusting cutting head angle:

The lawn trimmer is equipped with a three position adjustable working angle. This enables you to easily trim hard-to-reach areas in your garden.

To set the ideal working position, please follow the instructions below.



The cutting head should be inclined slightly forward while trimming.



Original Instructions

Adjusting the main hand

You can adjust the hand according to your requirement from 0 to 90 and 180.



Switching On and Off

Press lock off firstly, then press switch button to start work. Release switch for switching off.



Cutting Grass

Move the trimmer left and right, keeping it well away from the body.

Cut taller grass in stages.

Remove the wheels when cutting long grass

Cutting Around Trees and Bushes

Using with Auxiliary wheels when cutting around trees and bushes, in this way, they do not come into contact with the cutting line.

Instructions for use

CAUTION! Do not employ the device without the correct safety guard. Make sure it is functional before every use.

Hold front handle with one hand and auxiliary handle with the other hand.

Make sure that cutting line is fed out before operation.

Do not switch the machine on with the cutting head on or near material to be cut.

Ensure the machine is at full speed before contacting material to be cut.

Keep unit below waist level.

Original Instructions

Work only from your right to your left to ensure debris is thrown away from you. Proceed slowly, keeping the trimmer inclined (approx. 30°)

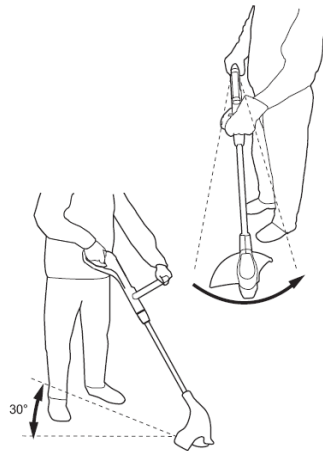

Without bending over, keep cutting head near and parallel to the ground (perpendicular when edging). Allow only the tip of cutting line to make contact. Do not cut damp or wet grass.

High grass should be cut in layers, always beginning from the top. The cuts should be short.

Avoid wearing the cutting line out quickly by knocking against hard objects (stone, walls, fences etc).

To edge, rotate the upper shaft with front handle 180°, place the edger wheel and cutting head above the surface you are going to edge.

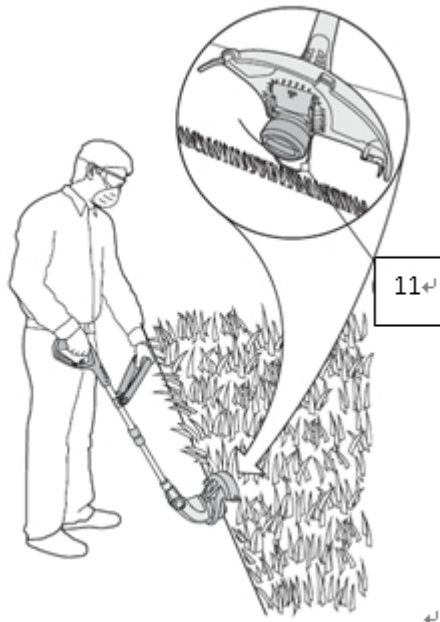

Original Instructions

Replacing the trimmer spool

WARNING! Use only cutting lines with correct diameter. Other sizes of cutting line will not feed properly and will result in improper function or can cause serious injury.

Fitting trimmer spool and cutting line complete

Your trimmer is supplied with a fully disposable trimmer spool which overcomes troublesome rewinding the cutting line

1. Remove the battery pack.
2. Clean any grass or debris from the trimmer head.
3. Press and hold in the cover release latches to open the cutting head cover and pull out the old trimmer spool from the cutting head.

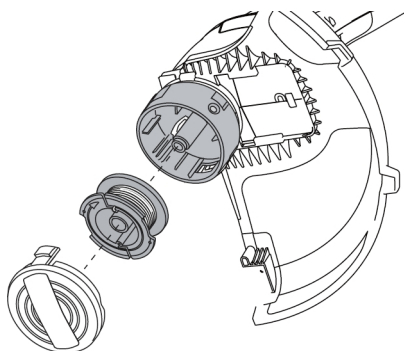

4. Clean out the cutting head.
5. Insert the end of the new cutting line through the spool eyelets and put the new trimmer spool into the cutting head.
6. Refit the cutting head cover.
7. Pull out the end of the cutting line until they reach the outside edge of trimmer safety guard.

MAINTENANCE



Before any work on the machine itself, remove battery from machine.

Note: To ensure long and reliable service, carry out the following maintenance regularly.

Regularly check for obvious defects such as loose fixings, and worn or damaged components.

Check that covers and guards are undamaged and correctly fitted. Carry out necessary maintenance or repairs before using.

If the trimmer should happen to fail despite the care taken in manufacture and testing, repair should be carried out by an authorized customer service agent

AFTER TRIMMING / STORAGE

After Trimming/Storage



Stop and remove battery from product. Ensure battery is removed before storage.

Clean the exterior of the machine thoroughly using a soft brush and cloth. Do not use water, solvents or polishes. Remove all grass and debris, especially from the ventilation slots.

Turn the machine on its side and clean the cutting guard inside. If grass cuttings are compacted, remove with a wooden or plastic implement.

Battery should be stored between 0 – 45°C; incorrect storage could result in the battery being damaged.

Store it out of reach of children.

FAULT FINDING

The following table gives checks and actions that you can perform if your machine does not operate correctly.

If these do not identify/remedy the problem, contact your service agent.



Warning: Switch off and remove battery before investigating fault.

Problem	Possible cause	Remedy
Line feed mechanism is not working.	Spool is empty.	Fit new spool.
	Line is torn and stuck inside spool.	Remove spool, check tightness of winding and replace spool in the usual way.
	Line is “welded” to itself or to spool through heat build-up.	Remove welded line section, check tightness of winding and replace spool in the usual way.
Grass trimmer switch off inadvertently	Battery overheating (temperature exceeding 45°C)	Allow battery to cool down
	Battery is empty	Charge battery
Grass trimmer cannot be switched on	Battery is empty	Charge battery
	Battery defective	Replace battery
Charger: No charging (red LED constantly on)	Battery temperature below 5 °C or above 45 °C	Allow battery to cool down or heat up
	Battery defective	Replace battery
Charger: Malfunction (red LED flashes)	Contacts dirty	Clean contacts
	Battery defective	Replace battery

Original Instructions

Disposal



Electronic devices are recyclable waste and must not be disposed of in the household waste. At the end of its service life, dispose of the product according to the relevant statutory regulations.



Remove any rechargeable battery, if necessary, and dispose of it separately from the product.

You thus fulfil your statutory obligations and contribute to environmental protection.

Exceltools.co.uk
Sales@exceltools.co.uk