

EXCEL

**18V Brushless grass trimmer/
brush cutter 2 in 1
11784/GT-B0118**



INSTRUCTION MANUAL

Original Instructions

DESCRIPTION OF SYMBOLS

Symbols are used in this manual to attract your attention to possible risks. The safety symbols and the explications which accompany them must be perfectly understood. The warning themselves do not prevent the risks and cannot be a substitute for proper methods of avoiding accidents.



Read operator's manual, and follow all warning and safety instructions.
Before any use, refer to the corresponding paragraph in the present manual.



Complies with relevant European regulations.



These symbols indicate the requirement of wearing eye protection, ear protection and gloves when using the product.



Wear slip-resistant footwear when using the device.



Wear head protection, where there is a risk of falling objects.



Do not expose to rain.



Remove battery before adjusting or cleaning, and before leaving the machine unattended for any period.

Original Instructions



Beware of blade thrust.



Danger of injury! Pay attention to objects being blown away. Keep others at a distance.



Keep other people out of working area during operation. The distance between the machine and bystanders should be at least 15 meters.



Fire hazard! The fuel is flammable and therefore may not be spilled. Do not work next to open flames. Do not smoke. Only refill fuel when the motor is cool and is not running.



Noise output level LWA



The crossed-out wheeled bin symbol indicates that the item should be disposed of separately from household waste. The item should be handed in for recycling in accordance with local environmental regulations for waste disposal.

By separating a marked item from household waste, you will help reduce the volume of waste sent to incinerators or land-fill and minimize any potential negative impact on human health and the environment.

Original Instructions

On battery



Do not expose the battery to water.



Do not expose the battery to fire or incinerate.



Do not expose the battery to high temperatures (above 40° C).

On charger



Class II machine – Double insulation – You don't need any earthed plug.



Use this device indoors only.

GENERAL SAFETY WARNINGS



WARNING. Read all safety warnings and all instructions. Failure to follow the warnings and instructions may result in electric shock, fire and/or serious injury.

Save all warnings and instructions for future reference.

The term "power tool" in the warnings refers to your mains-operated (corded) power tool or battery-operated (cordless) power tool.

This appliance can be used by children aged from 8 years and above and persons with reduced physical, sensory or mental capabilities or lack of experience and knowledge if they have been given supervision or instruction concerning use of the appliance in a safe way and understand the hazards involved. Children shall not play with the appliance. Cleaning and user maintenance shall not be made by children without supervision.

1 - Work area safety

- a) **Keep work area clean and well lit.** Cluttered or dark areas invite accidents.
- b) **Do not operate power tools in explosive atmospheres, such as in the presence of flammable liquids, gases or dust.** Power tools create sparks which may ignite the dust or fumes.
- c) **Keep children and bystanders away while operating a power tool.** Distractions can cause you to lose control.

2 - Electrical safety

- a) **The electric tool plugs must match the outlet. Never modify the plug in any way. Do not use adapters with earthed (grounded) tools.** Unmodified plugs and matching outlets will reduce the risk of electric shock.
- b) **Avoid any body contact with earthed or grounded surfaces, such as pipes, radiators, ranges and refrigerators.** There is an increased risk of electric shock if your body is earthed or grounded.
- c) **Do not expose tools to rain or wet conditions.** Water entering a tool will increase the risk of electrical shock.
- d) **Do not abuse the cord. Never use the cord for carrying, pulling or unplugging the power tool. Keep cord away from heat, oil, sharp edges or moving parts.** Damaged or entangled cords increase the risk of electric shock.
- e) **When operating a power tool outdoors, use an extension cord suitable for outdoor use.** Use of a cord suitable for outdoor use reduces the risk of electric shock.
- f) **If operating a power tool in a damp location is unavoidable, use a residual current device (RCD) protected supply.** Use of an RCD reduces the risk of electric shock.

3 - Personal safety

- a) **Stay alert, watch what you are doing and use common sense when operating a power tool. Do not use a power tool while you are tired or under the influence**

Original Instructions

of drugs, alcohol or medication. A moment of inattention while operating power tools may result in serious personal injury.

b) **Use personal protective equipment. Always wear eye protection.** Protective equipment such as dust mask, non-skid safety shoes, hard hat, or hearing protection used for appropriate conditions will reduce personal injuries.

c) **Prevent unintentional starting. Ensure the switch is in the off-position before connecting to power source and/or battery pack, picking up or carrying the tool.** Carrying power tools with your finger on the switch or energizing power tools that have the switch on invites accidents.

d) **Remove any adjusting key or wrench before turning the power tool on.** A wrench or a key left attached to a rotating part of the power tool may result in personal injury.

e) **Do not overreach. Keep proper footing and balance at all times.** This enables better control of the power tool in unexpected situations.

f) **Dress properly. Do not wear loose clothing or jewellery. Keep your hair, clothing and gloves away from moving parts.** Loose clothes, jewellery or long hair can be caught in moving parts.

g) **If devices are provided for the connection of dust extraction and collection facilities, ensure these are connected and properly used.** Use of dust collection can reduce dust-related hazards.

4 - Power tool use and care

a) **Do not force the power tool. Use the correct power tool for your application.** The correct power tool will do the job better and safer at the rate for which it was designed.

b) **Do not use the power tool if the switch does not turn it on and off.** Any power tool that cannot be controlled with the switch is dangerous and must be repaired.

c) **Disconnect the plug from the power source and/or the battery pack from the power tool before making any adjustments, changing accessories, or storing power tools.** Such preventive safety measures reduce the risk of starting the power tool accidentally.

d) **Store idle power tools out of the reach of children and do not allow persons unfamiliar with the power tool or these instructions to operate the power tool.** Power tools are dangerous in the hands of untrained users.

e) **Maintain power tools. Check for misalignment or binding of moving parts, breakage of parts and any other condition that may affect the power tool's operation. If damaged, have the power tool repaired before use.** Many accidents are caused by poorly maintained power tools.

f) **Keep cutting tools sharp and clean.** Properly maintained cutting tools with sharp cutting edges are less likely to bind and are easier to control.

g) **Use the power tool, accessories and tool bits etc. in accordance with these instructions, taking into account the working conditions and the work to be performed.** Use of the power tool for operations different from those intended could

Original Instructions

result in a hazardous situation.

5 - Service

- a) **Have your power tool serviced by a qualified repair person using only identical replacement parts.** This will ensure that the safety of the power tool is maintained.
- b) If the supply cord is damaged, it must be replaced by the manufacturer, its service agent or similarly qualified persons in order to avoid a hazard.

SAFETY WARNINGS FOR BRUSH CUTTER

- Use this brush cutter only for the purposes it was designed, do not aim the brush cutter at any people or animals.
- Remove the battery during transportation and during storage.
- Store brush cutters indoors – when not in use, brush cutter should be stored indoors in dry, locked-up place – out of reach of children.
- Keep all parts of the body away from the trimmings spool. Make sure the switch is off when clearing jammed material. A moment of inattention while operating the brush cutter may result in serious personal injury.
- Always inspect the tool before use, and after any impact, check for sign of wear or damage and repair as necessary, especially the parts of the cutting head.
- Carry the brush cutter by the handle with the trimming spool stopped. Proper handling of the brush cutter will reduce possible personal injury from the trimming spool.

Hold the power tool by insulated gripping surfaces only, because the cutter blade may contact hidden wiring. Cutter blades contacting a "live" wire may make exposed metal parts of the power tool "live" and could give the operator an electric shock.

- Hold the brush cutter properly, e.g. with both hands. Loss of control can cause personal injury.
- Keep hands and feet away from the cutting device at all times and especially when switching the product on.
- Always be sure of a safe and secure operating position, whilst using the product.
- Never use the product standing on steps or a ladder. Do not work over shoulder height.
- Always ensure the safety guard supplied is fitted before using the product. Never attempt to use an incomplete product or one fitted with an unauthorized modification.
- Check the trimming spool regularly for damage, and if damaged repair immediately.
- Switch the product off when the trimming spool is blocked. Remove the battery pack and remove the blockage. Inspect the spool for damage before using the product again.

SAFETY WARNINGS FOR GRASS TRIMMER

- The grass trimmer must not be used by anyone under the age of 16.
- Always check the good working order of the trimmer which, if not adequate, could endanger the user.

Original Instructions

- Do not use the trimmer if the cutting device is not secured properly or is damaged.
- Before starting the trimmer, make sure that the nylon line is not touching stones or debris.
- Always wear suitable clothing when using the trimmer to prevent head, hand or feet injuries.
- When the trimmer is in operation, keep the cutting section away from all parts of the body.
- Do not start the trimmer when it is upside down or when not in working position.
- Do not let other people or animals come within 5 meters of the trimmer when in use.
- Remain in a stable and secure position while operating the trimmer.
- Do not cut against hard objects. This could cause injury or damage the trimmer.
- Use the edge of the guard to keep the trimmer away from walls, surfaces, miscellaneous things and delicate objects.
- Never use the trimmer without the guard.

CAUTION! The guard is vital for your and other peoples' safety and for the good working order of the trimmer. The failure to observe these safety regulations are not only dangerous but also annuls the guarantee terms.

- Be careful of the line-cutting blade, which can give deep cuts.
- Do not try to stop the cutting device (nylon line) with your hands. Always let it come to a stop by itself.
- **CAUTION!** After switching off, the nylon line will continue to rotate for a few more seconds.
- Only use the original type of nylon line. Under no circumstances use metal wire instead of nylon.
- Do not use the trimmer to cut grass that is not in contact with the ground; for example, do not cut grass that is not walls or rocks etc.
- Do not switch the grass trimmer on in enclosed or poorly ventilated spaces or in the presence of inflammable and/or explosive substances such as liquids, gas and powders.
- The user of the grass trimmer is responsible for any damage sustained by third parties that has been caused by the grass trimmer within the working area.
- Do not cross roads or gravel paths with the trimmer still running.
- The trimmer should be used in compliance with these instructions and only in a position that is vertical in relation to the ground. Any other position is dangerous.
- Check regularly that the screws are properly secured.

INTENDED USE

This device is designed for cutting grass and soft vegetation alike and for trimming grass edges in private garden areas which are not accessible with a lawnmower.

The device is used for cutting and trimming hedges and bushes.

It should never be used with the cutting means rotating vertically.

Original Instructions

Its cutting plane should always be approximately parallel to the ground. If it is not used in this way, the possibility of injury to persons and property by thrown objects significantly increased.

The device is not allowed to be used in public gardens, parks, sports centers or at roadsides as well as in agriculture and forestry.

The national regulation can restrict the use of the machine.

It is not permitted to use this unit for any other purposes.

The user is liable for all injuries to third parties and damage to their property.

Operate the unit only in the technical condition as stipulated and delivered by the manufacturer.

Arbitrary changes to the unit will exclude the manufacturer from any liability for resulting injury and/or damage.

Improper use

Any use not identified in the chapter "Intended use" is an improper use. Please note that our equipment has not been designed for use in commercial, trade or industrial applications. Our warranty will be voided if the equipment is used in commercial, trade or industrial businesses or for equivalent purposes.

Residual risks:

Also when appropriate using the tool; it always remains a certain residual risk which cannot be excluded. From the kind and construction of the tool the following potential endanger can be derived:

- Damage of the ears, if no prescribed protection of the ears is carried
- Vibration. Warning: The actual existing vibration value during use of the machine can deviate from the manual or the manufacturer specified. This can be caused by the following factors, before or during each of use should be considered:
 - If the machine is used correctly
 - If the method of cutting the material and how it is processed correctly.
 - The use of the machine state is in the regulatory
 - Sharpness condition of cutting tool or cutting tool real

DESCRIPTION OF PARTS

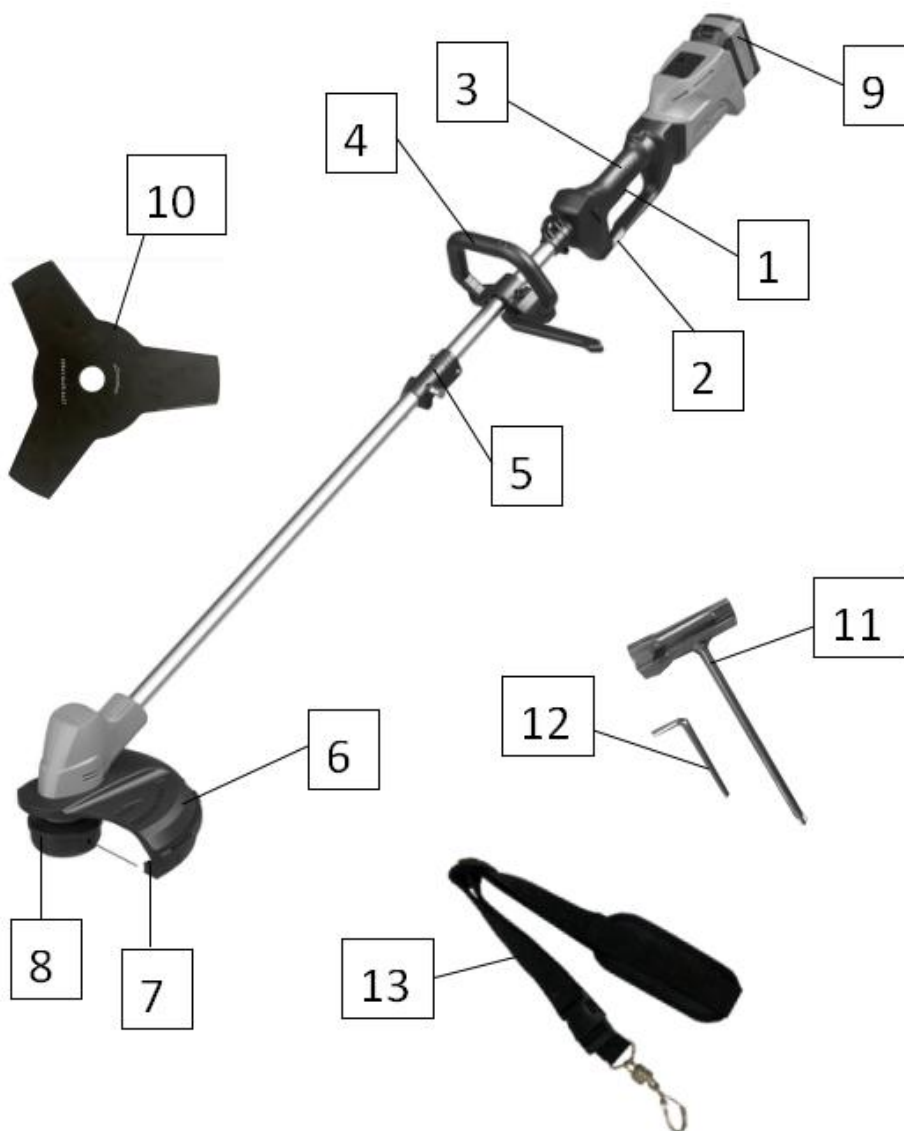

1 On/off switch	2 Lock-off button
3 Main handle	4 Front handle
5 Shaft coupler	6 Protection guard
7 Line cutter	8 Trimmer head
9 Battery pack(excluded)	10 Blade
11 Socket key	12 Hex wrench
13 Shoulder belt	

TECHNICAL DATA

Type:	GT-B0118
No load speed	trimmer: 6500rpm cutter: 7500rpm
Max cutting length	trimmer:300mm cutter:255mm
Line	ø2.0mm*5m
Vibration:	5.8 m/s ² (Main handle), K=1.5 m/s ² 1.8 m/s ² (Adjustable handle), K=1.5 m/s ²
Sound emission level (L _{pA}) :	84 dB(A) K=3.0 dB(A)
Guaranteed sound power level (L _{wA}):	96 dB(A) K=3.0 dB(A)
Battery and Charger	
Recommended battery	BA-1850B,Li-ion 18V d.c. 5.0Ah
Recommended charger	Model : CH-1802A Input : 100-240V~ 50Hz 60W Output : 20V DC 2.3A Charging time : 140MIN
	Model :CH-1802B Input : 100-240V~ 50Hz 125W Output : 20VDC, 5A Charging time : 70 MIN
	Model :CH-1802D Input : 100-240V~ 50Hz 130W Output : 20VDC, 2.3AX2, USB×2, 5VDC MAX 2A Charging time : 140MIN

CHARGING PROCEDURE

Battery charger (Fig.1)

The lithium-ion battery can be charged at any time and will not develop a “memory” when charged after only a partial discharge. It is not necessary to run down the battery pack charge before recharging. Remove the battery pack from the tool when convenient for you and your job. You can “top-off” your battery pack’s charge before starting a big job or long period of use.

Due to lithium-ion’s fade-free properties, the only time it is necessary to charge the lithium-ion battery pack is when the pack has reached the end of its charge. To signal

Original Instructions

the end of charge, power to the tool will drop quickly. Charge the battery pack as needed.

Fig.1



a. Charging the battery

This lithium-ion battery pack is shipped partially charged. Before using it the first time, fully charge the battery pack. A fully discharged battery pack with a temperature between 5°C and 35°C will charge in about 70-140MIN(See section"Specifications").

CH-1802A:

- Plug the charger adapter into power source. The green light on the charger stand will illuminate, indicating the charger is powered.
- Slide the battery all the way into the charger stand until it locks in place with a click. The red light on the charger stand will illuminate, indicating that the battery is charging.
- The red light will go off after charging is complete and a green light will appear.

CH-1802B/CH-1802D:

See the manual of CH-1802B/CH-1802D

NOTE: Batteries may become warm while charging. This is normal. If the battery is hot after continuous use in the tool, allow it to cool down to room temperature before charging. This will extend the life of your batteries.

WARNING: Always disconnect the battery pack from the tool before any assembly, adjustments or changing accessories.

a. Insertion and removal of rechargeable battery (Fig. 2)

Depress the battery-release button located on the front of the battery pack to release battery pack.

Pull the battery pack out and remove it from the tool.



Fig.2

Warning!

Always remove the battery pack before making adjustments to the equipment.

Be sure to read the following information before you put the cordless equipment into operation:

- Charge the battery pack with the charger. An empty battery pack requires a charging period of approximately 0.5 to 1 hour.

Products assembly

This product requires assembly.

Carefully remove the product and any accessories from the box. Make sure that all items listed in the packing list are included.

 **WARNING:** Do not use this product if any parts on the packing list are already assembled to your product when you unpack it. Parts on this list are not assembled to the product by the manufacturer and require customer installation. Use of a product that may have been improperly assembled could result in serious personal injury. Inspect the product carefully to make sure no breakage or damage occurred during shipping.

Do not discard the packing material until you have carefully inspected and satisfactorily operated the product.

 **WARNING:** If any parts are damaged or missing do not operate this product until the parts are replaced. Using a product with damaged or missing parts could result in serious personal injury.

 **WARNING:** Do not attempt to modify this product or create accessories not recommended for use with this product. Any such alteration or modification is misuse and could result in a hazardous condition leading to possible serious personal injury.



 **WARNING:** To prevent accidental starting that could cause serious personal injury, always remove the battery pack from the product when assembling parts.

ATTACHING PROTECTION GUARD

Fit the correct trimmer guard for use with the motor, then tighten screws so that the guard assembly cannot move.



REPLACE THE METAL BLADE TO SPOOL

-  CAUTION: NEVER use unit if blade is warped or has teeth that are chipped or missing. Replace a damaged blade immediately.
-  CAUTION: Always wear heavy-duty work gloves when handling and installing a blade.

METAL BLADE:

Turn the tool upside down so that you can replace the cutter blade easily.

To dismount the cutter blade, insert the hex wrench through the hole on the protector cover and receive washer. rotate the receive washer until it is locked with the hex wrench. Loosen the hex nut (left-hand thread) with the hex socket wrench and remove the nut, cup, clamp washer and hex wrench.

Mount the cutter blade onto the shaft so that the guide of the receive washer fits in the arbor hole in the cutter blade. Install the clamp washer, cup, and secure the cutter blade with the hex nut of tightening torque during holding the receive washer with hex wrench. Then tighten the one nut by clockwise rotate.

Steps as the below pictures.



Fig.a



Fig.b



Fig.c



Fig.d



Fig.e



Fig.f



Fig.g

GRASS TRIMMER ASSEMBLY(WITH NYLON LINE)

Convert from brush cutter to grass trimmer:

- Fit the Wing grange into the trimmer head, align the protrusion on the underside of the cover with the slots of the eyelets.
- Then put the Inner flange on the shaft, screw on the spool anticlockwise. .

If the line is too long when you use the equipment for the first time, the surplus end of it will be cut by the blade on the guard hood.

Steps as the below pictures.



Fig.a



Fig. b



Fig.c



Fig.d

Original Instructions

LOOP HANDLE ASSEMBLY

ATTACHING THE FRONT HANDLE

1. Take off the screw on the front handle(4).



2. Place the front handle (4) on the drive tube, adjust the handle to an angle that provides a comfortable working position.



3. Tighten screw so that the handle assembly cannot move.

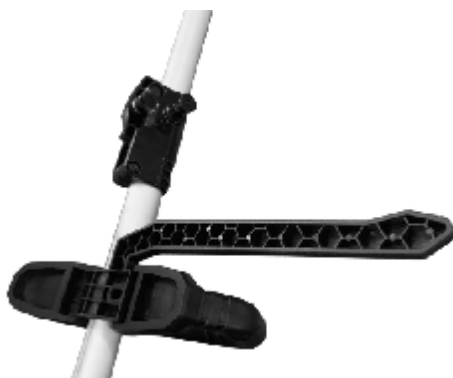

Original Instructions

Shaft assembly

Pull out the knob and push the drive axle into the connector by gently turning it back and forth. The locking knob must engage fully into its hole.

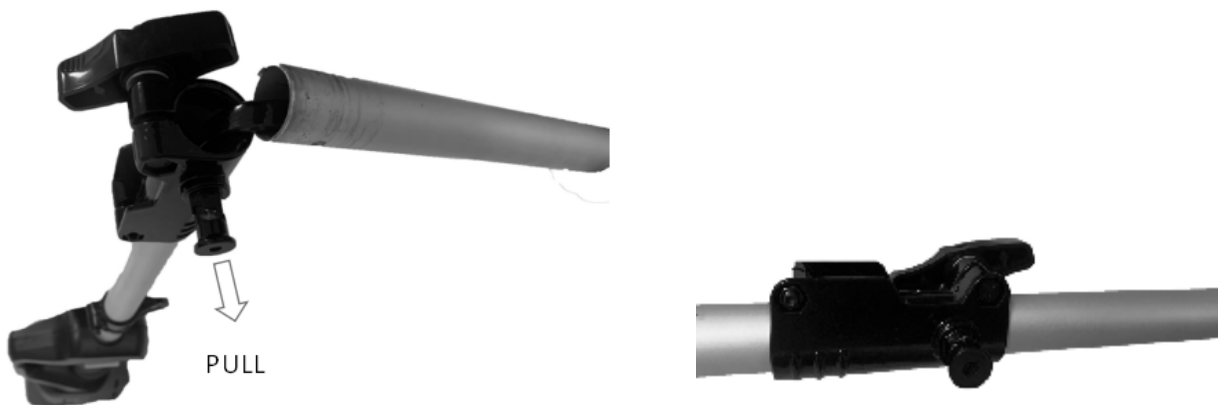

OPERATION

Use as grass trimmer and brush cutter

Before starting

Please always read the instruction manual carefully and check the machine before operating. **WARNING!**

1. Ensure the switch is in the off position and disconnect the battery from the tool.
2. Examine the general condition of the tool. Inspect the guard, switch, cord, check for loose screws, improper mounting, broken parts and any other condition that may affect its safe operation. If abnormal noise or vibration occurs during operation, turn the tool off immediately and have the problem corrected by a qualified repair person.
3. Ensure that you are on a flat surface and have secure footing.
4. Check that the line touches or goes beyond the edge of the guard.
5. Check the cutting attachment, never use blades that are dull, cracked or damaged.
6. Wear the shoulder belt so that it lies on the one side of shoulder as shown in below left pic. It can be removed quickly from your body in case of danger. Never attach the shoulder belt diagonally across your chest. (below right pic.)

Original Instructions



Caution! In an emergency, stop the machine by releasing the on/off switch.

Working with the grass trimmer and brush cutter

Important:

- Always use the shoulder belt when working with the machine.
- Always switch off the machine before you take off the shoulder belt.

Note: Keep a firm grip with both hands during operation.

1. Make sure the cutting means cannot come into contact with any object and your body.
2. Press the on/off switch, and then press the lock button, while activating trigger, then press the trigger to start the machine with normal speed, release the lock bottom the machine would keep running with with normal speed. If you want to operate with high speed, press the high speed bottom and then it would run with high speed.

Note: To stop the machine, simply release the trigger.



Stop the machine

1. To switch off, simply release the trigger and then press ON/OFF switch.
2. The machine stops completely after a few seconds.
3. Discount the battery from the tool for safety.

Note: The machine would automatically switch off if it is not work for more than 1min. Never touch the cutting head when it is still rotary.

Original Instructions

Trimming tips when using grass trimmer

- Inspect and clear the area to be trimmed for any rocks, broken glass or wire that could be thrown or become entangled in the cutting line. Trim only when grass or weeds are dry. Keep the cutting line parallel to the ground.
- Cut grass or weeds over 20cm tall from the top to the bottom in small amounts. This will prevent grass becoming wrapped around the trimmer head assembly, which may result in damage . If grass becomes wrapped around the trimmer head assembly, stop the machine, remove the battery and wait to the line standstill and remove the grass.
- Move the machine slowly in and out of the area you are cutting, keeping the trimmer at the desired cutting height. Use the tip of the line to do the cutting. Do not force the trimmer head assembly into uncut grass.
- Feed out some line after each use to prevent the line from retracting into the spool.
- The tip of the cutting line will wear during use. This reduces the cutting swath. If the line is not fed occasionally, it will wear down to the eyelet. When the trimmer stops, the line tends to relax and may retract into the spool. Should this occur, unplug the trimmer, remove the spool, refeed the line through the eyelets and reassemble the spool.
- Avoid hitting objects with the line, such as chain-link fences or concrete, as this causes rapid wear.
- Never drag the trimmer head assembly on the ground while trimming.
- When operating the grass trimmer (especially after changing the spool of line) for the first time, ensure to test the assembly by running the grass trimmer in a safe location, the line may not be fully extended, so you may need to “bump” the head at full speed on the ground to extend the line to the correct length.

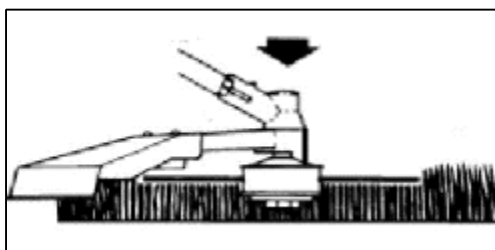

Note: To extend cutting line when you bump the cutting head on the ground, the machine must be operated close to full speed.

A spring-loaded button on the spool holder is depressed when the trimmer is “bumped” and this releases line due to the inertial force of the spinning spool. If too much line is fed out, it will project beyond the guard edge. It is cut by the blade in the guard, it is only necessary to replace line that is broken during use. Do not “bump” too excess as it wastes line. It takes a little practice and experience to judge when to “bump”.

Note: Do not cut damp or wet grass. Dry grass will give excellent results.

Original Instructions

Note: Always let the grass trimmer rotate at top speed. Do not work in such a way as to overload the trimmer.

Warning: Never pass the machine over the extension cable while the machine is running, make sure it is always in a safe position behind your back.

Do not use this machine without guard.

Replace the spool

1. Push the two buttons on the trimmer head and turn the top cover, put the spool in the trimmer head. Then put the top cover.

The steps as the below pictures.



Fig.a



Fig. b



Fig.c



Fig.d

Cutting tips when using brush cutter

-Brush cutter should be held at a comfortable position with the on/off handle about hip height. Maintain your grip and balance on both feet. Position yourself so that you will not be drawn off balance by the kick-back reaction of the cutting blade.

-Adjust the shoulder belt to position the brush cutter at a comfortable operating position and to ensure that the shoulder belt will reduce the risk of operator contact with the blade.

-Exercise extreme caution when using the blade with this machine. Blade thrust is the reaction which may occur when the spinning blade contacts anything it cannot

Original Instructions

cut. This contact may cause the blade to stop for an instant, and suddenly “thrust” the unit away from the object that was hit. This reaction can be violent enough to cause the operator to lose control of the unit. Blade thrust may occur without warning if the blade snags, stalls or binds. This is more likely to occur in areas where it is difficult to see the material being cut.

-For cutting ease and safety, approach the weeds being cut from the right to the left. In the event that an unexpected object or woody stock is encountered, this could minimize the blade thrust reaction.

-The blade is suited only for pulpy weeds and vines. When the blade becomes dull, it can be turned over to extend the life of the blade. Do not sharpen the blade.

Warning! Extreme care must be taken when using blades to ensure safe operation.

-Always hold brush cutter with both hands when operating. Use a firm grip on both handles.

-Maintain your grip and balance on both feet. Position yourself so that you will not be drawn off balance by the kick-back reaction of the cutting blade.

-Inspect and clear the area of any hidden objects such as glass, stones, concrete, fencing, wire, wood, metal, etc.

-Never use a blade after hitting a hard object without first inspecting it for damage. Do not use if any damage is detected.

-The unit is used as a scythe, cutting from the right to the left in a broad sweeping action from side to side.

Maintenance

There are no other parts inside the equipment which require maintenance. Please note some parts of this product are subject to normal or natural wear and that the following parts are therefore also required for use as consumables.

Storage

- Store the device in a dry and frost-free (5-40 °C) place.
- Store the battery and the device separately from each other.
- Charge the battery before storing it for the winter.
- Keep the device, and its plastic components in particular, always from brake fluid, petrol, products containing oil, penetrating oil etc. They contain chemical substances that may damage or destroy the plastic parts of the device.
- Fertilisers and other garden chemicals contain substances which can have a heavily corrosive effect on metal parts. Do not store the device close to these substances.

Disposal



Electronic devices are recyclable waste and must not be disposed of in the household waste. At the end of its service life, dispose of the product according to the relevant statutory regulations.

Exceltools.co.uk
Sales@exceltools.co.uk