

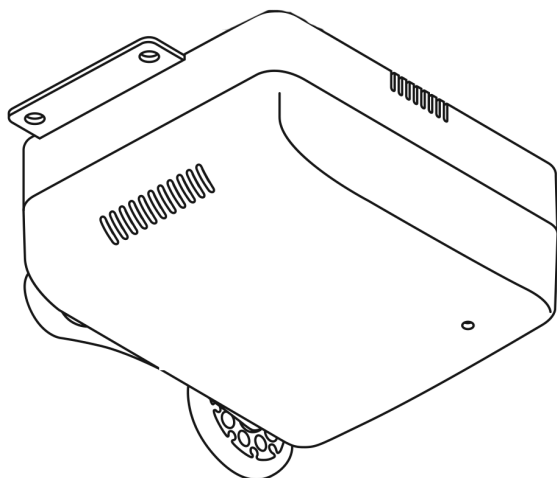

Scan this code or
visit www.mindr.com/setup
to view video installation
instructions



quickstart guide



Technical Specifications

Device

Size: 4.35" x 4.6" x 1.65"

Weight: 1 lb. 3.4 oz (550 g)

Power Source: x2 9v Energizer
Max Alkaline 522 VP (Included)

Alarm: 75 db SPL at 10 feet (3
meters)

Lights: 6 LED array, 1 RGB status
LED

Illumination: 12 Lux at 36"

Sensor: Vesper VM1010
Piezoelectric MEMS microphone
with proprietary listening
algorithm

Operating Conditions

Temperature: 32° to 104°F (0° to 40°C)

Humidity: Up to 90% RH unpackaged

Pressure: Up to 10,000 ft altitude

Compatibility

Door Requirements: Free swinging door
with normal hinges (not spring hinges or
'slow close') able to latch without making
contact with flooring or jamb.

Maximum Door Weight: 70 lbs.

Compatible Alarms: Most UL217 listed
smoke alarms manufactured after 1996
that emit a T3 tone. Smoke alarm must be
installed in the same room and within 6'
of **Mindr™**.

**Unit not to be installed on a fire rated
door.**

Device Status Guide

Normal State	Intermittent green LED flashes
Low Battery	Status LED flashes red when device wakes up and at the end of the cycle
Critical Battery	Red LED flashes and device chirps every 34 seconds. Device is inoperable
Alarm Response	LED status light flashes red, arm extends, main white LED array flashes, 3 tone pulsed buzzer sounds

In the Box

Thank you for choosing Mindr™.

Before you begin your installation,
please confirm that your package
contains all the following pieces:

- (1) Mindr™ Unit
- (1) Quick Start Guide
- (2) 3/4" Installation Screws
- (2) 9v Energizer Max Alkaline Batteries

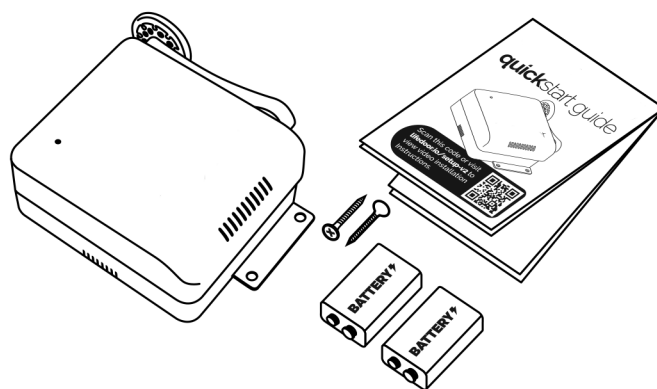

Preparation

1

NOTICE: This unit is to be installed in a room occupied for sleeping

1. Confirm Placement: Your Mindr™ unit should be
installed on the inswing side of the door - this is the
side where the hinges are exposed.

Align the Mindr™ unit with the top hinge of your door.
The moveable arm should be placed so it is either
above or below the hinge, as shown in the illustration.

Hinges on Left

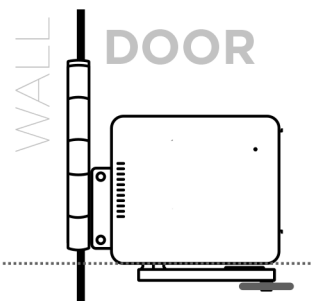

Hinges on Right

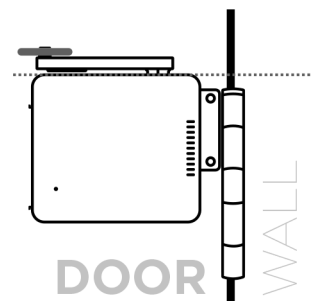

Recommended Install 2

Requires a #2 Phillips Head Screwdriver

1. Remove the battery tray from your Mindr™ unit.
2. Remove protective film from the double-sided adhesive on the back of your Mindr™ unit.
3. Carefully place the unit on the door by nesting the metal tab into the hinge and rotating the device towards the door, as shown in the illustration.
4. Hold firm pressure for at least 60 seconds.
5. Using a screwdriver or power drill, insert the 2 wood screws through the holes in the metal tab and tighten them into the door.
6. Install the (2) included 9v batteries into the battery tray and insert it into your Mindr™ unit until it clicks into place. Your Mindr™ unit will power on automatically, as indicated by a green LED flash every 30 seconds.
7. Unit not to be installed on a fire rated door.

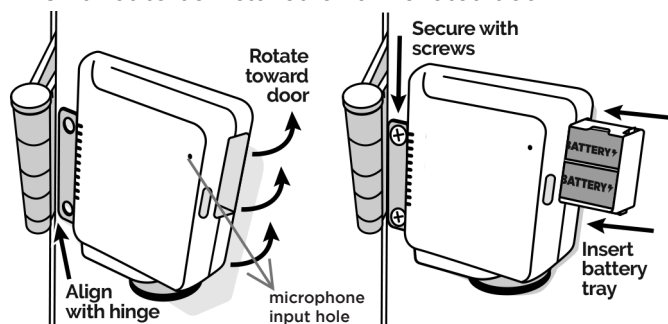

©2020 Shop Masonite, LLC

Effective 11/20

PN LB023-02

Testing 3



NOTICE: Smoke alarms are LOUD. To avoid potential hearing loss, always wear hearing protection when testing your Mindr™ units.

1. Ensure all doors equipped with Mindr™ unit are fully opened and free of obstructions.
2. Activate the smoke detector in the same room as Mindr™ using the manufacturer's recommended directions for testing. *If you are unsure how to test your smoke alarm, please refer to the manufacturer's instructions.*
3. Your Mindr™ unit should activate within 75 seconds. If unit doesn't activate, please refer to www.mymindr.com/faq.
4. Your Mindr™ unit will automatically reset after 40 seconds, if smoke alarms are not alarming.
Manual Activation: Press button on the side of the Mindr™ unit and release after 3 seconds. The device will chirp twice and flash the main LED, then activate the arm to close the door.

Manual activation is NOT recommended for testing, as it will check that the device internals are functional but does not confirm that the listening function is working.

©2020 Shop Masonite, LLC

Effective 11/20

PN LB023-02

Service & Maintenance

Replacement Batteries: Your Mindr™ unit requires (2) 9v batteries to function. Batteries are not warranted by Shop Masonite LLC. Battery life may vary.
NOTE: Always replace with 2 new, unexpired batteries. Always test device after replacing batteries.

Suitable battery replacement: Energizer 522VP 9V

WARNING:

Use only batteries specified. Use of other batteries will have a detrimental effect on the operation of the device and void your warranty.

Cleaning & Upkeep: Do not use a vacuum or compressed air to clean. Use a slightly damp cloth to wipe down the device annually. Do not paint device or otherwise cover the LEDs or block the microphone input hole. Deviating from installation or cleaning instructions may void your warranty.

Testing: Test weekly, follow the testing step in section 3 of this guide to ensure your Mindr™ unit is fully operational, follow the testing guide for instructions.

Warranty: See enclosed 1-year limited warranty.

©2020 Shop Masonite, LLC

Effective 11/20

PN LB023-02