

Thermal Receipt Printer

DT40P

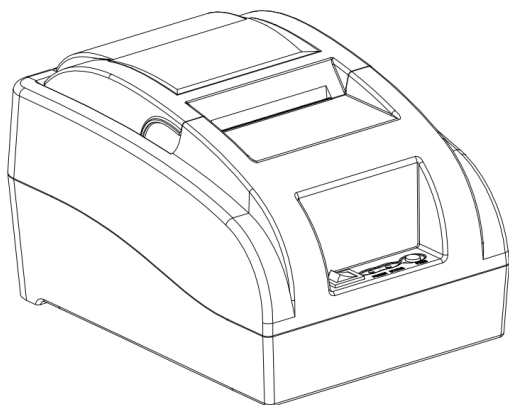

User Manual

Thank you for choosing our product. The FLASH DT40P Thermal Receipt Printer is the perfect solution for a safe, reliable and efficient printing quality at an affordable price. We recommend reading thoroughly all the information stipulated in this manual in order to make the best use of this product

PLEASE TAKE NOTICE Should the equipment be altered in any way or used in a manner for which it was not intended at the time of delivery, the supplier of the equipment accepts no responsibility for injury or damage to personnel or equipment. If the conditions for use of the equipment are changed, the supplier must be contacted or the declaration of conformity will be invalidated.

**All support provided from our North
American 24/7 Support Team
1-332-228-1098
support@deteckusa.com**

IMPORTANT SAFETY INSTRUCTIONS

WARNING

- Do not touch the Printer head right after Printing to avoid any burn
- Keep the machine away from heavy humidity and high temperature as it may prevent it from working properly.
- Do not drop conductive objects into the machine to prevent internal short circuit.
- Do not use this machine in areas where it may be exposed to water or other liquids
- Unplug this machine from the wall before opening the back cover for maintenance.
- Do not disassemble this machine as this may expose you to dangerous voltages as well as electrical shocks if wrongly re-assembled. Take it to qualified personnel for service or repair if required.

CAUTION

- When not using the machine for a prolonged period of time, please switch off the machine and disconnect the power cord
- Ensure the cable is disconnected before moving the machine otherwise the power cord may get damaged
- Do not pull the cord to unplug the power cord. Do not use the machine if the power cord is damaged or the plug socket is loose.
- Do not bend excessively the power cord as it may get damaged.
- Do not place heavy objects on the cord.

Not following these instructions may result in fire, electrical shock or damage to the machine.

SAFETY PRECAUTIONS

This product should not be exposed to:

- Shaky or vibrating surface
- High temperature including but not limited to strong sunlight, radiator heater register.
- High humidity and dust as this may damage the machine
- Water or other liquids. In case of spilled liquid into the interior of the machine, please stop operating, switch off and disconnect the power cord. Contact the service center for help
- Chemical solvents such as oil, gasoline, benzene and acidic liquids. In case of spilled liquid into the interior of the machine, please stop operating, switch off and disconnect the power cord immediately.
- Any kind of objects dropped into the machine through the case slots or openings .Especially conductive objects such as clips, pins, etc.

To ensure a long product cycle and quality of printing:

- Use the manufacturers' thermal paper (or similar).
- Use a dry cloth to clean the printer head. Do not use dissolved substances, such as: benzene, thinner or alcohol wipes
- Avoid printing in a paperless state; it will seriously damage the printing roller and thermal print head.

PACKAGE CONTENT

- Thermal Label Printer 58mm
- Power Adapter
- Paper roll
- USB-B/Serial Plug
- LAN/Serial Plug
- User Manual

PARAMETERS

Print Parameters	Print Method	Thermal Line Printer
	Print Width	48MM
	Resolution	384dots/Line (8dots/mm, 203dpi)
	Printing Speed	70mm/Second
	Interface Type	USB-B Port
	Line Spacing	3.75 mm (Can adjust by command)
	Line No.	Font A:32 character /Line - Font B:42 character/Line
	Character	Standard GB18030 simplified
	Character Size	Font A: 1.5×3.0mm (12×24Dots) Font B: 1.1×2.1mm (9×17Dots)
Print Character	Extended Character set	PC437/PC850/PC860/PC863/PC865/PC1252/PC866/PC852 etc. 50 international language in total
	Bar code	UPC-A/UPC-E/JAN13(EAN13)/JAN8(EAN8)CODE39/ITF/CODABAR/CODE93/CODE128
Paper	Type	Thermal Roll
	Width / Diameter	57.5±0.5mm; ≤60mm
	Feed Method	Easy feed (Clamshell feed)
Command	Commands	ESC/POS
Power	Power Adaptor	Input: AC 100V-240V,50-60Hz - Output: DC 12V/2A
	Cashier Drawer	Output: DC 12V/1A
Buffer	Input Buffer	32K bytes
	NV Flash	40K bytes
Product Features	Weight	1.3lb (590g)
	Dimension	7.3x5.1x4.4" (185*130*112MM)
Environment	Working	Temp: 5 ~ 45°C, Humidity: 10 ~ 80%
	Storage	Temp: -10 ~ 50°C, Humidity: 10 ~ 90% (No dew)
Reliability	Print Head Life	31 Miles / 50KM (print density≤12.5)
Software	Driver	Windows

INSTALLATION AND OPERATION

Connecting the Printer

1. Connect the power adapter cable to the printer power supply and the USB-B Port to the Printers interface

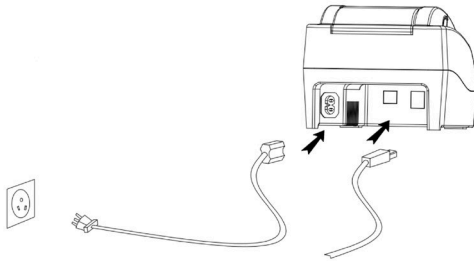

2. If your device has a Male Serial Port connection, Please use the USB-B / Female Serial Port cable. Plug the USB-B Port into the Printers interface and connect the Female Serial Plug into your device. This works with our DETECK DT800 and DT600 Money Counters
3. If your device has a Lan Port connection i.e. DETECK DT200 Money Counter, please (1) connect the Serial Port cables together as indicated in the picture below and (2) plug the USB-B Port into the Printers interface and (3) connect the LAN Plug into your device



Loading Paper

1. Open the upper cover of the printer
2. Insert the roll paper as shown in the illustration
3. Pull out a part of paper, and close the cover as show in 3 and 4
4. Press down the flip cover and tear off the paper with the cutter

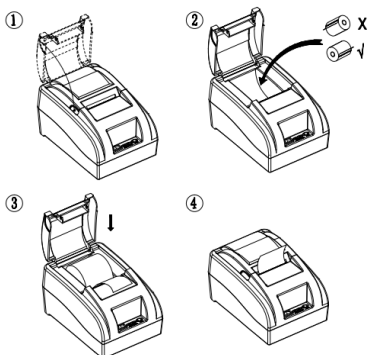

Note: take care of the roll direction, if inserted in the inverse direction, the content will not print out.

Attention

- (1) To get the best results from the printer, choose the recommended paper or other paper with equivalent quality, otherwise the printing quality will be affected and even the service life of thermal print head will be reduced.
- (2) Please do not use the paper roll that the end glued on the core of the paper roll, otherwise it may cause damage to the printer.
- (3) If the printing paper is contaminated by chemicals or oils, it may fade or reduce the sensible heat degree, and affect the printing effect.
- (4) Do not rub the surface of the printing paper with hard articles, otherwise it may cause fading.
- (5) The print paper will fade if the temperature is up to 70°C, keep it out of direct sunlight, humidity and high temperature.

Switch, Key name, Indicator and Function

1. POWER Switch

The power switch is used to turn the printer On or Off

2. (FEED) Key

Press the FEED button to advance paper or hold down to feed continuously

3. (STATUS) Green Light

If the STATUS light is off, this indicates that the printer is in normal working state.

If the STATUS light is flashing, this indicates that the printer is short of paper, print head overheating or error and other abnormal conditions.

4. (POWER) Red Light

The indicator light indicates the printer is connected to the power supply and is turned on.

5. Self-Test of Printer

Make sure the printer is power off before performing this task. Press and Hold the FEED button and then power on the printer. Release the button within 2-5seconds to print the self-test page

6. Restore Factory Settings

When the printer connected to the power adapter, press (feed) key and open the printer power at the same time, released the button after approximately 10 seconds, printer is restored to factory settings.

MAINTENANCE

1. How to clean the Printer: Use a wet cloth; gently wipe the printer surface and internal paper warehouse.

2. How to clean the Printer Core: Dip a cotton in anhydrous alcohol and gently wipe the printer core ceramic parts

3. In case of water spill, please immediately disconnect the printer power, and allow the printer to dry naturally. Do not expose to direct sunlight.

TROUBLESHOOTING

Error Phenomenon	Reason	Corrective Action
Printer Status indicator is flashing	1.Lack of paper 2.Printer head is over heating 3. Cover is not closed properly	1. Add Printing Paper 2.Open the cover to help dissipate the heat 3. Close the cover
Printer only perform a paper run, no content	Paper roll installed in the inverse direction	Install the paper roll in the opposite direction
Low Quality Print Result	The print head is dirty	Dip a cotton in anhydrous alcohol and gently wipe the printer core ceramic parts
Unable to Print	The power adaptor is not connected	Check if the power adaptor is properly connected

WARRANTY

This DETECK product is warranted to be free of defects in materials and workmanship for one (1) year after the date of purchase. Please ensure you activate your warranty by visiting our website:

<https://deteckusa.com/warranty>

If you need to contact Deteck Technical Service Center, please have the following Information with you:

- Product Model
- Order ID
- Nature of the problem
- Steps already taken to resolve the problem, and the results (if any)

All support provided from our North

American 24/7 Support Team

1-332-228-1098

support@deteckusa.com