

HALF CAGE ASSEMBLY GUIDE

VERSION: XHC-104

PART #: 5516801-D

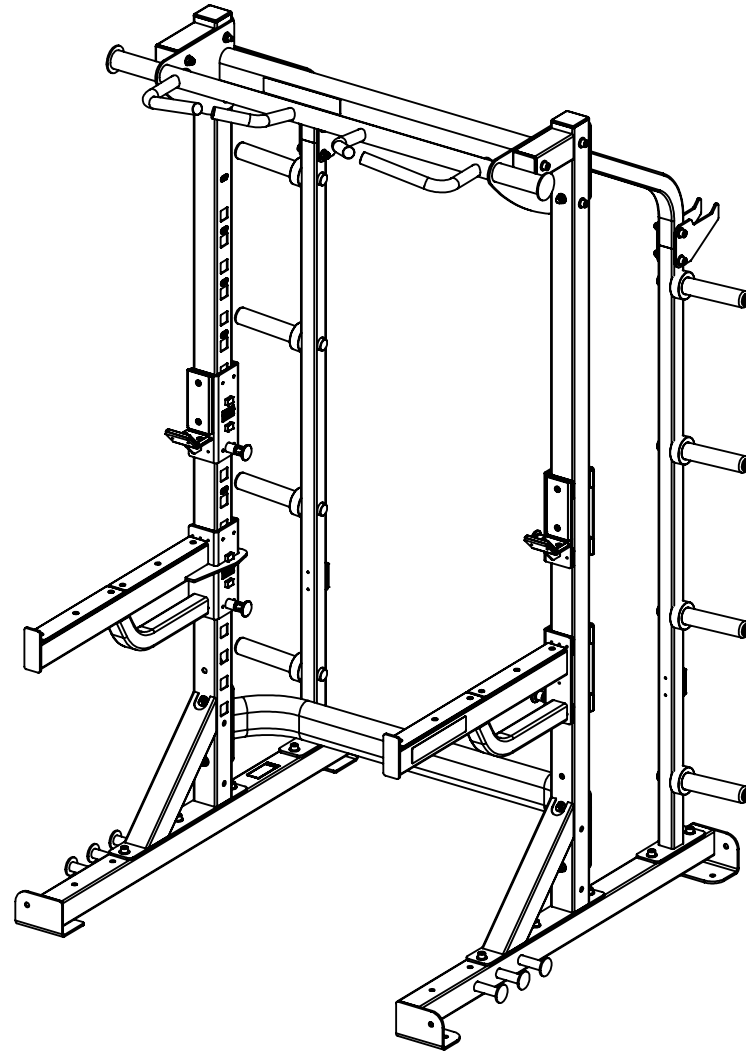

TORQUE USA

ITEM	PART NUMBER	DESCRIPTION	QTY
1	54485PA	PTD ASSY, LEFT BASE	1
2	55073PA	PTD ASSY, XHC LEFT UPRIGHT	1
3	55164PA	PTD ASSY, LEFT WEIGHT HORN UPRIGHT	1
4	2005815	BOLT, 1/2-13 X 4" (102mm) SOCKET HEAD	22
5	2001401	NUT, 1/2-13 LK ST ZN	24
6	2001301	WASHER, FLAT 1/2 SAE ST ZN	57
7	5516601	WLDMT, WEIGHT HORN UPRIGHT TOP	2
8	2006814	BOLT, 1/2-13 X 3-3/4" (95mm) SOCKET HEAD W/NP	2
9	5473101	PLATE, STORAGE HOOK CONNECTOR	4
10	2005812	BOLT, 1/2-13 X 3-1/4" (83mm) SOCKET HEAD	4
11	5449101	WLDMT, RIGHT BASE	1
12	55074PA	PTD ASSY, XHC RIGHT UPRIGHT	1
13	55958PA	PTD ASSY, RIGHT WEIGHT HORN UPRIGHT	1
14	5414601	WLDMT, LOWER CROSS SUPPORT	1
15	54493PA	PTD ASSY, CHIN-UP	1
16	2002401	NUT, 1/2 LW HT LK ST ZN	4
17	54748PA	PTD ASSY, RIGHT BAR CATCH	1
18	54745PA	PTD ASSY, LEFT BAR CATCH	1
19	54737PA	PTD ASSY, LEFT BAR SUPPORT	1
20	54742PA	PTD ASSY, RIGHT BAR SUPPORT	1
21	XRACK-6SX-101	XRACK 6' SINGLE CROSS	1
22	5597901	ASSY, GROUND ROTATIONAL TRAINER (OPTIONAL)	1
23	5598301	BUMPER, GRT STOP	1
24	5433701	SPACER, FLANGE (OPTIONAL)	1
25	2005816	BOLT, 1/2-13 X 4-1/4" (108mm) SOCKET HEAD	2

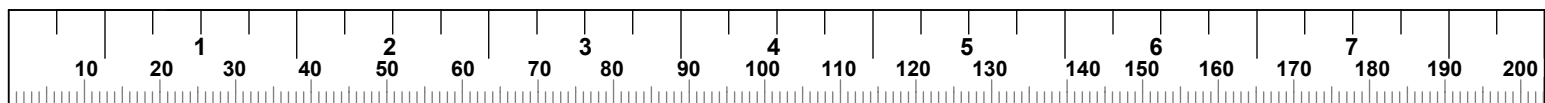

STEP 1

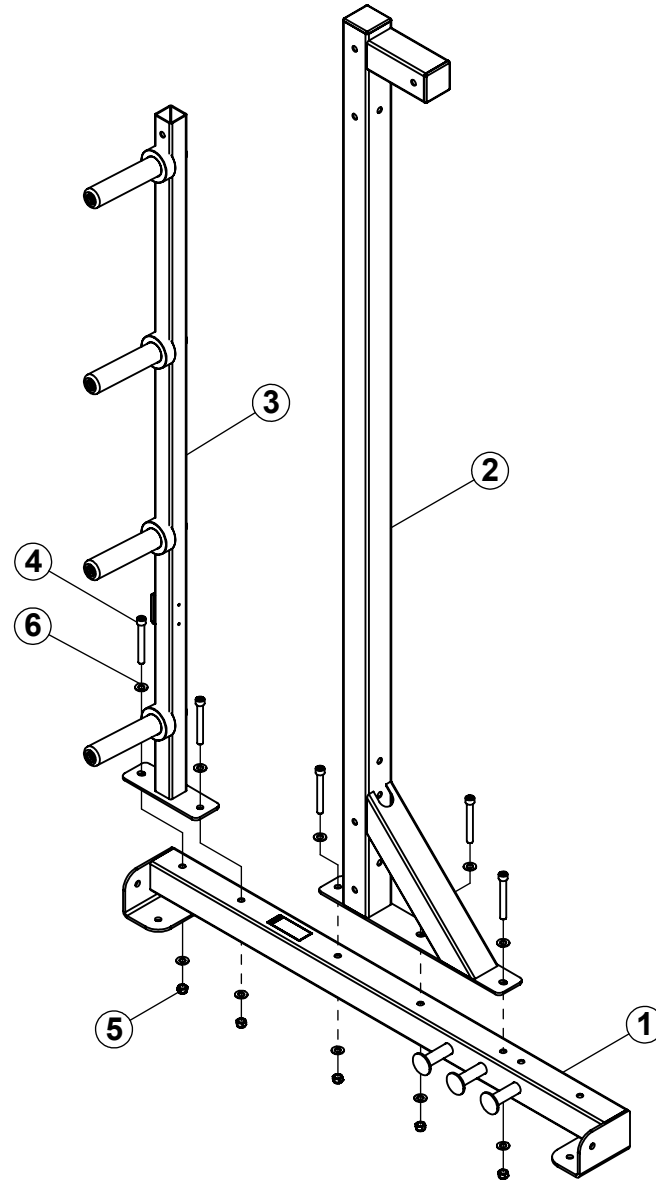

NOTE:

LOOSELY assemble bolt connections in this step.

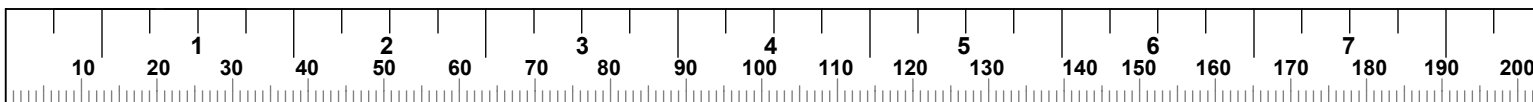

STEP 2

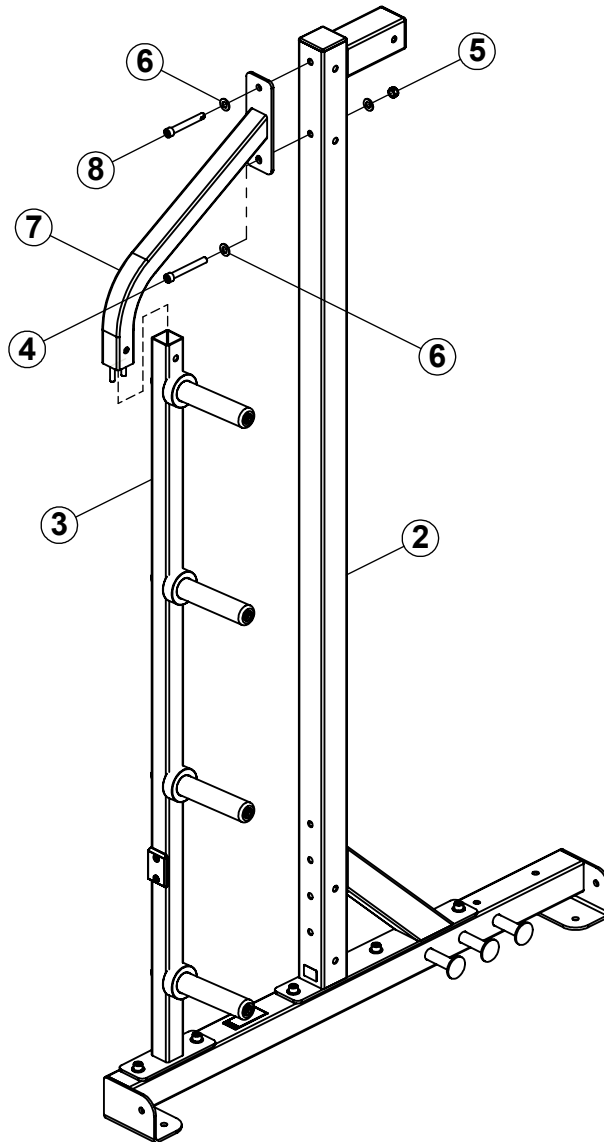

NOTE:

LOOSELY assemble bolt connections in this step.

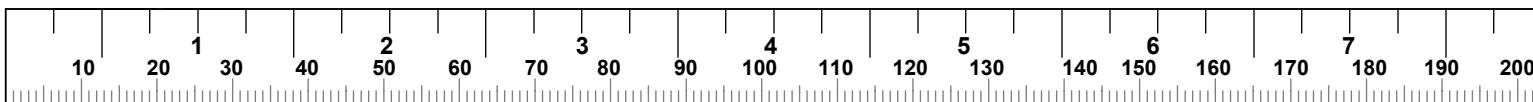

STEP 3

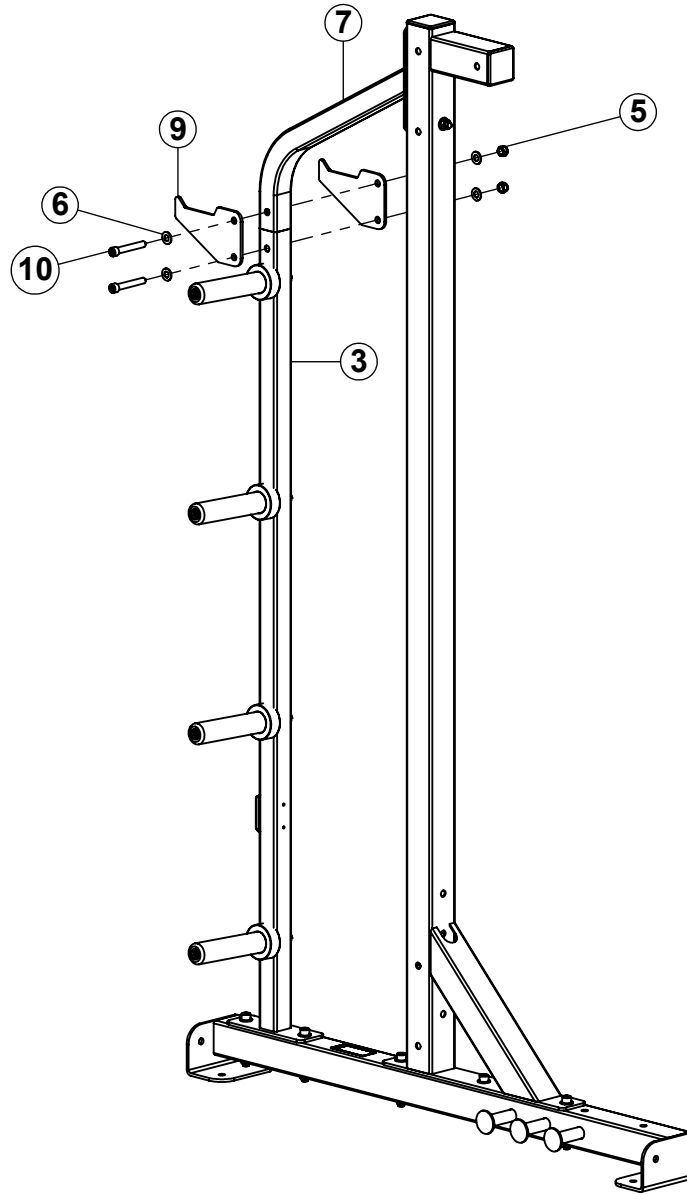

NOTE:

LOOSELY assemble bolt connections in this step.

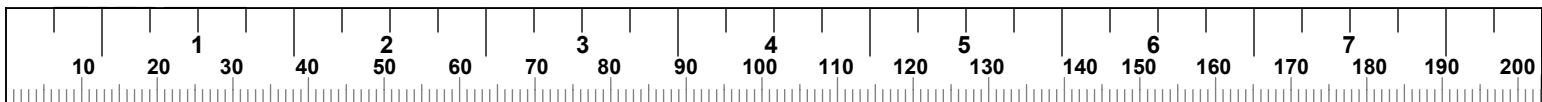

STEP 4

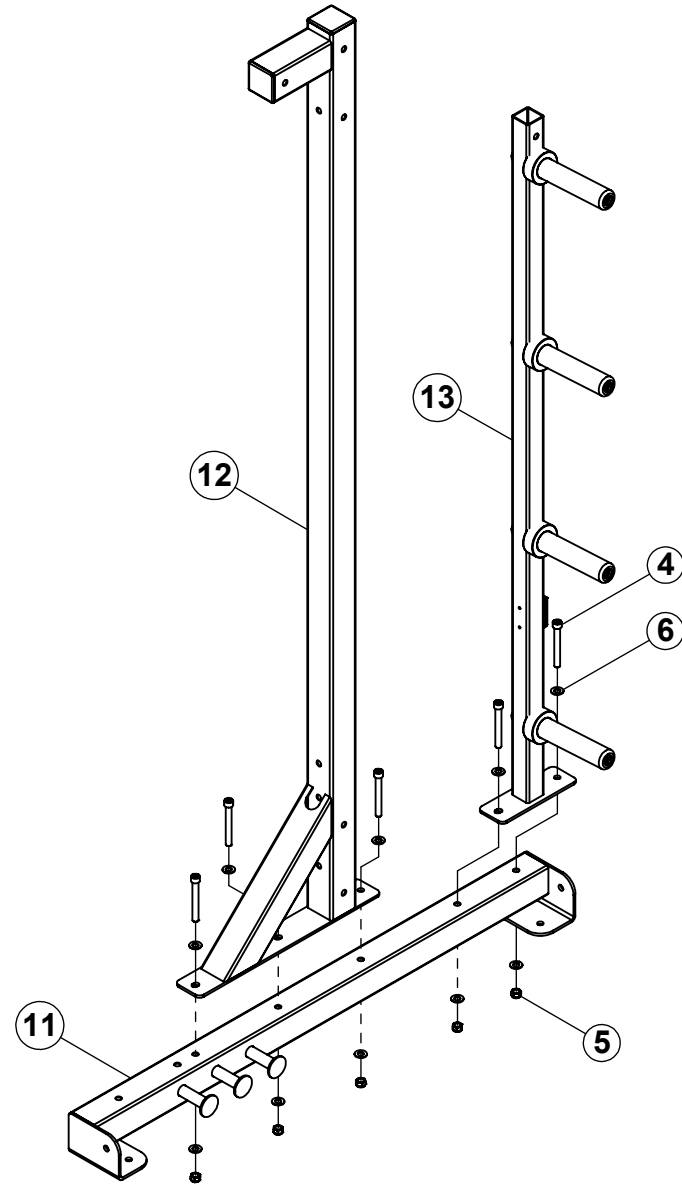

NOTE:

LOOSELY assemble bolt connections in this step.

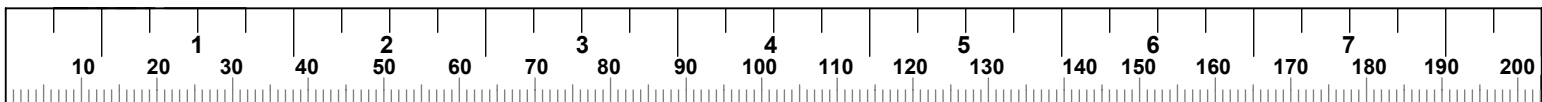

STEP 5

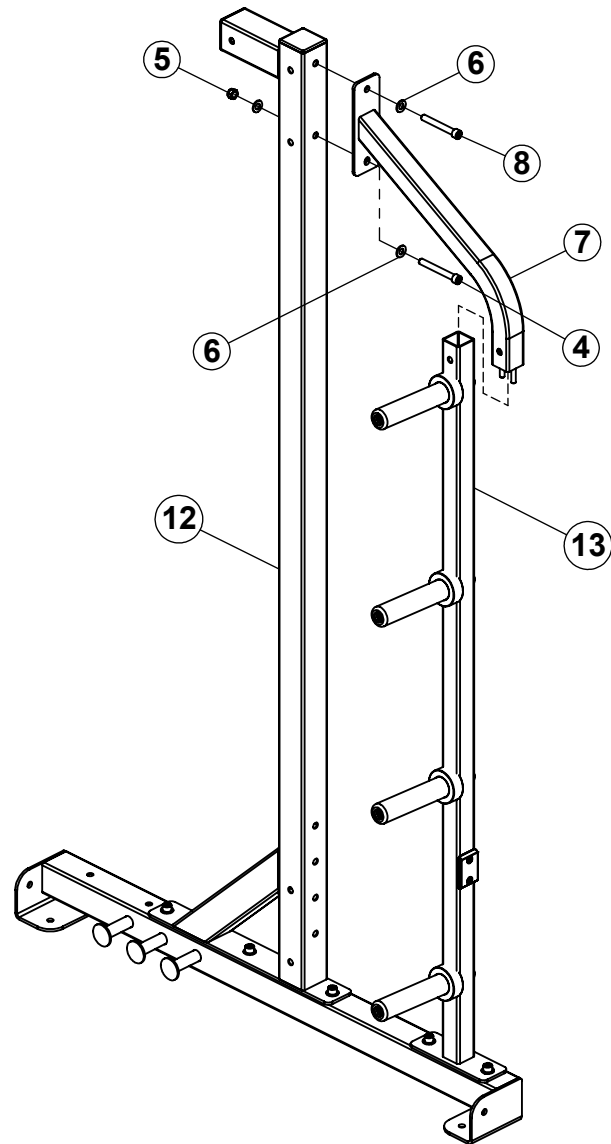

NOTE:

LOOSELY assemble bolt connections in this step.

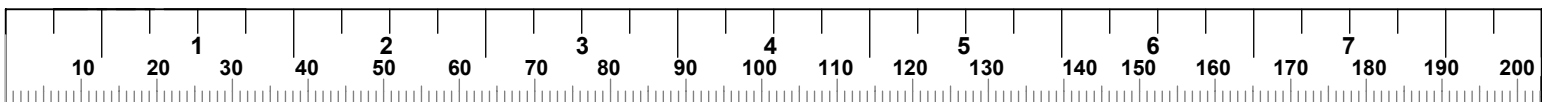

STEP 6

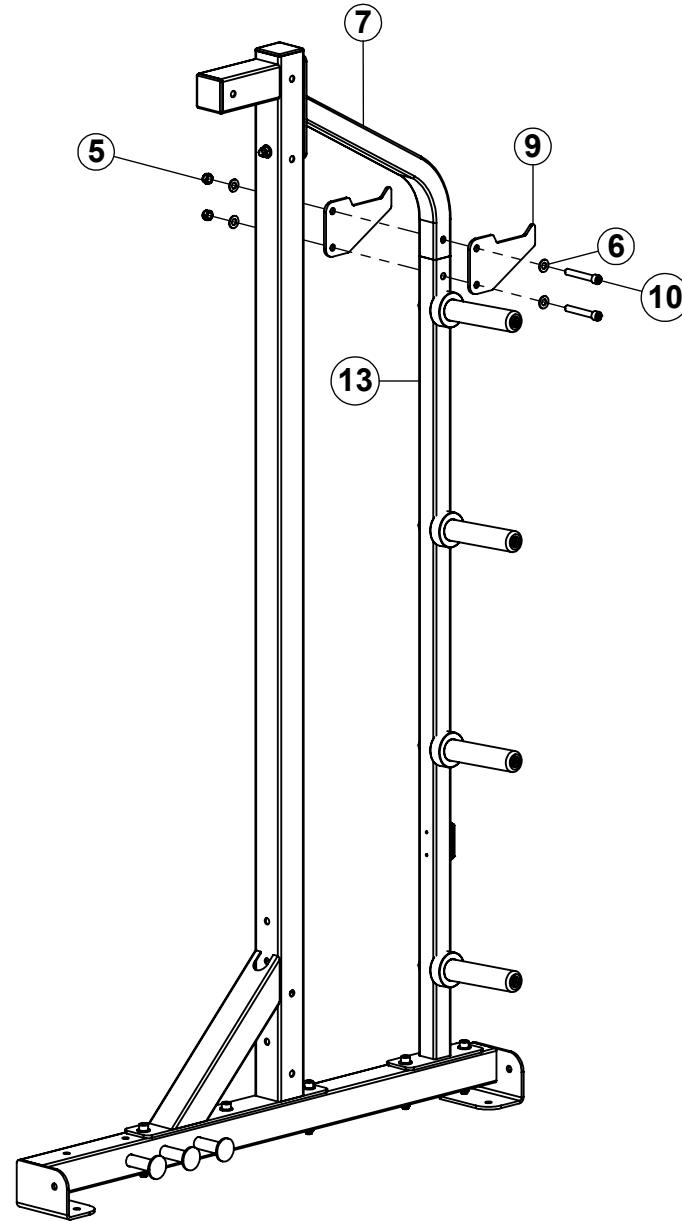

NOTE:

LOOSELY assemble bolt connections in this step.

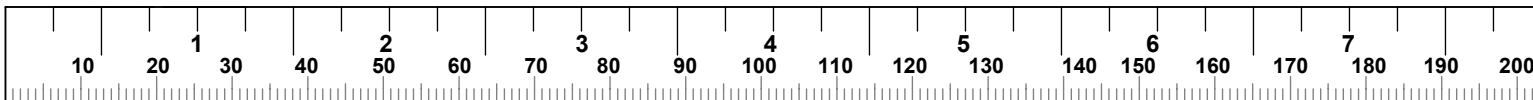

STEP 7

NOTE:
If a platform will be used,
assemble item 14 to the
upper set of holes on the XHC.

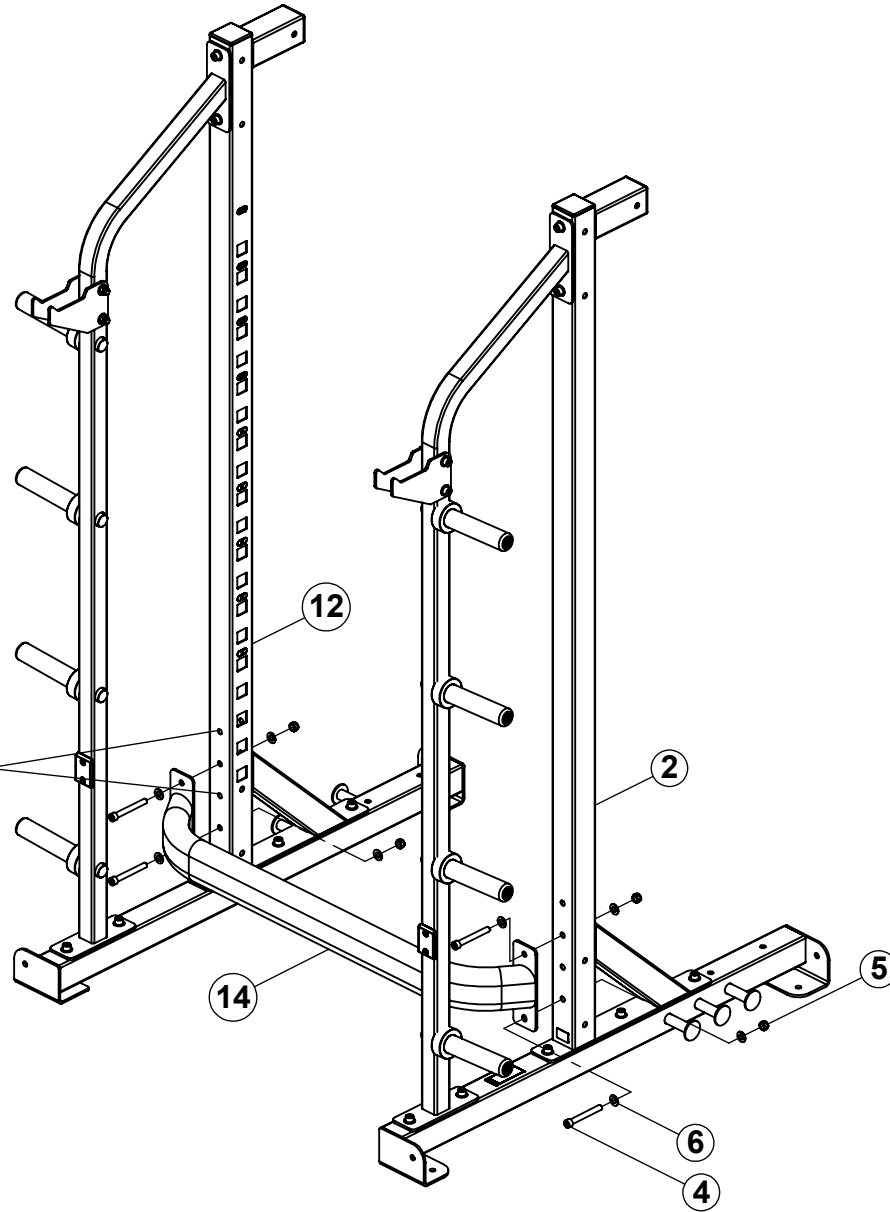

NOTE:

LOOSELY assemble bolt connections in this step.

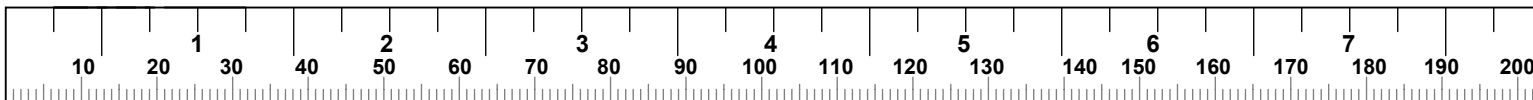

STEP 8

NOTE:

If more than one HALF CAGE will be joined together, leave these bolts loose until step 11.

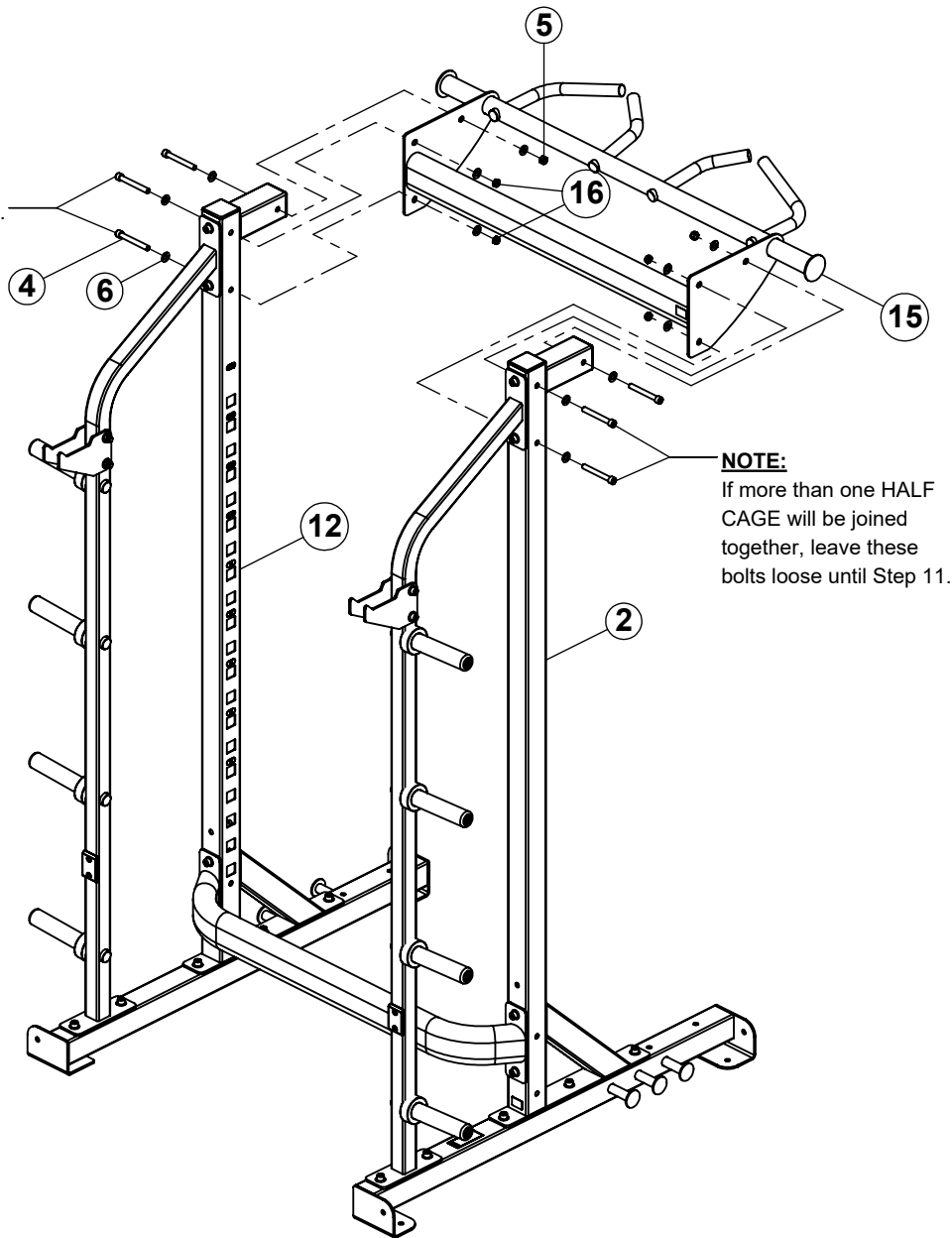

NOTE:

After this step has been assembled, **SECURELY** tighten all bolt connections from this step and previous steps.

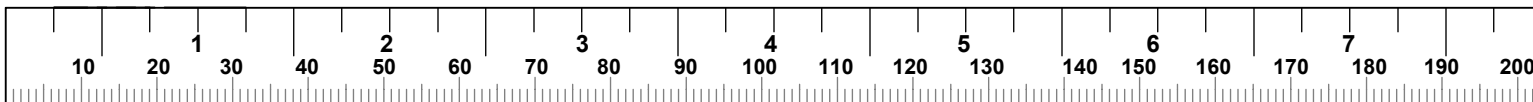

STEP 9

Insert Bar Catches into desired slots on the upright and allow it to drop down to lock in place.

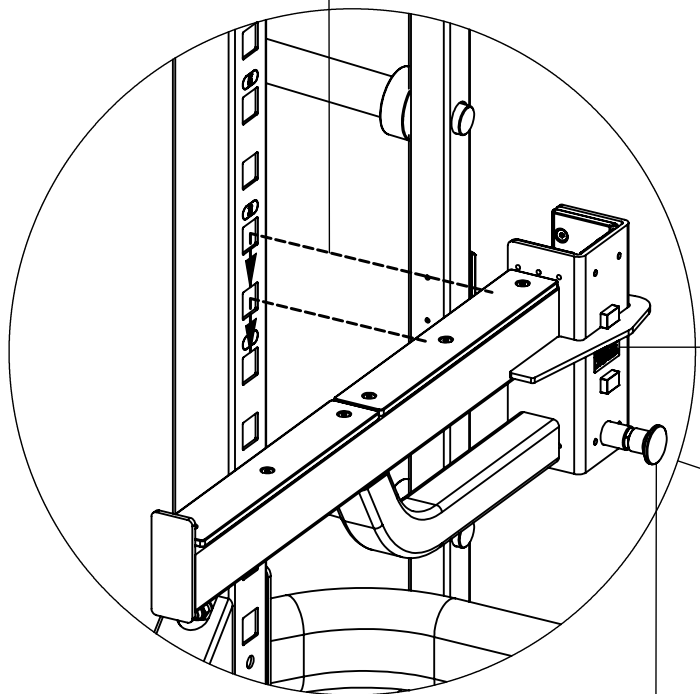

WARNING
SPRING PIN MUST
BE FULLY ENGAGED

To remove Bar Catches from upright, pull spring pin out to unlock, lift up and pull out.

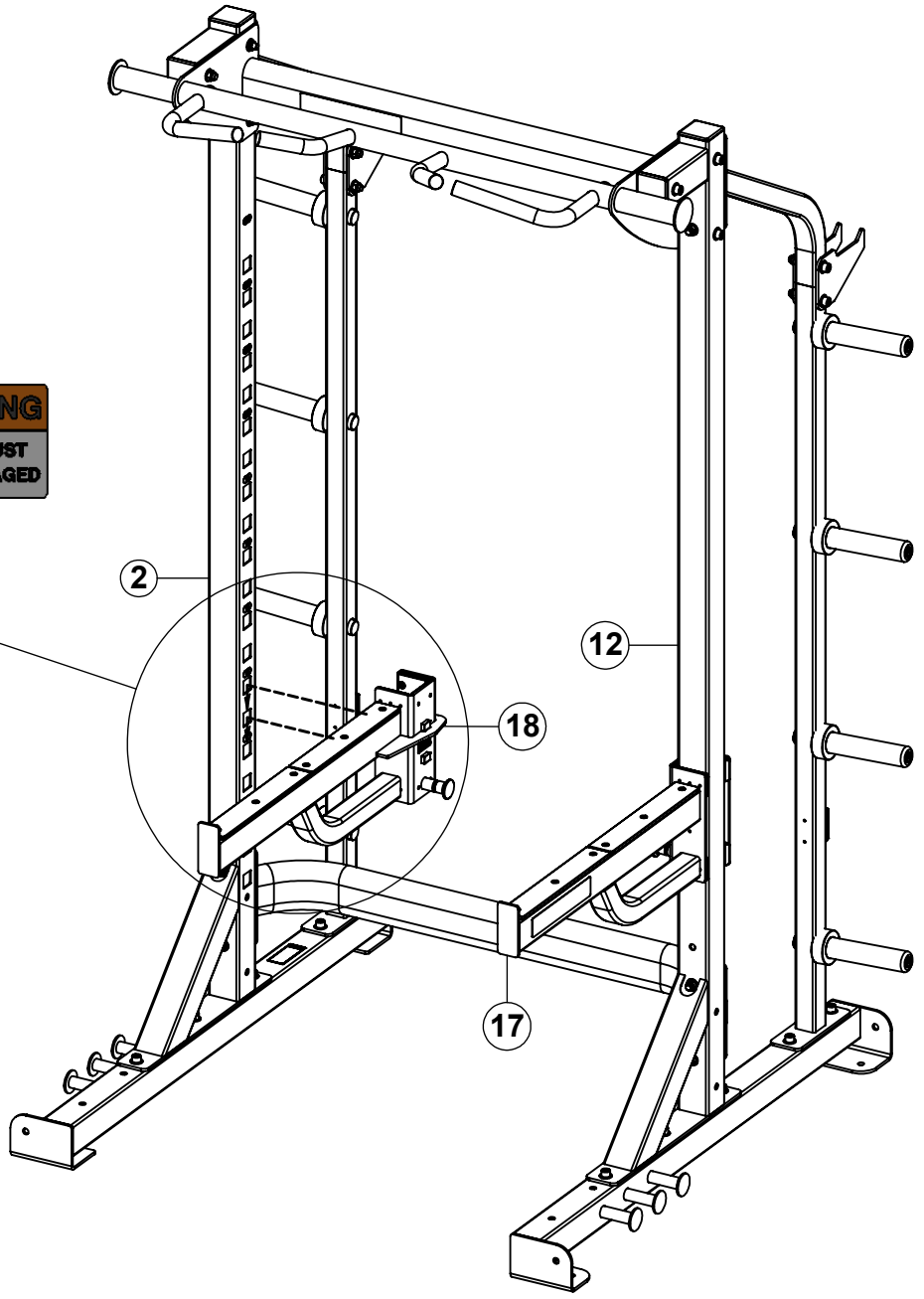

STEP 10

Insert Bar Supports into desired slots on the upright and allow it to drop down to lock in place.

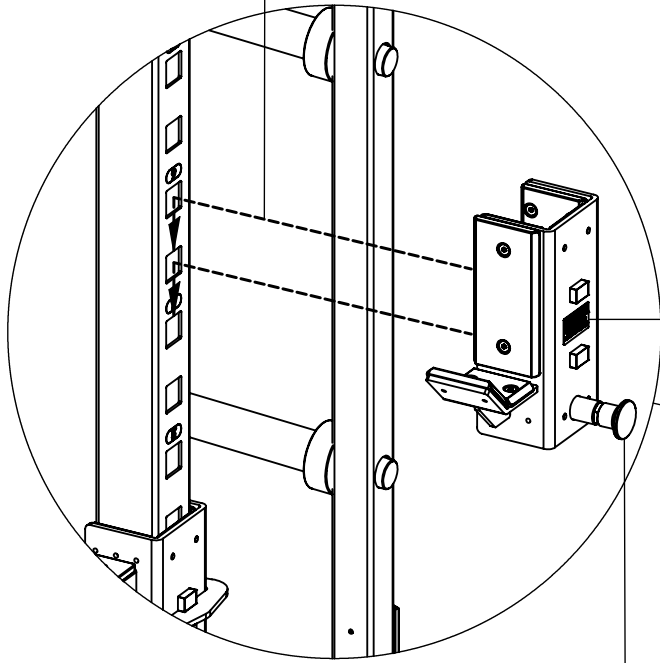

WARNING
SPRING PIN MUST
BE FULLY ENGAGED

To remove Bar Supports from upright, pull spring pin out to unlock, lift up and pull out.

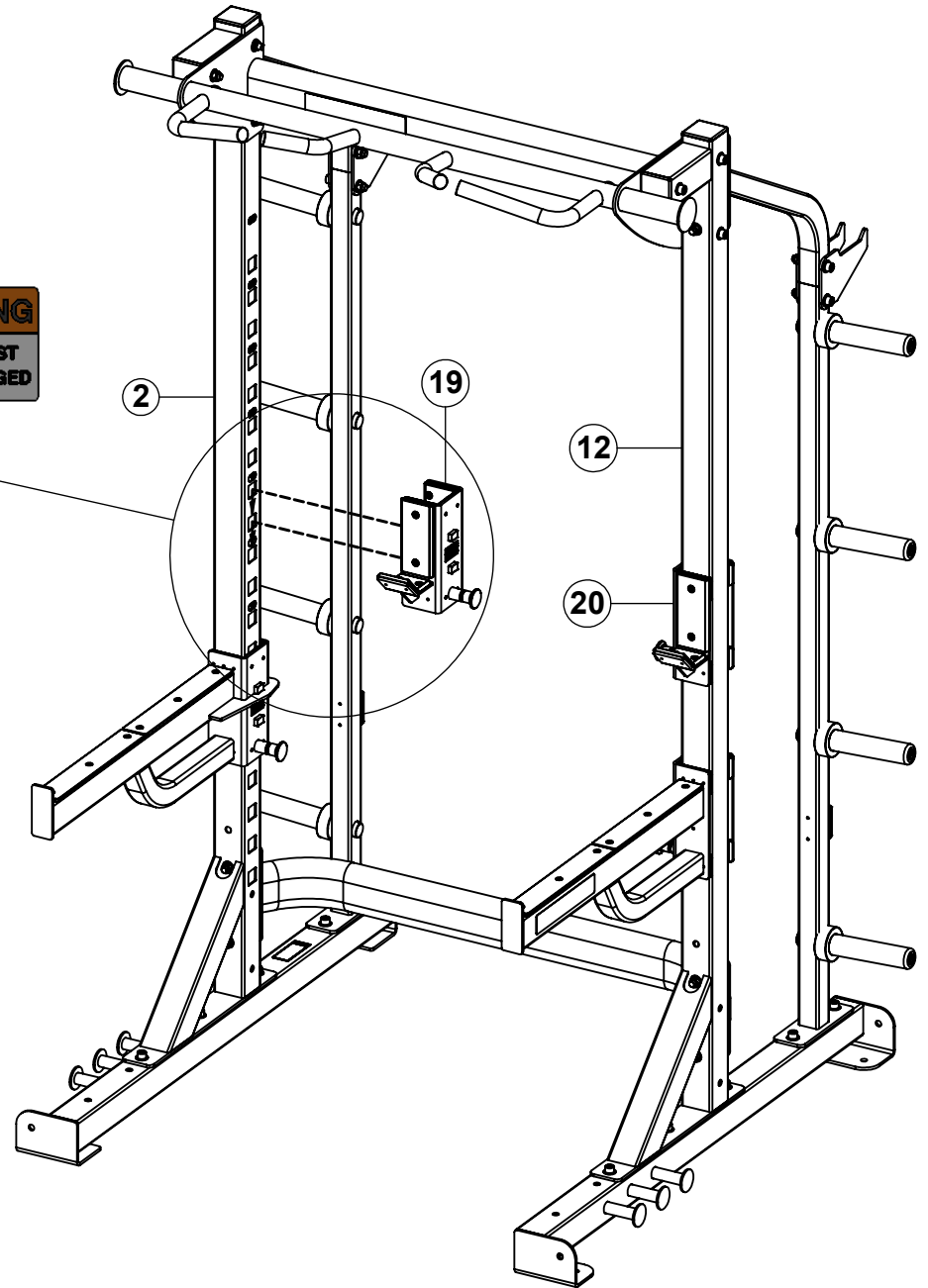

STEP 11a

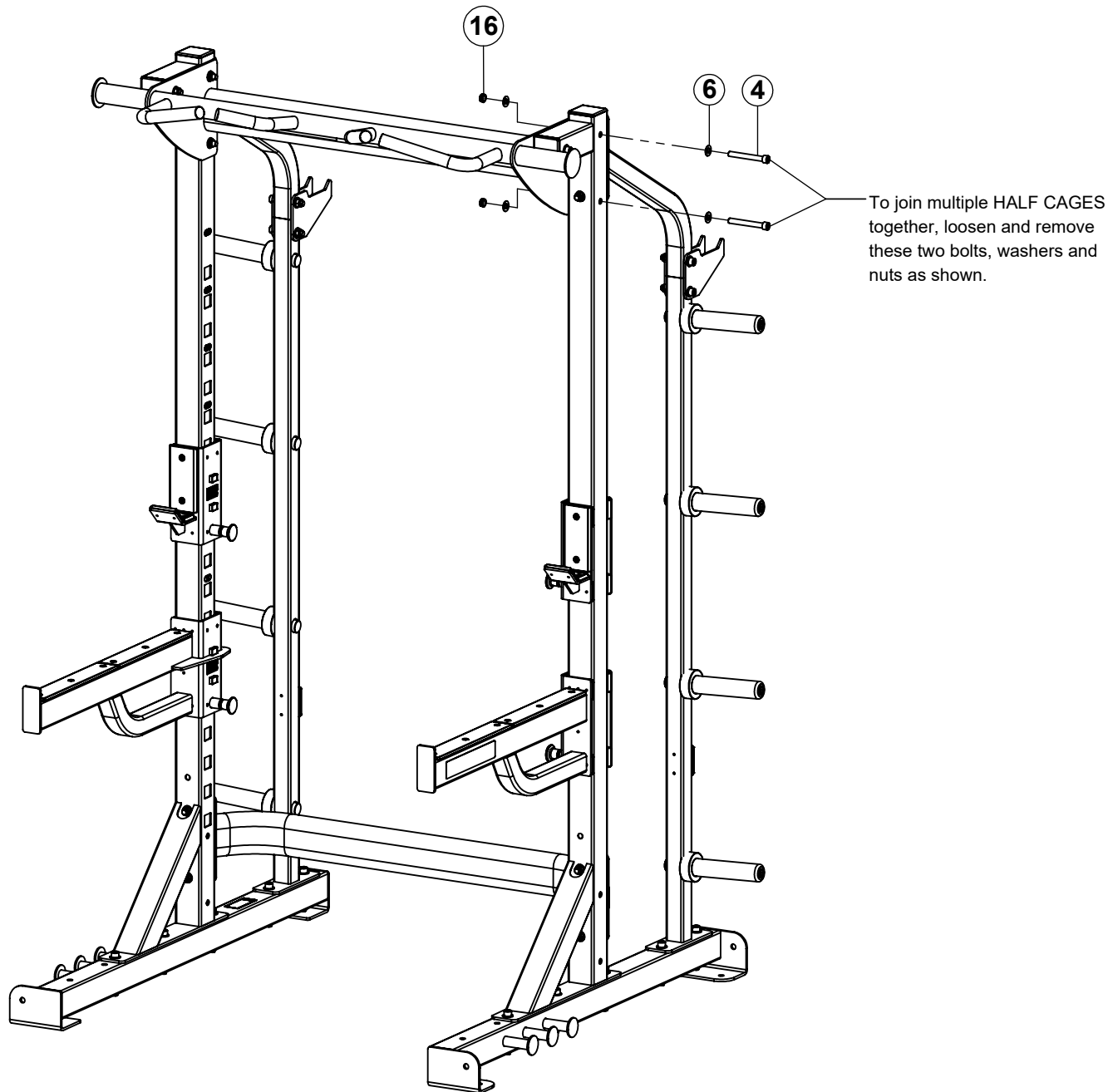

STEP 11b

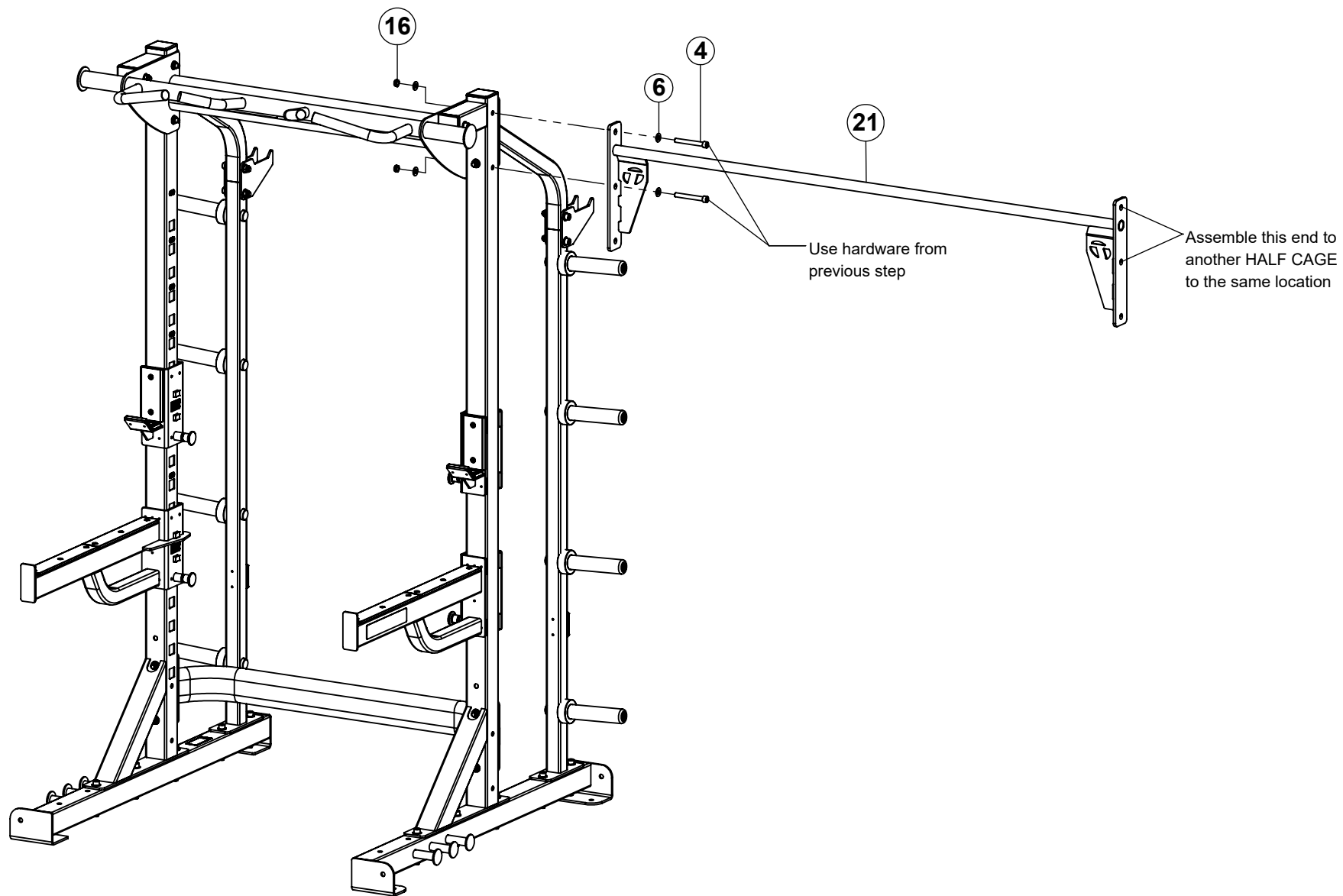

NOTE:

After this step has been assembled, **SECURELY** tighten all bolt connections from this step and previous steps

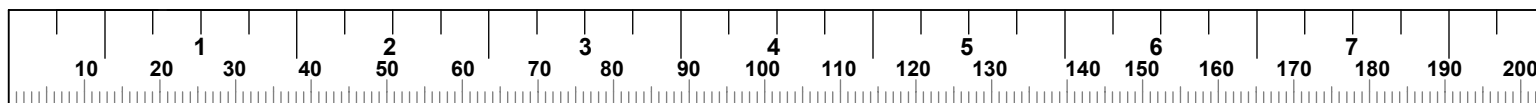

STEP 12a: OPTIONAL GRT

To assemble the GROUND ROTATIONAL TRAINER to the HALF CAGE, loosen and remove this bolt, washers and nut as shown

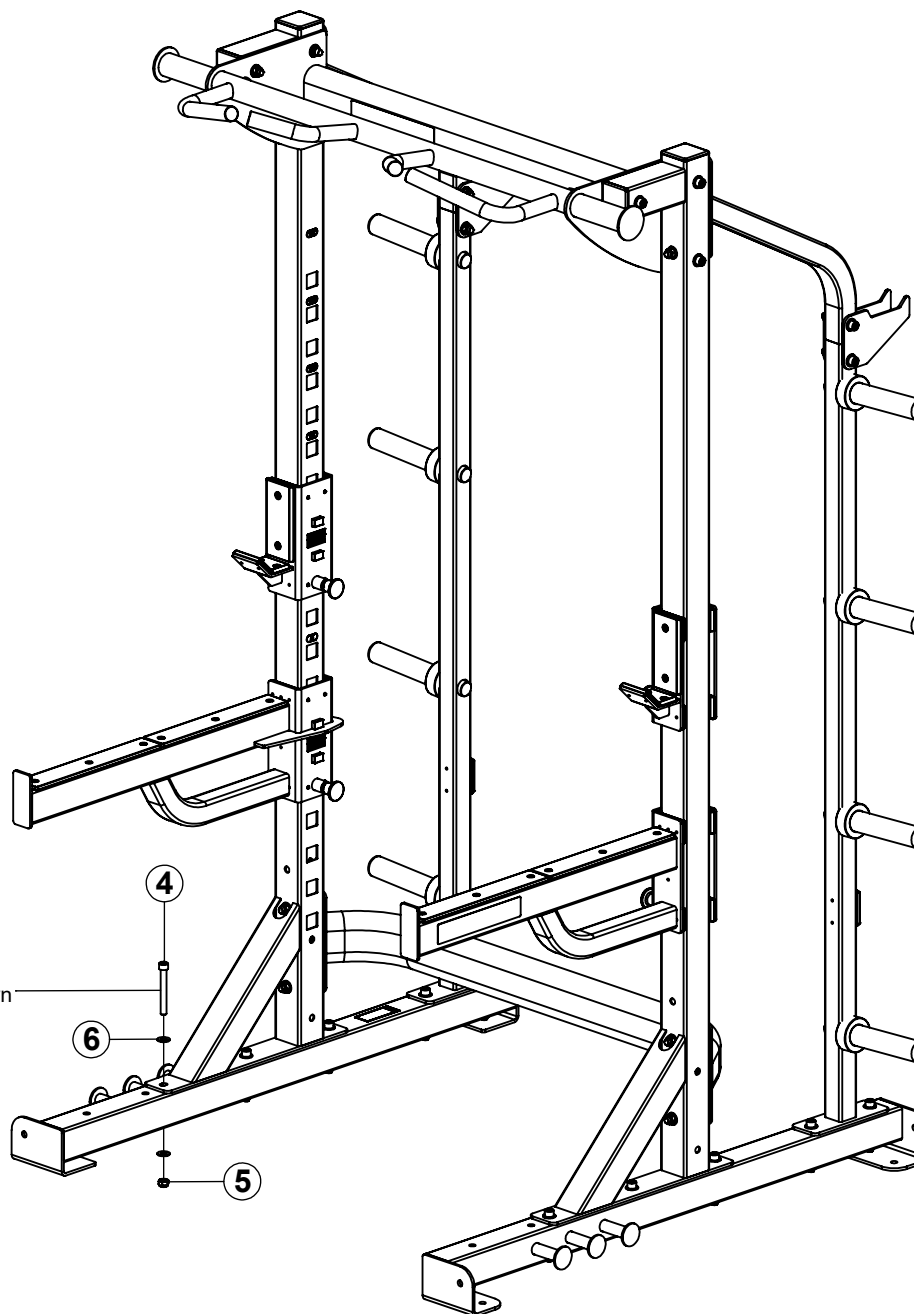

STEP 12b: OPTIONAL GRT

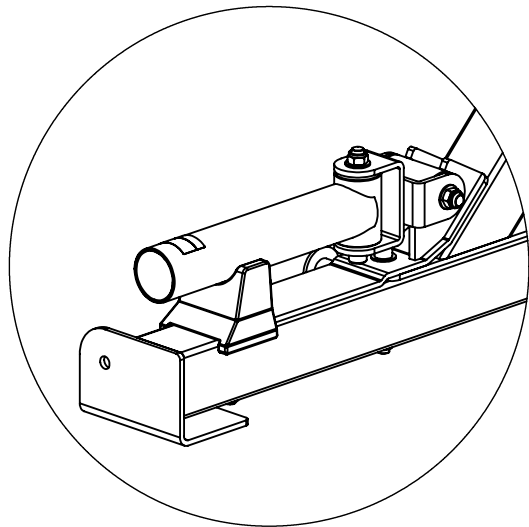

GRT STORED POSITION

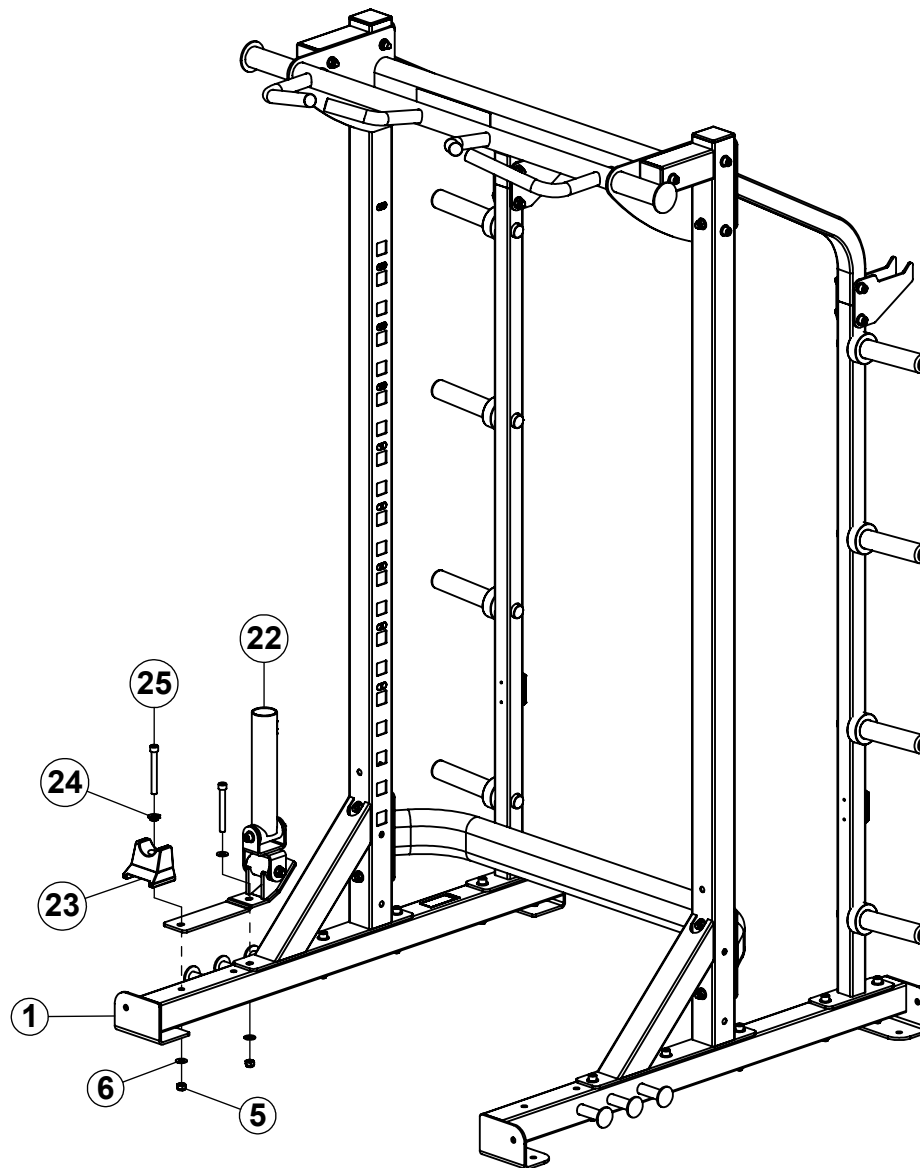

NOTE:

SECURELY tighten bolt connections in this step.

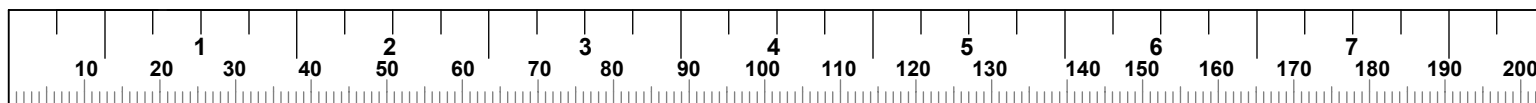

STEP 13a: OPTIONAL XERT

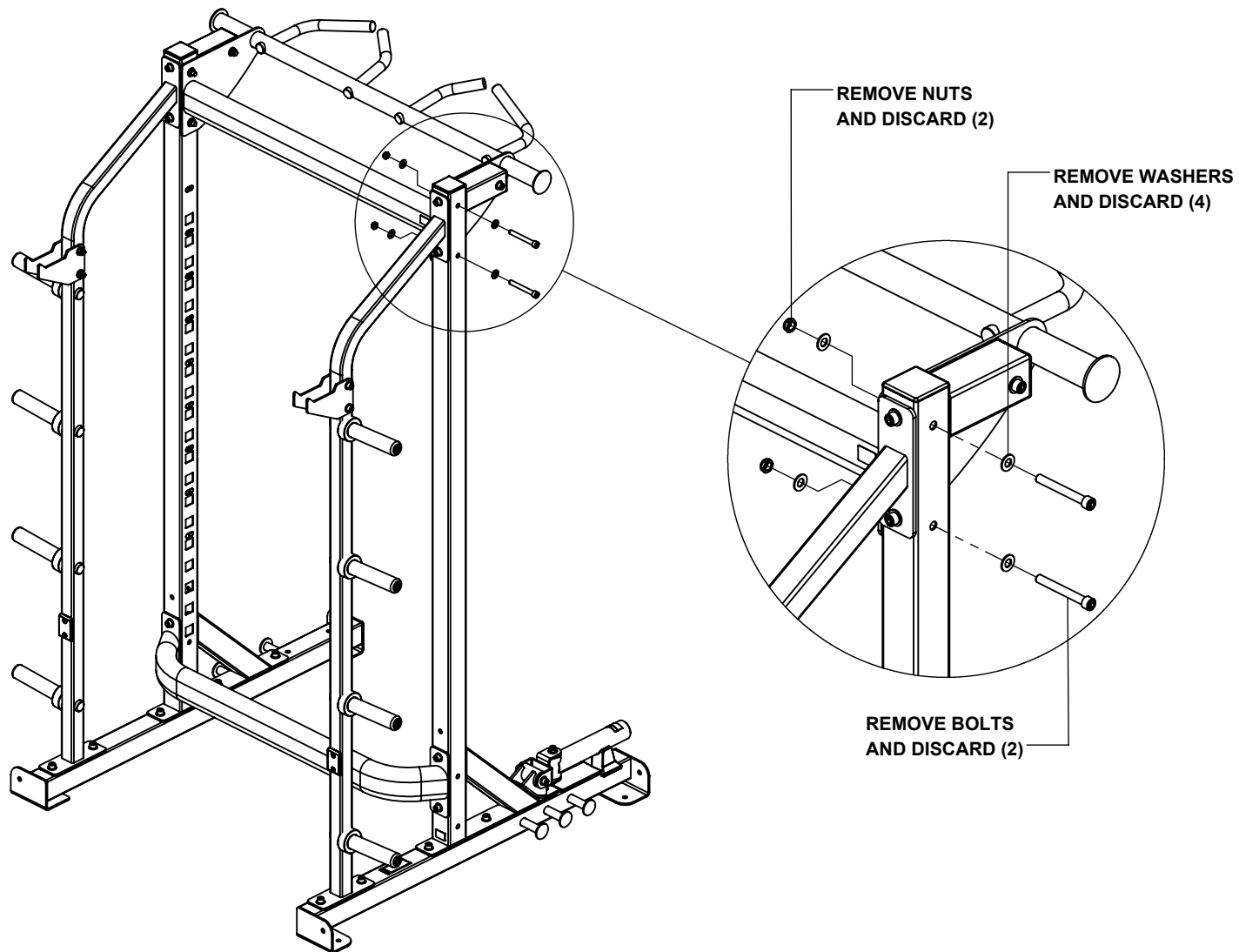

STEP 13b: OPTIONAL XERT

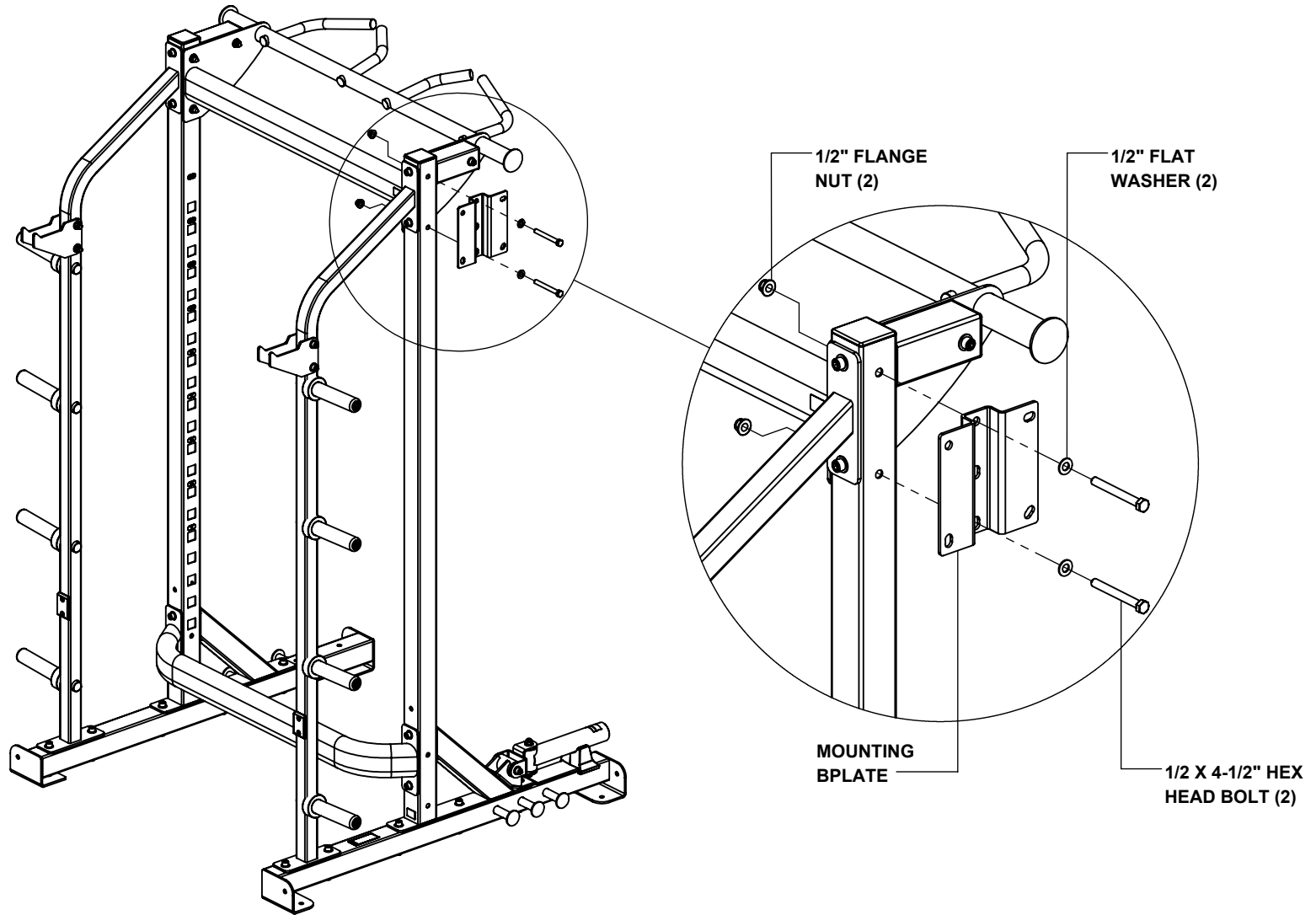

NOTE:

SECURELY tighten bolt connections in this step.

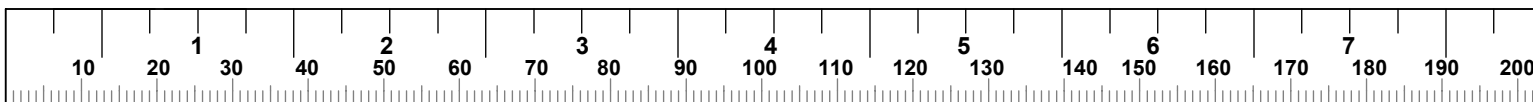

STEP 13c: OPTIONAL XERT

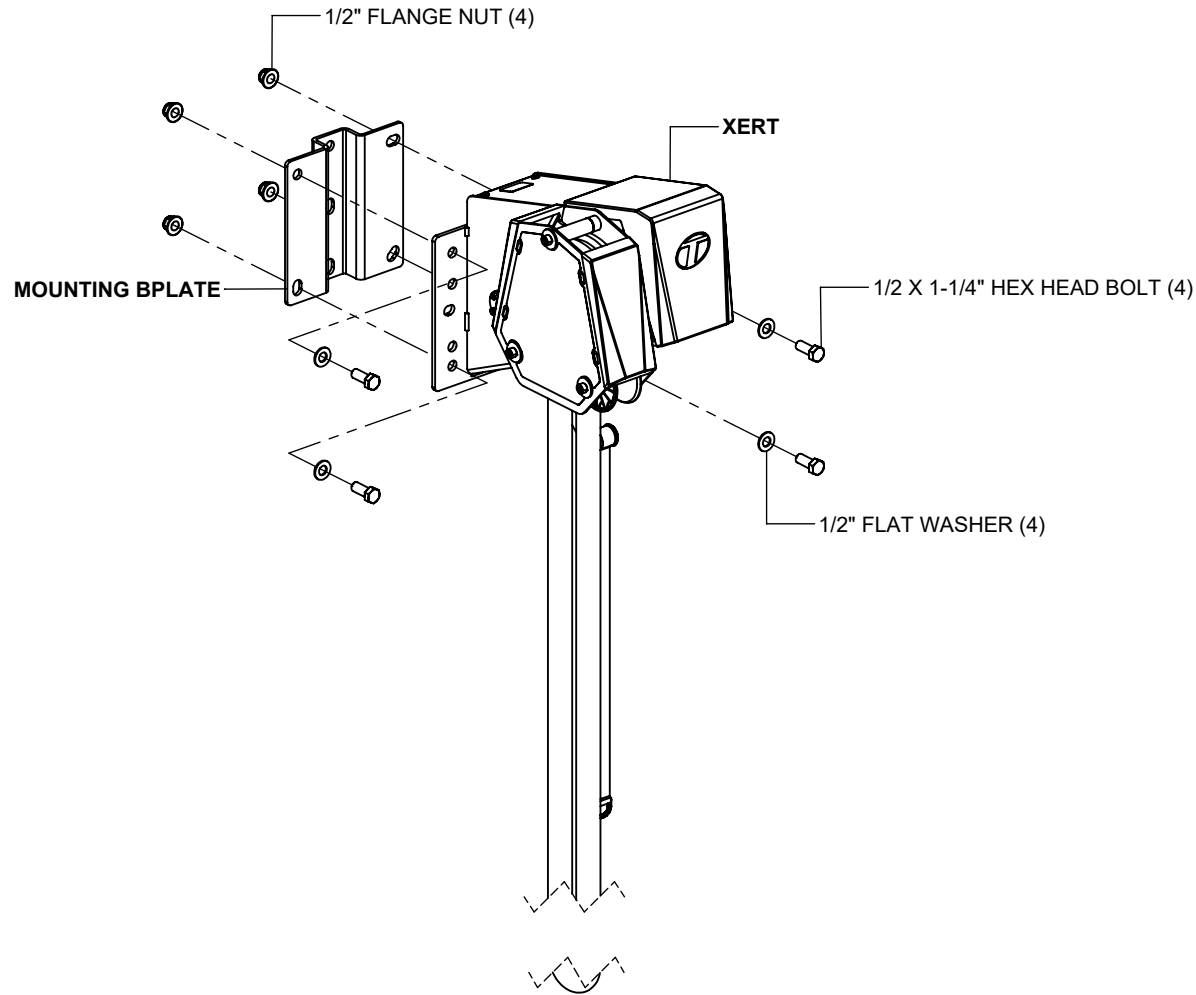

NOTES:

HALF CAGE has been hidden for assembly clarity.

SECURELY tighten bolt connections in this step.

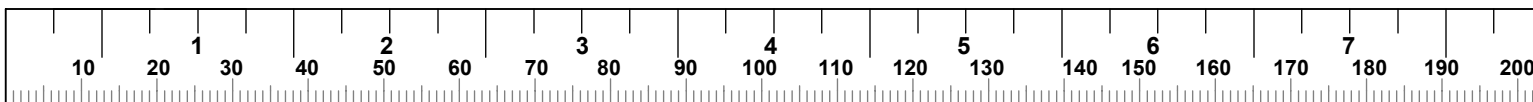

STEP 14

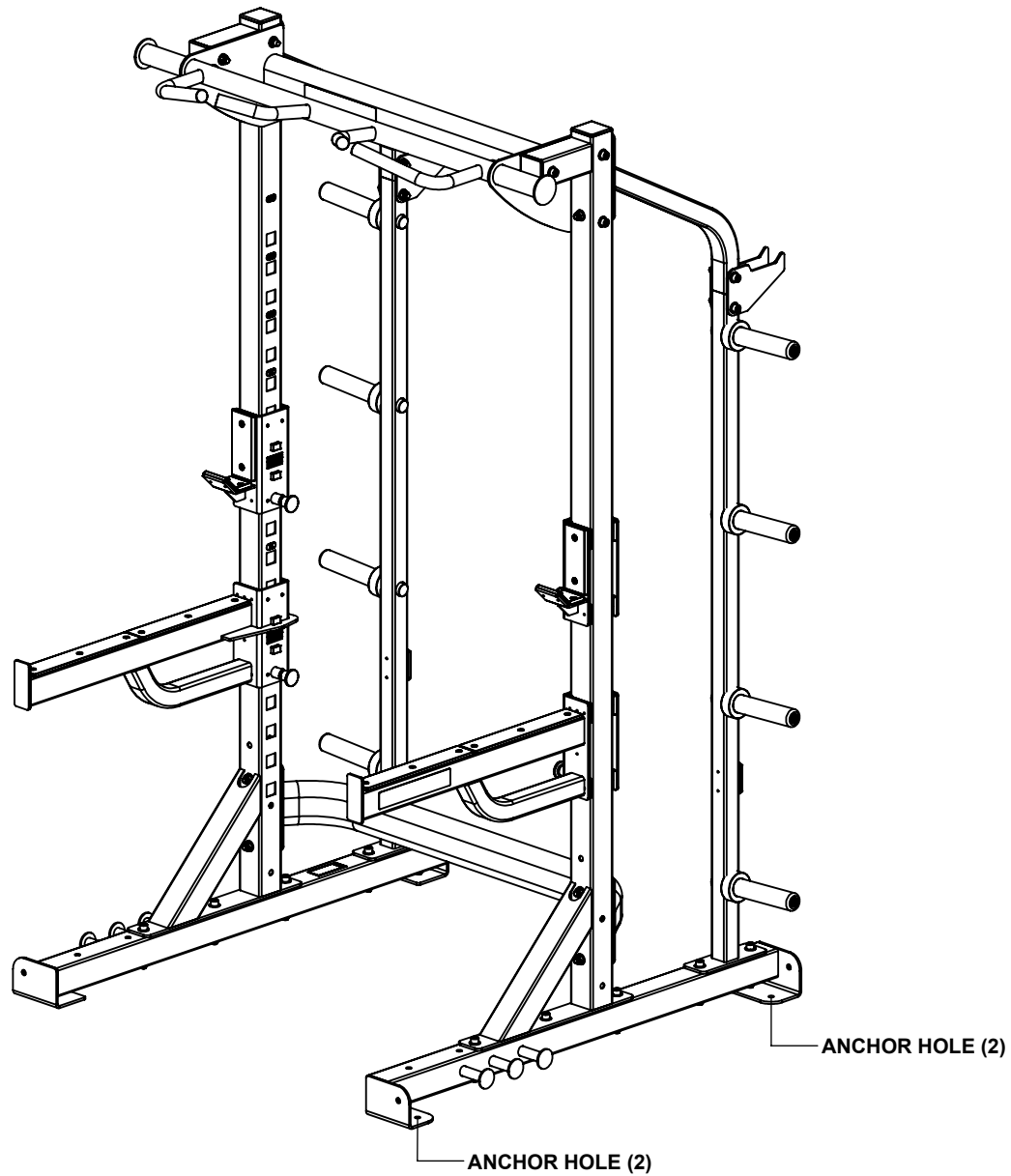

NOTES:

SECURELY anchor the machine to the floor using the anchor holes provided.

Consult a professional contractor for the actual anchoring of the machine.