

# Ambientec

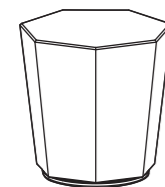

**Xtal**

Design Ryuichi Kozeki

Xtal

XL2-ST

## Instructions

Thank you for purchasing "the Ambientec Xtal". Please read these instructions thoroughly before using the product.

### Contents

- 1 Safety Precautions
- 2 Package Contents and Nomenclature
- 3 Before Using the Product
- 4 Waterproof Specifications
- 5 Operation
- 6 Care and Maintenance
- 7 Product Specifications

## 1 Safety Precautions

- To use the product correctly and safely, be sure to read the Safety Precautions before use. The Safety Precautions include critical information for safety. Be sure to heed them.
- The following symbols indicate the degree of risk or damage that may result if the information given after each symbol is ignored and the product is used improperly.

<b>⚠ DANGER</b>	Indicates an imminently hazardous situation which, if not avoided, will result in death or serious injury.
<b>⚠ WARNING</b>	Indicates a potentially hazardous situation which, if not avoided, could result in death or serious injury.
<b>⚠ CAUTION</b>	Indicates a potentially hazardous situation which, if not avoided, may result in minor/moderate injury or equipment damage.

**If the product is used improperly and any of the following DANGER, WARNING, or CAUTION information is ignored, there is potential for fire, heat generation, damage, or leakage that may cause burns, injury, or loss of sight.**

<b>⊘</b>	Indicates "prohibited" actions that must not be performed.
<b>!</b>	Indicates "compulsory" actions that must be performed.

### ⚠ DANGER

- ⊘ Do not put the product in a fire or heat it in an oven.
- ⊘ Do not expose the product to high temperatures or leave it in a place where it is subject to direct sunlight.
- ⊘ Do not place the product within reach of infants and children.
- ⊘ Do not open or modify the product.
- ⊘ Do not apply an impact to the product by dropping it, throwing it, etc.
- ⊘ Do not bring the LED light close to your eyes or look at it when it is lit.
- ! Disconnect the product immediately if you notice smoke or smell something burning.
- ! When carrying the main body, make sure that the crystal glass shade is fitted securely to the aluminum base. If it is loose, the base may fall off when the acrylic shade is lifted.

### ⚠ WARNING

- ⊘ Do not place the product in an area exposed to direct sunlight; otherwise, the product's glass shade could focus the sun's rays and cause a fire.
- ⊘ Do not short-circuit the recharging terminal of the main body or charger stand with a metal pin or other metallic object.
- ⊘ Do not cover the product with cloth, paper, or any other easily flammable material.
- ⊘ Keep water and other liquids away from the AC adapter and charger stand and do not use them while they are wet. Also do not plug or unplug the AC adapter and other connectors with a wet hand.
- ⊘ Do not use the USB cable if it is damaged.
- ⊘ Do not swing or throw the main body.
- ! Always supply power within the rated voltage range (100 to 240 V AC) of the AC adapter.
- ! Inspect the AC adapter, household power outlet, and the recharging terminals periodically to ensure that they are free of accumulated dust.
- ! Insert the plug of the AC adapter into the power outlet all the way.

### ⚠ CAUTION

- ⊘ Do not place the product on an unstable or tilted surface.
- ⊘ Do not leave the product outdoors for a long time to avoid damage from weather and strong sunlight.
- ! When the product is not to be used for a long period, disconnect the AC adapter and USB cable.
- ! Use and store the product under an ambient temperature between 0°C and 40°C.

## 2 Package Contents and Nomenclature

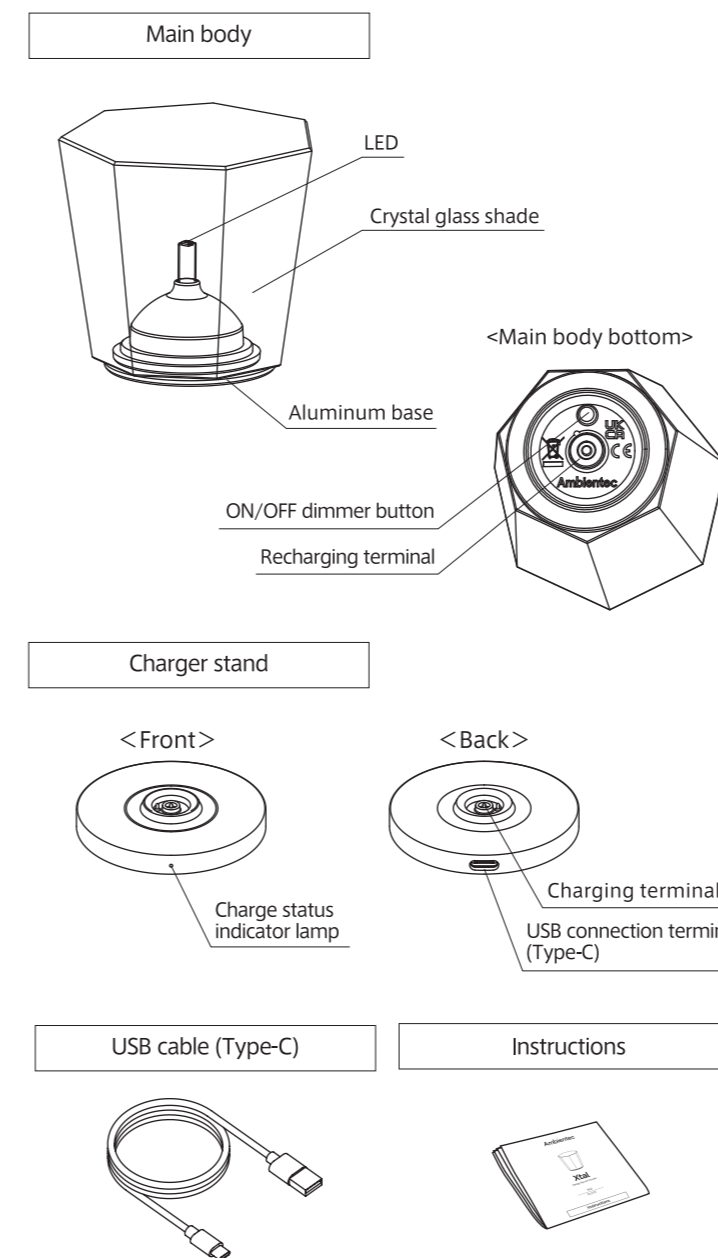

\* Thanks to widespread use of computers and mobile phones, most people today already possess a USB-compatible AC adapter. To minimize waste, AC adapter is not provided with this product.

\* In addition to the optional AMB-AC02 USB AC adapter, you can also use a USB AC adapter compatible with an output of 5 V DC, 1 A or more.

## 3 Before Using the Product

- Be sure to charge the product before using it for the first time or when it hasn't been used for a long period.
- Before use, always make sure the crystal glass shade and aluminum base are securely attached to one another and that the fitting is not loose.

### [1] External appearance

Since the crystal glass shade on this product is molded using a special method, each shade is unique and will differ slightly from other shades. However, only shades that have met the quality standard for the product are shipped.

### [2] Connecting and charging the charger stand

- Connect the smaller connector (Type-C side) of the USB cable to the USB connection terminal on the charger stand (①).  
Note: Although a commercially available USB Type-C cable can also be used, it may sometimes not be used depending on its configuration.
- Connect the larger connector (USB side) of the USB cable to the AC adapter (②) and plug the AC adapter into the wall outlet (③).  
Note: Be sure to use the provided AC adapter (AMB-AC02) to charge the product.
- Place the main body on the charger stand. Charging starts, and the charge status indicator lamp illuminates (④). When charging is complete, the charge status indicator lamp goes out. (If the LED on the main body is lit, it goes out when the main body is placed on the charger stand.)
- The charge status indicator lamp goes out when charging is complete. When the main body is removed from the charger stand, the LED automatically turns on (⑤).

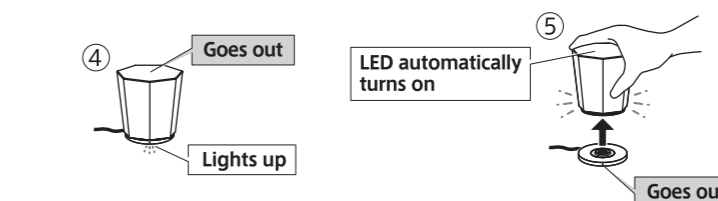

### [3] Error warning

If the product detects heat generation from the battery and control circuit board or an abnormality in the power supply, the protection function may be activated, in which case the charge status indicator lamp starts blinking and charging is not possible. Should this be the case, remove the main body from the charger stand, wait for a while, and then replace the main body on the charger stand to resume charging.

## 4 Waterproof Specifications

- The main body of this product is designed waterproof (IPX6\* equivalent) but it cannot be used underwater, for example in a bathtub.  
\* IPX6 means the degree of liquid ingress protection at which "water projected in powerful jets against the enclosure from any direction shall have no harmful effects".
- The charger stand and AC adapter are not waterproof. Make sure they don't get wet.

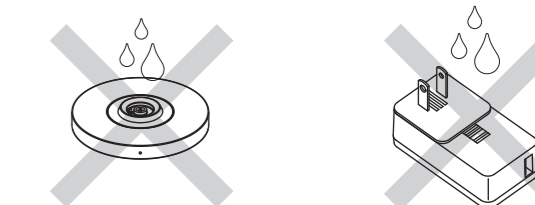

**Be sure to adhere to the following cautions when using the product in a bathroom or similar environment**

### ⚠ CAUTION

- ⊘ Do not leave the product for a long time in a high-temperature, high-humidity bathroom or sauna.
- ⊘ Do not place the product on a poorly drained bathroom floor or similar environment.



## 5 Operation

In addition to the Battery Power mode for cordless use, the Xtal is also provided with a USB Power mode which keeps the main body illuminated as long as power is supplied and charges the battery when the main body is placed on the charger stand.

### [1] Battery Power mode for cordless use

- The main body goes out when it is placed on the charger stand and lights up when removed from the stand.

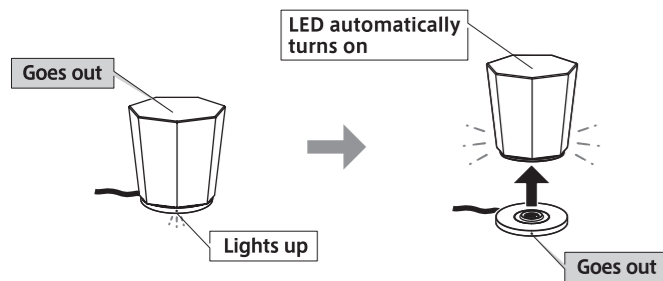

### <Operation using the ON/OFF dimmer button>

- The brightness of the Battery Power mode can be adjusted in two steps. Each time the ON/OFF dimmer button on the bottom of the main unit is pressed, the brightness level changes in the following order: OFF → LOW → MID → HIGH → OFF, and so on.

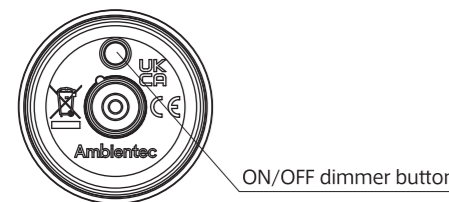

### [2] USB Power mode for lighting up the main body when it has been charged on the charger stand

#### <Switching from the Battery Power mode>

- Keep the ON/OFF dimmer button pressed until the LED on the main body starts blinking slowly. When it starts blinking, place the main body on the charger stand. The main body will light up while it is charging.

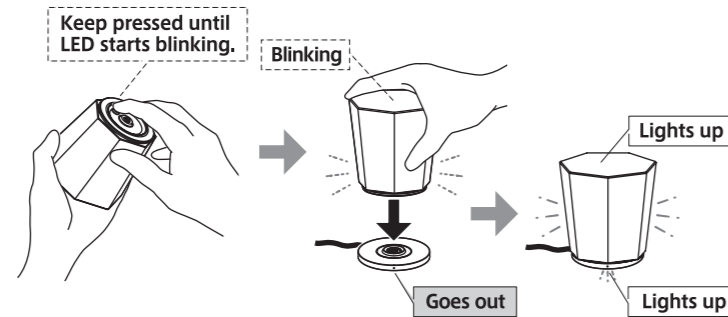

- The brightness changes in three levels in the USB Power mode. The brightness level activated when the USB Power mode is engaged depends on which brightness level was activated in the Battery Power mode as shown below.

**Note:** The ON/OFF dimmer button is inoperable when in the USB Power mode.

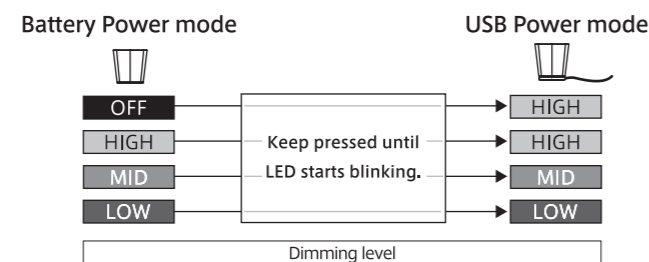

- When the main body is removed from the charger stand, the main body goes out. To return to the Battery Power mode, press the ON/OFF dimmer button once; the main body will light up.

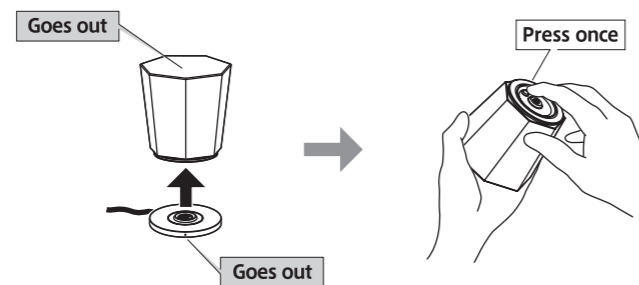

## 6 Care and Maintenance

To keep this product in optimal condition, please follow these maintenance guidelines.

- Turn off the power and disconnect the attached cable before cleaning the product.

- Use a soft, lint-free cloth to gently wipe the crystal glass shade and aluminum base.

- If the crystal glass shade is dirty, clean it with a cloth dampened with water or diluted detergent. Wipe off any moisture with a soft, dry lint-free cloth.

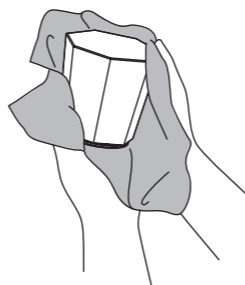

### CAUTION

- Do not use organic solvents or abrasive cleaners such as spray liquid cleaners, benzene, alcohol, or paint thinners. Use of those substances may crack, fog the glossy appearance, or cause the surface finish to peel, as well as hasten distortion and deterioration.

- The crystal glass shade is fragile and easily scratched. Handle it carefully. Avoid dropping or bumping it.

- If the terminal or silicone sheet (black sheet around the terminal) on the bottom is dirty, wipe it with a moistened, soft, lint-free cloth.

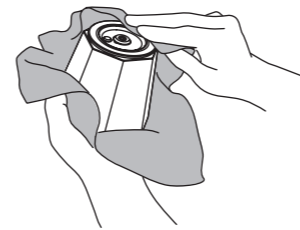

- If dirt or dust gets in the terminal on the charger stand, carefully remove with a cotton swab or similar soft object. Do not use a metallic tool such as tweezers.



- When the inner surface of the crystal glass shade or aluminum base gets dirty, the shade can be removed by turning it counterclockwise.

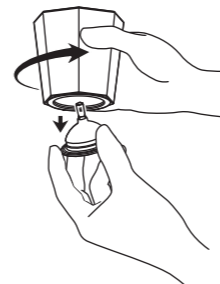

### CAUTION

- Never touch the LED which is an easily damaged precision component.

## 7 Product Specifications

Product name	Xtal			
Product code	XL2-ST			
Main materials	Main body/Shade	Crystal glass		
	Main body/Base	Aluminum, Silicone rubber, ABS, etc.		
	Charger stand	Zinc alloy, Silicone rubber, ABS		
Surface treatment	Main body	Not processed		
	Charger stand	Anodizing (Black)		
Dimensions (mm)	Main body	Outer diamete: Φ80	Height: 82	
	Charger stand	Outer diamete: Φ62	Height: 8	
Weight (g)	Main body	620		
	Charger stand	85		
Light source	LED*1*2			
Dimming level		LOW	MID	HIGH
Battery run time(h)	Battery power mode	32	16	8
	USB power mode	Until battery is exhausted		
Color temperature (K)	2000			
Recharging time	Approx. 3hours*3			
Recharging cycle	Approx. 500 times*4			
Power supply	Rechargeable lithium-ion battery, 3.7V/190mAh			
Waterproofing	Main body	IPX6 equivalent*5		
	Charger stand	Not waterproof		
Operating temperature (°C)	0~40			
Dimensions (mm)	Main body only: 82 Including charging stand:90			

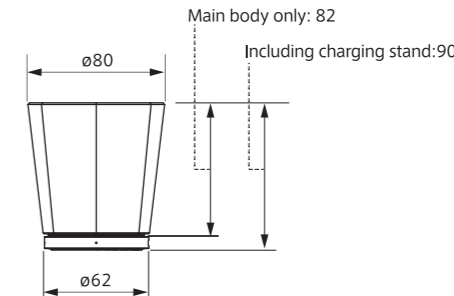

- \*1 The brightness of the LED elements decreases by about 70% after about 40,000 hours of use.
- \*2 The color and brightness of each individual LED element's light varies even when used in a light source with the same product code.
- \*3 Varies depending on operating conditions and environments.
- \*4 Applies when the battery performance drops below 50%.
- \*5 IPX6 means the degree of liquid ingress protection at which "water projected in powerful jets against the enclosure from any direction shall have no harmful effects".
- \*6 The LED Modules with the crystal glass shade removed is not weatherproof.

## MEMO

# Ambientec

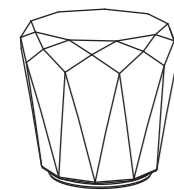

## Xtal Acrux

Design Ryuichi Kozeki

Xtal Acrux  
XL2-AX

### Instructions

Thank you for purchasing "the Ambientec Xtal Acrux". Please read these instructions thoroughly before using the product.

#### Contents

- 1 Safety Precautions
- 2 Package Contents and Nomenclature
- 3 Before Using the Product
- 4 Waterproof Specifications
- 5 Operation
- 6 Care and Maintenance
- 7 Product Specifications

## 1 Safety Precautions

- To use the product correctly and safely, be sure to read the Safety Precautions before use. The Safety Precautions include critical information for safety. Be sure to heed them.
- The following symbols indicate the degree of risk or damage that may result if the information given after each symbol is ignored and the product is used improperly.

<b>⚠ DANGER</b>	Indicates an imminently hazardous situation which, if not avoided, will result in death or serious injury.
<b>⚠ WARNING</b>	Indicates a potentially hazardous situation which, if not avoided, could result in death or serious injury.
<b>⚠ CAUTION</b>	Indicates a potentially hazardous situation which, if not avoided, may result in minor/moderate injury or equipment damage.

**If the product is used improperly and any of the following DANGER, WARNING, or CAUTION information is ignored, there is potential for fire, heat generation, damage, or leakage that may cause burns, injury, or loss of sight.**

<b>⊘</b>	Indicates "prohibited" actions that must not be performed.
<b>!</b>	Indicates "compulsory" actions that must be performed.

### ⚠ DANGER

- ⊘ Do not put the product in a fire or heat it in an oven.
- ⊘ Do not expose the product to high temperatures or leave it in a place where it is subject to direct sunlight.
- ⊘ Do not place the product within reach of infants and children.
- ⊘ Do not open or modify the product.
- ⊘ Do not apply an impact to the product by dropping it, throwing it, etc.
- ⊘ Do not bring the LED light close to your eyes or look at it when it is lit.
- ! Disconnect the product immediately if you notice smoke or smell something burning.
- ! When carrying the main body, make sure that the crystal glass shade is fitted securely to the aluminum base. If it is loose, the base may fall off when the acrylic shade is lifted.

### ⚠ WARNING

- ⊘ Do not place the product in an area exposed to direct sunlight; otherwise, the product's glass shade could focus the sun's rays and cause a fire.
- ⊘ Do not short-circuit the recharging terminal of the main body or charger stand with a metal pin or other metallic object.
- ⊘ Do not cover the product with cloth, paper, or any other easily flammable material.
- ⊘ Keep water and other liquids away from the AC adapter and charger stand and do not use them while they are wet. Also do not plug or unplug the AC adapter and other connectors with a wet hand.
- ⊘ Do not use the USB cable if it is damaged.
- ⊘ Do not swing or throw the main body.
- ! Always supply power within the rated voltage range (100 to 240 V AC) of the AC adapter.

- ! Inspect the AC adapter, household power outlet, and the recharging terminals periodically to ensure that they are free of accumulated dust.

- ! Insert the plug of the AC adapter into the power outlet all the way.

### ⚠ CAUTION

- ⊘ Do not place the product on an unstable or tilted surface.
- ⊘ Do not leave the product outdoors for a long time to avoid damage from weather and strong sunlight.
- ! When the product is not to be used for a long period, disconnect the AC adapter and USB cable.
- ! Use and store the product under an ambient temperature between 0°C and 40°C.

## 2 Package Contents and Nomenclature

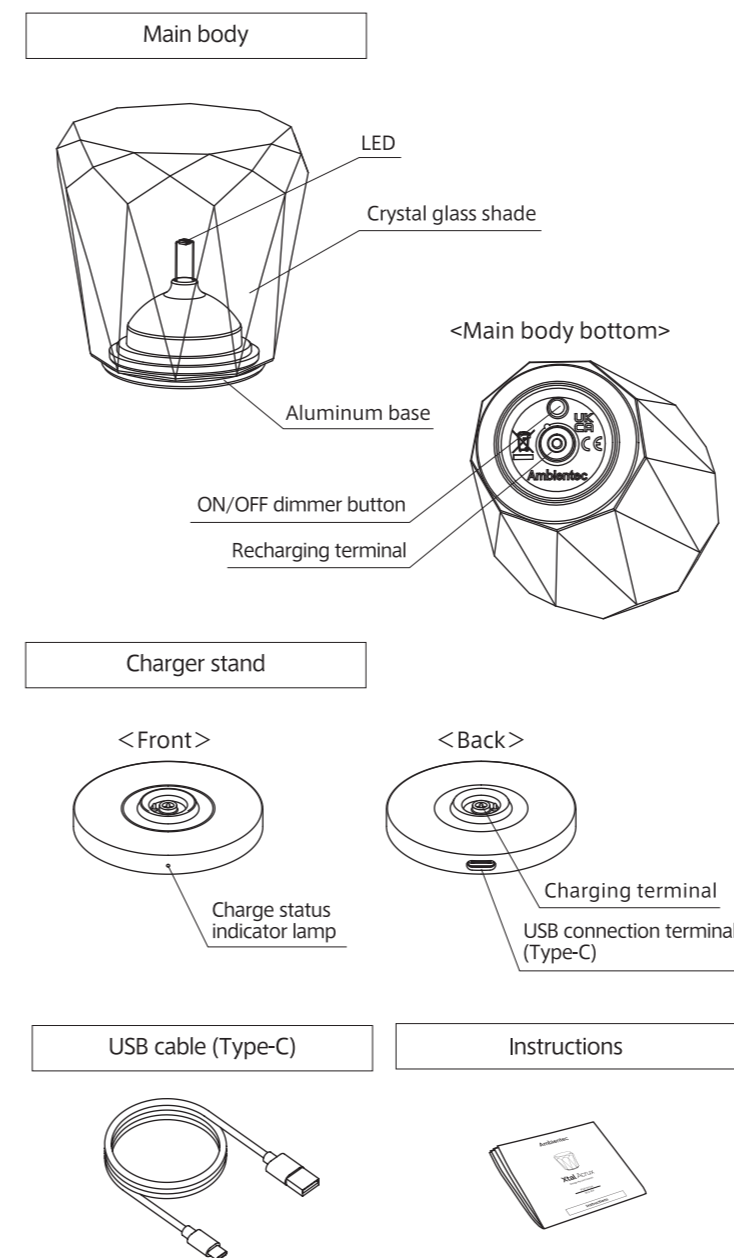

\* Thanks to widespread use of computers and mobile phones, most people today already possess a USB-compatible AC adapter. To minimize waste, AC adapter is not provided with this product.

\* In addition to the optional AMB-AC02 USB AC adapter, you can also use a USB AC adapter compatible with an output of 5 V DC, 1 A or more.

## 3 Before Using the Product

- Be sure to charge the product before using it for the first time or when it hasn't been used for a long period.
- Before use, always make sure the crystal glass shade and aluminum base are securely attached to one another and that the fitting is not loose.

### [1] External appearance

Since the crystal glass shade on this product is molded using a special method, each shade is unique and will differ slightly from other shades. However, only shades that have met the quality standard for the product are shipped.

### [2] Connecting and charging the charger stand

- Connect the smaller connector (Type-C side) of the USB cable to the USB connection terminal on the charger stand (①).  
Note: Although a commercially available USB Type-C cable can also be used, it may sometimes not be used depending on its configuration.
- Connect the larger connector (USB side) of the USB cable to the AC adapter (②) and plug the AC adapter into the wall outlet (③).  
Note: Be sure to use the provided AC adapter (AMB-AC02) to charge the product.
- Place the main body on the charger stand. Charging starts, and the charge status indicator lamp illuminates (④). When charging is complete, the charge status indicator lamp goes out. (If the LED on the main body is lit, it goes out when the main body is placed on the charger stand.)
- The charge status indicator lamp goes out when charging is complete. When the main body is removed from the charger stand, the LED automatically turns on (⑤).

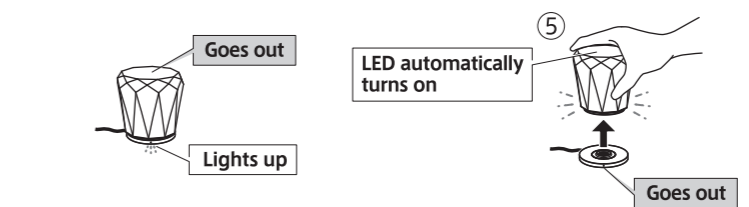

### [3] Error warning

If the product detects heat generation from the battery and control circuit board or an abnormality in the power supply, the protection function may be activated, in which case the charge status indicator lamp starts blinking and charging is not possible. Should this be the case, remove the main body from the charger stand, wait for a while, and replace the main body on the charger stand to resume charging.

## 4 Waterproof Specifications

- The main body of this product is designed waterproof (IPX6\* equivalent) but it cannot be used underwater, for example in a bathtub.  
\*IPX6 means the degree of liquid ingress protection at which "water projected in powerful jets against the enclosure from any direction shall have no harmful effects".

- The charger stand and AC adapter are not waterproof. Make sure they don't get wet.

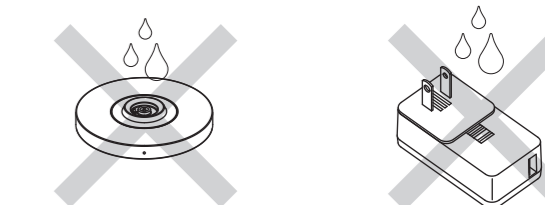

**Be sure to adhere to the following cautions when using the product in a bathroom or similar environment**

### ⚠ CAUTION

- ⊘ Do not leave the product for a long time in a high-temperature, high-humidity bathroom or sauna.
- ⊘ Do not place the product on a poorly drained bathroom floor or similar environment.



## 5 Operation

In addition to the Battery Power mode for cordless use, the Xtal is also provided with a USB Power mode which keeps the main body illuminated as long as power is supplied and charges the battery when the main body is placed on the charger stand.

### [1] Battery Power mode for cordless use

- The main body goes out when it is placed on the charger stand and lights up when removed from the stand.

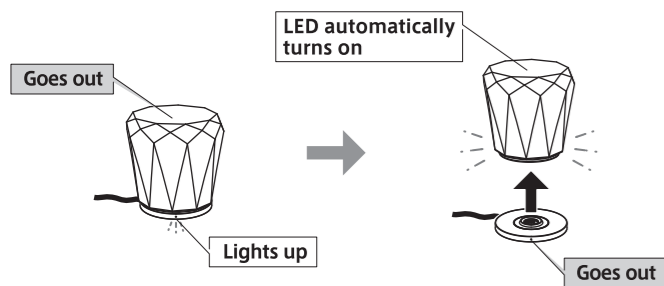

### <Operation using the ON/OFF dimmer button>

- The brightness of the Battery Power mode can be adjusted in two steps. Each time the ON/OFF dimmer button on the bottom of the main unit is pressed, the brightness level changes in the following order: OFF → LOW → MID → HIGH → OFF, and so on.

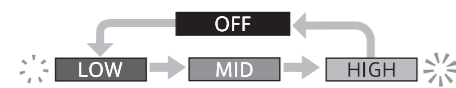
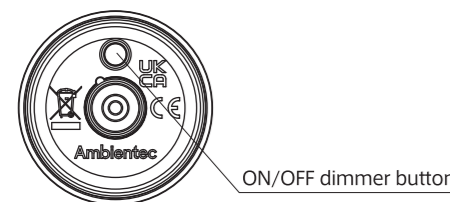

### [2] USB Power mode for lighting up the main body when it has been charged on the charger stand

#### <Switching from the Battery Power mode>

- Keep the ON/OFF dimmer button pressed until the LED on the main body starts blinking slowly. When it starts blinking, place the main body on the charger stand. The main body will light up while it is charging.

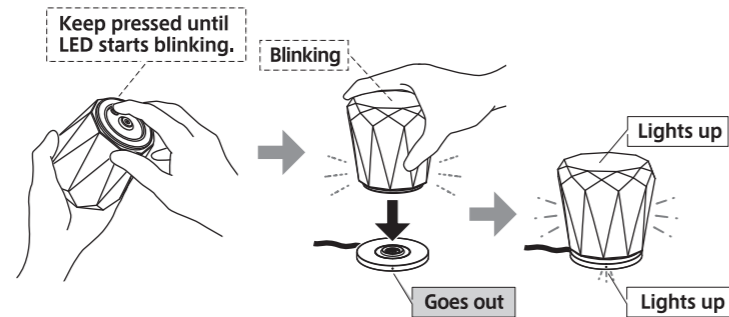

- The brightness changes in three levels in the USB Power mode. The brightness level activated when the USB Power mode is engaged depends on which brightness level was activated in the Battery Power mode as shown below.

**Note:** The ON/OFF dimmer button is inoperable when in the USB Power mode.

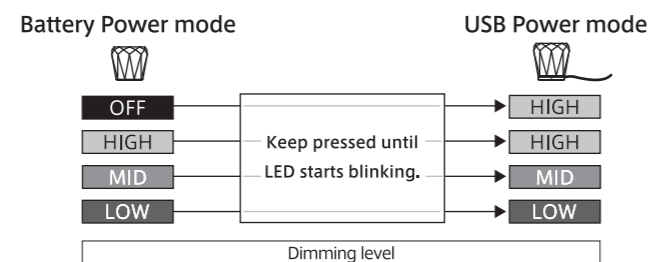

- When the main body is removed from the charger stand, the main body goes out. To return to the Battery Power mode, press the ON/OFF dimmer button once; the main body will light up.

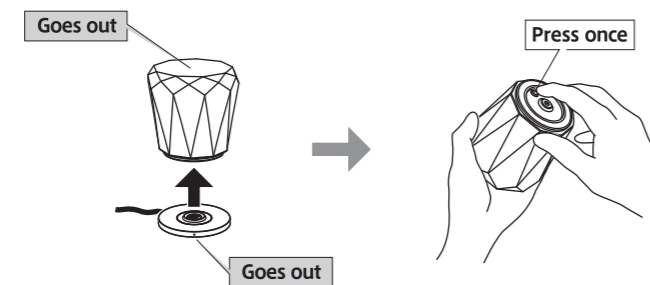

## 6 Care and Maintenance

To keep this product in optimal condition, please follow these maintenance guidelines.

- Turn off the power and disconnect the attached cable before cleaning the product.

- Use a soft, lint-free cloth to gently wipe the crystal glass shade and aluminum base.

- If the crystal glass shade is dirty, clean it with a cloth dampened with water or diluted detergent. Wipe off any moisture with a soft, dry lint-free cloth.

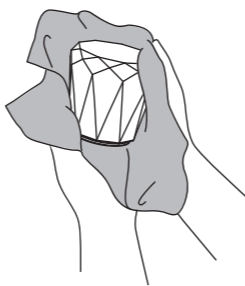

### CAUTION

- Do not use organic solvents or abrasive cleaners such as spray liquid cleaners, benzine, alcohol, or paint thinners. Use of those substances may crack, fog the glossy appearance, or cause the surface finish to peel, as well as hasten distortion and deterioration.

- The crystal glass shade is fragile and easily scratched. Handle it carefully. Avoid dropping or bumping it.

- If the terminal or silicone sheet (black sheet around the terminal) on the bottom is dirty, wipe it with a moistened, soft, lint-free cloth.

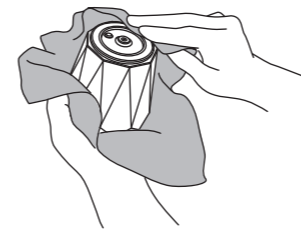

- If dirt or dust gets in the terminal on the charger stand, carefully remove with a cotton swab or similar soft object. Do not use a metallic tool such as tweezers.



- When the inner surface of the crystal glass shade or aluminum base gets dirty, the shade can be removed by turning it counterclockwise.

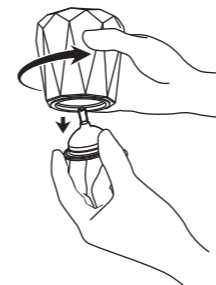

### CAUTION

- Never touch the LED which is an easily damaged precision component.

## 7 Product Specifications

Product name	Xtal Acrux				
Product code	XL2-AX				
Main materials	Main body/Shade	Crystal glass			
	Main body/Base	Aluminum, Silicone rubber, ABS, etc.			
	Charger stand	Zinc alloy, Silicone rubber, ABS			
Surface treatment	Main body	Not processed			
	Charger stand	Anodizing (Black)			
Dimensions (mm)	Main body	Outer diamete: $\Phi 87$	Height: 82		
	Charger stand	Outer diamete: $\Phi 62$	Height: 8		
Weight (g)	Main body	740			
	Charger stand	85			
Light source	LED *1*2				
Dimming level		LOW	MID	HIGH	
	Battery run time(h)	Battery power mode	32	16	8
		USB power mode	Until battery is exhausted		
Color temperature (K)	2000				
Recharging time	Approx. 3hours*3				
Recharging cycle	Approx. 500 times*4				
Power supply	Rechargeable lithium-ion battery, 3.7V/190mAh				
Waterproofing	Main body	IPX6 equivalent*5			
	Charger stand	Not waterproof			
Operating temperature (°C)	0~40				
Dimensions (mm)	Main body only: 82 Including charging stand: 90				

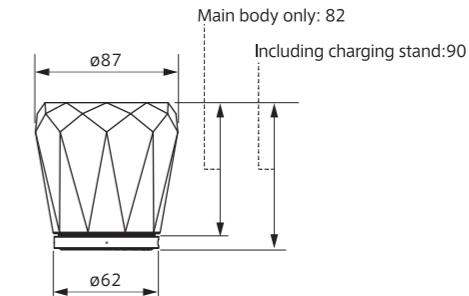

\*1 The brightness of the LED elements decreases by about 70% after about 40,000 hours of use.  
 \*2 The color and brightness of each individual LED element's light varies even when used in a light source with the same product code.  
 \*3 Varies depending on operating conditions and environments.  
 \*4 Applies when the battery performance drops below 50%.  
 \*5 IPX6 means the degree of liquid ingress protection at which "water projected in powerful jets against the enclosure from any direction shall have no harmful effects".  
 \*6 The LED Modules with the crystal glass shade removed is not weatherproof.

## MEMO

# Ambientec

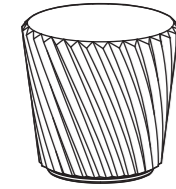

## Xtal Becrux

Design Ryuichi Kozeki

Xtal Becrux  
XL2-BX

### Instructions

Thank you for purchasing "the Ambientec Xtal Becrux". Please read these instructions thoroughly before using the product.

#### Contents

1 Safety Precautions
2 Package Contents and Nomenclature
3 Before Using the Product
4 Waterproof Specifications
5 Operation
6 Care and Maintenance
7 Product Specifications

### 1 Safety Precautions

- To use the product correctly and safely, be sure to read the Safety Precautions before use. The Safety Precautions include critical information for safety. Be sure to heed them.
- The following symbols indicate the degree of risk or damage that may result if the information given after each symbol is ignored and the product is used improperly.

	<b>DANGER</b> Indicates an imminently hazardous situation which, if not avoided, will result in death or serious injury.
	<b>WARNING</b> Indicates a potentially hazardous situation which, if not avoided, could result in death or serious injury.
	<b>CAUTION</b> Indicates a potentially hazardous situation which, if not avoided, may result in minor/moderate injury or equipment damage.

If the product is used improperly and any of the following **DANGER**, **WARNING**, or **CAUTION** information is ignored, there is potential for fire, heat generation, damage, or leakage that may cause burns, injury, or loss of sight.

	Indicates "prohibited" actions that must not be performed.
	Indicates "compulsory" actions that must be performed.

#### **DANGER**

- Do not put the product in a fire or heat it in an oven.
- Do not expose the product to high temperatures or leave it in a place where it is subject to direct sunlight.
- Do not place the product within reach of infants and children.
- Do not open or modify the product.
- Do not apply an impact to the product by dropping it, throwing it, etc.
- Do not bring the LED light close to your eyes or look at it when it is lit.
- Disconnect the product immediately if you notice smoke or smell something burning.
- When carrying the main body, make sure that the crystal glass shade is fitted securely to the aluminum base. If it is loose, the base may fall off when the acrylic shade is lifted.

#### **WARNING**

- Do not place the product in an area exposed to direct sunlight; otherwise, the product's glass shade could focus the sun's rays and cause a fire.
- Do not short-circuit the recharging terminal of the main body or charger stand with a metal pin or other metallic object.
- Do not cover the product with cloth, paper, or any other easily flammable material.
- Keep water and other liquids away from the AC adapter and charger stand and do not use them while they are wet. Also do not plug or unplug the AC adapter and other connectors with a wet hand.
- Do not use the USB cable if it is damaged.
- Do not swing or throw the main body.
- Always supply power within the rated voltage range (100 to 240 V AC) of the AC adapter.
- Inspect the AC adapter, household power outlet, and the recharging terminals periodically to ensure that they are free of accumulated dust.
- Insert the plug of the AC adapter into the power outlet all the way.

#### **CAUTION**

- Do not place the product on an unstable or tilted surface.
- Do not leave the product outdoors for a long time to avoid damage from weather and strong sunlight.
- When the product is not to be used for a long period, disconnect the AC adapter and USB cable.
- Use and store the product under an ambient temperature between 0°C and 40°C.

### 2 Package Contents and Nomenclature

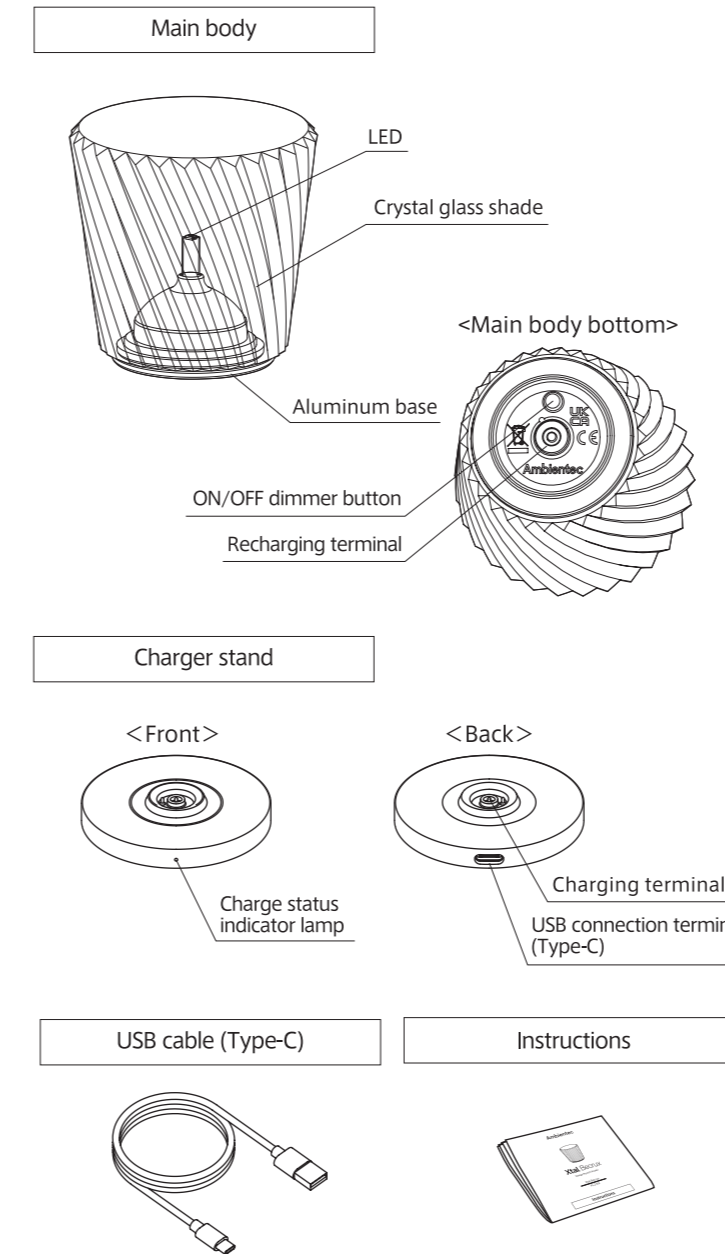

\* Thanks to widespread use of computers and mobile phones, most people today already possess a USB-compatible AC adapter. To minimize waste, AC adapter is not provided with this product.

\* In addition to the optional AMB-AC02 USB AC adapter, you can also use a USB AC adapter compatible with an output of 5 V DC, 1 A or more.

### 3 Before Using the Product

- Be sure to charge the product before using it for the first time or when it hasn't been used for a long period.
- Before use, always makes sure the crystal glass shade and aluminum base are securely attached to one another and that the fitting is not loose.

#### [1] External appearance

Since the crystal glass shade on this product is molded using a special method, each shade is unique and will differ slightly from other shades. However, only shades that have met the quality standard for the product are shipped.

#### [2] Connecting and charging the charger stand

- Connect the smaller connector (Type-C side) of the USB cable to the USB connection terminal on the charger stand (①).  
Note: Although a commercially available USB Type-C cable can also be used, it may sometimes not be used depending on its configuration.

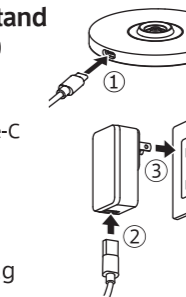

- Connect the larger connector (USB side) of the USB cable to the AC adapter (②) and plug the AC adapter into the wall outlet (③).  
Note: Be sure to use the provided AC adapter (AMB-AC02) to charge the product.

- Place the main body on the charger stand. Charging starts, and the charge status indicator lamp illuminates (④). When charging is complete, the charge status indicator lamp goes out. (If the LED on the main body is lit, it goes out when the main body is placed on the charger stand.)

- The charge status indicator lamp goes out when charging is complete. When the main body is removed from the charger stand, the LED automatically turns on (⑤).

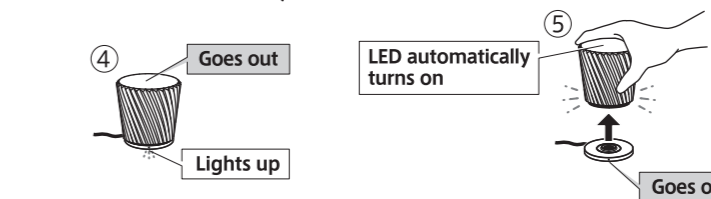

#### [3] Error warning

If the product detects heat generation from the battery and control circuit board or an abnormality in the power supply, the protection function may be activated, in which case the charge status indicator lamp starts blinking and charging is not possible. Should this be the case, remove the main body from the charger stand, wait for a while, and the replace the main body on the charger stand to resume charging.

### 4 Waterproof Specifications

- The main body of this product is designed waterproof (IPX6\* equivalent) but it cannot be used underwater, for example in a bathtub.  
\*IPX6 means the degree of liquid ingress protection at which "water projected in powerful jets against the enclosure from any direction shall have no harmful effects".

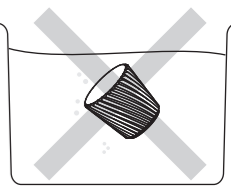

- The charger stand and AC adapter are not waterproof. Make sure they don't get wet.

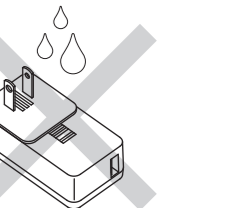

Be sure to adhere to the following cautions when using the product in a bathroom or similar environment

#### **CAUTION**

- Do not leave the product for a long time in a high-temperature, high-humidity bathroom or sauna.
- Do not place the product on a poorly drained bathroom floor or similar environment.



## 5 Operation

In addition to the Battery Power mode for cordless use, the Xtal is also provided with a USB Power mode which keeps the main body illuminated as long as power is supplied and charges the battery when the main body is placed on the charger stand.

### [ 1 ] Battery Power mode for cordless use

- The main body goes out when it is placed on the charger stand and lights up when removed from the stand.

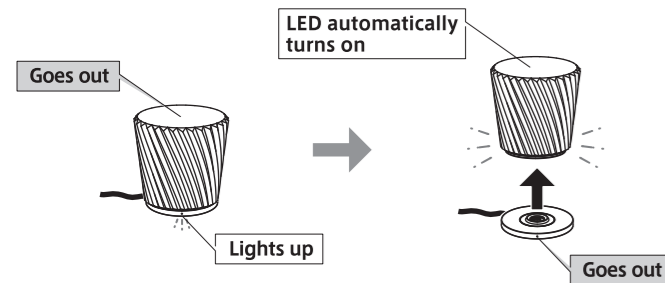

### < Operation using the ON/OFF dimmer button >

- The brightness of the Battery Power mode can be adjusted in two steps. Each time the ON/OFF dimmer button on the bottom of the main unit is pressed, the brightness level changes in the following order: OFF → LOW → MID → HIGH → OFF, and so on.

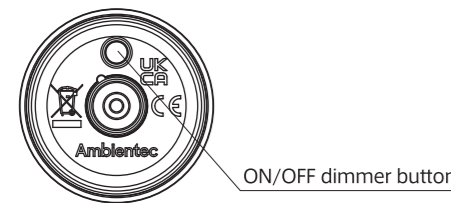

### [ 2 ] USB Power mode for lighting up the main body when it has been charged on the charger stand

#### < Switching from the Battery Power mode >

- Keep the ON/OFF dimmer button pressed until the LED on the main body starts blinking slowly. When it starts blinking, place the main body on the charger stand. The main body will light up while it is charging.

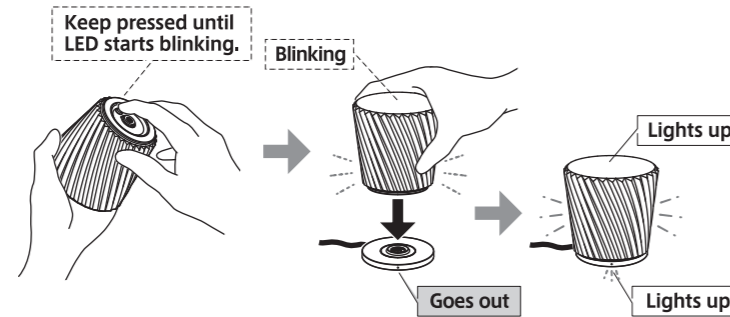

- The brightness changes in three levels in the USB Power mode. The brightness level activated when the USB Power mode is engaged depends on which brightness level was activated in the Battery Power mode as shown below.

Note: The ON/OFF dimmer button is inoperable when in the USB Power mode.

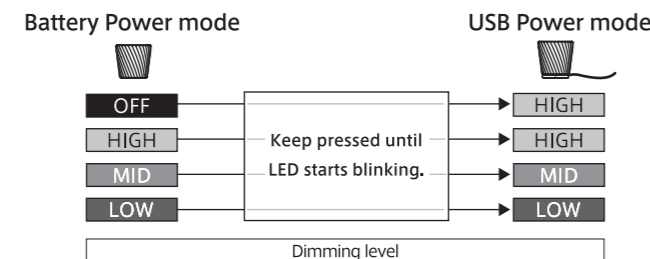

- When the main body is removed from the charger stand, the main body goes out. To return to the Battery Power mode, press the ON/OFF dimmer button once; the main body will light up.

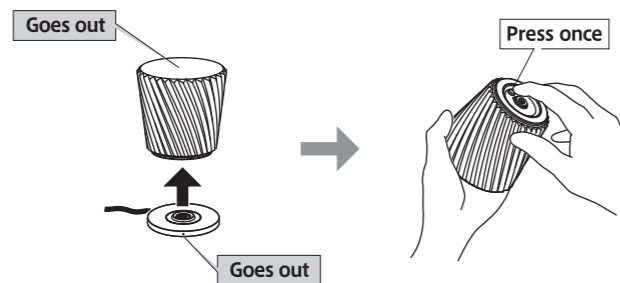

## 6 Care and Maintenance

To keep this product in optimal condition, please follow these maintenance guidelines.

- ❗ Turn off the power and disconnect the attached cable before cleaning the product.

- Use a soft, lint-free cloth to gently wipe the crystal glass shade and aluminum base.

- If the crystal glass shade is dirty, clean it with a cloth dampened with water or diluted detergent. Wipe off any moisture with a soft, dry lint-free cloth.

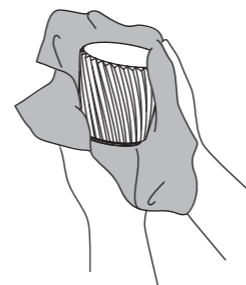

### ⚠ CAUTION

- ⊘ Do not use organic solvents or abrasive cleaners such as spray liquid cleaners, benzine, alcohol, or paint thinners. Use of those substances may crack, fog the glossy appearance, or cause the surface finish to peel, as well as hasten distortion and deterioration.

- ❗ The crystal glass shade is fragile and easily scratched. Handle it carefully. Avoid dropping or bumping it.

- If the terminal or silicone sheet (black sheet around the terminal) on the bottom is dirty, wipe it with a moistened, soft, lint-free cloth.

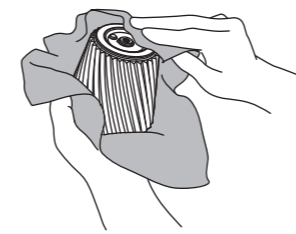

- If dirt or dust gets in the terminal on the charger stand, carefully remove with a cotton swab or similar soft object. Do not use a metallic tool such as tweezers.



- When the inner surface of the crystal glass shade or aluminum base gets dirty, the shade can be removed by turning it counterclockwise.

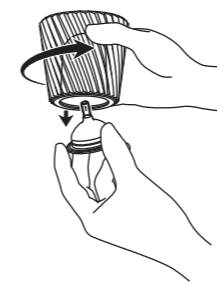

### ⚠ CAUTION

- ⊘ Never touch the LED which is an easily damaged precision component.

## 7 Product Specifications

Product name	Xtal Becrux			
Product code	XL2-BX			
Main materials	Main body/Shade	Crystal glass		
	Main body/Base	Aluminum, Silicone rubber, ABS, etc.		
	Charger stand	Zinc alloy, Silicone rubber, ABS		
Surface treatment	Main body	Not processed		
	Charger stand	Anodizing (Black)		
Dimensions (mm)	Main body	Outer diamete: Φ85	Height: 82	
	Charger stand	Outer diamete: Φ62	Height: 8	
Weight (g)	Main body	700		
	Charger stand	85		
Light source	LED*1+2			
Dimming level	LOW	MID	HIGH	
Battery run time(h)	Battery power mode	32	16	8
	USB power mode	Until battery is exhausted		
Color temperature (K)	2000			
Recharging time	Approx. 3hours*3			
Recharging cycle	Approx. 500 times*4			
Power supply	Rechargeable lithium-ion battery, 3.7V/190mAh			
Waterproofing	Main body	IPX6 equivalent*5		
	Charger stand	Not waterproof		
Operating temperature (°C)	0~40			
Dimensions (mm)				

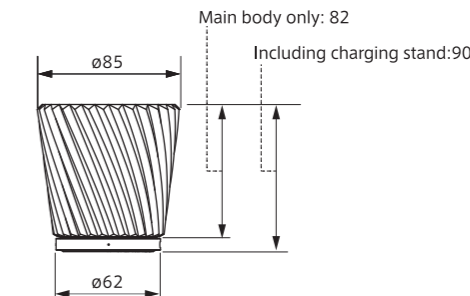

- \*1 The brightness of the LED elements decreases by about 70% after about 40,000 hours of use.
- \*2 The color and brightness of each individual LED element's light varies even when used in a light source with the same product code.
- \*3 Varies depending on operating conditions and environments.
- \*4 Applies when the battery performance drops below 50%.
- \*5 IPX6 means the degree of liquid ingress protection at which "water projected in powerful jets against the enclosure from any direction shall have no harmful effects".
- \*6 The LED Modules with the crystal glass shade removed is not weatherproof.

Design and specifications are subject to change without notice.

## MEMO

# Ambientec

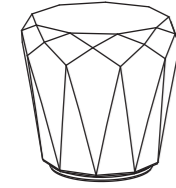

## Xtal Acrux | Dark Gray

Design Ryuichi Kozeki

Xtal Acrux / Darkgray  
XL2-AXGRY

### Instructions

Thank you for purchasing "the Ambientec Xtal Acrux / Darkgray".  
Please read these instructions thoroughly before using the product.

#### Contents

1 Safety Precautions
2 Package Contents and Nomenclature
3 Before Using the Product
4 Waterproof Specifications
5 Operation
6 Care and Maintenance
7 Product Specifications

## 1 Safety Precautions

- To use the product correctly and safely, be sure to read the Safety Precautions before use. The Safety Precautions include critical information for safety. Be sure to heed them.
- The following symbols indicate the degree of risk or damage that may result if the information given after each symbol is ignored and the product is used improperly.

	<b>DANGER</b> Indicates an imminently hazardous situation which, if not avoided, will result in death or serious injury.
	<b>WARNING</b> Indicates a potentially hazardous situation which, if not avoided, could result in death or serious injury.
	<b>CAUTION</b> Indicates a potentially hazardous situation which, if not avoided, may result in minor/moderate injury or equipment damage.

If the product is used improperly and any of the following **DANGER, WARNING, or CAUTION** information is ignored, there is potential for **fire, heat generation, damage, or leakage that may cause burns, injury, or loss of sight.**

	Indicates "prohibited" actions that must not be performed.
	Indicates "compulsory" actions that must be performed.

### DANGER

- Do not put the product in a fire or heat it in an oven.
- Do not expose the product to high temperatures or leave it in a place where it is subject to direct sunlight.
- Do not place the product within reach of infants and children.
- Do not open or modify the product.
- Do not apply an impact to the product by dropping it, throwing it, etc.
- Do not bring the LED light close to your eyes or look at it when it is lit.
- Disconnect the product immediately if you notice smoke or smell something burning.
- When carrying the main body, make sure that the crystal glass shade is fitted securely to the aluminum base. If it is loose, the base may fall off when the acrylic shade is lifted.

### WARNING

- Do not place the product in an area exposed to direct sunlight; otherwise, the product's glass shade could focus the sun's rays and cause a fire.
- Do not short-circuit the recharging terminal of the main body or charger stand with a metal pin or other metallic object.
- Do not cover the product with cloth, paper, or any other easily flammable material.
- Keep water and other liquids away from the AC adapter and charger stand and do not use them while they are wet. Also do not plug or unplug the AC adapter and other connectors with a wet hand.
- Do not use the USB cable if it is damaged.
- Do not swing or throw the main body.

- Always supply power within the rated voltage range (100 to 240 V AC) of the AC adapter.

- Inspect the AC adapter, household power outlet, and the recharging terminals periodically to ensure that they are free of accumulated dust.

- Insert the plug of the AC adapter into the power outlet all the way.

### CAUTION

- Do not place the product on an unstable or tilted surface.
- Do not leave the product outdoors for a long time to avoid damage from weather and strong sunlight.
- When the product is not to be used for a long period, disconnect the AC adapter and USB cable.
- Use and store the product under an ambient temperature between 0°C and 40°C.

## 2 Package Contents and Nomenclature

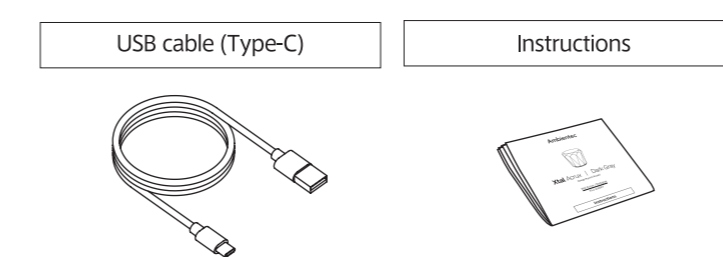
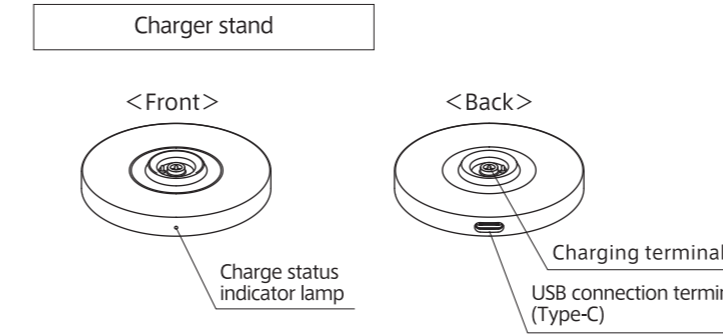
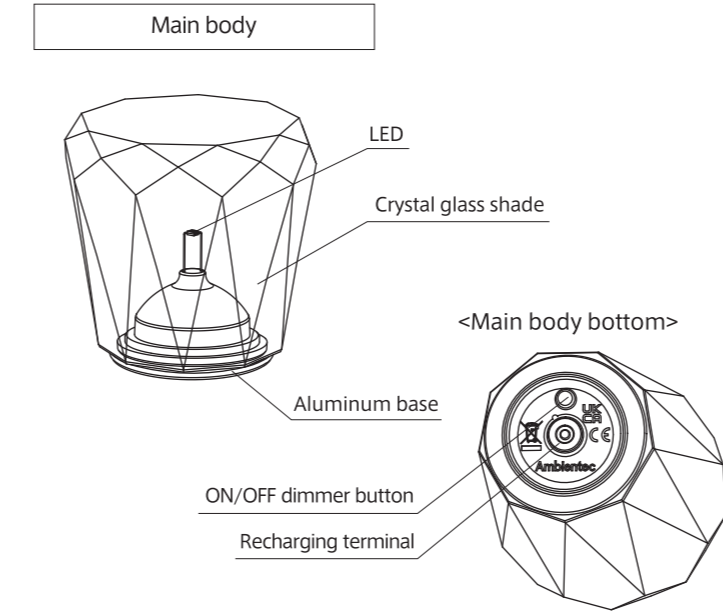

\* Thanks to widespread use of computers and mobile phones, most people today already possess a USB-compatible AC adapter. To minimize waste, AC adapter is not provided with this product.

\* In addition to the optional AMB-AC02 USB AC adapter, you can also use a USB AC adapter compatible with an output of 5 V DC, 1 A or more.

## 3 Before Using the Product

- Be sure to charge the product before using it for the first time or when it hasn't been used for a long period.
- Before use, always makes sure the crystal glass shade and aluminum base are securely attached to one another and that the fitting is not loose.

### [1] External appearance

Since the crystal glass shade on this product is molded using a special method, each shade is unique and will differ slightly from other shades. However, only shades that have met the quality standard for the product are shipped.

### [2] Connecting and charging the charger stand

- Connect the smaller connector (Type-C side) of the USB cable to the USB connection terminal on the charger stand (①).  
**Note:** Although a commercially available USB Type-C cable can also be used, it may sometimes not be used depending on its configuration.

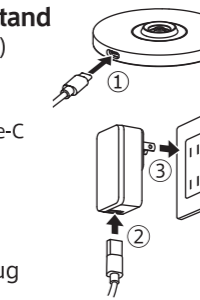

- Connect the larger connector (USB side) of the USB cable to the AC adapter (②) and plug the AC adapter into the wall outlet (③).  
**Note:** Be sure to use the provided AC adapter (AMB-AC02) to charge the product.

- Place the main body on the charger stand. Charging starts, and the charge status indicator lamp illuminates (④). When charging is complete, the charge status indicator lamp goes out. (If the LED on the main body is lit, it goes out when the main body is placed on the charger stand.)

- The charge status indicator lamp goes out when charging is complete. When the main body is removed from the charger stand, the LED automatically turns on (⑤).

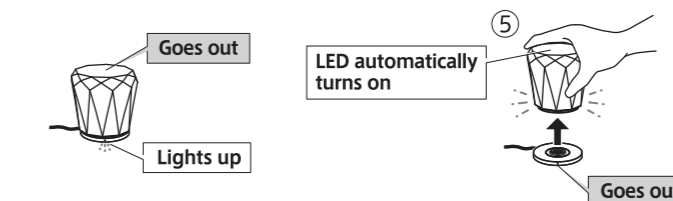

### [3] Error warning

If the product detects heat generation from the battery and control circuit board or an abnormality in the power supply, the protection function may be activated, in which case the charge status indicator lamp starts blinking and charging is not possible. Should this be the case, remove the main body from the charger stand, wait for a while, and the replace the main body on the charger stand to resume charging.

## 4 Waterproof Specifications

- The main body of this product is designed waterproof (IPX6\* equivalent) but it cannot be used underwater, for example in a bathtub.  
\*IPX6 means the degree of liquid ingress protection at which "water projected in powerful jets against the enclosure from any direction shall have no harmful effects".

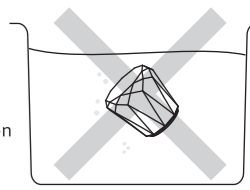

- The charger stand and AC adapter are not waterproof. Make sure they don't get wet.

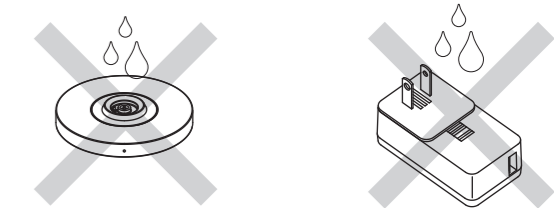

### Be sure to adhere to the following cautions when using the product in a bathroom or similar environment

#### CAUTION

- Do not leave the product for a long time in a high-temperature, high-humidity bathroom or sauna.
- Do not place the product on a poorly drained bathroom floor or similar environment.



## 5 Operation

In addition to the Battery Power mode for cordless use, the Xtal is also provided with a USB Power mode which keeps the main body illuminated as long as power is supplied and charges the battery when the main body is placed on the charger stand.

### [1] Battery Power mode for cordless use

- The main body goes out when it is placed on the charger stand and lights up when removed from the stand.

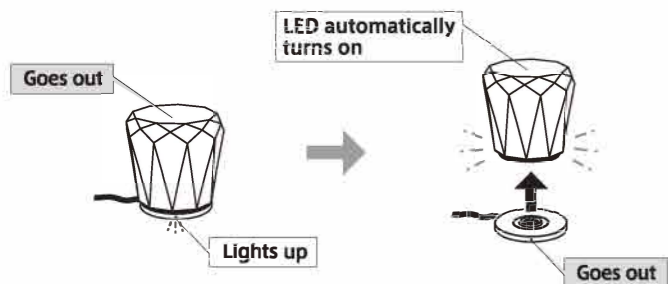

### <Operation using the ON/OFF dimmer button>

- The brightness of the Battery Power mode can be adjusted in two steps. Each time the ON/OFF dimmer button on the bottom of the main unit is pressed, the brightness level changes in the following order: OFF → LOW → MID → HIGH → OFF, and so on.



### [2] USB Power mode for lighting up the main body when it has been charged on the charger stand

#### <Switching from the Battery Power mode>

- Keep the ON/OFF dimmer button pressed until the LED on the main body starts blinking slowly. When it starts blinking, place the main body on the charger stand. The main body will light up while it is charging.

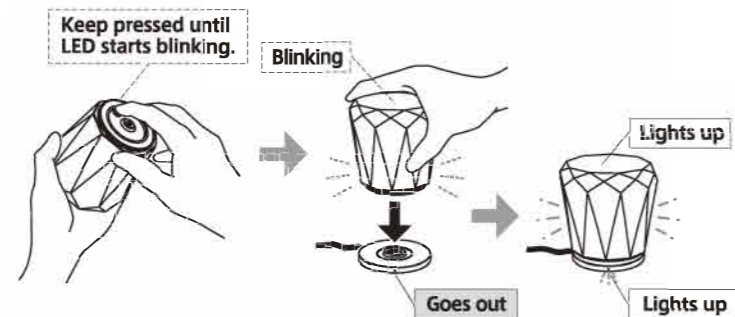

- The brightness changes in three levels in the USB Power mode. The brightness level activated when the USB Power mode is engaged depends on which brightness level was activated in the Battery Power mode as shown below.

Note: The ON/OFF dimmer button is inoperable when in the USB Power mode.

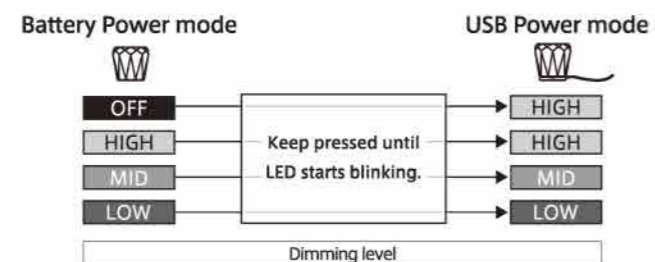

- When the main body is removed from the charger stand, the main body goes out. To return to the Battery Power mode, press the ON/OFF dimmer button once; the main body will light up.

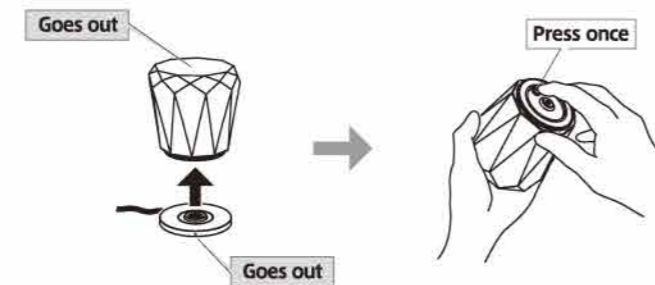

## 6 Care and Maintenance

To keep this product in optimal condition, please follow these maintenance guidelines.

- Turn off the power and disconnect the attached cable before cleaning the product.

- Use a soft, lint-free cloth to gently wipe the crystal glass shade and aluminum base.

- If the crystal glass shade is dirty, clean it with a cloth dampened with water or diluted detergent. Wipe off any moisture with a soft, dry lint-free cloth.



### CAUTION

- Do not use organic solvents or abrasive cleaners such as spray liquid cleaners, benzene, alcohol, or paint thinners. Use of those substances may crack, fog the glossy appearance, or cause the surface finish to peel, as well as hasten distortion and deterioration.

- The crystal glass shade is fragile and easily scratched. Handle it carefully. Avoid dropping or bumping it.

- If the terminal or silicone sheet (black sheet around the terminal) on the bottom is dirty, wipe it with a moistened, soft, lint-free cloth.

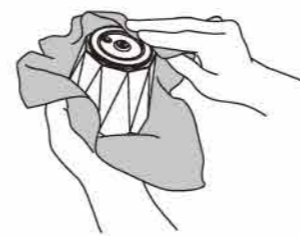

- If dirt or dust gets in the terminal on the charger stand, carefully remove with a cotton swab or similar soft object. Do not use a metallic tool such as tweezers.



- When the inner surface of the crystal glass shade or aluminum base gets dirty, the shade can be removed by turning it counterclockwise.



### CAUTION

- Never touch the LED which is an easily damaged precision component.

## 7 Product Specifications

Product name	Xtal Acrux / Darkgray			
Product code	XL2-AXGRY			
Main materials	Main body/Shade	Crystal glass		
	Main body/Base	Aluminum, Silicone rubber, ABS, etc.		
	Charger stand	Zinc alloy, Silicone rubber, ABS		
Surface treatment	Main body	Not processed		
	Charger stand	Anodizing (Black)		
Dimensions (mm)	Main body	Outer diamete: $\Phi 87$	Height: 82	
	Charger stand	Outer diamete: $\Phi 62$	Height: 8	
Weight (g)	Main body	740		
	Charger stand	85		
Light source	LED*1*2			
Dimming level		LOW	MID	HIGH
Battery run time(h)	Battery power mode	32	16	8
	USB power mode	Until battery is exhausted		
Color temperature (K)	2000			
Recharging time	Approx. 3hours*3			
Recharging cycle	Approx. 500 times*4			
Power supply	Rechargeable lithium-ion battery, 3.7V/190mAh			
Waterproofing	Main body	IPX6 equivalent*5		
	Charger stand	Not waterproof		
Operating temperature (°C)	0~40			
Dimensions (mm)	Main body only: 82 Including charging stand: 90			

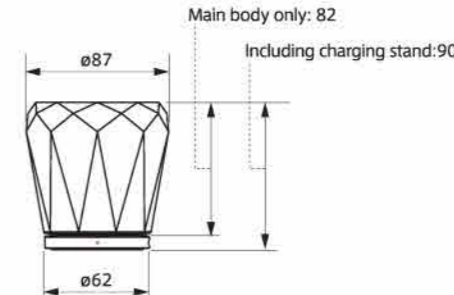

- \*1 The brightness of the LED elements decreases by about 70% after about 40,000 hours of use.
- \*2 The color and brightness of each individual LED element's light varies even when used in a light source with the same product code.
- \*3 Varies depending on operating conditions and environments.
- \*4 Applies when the battery performance drops below 50%.
- \*5 IPX6 means the degree of liquid ingress protection at which "water projected in powerful jets against the enclosure from any direction shall have no harmful effects".
- \*6 The LED Modules with the crystal glass shade removed is not weatherproof.

Design and specifications are subject to change without notice.

## MEMO