

# Ambientec

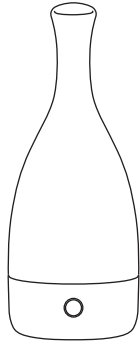

## Bottled

Design Ryuichi Kozeki

Bottled  
Matte Silver

BL002-11S

### Instructions

Thank you for purchasing the Ambientec Bottled.  
Please read these instructions thoroughly before using the product.

#### Contents

- 1 Safety Precautions
- 2 Package Contents and Nomenclature
- 3 Before Using the Product
- 4 USB AC Adapter
- 5 Dustproof and Waterproof Specifications
- 6 Operation
- 7 Care and Maintenance
- 8 Disposing of This Product
- 9 Product Specifications

Ambientec Corporation  
<https://ambientec.co.jp/>

## 1 Safety Precautions

- To use the product correctly and safely, be sure to read the Safety Precautions before use. The Safety Precautions include critical information for safety. Be sure to heed them.
- The following symbols indicate the degree of risk or damage that may result if the information given after each symbol is ignored and the product is used improperly.

**⚠ DANGER** Indicates an imminently hazardous situation which, if not avoided, will result in death or serious injury.

**⚠ WARNING** Indicates a potentially hazardous situation which, if not avoided, could result in death or serious injury.

**⚠ CAUTION** Indicates a potentially hazardous situation which, if not avoided, may result in minor/moderate injury or equipment damage.

**If the product is used improperly and any of the following DANGER, WARNING, or CAUTION information is ignored, there is potential for fire, heat generation, damage, or leakage that may cause burns, injury, or loss of sight.**

**⊘** Indicates "prohibited" actions that must not be performed.

**!** Indicates "compulsory" actions that must be performed.

### ⚠ DANGER

- ⊘ Do not put the product in a fire or heat it in an oven.
- ⊘ Do not expose the product to high temperatures or leave it in a place where it is subject to direct sunlight.
- ⊘ Do not place the product within reach of infants and children.
- ⊘ Do not open or modify the product.
- ⊘ Do not apply an impact to the product by dropping it, throwing it, etc.
- ⊘ Do not bring the LED light close to your eyes or look at it when it is lit.
- ⊘ Never open the Aluminum base except when you are going to dispose of the product.
- ! Disconnect the product immediately if you notice smoke or smell something burning.
- ! If you pick up the main body of the lamp by lifting it with the glass shade, it is possible the aluminum base will fall off if they are not fitted together tightly. Make sure they are tightly secured and be

careful when picking up the unit.

### ⚠ WARNING

- ⊘ Do not place the product in an area exposed to direct sunlight; otherwise, the product's glass shade could focus the sun's rays and cause a fire.
- ⊘ Do not short-circuit the recharging terminal of the main body or charger stand with a metal pin or other metallic object.
- ⊘ Do not cover the product with cloth, paper, or any other easily flammable material.
- ⊘ Keep water and other liquids away from the AC adapter and charger stand and do not use them while they are wet. Also do not plug or unplug the AC adapter and other connectors with a wet hand.
- ⊘ Do not use the USB cable if it is damaged.
- ⊘ Do not swing or throw the main body.
- ! Always supply power within the rated voltage range (100 to 240 V AC) of the AC adapter.
- ! Inspect the AC adapter, household power outlet, and the recharging terminals periodically to ensure that they are free of accumulated dust.
- ! Insert the plug of the AC adapter into the power outlet all the way.

### ⚠ CAUTION

- ⊘ Do not place the product on an unstable or tilted surface.
- ⊘ Do not leave the product outdoors for a long time to avoid damage from weather and strong sunlight.
- ⊘ Do not remove the glass shade except when the product is to be discarded or to be sent to your service representative for battery replacement.
- ! When the product is not to be used for a long period, disconnect the AC adapter and USB cable.
- ! Use and store the product under an ambient temperature between 0°C and 40°C.

## 2 Package Contents and Nomenclature

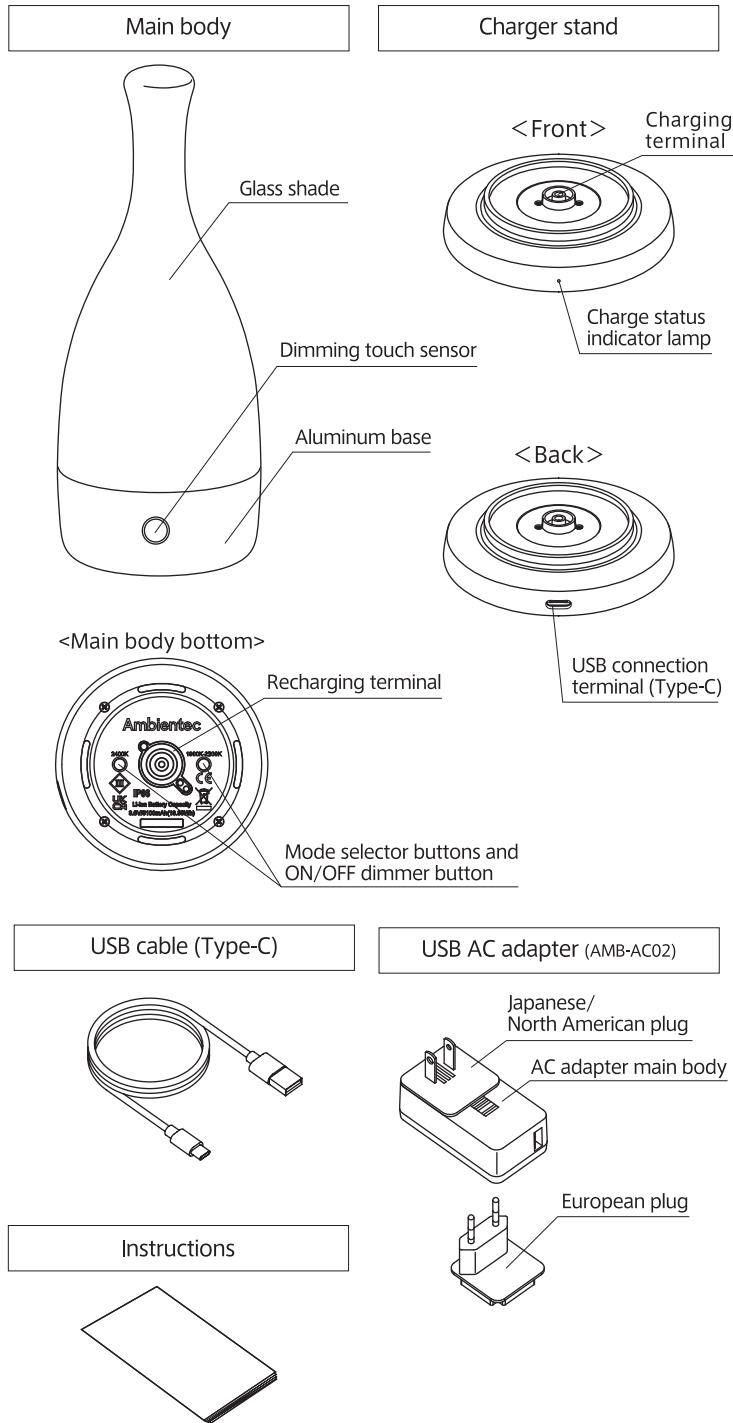

## 3 Before Using Product

- Be sure to charge the product before using it for the first time or when it hasn't been used for a long period.
- Every time you use the product, be sure to first confirm that the glass shade and aluminum base are snugly fitted and that there is no looseness.

### [1] External appearance

Despite its robust, near-unbreakable design, the glass shade gives off illumination that feels airy and transparent. Each and every one of our shades is custom-built by a craftsman using our original manufacturing method. This means that no two shades are exactly alike and occasional mild imperfections such as bubbles or distortion may be present. However, no shade is shipped to market unless it meets our rigorous quality standards.

### [2] Connecting and charging the charger stand

- Connect the smaller connector (Type-C side) of the USB cable to the USB connection terminal on the charger stand (①).

Note: Although a commercially available USB Type-C cable can also be used, it may sometimes not be used depending on its configuration.

- Connect the larger connector (USB side) of the USB cable to the AC adapter (②) and plug the AC adapter into the wall outlet (③).

Note: Be sure to use the provided AC adapter (AMB-AC02) to charge the product.

- Place the main body on the charger stand. Charging starts, and the charge status indicator lamp illuminates (④). When charging is complete, the charge status indicator lamp goes out. To turn the light on and off while charging the product, use the dimming touch sensor. (If the LED on the main body is lit, it goes out when the main body is placed on the charger stand.)

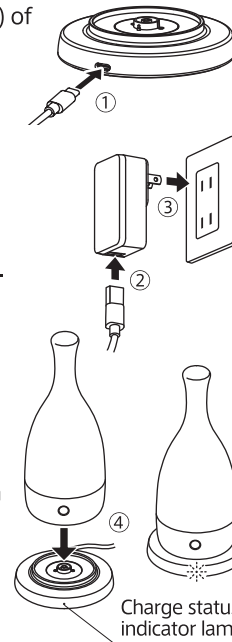

### [3] Error warning

If the product detects heat generation from the battery and control circuit board or an abnormality in the power supply, the protection function may be activated, in which case the charge status indicator lamp starts blinking and charging is not possible. Should this be the case, remove the main body from the charger stand, wait for a while, and then replace the main body on the charger stand to resume charging.

## 4 USB AC Adapter

### < How to attach the plug >

- While pushing the plug into the plug mount on the AC adapter's main body, slide the plug towards the PUSH button until it clicks. The mounting direction of the plug can be changed by 90 degrees in 4 ways to suit the location of use.

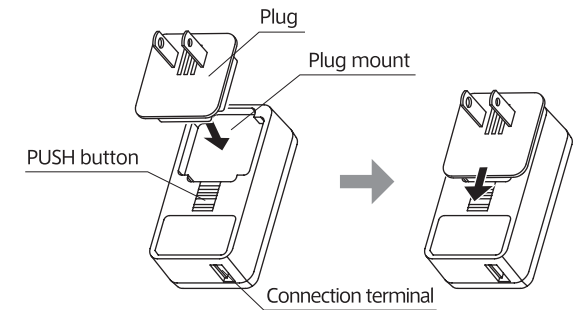

### In case the AC adapter does not work

#### ⚠ CAUTION

- If the plug is not securely attached to the AC adapter's main body, the AC adapter will not work. As a result, it may not be possible to charge the battery, adjust the brightness, or turn on the light.

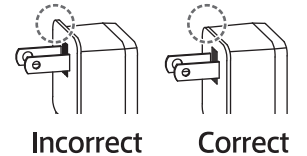

### < How to detach the plug >

- While pushing the PUSH button, slide the plug away from the PUSH button and pull it out.

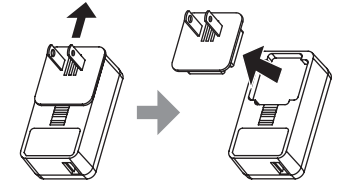

If only the plug remains attached to the wall outlet, reattach the AC adapter's main body to the plug in the order shown on the right and then remove the AC adapter from the wall outlet.

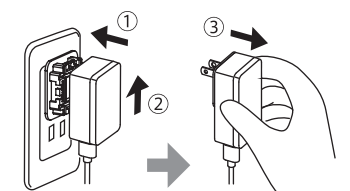

#### ⚠ WARNING

- Never use a metallic tool to remove the plug from the wall outlet.
- Do not touch the electrical contacts; electrical shock may result.

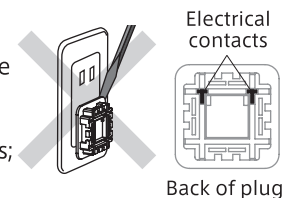

## 5 Dustproof and Waterproof Specifications

- While the LED module is dustproof and waterproof (IP66 equivalent\*), the glass shade and aluminum base are not. Consequently, this product cannot be used underwater. Do not immerse it in a bathtub or other water container.

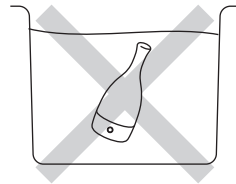

\*Indicates protection from dust and high-pressure water jets from any direction.

- The charger stand and AC adapter are not waterproof. Make sure they don't get wet.

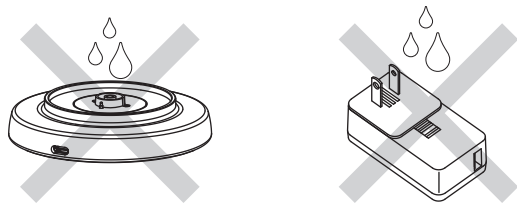

### Be sure to adhere to the following cautions when using the product in a bathroom or similar environment

#### ⚠ CAUTION

- ⊘ Do not leave the product for a long time in a high-temperature, high-humidity bathroom or sauna.
- ⊘ Do not place the product on a poorly drained bathroom floor or similar environment.



## 6 Operation

### [1] Activating the operation of the dimming touch sensor

The dimming touch sensor is deactivated when the product is shipped from the factory.

Pressing either of the ON/OFF dimmer buttons on the bottom of the main body sets the light to LOW intensity and activates the dimmer touch sensor.

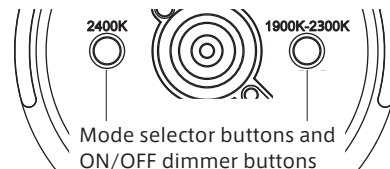

### How to deactivate the dimming touch sensor

When the product is to be stored or transported, deactivate the dimming touch sensor to prevent malfunction. Pressing and holding either of the ON/OFF dimmer buttons on the bottom of the main body for 2 seconds turns the light to LOW intensity and then off and deactivates the dimmer touch sensor.

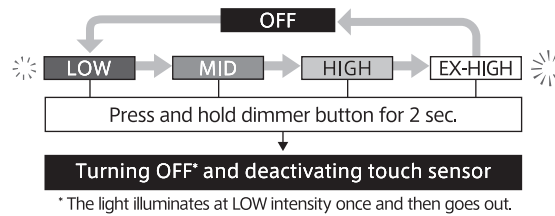

### [2] Using the dimmer touch sensor

- Each press of the dimmer touch sensor changes the dimming level in the sequence shown below.

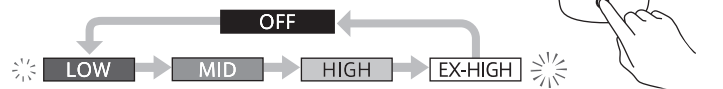

To turn off the light immediately without going through the adjustment sequence, press and hold the touch sensor (for 1 second). When the light is turned off this way, the light will come on at the same intensity the next time you press the touch sensor (Last Mode Memory function).

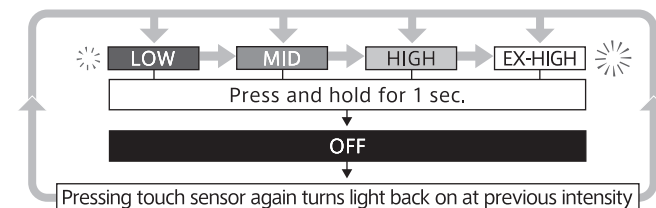

### [3] Using the mode selector buttons

- The mode selector buttons on the bottom of the main body let you switch between color modes. There are 2 color modes available: Warm, which reproduces the color and brightness and brightness of a traditional incandescent light bulb with variable color temperature of 1900 to 2300 K; and Original, which can change brightness while maintaining a fixed color temperature of 2400 K.

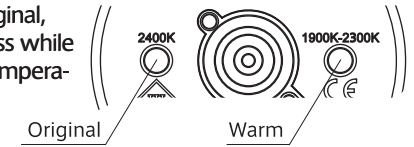

### Color temperature of general indoor lighting\*

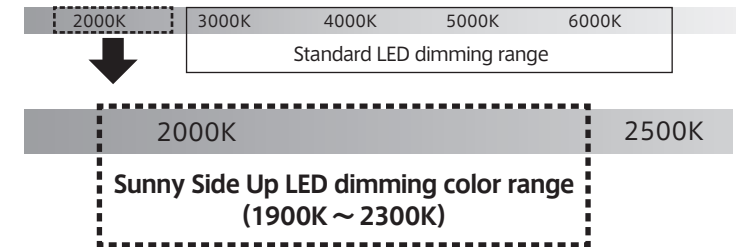

\* A characteristic of visible light that represents the color of the light and is measured in degrees of Kelvin (K). The higher the color temperature, the cooler the light.

### [4] Operation using the ON/OFF dimmer button

- While the dimming level can be changed with the dimming touch sensor, it can also be changed with either of the ON/OFF dimmer buttons on the bottom of the main body. As the button is pressed once, the dimming level changes sequentially.

### [5] If water gets on the dimmer touch sensor

- If the product is used outdoors or in a bathroom, it will become inoperable if water gets on the dimming touch sensor. (The light goes out as soon as water is detected and then goes on again automatically at the previous intensity.) If this happens, operate the product using the ON/OFF dimmer button on the bottom of the main body. Once any moisture has dried off, the dimmer touch sensor will be usable again.

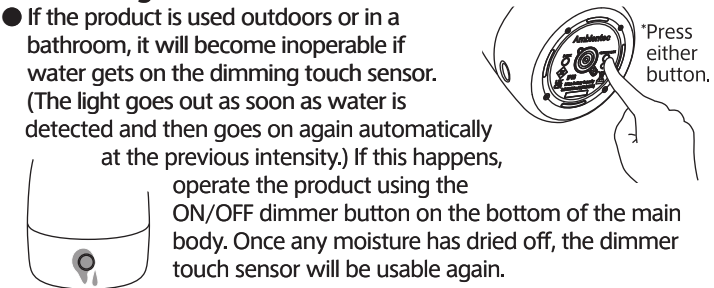

- The glass shade and aluminum base are not waterproof. If any liquid gets on the product, wipe it off. You can use the lamp again when it is completely dry.
- The charger stand and AC adapter are not waterproof. Make sure they don't get wet. If the main body gets wet, wipe off any moisture. Make sure it is completely dry before placing it on the charger stand.

## 7 Care and Maintenance

To keep this product in optimal condition, please follow these maintenance guidelines.

- ❗ Turn off the power and disconnect the attached cable before cleaning the product.

- Use a soft, lint-free cloth to gently wipe the glass shade and aluminum base.

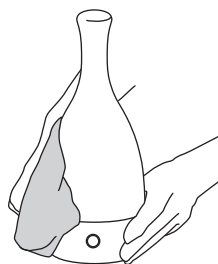

### ⚠ CAUTION

- ⊘ Do not use a liquid spray cleaner, solvent such as benzene, alcohol, thinner, or polishing agent to clean the product. Doing so may scratch the surface, reduce transparency and glossiness, and cause the surface coating to peel.

- ❗ The glass shade is very fragile. Handle it carefully. Try not to knock the product over or bang it.

- If the terminal or silicone sheet (black sheet around the terminal) on the bottom is dirty, wipe it with a moistened, soft, lint-free cloth.

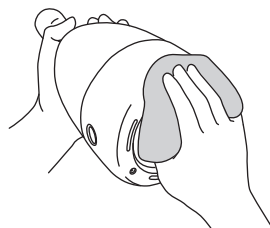

- If dirt or dust gets in the terminal on the charger stand, carefully remove with a cotton swab or similar soft object. Do not use a metallic tool such as tweezers.



## 8 Disposing of This Product

This product uses a rechargeable lithium-ion battery that contains recyclable rare earth metals. Before disposing of the product, remove the battery and dispose of it according to local regulations.

### How to remove the battery

1. Be sure to keep the light on until it goes out. This will allow the battery to discharge completely.
2. Place the aluminum base on a stable surface. While holding the aluminum base firmly, grasp the upper part of the glass shade and turn it counterclockwise to remove it (1).
3. Turn the LED module cover counterclockwise to remove it (2). Use a Phillips screwdriver to loosen the 4 screws until the top plate can be lifted as shown below (3). Be careful not to cut the attached lead line by pulling the top plate forcibly.

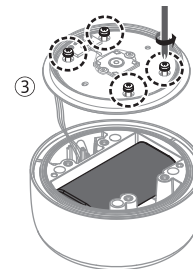
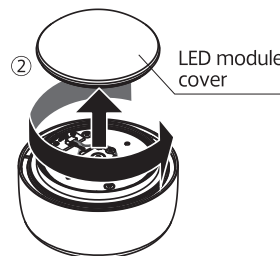

### ⚠ DANGER

- ⊘ Never open the Aluminum base except when you are going to dispose of the product.

4. Pull out the connector inside the aluminum base and remove the battery (4).

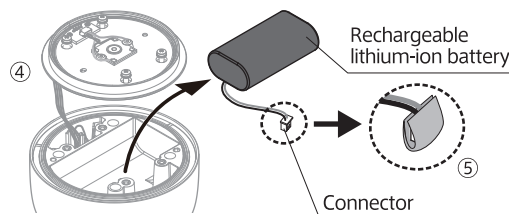

5. Affix the connector with adhesive tape for insulation (5) and dispose of the removed battery in accordance with local regulations.

## 9 Product Specifications

Product name	Bottled Matte Silver			
Product code	BL002-11S			
Light source	Ambientec-original Sunny Side Up LED *1*2			
Color rendering index	Ra 95 or more			
Dimming level	LOW	MID	HIGH	EX-HIGH
Power consumption (W)	0.05	0.25	0.75	2
Color-temperature (K)	Warm	1900	2000	2200
	Original	2400		
Battery run time (h)	200	60	20	8
Power supply	Rechargeable lithium-ion battery, 3.6V/5100 mAh			
Recharging time	Approx. 6 hours*3			
Recharging cycle	Approx. 500 times*4			
Water-proofing	Main body	LED Modules IP66 equivalent*5*6		
	Charger stand	Not waterproof		
Main-materials	Glass shade	Special painted glass		
	Aluminum base	Aluminum		
	Charger stand	LED Modules		
Surface treatment	Aluminum base	Baked painting (Silver)		
	Charger stand			
Dimensions (mm)	Main body	Outer diameter : Φ100	Height : 250	
	Charger stand	Outer diameter : Φ98		Height : 20
Weight (g)	Main body	1200		
	Charger stand	215		
Operating temperature (°C)	0~40			
Dimensions (mm)				

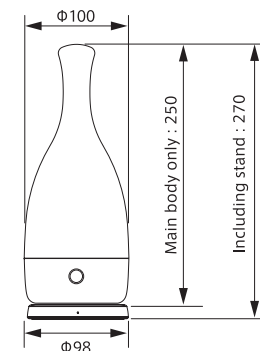

- \*1 The brightness of the LED elements decreases by about 70% after about 40,000 hours of use.
- \*2 The color and brightness of each individual LED element's light varies even when used in a light source with the same product code.
- \*3 Varies depending on operating conditions and environments.
- \*4 Applies when the battery performance drops below 50%.
- \*5 Indicates protection from dust and high-pressure water jets from any direction.
- \*6 Protects the main body from water even if moisture gets inside the glass shade. The glass shade and aluminum base are not waterproof.

Design and specifications are subject to change without notice.