

Remli

Design: we+

Remli

W-RM01

Instructions

Thank you for purchasing the Ambientec Remli.
Please read these instructions thoroughly before using the product.

Contents

1 Safety Precautions

2 Package Contents and Nomenclature

3 Before Using the Product

4 Operation

5 Protection against Dust and Water

6 Care and Maintenance

7 Product Specifications

8 Disposing of This Product

1 Safety Precautions

- To use the product correctly and safely, be sure to read the Safety Precautions before use. The Safety Precautions include critical information for safety. Be sure to heed them.
- The following symbols indicate the degree of risk or damage that may result if the information given after each symbol is ignored and the product is used improperly.

DANGER Indicates an imminently hazardous situation which, if not avoided, will result in death or serious injury.

WARNING Indicates a potentially hazardous situation which, if not avoided, could result in death or serious injury.

CAUTION Indicates a potentially hazardous situation which, if not avoided, may result in minor/moderate injury or equipment damage.

If the product is used improperly and any of the following DANGER, WARNING, or CAUTION information is ignored, there is potential for fire, heat generation, damage, or leakage that may cause burns, injury, or loss of sight.

Indicates "prohibited" actions that must not be performed.

Indicates "compulsory" actions that must be performed.

DANGER

- Do not put the product in a fire or heat it in an oven.
- Do not expose the product to high temperatures or leave it in a place where it is subject to direct sunlight.
- Do not place the product within reach of infants and children.
- Do not open or modify the product.
- Do not apply an impact to the product by dropping it, throwing it, etc.
- Do not look directly at the LED light source when it is lit.
- Do not charge the product in wet and humid environments such as outdoors or in the bathroom.
- Never loosen or remove the base of the main body except when you are going to dispose of the rechargeable lithium-ion battery.
- Disconnect the product immediately if you notice smoke or smell something burning.

WARNING

- Do not place the product in an area exposed to direct sunlight to prevent it from being discolored and deformed.
- Do not short-circuit the recharging terminal of the main body or charger stand with a metal pin or other metallic object.
- Do not cover the product with cloth, paper, or any other easily flammable material.
- Keep water and other liquids away from the AC adapter and charger stand and do not use them while they are wet. Also do not plug or unplug the AC adapter and other connectors with a wet hand.
- Do not use the USB cable if it is damaged.
- Do not swing or throw the main body.
- Always supply power within the rated voltage range (100 to 240V AC) of the AC adapter.

- ❗ Inspect the AC adapter, household power outlet, and the recharging terminals periodically to ensure that they are free of accumulated dust.
- ❗ Insert the plug of the AC adapter into the power outlet all the way.

⚠ CAUTION

- ⊘ Do not place the product on an unstable or tilted surface.
- ⊘ Do not leave the product outdoors for a long time to avoid damage from weather and strong sunlight.
- ❗ When the product is not to be used for a long period, disconnect the AC adapter and USB cable.
- ❗ Use and store the product under an ambient temperature between 0°C and 40°C.

2 Package Contents and Nomenclature

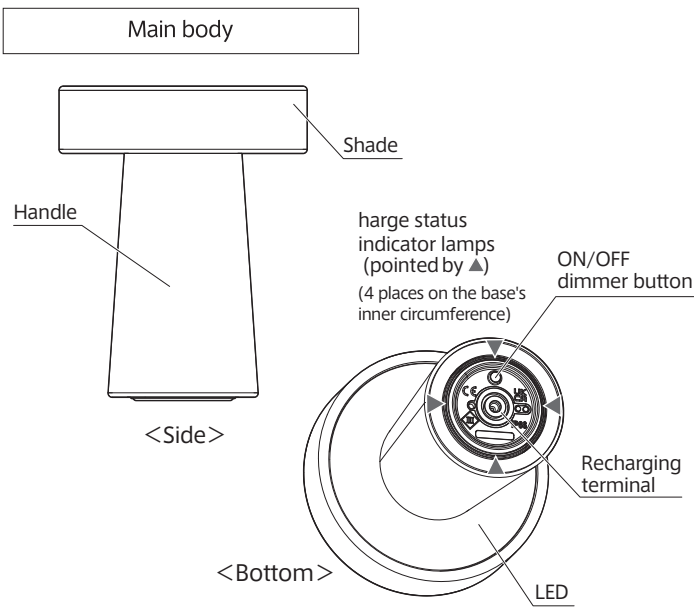

⚠ DANGER
 Do not look directly at the LED light source when it is illuminated.

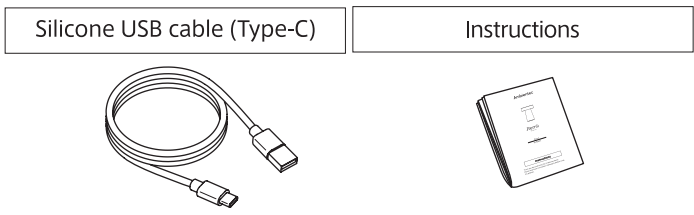
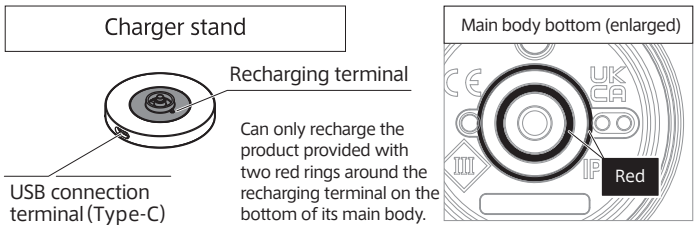

* Thanks to widespread use of mobile devices, most people today already possess a USB-compatible AC adapter. So it is not provided with this product in order to reduce environmental impact. When using this product, have a DC5V/2A (or 2A or higher) USB-compatible AC adapter handy. Ambientec's optional AC adapter (Product Code: AMB-AC02) can also be used.

3 Before Using the Product

● Be sure to charge the product before using it for the first time or when it hasn't been used for a long period.

[1] Connecting and charging the charger stand

1. Connect the smaller connector (USB-C side) of the USB cable to the USB connection terminal on the charger stand (①).
 Note: Although a commercially available USB Type-C cable can also be used, it may sometimes not be used depending on its configuration.
2. Connect the larger connector (USB-A side) of the USB cable to the AC adapter (②) and plug the AC adapter into the wall outlet (③).
3. When charging starts, the charge status indicator lamps glow (④). (If the LED on the main body is lit, it goes out when the main body is placed on the charger stand)
 The charge status indicator lamps emit light through the gaps in the charger stand (4 places on the base's inner circumference).
 Labels: Goes out, Lights up
4. When charging is complete, the charge status indicator lamps go out. The light will go on when remove the main body from the charger stand (⑤).
 Labels: LED automatically turns on, Goes out

⚠ DANGER

⊘ Do not charge the product when the USB connecting terminal is wet with water or other liquids.

[2] Error warning

If the product detects heat generation from the battery and control circuit board or an abnormality in the power supply, the protection function may be activated, in which case the charge status indicator lamps start blinking and charging is not possible. Should this be the case, remove the main body from the charger stand, wait for a while, and then replace the main body on the charger stand to resume charging.

4 Operation

[1] Battery Power mode for cordless use

- The main body goes out when it is placed on the charger stand and lights up when removed from the stand.

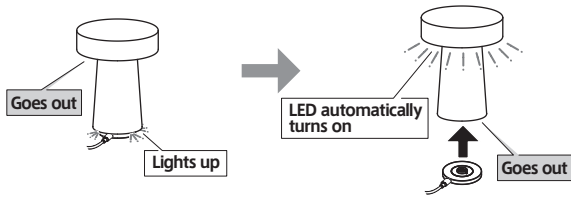

< Operation using the ON/OFF dimmer button >

- The brightness of the Battery Power mode can be adjusted in four steps. Each time the ON/OFF dimmer button on the bottom of the main unit is pressed, the brightness level changes in the following order: OFF → LOW → MID → HIGH → EX-HIGH → OFF, and so on.

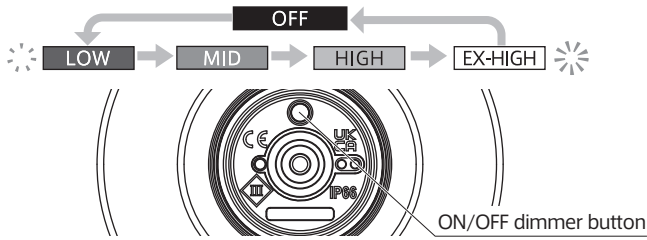

[2] USB Power mode for lighting up the main body when it has been charged on the charger stand

< Switching from the Battery Power mode >

- Keep the ON/OFF dimmer button pressed until the LED on the main body starts blinking slowly. When it starts blinking, place the main body on the charger stand. The main body will light up while it is charging.

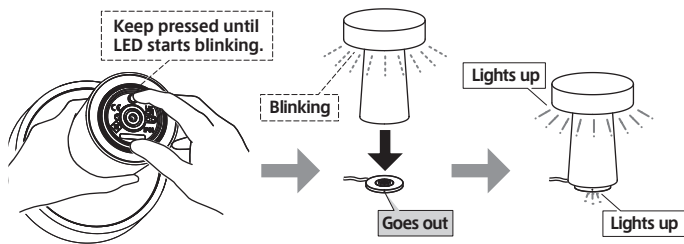

- The brightness changes in three levels in the USB Power mode. The brightness level activated when the USB Power mode is engaged depends on which brightness level was activated in the Battery Power mode as shown below.

Note: The ON/OFF dimmer button is inoperable when in the USB Power mode.

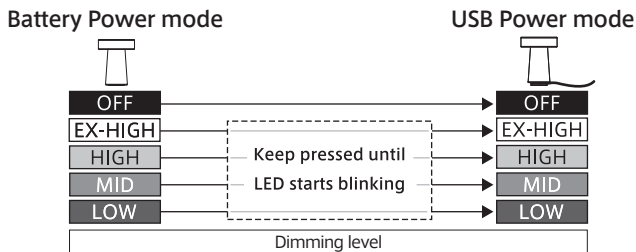

- When the main body is removed from the charger stand, the main body goes out. To return to the Battery Power mode, press the ON/OFF dimmer button once; the main body will light up.

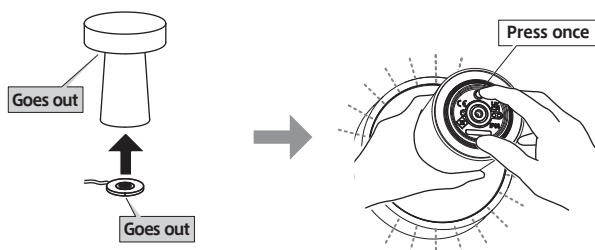

5 Protection against Dust and Water

- The main body is both dustproof and water-resistant (IP66* equivalent) but should not be used underwater. Do not put it in a bathtub or other water container.
* Indicates protection from dust and high-pressure water jets from any direction.

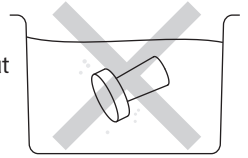

- The charger stand is not waterproof. Make sure it doesn't get wet.



Be sure to adhere to the following when using the product in a bathroom or similar environment

⚠ CAUTION

- ⊘ Do not leave the product for a long time in a high-temperature, high-humidity bathroom or sauna.
- ⊘ Do not place the product on a poorly drained bathroom floor or similar environment.



6 Care and Maintenance

To keep this product in optimal condition, please follow these maintenance guidelines.

- ⚠ Turn off the power and disconnect the attached cable before cleaning the product.

- If the main body is dirty, gently wipe it with a moistened, soft, lint-free cloth.



⚠ CAUTION

- ⊘ Do not use a liquid spray cleaner, solvent such as benzene or thinner, or polishing agent to clean the product. Doing so may scratch the surface, cause the surface coating to peel.

- If the terminal or silicone sheet (black sheet around the terminal) on the bottom is dirty, wipe it with a moistened, soft, lint-free cloth. When doing this, place a cloth or soft material underneath to protect the shade.



- If dirt or dust gets in the terminal on the charger stand, carefully remove it with a cotton swab or similar soft object. Do not use a metallic tool such as tweezers.

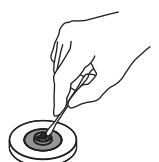

7 Product Specifications

Product name		Remli	
Product code		W-RM01	
Main materials	Main body / exterior	Concrete, pumice, glass, ceramics, etc.	
	Main body / interior	ABS, aluminum, acrylic resin, silicone rubber	
	Charger stand	Zinc alloy, ABS, silicone rubber	
Surface treatment	Main body	Plastering finish	
	Charger stand	Baked painting (Black)	
Dimensions (mm)	Main body	Outer diameter: $\phi 122$	Height: 155
	Charger stand	Outer diameter: $\phi 54$	Height: 8
Weight (g)	Main body	900	
	Charger stand	30	
Light source		LED*1*2	
Color rendering index		Ra 95 or more	
Dimming level		LOW / MID / HIGH / EX-HIGH	
Battery run time (h)	Battery power mode	150 / 72 / 24 / 8	
	USB power mode	Until battery is exhausted	
Power consumption (w)		0.1 / 0.2 / 0.6 / 2	
Illuminance (lx)		150 / 280 / 710 / 2000	
Color temperature (K)		2500	
Recharging time		Approx. 6 hours*3	
Recharging cycle		Approx. 500 times*4	
Power supply		Rechargeable lithium-ion battery, 3.6 V / 5100mAh	
Water-proofing	Main body	IP66*5 equivalent	
	Charger stand	Not waterproof	
Operating temperature (°C)		0~40	
Dimensions (mm)			

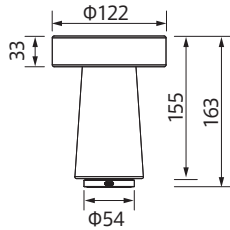

Lighting coverage (mm)

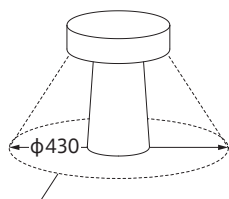

Distance at which the illuminance immediately below the center drops to 10%

*1 The brightness of the LED elements decreases by about 70% after about 40,000 hours of use.

*2 The color and brightness of each individual LED element's light varies even when used in a light source with the same product code.

*3 Varies depending on operating conditions and environments.

*4 Applies when the battery performance drops below 50%.

*5 Indicates protection from dust and high-pressure water jets from any direction.

Design and specifications are subject to change without notice.

8 Disposing of This Product

This product uses a rechargeable lithium-ion battery that contains recyclable rare earth metals. Before disposing of the product, remove the battery and dispose of it according to local regulations.

1. Be sure to keep the light on until it goes out. This will allow the battery to discharge completely.
2. Insert the tips of L-shaped C-ring pliers or a similar tool into the two recesses on the bottom of the base and press down (①). While holding the handle of the main body, turn the tool counterclockwise to detach the base from the main body (②). Be careful not to pull on the lead wire forcibly to avoid cutting it.

⚠ CAUTION

⊘ Never open the base except when you are going to dispose of the product.

3. Pull out the connector out of the main body (②).
4. Peel off the adhesive tape, pull the connector out of the base, and remove the battery by pulling it out (③).
5. Affix the connector with adhesive tape for insulation (④) and dispose of the removed battery in accordance with local regulations.

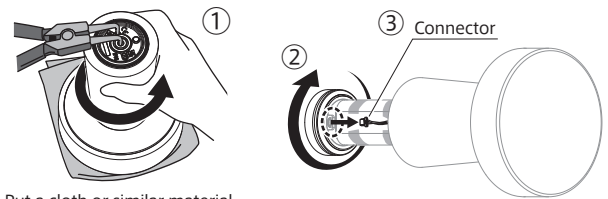

Put a cloth or similar material underneath.

