



# CORE LANDSCAPE PRODUCTS

THE ARCHITECT'S CHOICE



## PRODUCT CATALOGUE

FOUNDATIONS \ GLOW \ PRIVACY SCREENS

# INSIDE /



## ABOUT

Why our mission has always been to make going eco-friendly the easy choice.

## CORE FOUNDATIONS

CORE Foundation permeable grids for pathways, bike lanes, patios, parking lots, slope stabilization, and more.

## PRIVACY SCREENS

Unique and beautiful PVC screens to incorporate into any space for added privacy and elegance.

## CORE GLOW

Electricity-free photoluminescent solar lighting for stunning indoor and outdoor lighting installations.

# DIFFERENTIATORS

CORE believes that companies have the power to affect massive change within our communities and environments. That is why we are a proud member of 1% For The Planet as well as a B-Corp Certified company. CORE is also a woman-owned company which will help you meet the requirements of needing to incorporate diverse suppliers.



Certified



This company meets the highest standards of social and environmental impact

Corporation

# TRUSTED BY

Property Brothers- Lowell Observatory- Fire Marshalls across North America-Canadian and American National Parks- American Disability Association- USA Military- City of New York



# A B O U T

CORE Landscape Products was founded in 2010 on the notion that we, as humans, possess the ability to improve our environment through conscious choices. CORE prides itself on creating sustainable products that enrich & protect the natural world. Our ongoing research and development ensures that we create top quality products while providing the highest level of service. CORE Landscape Products is a proud supporter of environmental initiatives around the world, including the Haiti Ocean Project. Our goal is to promote and educate the use of environmentally sustainable landscaping products that ensures a future where humans and nature can co-exist. CORE Landscape Products started in 2010 with only a handful of eco-friendly products, a small office, warehouse space, and a few friends. Today, CORE is a growing company dedicated to creating and supplying unique and innovative products, for both private and public landscape settings, that are more eco-friendly and sustainable than traditional products.

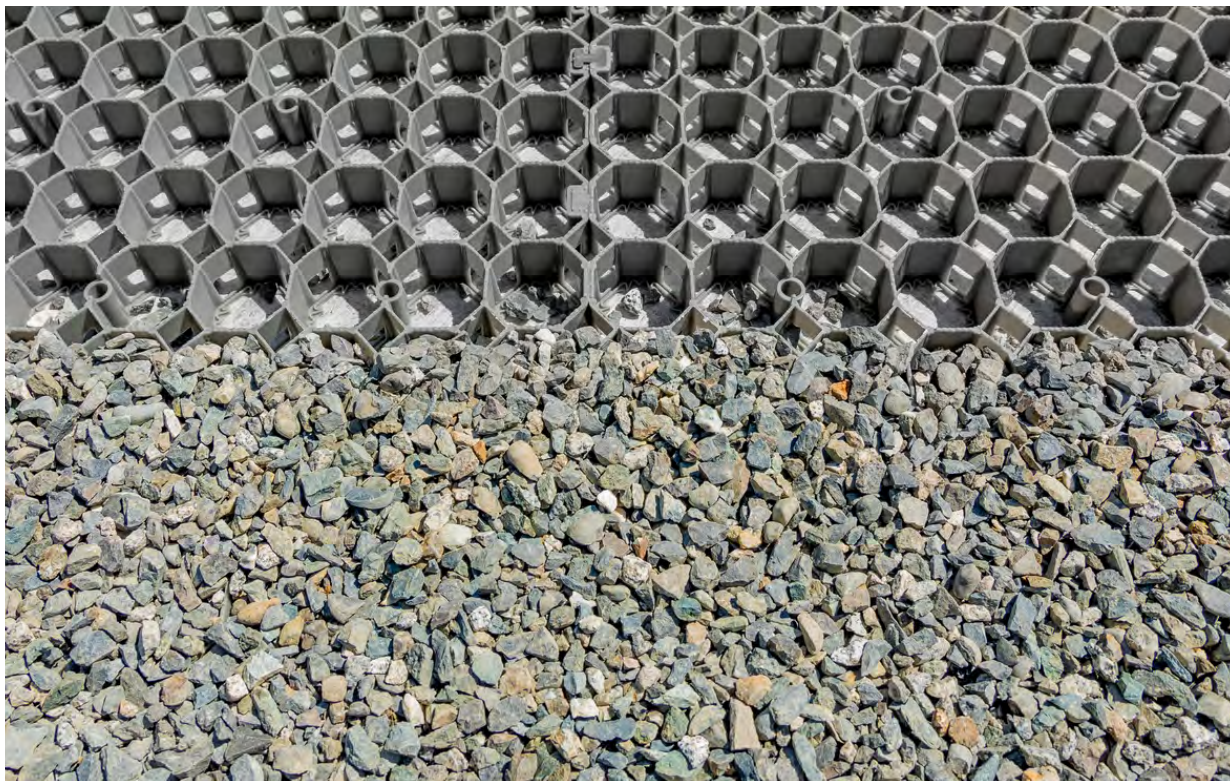



# GRAVEL FOUNDATIONS



The key to an eco-friendly surface is CORE Landscape Gravel Reinforcement Grids, which consist of a foundation of interlocking honeycomb-celled panels and our unique geotextile backing. Once filled with gravel this foundation is suitable for vehicle or pedestrian traffic with no compromise to strength or durability. Gravel is held in place within the grid structures to create an even, pedestrian, wheelchair, and vehicle friendly surface that can be used year round. This weed-free, dust-free, eco-friendly, 100% permeable foundation system improves storm water management and replenishes the groundwater. The porous nature of these foundations benefit trees and shrubs within the vicinity, allowing rain water or snow melt to seep back into the soil vs overtaxing our storm drains and urban creeks.

## CORE GRAVEL FOUNDATIONS FEATURES

**Gravel Stabilization:** Get gravel to stay put, no ruts, no sinking, no problems.

**Low Cost:** Because the gravel won't move around you can use less, giving you a porous surface that costs less than concrete, asphalt or block pavers.

**Superior Strength:** Enhanced load bearing eliminates rutting, separating or sliding with vehicle traffic.

**Easy/No Maintenance:** Doesn't crack or shift, so little/no maintenance is required (possible need to top dress every few years)

**Reduce Base Gravel Layer:** Gravel Equivalent Factor (GF) is 4"-6" for every 1" of our CORE Gravel grid height. Translation? Less base material needed when using our grids. Less base means less cost.

**Weed Reduction:** The non-rotting geotextile backing underneath each panel suppresses weed growth.

**Dust Reduction:** Because you are using 'clear' fractured, or pea, gravel, no fines are present, therefore no dust.

**Green Solution:** Environmentally friendly porous gravel paving allows the drain the rain over the entire surface.

**SUDS Compliant:** Because CORE Gravel™ is porous, it is ideal for solutions requiring a Sustainable Urban Drainage System (or SUDS).

**ADA Compliant:** Ideal for pedestrians, bicycles and wheelchair traffic.

**Aesthetically Pleasing:** When filled the product is practically invisible, leaving you with a stunning surface

# GRAVEL FOUNDATION SYSTEMS

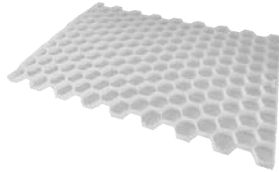

## 38-18 | LIGHT DUTY (WHITE)

Use: this light, flexible grid is perfect for pathways, patios, perimeter drainage, dryscaping, slope stabilization, etc.

**Panel coverage:** 9.9 sq ft (0.91m)

**Panel dimensions:** 45.3" x 31.5" x 0.71" (1150mm x 800mm x 18mm)

**Load bearing capacity:** 20 500 lbs/sq.ft.(Over 100 tons/m<sup>2</sup>)

**Suggested aggregate size:** 0.1" - 0.3" (3-10mm)

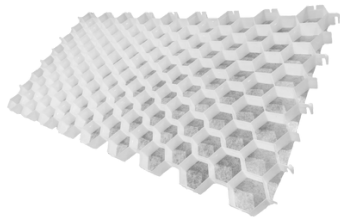

## 50-30 | LIGHT-MEDIUM DUTY (WHITE)

Use: residential long-term parking, patios, slope stabilization, perimeter drainage, etc.

**Panel coverage:** 10.33 sq ft (0.95m)

**Panel dimensions:** 47.25" x 31.5" x 1.18" (1200mm x 800mm x 30mm)

**Load bearing capacity:** > 30 720 lbs/sq.ft.(Over 150 tons/m<sup>2</sup>)

**Suggested aggregate size:** 0.2"-0.4"(5-10mm)

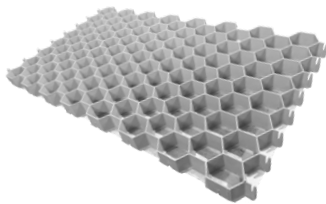

## 50-35 HD+ | HEAVY DUTY (GREY OR WHITE)

Use: residential parking & driveways, RV parking, public pathways & picnic areas, slope stabilization, etc.

**Panel coverage:** 9.7 sq ft (0.9m)

**Panel dimensions:** 45.3" x 30.7" x 1.4" (1150mm x 780mm x 35mm)

**Load bearing capacity:** > 51 200 lbs/sq.ft.(Over 250 tons/m<sup>2</sup>)

**Suggested aggregate size:** 0.2"-0.6"(5-15mm)

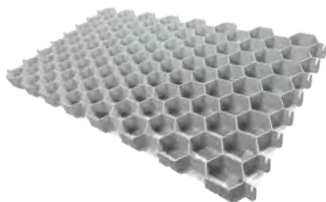

## 50-35 HDR | HEAVY DUTY (GREY)

Use: this recycled grid is the same as our 50-35HD, just recycled! [less suitable for slope stabilization]

**Panel coverage:** 9.7 sq ft (0.9m)

**Panel dimensions:** 45.3" x 30.7" x 1.4" (1150mm x 780mm x 35mm)

**Load bearing capacity:** > 51 200 lbs/sq.ft.(Over 250 tons/m<sup>2</sup>)

**Suggested aggregate size:** 0.2"-0.6"(5-15mm)

R indicates grid is made of minimum 50% recycled materials.

Product numbers denote width x depth in millimetres of each honeycomb shaped cell for all panels.

# GRAVEL FOUNDATION SYSTEMS



## 60-40+ R | EXTRA HEAVY DUTY (GREY) (WHITE AVAILABLE ON REQUEST)

Use: commercial parking lots, sloped driveways, loading ramps, construction entry/exit routes, fire-access lanes, etc.

**Panel coverage:** 12.4 sq ft (1.15)

**Panel dimensions:** 45.3" x 39.4" x 1.6" (1150mm x 1000mm)

**Load bearing capacity:** > 62 000 lbs/sq.ft.(Over 300 tons/m2)

**Suggested aggregate size:** 0.2"-0.6"(5-15mm)

+ special octagonal cell with lateral drainage

R indicates grid is made of minimum 50% recycled materials.

Product numbers denote width x depth in millimetres of each cell for all panels.

FOUNDATION	COST	STRENGTH	ECO-FRIENDLY	MAINTENANCE	ACCESSIBILITY
CORE	\$	✓	🌿🌿🌿	🔨	♿
CONCRETE	\$\$\$	✓	✗	🔨🔨	♿
ASPHALT	\$\$\$	✓	✗	🔨🔨🔨	♿
LOOSE GRAVEL	\$	✗	✗	🔨🔨	✗

### Cost | Affordable

Quick and simple installation drastically reduces engineering and installation costs.

### Strength | Great

With a load bearing capacity of 62,000 lbs/sq.ft. (>300 tons/m2) and temperature range of -45°C to 70°C, CORE is as strong as concrete and asphalt with a suite of other benefits.

### Eco-friendly | Extremely

CORE is made from recycled materials with a low environmental impact. The porous surface filters rain water, reduces peak storm flow events, and facilitates a more resilient local water table. By also preventing compaction (unlike gravel) CORE ensures water returns where it belongs.

### Maintenance | Simple

CORE's modular grid system makes maintenance a breeze. As ground moves over time, our modular grid is simple to fix, unlike concrete and asphalt. Just unclip, repair area of concern, and reinstall the grid, no resurfacing needed. CORE keeps gravel in place, so requires less continuous maintenance than loose gravel.

### Accessibility | Best

CORE prevents ice, improves traction, and does not heave and crack like asphalt and concrete. Permeable means incredible drainage, so no ice build-up and no slippery surface. Wheelchair, bike and high heel shoe friendly!

### Additional benefits | So Many

Reduces Heat Island Effect: CORE foundations do not hold summer heat like asphalt and concrete. Reduces Storm Sewer Pressure: because our foundations allow rainwater to reenter the ground directly, no pressures are placed on the storm sewer system. No Black Ice: the permeable surface eliminates the formation of ice, improving safety for everyone.

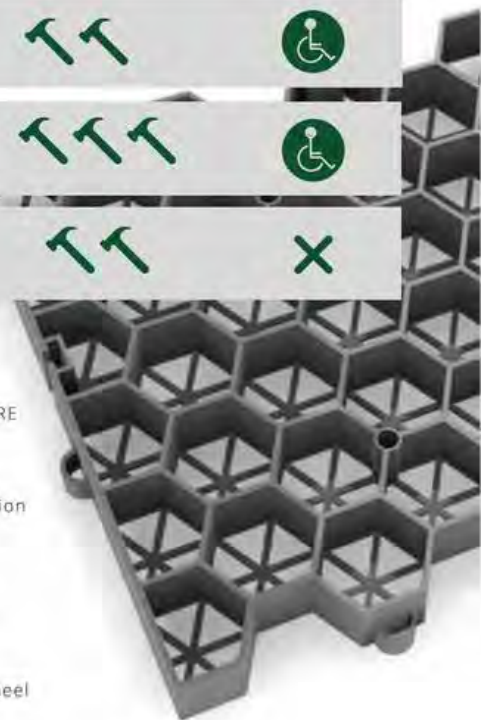



# GRASS FOUNDATIONS



CORE Grass™ is a turf stabilizing system. The CORE Foundation protects the roots of the grass or sedum from compaction allowing for heavy vehicle traffic on a truly green surface. CORE Grass Reinforcement grids provide amazing stability, grass protection and sustainable drainage, while delivering the desirable visual and natural effect of grass paving.

## ✓ CORE GRASS FOUNDATIONS FEATURES

**Max Load Support:** Enhanced load bearing ensures no rutting or soil compression with vehicle traffic, yet still 100% pervious (permeable)

**Stormwater BMP:** Reduces storm water runoff significantly and improves water quality with natural pollution filtration and treatment.

**Heat Island LID:** Reduce and mitigate urban heat island effects with this cool low-impact development practice

**LEED Credit:** Used in SUDS and LEED compliant porous paving BMPs for ideal draining and minimal environmental impact.

**ADA Compliant:** Used in ADA disability compliant surfaces for pedestrians, bicycles, & wheelchair traffic.

**Erosion Control:** Address a wide range of erosion control, earth retention, slope protection, and stability issues.

**Parking lines in grass:** Easily add delineation and edge indicators with CORE Marker.

**Aesthetically pleasing:** Nearly invisible, no unsightly infrastructure is seen, just green grass.

# GRASS FOUNDATION SYSTEMS

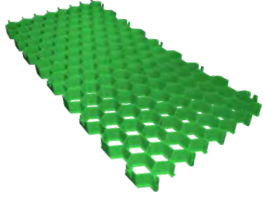

## 50-35 | HEAVY DUTY

Use: residential driveways, parking pads, living driveways, RV parking, garden paths, slope stabilization, commercial paths, etc.

**Panel coverage:** 9.7 sq ft (0.9m)

**Panel dimensions:** 45.3" x 30.7" x 1.4" (1150mm x 780mm x 35mm)

**Load bearing capacity:** > 51 200 lbs/sq.ft.(Over 250 tons/m<sup>2</sup>)

**Material:** 50% recycled polypropylene

## 60-40+ R | EXTRA HEAVY DUTY

Use: sloped driveways, commercial parking, Fire access lanes, loading ramps, construction entry/exit routes, etc.

**Panel coverage:** 12.4 sq ft (1.15)

**Panel dimensions:** 45.3" x 39.4" x 1.6" (1150mm x 1000mm)

**Load bearing capacity:** > 62 000 lbs/sq.ft.(Over 300 tons/m<sup>2</sup>)

**Material:** 50% Recycled polypropylene (PP)

+ special octagonal cell with lateral drainage

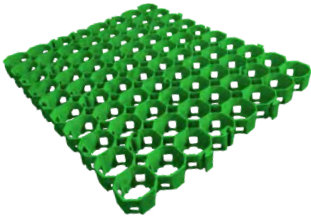



# INDUSTRIAL FOUNDATIONS



CORE's Industrial Grade foundations are created to support large loads and high traffic. Used on fire access lanes, military bases and horse paddocks alike.

## 65-45 R | ULTRA HEAVY DUTY (BLACK)

Use: commercial parking, fire access lanes & horse paddocks

**Panel coverage:** 7.5 sq ft (0.7 m)

**Panel dimensions:** 45.3" x 39.4" x 1.6" (1150mm x 1000mm)

**Load bearing capacity:** > 62 000 lbs/sq.ft.(Over 300 tons/m<sup>2</sup>)

**Suggested aggregate size:** 0.2"-0.6"(5-15mm)

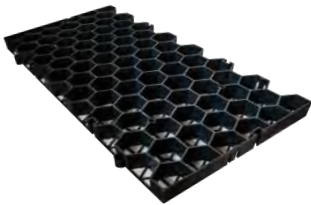

## 65-45 R | ULTRA HEAVY DUTY

Use: extra heavy duty applications such as equestrian settings & parking lots for heavier commercial vehicles

**Panel coverage:** 9.4 sq ft (0.87 m)

**Panel dimensions:** 44.3" x 30.5" x 1.8" (1125mm x 775mm x 45mm)

**Load bearing capacity:** > 65 000 lbs/sq.ft.(Over 350 tons/m<sup>2</sup>)

**Material:** 50% Recycled polypropylene (PP)

+ reinforced panel base

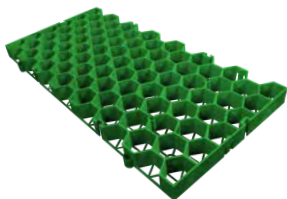



# PRIVACY SCREENS



Discover an exquisite collection of over **100 captivating designs** meticulously crafted by talented local artists, each one meticulously curated to elevate and **enrich your living space**. Alternatively, unleash your own artistic prowess and bring **your vision to life** with CORE's innovative custom creations! Available in three stunning colours - **black, white, and brown** - these remarkable **all-weather** panels are built to endure any climate, ensuring long-lasting durability. Our screens are offered in standard sizes of **2'x4', 3'x6', and 4'x6'**, but can also be tailored to your **exact specifications**, enabling you to create a truly **personalized masterpiece**.

Coast Salish



Nature



Geometric

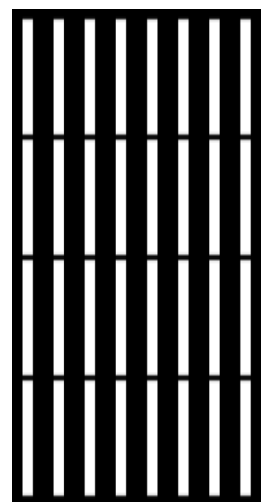



# CORE GLOW



Introducing CORE Glow, the eco-friendly lighting solution that defies conventional electricity requirements. With CORE Glow aggregate, transform your driveway, sidewalks, and pathways into enchanting pathways illuminated by a gentle, inviting glow. Experience the magic of enhanced lighting for edging, flower beds, house plants, and beyond. Embracing a renewable light source, CORE Glow emits zero carbon emissions, making it a responsible choice for both your wallet and the planet. Discover an affordable and sustainable lighting solution that adds a touch of mesmerizing beauty to your surroundings with CORE Glow.

## ✓ CORE GLOW FEATURES

**Charge Time:** CORE Glow aggregates require 10-20 minutes of daylight or lamplight to charge.

**Glow Time:** 10-12 hours

**Sizes:** From powder to boulders we have a wide range of shapes and sizes

**Environmental:** All CORE Glow products require no electricity and thus no wires, no power supply and no batteries. All products are also non-radioactive, non-toxic and environmentally friendly. The photoluminescent material itself is biologically and chemically inert, and is REACH (Registration, Evaluation, Authorization and Restriction of Chemicals) compliant.

**Reduces Light Pollution:** Not only does light pollution reduce the amount of stars you see in the sky, but it also greatly disrupts the migratory routes of birds. CORE Glow is used at Observatories and protected sensitive habitats around the world because of our low light emittance.

**Lifespan:** 20+ years

**Colours:** Green, Aqua and Blue

**Waterproof:** Expert engineering has enabled excellent water resistance compared to the common photoluminescent or afterglow pigments.

**Strengths:** Depending on your project and budget we have the glow for you. Starting with Glow Stones, then Commercial Grade and finally our brightest glow of all, Quantum Grade.

# QUANTUM

BRIGHTEST GLOW



pathways-patios-roadways-edging- flooring-countertops-safety-markings-bathrooms-gardens- murals-Pools

With 60% more active agent than our Commercial Grade, we went ALL IN with Quantum!  
Choose our ultra-premium line, Quantum, for the best glow at the best price.

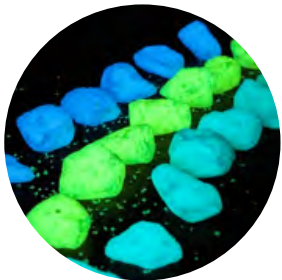

## QUANTUM & COMMERCIAL GRADE AGGREGATE

SIZES: 0.5-1, 1-3, 3-8 & 8-15 & 16-25MM (QUANTUM ONLY) (CUSTOM AVAILABLE WITH MINIMUM ORDER)

### Colours:

day: natural white  
night: Green, Blue, Aqua

### Quantities:

1 pound or 4 pound bags (volume/bulk purchases available at a discount)



## QUANTUM GRADE BOULDERS

Colours: Hot green, aqua blaze, or ethereal blue

Options: 100% Quantum Glow Boulders available in

- full (~3-4")
- half cuts (~2-3")
- tiny boulders (~1.5-2")

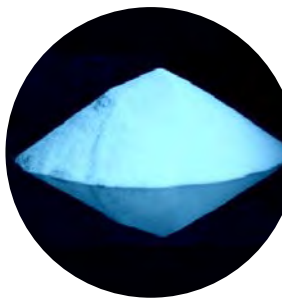

## PURE GLOW POWDER

Our commercial grade powder is for professionals and DIY-ers alike. Use in resin casting, mold-making, painting, and more to make your work shine.

Colours: Hot green, aqua blaze, or ethereal blue

Options: 100% Quantum Glow Boulders in full or half cuts



# LED LIGHT TOWERS

Adhering to our **Zero Waste Policy**, we use **residual materials** generated from the production of our privacy screens, we proudly present our exceptional light towers **crafted entirely from 98% recycled PVC material**. Embrace sustainability while making a bold statement with these unique feature pieces designed to elevate your space above and beyond. Choose from our remarkable selection of light towers, each adorned with a **powerful 50 Watt LED light** or the **eco-conscious alternative of a 10 Watt solar-powered light**. Let these captivating installations illuminate your surroundings and transform your space into a beacon of distinction.



## Specifications

Screen size	4 pcs - 1'x5' screens
Designs	Lily, Labyrinth, & Art Deco
LED Light	50 Watt Wired or 10 Watt Solar
Style	Free Standing
Colours	Black or white
Parts	All necessary hardware included



# CANA PLANTERS



Adhering to our **Zero Waste Policy**, we use residual materials generated from the production of our privacy screens, we proudly present our garden planters crafted entirely **from 98% recycled PVC material**. By repurposing every single off-cut, we ensure that **no material goes to waste** in the production process.

## Specifications

Sizes	Small (2gal) & Medium (5gal)
Colour	Black, Brown, White
Designs	Monstera, Morocco, Apple Blossom, & Protea

# CANA EDGE



## Specifications

Depth	2.5", 4", or 6" (+3" with spikes)
Length	16.4' (5m) in one pack
Colour	Black, Grey, Corten
Parts	15 steel spikes (optional)

Transform your garden into a captivating oasis by incorporating our exceptional flexible metal garden edging. Crafted with utmost precision and care, our edging is designed to elevate your garden design and withstand the harshest elements nature throws its way.

Our metal garden edging boasts unrivaled durability, ensuring it remains a long-lasting and reliable addition to your outdoor space. Constructed from high-quality materials, it is engineered to resist corrosion, fading, and warping, making it a robust solution for enhancing the borders of your flower beds, pathways, or garden



# CORE WATER

CORE Water is an easy solution for stormwater retention, attenuation, and infiltration for commercial and residential projects. The design helps relieve pressure on water drainage systems, acting as an underground reservoir during rainfall. Rainfall is collected within the system and slowly returned to the earth at a natural rate which helps to avoid waterlogging. CORE Water is an easy to assemble crate and can be used in various applications, such as under driveways, garden beds, and more. In addition, CORE Water is compliant with SUDS (Sustainable Urban Drainage Systems), making it a green solution for projects.

## BENEFITS OF CORE WATER

- 💧 Flood mitigation with effective storm water management
- 💧 Sediment prevention with a 80 gsm infiltration membrane
- 💧 Superior structural integrity
- 💧 Easy to assemble + affordable
- 💧 Simple lightweight design



### TECHNICAL SPECIFICATION

<b>Material:</b>	Recycled Polypropylene
<b>Crate Dimensions:</b>	800 x 540 x 500mm
<b>Wall Thickness:</b>	17mm
<b>Cubic Area of Crate:</b>	0.216m <sup>3</sup>
<b>Membrane:</b>	Non-woven 80gsm
<b>Crate Weight</b>	20 lbs
<b>Chemical Resistance:</b>	Excellent

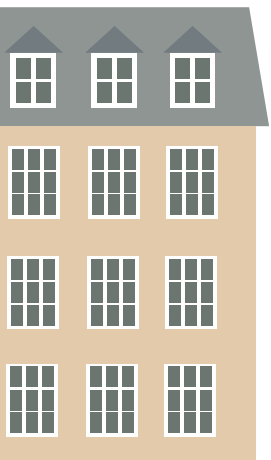

Landscape/pedestrian installation  
min 450mm depth

Light vehicular traffic installation min 900mm dept

Recycled polypropylene walls

Underground drainage pipe tight to the membrane  
surrounding the water crate

Compacted granular base

Cylindrical support columns

Wrapped in geotextile membrane  
to prevent silt buildup inside

Min distance from building= 5.0m



# CORE DRAINAGE

CORE Drainage Cells effectively capture sub-surface water and transports it away. This product is ideal for saturated grounds against an external wall of a sloped driveway or basement room. CORE Drainage cells aim to relieve the hydro-static ground pressure against retaining walls and prevent the water from becoming logged. CORE drainage cells are made from recycled polypropylene and are extremely lightweight with superior structural integrity.

## BENEFITS OF CORE DRAINAGE CELLS

- 💧 **Flood mitigation with an effective capture and transport capacity**
- 💧 **Hydro-static ground pressure relief preventing stagnant water**
- 💧 **Superior structural integrity**
- 💧 **Easy to assemble + affordable**
- 💧 **Simple lightweight interlocking design**

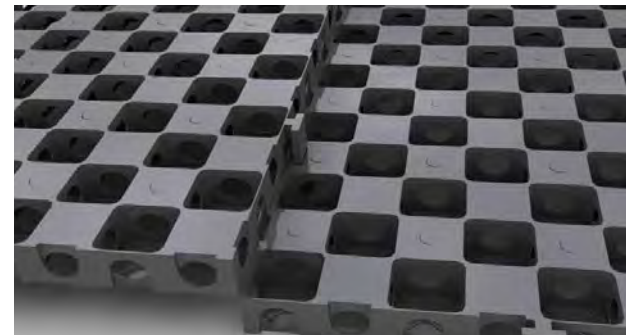

Final product can be wrapped in a non-woven geotextile

### TECHNICAL SPECIFICATION

**Material:** Recycled Polypropylene

**Cell Dimensions:** 600x290x25mm

**Interlocking:** yes, pin and socket

**Discharge Capacity:** 5 L/s

**Cell Weight:** 1.2 lbs

**Chemical Resistance:** Excellent

**Horizontal Void:** 58% void area

**Service Temp:** -10 ° C to 40 ° C







# OUR PROMISE

---

CORE Landscape Products was founded on the belief that we all have the ability to improve our environment. For us at CORE, that means creating products that both enrich our environment and are sustainable. Our philosophy comes from years of work in the environmental and development field, and a desire to provide a unique quality of service to our clients.

Every improvement adds up to a better environment for ourselves, our fellow (wo)man and the critters we live alongside. Which is why we are proud to work with everyone from the homeowner, busy contractors, and professional partners.

*- C. Rutledge*

---

## CONTACT INFORMATION

2750 CUMBERLAND ROAD, COURTENAY, BC

855.777.2673 | 250.871.6840

CORELANDSCAPEPRODUCTS.CA | SHOP.COREGRAVEL.CA | COREGLOW.CA

INFO@CORELANDSCAPEPRODUCTS.CA

---





**CORE**

L A N D S C A P E  
P R O D U C T S

**THE ARCHITECT'S CHOICE**