



Imagined
by kids for kids!

POWER PONY OWNER'S MANUAL

Read and understand this entire manual
before allowing child to use this product!

For assistance contact customer support.
DO NOT RETURN TO STORE.

NOTE: Manual illustrations are for demonstration purposes only.
Illustrations may not reflect exact appearance of actual product.
Specifications subject to change without notice.

CONTENTS

Safety Warnings and Safe Use Instructions	1-2	How to Operate the Power Pony.....	9 - 10
Before You Begin / Unboxing.....	3	Lights and Sounds Riding Modes.....	11
Assembly.....	4-6	Repair and Maintenance.....	12
Charging the Battery.....	7	Storage / FCC Compliance / Warranty.....	13
Pre-Ride Safety Checklist and Calibration.....	8		

SAFETY WARNINGS AND SAFE USE INSTRUCTIONS

AN ADULT MUST READ THIS ENTIRE MANUAL

This Owner's Manual must be read and understood **fully** before **allowing** any child to ride the Push Pony. This manual contains numerous warnings, cautions, safe-riding instructions and other safety information regarding the consequences of failing to properly assemble, maintain, inspect and use your Power Pony. It is your responsibility to review this information and make sure that **all** riders understand the warnings and safe-riding instructions to ensure that young riders are able to safely and responsibly use this product. Because any incident involving your Power Pony can result in severe injury or even death, this manual does not repeat the warning of potential severe injury or death each time such a possibility is mentioned.

⚠ WARNING:

The Power Pony is designed to **allow** movement forward, backward, in wide turns or tight spinning circles. It is extremely important to start out slowly, and take the time to get familiar and comfortable with the Power Pony's unique foot driven riding and steering controls, before attempting quick turns or other fast moving actions, or otherwise trying to make full use of the Power Pony's capabilities. Using this product requires flat open space, free of traffic, moving vehicles, or other obstacles.

⚠ WARNING:

PARENTAL OR ADULT RESPONSIBILITY AND SUPERVISION NECESSARY:

It is your responsibility to review this information and make sure that **all** riders understand the warnings, cautions, instructions, and safety topics, and that young riders are able to safely and responsibly use this product. **All** riders must use a helmet meeting the requirements of the United States Consumer Product Safety Commission and other protective equipment and demonstrate careful riding under constant adult supervision. **Adult supervision is required at all times.** ZÜME recommends that you periodically review and reinforce the information in this manual with younger riders, and that you regularly inspect and properly maintain this product to ensure their safe riding.

⚠ WARNING:

Riding any ride-on toy can be an inherently hazardous activity and accidents can occur even when the Push Pony operates properly. Like other ride-on products, the Power Pony is intended to move, and therefore it is possible to lose control, roll over, fall off and/or get into dangerous situations even during routine use like turning if you fail to take proper precautions. **If such things occur you can be seriously injured, including head, brain or neck injury, paralysis or death, even when using safety equipment and all other precautions. RIDE AT YOUR OWN RISK AND USE COMMON SENSE.**

⚠ WARNING:

NOT FOR CHILDREN UNDER AGE 4 OR HEAVIER THAN 200 LBS (90 KGS).

Because products, like the Power Pony, can and do present inherent potential hazards plainly associated with their use, it is recognized THE NEED FOR EXERCISE OF PARENTAL RESPONSIBILITY IN SELECTING RIDING PRODUCTS APPROPRIATE TO THE AGE OF A CHILD, AND PARENTAL SUPERVISION IN SITUATIONS IN WHICH CHILDREN OF VARIOUS AGES MAY HAVE ACCESS TO THE SAME RIDING PRODUCTS.

ZÜME recommends that children under the age of 4 not be permitted to use this product. The recommended rider age of 4 years or older can be affected by the rider's size, weight or skills and not every child 4 years old will be suited to the product. Published age guidelines are not a substitute for careful evaluation of your own child. A parent's decision to allow his or her child to ride this product should be based on the child's maturity, skill, and ability to follow rules. **ZÜME emphasizes that adults are strongly advised not to disregard ZÜME's recommendations or permit younger children to ride the Power Pony.** Keep this product away from small children. Any rider who is unable to fit comfortably on the Push Pony or reach its controls should not attempt to ride it.

DO NOT EXCEED THE WEIGHT LIMIT OF 200 lbs (90 kgs). Exceeding the weight limit can result in loss of control or damage to the Power Pony, which can result in an accident, severe injury or death. Keep this product away from small children and remember that this product is intended for use only by persons who are, at a minimum, completely comfortable, and competent while operating the product. Do not allow more than one (1) rider at a time.

Persons with any intellectual, emotional or physical challenges that may make them susceptible to injury, impair their physical dexterity or mental capabilities to recognize, understand, and follow safety instructions, and to be able to understand the hazards inherent in the product's use, should not use or be permitted to use products inappropriate for their abilities. Persons with heart conditions, head, back or neck ailments (or prior surgeries to these areas of the body), or pregnant women, should be cautioned not to operate this product.

SAFETY WARNINGS

AN ADULT MUST READ THIS ENTIRE MANUAL

⚠ **WARNING:**

SAFE OPERATION REQUIRES CAREFUL ATTENTION. This product does not have a traditional brake. Stopping the Power Pony is done by the coordination and pivoting of your feet. Read "How to Operate" section on pages 9 and 10 of this manual and practice to develop skills in using the Power Pony.

Always check and obey all local laws or regulations which may affect the locations where the Power Pony may be used. The Power Pony is meant to be used on private property and on closed courses, not on public streets or sidewalks. Do not ride your Power Pony in any areas where pedestrians, vehicle traffic, or other obstacles are present.

This product was manufactured for performance and durability but is not impervious to damage. Do not ride over obstacles or engage in other aggressive riding. Such riding behavior can over-stress and damage the Power Pony, and can result in the loss of control and/or an accident causing severe injury or even death. The rider assumes all risks associated with high-stress activity.

- Always ride defensively. Watch out for potential obstacles that could catch your wheel(s) or force you to swerve suddenly or lose control. Be careful to avoid pedestrians, skaters, skateboards, scooters, bikes, children or animals who may enter your path, and respect the rights and property of others.
- Never stand-up while riding the Power Pony.
- Never carry passengers or allow more than one person at a time to ride the Power Pony.
- Do not ride the Power Pony in wet or icy weather and never immerse this electric product in water, do not store outdoors, as the electrical and drive components could get damaged by water or possibly create other unsafe conditions.
- Wet, slick, bumpy, uneven or rough surfaces may increase risks, including but not limited to the risk of losing control, falling and sustaining injury. Do not ride this electric product in mud, ice, puddles or water. Avoid excessive speeds that can be associated with downhill rides.
- Never use on or near steep inclines or steps, swimming pools or other bodies of water.

- Do not ride at night or when visibility is limited.
- Do not touch the electric motor on your product when in use (or after using) as it can become very hot.
- Never race, perform stunts, trick maneuvers, or jumps on the Power Pony. Such riding behavior or maneuvers increase the risk for loss of control, accidents, and uncontrolled rider actions, steering inputs, and reactions.
- Always be careful and ride within the limits of your riding skills.

PROPER RIDING ATTIRE

Always wear proper protective equipment, such as an approved protective helmet with a chin strap securely buckled. A helmet may be legally required by local law or regulation in your area. Elbow pads and kneepads, a long-sleeved shirt, long pants and gloves are recommended. Always wear athletic shoes, never ride barefooted or in sandals, and keep shoelaces tied and out of the way of the wheels, motor, and drive system.

USING THE CHARGER

The charger supplied with the Power Pony should be regularly examined for damage to the cord, plug, enclosure and other parts. In the event of such damage, the Power Pony must not be charged until the charger has been repaired or replaced.

- Use only with the recommended charger.
- Use caution when charging.
- The charger is not a toy. Charger should be operated by an adult.
- Do not operate charger near flammable materials.
- Unplug charger and disconnect from Power Pony when not in use.
- Always disconnect from the charger prior to spot cleaning your Power Pony with damp cloth.

FAILURE TO USE COMMON SENSE AND HEED THE WARNINGS INCREASES THE RISK OF SERIOUS INJURY, SERIOUS HEAD, BRAIN, OR NECK INJURY, PARALYSIS OR EVEN DEATH MAY OCCUR. USE WITH APPROPRIATE CAUTION AND SERIOUS ATTENTION TO SAFE OPERATION

BEFORE YOU BEGIN

VERIFY THAT ALL THE PARTS LISTED ARE PRESENT IN THE BOX

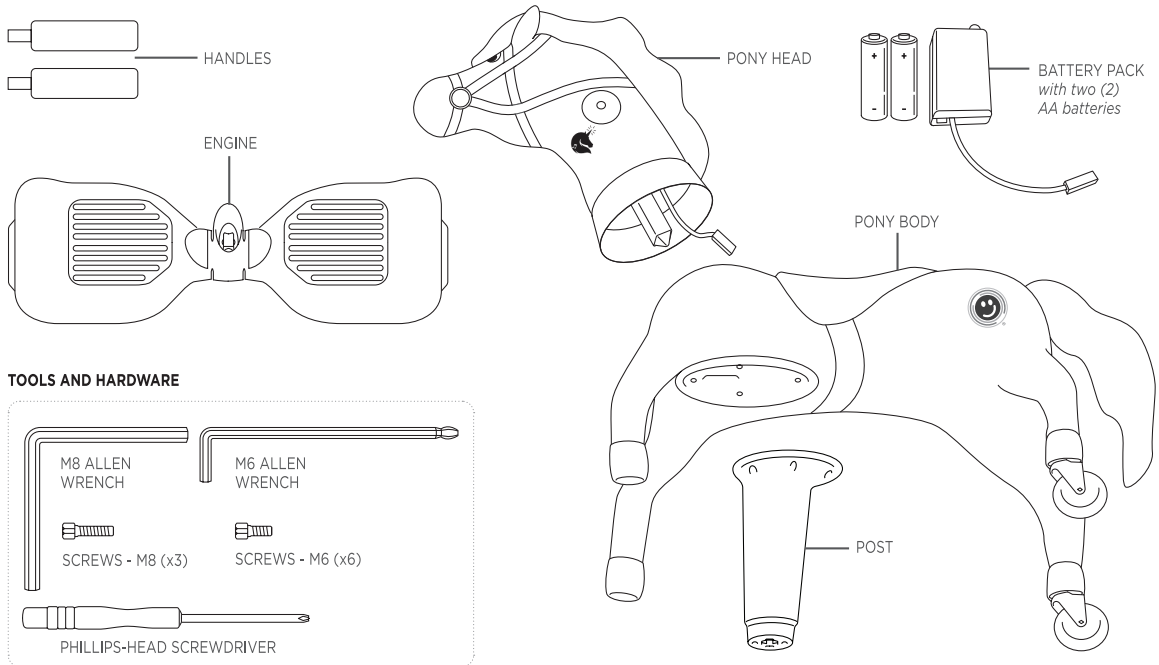

TOOLS AND HARDWARE

INSTRUCTIONAL MATERIAL ON HOW TO ASSEMBLE AND SET-UP YOUR POWER PONY IS AVAILABLE TO YOU INTO 3 DIFFERENT MEDIUMS:

- Enclosed in this manual.
- In video format at: how-to videos at powerpony.com/QuickStart
- By scanning the QR code here.



Your power pony came shipped to you from its stable programmed in beginner learning mode. As you improve your skills and practice, you can always change settings to go faster by downloading the IOS ZÜME app.

UNBOXING

Your Power Pony has been packed in a box inside a box for better protection during shipping. Once the outer box has been discarded please follow the steps below:

- **Position the inner box on the floor with the ZÜME logo on the bottom right corner.**
- Open the box and remove the engine and put it aside until it is called for later.
- Remove and discard cardboard insert.
- Remove the remaining package contents (Head, Body, Handles, Battery Pack, two (2) AA Batteries, Screws, Screwdriver & Allen Wrenches) and put aside.
- Remember to recycle your packaging.

⚠ WARNINGS

- The ride-on toy must be assembled by an adult who has read and understands the instructions in this manual. The failure to properly assemble the ride-on toy may result in severe injury or death.
- NEVER mix old and new batteries..
- NEVER mix alkaline, standard (carbon-zinc), or rechargeable batteries.

Notice: Do not use power tools to tighten the screws as there is a risk of stripping or damaging the product.

⚠ WARNINGS

- **CHOKING HAZARD. THIS RIDE-ON TOY CONTAINS SMALL PARTS. KEEP CHILDREN AWAY WHEN ASSEMBLING**
- **PLASTIC BAGS CAN BE DANGEROUS. TO AVOID DANGER AND SUFFOCATION KEEP THE PLASTIC BAG AWAY FROM BABIES AND CHILDREN.**

❓ NEED HELP

Visit our website at powerpony.com or contact us at support@powerpony.com

ASSEMBLY | STEP 1

CONNECT POST TO PONY

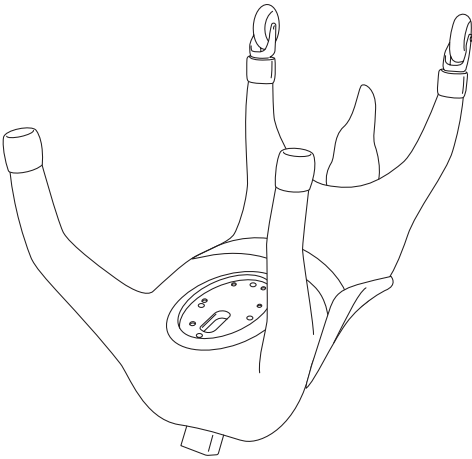

A
Position the body of the Power Pony on a clean, level surface with the legs up.

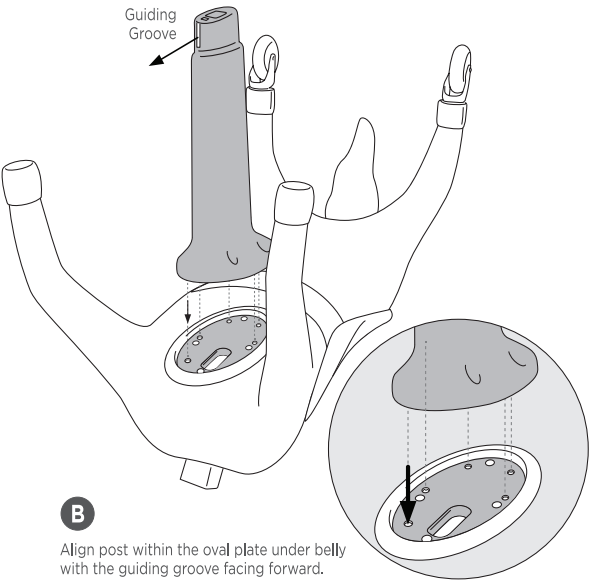

B
Align post within the oval plate under belly with the guiding groove facing forward.

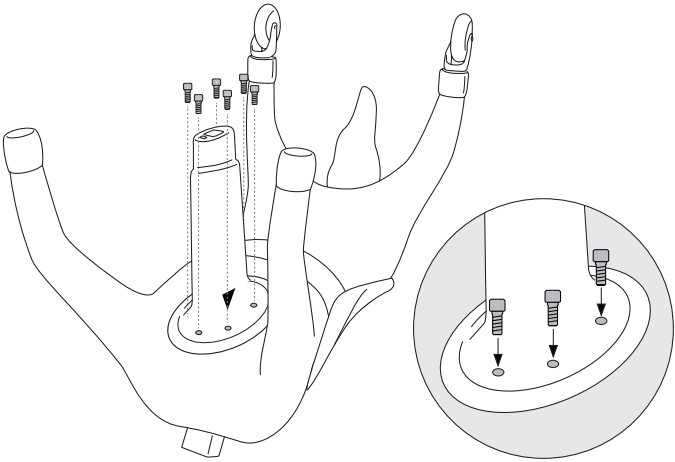

C
Secure post. Guide 6-M6 screws into the threads by hand, finish with the M6 wrench provided.

NEED HELP

Visit our website at powerpony.com or contact us at support@powerpony.com

ASSEMBLY I STEP 2

CONNECT POST TO ENGINE

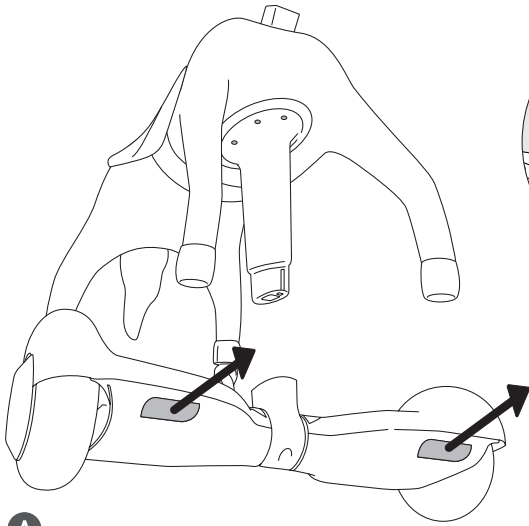

A

Place engine with lights forward.

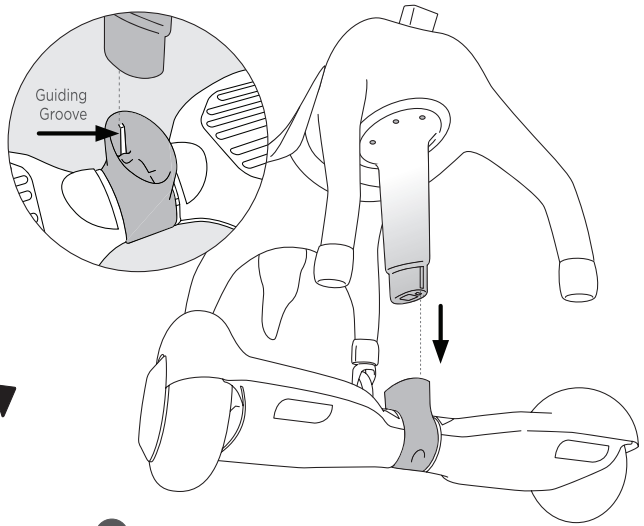

B

Insert post onto engine aligning the guiding groove.

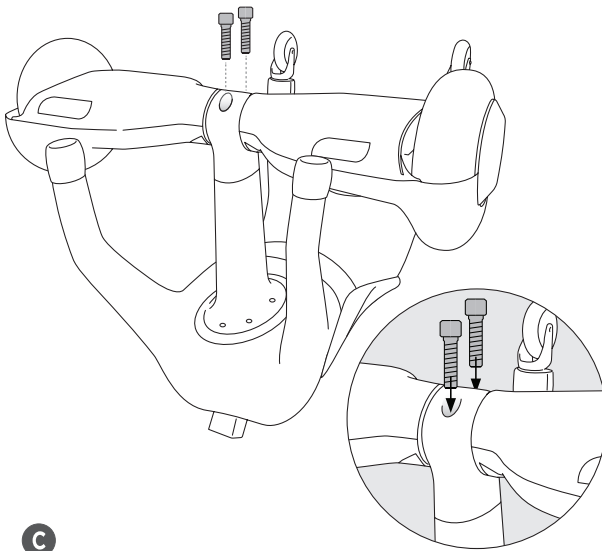

C

Slowly flip your Power Pony on its back on a clean, level surface, while holding the engine in place. Guide 2-M8 screws into the threads by hand, finish with the M8 wrench provided.

? NEED HELP

Visit our website at powerpony.com or contact us at support@powerpony.com

ASSEMBLY I STEP 3

CONNECT PONY HEAD TO PONY BODY

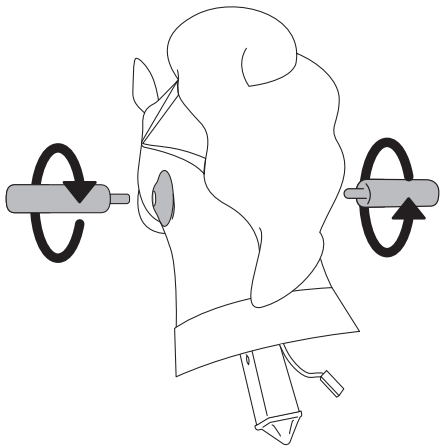

A
Attached handles to the head, turning each one as indicated until both are securely tightened.

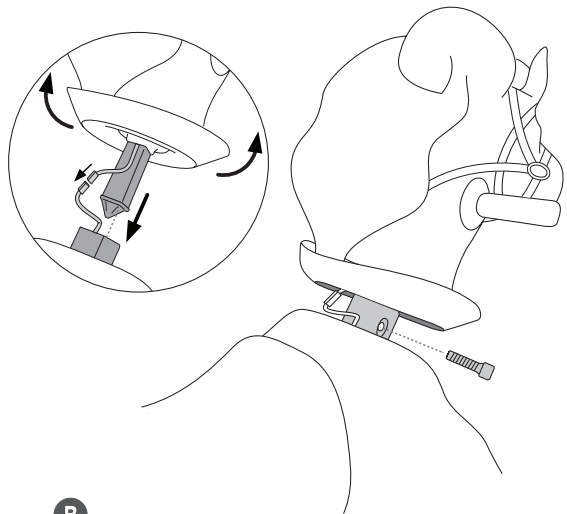

B
Secure neck tube. Align the holes and guide 1-M8 screw into the threads by hand, finish with the M8 wrench provided.
For optional lights and sounds, the plug at the neck needs to be connected, to the larger plug from the neck to that of the body.

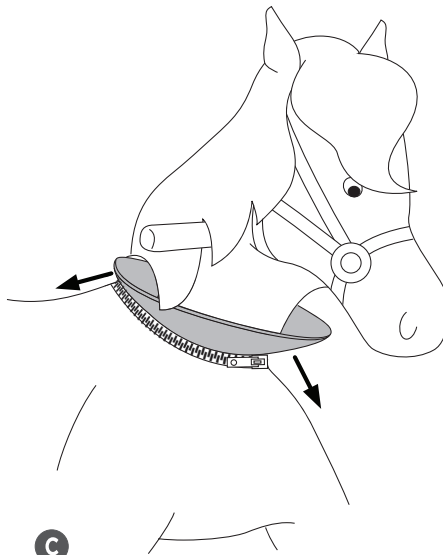

C
Zip neck to pony body and flip down collar to hide zipper.
CAUTION: Carefully align zipper and pull slowly.

? NEED HELP

Visit our website at powerpony.com or contact us at support@powerpony.com

CHARGING THE BATTERY

CHARGE PRIOR TO USE

Your Power Pony may not have a fully charged battery; therefore, you must charge the battery prior to use.

- Initial charge time: 4 hours.
- Recharge time: approximately 2 - 3 hours, even if the light turns green. Recommended maximum charging time is 6 hours.
- Always charge the battery immediately after riding.
- Fully charge battery before storing for extended periods of time.
- Do not charge overnight.
- Always unplug charger from the wall outlet when not in use.
- Make sure the power switch is turned OFF when unit is not in use. If the power switch is left on for an extended period of time, the battery may reach a stage at which it will no longer hold a charge.
- To ensure long battery life, never store the product in freezing or below freezing temperatures! Freezing will permanently damage the battery.
- Run time: Up to 40 minutes of continuous ride time. Run time may vary depending on riding conditions, rider weight, climate, and/or proper maintenance.
- Battery life can vary depending on proper maintenance and usage of the unit.

Notice: Failure to recharge battery periodically or at least once a month may result in a battery that will not maintain or accept a charge.

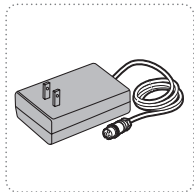

Note: Make sure power is turned OFF when unit is not in use. If the power switch is left on for an extended period of time, the battery may reach a stage at which it will no longer hold a charge.

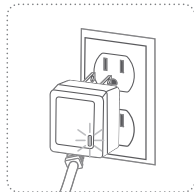

1. Plug the charger plug into wall outlet. The light on the charger should be green.
Note: If green light (LED) does not turn on, try a different outlet.

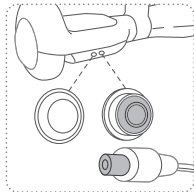

2. Plug the charger into the charger port on the Power Pony. Make sure the power switch is in the OFF position. The light on the charger should turn red during charging. The light will turn green again when charging is complete.

WALL OUTLET | GREEN
Stand by

WALL OUTLET & UNIT | RED
Charging

WALL OUTLET & UNIT | GREEN
Charged

*This could take several minutes to turn from green to red to indicate charging.

The charger supplied with the Power Pony should be regularly examined for damage to the cord, plug, enclosure, and other parts. In the event of damage, the Power Pony must not be charged until the charger has been repaired or replaced.

Chargers have built-in over-charge protection to prevent battery from being over-charged.

Note: If the charger gets warm during regular use, this is a normal response and is no cause for concern. If your charger does not get warm during use, it does not mean that it is not working properly.

⚠️ WARNINGS

- **Use ONLY with the recommended charger.** Batteries are only to be charged under adult supervision. The charger is not a toy.
- **NEVER** use an extension cord when charging. Always disconnect the charger before wiping down or spot cleaning the Power Pony.
- **NEVER** use a damaged charger. Using a damaged charger may cause a fire or explosion.

🔥 FLAMMABLE AND EXPLOSIVE MATERIALS

- Use of a battery or charger other than the supplied rechargeable battery and charger may cause a fire or explosion. Only use the supplied rechargeable battery and charger with your Power Pony.
- Do not charge the battery near heat or flammable materials.
- **Using the rechargeable battery and charger for any other product may result in overheating, fire or explosion.**
- Never use the rechargeable battery and charger with another product.
- Plug wall charger directly into a wall outlet. Do not use an extension cord when charging as the use of an extension cord can cause a fire.

⚡ ELECTRIC SHOCK AND FIRE WARNINGS

- Liquids on the battery may cause fire or electric shock.
- Always keep all liquids away from the battery and keep the battery dry.
- Tampering or modifying the electric circuit system may cause a shock, fire or explosion and may permanently damage the system. Exposed wiring, or circuitry in the charger may cause electric shock. Always keep the charger housing closed.
- Regularly check charger, supply cord and connectors for wear and damage. Look for frayed or kinked wires, any exposed inner wires, any missing insulation. If any damage is observed do not plug in the charger and do not charge the battery.

PRE-RIDE SAFETY CHECKLIST

TO BE PERFORMED BY A SUPERVISING ADULT

⚠ WARNING

Always perform the following safety checks before every ride. Do not ride the Power Pony if it is not in proper working condition. If the Power Pony is damaged in any way, do not ride. The failure to perform the following safety checks, or riding the Power Pony when it is not in proper working condition, may result in an accident, severe injury or even death.

○ WHEELS

Verify that the wheels are not worn down and have adequate traction. Verify that the rear casters are well secured to the back legs and do not require tightening. Notice: Impacting wheels against hard surfaces can damage the wheels. Wheels are not covered under the Limited Warranty.

○ ENGINE

Verify that the battery is fully charged, and the charging cord is not attached to the Power Pony. No wiring is exposed, worn, or detached. Check for cracks to the engine casing and confirm the motor is not hot to touch. Verify that the power button is functioning, and lights and sounds are working properly.

○ FRAME

Check the frame for cracks, breaks, or bends. Verify that the legs, post, or any other parts of the frame are not bent, broken, or cracked.

○ HARDWARE/LOOSE PARTS

Check all parts, such as nuts, bolts, cables, fasteners, and other connections to ensure they are secure and assembled correctly. There should not be any unusual rattles or sounds from loose parts or broken components. Ensure that the reigns or other straps do not interfere with wheels or operation of your Power Pony.

○ SAFETY GEAR

Always wear an approved protective helmet with a properly secured chin strap, and protective gear including elbow pads and kneepads. Always wear athletic shoes (lace-up shoes with rubber soles) and keep shoelaces tied and out of the way of the wheels, motor and drive system. NEVER RIDE BAREFOOTED OR IN SANDALS

○ LAWS AND REGULATIONS

Always check and obey all local laws or regulations.

○ SAFETY WARNINGS

This manual contains important assembly, safe-riding instructions, maintenance, warnings and other safety information. It is your responsibility to review this information and make sure that all riders understand all warnings, precautions, instructions, and safety topics covered in this manual, and to make sure that young riders are able to safely and responsibly use this product before every ride. Adult supervision is required at all times during use of the Power Pony.

CALIBRATING THE POWER PONY

CALIBRATING YOUR POWER PONY ZUME ENGINE MAY BE NEEDED PERIODICALLY FOR OPTIMUM PERFORMANCE. MAKE SURE YOUR BATTERY IS FULLY CHARGED 100% BEFORE CALIBRATING.

TO BE PERFORMED BY A SUPERVISING ADULT

STEP 1

Put the engine on a flat surface and position both foot pads evenly. Line up the center piece lines with the lines on the both sides of the engine to ensure both are equally balanced (as pictured to the right).

STEP 2

Turn on the engine. Press and hold the power button for 5 to 7 seconds to go into calibration mode. The lights over the wheels will flash multiple colors alerting you that the calibration is complete. Release the hold from the power button, proceed to step 3.

STEP 3

Press the power switch to turn OFF the engine

STEP 4

Press the power switch again to turn the engine back on.

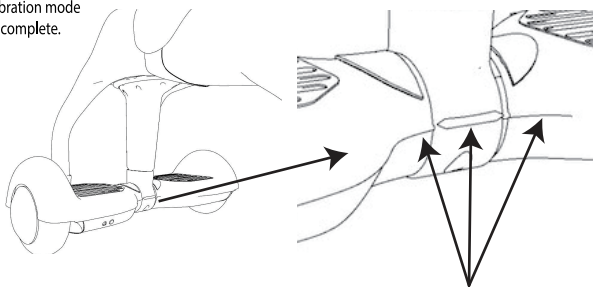
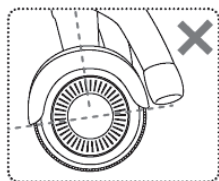
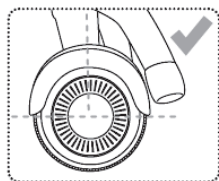

**YOU ARE NOW READY
TO RIDE!**

***Make sure all three lines align in a straight line**

HOW TO OPERATE THE POWER PONY

POWER PONY CONTROLS & MANEUVERS

Before you ride the Power Pony, take the time to study these safe operating instructions and learn how to control the Power Pony when riding. Start out slowly. You must familiarize yourself with these riding hints and tips with the Power Pony to help you maintain control when riding. Practice riding only in open areas free of water, debris, and other obstacles. **The best way to learn how to ride the Power Pony is at low speed.**

The Power Pony allows for really creative riding, spinning and turning like no other ordinary ride-on toy. Be mindful of the rear caster wheels and how they allow for rapid changes in direction. The more you ride the sooner you will master the unique riding characteristics of the Power Pony. Practice with the Power Pony can lead to amazing fun, but **exercising caution and common sense when riding all ride-on, moving products is of the utmost importance for every rider.**

Safety in operating the Power Pony is important. The rider must always ride in a seated position. **Do not ride while standing.** Please familiarize yourself with the following instructions for an optimal riding experience

STEP 1

Press the power button to turn on the Power Pony only after you are in a safe environment for riding.

STEP 2

Adjust the saddle and sit comfortably on the Power Pony and place both hands on the handlebars. Grip the handles.

STEP 3

Evenly distribute your feet across both ZUME Engine footpads. Your Zume Engine footpads are only activated when your feet are in constant contact.

STEP 4

Constant foot pressure on your footpads and rotation forward or backward makes your Power Pony move properly, more rotation on one side or the other will execute a turn.

Note: If you attempt to ride the Power Pony while the two sides are not calibrated at level your Power Pony may spin one way or another.

For even more fun — name your Power Pony and/or change your factory settings — Download the ZUME IOS APP.

- In video format at: powerpony.com/QuickStart
- By scanning the QR code here



SPEED LIMIT

The Maximum Speed limit of the Power Pony is approximately 7 miles per hour (12 kilometers per hour). Never ride over the maximum allowable speed. If you exceed the speed limit, immediately slow down.

⚠ WARNING:

Never exceed the maximum allowable speed of the Power Pony. Riding over the maximum speed limit may result in loss of control, severe injury or death.

RIDING LIMITS

The maximum range of the Power Pony riding device is subject to multiple factors, including:

Terrain: Smooth, flat terrain will increase the device's range, while rougher, bumpier terrain will reduce it.

Weight: Lighter rider will be able to travel further on a single charge.

Environment Temperature: Extreme hot or cold temperature will reduce the device's range.

Speed and driving style: Keeping a medium, comfortable speed will increase the maximum range of the device, while frequent starts, stops, and abrupt turns will reduce it.

⚠ WARNING

For your safety, do not attempt sharp turns at high speeds. Do not start or end operation of the Power Pony on a slope as this may damage system or cause it to function incorrectly. Failure to follow the instructions for safe riding and operation of the Power Pony in this manual may result in loss of control, a roll over, the rider falling off or other accident leading to severe injury or even death.

💡 RIDING TIPS

Keep in mind that foot pressure is what makes the Power Pony move.

- The riders feet must be correctly positioned and stay flat on each footpad.
- While keeping your feet flat on the Zume footpads with pressure, rotating each side evenly will make your Power Pony move. To stop or slow down while moving forward, while applying pressure to the footpads, rotate each side evenly backwards, to stop or slow down while moving backwards, while applying pressure to the footpads, rotate each side forward.
- Lifting your feet or positioning them incorrectly on each footpad could cause your Power Pony to turn abruptly.

Note: It is important to remember to keep both feet flat on the foot pads with even straight line.

***The Power Pony riding experience is interactive, unique, and fun, and may require practice to master the ride movement.**

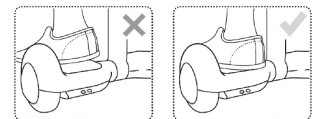

HOW TO OPERATE THE POWER PONY

RIDING SAFELY

SAFETY FEATURES

Your Power Pony engine will alert the user with a warning light and alarm buzzer if any of the following events occur during use:

- When the charge of the battery is low (Low Battery).
- If you rock back and forth for more than 30 seconds.

In addition, the Power Pony will automatically enter "stop" mode if any of the following occurs:

- The foot paddles rotate in either direction more than 35 degrees.
- The tires become locked for more than 2 seconds.
- If there is sustained, continued discharge of battery that is caused by a pushing the engine for too long (such as climbing a steep slope).

LOW BATTERY

If the "Low Battery" indicator on the Power Pony turns on, DO NOT continue to operate the Power Pony. If either of the following occurs, immediately stop using the Power Pony.

- 1 - Noticeable smell or high temperature coming from the engine.
- 2 - Leaking or discharge of any liquid from the engine.

BEST RIDING PRACTICES

For your safety, please observe the following conditions when operating the Power Pony:

- Always wear a certified protective helmet and safety equipment including elbow and knee pads when riding.
- Always wear shoes without heels to ensure proper contact with the foot pads and comfortable, casual sportswear. Do not wear loose articles of clothing or accessories.
- Ride the Power Pony in an open field, empty parking lot, or other familiar, flat terrain free of debris, uneven surfaces and bumps. Riding surfaces should be flat with minimal elevation changes. Avoid riding on steep slopes. Do not ride near steps or swimming pools.
- Do not ride on a wet road or in the rain or snow.
- Do not ride at high speeds. Do not exceed the recommended maximum speed under any circumstances.
- Do not ride while standing.
- Do not ride at night or when visibility is impaired or limited.
- Never allow more than one person on the Power Pony at any time.
- Never ride when distracted. Do not wear headphones or use any other electronic devices while riding.
- Avoid riding the Power Pony near pedestrians, vehicles, or traffic. The Power Pony is not street-legal and should not be operated on roads where motor vehicles are permitted. DO NOT RIDE AROUND CARS!

⚠ WARNING:

Always follow these warnings and safe-riding instructions. The failure to follow these warnings and instructions can lead to loss of control or any accident, which may result in severe injury or death.

⚠ WARNINGS

Always keep children away from the wheels where there is a potential risk of pinching or crushing fingers or other appendages.

⚠ WARNINGS

Do not attempt stunts, tricks, or spins at excessive speeds in turns on your Power Pony as it may result in loss of balance, loss of control and tipping. Never accelerate out a spin.

NOTICE: Prolonged use when the battery is low will result in the wheels locking, potentially damaging the product permanently.

LIGHTS AND SOUNDS

LEARN HOW TO USE THE LIGHTS AND SOUNDS EFFECTS (OPTIONAL)

Your Power Pony is equipped to make sounds and to trigger flashing lights when tapping these secret locations.

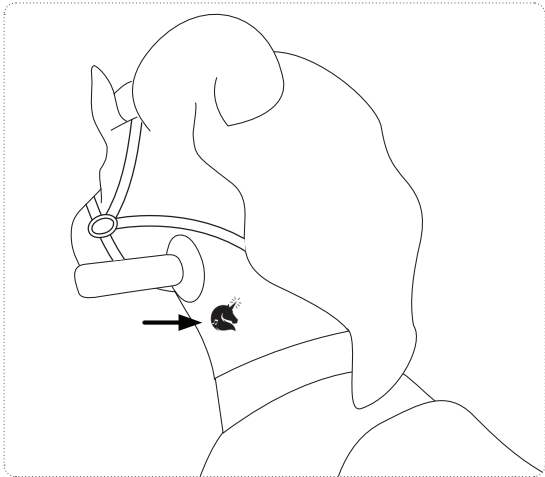

Tap the "horse" on the neck.

Reminder: For optional lights and sounds.
1. Install the two (2) AA Batteries included, in the battery box, and connect the battery box to the plug coming out of the head. Make sure the battery box switch is turned ON.

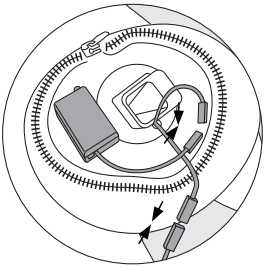

⚠️ WARNINGS

- Do not mix old and new batteries.
- Do not mix alkaline, standard (carbon-zinc), or rechargeable batteries.

RIDING MODES

UNDERSTANDING RIDING MODES

YOUR POWER PONY CAME SHIPPED TO YOU FROM ITS STABLE PROGRAMMED IN BEGINNER LEARNING MODE. AS YOU IMPROVE YOUR SKILLS and PRACTICE, you can always change settings to go faster by downloading the IOS ZUME App.

RIDING MODES	
Learning Mode	Freestyle Mode
Trot	Skilled
Gallop	Expert
Race	Master

PLEASE DOWNLOAD THE IOS APP TO CHANGE MODES



REPAIR AND MAINTENANCE

KEEPING YOUR POWER PONY IN GOOD WORKING CONDITION

CLEANING

Wipe down your Power Pony with a soft, dry cloth. You can spot clean the fabric only using a damp cloth and a mild detergent. Do not use harsh chemicals or abrasive cleansers. Never spray with a hose or submerge your Power Pony in water. Never clean your Power Pony while charging. Be sure to power down your Power Pony and make sure that it is disconnected from the wall outlet before attempting to clean it. Water will damage the motor, electrical system, and battery.

WHEELS

Wheels and are subject to normal wear and tear. It is the responsibility of the user to periodically inspect wheels for excess wear. The rear wheels are replaceable and can be changed.

Tools Required: 5 mm Allen Wrench, flat 24 mm Wrench (*not included*).

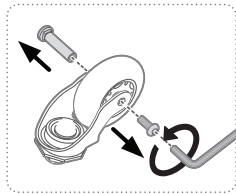

Carefully turn the unit over. Using a 4 mm Allen wrench, loosen coupling bolt and remove wheel.

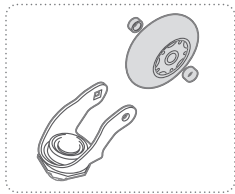

Install the wheel into the caster.

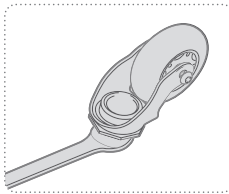

To remove the caster, use a 24 mm wrench to loosen nut on the caster and remove.

REPLACEMENT PARTS

The most frequently requested replacement parts are available for purchase on our website. For the complete selection of replacement parts visit powerpony.com

REPAIR CENTERS

For a list of authorized ZÜME repair centers, check online at powerpony.com

CHARGER

The charger supplied with the electric product should be regularly examined for damage to the cord, plug, enclosure and other parts and in the event of such damage, the product must not be charged until it has been repaired or replaced. Use ONLY with the recommended charger.

BATTERY CARE AND DISPOSAL

Please adhere to the following instructions for good care of the battery contained in the Power Pony.

Do not store in freezing or below freezing temperatures! To properly maintain your battery and ensure maximum battery life, carefully read the "Charging the Battery" section on page 7 of this owner's manual.

CONTAINS SEALED LITHIUM-ION BATTERIES. BATTERIES MUST BE RECYCLED

Disposal: Your ZÜME product uses sealed lithium-ion batteries which must be recycled or disposed of in an environmentally safe manner.

Only trained professionals should handle removal and maintenance of the battery. Do not dispose of a lithium-ion battery in a fire. The battery may explode or leak. Do not dispose of a lithium-ion battery in your regular household trash. The incineration, land filling or mixing of sealed lithium-ion batteries with household trash is prohibited by law in most areas. Return exhausted batteries to a federal or state approved lithium-ion battery recycler.

WARNING

Failure to properly adjust and tighten the screws, nuts and bolts that affix the rear wheels can cause you to lose control and crash.

WARNING CORROSIVE MATERIAL

Batteries contain chemicals (acids) which are toxic and corrosive. Never open the battery. If a battery leak develops, avoid contact with the liquid and place the damaged battery in a plastic bag. Refer to the disposal instructions. Contact or exposure to battery leakage may cause serious injury. If contact or exposure occurs with the skin or in the eyes, flush with cool water for at least 15 minutes. If the chemical is swallowed, immediately call 911 or contact a physician.

STORAGE

STORAGE AND OPERATING TEMPERATURE

- Check the battery and charger (supply cord, connector) for wear and damage before charging.
- Do not charge the battery if damage has occurred. Do not use an extension cord when charging the Power Pony.
- Do not charge the Power Pony if the charger or port is wet.
- Do not store or charge the Power Pony in extreme hot or cold temperatures as this will damage the battery and the internal electronics.
- Prolonged exposure to UV rays, rain and the elements may damage your Power Pony. **Store indoors when not in use.**

FCC COMPLIANCE

This device complies with Part 15 of the FCC Rules. Operation is subject to the following two conditions:

- (1) This device may not cause harmful interference, and
- (2) this device must accept any interference received, including interference that may cause undesired operation.

Note: This equipment has been tested and found to comply with the limits for a Class B digital device, pursuant to part 15 of the FCC Rules. These limits are designed to provide reasonable protection against harmful interference in a residential installation. This equipment generates, uses and can radiate radio frequency energy and, if not installed and used in accordance with the instructions, may cause harmful interference to radio communications. However, there is no guarantee that interference will not occur in a particular installation. If this equipment does cause harmful interference to radio or television reception, which can be determined by turning the equipment off and on, the user is encouraged to try to correct the interference by one or more of the following measures:

- Reorient or relocate the receiving antenna.
- Increase the separation between the equipment and receiver.
- Connect the equipment into an outlet on a circuit different from that to which the receiver is connected.
- Consult the dealer or an experienced radio/TV technician for help.

WARNING

Changes or modifications to this unit not expressly approved by the party responsible for compliance, could void the user's authority to operate the equipment.

WARRANTY

ZÜME LIMITED WARRANTY

The manufacturer warrants this product to be free of manufacturing defects for a period of 90 days from date of purchase when properly assembled, operated, maintained, and stored in accordance with the recommendations set forth by ZÜME, including in this Owner's Manual. This Limited Warranty does not cover normal wear and tear of front tires, rear wheels, or any damage, failure or loss caused by improper assembly, maintenance, storage, or abuse of the Power Pony.

- This Limited Warranty will be void if the product is ever used in a manner other than for recreation, is modified in any way, or rented.
- The manufacturer is not liable for incidental or consequential loss or damage due directly or indirectly to the use of this product.
- ZÜME does not offer an extended warranty. If you have purchased an extended warranty, it must be honored by the store at which it was purchased.
- For your records, save your original sales receipt with this manual.

EXCLUSIONS OF LIABILITY

EXCEPT AS OTHERWISE EXPRESSLY STATED HEREIN, ZÜME MAKES NO OTHER WARRANTY OR REPRESENTATION OF ANY KIND, EXPRESSED OR IMPLIED. THE IMPLIED WARRANTY OF MERCHANTABILITY AND FITNESS FOR A PARTICULAR PURPOSE ARE EXCLUDED FROM THIS LIMITED WARRANTY. TO THE EXTENT THEY CANNOT BE DISCLAIMED, THE IMPLIED WARRANTIES ARE LIMITED IN DURATION TO THE LIFE OF THE EXPRESS WARRANTY. THIS LIMITED WARRANTY ALSO EXCLUDES INCIDENTAL, CONSEQUENTIAL, AND SPECIAL DAMAGES. THIS EXCLUSION OF CONSEQUENTIAL, INCIDENTAL, AND SPECIAL DAMAGES IS INDEPENDENT FROM AND SHALL SURVIVE ANY FINDING THAT THE EXCLUSIVE REMEDY FAILED OF ITS ESSENTIAL PURPOSE. THE REMEDIES SET FORTH IN THIS WARRANTY ARE THE ONLY REMEDIES AVAILABLE TO ANY PERSON UNDER THIS WARRANTY. SOME STATES/PROVINCES DO NOT ALLOW FOR THE DISCLAIMERS, LIMITATIONS, AND EXCLUSIONS IDENTIFIED ABOVE AND, AS A RESULT, THEY MAY NOT APPLY TO YOU.

Upon purchase of the Power Pony, purchaser assumes all liability, all personal injury and property damage resulting from the handling, possession or use of the Power Pony.

No agent, employee or representative of ZÜME, nor any ZÜME Service Partner, is authorized to bind ZÜME to any affirmation, representation or warranty regarding the Power Pony except as specifically contained in this limited warranty.



We would love to hear about your
POWER PONY

Please SHARE your
ZÜME Experience with us at
share@powerpony.com

To see our complete line of
POWER PONY RIDE-ON TOYS, VISIT:
powerpony.com



Z:ME®

Imagined
by kids for kids!