

TURFBUCKET®

OWNER'S MANUAL

Riding Lawn Tractor Double Grass Bagger

MODEL NO. MK1012365

- ✓ PARTS LIST
- ✓ ASSEMBLY INSTRUCTIONS
- ✓ OPERATION

C-MAN-0003



8 0 3 4 6 7 2 4 1 2 8 9

BTEN
PARTS

BTENPARTS.COM

THANK YOU

Thank you for purchasing a bagging attachment. It was carefully engineered to provide excellent performance when properly operated and maintained.

Please read this entire manual prior to operating the equipment. It instructs you how to safely and easily set up, operate and maintain your equipment. Please be sure that you, and any other people who will operate the machine, carefully follow the recommended safety practices at all times. Failure to do so could result in personal injury or property damage.

All information in this manual is relative to the most recent product information available at the time of printing. Review this manual frequently to familiarize yourself with the equipment, its features and operation. Please be aware that this Operator's Manual may cover a range of product specifications for various models. Characteristics and features discussed and/or illustrated in this manual may not be applicable to all models. We reserve the right to change product specifications, designs, and equipment without notice and without incurring obligation.

If you have any problems or questions concerning this equipment please contact us. We want to always ensure your complete satisfaction. Throughout this manual, all references to the right and left side of the machine are observed from the operating position.

CONTENTS OF CARTON

Before beginning installation, remove all parts from the carton to make sure everything is present. Carton contents are listed below and shown in Figure 1*: The hardware pack(s) included in this kit are detailed on page 4.

- A. Bagger Cover Kit – K-BPK-0002
 - B. Baffle – C-MBP-0002
 - C. Baffle Housing – C-MBP-0003
 - D. Screen – C-MBP-0004
 - E. Window – C-MBP-0005
 - F. Hose Connect Kit – K-BPK-0001
 - G. Hose Adapter – C-MBP-0006
 - H. Quick Connect – C-MBP-0007
 - I. Mounting Bracket Kit – K-MMK-0002
 - J. Universal Support Bracket – C-MBM-0007
 - K. Hitch Bracket Side – C-MBM-0009 (2)
 - L. Hitch Bracket Rear – C-MBM-0008
 - M. Frame Assembly – K-MMK-0001
 - N. Hanger Assembly – C-MBM-0001
 - O. Hinge Pin – C-MBM-0002
 - P. Bagger Cover – C-MBP-0001
 - Q. Hose – C-MBH-0001
 - R. Chute – C-CHU-0002
 - S. Grass Bag Assembly (2) – C-MBB-0001
 - T. Vertical Support – C-MBM-0003
 - U. 700 Series Mounting Brackets – K-MMK-0008
 - V. RH Bracket – C-MBM-0027
 - W. LH Bracket – C-MBM-0028
- Hardware Pack – K-HWK-0001 (shown on page 4)
 - Hardware Pack – K-HWK-0003 (shown on page 4)
 - Hardware Pack – K-HWK-0028 (shown on page 4)

*Carton content diagrams not shown to scale.

CONTENTS OF CARTON

FIGURE 1

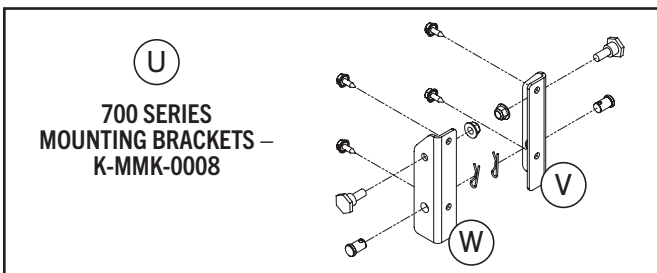
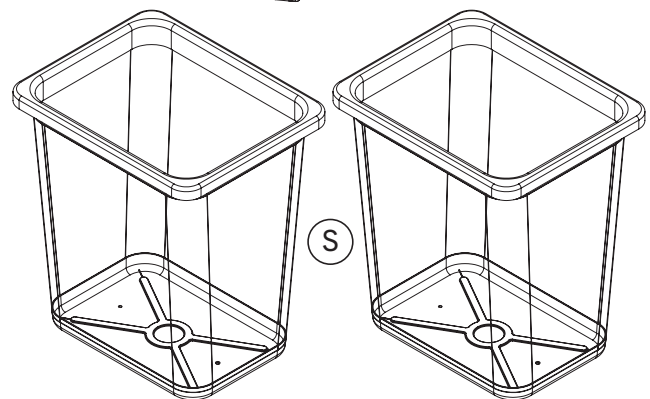
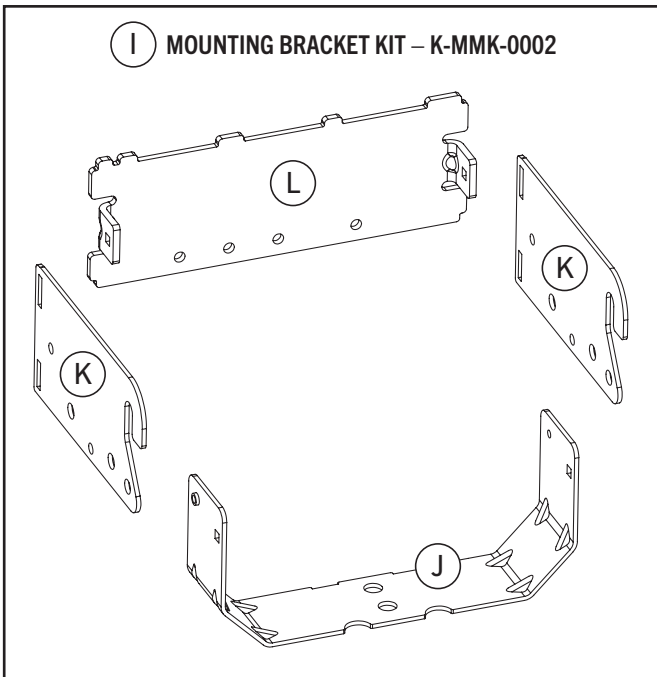
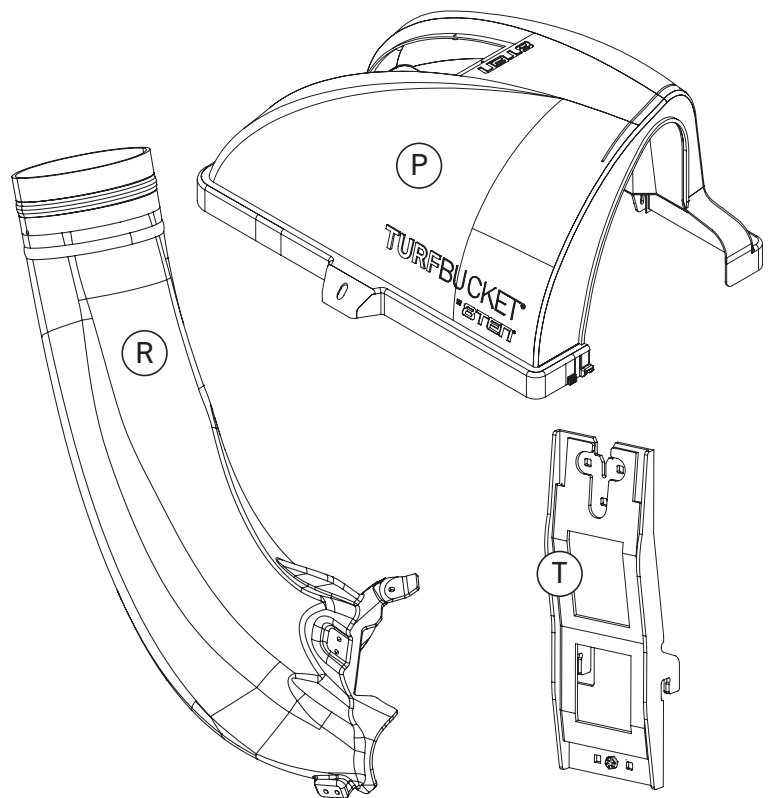
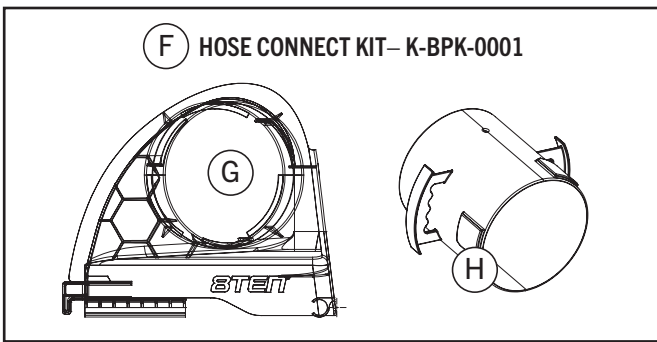
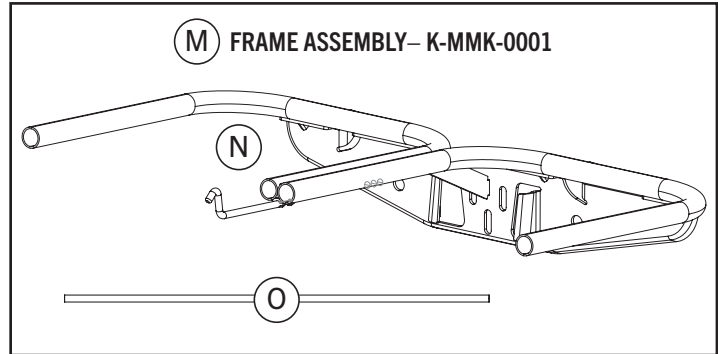
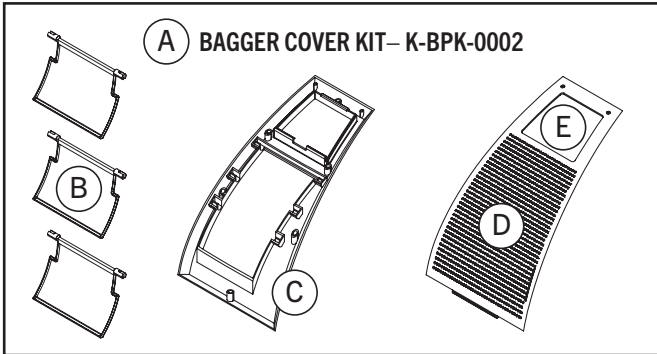

CONTENTS OF HARDWARE PACK

Please check your hardware packs against the illustrations below.* The quantities for each item are listed in parentheses.

HARDWARE PACK K-HWK-0001

- Button Head Hex Drive Screw (6) – C-SCW-0033
- Self Tapping Philips Screw (2) – C-SCW-0034
- Hex Lock Nut (6) – C-NUT-0019
- Socket Head Screw (2) – C-SCW-0056
- Split Lock Washer (2) – C-WSH-0066

HARDWARE PACK K-HWK-0003

- Carriage Bolt, 5/16"-18 x 1" (7) – C-SCW-0016
- Clevis Pin (1) – C-PIN-0004
- Cotter Pin (1) – C-PIN-0008
- Flanged Hex Bolt, 5/16"-18 x 0.75" (4) – C-SCW-0022
- Hex Flanged Lock Nut, 5/16"-18 (2) – C-NUT-0013

- Washer, 0.337" ID x 0.867" OD x 0.057" (2) – C-WSH-0043
- Wing Nut, 5/16"-18 (6) – C-NUT-0018

HARDWARE PACK K-HWK-0028

- Hex Bolt, 5/16"-18 x 3.25" (1) – C-SCW-0024
- Hex Bolt, 1/4"-20 x 0.75" (4) – C-SCW-0029
- Hex Flanged Lock Nut, 1/4"-20 (4) – C-NUT-0016
- Ribbed Push-In Rivet (2) – C-RVT-0001
- Washer, 0.281" ID x 0.625" OD x 0.057" (4) – C-WSH-0044
- Wing Nut, 5/16"-18 (1) – C-NUT-0018
- Chute Bracket (1) – C-BRK-0001
- Chute Mounting Rod (1) – C-BRK-0005

*Hardware diagrams not shown to scale.

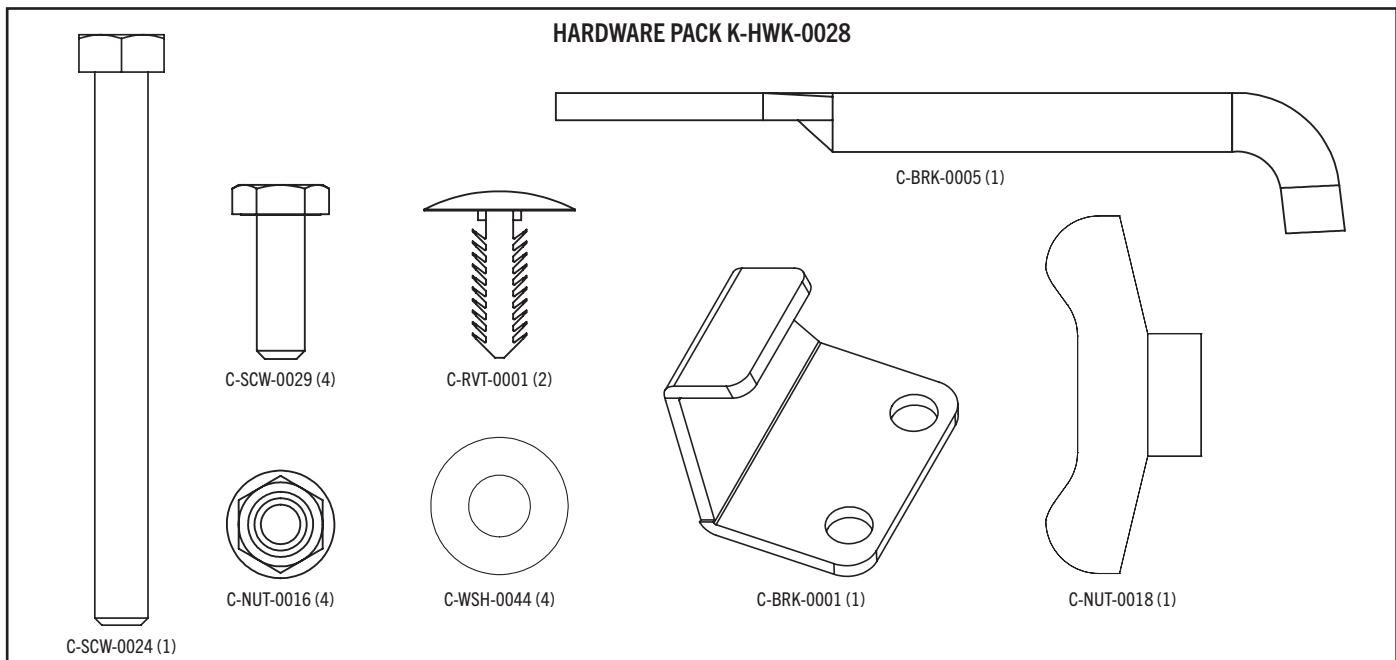
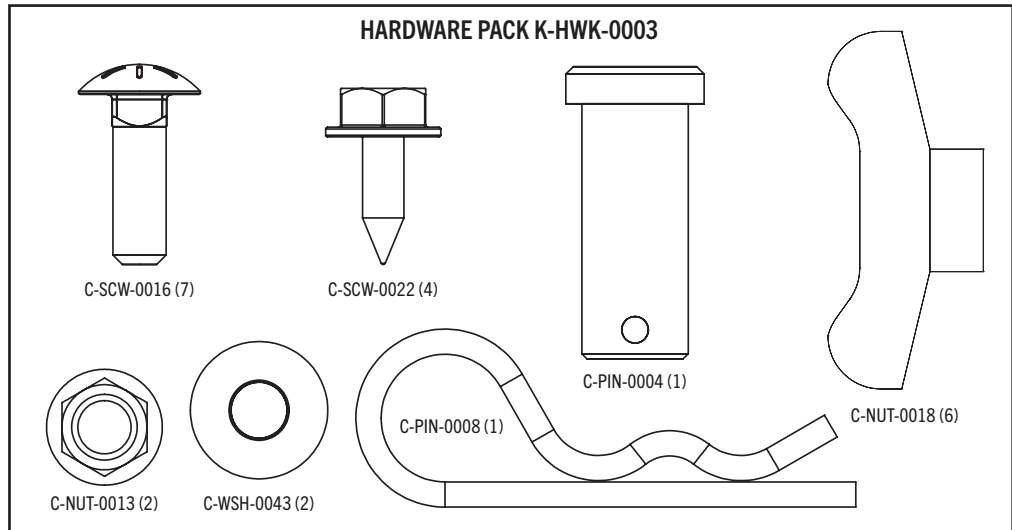
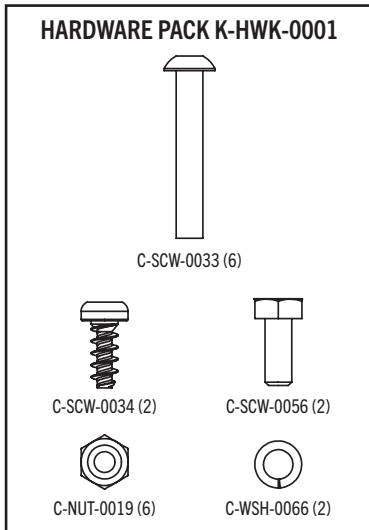

ASSEMBLY & INSTALLATION

NOTE: References to left, right, front and rear of the tractor are from the operator's position, unless otherwise stated.

⚠ IMPORTANT ⚠ Before assembly, place the tractor on a firm, level surface, disengage the PTO, stop the tractor engine, and set the parking brake.

For convenience, pivot the seat forward and leave it in that position until the grass collector is fully mounted and assembled.

Required Tools

- 7/16" Socket Wrench (2)
- 1/2" Socket Wrench

Mounting 700 Series Mounting Brackets Assembly

To install 700 Series Mounting Brackets, follow these steps:

1. If not already installed by the factory, install a Shoulder Bolt from the hardware pack on each bracket, securing them with Flange Lock Nuts also included in the 700 Series Mounting Brackets Assembly (K-MMK-0008) hardware pack. Refer to Figure 2.
2. If already installed in the brackets, remove the Clevis Pins and clips, retain for later instructions. Refer to Figure 2.
3. Mount the mounting brackets to your tractor using four Self-Tapping Hex Screws included with your kit. See Figure 3.

FIGURE 2 – STEP 1

K-MMK-0008 – Mounting Bracket

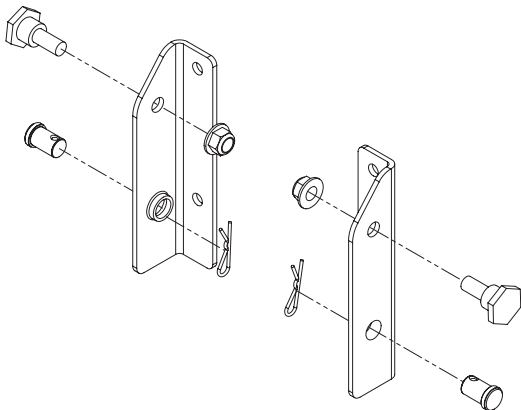
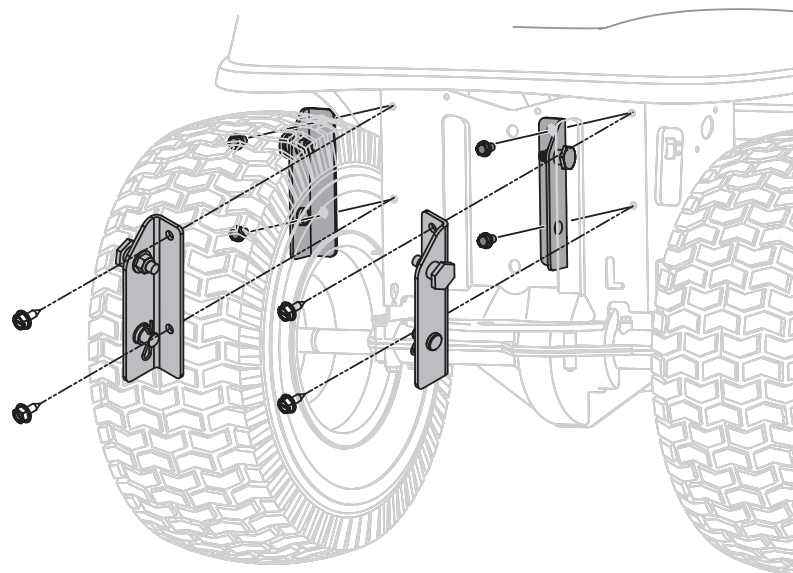

FIGURE 3 – STEP 2

Mount the 700 Series Tractor Mounting Brackets



ASSEMBLY & INSTALLATION

Assemble Mounting Brackets

To assemble the universal mounting assembly, locate the Mounting Bracket Kit – K-MMK-0002 and the universal support bracket (C-MBM-0007) and follow these steps:

1. Attach the two hitch side brackets to the rear support bracket using two Carriage Bolts (C-SCW-0016) and Wing Nuts (C-NUT-0018) from hardware pack K-HWK-0003. See Figure 4.

NOTE: Hooks on side brackets should point downwards and tabs on rear support bracket point upwards.

2. Flip over assembly and mount hitch support bracket to universal support bracket using two Carriage Bolts (C-SCW-0016) and Wing Nuts (C-NUT-0018) from hardware pack K-HWK-0003, as shown in Figure 5.

NOTE: It might be easier during the mounting stage to leave this hardware only finger tight to facilitate lining up the hitch hole for the Clevis Pin. You will be instructed to tighten this hardware later in this manual.

Mount Assembly on Tractor

Install mounting assembly on tractor as follows:

1. Place hooked ends of mounting assembly over Shoulder Bolts on 700 Series Mounting Brackets previously installed on back of tractor frame, as shown in Figure 6, and line up hitch support bracket center hole with hole on the tractor's hitch.
2. Replace Clevis Pins and Cotter Pins removed in Mounting 700 Series Mounting Brackets Assembly section. See Figure 2.
3. Install the Clevis Pin (C-PIN-0004) from hardware pack K-HWK-0003 into the tractor's hitch and secure with Cotter Pin (C-PIN-0008). See Figure 7.

NOTE: The Clevis Pin can be fed down through the hitch plate and secured underneath with the Cotter Pin, or it may be easier to feed the Clevis Pin up through the hitch plate hole and secure with the Cotter Pin on the topside. Insert the Cotter Pin into the top hole, closest to the head of the pin. You may need to push up on the pin to make the hole accessible.

! IMPORTANT ! If you decide to leave the hitch support only finger tight during the assembly process, tighten all of the hardware securely at this time.

FIGURE 4 – STEP 1

K-MMK-0002 – AMB

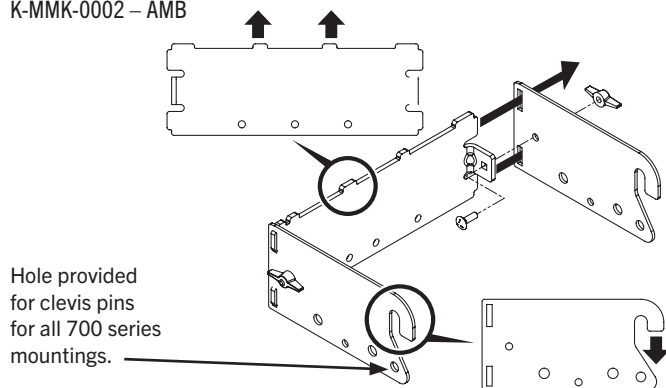

FIGURE 5 – STEP 2

K-MMK-0002 – AMB (700)

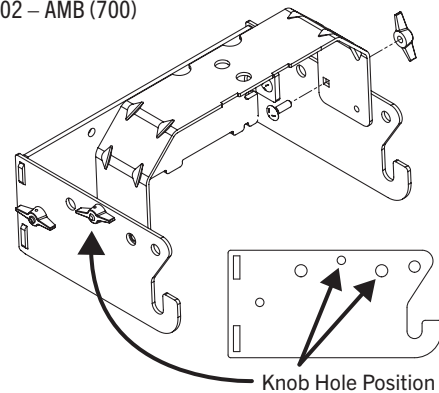

FIGURE 6 – STEP 1

K-MMK-0002 – AMB (700)

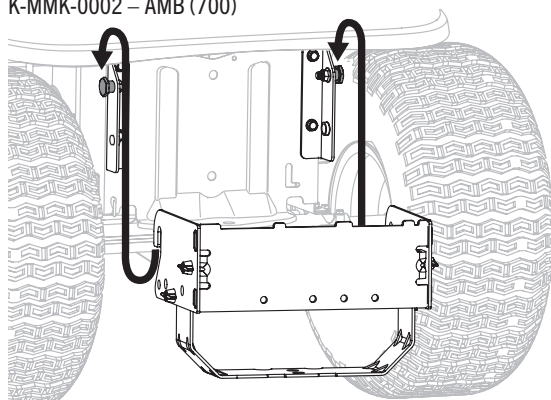
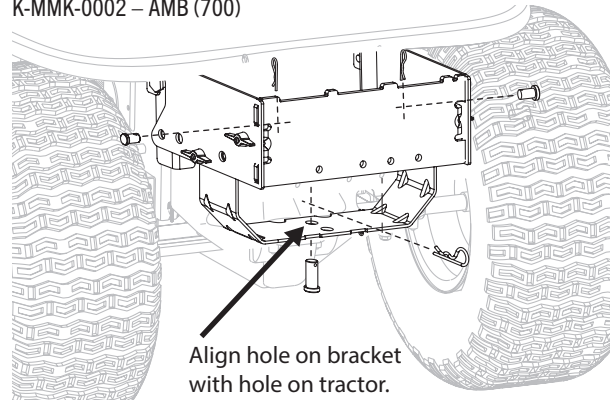

FIGURE 7 – STEP 2

K-MMK-0002 – AMB (700)



ASSEMBLY & INSTALLATION

Install the Vertical Bagger Support

1. Install the vertical bagger support (C-MBM-0003) onto the mounting assembly on the tractor by hooking it over the cross mounting bracket. See Figure 8.
2. Align the vertical bagger support with the hole labeled "C". See inset in Figure 8.
3. Secure the vertical bagger support to the cross mounting bracket using a Carriage Bolt (C-SCW-0016) and Wing Nut (C-NUT-0018) from hardware pack K-HWK-0003. See Figure 9.

NOTE: Position "C" is the recommended mounting position, but you may use other mounting positions to accommodate other attachments.

FIGURE 8 – STEP 1

K-MMK-0002 – Back View

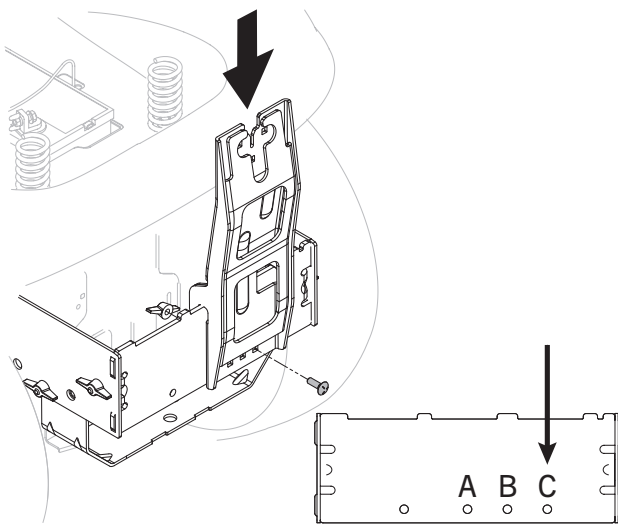
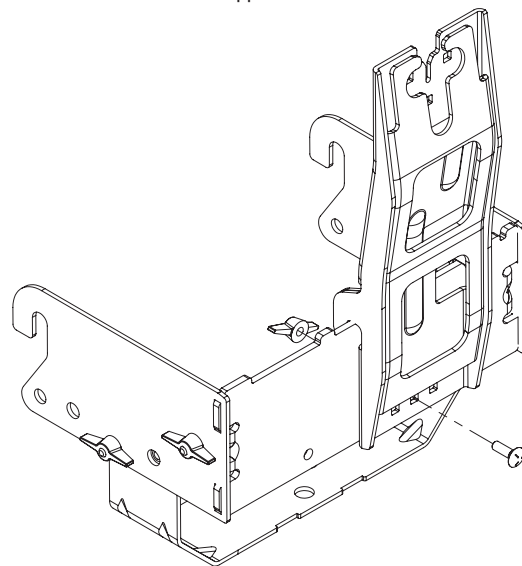

FIGURE 9 – STEP 2

K-MMK-0002 – AMB – Vertical Support Mount



Install Hanger Assembly

1. Install two Hex Head Screws (C-SCW-0056) through the hook into the end of the hanger assembly. See Figure 10.
2. Install and secure the hanger assembly (C-MBM-0001) onto the vertical bagger support using two Carriage Bolts (C-SCW-0016), two Cup Washers (C-WSH-0043) and two Flange Lock Nuts (C-NUT-0013) from hardware pack K-HWK-0003. Figure 10.

NOTE: Concave curve of cup washer should be facing hanger assembly.

FIGURE 10

K-MMK-0002 – Install Hanger

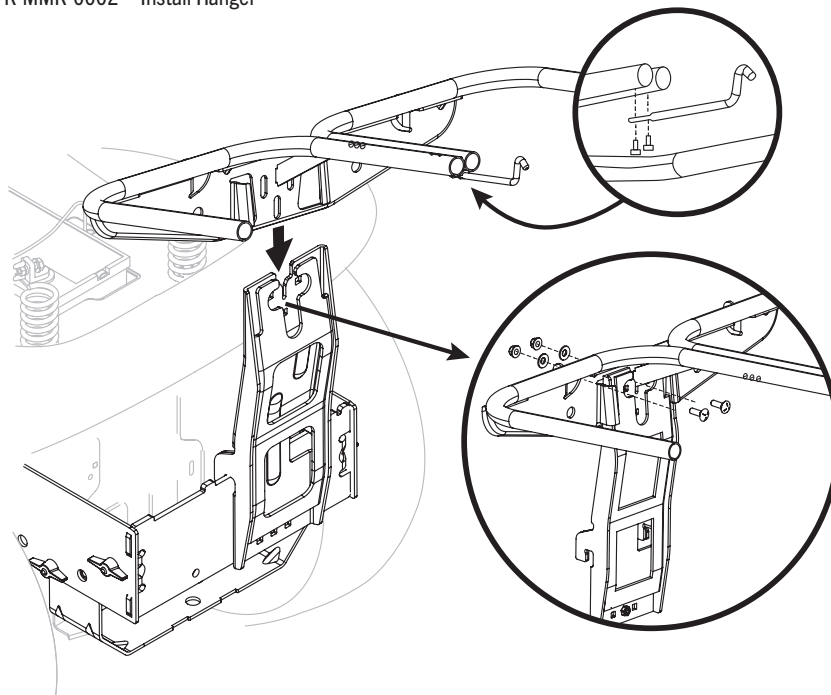

ASSEMBLY & INSTALLATION

Assembling Remaining Bagger Components

With the mounting brackets assembled and in place on the tractor, follow these steps to assemble the remaining bagger components.

1. Snap the upper chute support (C-MBP-0006) in place by first clipping the side portion onto the hanger assembly rail (2), as shown in Figure 11.
2. Snap the front side of the upper chute support to the rail (2), as shown in Figure 11.
3. Install the bagger cover onto the hanger assembly, as seen in Figure 12. The cover goes inside the two mounting tabs.

FIGURE 11

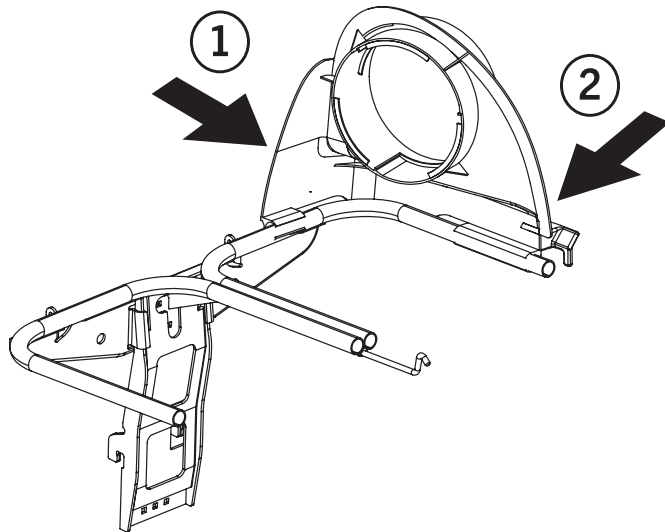

→ FIGURE 12

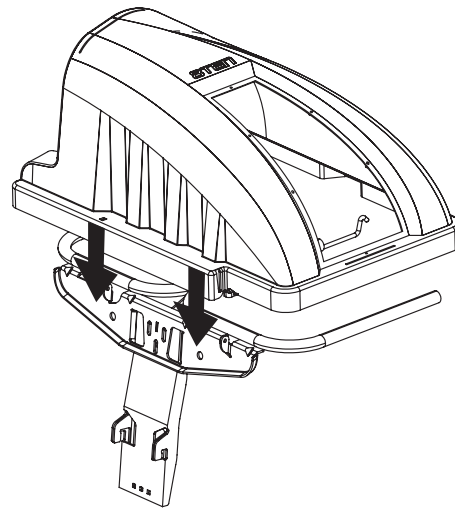

Assemble Baffle Housing Parts

NOTE: References to left, right, front and rear of the tractor are from the operator's position, unless otherwise stated.

⚠ IMPORTANT ⚠ Before assembly, place the tractor on a firm, level surface, disengage the PTO, stop the tractor engine and set the parking brake.

1. Mount baffle housing on the bagger cover using the six machine screws C-SCW-0033 and Lock Nuts C-NUT-0019 from the hardware pack K-HWK-0001 as shown in Figure 13.
2. Attach baffles on the housing, starting from the top, as shown in Figure 14.
3. Align and install the screen by pushing the tab into the slot on the cover. See Figure 15.
4. Use self-tapping screws C-SCW-0034 from the hardware pack K-HWK-0001 to secure it to the baffle housing. See Figure 16.
5. Slide the hinge pin (C-MBM-0002) into the hole located on the mounting tab, as shown in Figure 17. Use the cut-out window (see inset in Figure 17) to line up the hinge pin on the other side and push pin all the way in until it reaches the end-stop. At this point the pin clips into place and is secured by a tab in the bagger cover. See Figure 18.
6. Open bagger cover by pushing in on the rear, right-side tab with your right hand (1), and lifting the cover with your left hand in the center rear of the bagger cover (2) as shown in Figure 19.
7. Install both grass bag assemblies (C-MBB-0001) onto the hanger assembly rails by inserting the front edge in first (1), and then setting the back edge down until it fits into the assembly (2), as shown in Figure 20.

ASSEMBLY & INSTALLATION

FIGURE 13

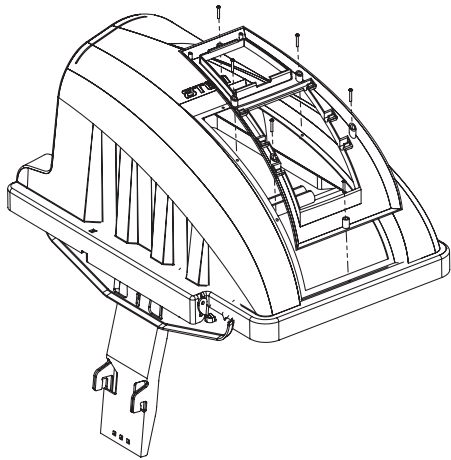

→ FIGURE 14

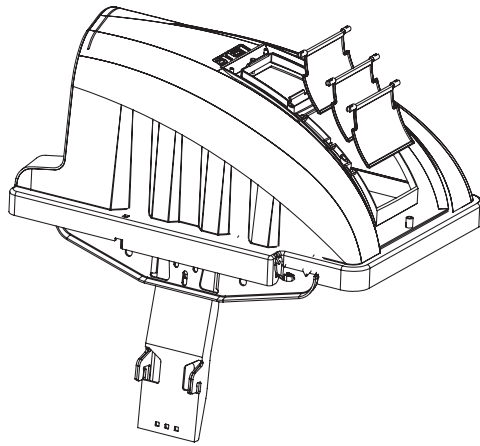

→ FIGURE 15

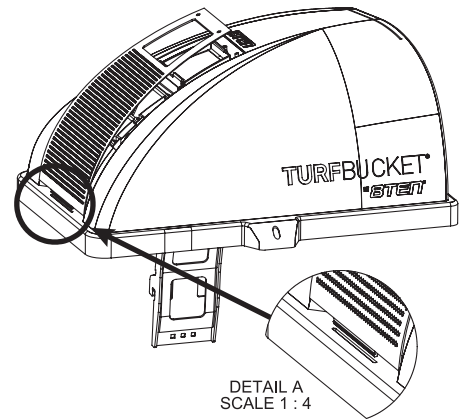
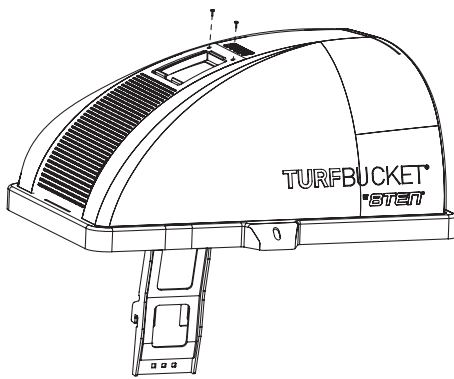
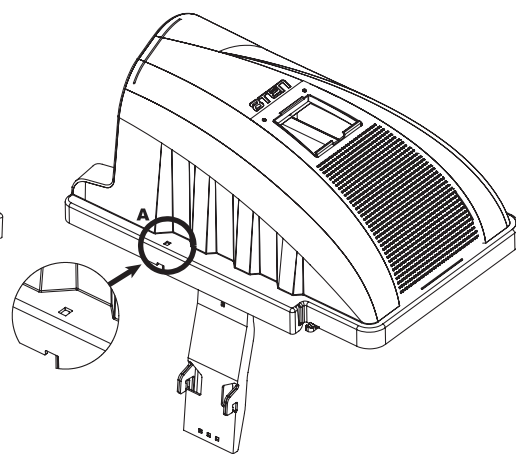

FIGURE 16



→ FIGURE 17



→ FIGURE 18

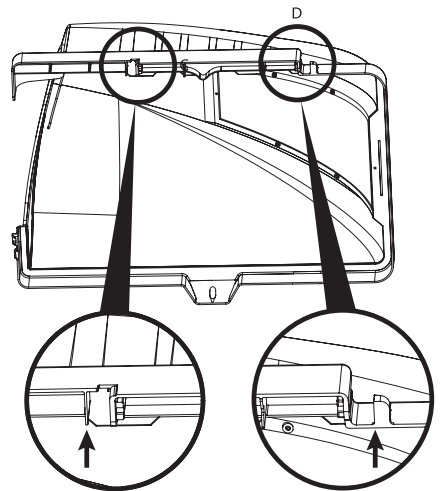
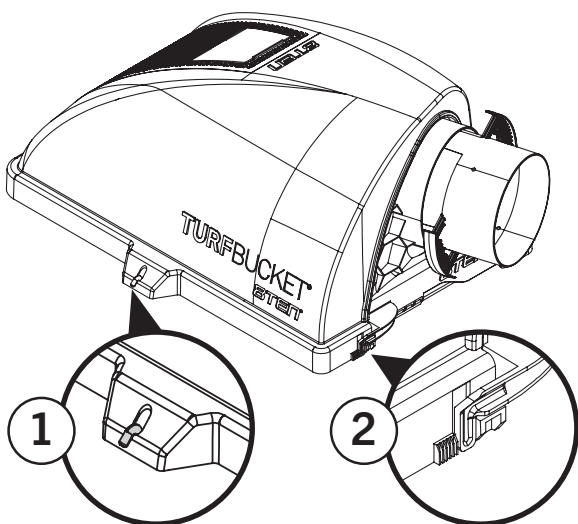
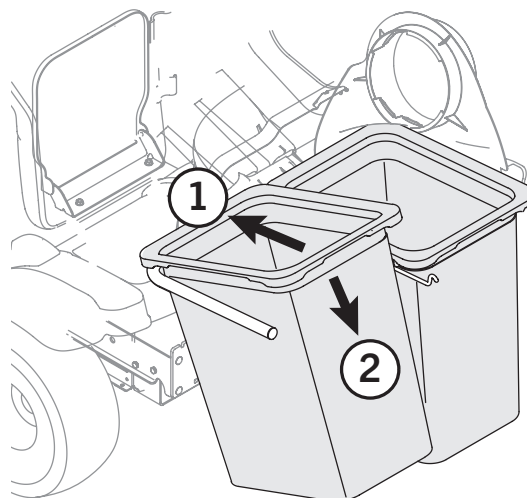

FIGURE 19



→ FIGURE 20



ASSEMBLY & INSTALLATION

Installing the Chute

1. Place deck in lowest position.
2. Remove Wing Nut holding mulch plug closed on deck.
3. With the tractor's mulch plug raised up and held open (1), install the chute (C-CHU-0009) by placing the chute mounting rod into the hole provided in either your deck wheel bracket or chute mounting tab (2), as shown in Figure 21.
4. Secure the chute to the deck by using a Wing Nut (C-NUT-0018) from hardware pack K-HWK-0003. See Figure 22.
5. Release the mulch plug, making sure to rest it on the chute bracket previously installed on the chute. See Figure 21.

⚠ IMPORTANT! ⚠ Be certain that the bottom of the discharge chute is located inside of the lip of the deck opening, as shown in Figure 23.

Installing the Hose

1. Secure the upper end of the hose (C-MBH-0001) all the way onto the hose quick connect (C-MBP-0007). There are two holes on the lower part of the quick connect to allow for a sturdy connection. Use 2 Retainer clips (C-RVT-0001). See Figure 24.
2. Lift the quick connect with handles. Slide it into the hose adapter all the way and then twist to tightly lock in position as shown in Figure 25.
3. Lift at the other end of the hose. Slide the hose over the chute mounted on the cutting deck and use two retainer clips (C-RVT-0001) as shown in Figure 26. Make sure the connection is secure and there are no gaps between the hose and the chute.

NOTE: If open, close the bagger cover prior to mowing.

FIGURE 21

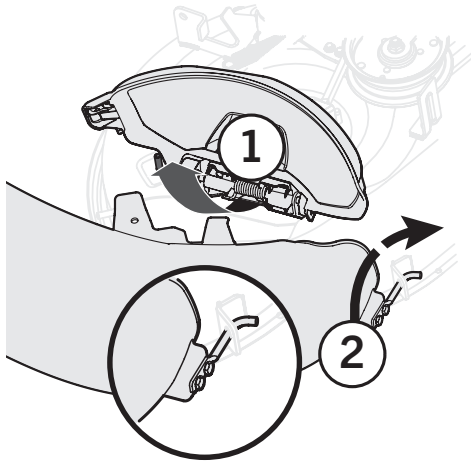

→ FIGURE 22

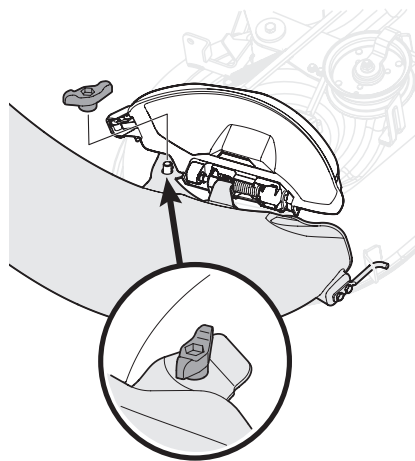

→ FIGURE 23

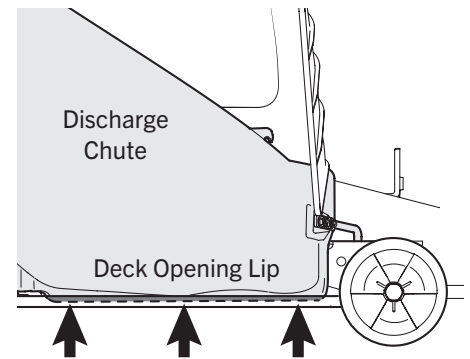
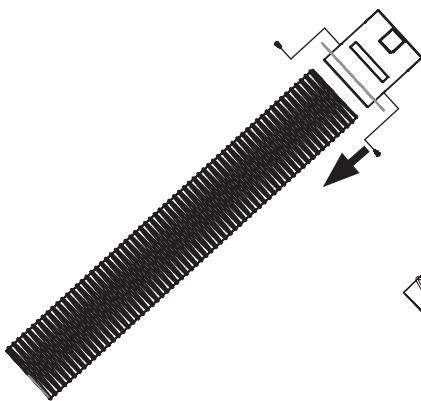
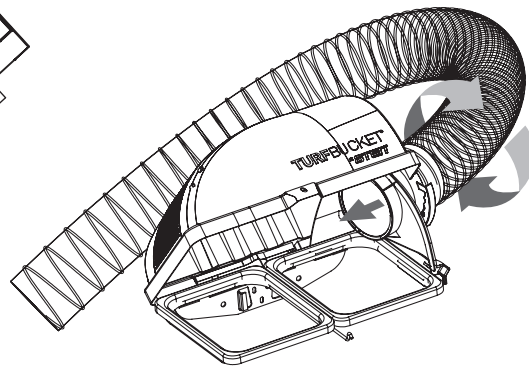

FIGURE 24



→ FIGURE 25



→ FIGURE 26

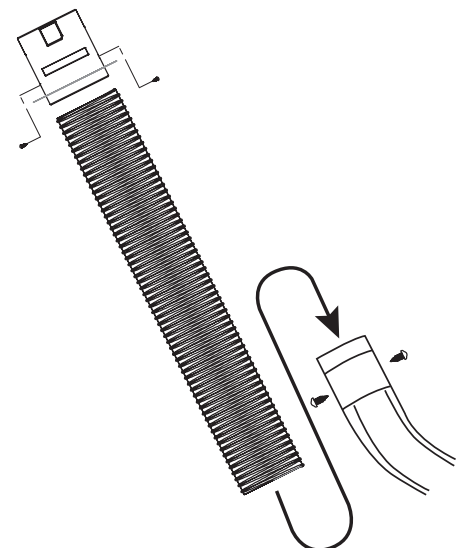

OPERATION

Double Bagger Usage

NOTE: When both grass bags are full, place the tractor on a firm, level surface, disengage the PTO, turn the tractor engine off and set the parking brake.

1. While mowing, periodically stop and check the viewing window on top of the grass catcher cover. See Figure 27.

NOTE: To ensure longevity and reliable performance do not allow grass bags to fill over the edge of the rim before emptying.

2. Open the bagger cover by pushing in on the rear side tabs with your hand (1) and lifting the cover with your other hand in the center rear of the bagger cover (2) as shown in Figure 28.
3. Do not remove the hose from the tractor.
4. Remove both bag assemblies from the hanger rails by lifting the back edge up first, and then sliding the front edge out and up until it is clear of the frame. See Figure 29.
5. Empty the grass clippings at a proper disposal site, use the handle at the bottom of each grass bag. Holding the bag firmly, empty the contents.
6. If the hose has buildup it can be cleared by removing it at the quick connect.
7. Replace grass bags, close lid, flip down seat, restart your tractor, release parking brake and resume cutting your grass.

FIGURE 27

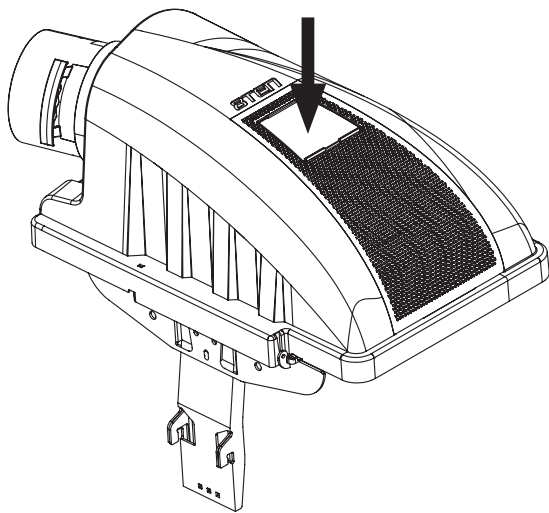

FIGURE 28

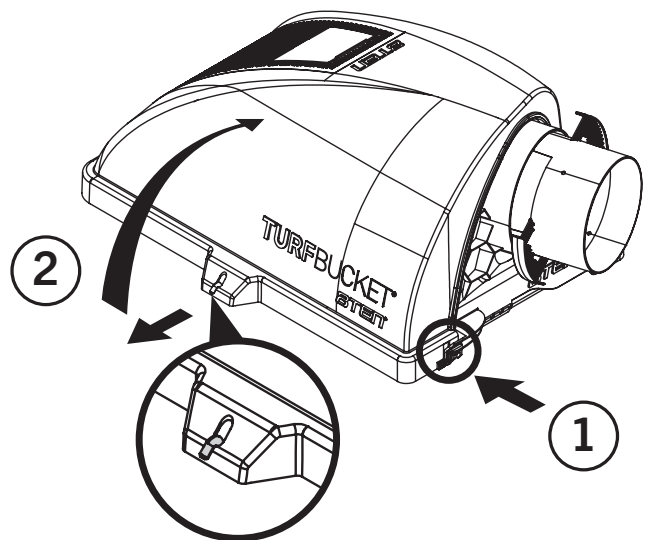
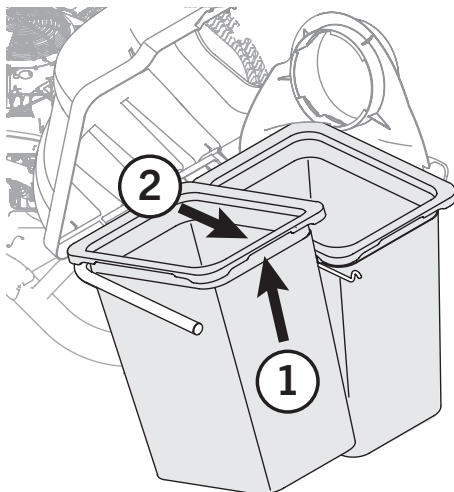
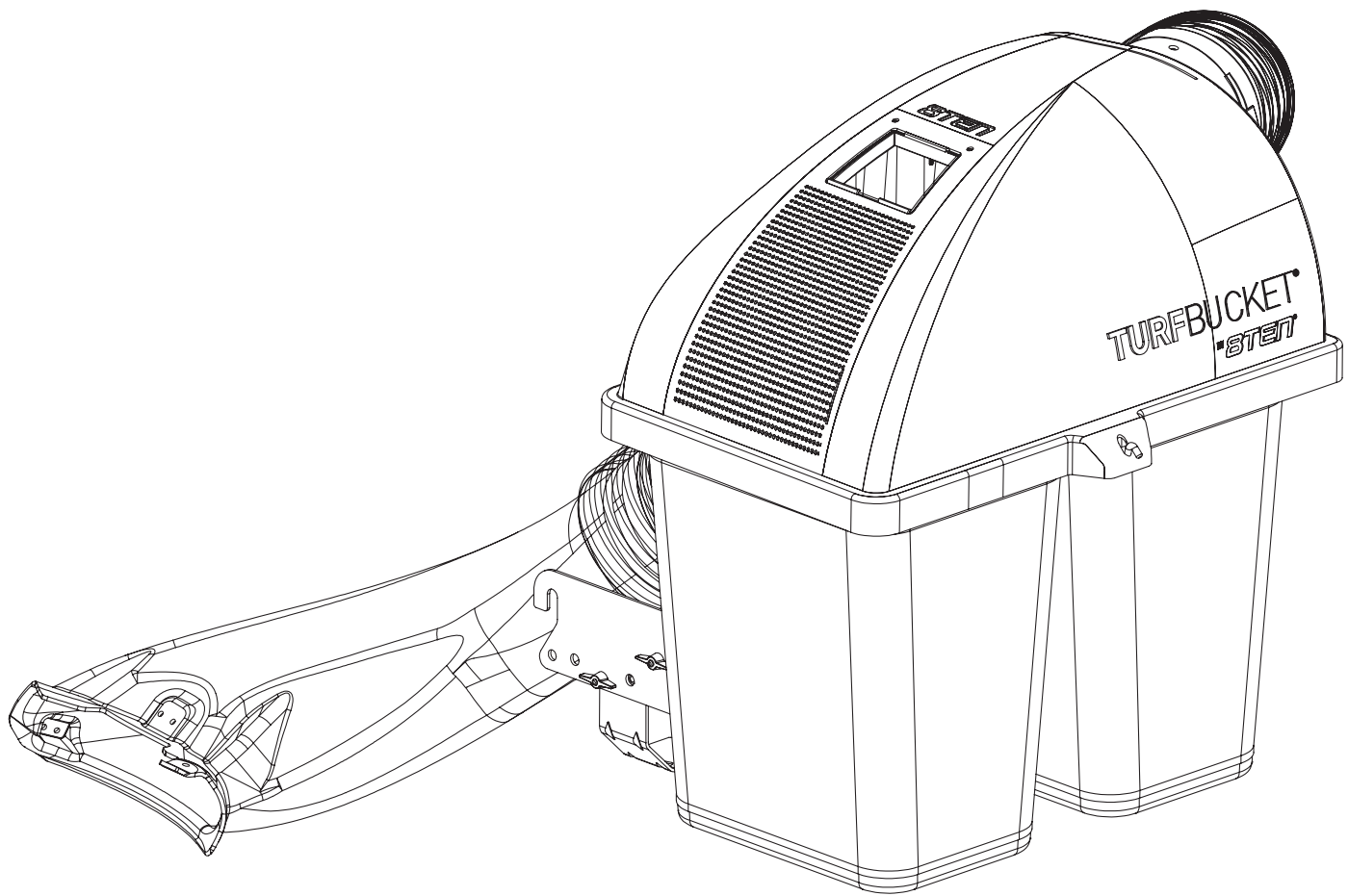

FIGURE 29





CONTACT US

Visit us at www.8TENPARTS.com for additional support and to view our full selection of replacement parts and accessories for your lawn mowers and outdoor power equipment.

Copyright © 2024 8TEN Parts®. All rights reserved.

This assembly manual and its contents are proprietary to 8TEN Parts®. No part of this manual may be reproduced, stored in a retrieval system, or transmitted in any form or by any means, electronic, mechanical, photocopying, recording, or otherwise, without the prior written permission of 8TEN Parts®.

TURFBUCKET® is a trademark of 8TEN Parts®, a subsidiary of subsidiary of SureFit Parts LLC.

8TEN Parts® reserves the right to make changes to the product described in this manual without notice. 8TEN Parts® assumes no responsibility for any errors that may appear in this manual.

8TEN
PARTS