

Diono[®]
Safety **in** Style™

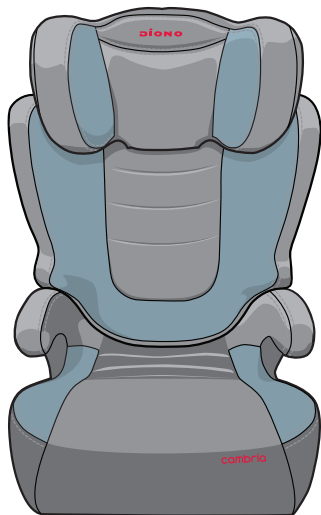

cambria

Instruction Manual

ENGLISH



WARNING ! **Death or SERIOUS INJURY can occur.**

Failure to follow all written instructions and product labels can result in death or serious injury in a crash. Carefully read and understand this instruction manual prior to using this restraint. If you have any questions visit diono.com or contact Diono LLC. To insure proper long-term use, store this manual under the bottom of the base.

- Use only with children whose height is between 38" and 63" and whose weight is between 40 lbs and 120 lbs.
- Only use this restraint forward-facing.
- Use only the vehicle's lap and shoulder belt system when restraining the child in this booster seat.
- NEVER use with only a vehicle lap belt to restrain a child. This could result in serious injury or death to a child.
- Some vehicle seat belt systems cannot be used with this booster seat. Read vehicle owner's manual and 'Vehicle Seat Belt Systems' section of this manual.
- DO NOT use this booster seat without the backrest unless there is vehicle headrest for that seating position.
- DO NOT use this booster seat without the backrest unless proper vehicle seat belt placement can be achieved.
- DO NOT use this booster seat with any other backrest or cushions.
- To prevent injury due to product deterioration, do not use this booster seat if it has been involved in a severe accident or if it is older than ten years.
- Never leave a child alone in a vehicle, even for a short time.





WARNING !
Death or SERIOUS INJURY can occur.

- Always secure this booster seat using vehicle seat belt or LATCH anchors even when not occupied. In a crash, an unsecured item may cause injury to other vehicle occupants.
- Except as described in this manual, do not disassemble or modify any part of this booster seat or vehicle seat belt.
- Register your child restraint with the manufacturer.
- Do not place anything under the booster seat to raise it off the vehicle seat.
- This restraint is not a toy. Do not let a child play with it.
- Do not leave folding vehicle seats unlatched. In the event of a sudden stop, a loose seat back could prevent the booster seat from protecting the child as well as it should.
- In the event of an accident, the vehicle body itself provides the most significant passenger protection. While a properly installed restraint will improve chances for survival in most accidents, a booster seat will not protect a child if the vehicle is too severely impacted.
- Follow all instructions on this child restraint and in the written instructions. To insure proper long term use, store this manual under the bottom of the base.



WARNING !
Death or SERIOUS INJURY can occur.

- According to accident statistics, the National Highway Transportation Safety Administration (NHTSA) recommends that parents select the rear seat as the safest location to properly install a booster seat. Please read carefully the section concerning vehicle seat belts in this guide to insure the child's safety. If in doubt about installing this booster seat, please consult the vehicle owner's manual

WARNING: *DO NOT place a child restraint in the front seat of a vehicle with a passenger air bag unless the air bag is turned off. DEATH or SERIOUS INJURY can occur. The back seat is the safest place for children under 12.*



IMPORTANT: Children who weigh 40 lbs (18 kg) or less are best protected in a 5-point harness restraint. Diono recommends that children remain in a 5-point harness restraint until reaching the maximum weight or height allowed.

- If the child will not keep the vehicle shoulder belt properly positioned at all times, DO NOT use a booster seat. You must use a harnessed child restraint.
- **Maximum Child Height:** Child is too tall if the top of the ears are above the top of either the fully raised booster seat headrest or fully raised vehicle headrest.

Safety Information

GENERAL

- Cover this booster seat if vehicle is left in direct sunlight. Portions of the booster seat can become hot enough to burn a child and cover fabric can become faded.
- Store this booster seat in a safe place when not in use. Do not store near direct heat source or place heavy objects on top of it.
- Always make sure vehicle seat is locked in its upright position. Reclining the vehicle seat will adversely affect the safety and performance of the child seat in an accident.

CERTIFICATION

This child restraint system conforms to all applicable Federal Motor Vehicle Safety Standards. **This restraint is not certified for use in aircraft.** Lap belts in aircraft cannot be used safely with this booster seat.

REGISTRATION

Visit www.diono.com to register your restraint online. Child restraints can be recalled for safety reasons. You must register this restraint to be reached in a recall. Send your name, address and this restraint's model and serial number and manufacturing date to Diono LLC, 418 Valley Avenue NW, Puyallup, WA 98371, or call **1-855 GO DIONO**. For recall information call the U.S. Government's Vehicle Auto Safety Hotline at **1-888-327-4236** (TTY 1-800-424-9153) or go to www.nhtsa.gov.

VEHICLE SEAT BELT SYSTEMS

IMPORTANT: Some vehicles have no seating positions compatible with booster seats. If in doubt, please contact the vehicle manufacturer for assistance.



WARNING: *ONLY use this booster seat with a 3-point (lap-and-shoulder) vehicle seat belt that is NOT motorized or anchored to the vehicle door.*

Safety Information *(continued)*

In order to protect a child in an accident, this booster must be used with a compatible vehicle seat belt.

The following seat belt types are NOT compatible with this booster seat:

- *Two-point seatbelts of any kind.*
- *Three-point seat belts with separate retractors for lap and shoulder sections.*
- *Motor-driven, automatic seat belts.*
- *Seat belts with anchorage points on the door.*

The vehicle owner's manual will have complete information on the types of seat belts in the vehicle. If the seat belt type is listed above, choose another seating position in the vehicle.

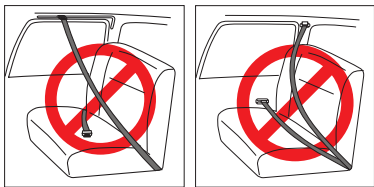

VEHICLE SEATING POSITIONS

Diono and the U.S. Department of Transportation warn that children under 12 must ride in the rear seats and away from front airbags. The only exception is if the airbag is turned off. When using a vehicle with airbags, refer to the vehicle owner's manual for additional booster seat installation instructions and precautions.



WARNING: *Only use this booster seat in forward-facing vehicle seats. DO NOT use this booster seat in side-facing or rear-facing seats in vans or station wagons.*



Seats which face sides of vehicle.

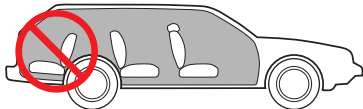

Seats which face rear of vehicle.

Parts for Assembly & Installation

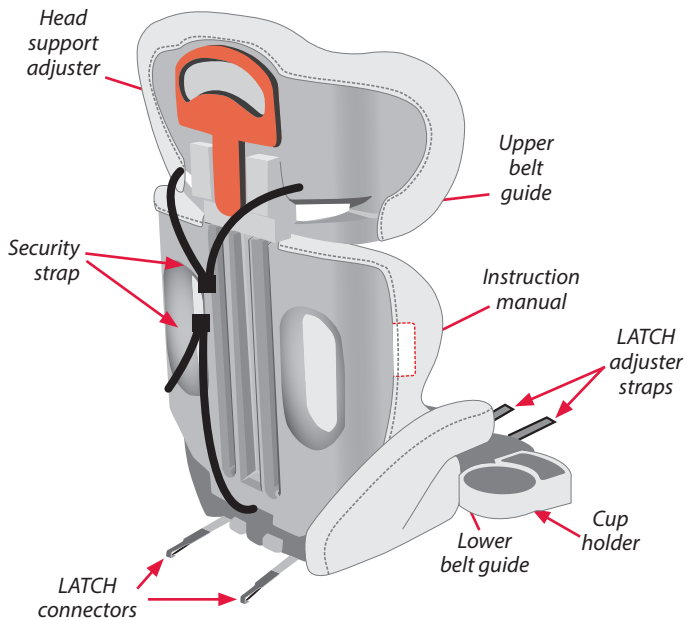

CUP HOLDERS

Cup holders are located on both sides of seat bottom: swivel outward to the locked position for use. Swivel inward to the recessed and locked position when not in use.

IMPORTANT: Do not step on or put excess weight on cup holder which could cause it to break.

CAUTION: DO NOT use with hot liquids as this could burn a child.

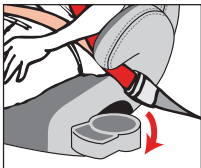

Booster Seat Assembly

ATTACHING THE BACKREST

- 1 Lay backrest on flat surface with front facing down.
- 2 Hold seat bottom facing down. Align seat bottom pivot bar at 90° angle with backrest hooks. Push in to attach seat bottom to backrest.
- 3 Rotate seat bottom downwards and under back rest until a 'click' is heard and the seat shape is formed.

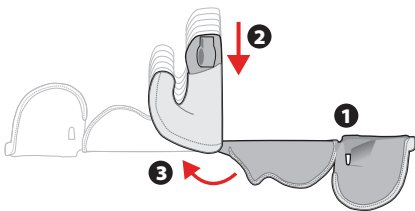

REMOVING THE BACKREST

Follow above instructions in reverse.

ADJUSTING THE HEADREST

Squeeze the red head support adjuster on back of booster seat head rest while adjusting its height up or down to fit the child.

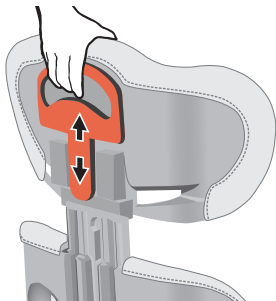

LATCH Installation

To improve safety and performance, this booster seat is equipped with a unique, LATCH system that allows secure attachment to a vehicle's lower LATCH anchor locations.



WARNING: *Unsecured objects can become flying hazards and can cause serious injury in an accident. Diono always recommends utilizing LATCH installation in vehicles equipped with lower anchors.*

Disengage LATCH connectors from storage slots and lay booster seat on its side.

- 1 While depressing the cam lock lever,
- 2 pull LATCH connectors away from the booster seat and extend both straps all the way.
- 3 Attach both LATCH connectors to the vehicle anchors, starting with the connector that is furthest from you. For ease of use, make sure open end of hooks face upward during use.
- 4 While pushing booster against vehicle seat,
- 5 pull one adjuster strap tight and then the other.

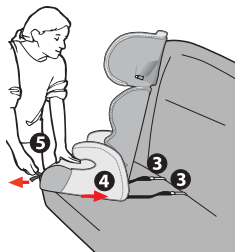
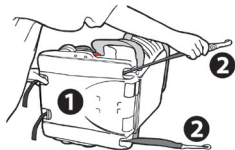

NOTE: Even with LATCH properly attached and adjusted, child seat will still have movement against the vehicle seat back and bottom.



SECURITY STRAP

This restraint features a unique security strap that improves the safety, performance and security of this child restraint. Diono always recommends the use of this security strap when possible.

INSTRUCTIONS

- 1 Route lower end of strap (2) under vehicle seat back
- 2 Extend upper end of strap (1) over top of vehicle seat back
- 3 Fasten upper and lower ends of strap together
- 4 Confirm restraint is positioned properly on vehicle seat
- 5 Pull free end of strap (2) until top of vehicle seat cushion is compressed and strap is tight
- 6 Confirm restraint is secured tightly to vehicle seat. If not, repeat step 5.

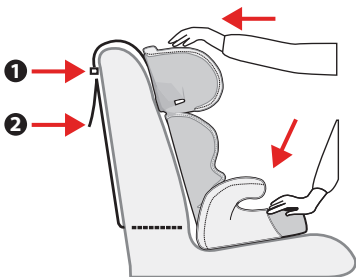
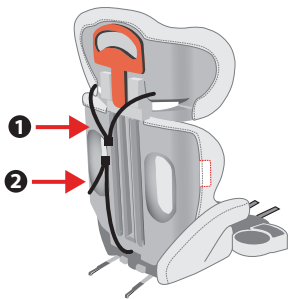

DISENGAGING LATCH INSTALLATION

Follow above instructions in reverse:

- 1) Depress the cam lock lever while pulling child seat away from the vehicle seat back until the LATCH straps are extended all the way.
- 2) Disconnect LATCH connectors from vehicle anchors.
- 3) Pull LATCH adjuster straps to recess the LATCH connectors into the back of the booster seat bottom for safe storage.

Proper Positioning on Vehicle Seat

Place booster seat on vehicle seat so it is resting firmly on vehicle seat bottom and touching the vehicle seat back.

IMPORTANT: When using the booster seat as a high-back booster, try to position backrest in full contact with vehicle seat back. It may also be necessary to adjust the recline angle of the booster seat to match that of the vehicle seat.

IMPORTANT: When using booster seat in center seating position, make sure it is stable and does not rock from side to side.

IMPORTANT: Do not use LATCH if installation interferes with vehicle seat belt.

ADJUSTING THE RECLINE ANGLE

This booster seat features a recline angle that can adjust to match that of the vehicle seat:

- 1) Push booster seat backrest backwards until you hear a click. Backrest will now pivot freely and does not need to click into another position.
- 2) Push seat bottom and backrest of booster seat down and back into vehicle seat until there is secure positioning and full contact with the booster seat and vehicle seat bottom and vehicle seat back.



Securing the Child

- 1) Make sure booster seat is properly positioned and installed on vehicle seat as per the instructions in page 11.
- 2) Properly position child: sitting upright and all the way back in the booster seat.
- 3) Raise the headrest to access the upper belt guides. Feed the diagonal portion of the seatbelt through the upper belt guide on the side opposite the seatbelt buckle.
- 4) Fasten seatbelt across child: Lap portion of seatbelt should rest within both lower belt guides. Diagonal shoulder portion should route inside the lower belt guide closest to the buckle and over child's shoulder.
- 5) Adjust headrest (*page 8*) to proper height: Upper shoulder guide should be slightly above (at least 1 cm) the child's shoulders.
- 6) Make sure seat belt is not twisted and lays flat across child's lap, torso and shoulder.
- 7) Tighten the seatbelt by pulling the diagonal shoulder belt portion in the direction of the arrows.
- 8) Confirm seatbelt buckle is in correct position (*see below*).

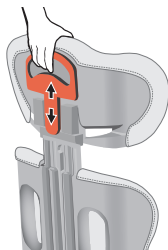



WARNING: If lap portion and diagonal portion of seatbelt are not positioned correctly, the booster seat is not properly installed:

- Diagonal portion of seatbelt should lay over the shoulder and **NOT** touching the neck.
- Lap belt position should be forward and as low as possible over child's pelvis and contacting the upper thigh.

PROPER BUCKLE POSITION

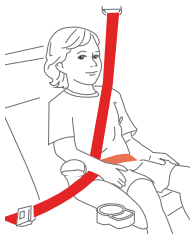

IMPORTANT: After booster seat is installed and seatbelt is fastened around child, it is important to confirm correct seatbelt buckle position to ensure secure installation. Correct seatbelt buckle position: Buckle is on the outside of lower belt guide.

Incorrect seat belt buckle position.

If buckle is being pulled across the lower belt guide and into the seat, choose another seating position within the vehicle.



Backless Booster Seat

While this booster seat is designed to offer advanced side-impact protection with its backrest section attached, the seat bottom can also be used alone as a backless booster.

- 1) Remove seat bottom from backrest section (see page 9).
- 2) Make sure booster seat is correctly installed (page 11) and properly positioned on vehicle seat.
- 3) Properly position child: sitting upright and all the way back in the booster seat.



- 4) Fasten seatbelt across child.
- 5) Make sure seat belt is not twisted and lays flat across child's hips, torso and shoulder.
- 6) Tighten the seatbelt by pulling the diagonal shoulder belt portion in the direction of the arrows.

IMPORTANT: Lap belt position should be as far forward and as low as possible over child's pelvis and contacting upper thighs.

IMPORTANT: Diagonal seat belt portion should route inside the lower belt guide closest to the buckle and over child's shoulder. It should NOT be touching the neck.

NEVER position the shoulder belt loosely or under the child's arm or behind their back.



WARNING: If the diagonal seat belt portion does not correctly fit the child, then the seat must be used with the shoulder belt guide strap or with the seatback portion attached and properly adjusted to fit the child.

Using the Shoulder Belt Guide Strap

Remove shoulder belt guide strap from storage area underneath seat.

Position child correctly in seat as per the instructions in the manual, making sure lap and shoulder belts are positioned properly across child.

Attach the red shoulder belt guide strap onto the diagonal shoulder belt.

Adjust strap to correct length, so that red guide is just above shoulder.

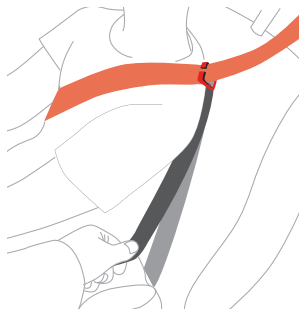

Care & Maintenance

CLEANING THE COVER

Read all labels attached to cover for washing instructions.

Hand wash cover in cold water with mild detergent only.

Line dry to prevent shrinkage.

Do NOT wash cover in hot water.

Do NOT bleach, machine wash or machine dry.

CLEANING THE SHELL

Sponge clean ONLY using warm water and mild soap. Towel dry when finished. Do NOT use solvents, detergents or any other chemical or cleaning agent. Do NOT lubricate any part of the seat.

REMOVING THE FABRIC COVER

- 1) Separate seat back section from seat bottom section.
- 2) Remove plastic fasteners and elastics that secure fabric cover to seat bottom, seat back and head rest.
- 3) Remove fabric cover pieces from the booster seat sections.

ATTACHING THE COVER

Follow the above instructions in reverse.

Warranty Information

The manufacturer of this child restraint, Diono LLC, warrants this product only to the original retail purchaser. Visit www.diono.com for complete warranty information and details.

diono®

Safety in Style™

Product: Cambria child booster seat
Model: 310000
Mfg. by: Diono LLC
418 Valley Avenue NW
Puyallup, WA 98371

CUSTOMER SERVICE

Tel: 855.463.4666

Email: dionoUSA@diono.com

diono.com

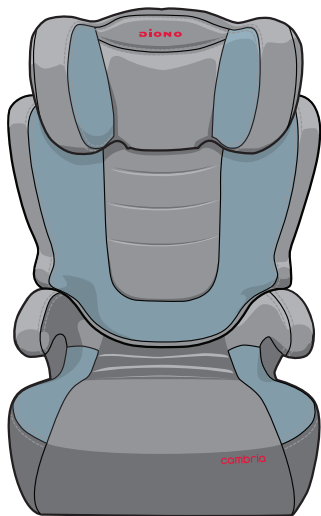

cambria