



THE  
MAGIC-FLIGHT  
LAUNCH BOX  

---

FLIGHT GUIDE

# INTRODUCTION

THIS **LAUNCH BOX FLIGHT GUIDE** INTRODUCES YOU TO THE UNIQUE DIFFERENCES & NUANCES OF THE LAUNCH BOX. PROPER USE WILL HELP ENSURE THE LONGEVITY OF YOUR INVESTMENT.

OUR QUALITY CRAFTSMANSHIP INTEGRATES A PATENTED TECHNOLOGY WITH NO ELECTRONICS AND NO INTERNAL CIRCUIT BOARD TO FAIL. YOUR **LAUNCHBOX** IS RELIABLE & BUILT-TO-LAST.

**FOR OPTIMAL RESULTS:** THE **FINISHING GRINDER** WILL PROVIDE A FLUFFY, ULTRA FINE GRIND & MAXIMIZE YOUR HERBAL YIELD.

*Love is that which enables choice.  
Choose on the basis of Love.*

# QUICK START GUIDE

## 1. FILL SCREEN TRENCH WITH A FINE GRIND.



Too coarse



Just right

### SCREEN CARE

- THE SCREEN TRENCH ON THE TOP OF YOUR BOX IS EXTREMELY DURABLE BUT FRAGILE TO PRESSURE.
- **DO NOT PRESS ON THE SCREEN. DO NOT PACK THE TRENCH.**
- FILL ONLY TO TOP OF SIDE RAILS TO ENSURE 360 DEGREE AIRFLOW.

### HERBAL MATERIAL

- **ALWAYS USE BONE DRY HERBAL MATERIAL.**

**WE RECOMMEND:** ORGANIC CANNABIS, MEDICINAL HERBS, FLOWERS, OR THE TINIEST BIT OF TOBACCO.

- THE **FINISHING GRINDER** IS PERFECTLY DESIGNED TO FIT SNUGLY ON TOP, FOR AN ULTRA FINE GRIND. YOU MAY USE YOUR OWN GRINDER TO PRE-GRIND BUT A FINE GRIND IS KEY FOR THE BEST LAUNCH & OPTIMAL YIELD.

# QUICK START GUIDE

## 2. ENGAGE EXTERNAL POWER SOURCE.



INSERT BATTERY OR RHEOSTAT INTO  
THE SIDE CHAMBER.



LOOK FROM ABOVE OR INTO THE  
DRAW HOLE FOR INDICATOR LIGHT.

- SELECT FROM: (1) **POWER PAC**, (2) **POWER UP 3.0**, OR (3) **MAGIC FLIGHT AA RECHARGEABLE BATTERY SET**.

### POWER OPTIONS:

**AA BATTERY SET** IS INCLUDED WITH THE FLIGHT FLIGHT.

THE **RHEOSTAT** COMES WITH THE **POWER PAC & POWER UP 3.0** WITH ADJUSTABLE TEMPERATURE CONTROL.

- INSERT THE RHEOSTAT OR FULLY CHARGED AA BATTERY INTO THE SIDE CHAMBER.
- PRESS PRESS THE BUTTON ON THE RHEOSTAT OR PUSH IN BATTERY TO ENGAGE POWER.
- SCREEN HEATS TO 370-720 FAHRENHEIT & VAPOR WILL BEGIN TO APPEAR WITHIN 3-5 SECONDS.

# QUICK START GUIDE

## 3. AFTER VAPOR FORMS, DRAW SLOWLY.

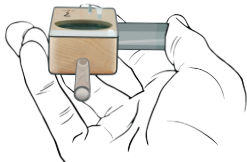

- KEEP BOX RELATIVELY LEVEL & DRAW SLOWLY FROM DRAW STEM.
- **DRAW SLOW & EASY...** A SLOOOOW EASY SIP, AS IF FROM A CUP OF HOT TEA.
  - **THE POWER IS YOUR HANDS.** THIS MAY SEEM COUNTER-INTUITIVE HOWEVER, YOU CONTROL THE TEMPERATURE WITH THE RATE OF YOUR DRAW.
  - **EXPLORE THIS NUANCE:** THE STRONGER YOUR DRAW, THE COOLER THE SCREEN  
THE SLOWER YOUR DRAW, THE HOTTER THE SCREEN
- AT THE END OF YOUR DRAW, RELEASE THE RHEOSTAT BUTTON OR BATTERY PRESSURE TO DISENGAGE POWER. *NO SMOKE. NO COMBUSTION. NO CARTRIDGE. NO SOLDER. NO LEAD. NO HEAVY METAL.*
- THE VAPOR IS A PURE HERBAL EXTRACTION FOR A DISCREET YET HIGHLY EFFECTIVE LAUNCH.

# QUICK START GUIDE

## 4. SHAKE BETWEEN DRAWS. BRUSH TO CLEAN.

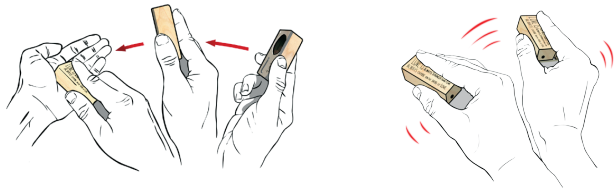

- SHAKE YOUR BOX TO REDISTRIBUTE YOUR HERBAL MATERIAL BETWEEN DRAWS.
- YOUR SESSION IS FINISHED WHEN THE MATERIAL IS AN EVEN BROWNISH COLOR & TASTES A BIT LIKE TOASTED POPCORN.
- TO CLEAN, GENTLY BRUSH OUT HERBAL MATERIAL WITHOUT APPLYING PRESSURE TO THE SCREEN TRENCH.
- USING BONE DRY HERB WON'T LEAVE RESIDUE OR BUILD UP & ENSURES THE LONGEVITY OF YOUR SCREEN.
- **BONUS:** SAVE & COLLECT YOUR **ABL** (ALREADY BEEN LAUNCHED) TOASTY MATERIAL.

TOSS INTO YOUR SPECIAL BROWNIE OR COOKIE BATCH OR EVEN SPAGHETTI SAUCE TO FURTHER ENJOY ANY REMAINING ACTIVE INGREDIENTS.

# FLIGHT SUPPORT

QUESTIONS OR FEEDBACK? OUR FLIGHT CREW IS AT YOUR SERVICE:

[CUSTOMERSERVICE@MAGIC-FLIGHT.COM](mailto:CUSTOMERSERVICE@MAGIC-FLIGHT.COM)

## STAY CONNECTED!

JOIN OUR MAGIC TRIBE

SUBSCRIBE TO OUR NEWSLETTER FOR EXCLUSIVE OFFERS

SHARE YOUR PRAISES & LAUNCH SPOT PHOTOS

SPREAD THE NEWS ABOUT OUR HANDCRAFTED CREATIONS WITH  
YOUR FRIENDS & HELP THE WORLD BREATHE EASIER!

[INSTAGRAM.COM/MAGICFLIGHT](https://www.instagram.com/magicflight)

[FACEBOOK.COM/MAGICFLIGHT](https://www.facebook.com/magicflight)